

ON-VEHICLE INSPECTION

1. ADJUST STANDARD VEHICLE HEIGHT

- (a) Release the parking brake and stabilize the suspensions by pushing up and down on the corners of the vehicle.
- (b) Adjust the shift lever to the N position and settle the tires by shifting the vehicle back and forth by hand.
- (c) Start the engine.
- (d) On the height control switch, first press "HI" to raise the vehicle's height, and next press "LO" to lower it, and then press the switch to change it to the "N" position.

NOTICE:

Make sure to release the parking brake and adjust the shift lever to the N position.

2. INSPECT TIRE

3. ADJUST VEHICLE HEIGHT

4. ADJUST VEHICLE HEIGHT

5. INSPECT VEHICLE HEIGHT SWITCH FUNCTION

NOTICE:

Perform the procedure with the vehicle vacant and unloaded.

- (a) Change the height control switch from the "N" position to the "HI" position and back to the "N" position again. Check the time it took and the degree of change in the vehicle's height to reach the target height.

"N" → "HI" position:

approx. 40 to 60 seconds

"HI" → "N" position:

approx. 20 to 40 seconds

Change in vehicle height:

approx. 30 mm (1.18 in.)

NOTICE:

Shut off the engine to check the vehicle height.

- (b) Change the vehicle height control switch from the "N" position to the "LO" position and back to the "N" position again. Check the time it took and the degree of change in the vehicle's height to reach the height target height.

"N" → "LO" position:

approx. 10 to 30 seconds

"LO" → "N" position:

approx. 20 to 40 seconds

Change in vehicle height:

approx. 15 mm (0.59 in.)

NOTICE:

Shut off the engine to check the vehicle height.

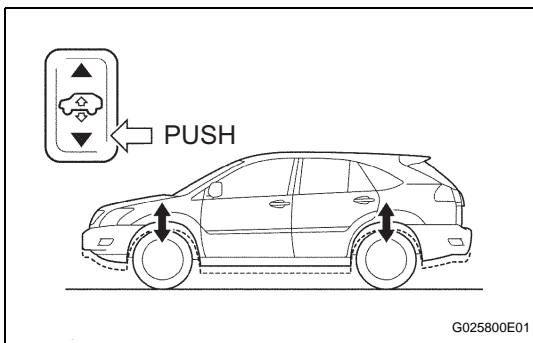

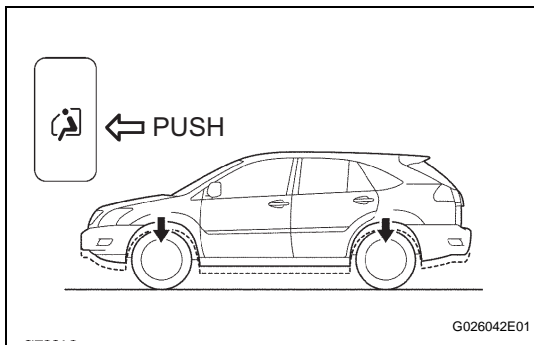

6. INSPECT GET ON AND OFF MODE FUNCTION

- (a) Turn the access mode switch ON and check the change in the vehicle's height with the engine stopped.

Change in the vehicle height, Down from "N" position:

approx. 30 mm (1.18 in.)

NOTICE:

When the function inspections are performed in succession, the vehicle height control is interrupted.

7. INSPECT AUTOMATIC LEVELING FUNCTION

NOTICE:

Make sure the height control switch is in the "NORM" position and the access mode switch is OFF.

- (a) Turn the ignition switch OFF and have four people (two in the front, two in the rear) ride in the vehicle.

HINT:

Each person should weigh approx. 68 kg.

- (b) Start the engine and check the time it takes to complete vehicle height control.

Time to target height:

approx. 40 to 60 seconds

- (c) Turn the ignition switch OFF and then have the four people get out of the vehicle.

- (d) Start the engine and check the time it takes to complete vehicle height control.

Time to target height:

approx. 10 to 30 seconds

8. CHECK CONNECTIONS OF TIRES FOR AIR LEAKAGE

- (a) Set the height control switch to the "HI" position and raise the vehicle's height.

- (b) Stop the engine.

(c) Apply soapy water to the connections of the tubes and check if there is any air leakage.

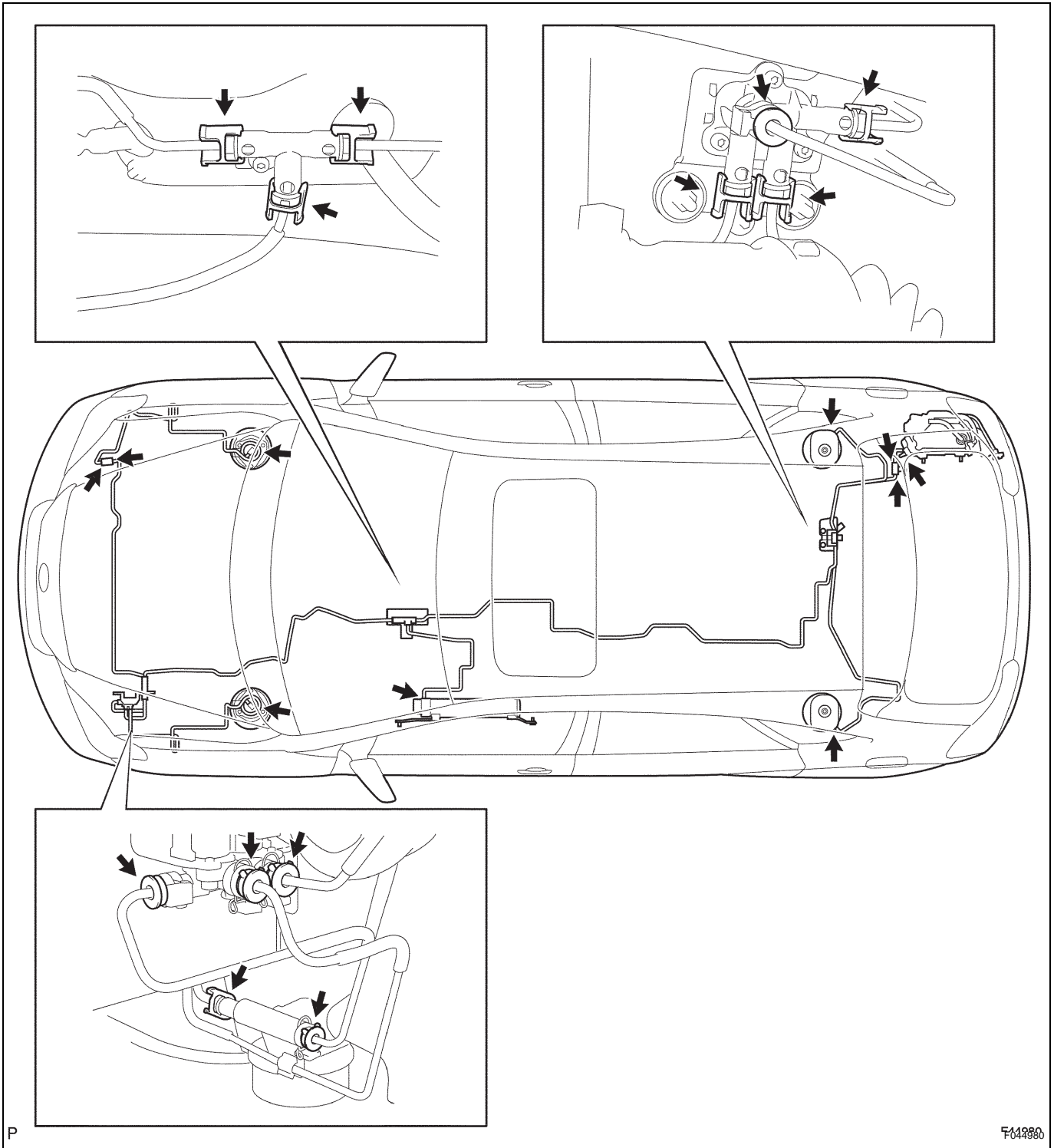

P

F04280

SC