

- (c) Remove the 3 bolts and windshield wiper motor assembly from the windshield wiper link assembly.

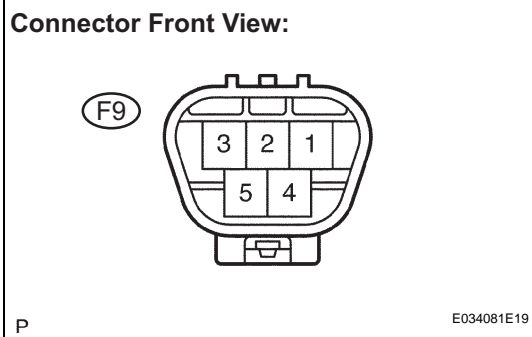

INSPECTION

1. INSPECT FRONT WIPER MOTOR

- (a) LO Operation Check
 - (1) Connect the positive battery (+) lead to terminal 1 (+1) of the connector, and the negative battery (-) lead to terminal 5 (E), and check that the motor operates with low speed (LO).
- (b) HI Operation Check
 - (1) Connect the positive battery (+) lead to terminal 4 (+2) of the connector, and the negative battery (-) lead to terminal 5 (E), and check that the motor operates with high speed (HI).
- (c) Automatic Stop Operation Check
 - (1) Put the matchmarks on the front wiper motor.
 - (2) Connect the positive battery (+) lead to terminal 1 (+1) of the connector, and the negative battery (-) lead to terminal 5 (E). With the motor being rotated at low speed (LO), disconnect the terminal 1 (+1) to stop the wiper motor operation at position other than the matchmarks.
 - (3) Using SST, connect the terminal 1 (+1) and the terminal 3 (S), and the positive battery (+) lead to the terminal 2 (B) to restart the motor operation at low speed.
SST 09843-18040
 - (4) Align the matchmarks with the front wiper motor.

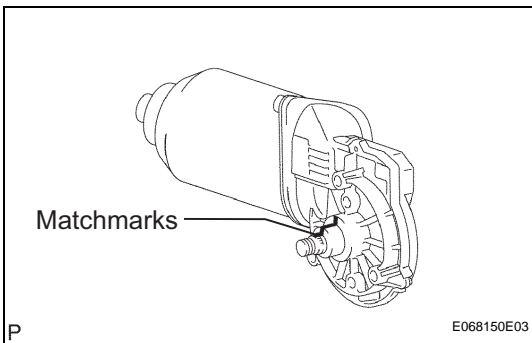

INSTALLATION

- ### 1. INSTALL WINDSHIELD WIPER MOTOR ASSEMBLY
- (a) Install the windshield wiper motor assembly with the 3 bolts.
Torque: 5.4 N*m (55 kgf*cm, 48 in.*lbf)
 - (b) Apply MP grease to the crank arm pivot of the windshield wiper motor assembly.

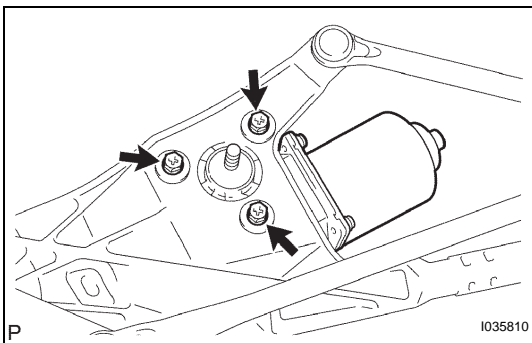

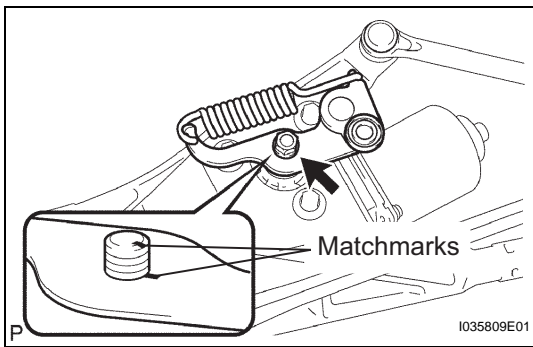

- (c) Align the matchmarks on the crank arm assembly and windshield wiper motor assembly, then install the washer and nut.

Torque: 17 N*m (175 kgf*cm, 13 ft.*lbf)

- (d) Install the rod to the crank arm pivot of the windshield wiper motor assembly.

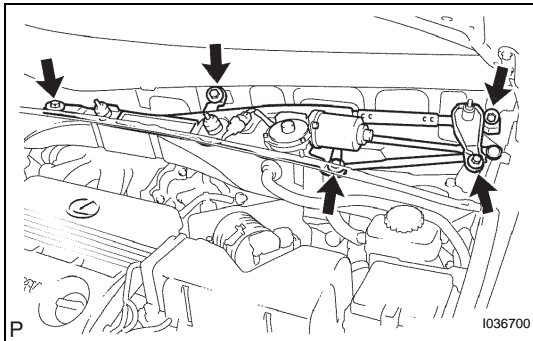

2. INSTALL WINDSHIELD WIPER MOTOR AND LINK ASSEMBLY

- (a) Install the windshield wiper motor and link assembly with the 5 bolts.

Torque: 7.0 N*m (71 kgf*cm, 62 in.*lbf)

- (b) Connect the connector.

3. INSTALL COWL TOP VENTILATOR LOUVER SUB-ASSEMBLY

4. INSTALL FRONT WIPER ARM AND BLADE ASSEMBLY LH

- (a) Operate the wiper, and stop the windshield wiper motor assembly at the automatic stop position.

- (b) Clean the wiper arm serrations.

- (c) Clean the wiper pivot serrations with a wire brush (when reinstalling).

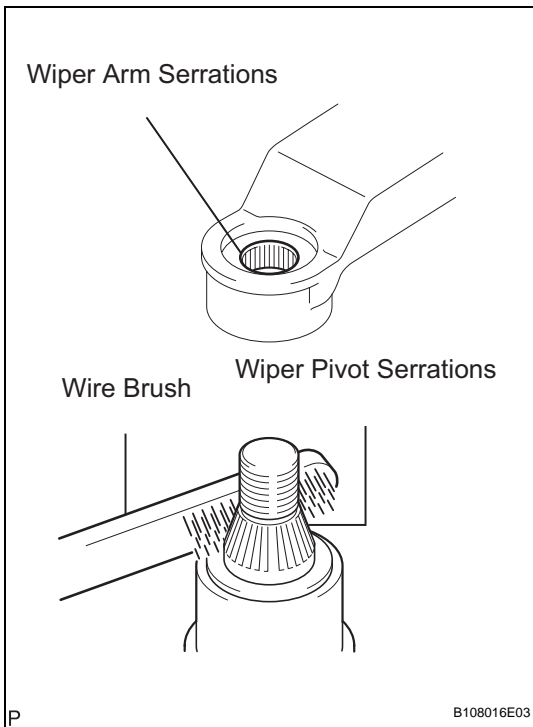

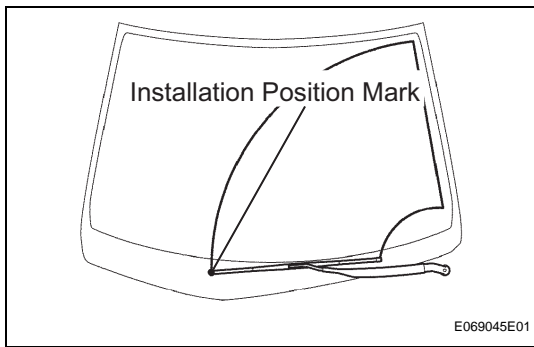

- (d) Install the front wiper arm and blade assembly LH with the nuts at the position as shown in the illustration.

Torque: 24 N*m (245 kgf*cm, 18 ft.*lbf)

HINT:

Hold the arm hinge by hand to fasten the nut.

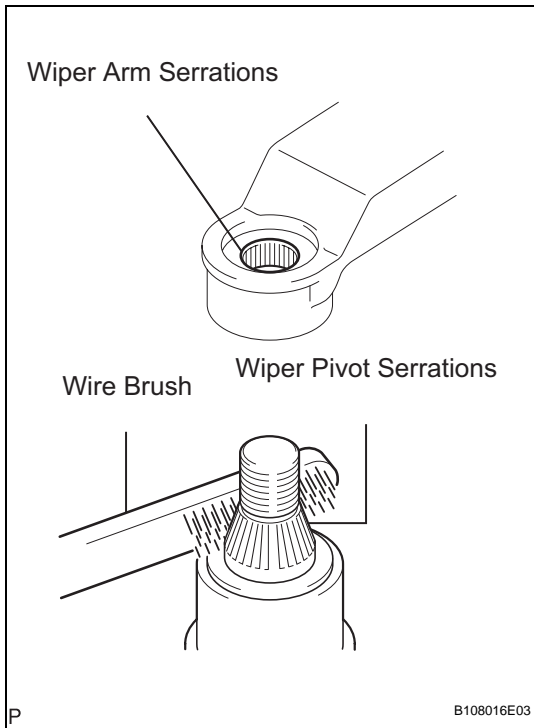

5. INSTALL FRONT WIPER ARM AND BLADE ASSEMBLY RH

- (a) Clean the wiper arm serrations.
- (b) Clean the wiper pivot serrations with a wire brush (when reinstalling).

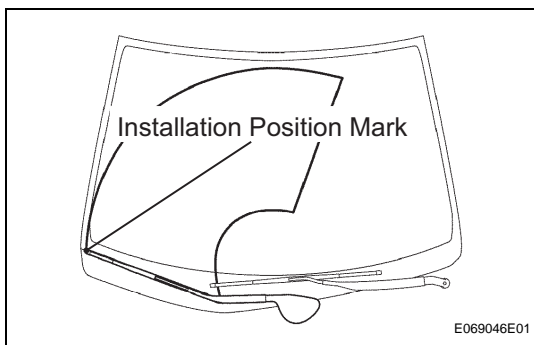

- (c) Install the front wiper arm and blade assembly RH with the 2 nuts at the position as shown in the illustration.

Torque: 24 N*m (245 kgf*cm, 18 ft.*lbf)

HINT:

Hold the arm hinge by hand to fasten the nut.

- (d) Operate the front wipers while spraying water or washer fluid on the windshield.
- (e) Make sure that the wipers function properly and there is no interference with the vehicle body.