

GROUP 13C

FUEL SUPPLY

CONTENTS

GENERAL INFORMATION	13C-2	FUEL TANK PUMP ASSEMBLY REPLACEMENT	13C-2
SEALANT	13C-2	FUEL TANK GAUGE UNIT REPLACEMENT	13C-3
SPECIAL TOOL	13C-2	FUEL LEAK CHECK OF FUEL TANK	13C-4
ON-VEHICLE SERVICE	13C-2	FUEL TANK	13C-5
FUEL TANK PUMP OPERATION CHECK	13C-2	REMOVAL AND INSTALLATION	13C-5
FUEL TANK GAUGE UNIT CHECK	13C-2	DISASSEMBLY AND REASSEMBLY	13C-7

GENERAL INFORMATION

- The fuel tank assembly is located under the floor of the rear seats to provide increased protection and a more luggage space.
- A fuel tank safety valve has been adopted to prevent fuel from leaking out in case of a collision.
- A fuel tank pump assembly including fuel tank pump and fuel tank filter, has been adopted to lighten weight and improve serviceability.

M1135000100383

SEALANT

M1135005200028

Item	Specified sealant
Service hole cover and floor pan	3M 8513 Grommets windshield sealer (Black)

SPECIAL TOOL

M1135000600526

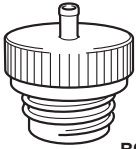
Tool	Number	Name	Use
 B992145	MB992145	Fuel leak check cap	Fuel leak check

ON-VEHICLE SERVICE

FUEL TANK PUMP OPERATION CHECK

M1135001000129

Refer to GROUP 13A - On-vehicle Service

[P.13A-402.](#)

FUEL TANK GAUGE UNIT CHECK

M1135003100326

Refer to GROUP 54A - Combination Meter

[P.54A-65.](#)

FUEL TANK PUMP ASSEMBLY REPLACEMENT

M1135004900273

1. Remove the rear seat cushion (Refer to GROUP 52A - Rear Seat [P.52A-30](#)).
2. Remove the service hole cover mounting screws and remove the service hole cover.
3. Disconnect the fuel tank pump assembly connector, fuel high-pressure hose and fuel tank hose.
4. Remove the mounting nuts and fuel pump bracket plate, and remove the fuel pump assembly from the service hole.
5. Install the fuel pump assembly to the fuel tank through the service hole.

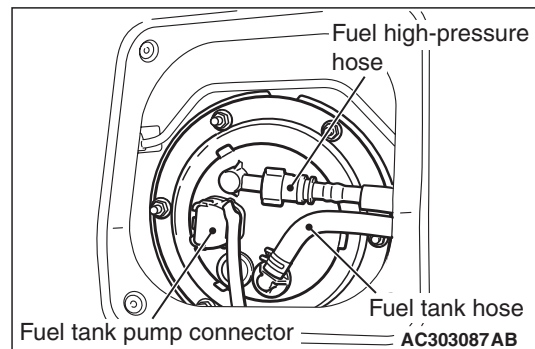

- Install the fuel pump bracket plate to the fuel tank and tighten the mounting nuts to the specified torque.

Tightening torque: 2.5 ± 0.5 N·m

CAUTION

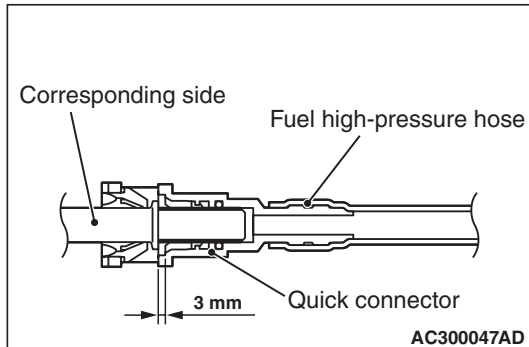

After connecting the fuel high-pressure hose, slightly pull it to ensure that it is installed securely. Also confirm that there is a play approximately 3 mm.

- Connect the fuel tank pump assembly connector, fuel high-pressure hose and fuel tank hose.
- Tighten the service hole cover mounting screws and install the service hole cover.
- Install the rear seat cushion. (Refer to GROUP 52A - Rear Seat P.52A-30).

FUEL TANK GAUGE UNIT REPLACEMENT

M1135001400309

- Remove the rear seat cushion (Refer to GROUP 52A - Rear Seat P.52A-30).

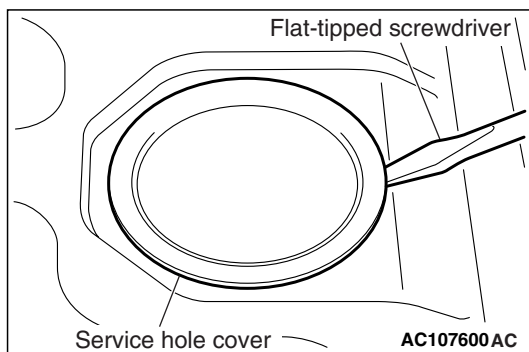

- Pry off the service hole cover using a flat-tipped screwdriver, etc.

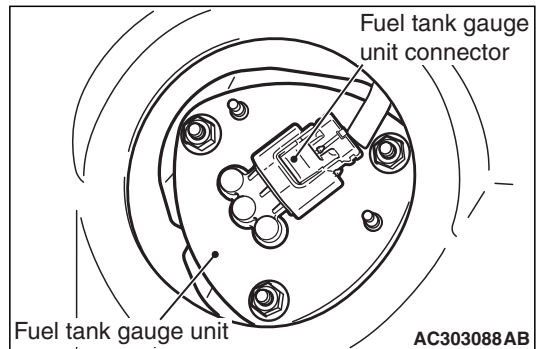

- Disconnect the fuel tank gauge unit connector.

CAUTION

Pay attention not to damage the gauge unit and the float of the fuel tank gauge unit when withdrawing it from the service hole.

- Remove the fuel tank gauge unit mounting nuts and remove the fuel tank gauge unit from service hole.

CAUTION

Pay attention not to damage the gauge unit and the float of the fuel tank gauge unit when inserting it from the service hole.

- Install the fuel tank gauge unit to the fuel tank through the service hole, and tighten the mounting nuts to the specified torque.

Tightening torque: 2.5 ± 0.5 N·m

- Connect the fuel tank gauge unit connector.

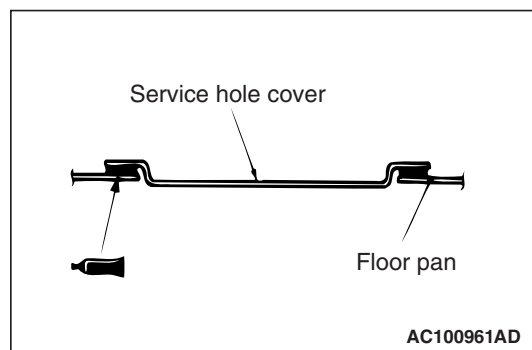

- Apply the specified sealant to the contact surfaces of the service hole cover and the floor pan, and install the service hole cover.

Specified sealant: 3M 8513 Grommets Windshield Sealer (Black)

- Install the rear seat cushion (Refer to GROUP 52A - Rear Seat P.52A-30).

FUEL LEAK CHECK OF FUEL TANK

M1135005900027

CAUTION

Always check the fuel leak of fuel tank with the vehicle loaded. If it is checked with the fuel tank removed, the fuel tank may be damaged.

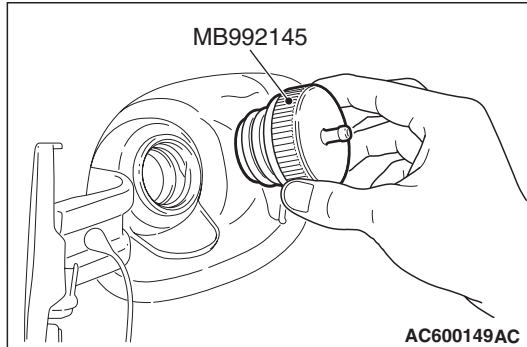

1. Remove the fuel tank cap, install the special tool fuel leak check cap (MB992145).

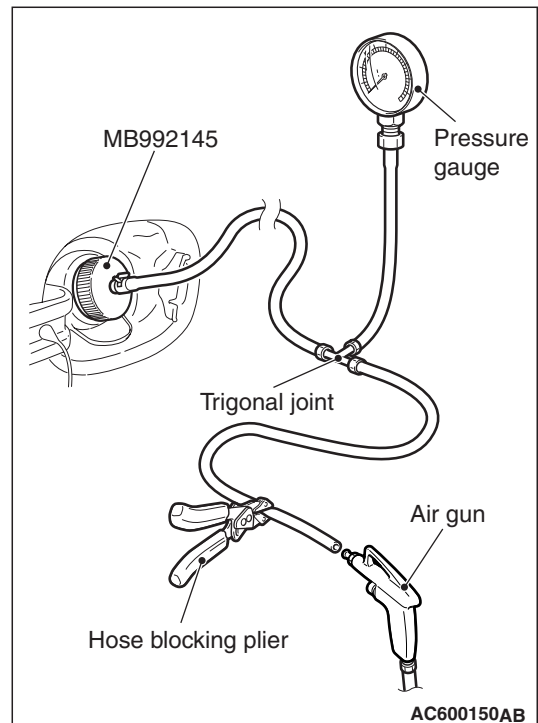

2. Install the hose and pressure gauge to the special tool (MB992145) as shown.
3. Block the canister vapour hose (fuel tank side).

CAUTION

- Do not pressurise suddenly.
 - Do not pressurise 11.76 kPa or more to prevent the damage of components.
4. Pressurize while checking the pressure gauge and hold if it reaches from 9.80 to 11.76 kPa.
 5. Leave it for approximately 3 minutes and check that the pressure is not weakened.
 6. If the pressure is weakened, apply soapy water to each part with pressurised state and check the leak while confirming if air bubbles are seen.

Fuel tank assembly removal steps (Continued)

13. Fuel tank gauge unit gasket
14. Fuel tank safety valve
15. Fuel tank safety valve gasket
16. Fuel tank hose
17. Fuel tank vapour hose 2-way valve
18. Fuel vapour pipe
19. Fuel filler hose
20. Fuel filler neck breather hose
21. Fuel tank

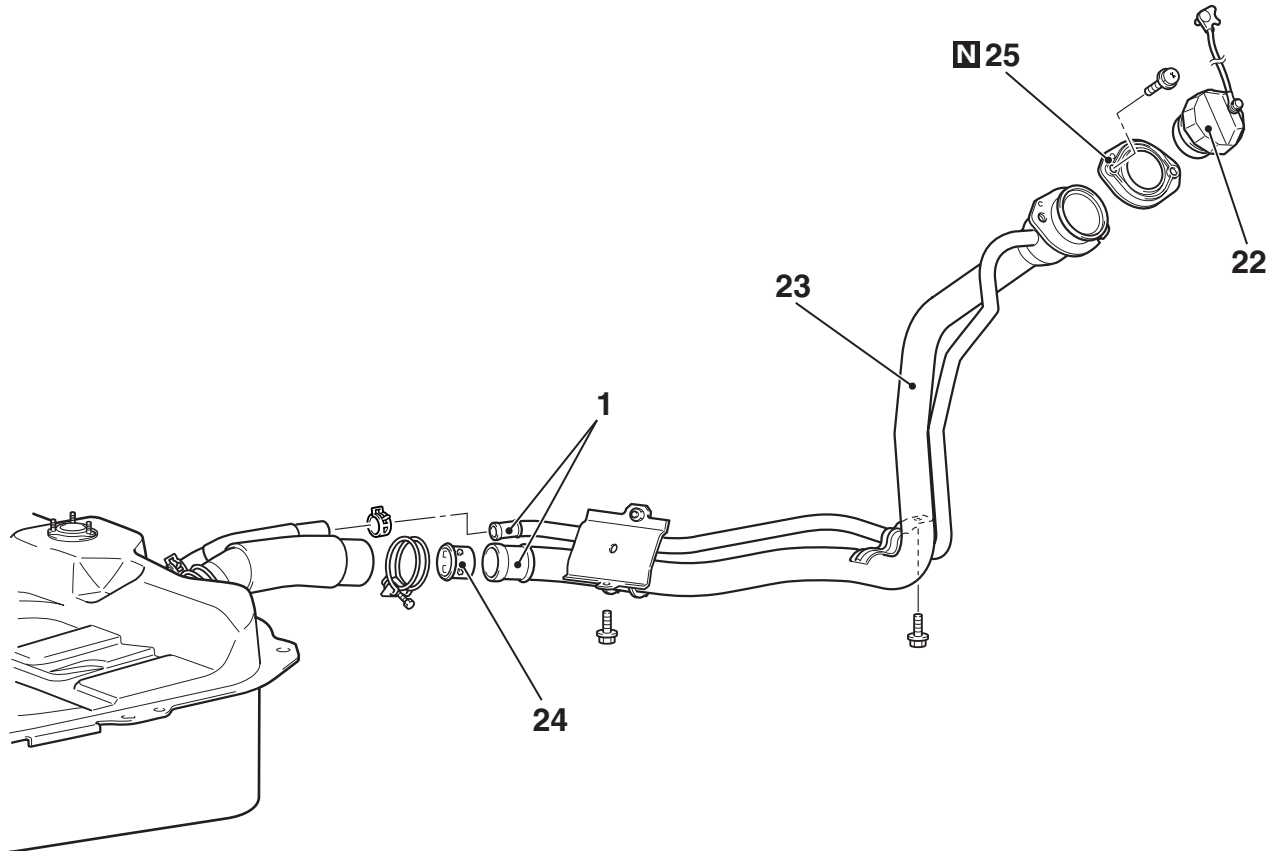

AC303093AB

Fuel filler neck removal steps

1. Fuel filler neck assembly connection
22. Fuel tank cap
23. Fuel filler neck assembly
24. Fuel filler neck valve
25. Fuel filler neck gasket

REMOVAL SERVICE POINTS**<<A>> FUEL TANK PUMP ASSEMBLY CONNECTOR/FUEL TANK GAUGE UNIT CONNECTOR REMOVAL**

Lower the fuel tank assembly the connectors can be disconnected.

<> FUEL TANK GAUGE UNIT REMOVAL**⚠ CAUTION**

When withdrawing the fuel tank gauge unit from the fuel tank, be careful not damage the module unit and the float.

INSTALLATION SERVICE POINTS**>>A<< FUEL TANK GAUGE UNIT INSTALLATION****⚠ CAUTION**

When inserting the fuel tank gauge unit to the fuel tank, be careful not damage the module unit and the float.

>>B<< FUEL HIGH-PRESSURE
HOSE/FUEL LINE PIPE CONNECTION
INSTALLATION

CAUTION

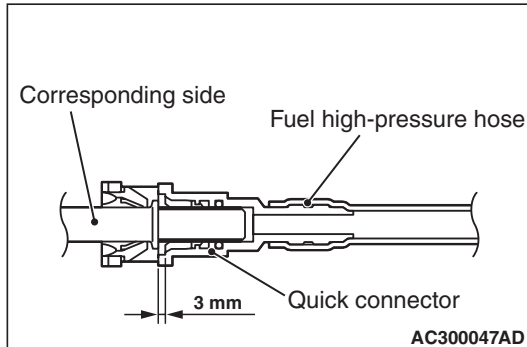

After connecting the fuel high-pressure hose, slightly pull it to ensure that it is installed securely. Also confirm that there is a play approximately 3 mm.

DISASSEMBLY AND REASSEMBLY

M1135004600335

FUEL TANK PUMP ASSEMBLY

NOTE: For the removal and installation procedures, refer to the fuel tank pump assembly replacement procedure in On-vehicle Service. (Refer to P.13C-2).

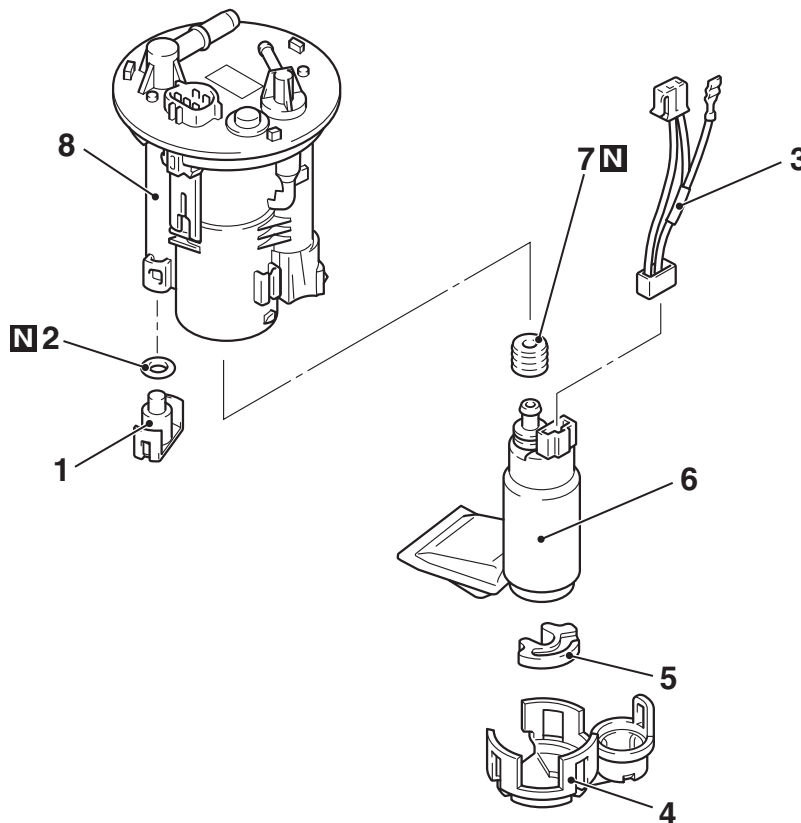

AC303094 AB

Disassembly steps

- >>A<<
1. Fuel pump cap
 2. Fuel tank O-ring
 3. Fuel pump harness
 4. Fuel pump bracket
 5. Fuel tank pump cushion
 6. Fuel tank pump
 7. Fuel tank grommet
 8. Fuel tank filter assembly

REASSEMBLY SERVICE POINT

>>A<< FUEL TANK GROMMET/FUEL
TANK O-RING INSTALLATION

Apply gasoline on the grommet and the O-ring before mounting them to prevent damage or twisting.

NOTES