GROUP 15

**INTAKE AND
EXHAUST**

CONTENTS

AIR DUCT AND AIR CLEANER	15-2	EXHAUST MANIFOLD	15-4
INTAKE MANIFOLD	15-3	EXHAUST PIPE AND MUFFLER	15-4

AIR DUCT AND AIR CLEANER

M2150004000656

A front air intake system that actively sucks cooling air from the front through the top of the radiator has been adopted in order to improve engine performance and reduce air intake noise.

CONSTRUCTION DIAGRAM

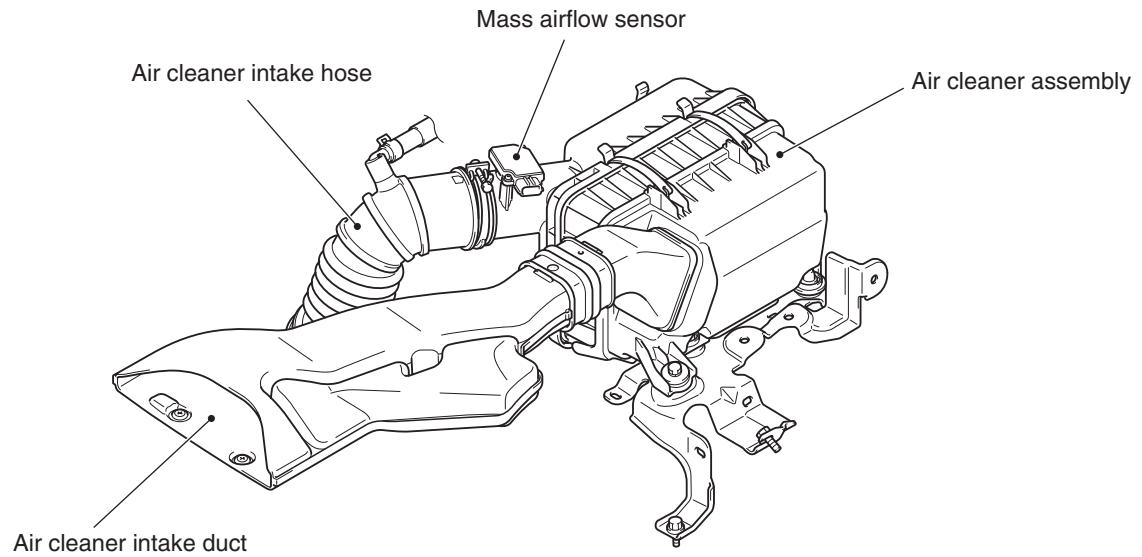

AC608342AB

INTAKE MANIFOLD

M2150005000239

The intake manifold is made of plastic for weight reduction, and the surface roughness of the inner walls of the ports has been improved to reduce intake resistance.

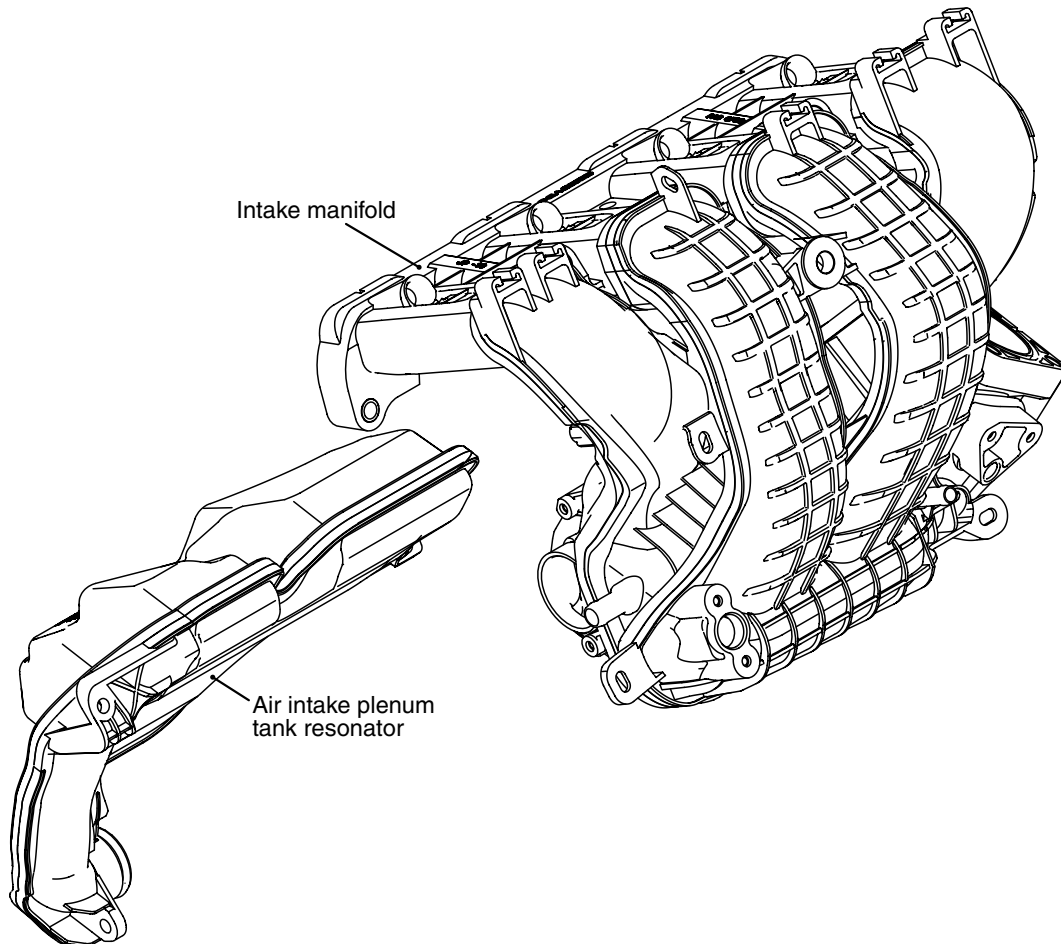

AK502555AD

EXHAUST MANIFOLD

M2150006000566

<California>

A clamshell type exhaust manifold is used.

<CALIFORNIA>

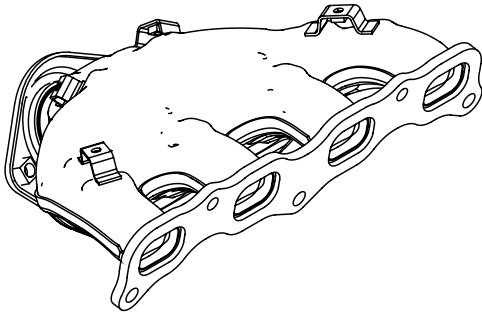

<Except California>

A SUS pipe type exhaust manifold is used.

<Except CALIFORNIA>

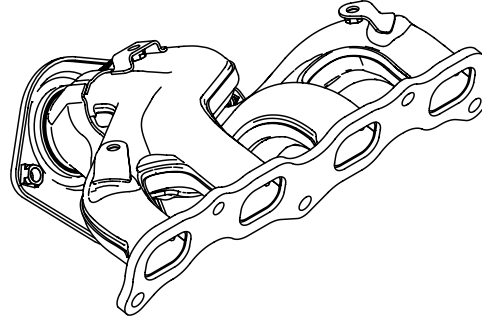

AK603623AB

EXHAUST PIPE AND MUFFLER

M2150003000783

The exhaust system is composed of the front exhaust pipe, center exhaust pipe, and main muffler, and it has the following characteristics.

- Fewer, more environmentally-friendly rubber hangers to reduce vibration from exhaust system.
- Straighter exhaust pipe to reduce noise.

CONSTRUCTION DIAGRAM

<Except for California>

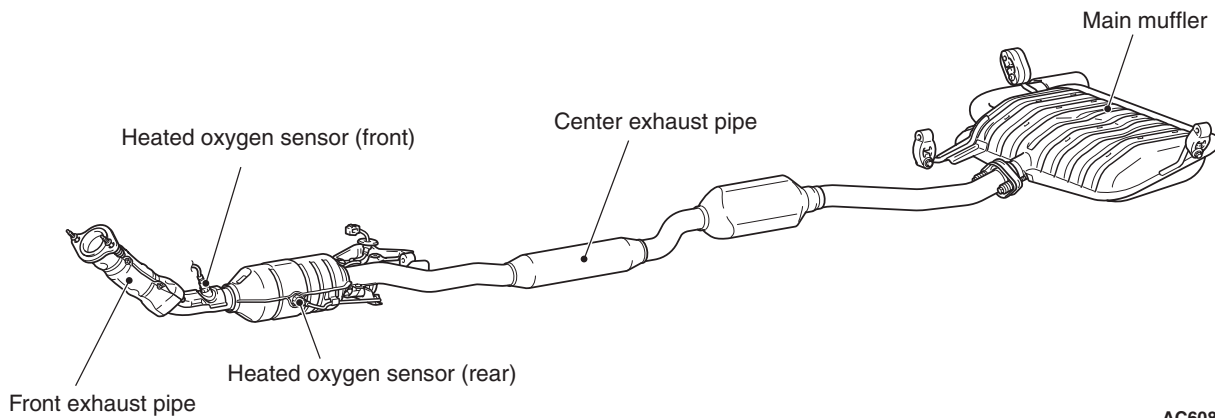

AC608352AB

<Vehicles for California>

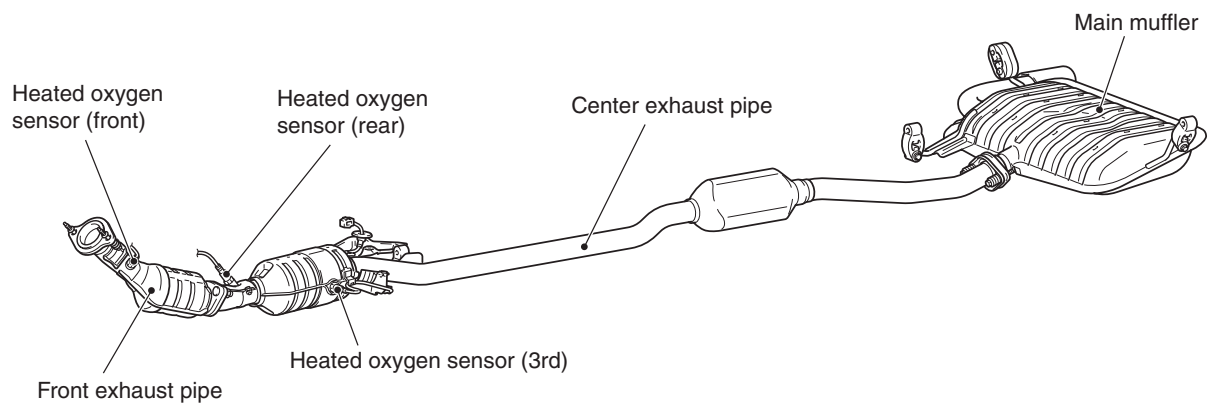

AC608488 AB