GROUP 22**MANUAL
TRANSAXLE****CONTENTS**

MANUAL TRANSAXLE	22-2	TRANSAXLE CONTROL	22-4
GENERAL INFORMATION	22-2	GENERAL INFORMATION	22-4
SECTIONAL VIEW	22-3		

MANUAL TRANSAXLE

GENERAL INFORMATION

F5MBB type has been adopted.

M2220000100729

SPECIFICATIONS

Item		Specification
Transmission model		F5MBB
Transmission type		5-speed forward, 1-speed reverse constant mesh
Gear ratio	1st	3.538
	2nd	1.913
	3rd	1.333
	4th	1.028
	5th	0.820
	Reverse	3.583
Final gear ratio		4.235

SECTIONAL VIEW

M2220000500136

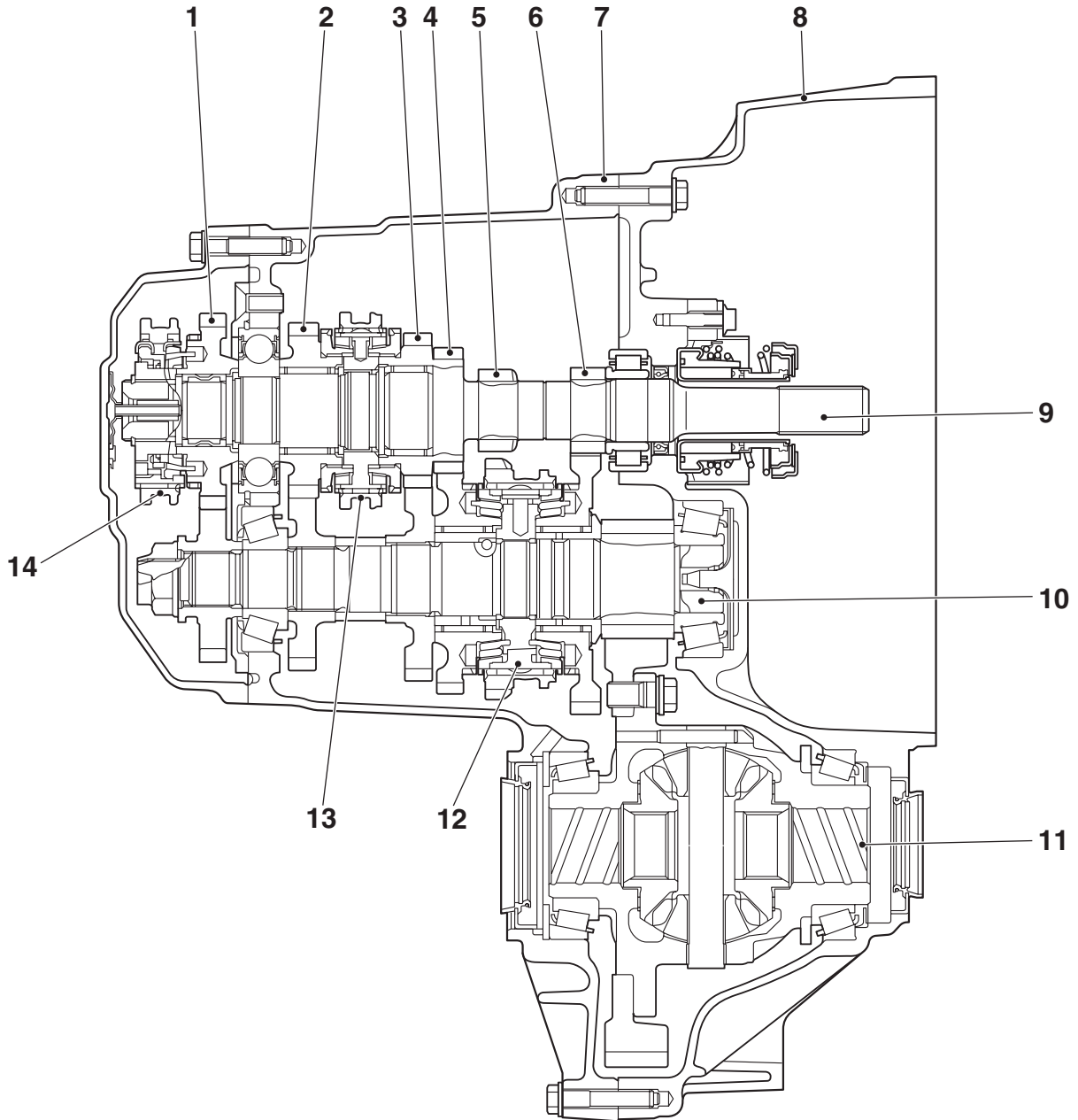

1. 5th speed gear
2. 4th speed gear
3. 3rd speed gear
4. 2nd speed gear
5. Reverse speed gear
6. 1st speed gear
7. Transaxle case

8. Clutch housing
9. Input shaft
10. Output shaft
11. Front differential
12. 1st -2nd speed synchronizer hub
13. 3rd -4th speed synchronizer hub
14. 5th speed synchronizer hub

AC611252AB

TRANSAXLE CONTROL

GENERAL INFORMATION

M2222000100286

For the transaxle control, a cable-type remote control gear shift has been adopted, and each section has the following features.

Shift lever assembly

- A spherical rotary shaft fulcrum type has been adopted to assure a non-rickety, smooth shift feeling.
- A resin base bracket has been adopted to reduce weight.

Shift cable

- A cable end that can be installed by one-touch has been adopted to the transaxle side and the shift lever side to improve assembling workability.
- For the transaxle side of the shift cable and the select cable, mounting sockets that have elastic solid inside have been adopted to minimize the binding touch or tight spots.

Shift knob

- A mass-filled shift knob has been adopted to minimize the binding touch or tight spots at the time of a shift.

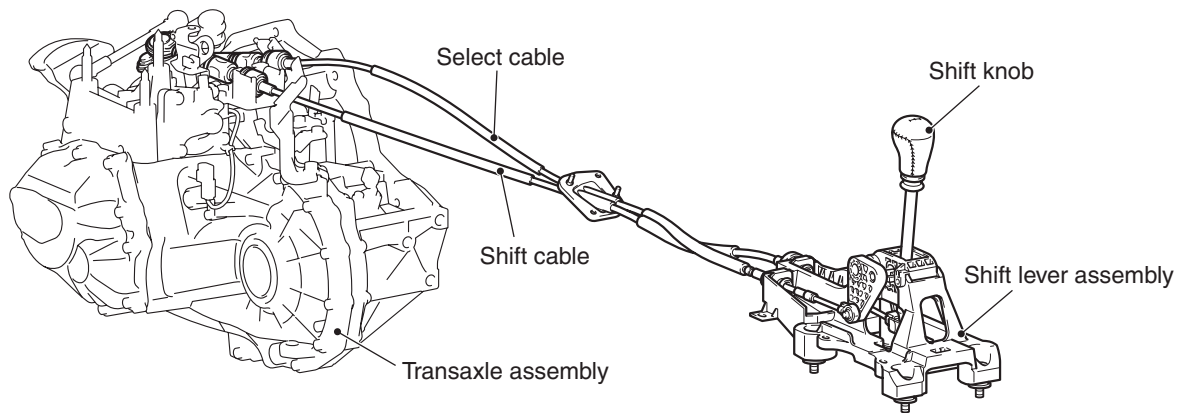

AC609226AB