

# STEERING COLUMN

1998 Mitsubishi Galant

1997-98 STEERING  
Steering Columns - AWD & FWD

Diamante, Eclipse, Galant, Mirage, 3000GT

## DESCRIPTION & OPERATION

**WARNING:** All models are equipped with a Supplemental Restraint System (SRS). Use caution when working around steering column. Ensure battery is disconnected before attempting any repair. DO NOT apply electrical power to any component on steering column without disabling air bag system (air bag could deploy).

**NOTE:** For information on air bag DIAGNOSIS & TESTING or DISPOSAL PROCEDURES, see AIR BAG RESTRAINT SYSTEM.

The steering system consists of solid steering shaft with a lower joint assembly. All models are equipped with a Supplemental Restraint System (SRS) that includes an air bag located in steering wheel and a clockspring located in the steering column. See Fig. 1.

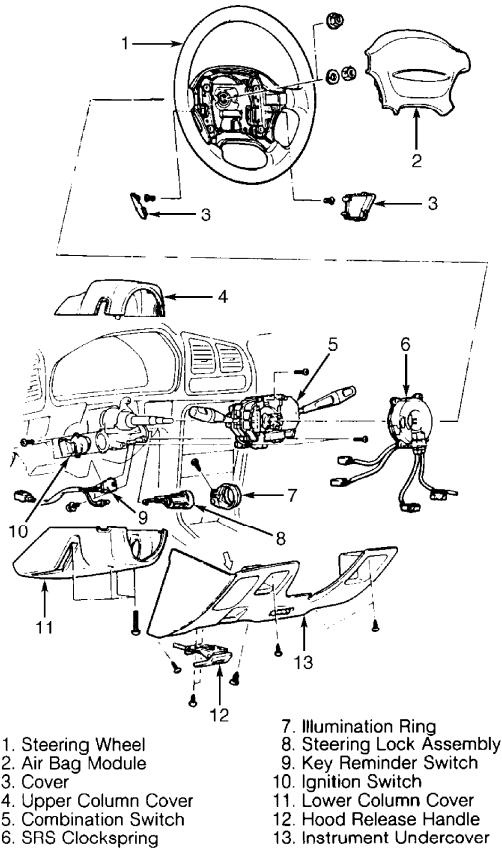

94J46523  
Fig. 1: Exploded View Of SRS Steering Column Components (Typical)  
Courtesy of Mitsubishi Motor Sales of America.

## DISABLING & ACTIVATING AIR BAG SYSTEM

**WARNING:** Wait at least 60 seconds after disconnecting negative battery cable before servicing SRS. System reserve capacitor maintains SRS voltage for about 60 seconds after battery is disconnected. Servicing SRS before 60-second period may cause accidental air bag deployment and possible personal injury.

To disable system, turn ignition switch to OFF position. Disconnect and isolate negative battery cable end. Wait at least 60 seconds. To activate system, reconnect negative battery cable.

## **AIR BAG SERVICE PRECAUTIONS**

The following precautions should be observed when working with SRS:

- \* Disable SRS before servicing any SRS or steering column component. Failure to do this may result in accidental air bag deployment and possible personal injury. See DISABLING & ACTIVATING AIR BAG SYSTEM.
- \* Wait at least 60 SECONDS after disabling air bag system. SRS system retains enough voltage, for a short time after system is disabled, to deploy air bag.
- \* After repairs, always turn ignition on to ensure SRS warning light is working properly and no system faults are indicated.
- \* Always wear safety glasses when servicing or handling an air bag.
- \* DO NOT expose air bag module and clockspring to temperatures more than 200°F (93°C).
- \* When placing a live air bag on a bench or other surface, always face air bag and trim cover up, away from surface. This will reduce motion of module if air bag accidentally deploys.
- \* After air bag deploys, air bag surface may contain deposits of sodium hydroxide, which irritate skin. Always wear safety glasses, rubber gloves and long-sleeved shirt during clean up. Wash hands using mild soap and water. Follow correct clean-up and disposal procedures.
- \* Because of critical system operating requirements, DO NOT service any SRS components. Repairs are only made by replacing defective part(s).
- \* DO NOT allow any electrical source near inflator on the back of air bag module.
- \* When carrying live air bag module, trim cover should be pointed away from body to minimize injury in case of accidental air bag deployment.
- \* If SRS is not fully functional for any reason, DO NOT drive

vehicle until system is repaired and is fully functional. DO NOT remove bulbs, modules, sensors or other components, or in any way disable system from operating normally. If SRS is not functional, park vehicle until repairs are made.

## **REMOVAL & INSTALLATION**

### **STEERING WHEEL & AIR BAG**

Removal

1) Before proceeding, follow air bag service precautions. See AIR BAG SERVICE PRECAUTIONS. Disable SRS. See

#### DISABLING & ACTIVATING AIR BAG SYSTEM.

2) Driver's air bag module is mounted on face of steering wheel. See Fig. 1. Ensure wheels are straight ahead and steering wheel is locked. Remove air bag module-to-steering wheel nuts from back side of steering wheel.

3) Lift air bag module. Disconnect electrical connector from air bag module by pressing air bag connector lock toward outside to spread it open. See Fig. 2. Pry upward gently to remove connector. DO NOT apply excessive force. Remove air bag module.

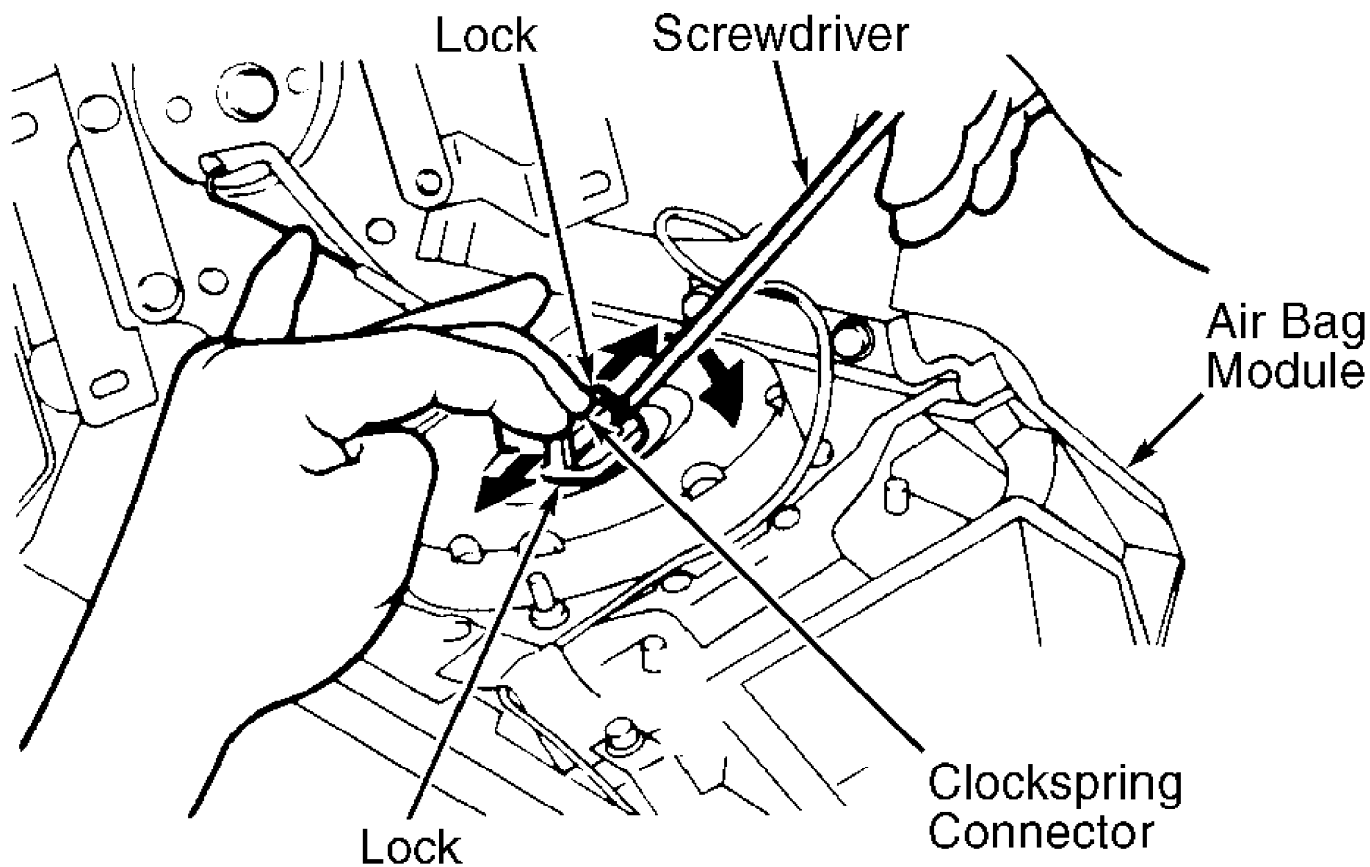

91D03726

Fig. 2: Disconnecting Clockspring Connector  
Courtesy of Mitsubishi Motor Sales of America.

**CAUTION:** DO NOT hammer on steering wheel during removal or installation, as it may damage steering column.

4) Place reference mark on steering wheel and steering column shaft for installation reference. Remove steering wheel nut and washer. Using steering wheel puller, remove steering wheel.

#### Installation

To install, reverse removal procedure. Ensure reference marks are aligned. Tighten steering wheel nut to specification. See TORQUE SPECIFICATIONS.

#### COMBINATION SWITCH

**CAUTION:** When installing steering wheel, if rotating part of clockspring is not properly centered with steering column

and front wheels, clockspring failure will result.

#### Removal & Installation

1) Remove steering wheel and air bag. See STEERING WHEEL & AIR BAG. Remove instrument panel undercover (if equipped). See Fig. 1. Remove steering column covers.

CAUTION: A double-lock connector locking mechanism is used on SRS Diagnosis Unit (SDU). DO NOT use excessive force when disconnecting connector, or damage to connector may occur.

2) Disconnect clockspring electrical connector. Remove screws attaching clockspring. Remove clockspring. Disconnect combination switch electrical connectors. Remove screws and combination switch. See Fig. 1. To install, reverse removal procedure.

## IGNITION SWITCH & STEERING LOCK CYLINDER

#### Removal

Remove steering wheel and combination switch. See STEERING WHEEL & AIR BAG and COMBINATION SWITCH. Disconnect ignition switch electrical connector. Using a hacksaw, cut bolts at steering lock bracket. Remove ignition switch, steering lock and bracket.

#### Installation

To install, reverse removal procedure. Use NEW steering lock bracket and bolts. Temporarily install ignition switch and steering lock cylinder onto steering column. Ensure ignition switch functions normally, then tighten steering lock cylinder bolts. Tighten lock bolts until heads twist off. To complete installation, reverse removal procedure.

## STEERING COLUMN

NOTE: Before removing, ensure wheels are in straight-ahead position and note steering wheel location for reassembly reference.

#### Removal

1) Remove steering wheel, horn pad and combination switch. See STEERING WHEEL & AIR BAG and COMBINATION SWITCH. Remove lower instrument panel covers and air ducts. Disconnect all electrical connectors to steering column.

2) Remove key interlock cable and slide lever (if equipped). Remove coupling bolt at steering gear. Remove cover bolts or retaining band. Remove steering column bracket bolts. Remove steering column assembly.

#### Installation

To install, reverse removal procedure. Ensure coupling is installed on steering gear so steering wheel will be centered.

## OVERHAUL

### STEERING COLUMN

#### Disassembly

Remove steering column. See STEERING COLUMN under REMOVAL & INSTALLATION. Remove joint assembly. See Fig. 3. Remove boot, cover and bearing. Remove snap ring, stopper and spacer. If removing steering lock, cut retaining screws with hacksaw. Remove steering lock and bracket.

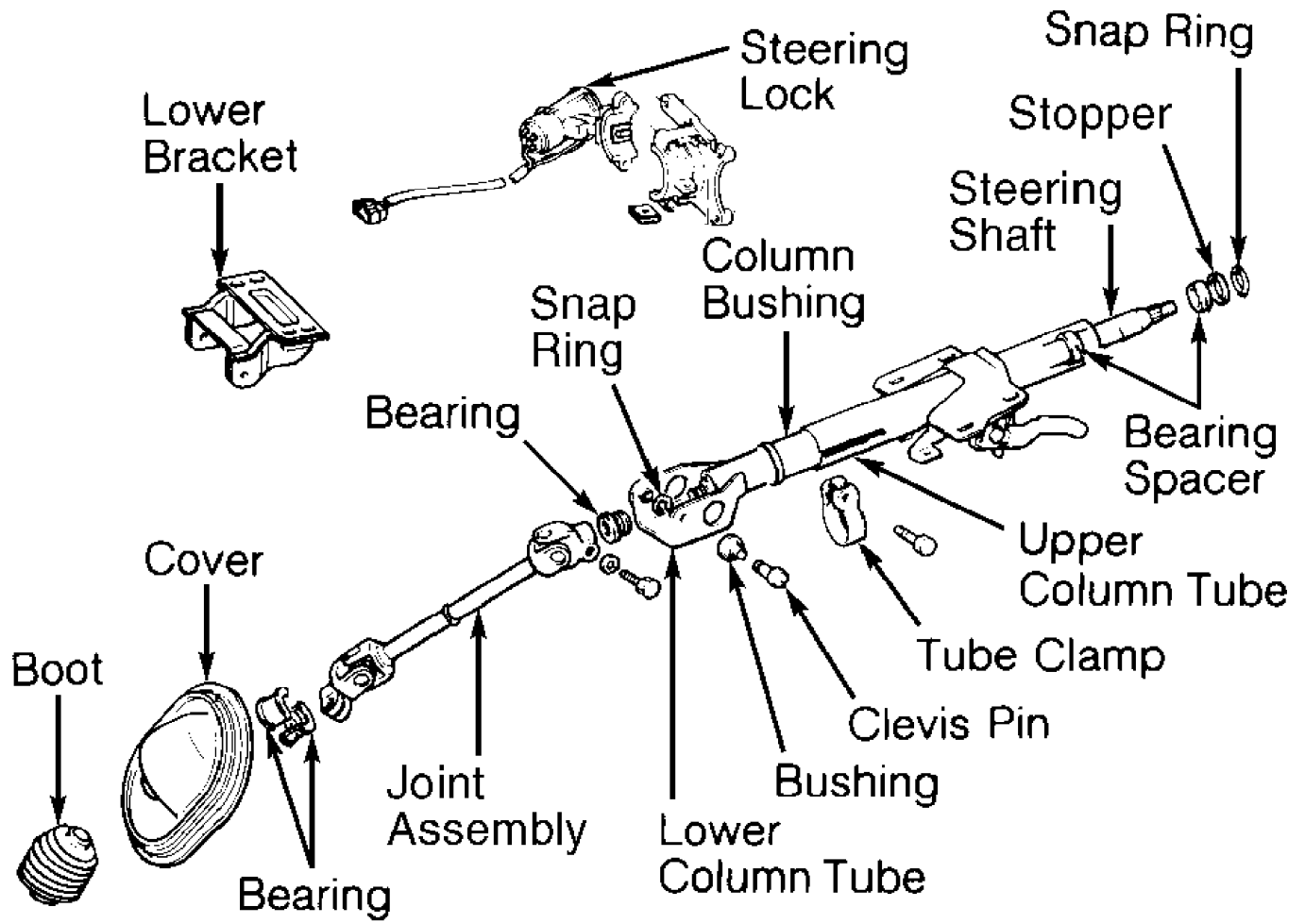

90F02469

Fig. 3: Exploded View Of Steering Column Assembly (Typical)  
 Courtesy of Mitsubishi Motor Sales of America.

CAUTION: If steering lock is removed, use NEW steering lock bracket and bolts when assembling steering lock.

Reassembly

1) To reassemble, reverse disassembly procedure. Align steering lock with column boss. Ensure steering lock is operational. Tighten steering lock bracket bolt until bolt head breaks off.

2) Apply multipurpose grease to bearing spacer and lower column tube-to-shaft contact areas. Install cover on joint assembly. Fill inside of bearing with multi-purpose grease. Install bearing on joint assembly. Wrap tape around circumference of bearing approximately 1 1/2 times. Press bearings into cover.

**TORQUE SPECIFICATIONS**

TORQUE SPECIFICATIONS

Application	Ft. Lbs. (N.m)
Joint Clamp Bolt .....	13 (18)
Steering Wheel Nut .....	30 (41)

INCH Lbs. (N.m)

Air Bag Module Nuts .....	48 (5)
Column Bracket Bolt .....	81 (12)
Dust Cover Bolt .....	43 (5)

---