

REAR SUSPENSION

CONTENTS

N17AA-

<2.6L ENGINE>

REAR SUSPENSION ASSEMBLY	3
SERVICE ADJUSTMENT PROCEDURES	3
Rear Wheel Alignment Inspection	3
SPECIFICATIONS	2
General Specifications	2
Service Specifications	2
Torque Specifications	2

<3.0L ENGINE>

COIL SPRING AND AXLE BUMPER	9
LOWER ARM	7
Lower Arm Rear Bushing Replacement	7

SERVICE ADJUSTMENT PROCEDURES	6
Rear Wheel Alignment Inspection	6
SHOCK ABSORBER AND LATERAL ROD ...	8
Lateral Rod Bushing Replacement	8
SPECIAL TOOLS	6
SPECIFICATIONS	5
General Specifications	5
Service Specifications	5
Torque Specifications	5
STABILIZER BAR	10

REAR SUSPENSION <2.6L ENGINE>**SPECIFICATIONS****GENERAL SPECIFICATIONS**

N17CA-0

Items	Specifications
Suspension system	Asymmetrical semielliptic leaf springs
Leaf springs	
Number of leaf springs	4
Straight span mm (in.)	1,196.5-1,203.5 (47.106-47.382)
Camber (unladen) mm (in.)	72.5-83.5 (2.854-3.287)
Spring constant N/mm (lbs./in.)	
- as installed	
at load of 1,000-2,500 N (220-551 lbs.)	24 (134)
at load of 5,500-8,500 N (1,213-1,874 lbs.)	56 (314)
Shock absorbers	
Type	Hydraulic cylinder, double-acting type
Max. length mm (in.)	548 (21.6)
Min. length mm (in.)	328 (12.9)
Stroke mm (in.)	220 (8.7)
Damping force [at 0.3 m/sec. (0.984 ft./sec.)]	
Expansion N (lbs.)	1,580-2,100 (348-463)
Compression N (lbs.)	580-860 (128-190)

SERVICE SPECIFICATIONS

N17CB-0

Items	Specifications
Standard value	
Toe-in mm (in.)	0 (0) [Non adjustable]
Camber	0° [Non adjustable]

TORQUE SPECIFICATIONS

N17CC-0

Items	Nm	ft.lbs.
Shackle assembly mounting nut	45-60	33-43
Front pin assembly mounting nut	45-60	33-43
Shock absorber mounting nut	18-25	13-18
Front pin assembly mounting bolt	14-20	10-14
U-bolt mounting nut	85-110	61-80

SERVICE ADJUSTMENT PROCEDURES

N17FAABa

REAR WHEEL ALIGNMENT INSPECTION

The rear suspension assembly must be free of worn, loose or damaged parts prior to measurement of rear wheel alignment.

**Standard value : Toe-in 0 mm (0 in.)
Camber 0°**

NOTE

Toe-in and camber are set at the factory and cannot be adjusted.

REAR SUSPENSION ASSEMBLY

REMOVAL AND INSTALLATION

N17GA-

Post-installation Operation

- Inspection of Rear Wheel Alignment.

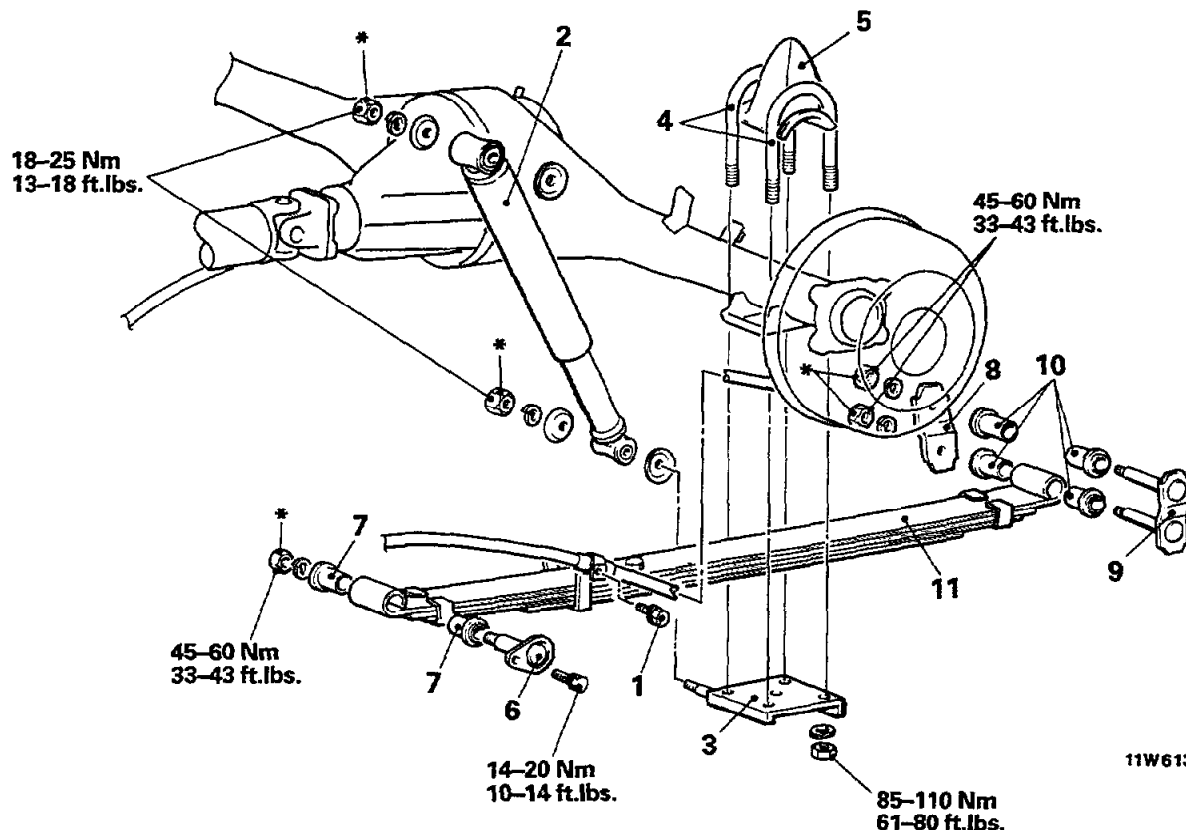

Removal steps

- | | |
|---------------------------------------|------------------------|
| 1. Parking brake cable attaching bolt | |
| 2. Shock absorber | |
| ◆◆ 3. U-bolt seat | ◆◆ 9. Shackle assembly |
| ◆◆ 4. U-bolts | 10. Rubber bushings |
| 5. Bump stopper | ◆◆ 11. Rear spring |
| ◆◆ 6. Front pin assembly | |
| 7. Rubber bushings | |
| 8. Shackle plate | |

NOTE
 (1) Reverse the removal procedures to reinstall.
 (2) ◆◆ : Refer to "Service Points of Installation".
 (3) * : Tighten when the vehicle is unloaded.

17-4 REAR SUSPENSION <2.6L ENGINE> - Rear Suspension Assembly

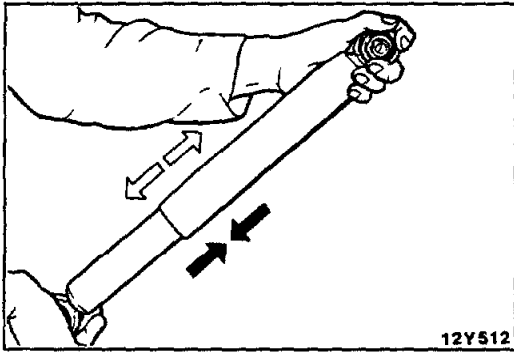

INSPECTION

N17GCAI

- Check the leaf springs for damage or deterioration.
- Check the U-bolt for cracks or bends.
- Check the rubber parts for cracks or deterioration.

SHOCK ABSORBER CHECK

Expand and contract the shock absorber to check it for damage, oil leakage or abnormal noise.

SERVICE POINTS OF INSTALLATION

N17GDAE

11. INSTALLATION OF REAR SPRING

Install the spring assembly to vehicle. Make sure the front end (front pin side) to center bolt distance is shorter than the rear end to center bolt distance.

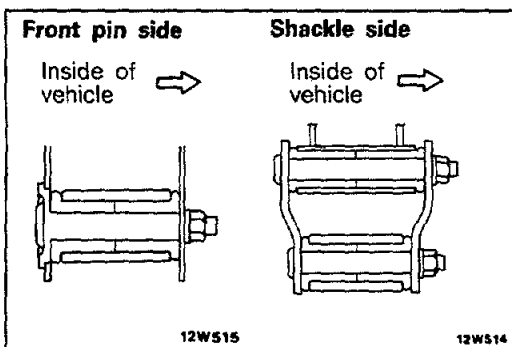
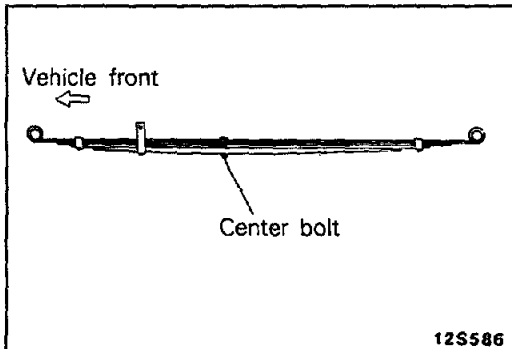

9. INSTALLATION OF SHACKLE ASSEMBLY/6. FRONT PIN ASSEMBLY

- (1) Install the front pin assembly from the outside toward the inside of vehicle.
- (2) Install the shackle assembly from the outside toward the inside of vehicle.

4. INSTALLATION OF U-BOLT/3. U-BOLT SEAT

Before the U-bolts are tightened to specified torque, confirm the relative position of the center bolt and axle housing and that of the center bolt and the hole in the U-bolt seat.

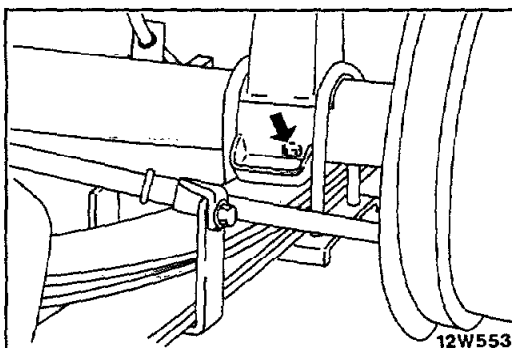

REAR SUSPENSION <3.0L ENGINE> SPECIFICATIONS

GENERAL SPECIFICATIONS

N17CA-1

Items	2-door vehicles	4-door vehicles
Suspension system	3-link, rigid	3-link, rigid
Coil spring Wire dia. x O.D. x free length mm (in.) Spring constant N/mm (lbs./in.) Coil spring identification color	14.0 x 174.0 x 433.3 (.55 x 6.73 x 17.06) 18 (101) Pink-1 Line	14.7 x 174.7 x 440.9 (.58 x 6.88 x 17.36) 22 (123) Green-1 Line
Shock absorbers Type Max. length mm (in.) Min. length mm (in.) Stroke mm (in.) Damping force [at 0.3 m/sec. (0.984 ft./sec.)] Expansion N (lbs.) Compression N (lbs.)	Hydraulic cylinder, double-acting type 501 (19.7) 313 (12.3) 188 (7.4) 1,550-2,050 (342-452) 480-720 (106-159)	Hydraulic cylinder, double-acting type 501 (19.7) 313 (12.3) 188 (7.4) 1,550-2,050 (342-452) 480-720 (106-159)

SERVICE SPECIFICATIONS

N17CB-1

Items	Specifications
Standard value Toe-in mm (in.) Camber Stabilizer bar mounting bolt attaching dimension mm (in)	0 (0) [Non adjustable] 0° [Non adjustable] 15-17 (.59-.67)

TORQUE SPECIFICATIONS

N17CC-1

Items	Nm	ft.lbs.
Lower arm to body	130-150	94-108
Lower arm to rear axle housing	190-220	137-159
Shock absorber to body	40-50	29-36
Shock absorber to rear axle housing	110-130	80-94
Lateral rod mounting nut	110-130	80-94
Axle bumper to body	8-12	6-9
Stabilizer bar to rear axle housing	30-40	22-29

SPECIAL TOOLS

N17DA-

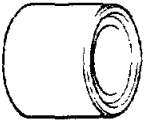
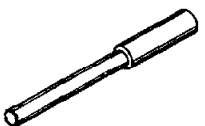
Tool	Number	Name	Use
	MB991293	Rear suspension bushing arbor	Removal and installation of lower arm rear bushing
	MB990891	Bushing remover/installer base	
	MB990650	Lower arm bushing arbor	Removal and installation of lateral rod bushing

SERVICE ADJUSTMENT PROCEDURES

N17FAAF

REAR WHEEL ALIGNMENT INSPECTION

Refer to P.17-3.

**LOWER ARM
REMOVAL AND INSTALLATION**

N17HA-

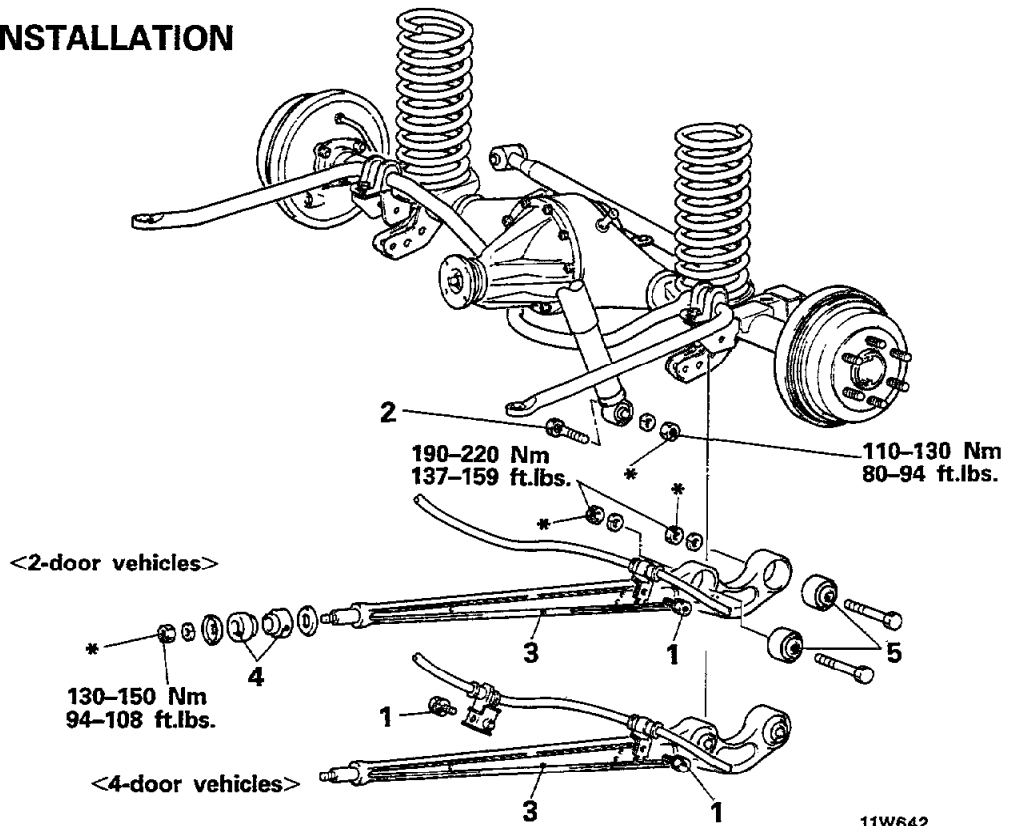

Removal steps

1. Parking brake cable attaching bolt
2. Shock absorber mounting bolts (Lower side)
3. Lower arm
4. Lower arm front bushing
5. Lower arm rear bushing

NOTE

- (1) Reverse the removal procedures to reinstall.
- (2) * : Tighten when the vehicle is unloaded.

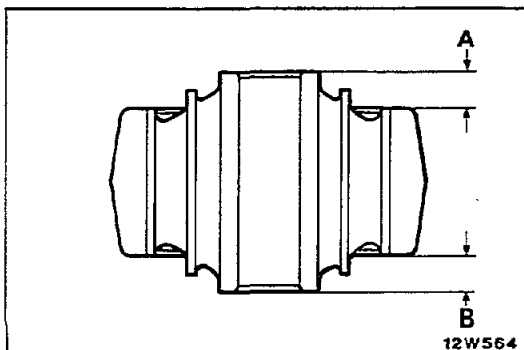
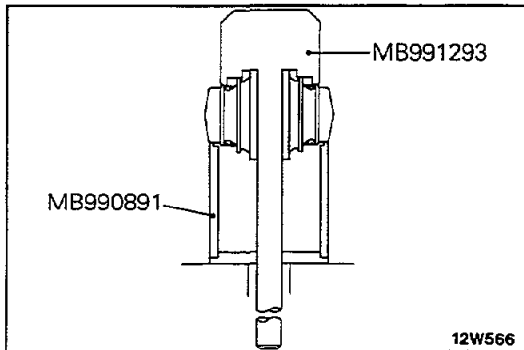

INSPECTION

N17HBAB

- (1) Check the lower arm for damage or crack.
- (2) Check the bushing for cracking, deterioration or unusual wear.

LOWER ARM REAR BUSHING REPLACEMENT

N17HCAB

- (1) Replace the bushing by using the special tools and a press.

- (2) When pressing the bushing in, be sure that the difference between the projecting lengths (A - B) does not exceed the following value.

$$A - B = 0 \pm 1.0 \text{ mm } (0 \pm .04 \text{ in.})$$

SHOCK ABSORBER AND LATERAL ROD

REMOVAL AND INSTALLATION

N170A-

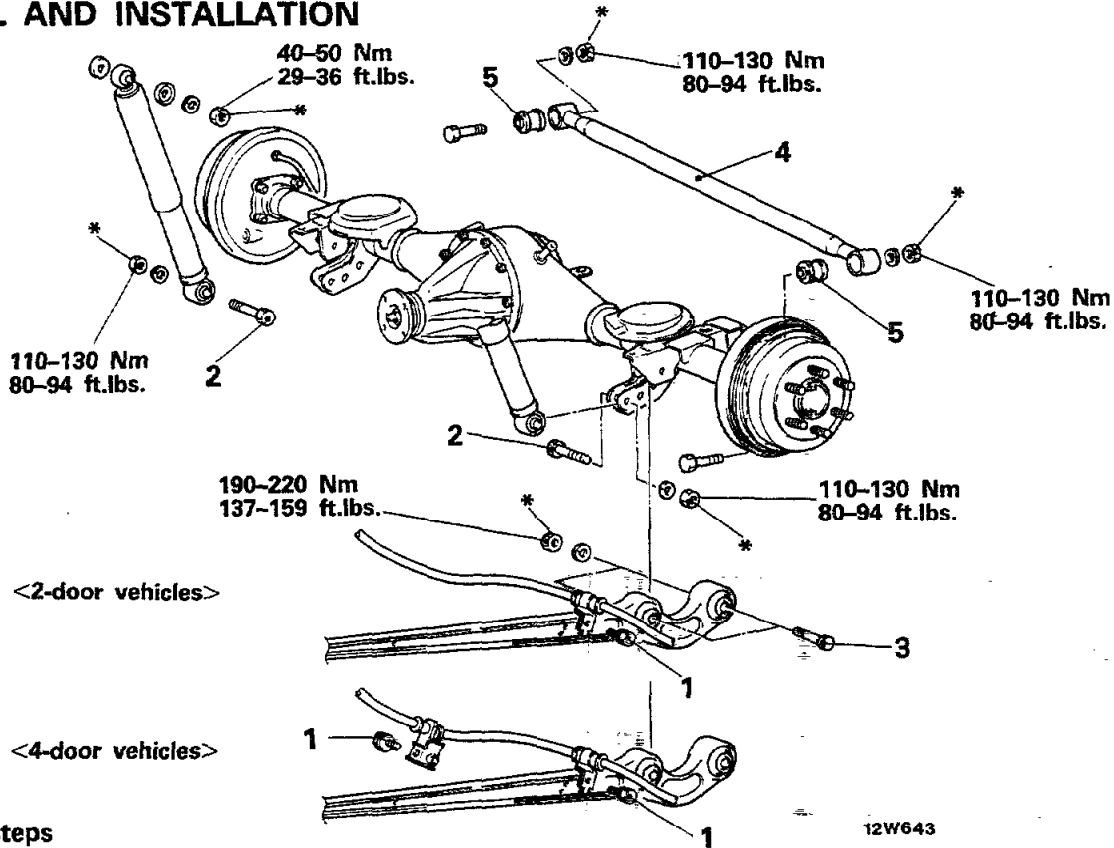

Removal steps

1. Parking brake cable attaching bolt
2. Shock absorber mounting bolt
3. Lower arm mounting bolt (left side only)
4. Lateral rod
5. Lateral rod bushing

NOTE

- (1) Reverse the removal procedures to reinstall.
- (2) * : Tighten when the vehicle is unloaded.

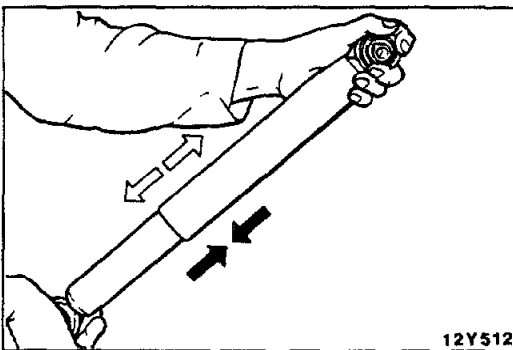

12Y512

INSPECTION

N170CAC

- (1) Check the lateral rod for deformation or damage.
- (2) Check the rubber parts for cracks or deterioration.

SHOCK ABSORBER CHECK

Expand and contract the shock absorber to check it for damage, oil leakage or abnormal noise.

LATERAL ROD BUSHING REPLACEMENT

N170EAD

- (1) Use the special tool to drive out and press in the lateral rod bushing.
- (2) Be careful that the difference (A - B) in bushing projection distances does not exceed the following value.

$$A - B = 0 \pm 1.0 \text{ mm} (0 \pm .04 \text{ in.})$$

Caution

When pressing in the bushing, apply a sufficient amount of soapsuds to the inside of the lateral rod eyes and the rubber area of the bushing.

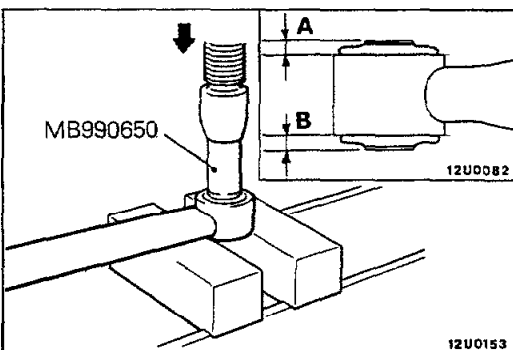

COIL SPRING AND AXLE BUMPER REMOVAL AND INSTALLATION

N17QA--

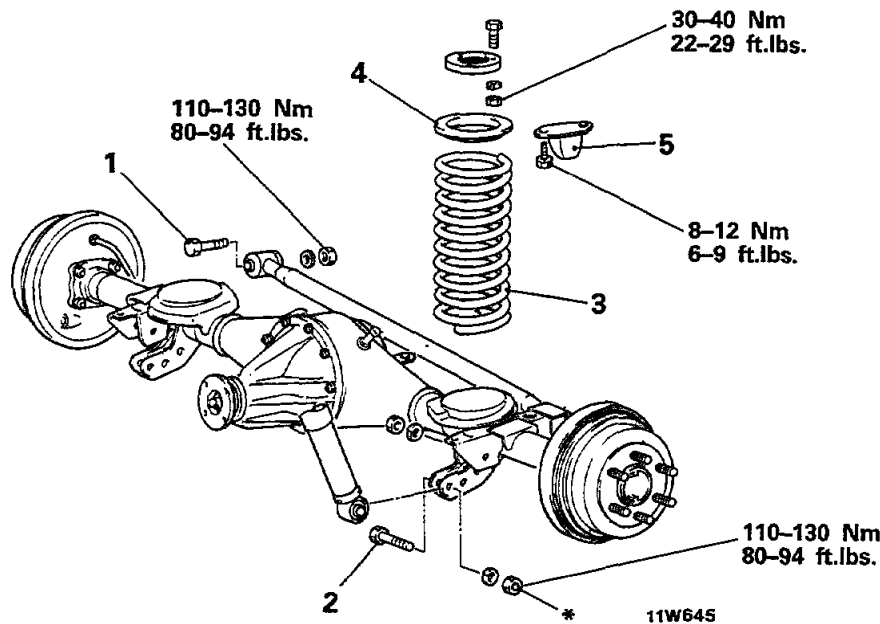

Removal steps

1. Lateral rod mounting bolt (body side only)
2. Shock absorber mounting bolt
3. Coil spring
4. Spring seat
5. Axle bumper

NOTE

- (1) Reverse the removal procedures to reinstall.
- (2) ◀▶ : Refer to "Service Points of Removal".
- (3) ▶◀ : Refer to "Service Points of Installation".
- (4) * : Tighten when the vehicle is unloaded.

SERVICE POINT OF REMOVAL

N17QBAA

3. REMOVAL OF COIL SPRING

Slowly lower the jack and remove the coil spring and spring seat.

Caution

When lowering the jack, take care not to damage the rear brake tube between the main brake tube and the rear axle housing.

INSPECTION

N17QCAA

- (1) Check the coil springs for crack, damage or deterioration.
- (2) Check the rubber parts for damage.

SERVICE POINTS OF INSTALLATION

N17QDAA

3. INSTALLATION OF COIL SPRING

When replacing the coil spring, select the correct coil spring for the vehicle according to its identification color.

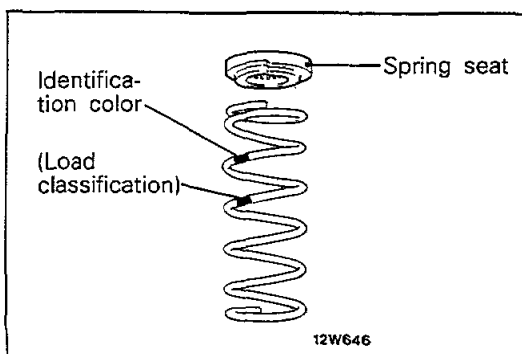

STABILIZER BAR

REMOVAL AND INSTALLATION

N171A-

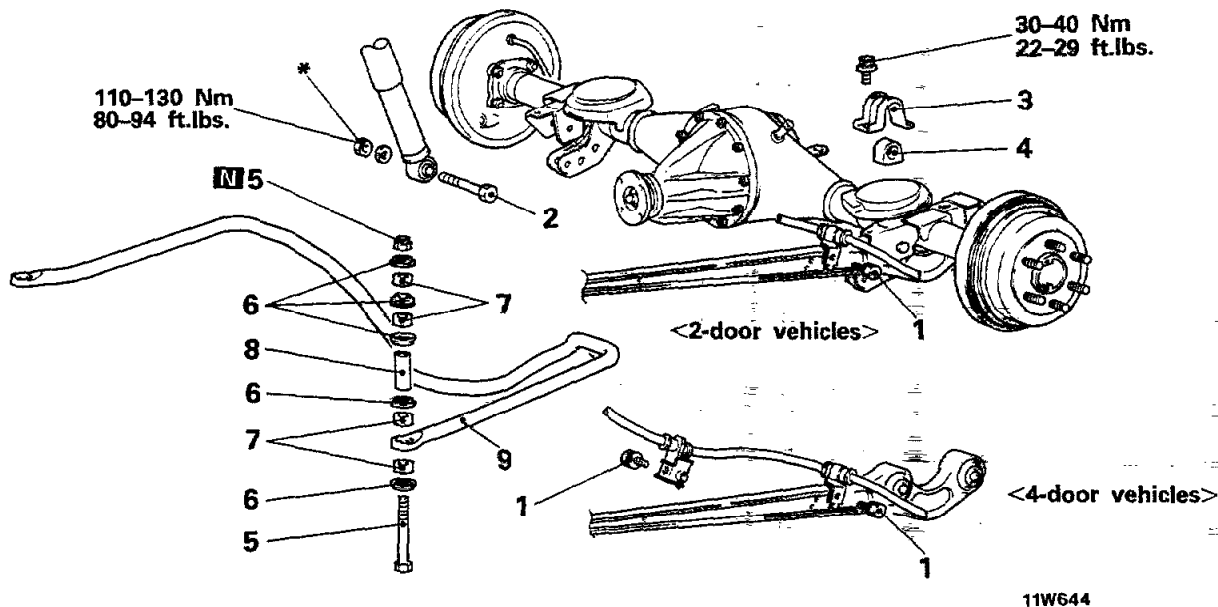

11W644

Removal steps

1. Parking brake cable attaching bolt
2. Shock absorber mounting bolts (Lower side)
3. Bracket C
4. Bushing B
- ◆◆ 5. Stabilizer bar mounting bolt and nut
6. Joint cup

7. Rubber bushing
8. Collar
- ◆◆ 9. Stabilizer

NOTE

- (1) Reverse the removal procedures to reinstall.
- (2) ◆◆ : Refer to "Service Points of Removal".
- (3) ◆◆ : Refer to "Service Points of Installation".
- (4) * : Tighten when the vehicle is unloaded.
- (5) N : Non-reusable parts

SERVICE POINTS OF REMOVAL

N171DAA

9. REMOVAL OF STABILIZER BAR

Slowly lower the jack and remove the stabilizer bar to the vehicle right side.

Caution

When lowering the jack, take care not to damage the rear brake tube between the main brake tube and the rear axle housing.

INSPECTION

N171BAB

- Check the stabilizer bar for bend and deformation.
- Check the rubber parts for cracks or deterioration.

SERVICE POINTS OF INSTALLATION

N171CAB

5. STABILIZER BAR MOUNTING BOLT AND NUT

- (1) To install the stabilizer bar, assemble the joint cups and rubber bushings by the order and the certain direction as shown in the figure.
- (2) Install the nut on the stabilizer bar mounting bolt to the specified dimensions.

Standard value : 15-17 mm (.59-.67 in.)

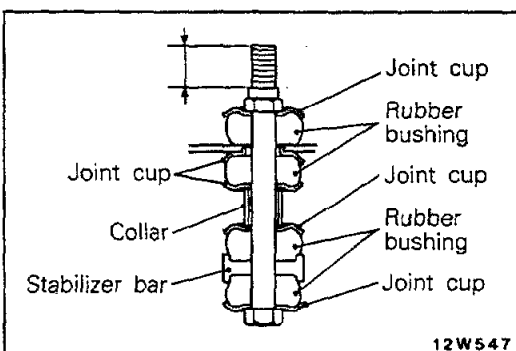

12W547