

STEERING COLUMN

1993 Mitsubishi Montero

1993 STEERING
Mitsubishi - Steering Columns

Montero

DESCRIPTION & OPERATION

Steering column consists of a collapsible steering shaft with lower joint assembly.

REMOVAL & INSTALLATION

STEERING WHEEL & HORN PAD

Removal

Remove screws retaining horn pad. Remove horn pad. Place reference mark on steering wheel and steering column shaft for installation reference. Remove steering wheel nut and washer. Using steering wheel puller, remove steering wheel.

CAUTION: DO NOT hammer on steering wheel during servicing, as it may damage steering column.

Installation

To install, reverse removal procedure. Ensure reference marks are aligned. Tighten steering wheel nut to specification. See TORQUE SPECIFICATIONS.

COMBINATION SWITCH

Removal & Installation

Remove horn pad and steering wheel. See STEERING WHEEL & HORN PAD under REMOVAL & INSTALLATION. Remove lower heater duct (if equipped). Remove upper and lower steering column covers. Disconnect combination switch electrical connectors. Remove screws and combination switch. To install, reverse removal procedure.

IGNITION SWITCH

Removal & Installation

1) Remove lower instrument cover and heater duct (if equipped). Remove upper and lower steering column covers. Disconnect harness connector from ignition switch. Insert ignition key into cylinder and turn key to ACC position.

2) Using small punch or awl, press down on locks pin located in cylinder lock housing. Remove ignition switch assembly. To install, reverse removal procedure.

STEERING COLUMN

CAUTION: Applying excessive pressure or causing impact to steering shaft during service may cause column to collapse. Before removing steering column, ensure wheels are in straight-ahead position. Note steering wheel location for installation reference.

Removal

1) Remove steering wheel and combination switch (if

necessary). See STEERING WHEEL & HORN PAD and COMBINATION SWITCH under REMOVAL & INSTALLATION.

2) Remove air ducts and lower instrument panel covers (if equipped). Disconnect all electrical connections. Disconnect brake pedal return spring (if equipped).

3) Remove bolts for dust cover at firewall. Remove bolt from clamp at steering gear. DO NOT separate lower steering shaft from steering column (if equipped). Remove steering column bolts and remove steering column.

Installation

To install, reverse removal procedure. Apply sealant to dust cover bolts before installing. Tighten bolts to specification. See TORQUE SPECIFICATIONS.

OVERHAUL

STEERING COLUMN

Disassembly

1) Remove steering column from vehicle. See STEERING COLUMN under REMOVAL & INSTALLATION. Remove clamp bolt from joint assembly. See Fig. 1. Remove return springs, clevis pin, bolts and bushings from upper steering column.

2) Remove snap ring, stopper and bearing spacer from upper steering column. Using ignition switch, unlock steering wheel. Remove upper steering shaft. Remove dust seal, bushing and upper steering column.

3) To remove steering lock, use a hacksaw to cut bolts at steering lock bracket side. Remove steering lock and bracket. Remove dust cover. Remove column tube clamp and lower steering column.

4) Remove column bushing, column tube and lower steering shaft. Remove snap ring from lower steering shaft. Remove clip and bearing from column tube. Remove split pin, tilt lever and snap ring. Remove lock plate. Remove lower boot, upper boot and dust cover from joint assembly.

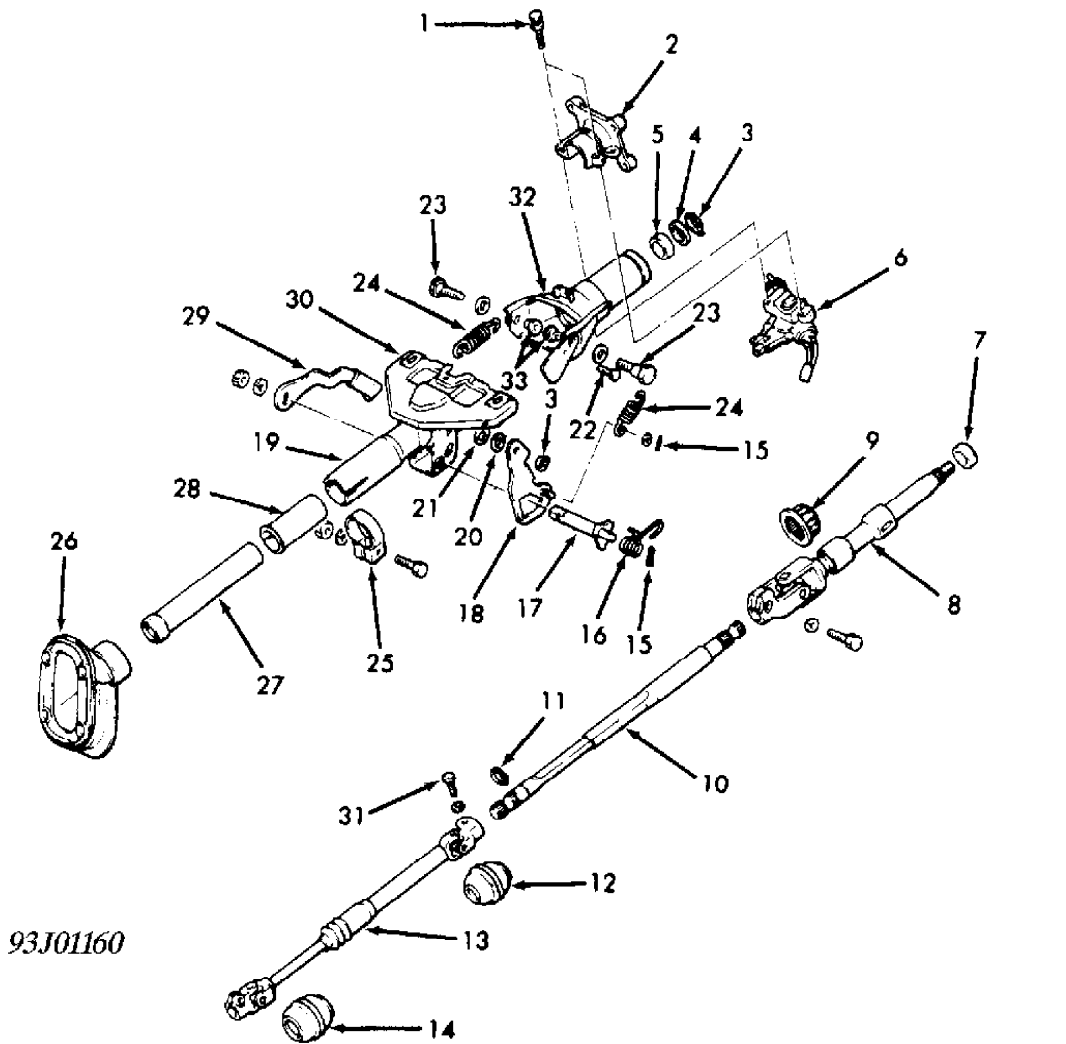

- | | | |
|---------------------------|---------------------------|-----------------------------|
| 1. Bolt | 12. Upper Boot | 23. Bolt |
| 2. Steering Lock Bracket | 13. Joint Assembly | 24. Return Spring |
| 3. Snap Ring | 14. Lower Boot | 25. Clamp |
| 4. Stopper | 15. Split Pin | 26. Dust Cover |
| 5. Bearing Spacer | 16. Return Spring | 27. Lower Pipe |
| 6. Steering Lock Cylinder | 17. Shaft | 28. Steering Column Bushing |
| 7. Bearing Spacer | 18. Lock Plate | 29. Tilt Lever |
| 8. Upper Steering Shaft | 19. Lower Steering Column | 30. Column Bracket |
| 9. Bearing | 20. Washer | 31. Clamp Bolt |
| 10. Lower Steering Shaft | 21. Wave Washer | 32. Upper Steering Column |
| 11. Snap Ring | 22. Clevis Pin | 33. Bushing |

Fig. 1: Exploded View Of Steering Column
 Courtesy of Mitsubishi Motor Sales of America.

Inspection
 Check for worn or damaged bushings, dust seals, bearings and

mounting plate. Check joint bearing and steering shaft for wear. Check cover and teeth of plate assembly for damage. Replace components if necessary.

Reassembly

1) To reassemble, reverse disassembly procedure. Install upper boot on joint assembly. Install lower boot and dust cover on joint assembly. Leave boots on shafts without assembling them to universal joint.

2) Apply multipurpose grease to universal joints of joint assembly. When installing upper boot, lower boot and dust cover, ensure arrows on boots align with slit area on yoke. When assembling lever assembly and plate assembly, apply grease to cam area of lever assembly, plate clevis pin, and space between clevis pin and return spring.

3) Apply grease to dust cover grommet, dust seal and upper steering shaft before installing. Align steering lock with column boss. Ensure steering lock is operational. Tighten bolt until bolt head breaks off.

4) When installing upper steering shaft in steering column, ensure projected area on dust seal aligns with notch of upper steering column. Apply grease to steering shaft bushings before installing.

5) Assemble upper steering column with lower steering column. Ensure mating mark on lower steering shaft aligns with yoke groove in upper steering shaft. See Fig. 2. Apply thread sealant to bolts and nuts of lower steering column.

6) Install NEW clevis pin until pin is even with lower steering column. Align mating mark on lower steering shaft with yoke groove of joint assembly. See Fig. 2.

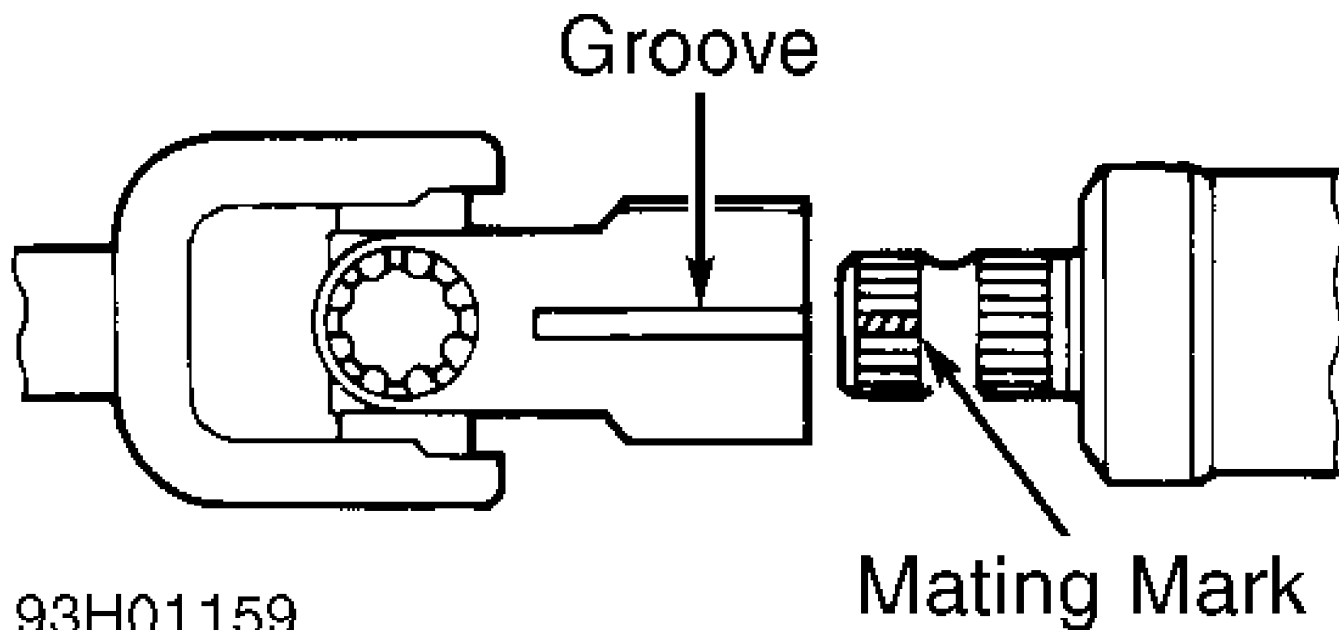

93H01159

Fig. 2: Aligning Mating Mark
Courtesy of Mitsubishi Motor Sales of America.

TORQUE SPECIFICATIONS

TORQUE SPECIFICATIONS TABLE

Application

Ft. Lbs. (N.m)

Column Bracket Bolts	16	(22)
Lower Steering Shaft Clamp Bolt	22-25	(30-34)
Steering Gear Clamp Bolt	22-25	(30-34)
Steering Wheel Nut	29	(40)
Upper Column Side Bolt	17	(23)
Upper Shaft Assembly Clamp Bolt	13	(18)

INCH Lbs. (N.m)

Dust Cover Bolt	36	(4)
Horn Pad Bolt	17-26	(2-3)
Steering Column Tube Clamp	39	(4.5)
Tilt Lever Bolt	108	(12)
