

---

# STEERING

# STEERING

## CONTENTS

37209000057

<b>GENERAL INFORMATION</b> .....	2	Drive Belt Tension Check .....	7
<b>SERVICE SPECIFICATIONS</b> .....	3	Fluid Level Check .....	7
<b>LUBRICANTS</b> .....	3	Fluid Replacement .....	8
<b>SPECIAL TOOLS</b> .....	3	Bleeding .....	8
<b>ON-VEHICLE SERVICE</b> .....	5	Oil Pump Pressure Test .....	10
Steering Wheel Free Play Check .....	5	Power Steering Oil Pressure Switch Check ....	11
Steering Angle Check .....	5	<b>STEERING WHEEL AND SHAFT*</b> .....	12
Tie Rod End Ball Joint Starting Torque Check .....	6	<b>POWER STEERING GEAR BOX*</b> .....	15
Stationary Steering Effort Check .....	6	<b>POWER STEERING OIL PUMP</b> .....	19
Checking Steering Wheel Return to Centre .....	7	<b>POWER STEERING HOSES</b> .....	20

### WARNINGS REGARDING SERVICING OF SUPPLEMENTAL RESTRAINT SYSTEM (SRS) EQUIPPED VEHICLES

#### WARNING!

- (1) Improper service or maintenance of any component of the SRS, or any SRS-related component, can lead to personal injury or death to service personnel (from inadvertent firing of the air bag) or to the driver and passenger (from rendering the SRS inoperative).
- (2) Service or maintenance of any SRS component or SRS-related component must be performed only at an authorized MITSUBISHI dealer.
- (3) MITSUBISHI dealer personnel must thoroughly review this manual, and especially its GROUP 52B – Supplemental Restraint System (SRS) before beginning any service or maintenance of any component of the SRS or any SRS-related component.

#### NOTE

The SRS includes the following components: SRS-ECU, SRS warning lamp, air bag module, clock spring and interconnecting wiring. Other SRS-related components (that may have to be removed/installed in connection with SRS service or maintenance) are indicated in the table of contents by an asterisk (\*).

**GENERAL INFORMATION**

37200010196

The steering wheel is a 3-spoke type for standard models and a 4-spoke type for vehicles with SRS. The steering column is equipped with both shock absorbing and a tilt steering mechanism. The power steering is an integral rack and pinion

type that combines the steering gear and linkage into one light-weight and compact assembly. The steering system uses a vane oil pump with a fluid flow control system, so that steering effort varies with engine speed.

Items		Specifications
Steering gear and linkage	Type	Integral type
	Gear type	Rack and pinion
Oil pump	Type	Vane type
	Displacement ml/rev.	5.9
	Relief set pressure MPa	9.8

**CONSTRUCTION DIAGRAM**

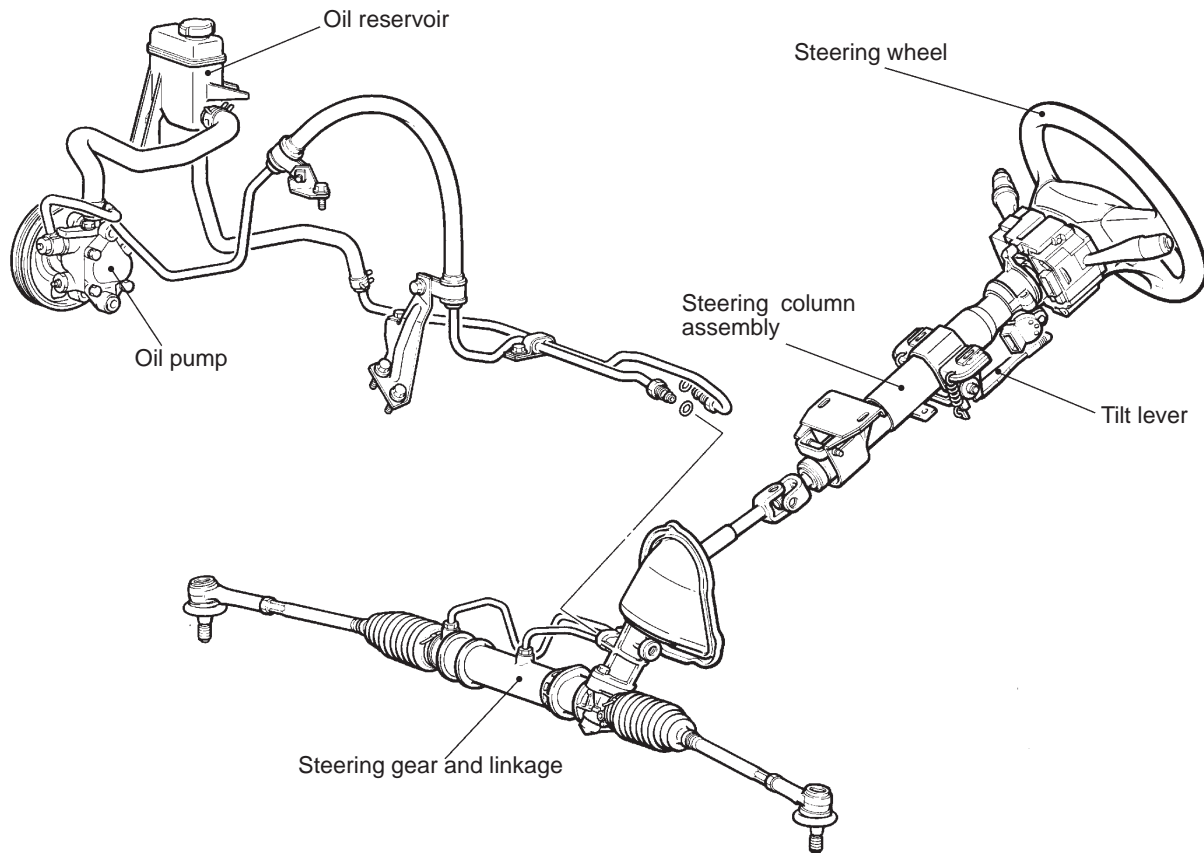

AV0128AJ

## SERVICE SPECIFICATIONS

37200030222

Items		Standard value	Limit
Steering wheel free play mm	with engine stopped	10 or less	–
	when hydraulic operation	–	30
Steering angle	Inner wheel	$39^{\circ}00' \pm 1^{\circ}30'$	–
	Outer wheel (Reference value)	$32^{\circ}00'$	–
Tie rod end ball joint starting torque Nm		9.8	–
Stationary steering effort N (Fluctuation allowance)		34 or less (5.9 or less)	–
Oil pump pressure MPa	Oil pump relief pressure	9.8	–
	Pressure under no-load conditions	0.3 – 0.8	–
	Steering gear retention hydraulic pressure	9.8	–
Oil pressure switch operating pressure MPa	OFF → ON	1.8 – 2.4	–
	ON → OFF	1.0 – 2.4	–
Total pinion preload Nm (Change in torque: 0.4 Nm)		0.6 – 1.3	–
Tie-rod joint swing resistance N (Tie-rod joint swing torque Nm)		6 – 20 (1.5 – 4.9)	–

## LUBRICANTS

37200040041

Items	Specified lubricant	Quantity
Power steering fluid	Automatic transmission fluid DEXRON or DEXRON II	As required
O-ring	Automatic transmission fluid DEXRON or DEXRON II	As required

## SPECIAL TOOLS

37200060207

Tool	Number	Name	Use
	MB990635, MB991113 or MB991406	Steering linkage puller	Disconnection of tie-rod end

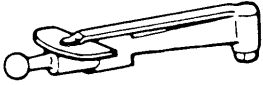
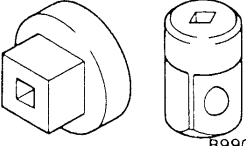
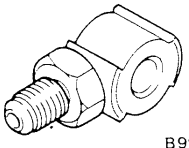
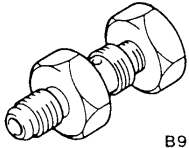
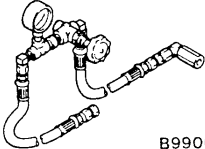
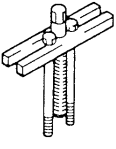
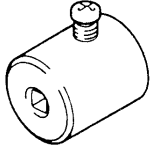
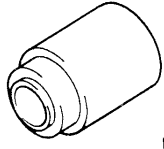
Tool	Number	Name	Use
	MB990685	Torque wrench	<ul style="list-style-type: none"> <li>• Measurement of the ball joint starting torque</li> <li>• Measurement of the pinion shaft preload</li> </ul>
	MB990326	Preload socket	Measurement of the ball joint starting torque
	MB990993 or MB991217	Power steering oil pressure gauge adapter (pump side)	Measurement of oil pressure
	MB990994	Power steering oil pressure gauge adapter (hose side)	
	MB990662	Oil pressure gauge assembly	
	MB990803	Steering wheel puller	Disconnection of the steering wheel
	MB991006	Preload socket	Measurement of the pinion shaft preload
	MB990776	Front axle base	Installation of dust cover for tie rod end ball joint

**ON-VEHICLE SERVICE**

37200100046

**STEERING WHEEL FREE PLAY CHECK**

1. With engine running (hydraulic operation), set front wheels straight ahead.
2. Measure the play on steering wheel circumference before wheels start to move when slightly moving steering wheel in both directions.

**Limit: 30 mm**

3. When play exceeds the limit, check for play on steering shaft connection and steering linkage. Correct or replace.
4. If the free play still exceeds the limit value, set steering wheel straight ahead with engine stopped. Load 5 N towards steering wheel circumference and check play.

**Standard value (steering wheel play with engine stopped): 10 mm or less**

If the play exceeds the standard value, remove steering gear box and check total pinion torque.

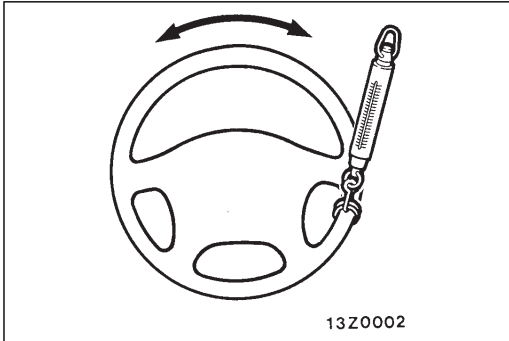
**STEERING ANGLE CHECK**

37200110056

1. Locate front wheels on turning radius gauge and measure steering angle.

**Standard value:****Inner wheel 39°00' ± 1°30'****Outer wheel 32°00' (Reference value)**

2. When the angle is not within the standard value, the toe is probably incorrect. Adjust toe (Refer to GROUP 33A – On-vehicle Service) and recheck steering angle.

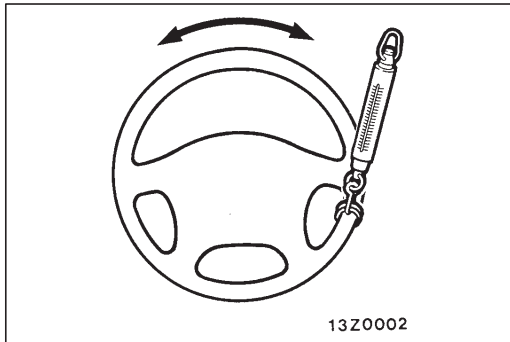
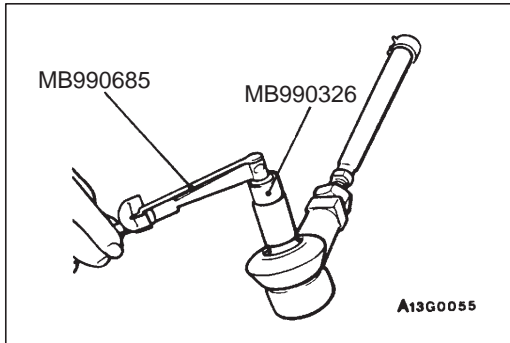
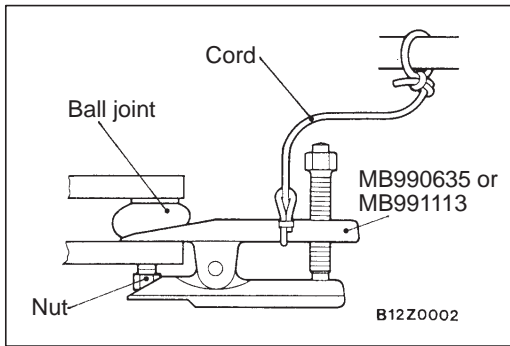

## TIE ROD END BALL JOINT STARTING TORQUE CHECK

37200150171

1. Disconnect tie rod and knuckle with special tool.

### Caution

1. Be sure to use the special tool to loosen the tie rod end mounting nut to prevent the ball joint thread from damaging. Only loosen the nut; do not remove it from the ball joint.
2. Support the special tool with a cord, etc. to prevent it from coming off.

2. Move ball joint stud several times and install nut on stud. Measure ball joint starting torque with special tools.

**Standard value: 9.8 Nm**

3. When the starting torque exceeds the standard value, replace tie rod end.
4. When the starting torque is under the standard value, check ball joint for end play or ratcheting. If none of these, the joint is still serviceable.

## STATIONARY STEERING EFFORT CHECK

37200170207

1. With the vehicle stopped on a flat, paved surface, turn the steering wheel to the straight ahead position.
2. Start the engine and set it to  $1,000 \pm 100$  r/min.

### Caution

**After checking the engine r/min must be a return to the standard idling r/min.**

3. Attach a spring balance to the outer circumference of the steering wheel and measure the steering force required to turn the steering wheel from the straight ahead position to the left and right (within a range of 1.5 turns). Also check to be sure that there is no significant fluctuation of the required steering force.

### Standard value:

**Steering effort: 34 N or less**

**Fluctuation allowance: 5.9 N or less**

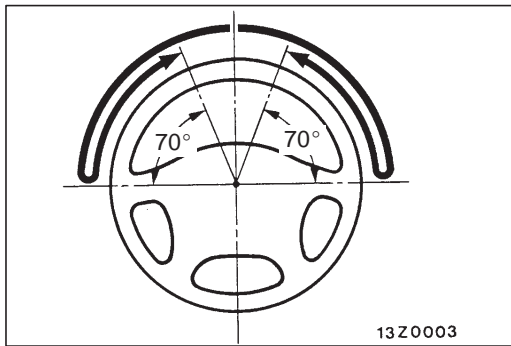

## CHECKING STEERING WHEEL RETURN TO CENTRE

37200180057

To make this test, conduct a road test and check as follows.

1. Make both gradual and sudden turns and check the steering “feeling” to be sure that there is not difference in the steering force required and the wheel return between left and right turns.
2. At a speed of 35 km/h, turn the steering wheel 90° and release the steering wheel after 1 or 2 seconds. If the steering wheel then returns 70° or more, the return can be judged to be satisfactory.

### NOTE

There will be a momentary feeling or “heaviness” when the wheel is turned quickly, but this is not abnormal. (This is because the oil pump discharge amount is especially apt to be insufficient during idling.)

## DRIVE BELT TENSION CHECK

37200190203

Refer to GROUP 11 – On-vehicle Service.

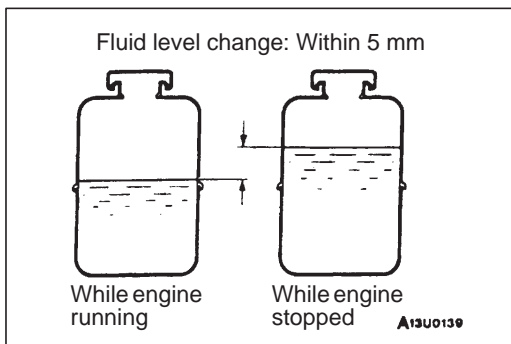

## FLUID LEVEL CHECK

37200200043

1. Park the vehicle on a flat, level surface, start the engine, and then turn the steering wheel several times to raise the temperature of the fluid to approximately 50 – 60°C.
2. With the engine running, turn the wheel all the way to the left and right several times.
3. Check the fluid in the oil reservoir for foaming or milkiness. Check the difference of the fluid level when the engine is stopped, and while it is running. If the change of the fluid level is 5 mm or more, air bleeding should be done.



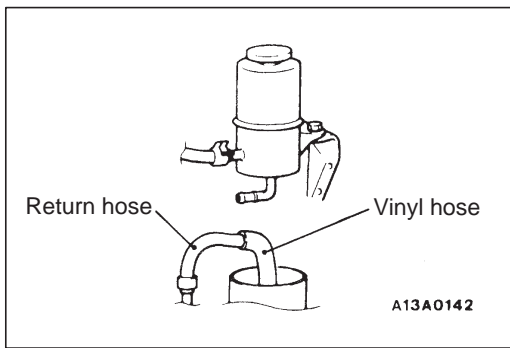

## FLUID REPLACEMENT

37200210145

1. Raise the front wheels on a jack, and then support them with rigid racks.
2. Disconnect the return hose connection.
3. Connect a vinyl hose to the return hose, and drain the oil into a container.
4. Disconnect the high-tension cable <1300> or the ignition coil connector <1800>.

### Caution

**Be careful not to position the high-tension cable near the delivery pipe. <1300>**

5. While operating the starting motor intermittently, turn the steering wheel all the way to the left and right several times to drain all of the fluid.
6. Connect the return hoses securely, and then secure it with the clip.
7. Fill the oil reservoir with the specified fluid up to the lower position of the filter, and then bleed the air.

### Specified fluid:

**Automatic transmission fluid  
DEXRON or DEXRON II**

## BLEEDING

37200220186

1. Jack up the front wheels and support them by using a rigid rack.
2. Disconnect the high-tension cable <1300> or the ignition coil connector <1800>.

### Caution

**Be careful not to position the high-tension cable near the delivery pipe.**

3. While operating the starting motor intermittently, turn the steering wheel all the way to the left and right five or six times (for 15 to 20 seconds).

**Caution**

- (1) The fluid level should be between MIN and MAX of the fluid level gauge during air bleeding. Carry out the air bleeding while checking the fluid level and adding the fluid.
- (2) If air bleeding is done while engine is running, the air will be broken up and absorbed into the fluid; be sure to do the bleeding only while cranking.

4. Connect the high-tension cable <1300> or the ignition coil connector <1800>. Then start the engine and let it run at idle.
5. Turn the steering wheel to the left and right until there are no air bubbles in the oil reservoir.
6. Confirm that the fluid is not milky, and that the level is up to the specified position on the level gauge.
7. Confirm that there is very little change in the fluid level when the steering wheel is turned left and right.

8. Check whether or not the change in the fluid level is within 5 mm when the engine is stopped and when it is running.
9. If the change of the fluid level is 5 mm or more, the air has not been completely bled from the system, and thus must be bled completely.

**Caution**

- (1) If the fluid level rises suddenly after the engine is stopped, the air has not been completely bled.
- (2) If air bleeding is not complete, there will be abnormal noises from the pump and the flow-control valve, and this condition could cause a lessening of the life of the pump, etc.

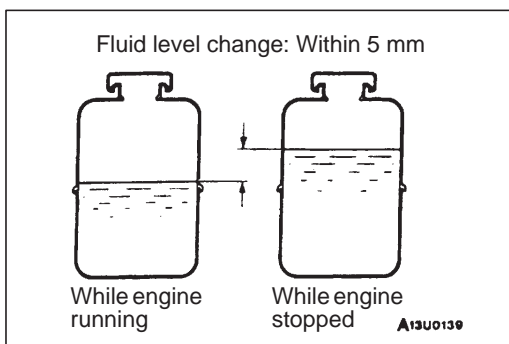

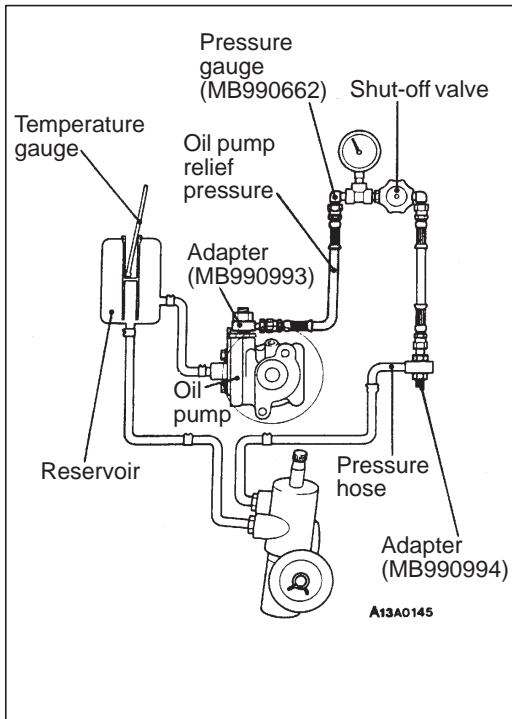

## OIL PUMP PRESSURE TEST

37200230219

1. Disconnect the pressure hose from the oil pump, and then connect the special tools.
2. Bleed the air, and then turn the steering wheel several times while the vehicle is not moving so that the temperature of the fluid rises to approximately 50 – 60°C.
3. Start the engine and idle it at 1,000 ± 100 r/min.
4. Fully close the shut-off valve of the pressure gauge and measure the oil pump relief pressure to confirm that it is within the standard value range.

**Standard value: 9.8 MPa**

### Caution

**Pressure gauge shut off valve must not remain closed for more than 10 seconds.**

5. If it is not within the standard value, replace the oil pump.
6. Check whether or not the hydraulic pressure is the standard value when no-load conditions are created by fully opening the shut-off valve of the pressure gauge.

**Standard value: 0.3 – 0.8 MPa**

7. If it is not within the standard value, the probable cause is a malfunction of the oil line or steering gear box, so check these parts and repair as necessary.
8. Fully open the shut-off valve of the pressure gauge.
9. Turn the steering wheel all the way to the left or right; then check whether or not the retention hydraulic pressure is the standard value.

**Standard value: 9.8 MPa**

10. When not within the standard value, replace the power steering gear box.  
Remeasure fluid pressure.
11. Remove the special tools, and then tighten the pressure hose to the specified torque.

**Tightening torque: 17 Nm**

12. Bleed the system.

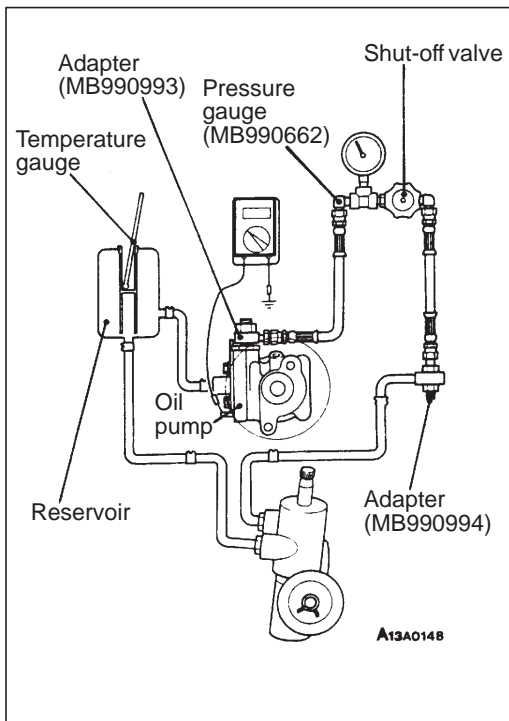

## POWER STEERING OIL PRESSURE SWITCH CHECK

37200720198

1. Disconnect the pressure hose from the oil pump, and then connect the special tools.
2. Bleed the air, and then turn the steering wheel several times while the vehicle is not moving so that the temperature of the fluid rises to approximately 50 – 60°C.
3. The engine should be idling.
4. Disconnect the connection of the connector for the oil pressure switch, and place an ohmmeter in position.
5. Gradually close the shut-off valve of the pressure gauge and increase the hydraulic pressure, then check whether or not the hydraulic pressure that activates the switch is the standard value.

**Standard value: 1.8 – 2.4 MPa**

6. Gradually open the shut-off valve and reduce the hydraulic pressure; then check whether or not the hydraulic pressure that deactivates the switch is the standard value.

**Standard value: 1.0 – 2.4 MPa**

7. Remove the special tools, and then tighten the pressure hose to the specified torque.

**Tightening torque: 17 Nm**

8. Bleed the system.

# STEERING WHEEL AND SHAFT

## REMOVAL AND INSTALLATION

### CAUTION: SRS

Before removal of air bag module, refer to GROUP 52B – Service Precautions and Air Bag Module and Clock Spring.

**Pre-removal Operation**  
 Instrument Under Cover Removal  
 (Refer to GROUP 52A – Instrument Panel.)

**Post-installation Operation**

- Instrument Under Cover Installation  
 (Refer to GROUP 52A – Instrument Panel.)
- Checking Steering Wheel Position with Wheels Straight Ahead

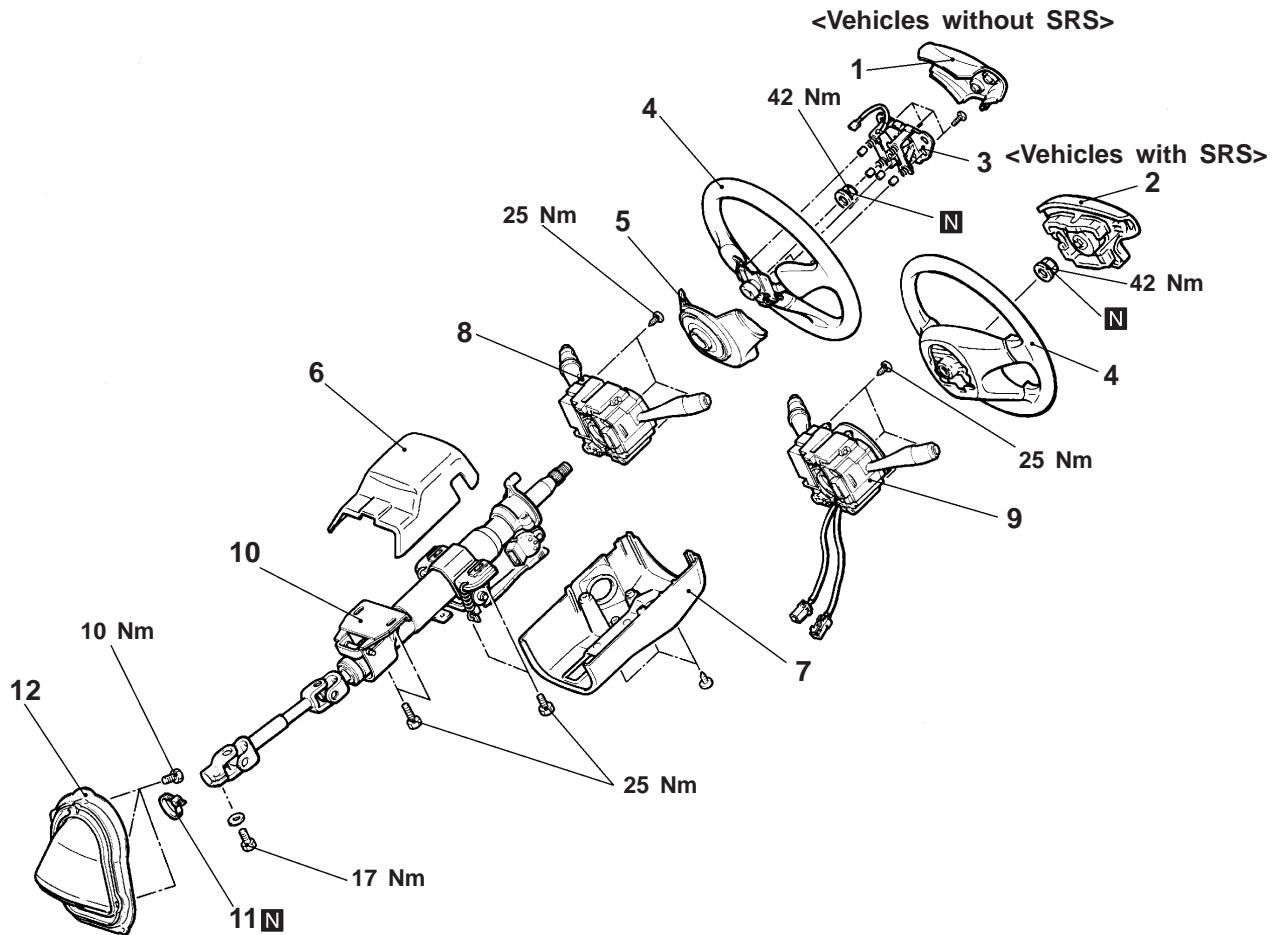

AV0335AJ

### Removal steps

1. Horn pad <Vehicles without SRS>
2. Air bag module  
 (Refer to GROUP 52B – Air Bag Module and Clock Spring.)
3. Horn switch  
 <Vehicles without SRS>
4. Steering wheel
5. Steering wheel lower cover  
 <Vehicles without SRS>
6. Upper column cover
7. Lower column cover

- ▶◀ 8. Column switch  
 <Vehicles without SRS>
- ▶◀ 9. Clock spring and column switch  
 (Refer to GROUP 52B – Air Bag Module and Clock Spring.)
10. Steering shaft assembly
11. Band
12. Retainer assembly



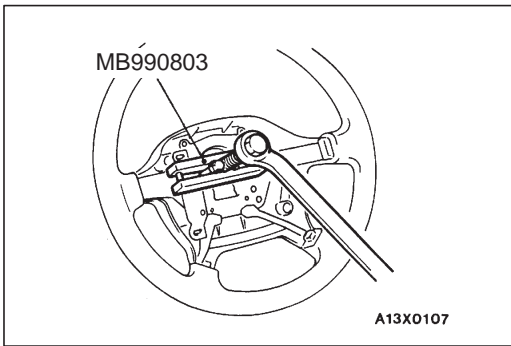

**REMOVAL SERVICE POINT**

◀A▶ STEERING WHEEL REMOVAL

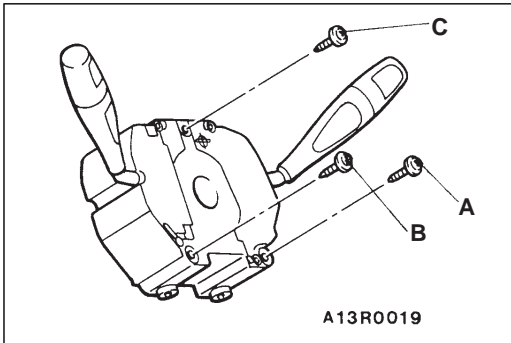

**INSTALLATION SERVICE POINT**

▶A◀ CLOCK SPRING AND COLUMN SWITCH/COLUMN SWITCH INSTALLATION

Tighten the screws in an alphabetical order.

**DISASSEMBLY AND REASSEMBLY**

37200280184

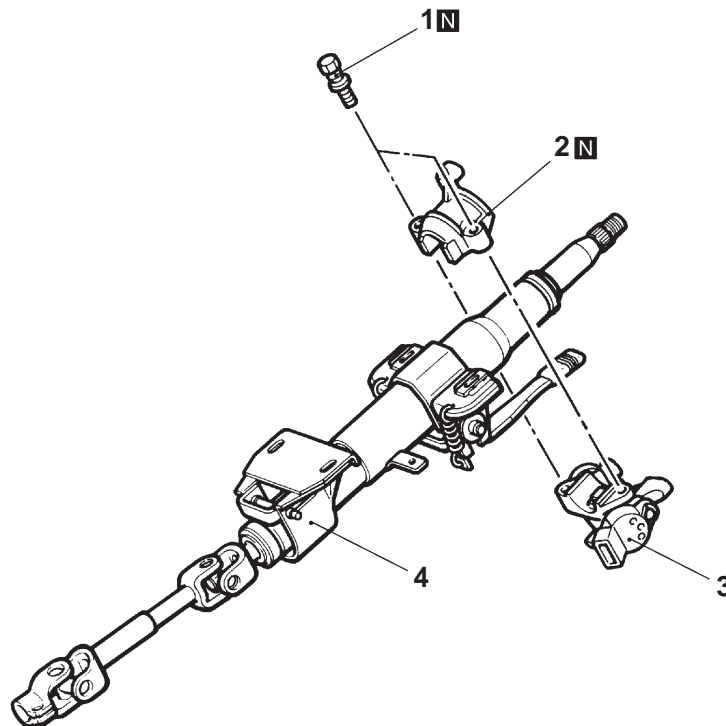

AV0112AJ

**Disassembly steps**

- ◀A▶ ▶A◀ 1. Special bolt
- ▶A◀ ▶A◀ 2. Steering lock bracket
- ▶A◀ ▶A◀ 3. Steering lock cylinder
- ▶A◀ ▶A◀ 4. Steering shaft

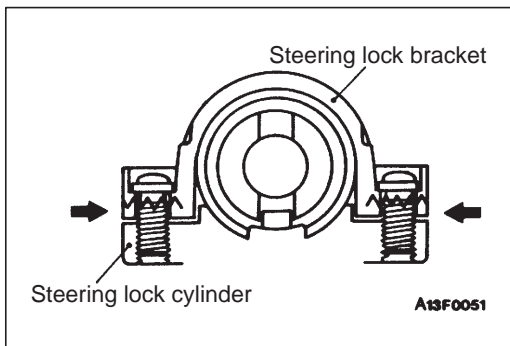
**DISASSEMBLY SERVICE POINT****◀A▶ STEERING LOCK BRACKET/STEERING LOCK CYLINDER REMOVAL**

If it is necessary to remove the steering lock cylinder, use a hacksaw to cut the special bolts at the steering lock bracket side.

**REASSEMBLY SERVICE POINT****▶A◀ STEERING LOCK CYLINDER/STEERING LOCK BRACKET/SPECIAL BOLT INSTALLATION**

1. When installing the steering lock cylinder and steering lock bracket to the column tube, temporarily install the steering lock in alignment with the column boss.

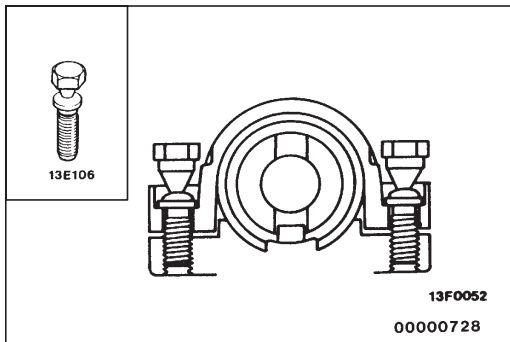

2. After checking that the lock works properly, tighten the special bolts until the head twists off.

**Caution**

**The steering lock bracket and bolts must be replaced with new ones when the steering lock is installed.**

# POWER STEERING GEAR BOX

## REMOVAL AND INSTALLATION

### CAUTION: SRS

For vehicles with SRS, before removal of steering gear box, refer to GROUP 52B, centre front wheels and remove ignition key. Failure to do so may damage SRS clock spring and render SRS system inoperative, risking serious driver injury.

#### Pre-removal Operation

- Power Steering Fluid Draining (Refer to P.37A-8.)
- Center Member Removal (Refer to GROUP 32.)
- Front Exhaust Pipe Removal (Refer to GROUP 15.)

#### Post-installation Operation

- Check the Dust Cover for Cracks or Damage by Pushing it with Finger.
- Front Exhaust Pipe Installation (Refer to GROUP 15.)
- Center Member Installation (Refer to GROUP 32.)
- Power Steering Fluid Supplying (Refer to P.37A-8.)
- Power Steering Fluid Line Bleeding (Refer to P.37A-8.)
- Checking Steering Wheel Position with Wheels Straight Ahead
- Front Wheel Alignment Adjustment (Refer to GROUP 33A.)

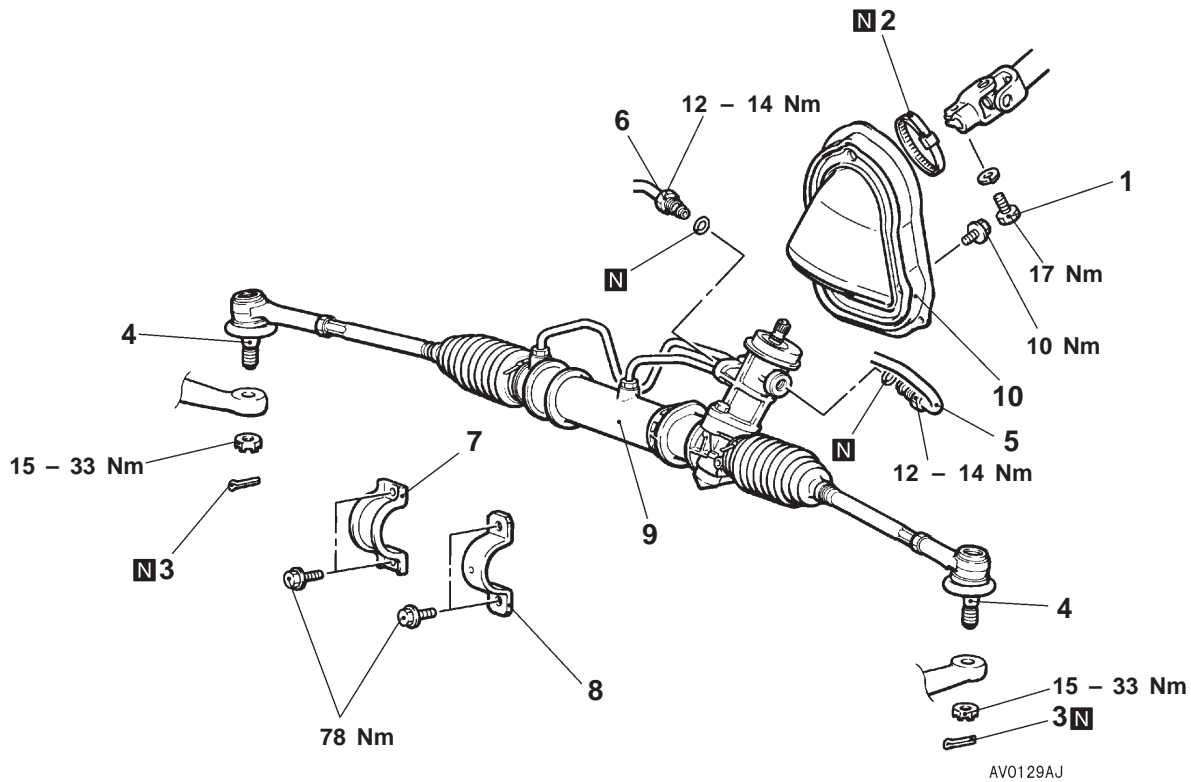

#### Removal steps

1. Steering shaft assembly and gear box connecting bolt
2. Band
3. Split pin
4. Tie-rod end and knuckle connection
5. Return hose connection

6. Pressure hose connection
7. Cylinder clamp
8. Gear housing clamp
9. Gear box assembly
10. Retainer assembly





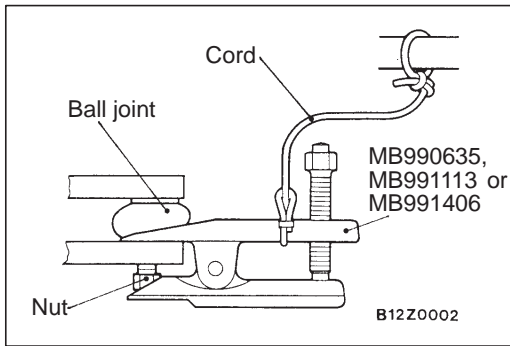

## REMOVAL SERVICE POINTS

### ◀A▶ TIE ROD END DISCONNECTION

#### Caution

1. Be sure to use the special tool to loosen the tie rod end mounting nut to prevent the ball joint thread from damaging. Only loosen the nut; do not remove it from the ball joint.
2. Support the special tool with a cord, etc. to prevent it from coming off.

### ◀B▶ GEAR BOX ASSEMBLY REMOVAL

#### Caution

Be careful not to damage the bellows and the tie rod end dust cover when removing the gear box assembly.

## INSPECTION

37200400177

Check the rubber parts for cracks and breakage.

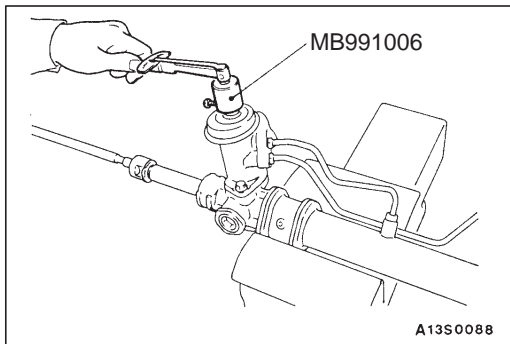

## GEAR BOX TOTAL PINION TORQUE

Using the special tools, rotate the pinion gear at the rate of one rotation in approximately 4 to 6 seconds to check the total pinion torque.

**Standard value: 0.6 – 1.3 Nm**  
**[Change in torque: 0.4 Nm]**

#### NOTE

When measuring, remove the bellows from the rack housing. Measure the pinion torque through the whole stroke of the rack.

If the measured value is not within the standard range, first adjust the rack support cover, and then check the total pinion starting torque again.

If the torque cannot be adjusted to the standard value, replace the power steering gear box assembly.

#### Caution

The power steering gear box assembly should be secured at the mounting sections. If it is secured in any other places, the gear housing may become deformed or damaged.

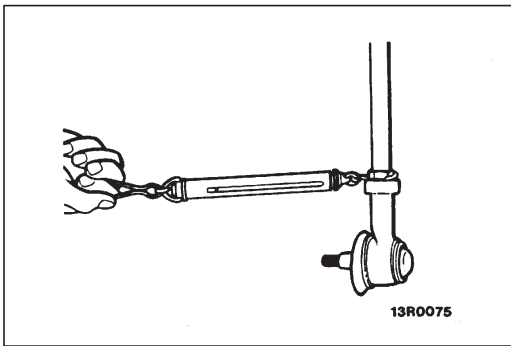

**CHECK THE TIE ROD FOR SWING RESISTANCE**

1. Give 10 hard swings to the tie rod.
2. Measure the tie rod swing resistance with a spring balance.

**Standard value: 6 – 20 N [1.5 – 4.9 Nm]**

3. If the measured value exceeds the standard value, replace gear box assembly.
4. Even if the measured value is below the standard value, the tie rod which swings smoothly without excessive play may be used.

**TIE ROD END BALL JOINT DUST COVER CHECK**

1. Check the dust cover for cracks or damage by pushing it with finger.
2. If the dust cover is cracked or damaged, replace the tie rod end.

**NOTE**

Check or damage of the dust cover may cause damage of the ball joint. when it is damaged during service work, replace the dust cover.

**DISASSEMBLY AND REASSEMBLY**

37200410163

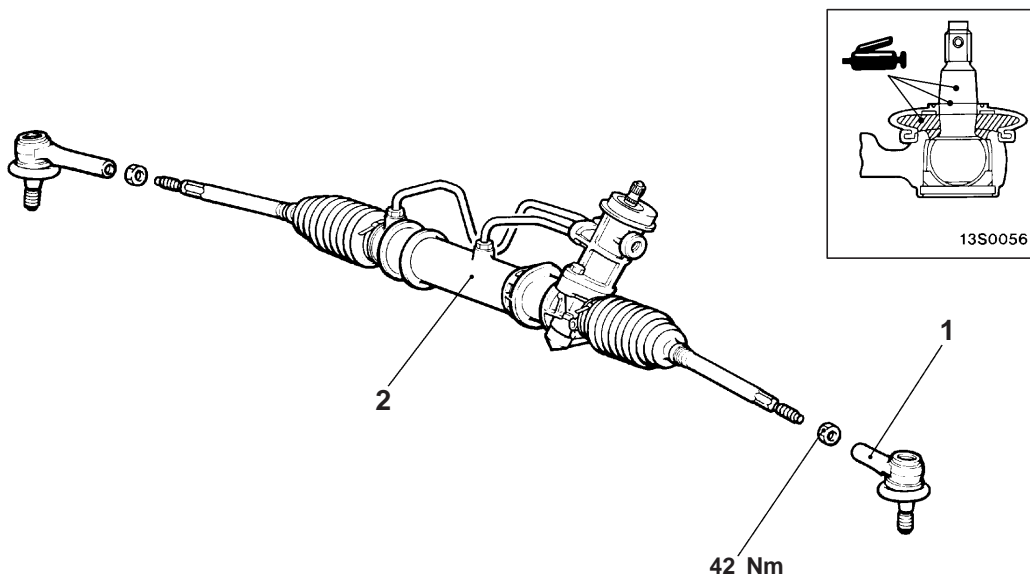

V0130AJ  
00008290

**Disassembly steps**

- ▶B◀ 1. Tie rod end
- ▶B◀ 2. Gear box assembly
- ▶A◀ • Total pinion torque adjustment

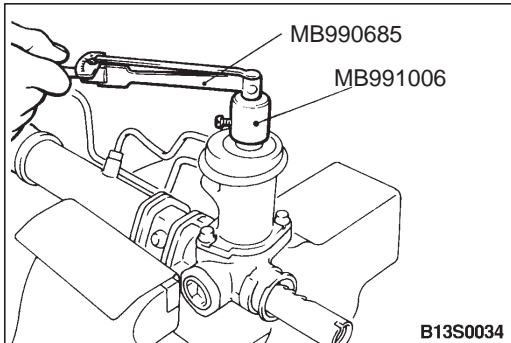
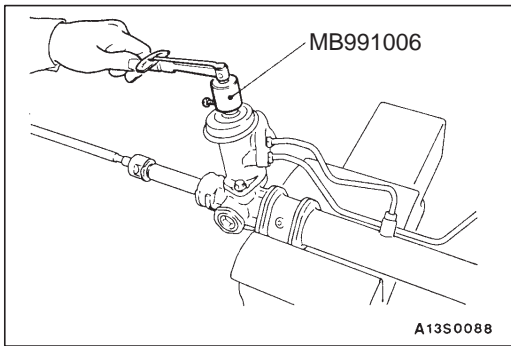

**REASSEMBLY SERVICE POINTS**

**▶A◀ TOTAL PINION TORQUE ADJUSTMENT**

1. Position rack at its centre. Tighten rack support cover to 15 Nm.
2. In neutral position, rotate pinion shaft clockwise one turn/4 – 6 seconds with special tool. Return rack support cover 30° – 60° and adjust torque to the standard value.

3. Using the special tools, rotate the pinion gear at the rate of one rotation in approximately 4 to 6 seconds to check the total pinion torque.

**Standard value: 0.6 – 1.3 Nm**  
**[Change in torque: 0.4 Nm]**

**Caution**

- (1) When adjusting, set the standard value at its highest value.
- (2) Assure no ratcheting or catching when operating rack towards the shaft direction.

**NOTE**

When it cannot be adjusted within the specified return angle, check rack support cover components or replace.

4. After adjusting, lock rack support cover with lock nut.

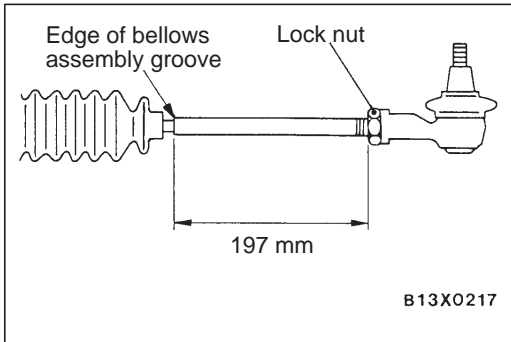

**▶B◀ TIE ROD END INSTALLATION**

Screw in tie rod end to have its right and left length as illustrated. Lock with lock nut.

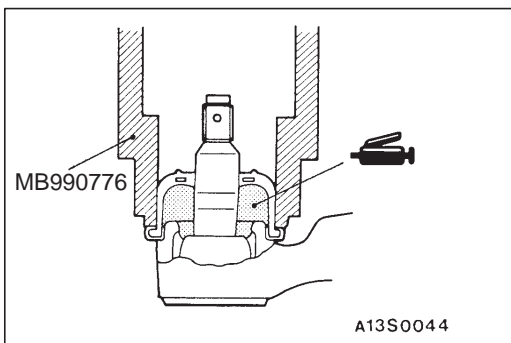

**DUST COVER INSTALLATION**

Only when the dust cover is damaged accidentally during service work, replace the dust cover as follows:

1. Apply grease to the inside of the dust cover.
2. Apply the specified sealant to the mounting surface of the dust cover.

**Specified fluid: 3M ATD Part No. 8661 or equivalent**

3. Drive in the dust cover with special tool until it is fully seated.
4. Check the dust cover for cracks or damage by pushing it with finger.

**POWER STEERING OIL PUMP**

37200520316

**REMOVAL AND INSTALLATION**

**Pre-removal Operation**

Power Steering Fluid Draining (Refer to P.37A-8.)

**Post-installation Operation**

- Power Steering Fluid Supplying (Refer to P.37A-8.)
- Drive-belt Tension Adjusting (Refer to GROUP 11 – On-vehicle Service.)
- Power Steering Fluid Line Bleeding (Refer to P.37A-8.)
- Oil Pump Pressure Check (Refer to P.37A-10.)

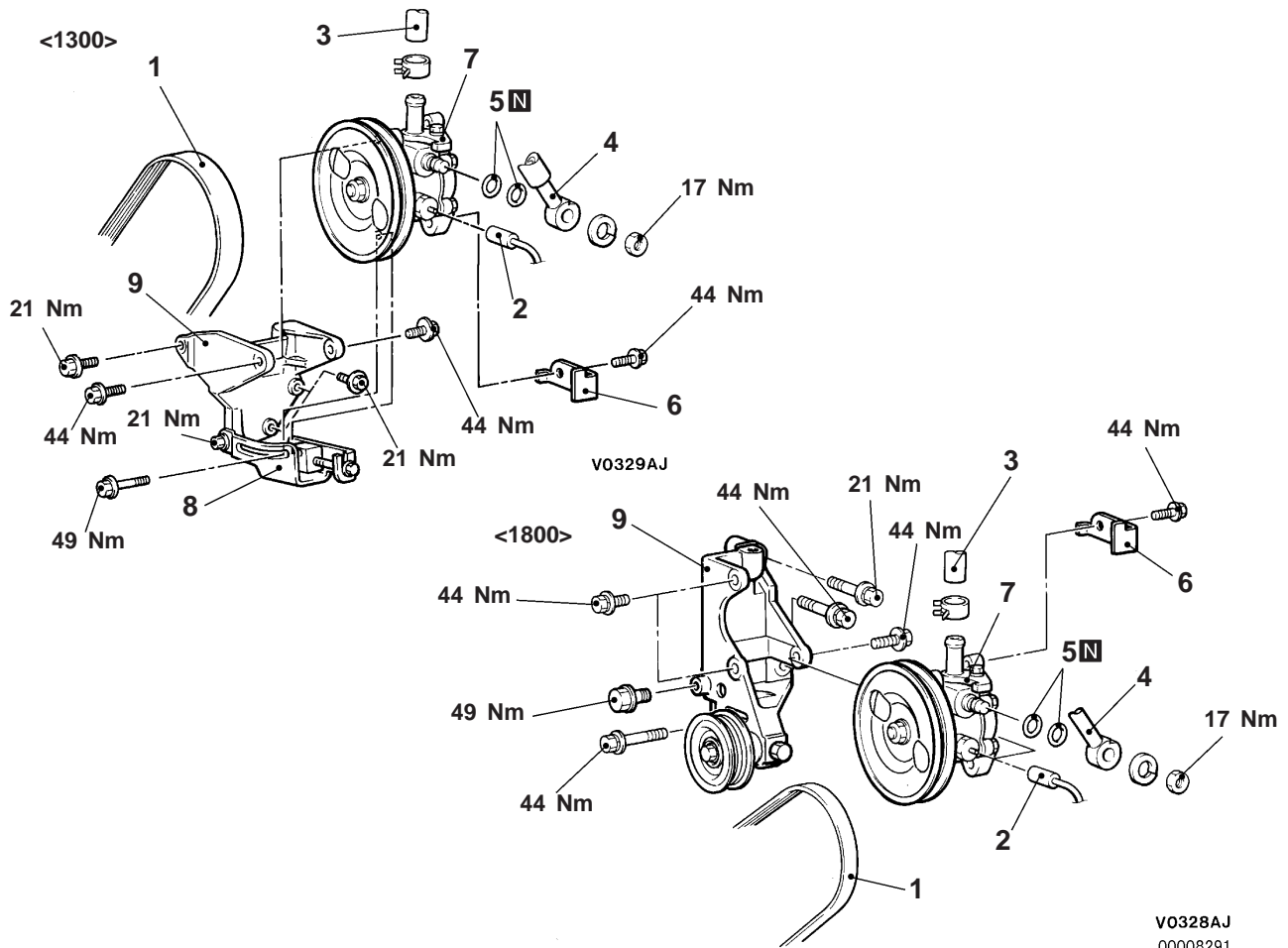

**Removal steps**

1. Drive-belt
2. Pressure switch connector
3. Suction hose
4. Pressure hose
5. O-ring

6. Power steering switch bracket
7. Oil pump
8. Oil pump brace
9. Oil pump bracket

**INSPECTION**

- Check the drive-belt for cracks.
- Check the pulley assembly for uneven rotation.

37200530036

POWER STEERING HOSES

37200570342

REMOVAL AND INSTALLATION

**Pre-removal Operation**  
 Power Steering Fluid Draining (Refer to P.37A-8.)

**Post-installation Operation**

- Power Steering Fluid Supplying (Refer to P.37A-8.)
- Power Steering Fluid Line Bleeding (Refer to P.37A-8.)

<1300>

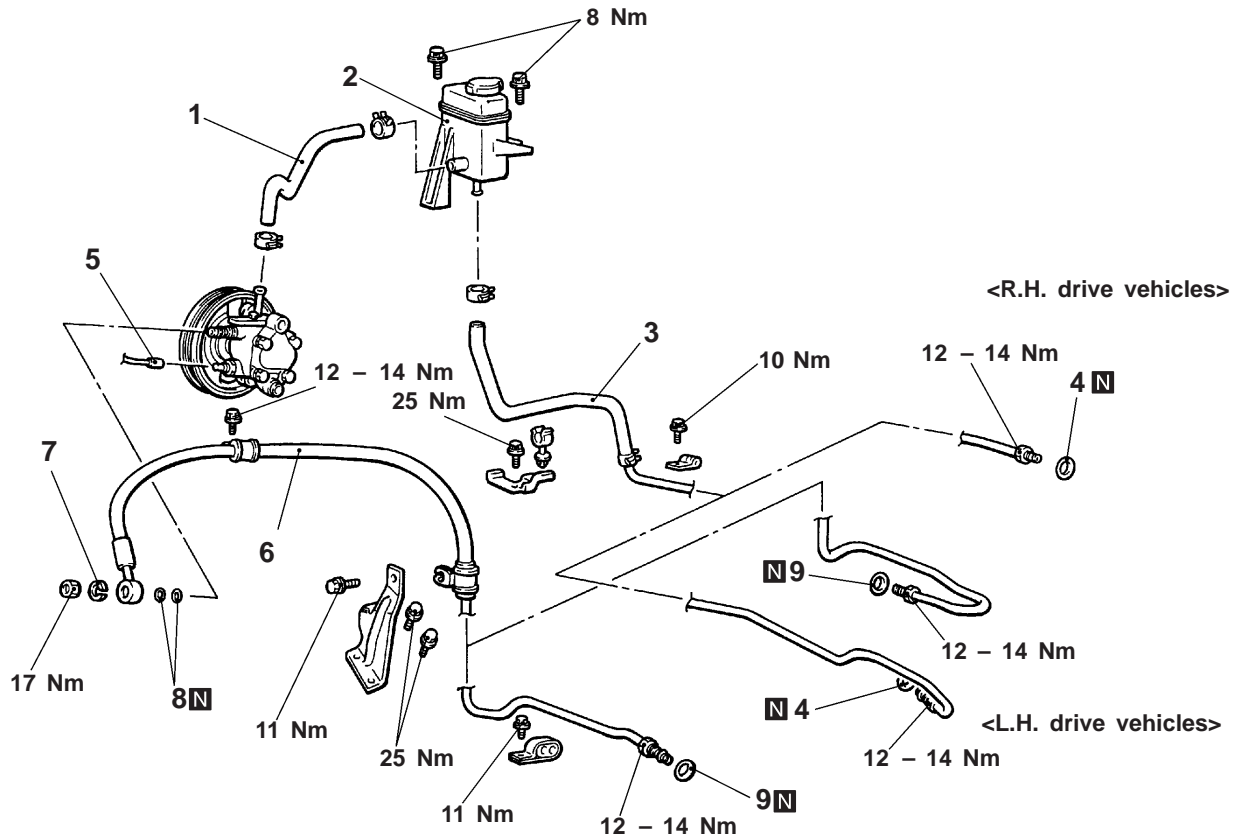

AV0318AJ

**Removal steps**

- |  |   |
|--|---|
| <ul style="list-style-type: none"> <li>▶A◀ 1. Suction hose</li> <li>▶A◀ 2. Oil reservoir</li> <li>▶A◀ 3. Return hose</li> <li>▶A◀ 4. O-ring</li> <li>▶A◀ 5. Pressure switch connector</li> </ul> | <ul style="list-style-type: none"> <li>6. Pressure hose</li> <li>7. Washer</li> <li>8. O-ring</li> <li>9. O-ring</li> </ul> |
|--|---|

<1800>

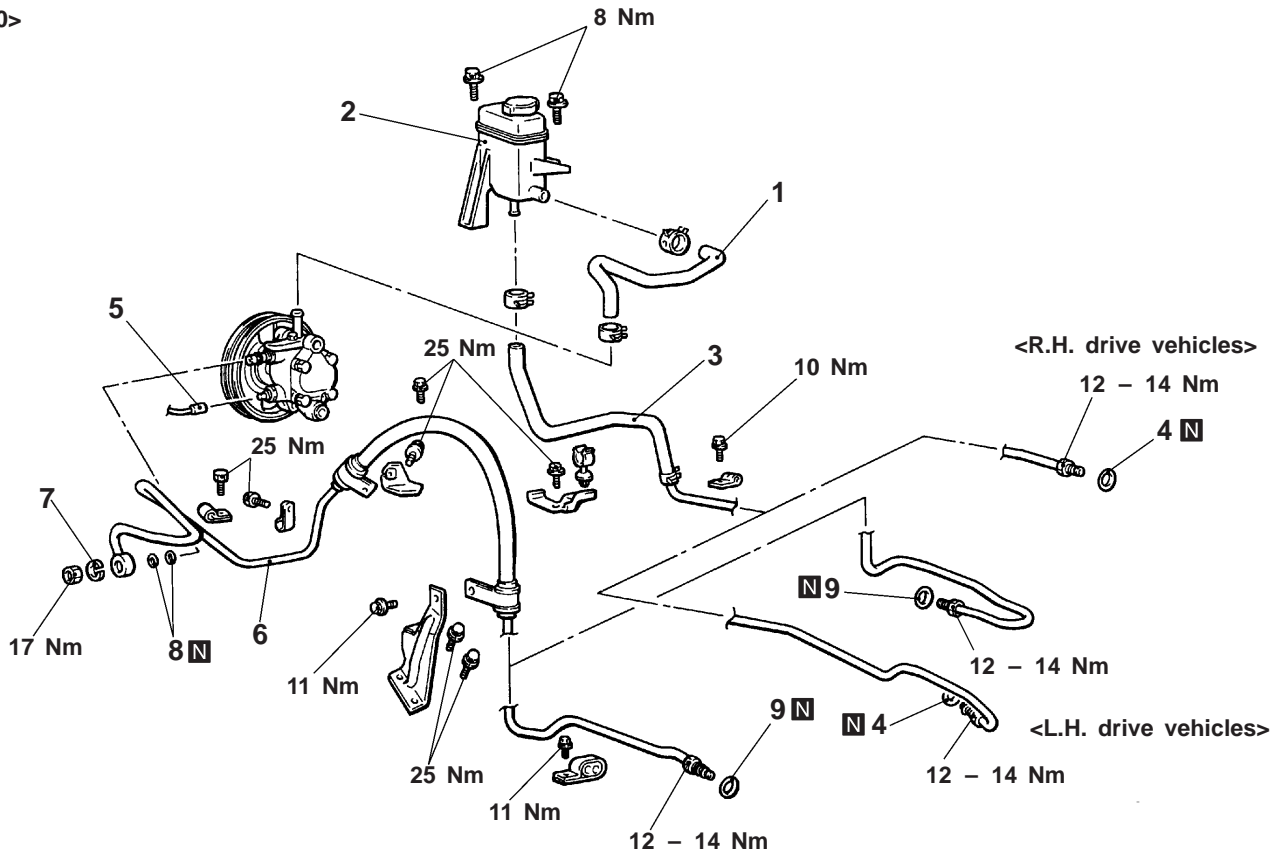

AV0317AJ

**Removal steps**

- ▶A◀ 1. Suction hose
- ▶A◀ 2. Oil reservoir
- ▶A◀ 3. Return hose
- ▶A◀ 4. O-ring
- ▶A◀ 5. Pressure switch connector
- 6. Pressure hose
- 7. Washer
- 8. O-ring
- 9. O-ring

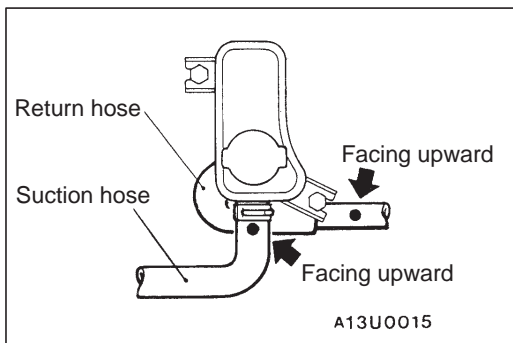

**INSTALLATION SERVICE POINT**

▶A◀ **RETURN HOSE/SUCTION HOSE INSTALLATION**

Connect the hose so that the marking is facing upwards.

A13U0015

---

## NOTES

## GROUP 37A

# STEERING

### GENERAL

#### OUTLINE OF CHANGE

- The standard value of the gear box total pinion torque has been changed due to the changes on the steering gear box <1800-SPORT, 1900-SPORT>.
- The service procedure of the power steering oil pump has been added due to the introduction of the 1,900 mL diesel engine.
- The service procedure of the power steering hoses has been added due to the introduction of the 1,900 mL diesel engine.

#### POWER STEERING GEAR BOX <1800-SPORT, 1900-SPORT>

The same procedures as before are applied except for the inspections below.

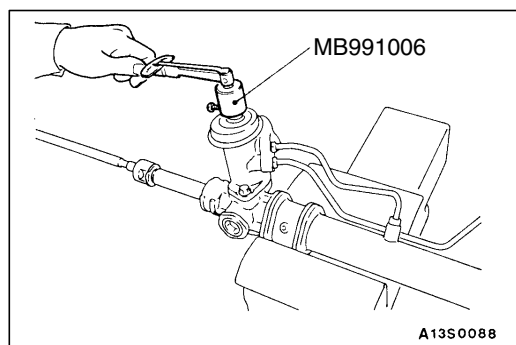

#### INSPECTION

##### GEAR BOX TOTAL PINION TORQUE

Using the special tools, rotate the pinion gear at the rate of one rotation in approximately 4 to 6 seconds to check the total pinion torque.

**Standard value: 0.5 – 1.2 Nm**  
**[Change in torque: 0.4 Nm]**

##### NOTE

When measuring, remove the bellows from the rack housing. Measure the pinion torque through the whole stroke of the rack.

If the measured value is not within the standard range, first adjust the rack support cover, and then check the total pinion starting torque again.

If the torque cannot be adjusted to the standard value, replace the power steering gear box assembly.

##### Caution

**The power steering gear box assembly should be secured at the mounting sections. If it is secured in any other places, the gear housing may become deformed or damaged.**



**POWER STEERING OIL PUMP <1900>****REMOVAL AND INSTALLATION****Pre-removal Operation**

Power Steering Fluid Draining

**Post-installation Operation**

- Power Steering Fluid Supplying
- Drive-belt Tension Adjusting  
(Refer to GROUP 11C – On-vehicle Service.)
- Power Steering Fluid Line Bleeding

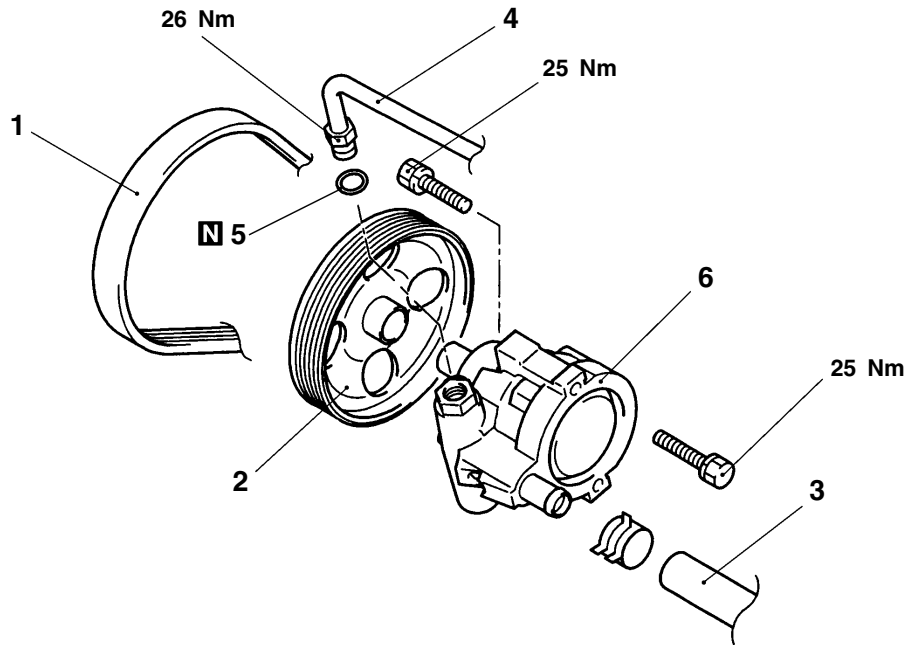

AY0205AJ

**Removal steps**

1. Drive-belt
2. Power steering pump pulley
3. Suction hose
4. Pressure hose
5. O-ring
6. Oil pump

**INSPECTION**

- Check the drive-belt for cracks.
- Check the pulley assembly for uneven rotation.

# POWER STEERING HOSES <1900>

## REMOVAL AND INSTALLATION

**Pre-removal Operation**  
Power Steering Fluid Draining

**Post-installation Operation**

- Power Steering Fluid Supplying
- Power Steering Fluid Line Bleeding

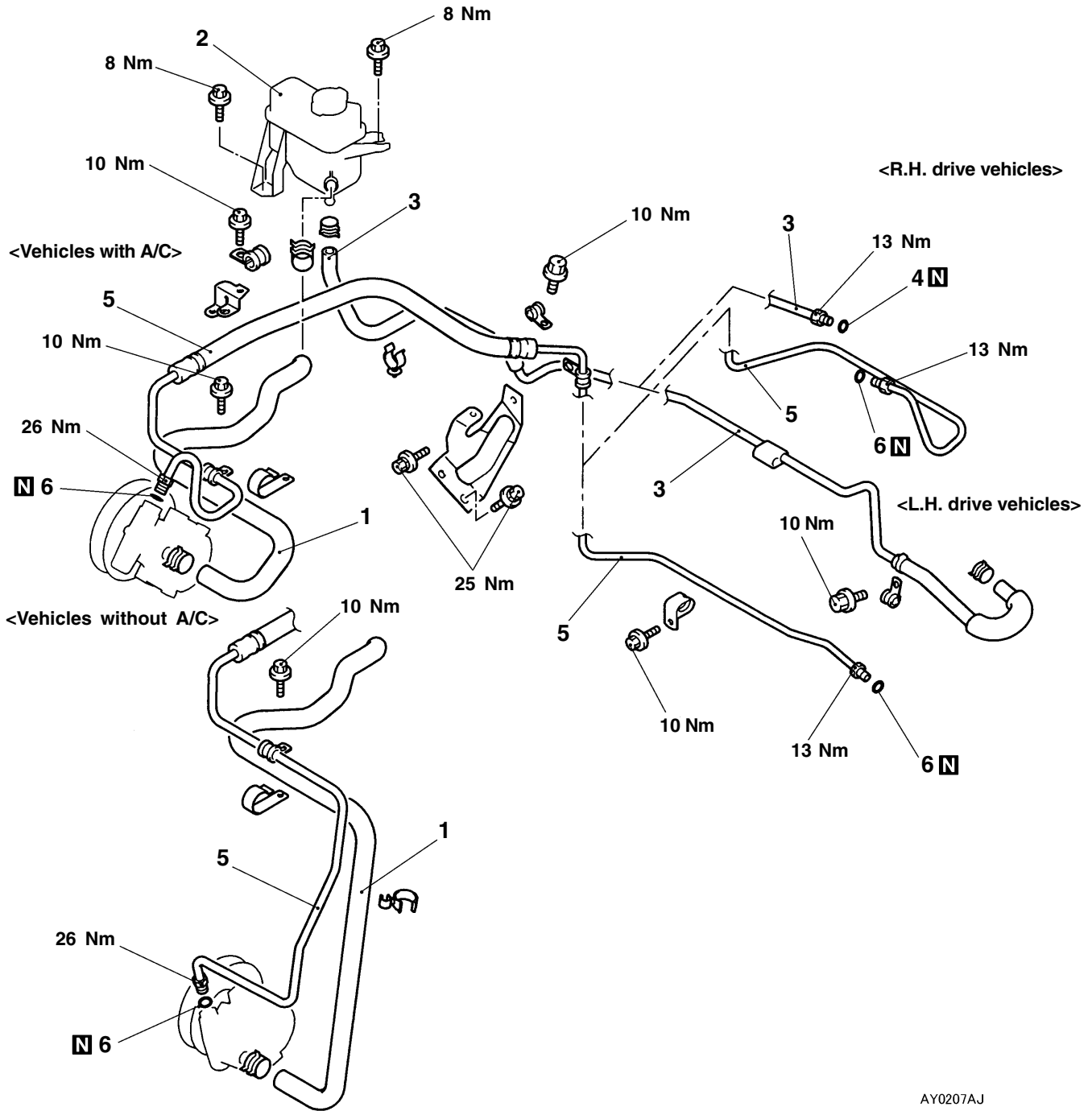

**Removal steps**

1. Suction hose
2. Oil reservoir
3. Return hose

4. O-ring
5. Pressure hose
6. O-ring

AY0207AJ

---

## NOTES

## GROUP 37A STEERING

### GENERAL

#### OUTLINE OF CHANGE

Due to the change of the steering wheel, the service procedures for the steering wheel have been revised.

NEW

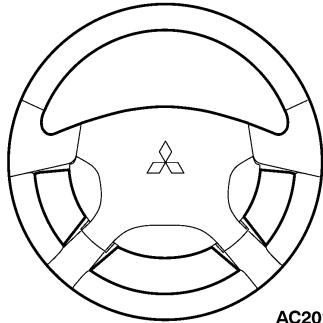

AC201439

OLD

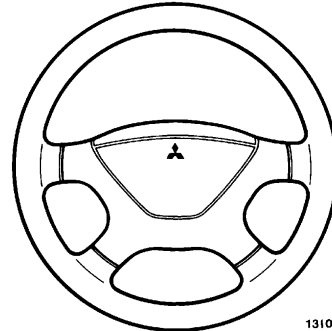

1310023

## STEERING WHEEL

### REMOVAL AND INSTALLATION

#### Caution: SRS

Before removal of air bag module, refer to SPACE STAR '99 Workshop Manual chassis (Pub. No. CMXE99E1), GROUP 52B – Service Precautions and Air Bag Module and Clock Spring.

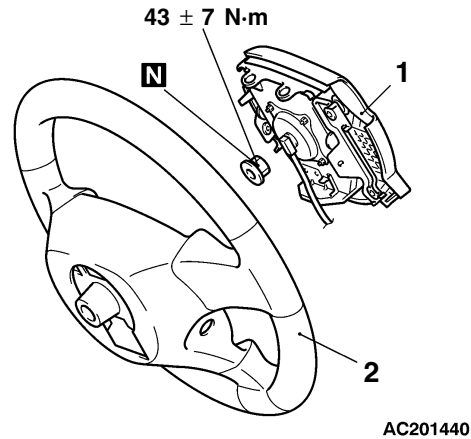

#### Removal steps

1. Air bag module  
(Refer to GROUP 52B.)
2. Steering wheel

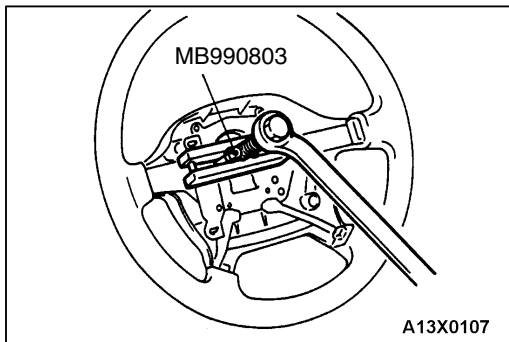

#### REMOVAL SERVICE POINT

##### ▶A◀ STEERING WHEEL REMOVAL

Use special tool MB990803 to remove the steering wheel.



# SERVICE BULLETIN

PUBLICATION GROUP, AFTER SALES SERVICE DEP.  
MITSUBISHI MOTOR SALES EUROPE BV

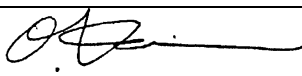
<b>SERVICE BULLETIN</b>		No.: ESB-01E37-501	
		Date: 2001-12-04	
<b>Subject:</b> RECTIFICATION OF OMISSION OF POWER STEERING SYSTEM BLEEDING		<Model> (EC)CARISMA(DX) (DA0A) (EC)SPACE STAR (MGX) (DG0A)	<M/Y> 97-01  01-01
<b>Group:</b> STEERING	<b>Draft No.:</b> 01CH003		
<b>CORRECTION</b>	INTERNATIONAL CAR ADMINISTRATION OFFICE	 O. Kai - E.V.P. & G.M. After Sales Service Dept.	
<b>1. Description:</b> This Service Bulletin informs you that omission of the power steering system bleeding has been rectified.			
<b>2. Applicable Manuals:</b>			
Manual	Pub. No.	Language	Page(s)
'97 CARISMA Workshop Manual Chassis	PWDE9502-A	(English)	37A-1
	PWDS9503-A	(Spanish)	
	PWDF9504-A	(French)	
	PWDG9505-A	(German)	
	PWDD9506-A	(Dutch)	
	PWDW9507-A	(Swedish)	
'01 CARISMA Workshop Manual Chassis	PWDE9502-E	(English)	37A-1
	PWDS9503-E	(Spanish)	
	PWDF9504-E	(French)	
	PWDG9505-E	(German)	
	PWDD9506-E	(Dutch)	
	PWDW9507-E	(Swedish)	
'01 SPACE STAR Workshop Manual Chassis	CMXE99E1-A	(English)	37A-1
	CMXS99E1-A	(Spanish)	
	CMXF99E1-A	(French)	
	CMXG99E1-A	(German)	
	CMXD99E1-A	(Dutch)	
	CMXW99E1-A	(Swedish)	

**GROUP 37A  
STEERING**

2. <Corrected>

**GENERAL**

**OUTLINE OF CHANGES**

- The following service procedures have been added to the addition of the diesel-powered vehicle  
Applicable models: 1900D.

<Added>

1. Bleeding

☒ Removal and installation of the power steering oil pump

☒ Removal and installation of the power steering hoses

3. <Corrected>

<Added>

See following page.

**POWER STEERING OIL PUMP  
REMOVAL AND INSTALLATION**

**Pre-removal Operation**

- Power Steering Fluid Draining
- Timing Belt Lower Cover Removal (Refer to GROUP 11 –Crankshaft Pulley.)

**Post-Installation Operation**

- Power Steering Fluid Supplying
- Drive-Belt Tension Adjusting
- Power Steering Fluid Line Bleeding
- Oil Pump Pressure Check
- Timing Belt Lower Cover Installation (Refer to GROUP 11 –Crankshaft Pulley.)

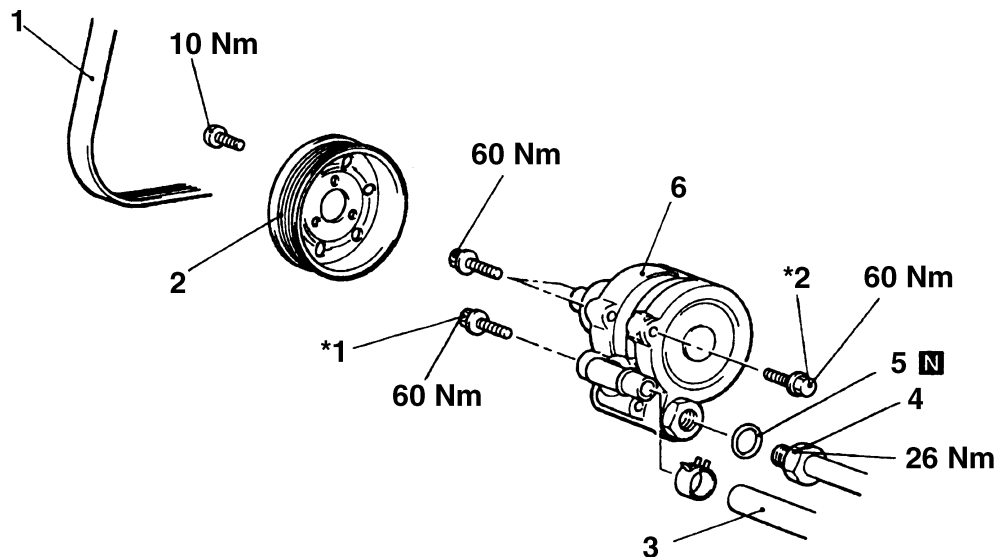

**Removal steps**

- Drive Belt
- Power steering pump pulley
- Suction hose connection
- Pressure hose connection
- O-ring
- Oil pump

**NOTE**

- \*1: Vehicles with A/C
- \*2: Vehicles without A/C

**INSPECTION**

Check the drive-belt for cracks.  
Check the pulley assembly for uneven rotation.

## ON-VEHICLE SERVICE

### BLEEDING

1. Jack up the front wheels and support them by using a rigid rack.
2. Manually turn the oil pump pulley a few times.
3. Turn the steering wheel all the way to the left and to the right five or six times.
4. Disconnect the timing control solenoid valve connector.

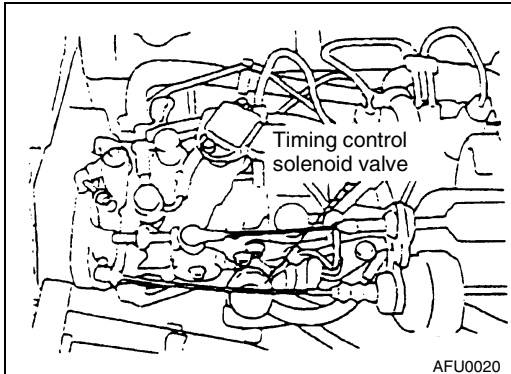

5. While operating the starting motor intermittently, turn the steering wheel all the way to the left and right five or six times (for 15 to 20 seconds).

### Caution

1. **During air bleeding, replenish the fluid supply so that the level never falls below the lower position of the filter.**
2. **If air bleeding is done while engine is running, the air will be broken up and absorbed into the fluid; be sure to do the bleeding only while cranking.**

6. Connect the timing control solenoid valve connector and run the engine at idle.
7. Turn the steering wheel to the left and right until there are no air bubbles in the oil reservoir.
8. Confirm that the fluid is not milky, and that the level is up to the specified position on the level gauge.
9. Confirm that there is very little change in the fluid level when the steering wheel is turned left and right.

10. Check whether or not the change in the fluid level is within 5 mm when the engine is stopped and when it is running.
11. If the change of the fluid level is 5 mm or more, the air has not been completely bled from the system, and thus must be bled completely.

### Caution

1. **If the fluid level rises suddenly after the engine is stopped, the air has not been completely bled.**
2. **If air bleeding is not complete, there will be abnormal noises from the pump and the flow-control valve, and this condition could cause a lessening of the life of the pump, etc.**

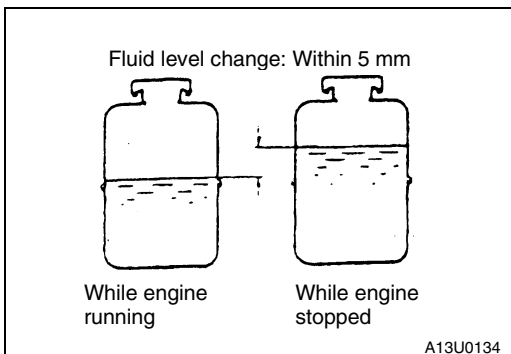



**GROUP 37A  
STEERING**

**GENERAL**

**OUTLINE OF CHANGE**

The following service procedures have been added due to the introduction of the 1900-mL diesel engine.

The other items are the same as before.

- Power steering oil pump
- Power steering hoses

<Added>

- Bleeding

<Added>

See following page.

**POWER STEERING OIL PUMP  
REMOVAL AND INSTALLATION**

**Pre-removal Operation**  
Power Steering Fluid Draining

**Post-Installation Operation**

- Power Steering Fluid Supplying
- Drive-Belt Tension Adjusting  
(Refer to GROUP 11C –On-vehicle Service.)
- Power Steering Fluid Line Bleeding

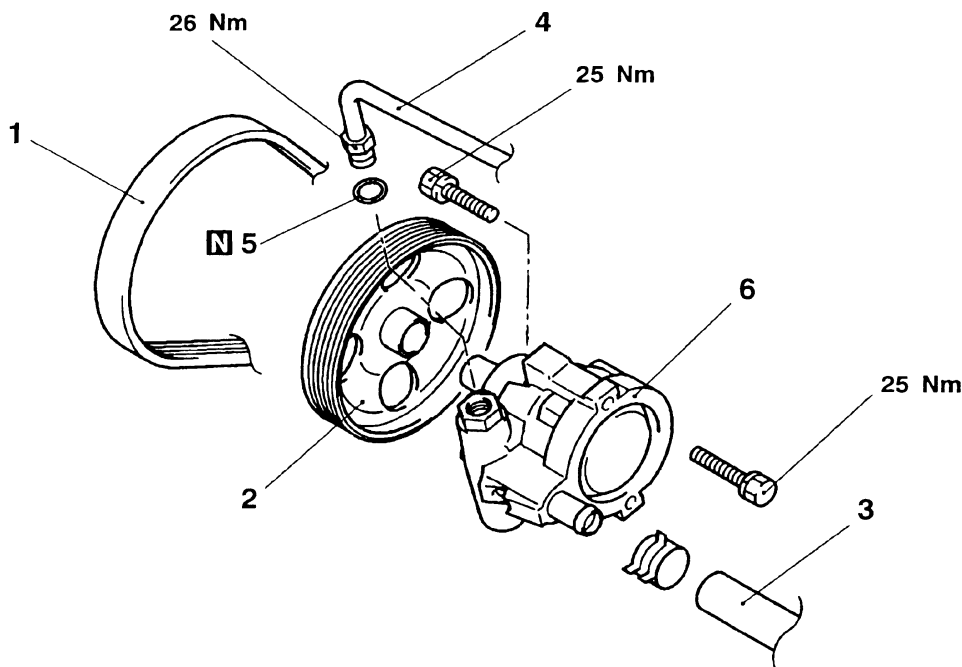

AY0205AJ

**Removal steps**

1. Drive-Belt
2. Power steering pump pulley
3. Suction hose connection

4. Pressure hose
5. O-ring
6. Oil pump

**INSPECTION**

- Check the drive-belt for cracks.
- Check the pulley assembly for uneven rotation.

## 37A-2

## STEERING –On-Vehicle Service

### ON-VEHICLE SERVICE <1900> BLEEDING

1. Jack up the front wheels and support them by using a rigid rack.
2. Disconnect the injector connector.
3. While operating the starting motor intermittently, turn the steering wheel all the way to the left and right five or six times (for 15 to 20 seconds).

#### Caution

- (1) The fluid level should be between MIN and MAX of the fluid level gauge during air bleeding. Carry out the air bleeding while checking the fluid level and adding the fluid.
- (2) If air bleeding is done while engine is running, the air will be broken up and absorbed into the fluid; be sure to do the bleeding only while cranking.

4. Connect the injector connector. Then start the engine and let it run at idle.
5. Turn the steering wheel to the left and right until there are no air bubbles in the oil reservoir.
6. Confirm that the fluid is not milky, and that the level is up to the specified position on the level gauge.
7. Confirm that there is very little change in the fluid level when the steering wheel is turned left and right.
8. Check whether or not the change in the fluid level is within 5 mm when the engine is stopped and when it is running.
9. If the change of the fluid level is 5 mm or more, the air has not been completely bled from the system, and thus must be bled completely.

#### Caution

- (1) If the fluid level rises suddenly after the engine is stopped, the air has not been completely bled.
- (2) If air bleeding is not complete, there will be abnormal noises from the pump and the flow-control valve, and this condition could cause a lessening of the life of the pump, etc.

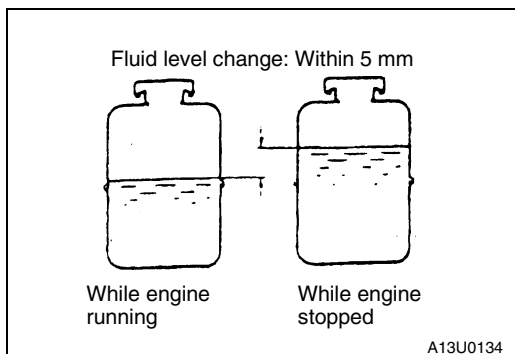
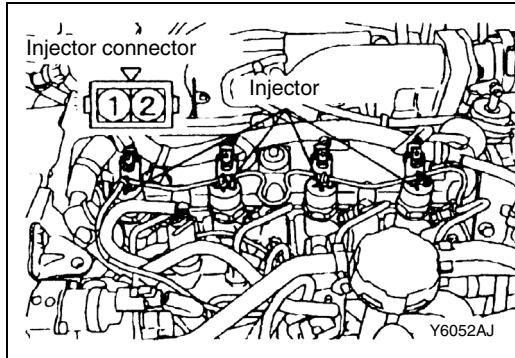

## GROUP 37A STEERING

<Corrected>

- The bleeding procedures have been added. <1900>

### GENERAL

#### OUTLINE OF CHANGE

- The standard value of the gear box total pinion torque has been changed due to the changes on the steering gear box <1800-SPORT, 1900-SPORT>.
- The service procedure of the power steering oil pump has been added due to the introduction of the 1,900 mL diesel engine.
- The service procedure of the power steering hoses has been added due to the introduction of the 1,900 mL diesel engine.

<Added>

See following page.

### POWER STEERING GEAR BOX <1800-SPORT, 1900-SPORT>

The same procedures as before are applied except for the inspections below.

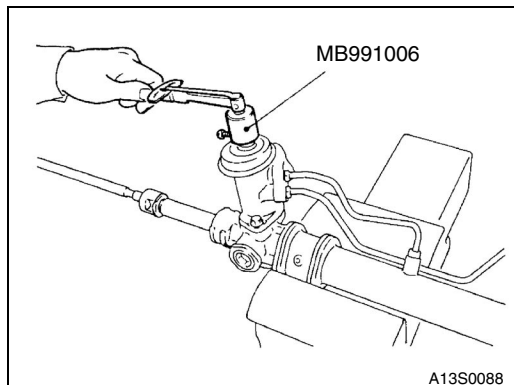

#### INSPECTION

##### GEAR BOX TOTAL PINION TORQUE

Using the special tools, rotate the pinion gear at the rate of one rotation in approximately 4 to 6 seconds to check the total pinion torque.

**Standard value: 0.5 –1.2 Nm**  
**[Change in torque: 0.4 Nm]**

#### NOTE

When measuring, remove the bellows from the rack housing. Measure the pinion torque through the whole stroke of the rack.

If the measured value is not within the standard range, first adjust the rack support cover, and then check the total pinion starting torque again.

If the torque cannot be adjusted to the standard value, replace the power steering gear box assembly.

#### Caution

**The power steering gear box assembly should be secured at the mounting sections. If it is secured in any other places, the gear housing may become deformed or damaged.**

## 37A-2

## STEERING –On-Vehicle Service

### ON-VEHICLE SERVICE <1900>

#### BLEEDING

1. Jack up the front wheels and support them by using a rigid rack.

2. Disconnect the injector connector.

3. While operating the starting motor intermittently, turn the steering wheel all the way to the left and right five or six times (for 15 to 20 seconds).

#### Caution

(1) The fluid level should be between MIN and MAX of the fluid level gauge during air bleeding. Carry out the air bleeding while checking the fluid level and adding the fluid.

(2) If air bleeding is done while engine is running, the air will be broken up and absorbed into the fluid; be sure to do the bleeding only while cranking.

4. Connect the injector connector. Then start the engine and let it run at idle.

5. Turn the steering wheel to the left and right until there are no air bubbles in the oil reservoir.

6. Confirm that the fluid is not milky, and that the level is up to the specified position on the level gauge.

7. Confirm that there is very little change in the fluid level when the steering wheel is turned left and right.

8. Check whether or not the change in the fluid level is within 5 mm when the engine is stopped and when it is running.

9. If the change of the fluid level is 5 mm or more, the air has not completely bled from the system, and thus must be bled completely.

#### Caution

(1) If the fluid level rises suddenly after the engine is stopped, the air has not been completely bled.

(2) If air bleeding is not complete, there will be abnormal noises from the pump and the flow-control valve, and this condition could cause a lessening of the life of the pump, etc.

