

GROUP 26 FRONT AXLE

GENERAL

OUTLINE OF CHANGES

Due to the addition of the vehicle with the F9Q1 engine, the service procedures for the front axle have been established.

DRIVE SHAFT <F9Q1>

REMOVAL AND INSTALLATION

Caution:

Do not strike the ABS rotors installed to the R.J. outer race of drive shaft against other parts when removing or installing the drive shaft. Otherwise the ABS rotors will be damaged.

Pre-removal and Post-installation Operation

- Brake Hose Clamp, Speed Sensor Cable Connection.
- Stabilizer Link Connection Removal and Installation.
- Side Under Cover Removal and Installation

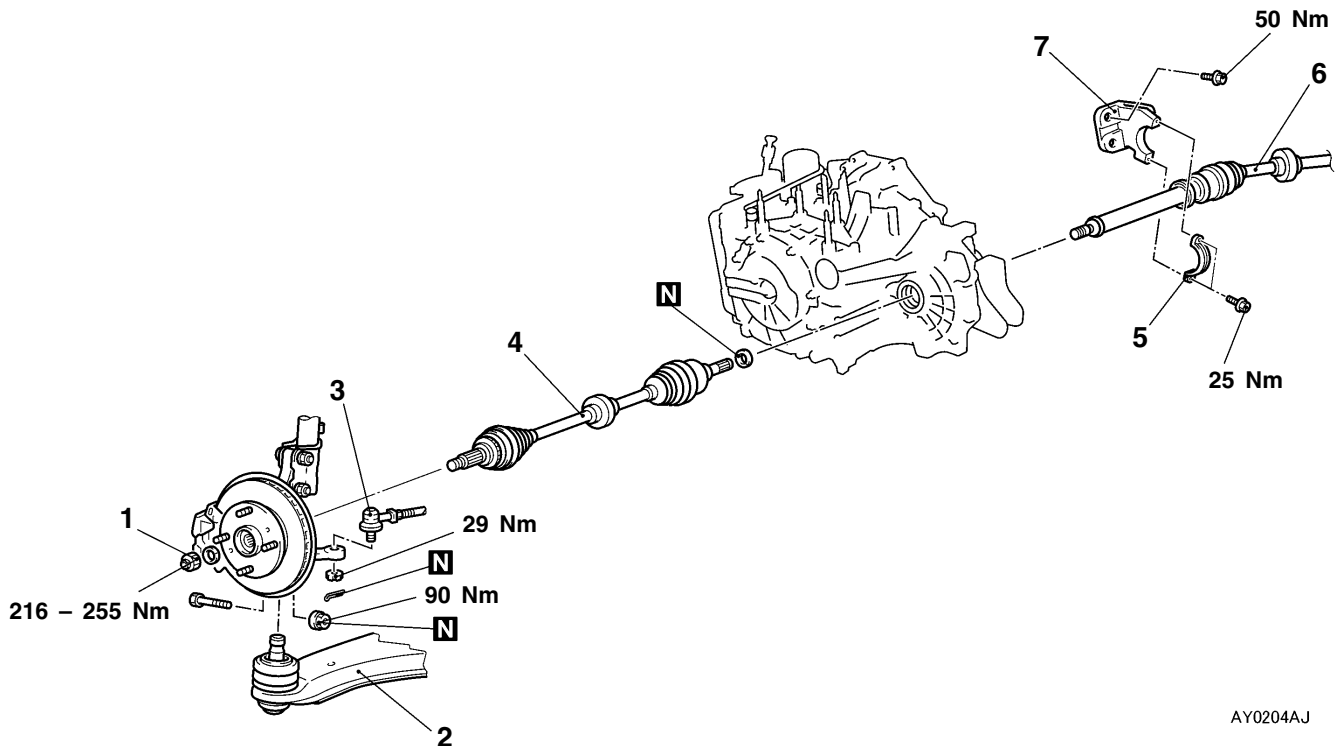

AY0204AJ

Removal steps

- ◀A▶ ▶A▶ 1. Drive shaft nut
- ▶B▶ 2. Lower arm ball joint connection
- ▶C▶ 3. Tie rod end connection
- 4. Drive shaft (L.H.)
- 5. Bearing bracket cap

- ▶C▶ 6. Drive shaft and transmission side shaft (R.H.)
- 7. Bearing bracket

NOTE

The service points for removal and installation are the same procedures as before.

DISASSEMBLY AND REASSEMBLY

Caution

1. R.J. assembly cannot be disassembled.
2. Be sure not to damage the rotor attached to the R.J. outer race.

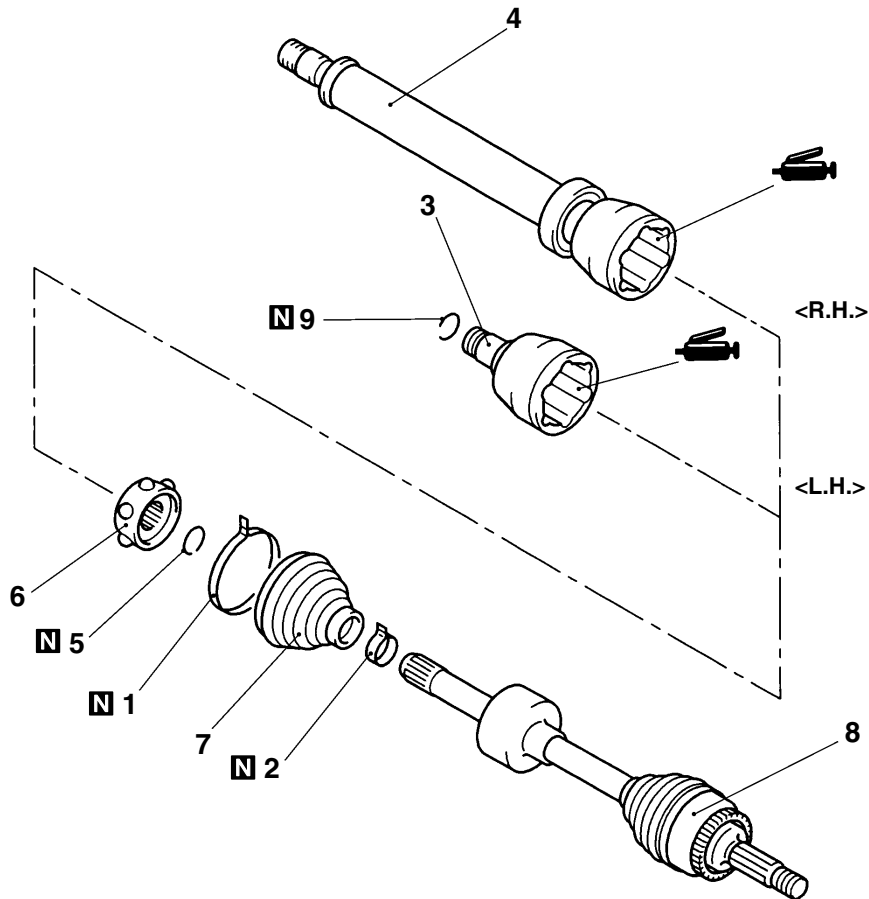

AY0181AJ

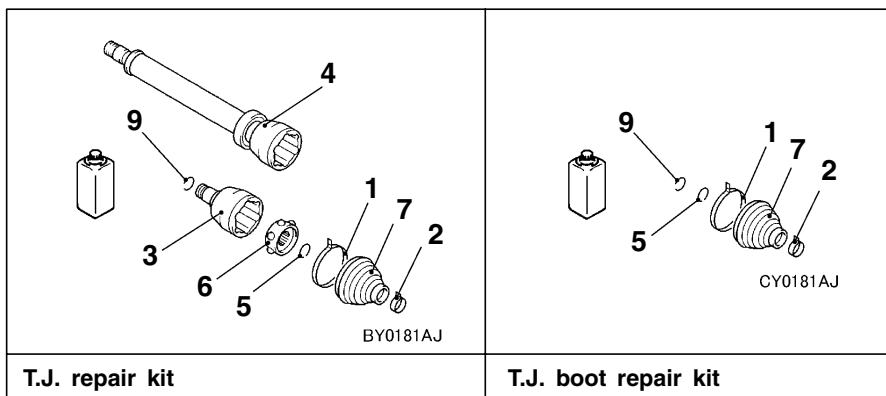

Disassembly steps

1. T.J. boot band (large)
2. T.J. boot band (small)
3. T.J. case (L.H.)
4. T.J. assembly (R.H.)
5. Snap ring



6. Joint assembly
7. T.J. boot
8. R.J. assembly
9. Circlip (L.H.)

DISASSEMBLY SERVICE POINTS**◀A▶ T.J. CASE/T.J. ASSEMBLY/JOINT ASSEMBLY
REMOVAL**

1. Remove grease from T.J. case, T.J. assembly, and the joint assembly.
2. If removed grease contains foreign objects, such as water and dust, make sure to clean the joint assembly.

◀B▶ T.J. BOOT REMOVAL

1. Remove grease from the shaft spline.
2. If T.J. boot is reused, wind tape around the spline of the shaft to prevent the boot from being damaged during removal.

NOTES