

GROUP 51 EXTERIOR

GENERAL

OUTLINE OF CHANGES

- Service adjustment procedures have been changed to correspond to the addition of a dynamic damper to the front bumper structural parts. <Diesel vehicles>
- Service adjustment procedures have been changed to correspond to changes to the side protector mouldings.
- Service adjustment procedures have been changed to correspond to the addition of a DI-D mark and changes to the application position for the GDI mark.

FRONT BUMPER <FOR DIESEL>

DISASSEMBLY AND REASSEMBLY

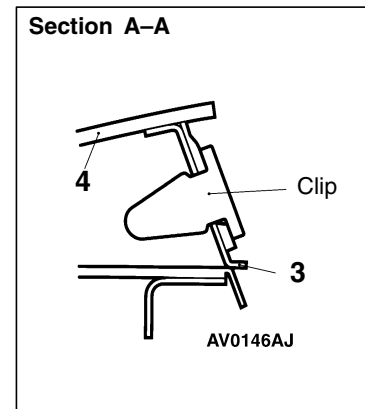
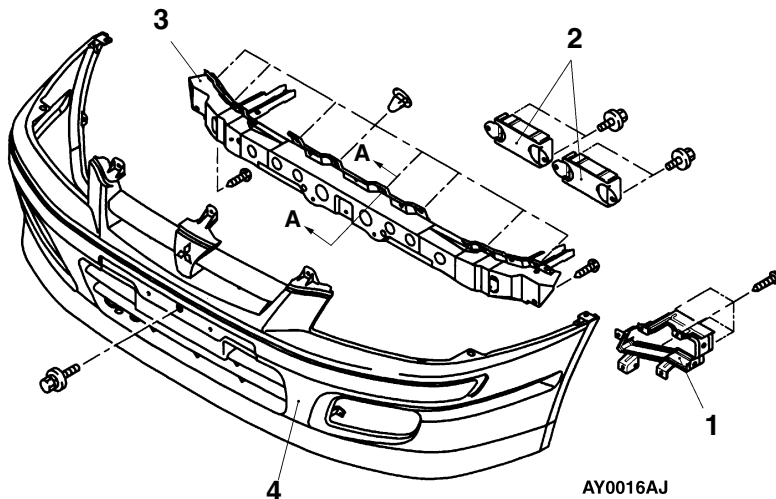

Disassembly steps

1. Front fog lamp bracket assembly
2. Dynamic damper

3. Bumper reinforcement
4. Bumper face

MOULDING

SEALANT AND ADHESIVE

Items	Specified sealant and adhesive
Side protect moulding to body panel	Adhesive tape: 3M ATD part No. 6382 or equivalent [12 mm wide and 0.8 mm thick]
	Primer: 3M ATD part No.8608 Super Fast Urethane Primer or equivalent and 3M ATD part No. 8609 Super Fast Urethane Primer or equivalent

REMOVAL AND INSTALLATION

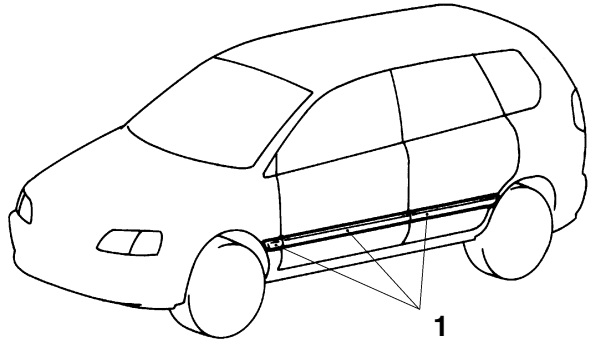

AV0231AJ

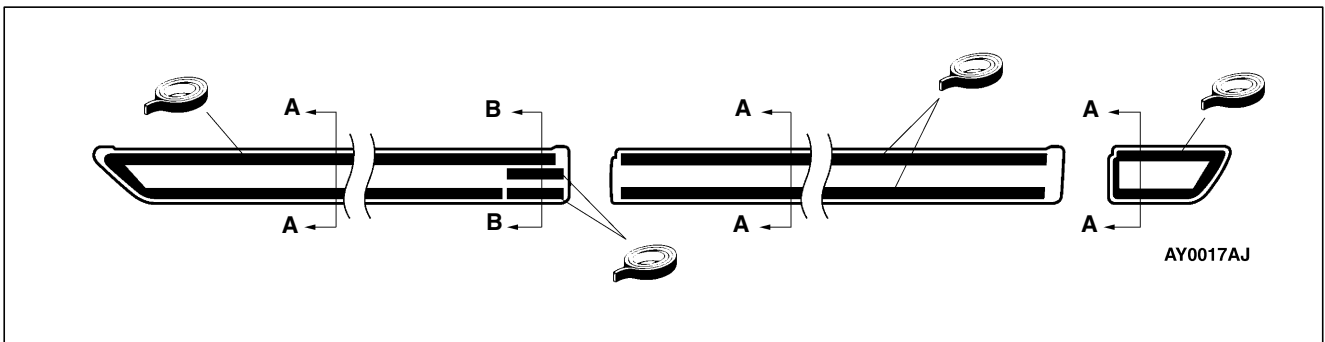
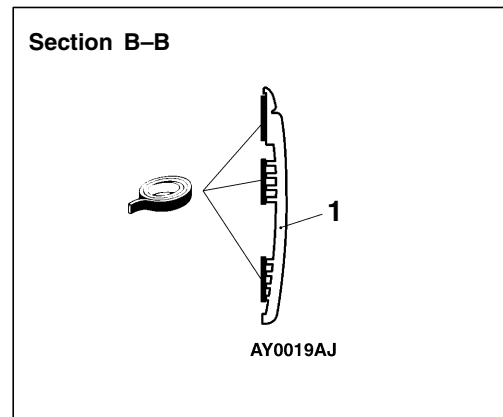
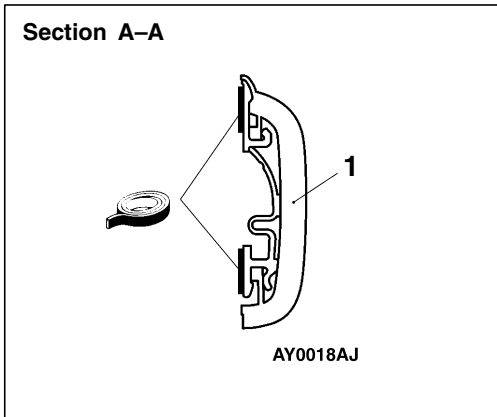

Adhesive tape: double-sided tape [12 mm wide and 0.8 mm thick]

◀A▶ ▶A◀ 1. Side protector moulding

NOTE
For service point, refer to Basic Manual.

MARKS

REMOVAL AND INSTALLATION

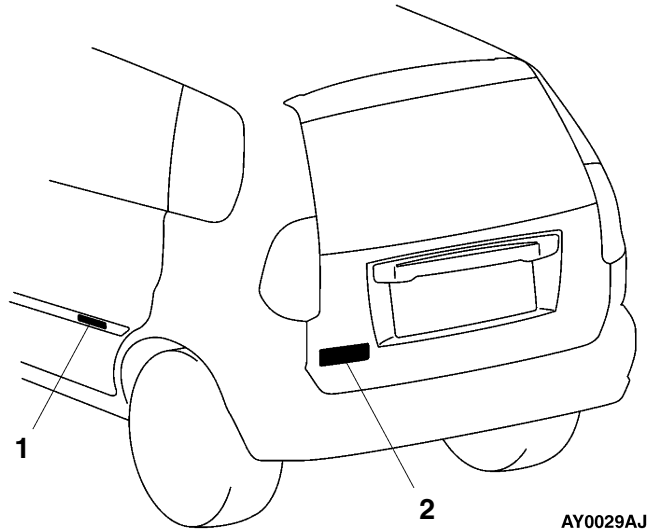

AY0029AJ

▶◀ 1. GRADE mark

▶◀ 2. GDI or DI-D mark

INSTALLATION SERVICE POINT

▶◀ MARK INSTALLATION

(1) GRADE MARK

<COMFORT, SPORT, ADVANCE, FAMILY>

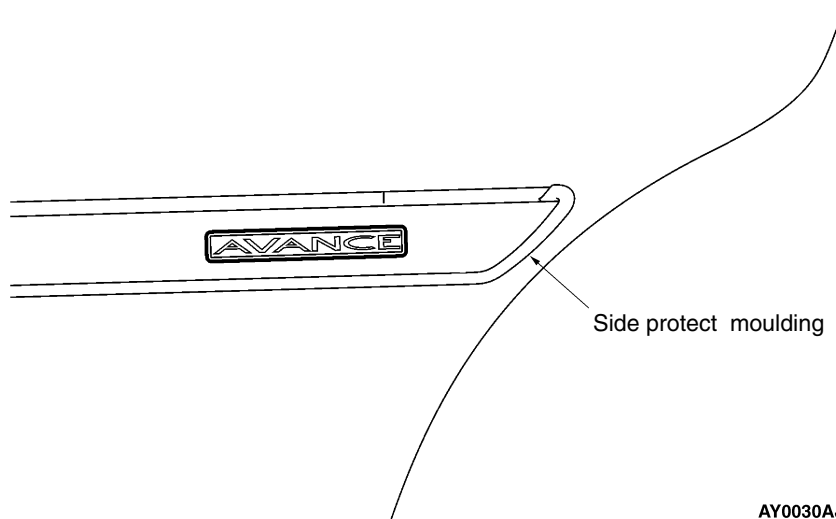

AY0030AJ

(2) GDI OR DI-D MARK

<GDI MARK>

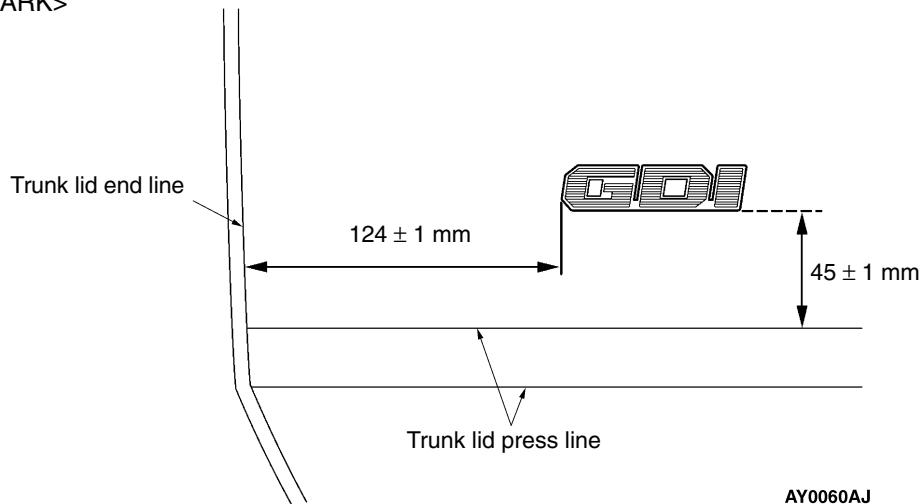

<DI-D MARK>

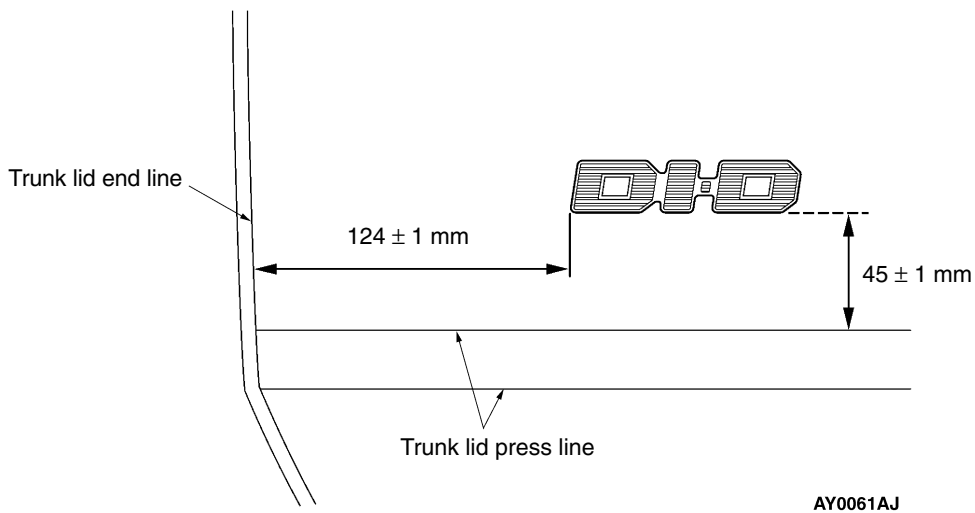

1. Clean the mark installation surfaces on the body with unleaded petrol.
2. Peel off the backing paper from the reverse side of the marks, and then attach the marks to the vehicle body so that they fit properly into position.

Caution

When attaching the marks, the surrounding temperature should be 20 – 38°C and the air should be completely free from dust.

If the surrounding temperature is lower than 20°C, the marks and the places on the body where the marks are to be attached should be heated to 20 – 38°C.