

ACCELERATOR CONTROL, FUEL & EXHAUST SYSTEMS

SECTION **FE**

CONTENTS

ACCELERATOR CONTROL SYSTEM2	Removal and Installation3
Removal and Installation2	FUEL PUMP AND GAUGE4
Adjusting Accelerator Wire2	EXHAUST SYSTEM6
FUEL SYSTEM3	Removal and Installation6

GI

MA

EM

LC

EC

FE

CL

MT

AT

AX

SU

BR

ST

RS

BT

HA

SC

EL

IDX

ACCELERATOR CONTROL SYSTEM

Removal and Installation

Removal and Installation

NCFE0002

CAUTION:

- When removing accelerator wire, make a mark to indicate lock nut's initial position.
- Check that throttle valve opens fully when accelerator pedal is fully depressed. Also check that it returns to idle position when pedal is released.
- Check accelerator control parts for improper contact with any adjacent parts.
- When connecting accelerator wire, be careful not to twist or scratch its inner wire.
- For adjustment of A/T throttle wire, refer to AT section ("Throttle Wire Adjustment", "ON-VEHICLE SERVICE").

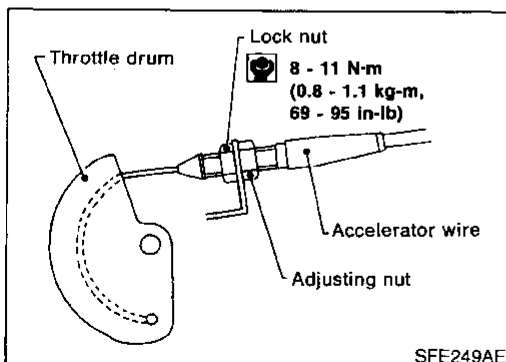
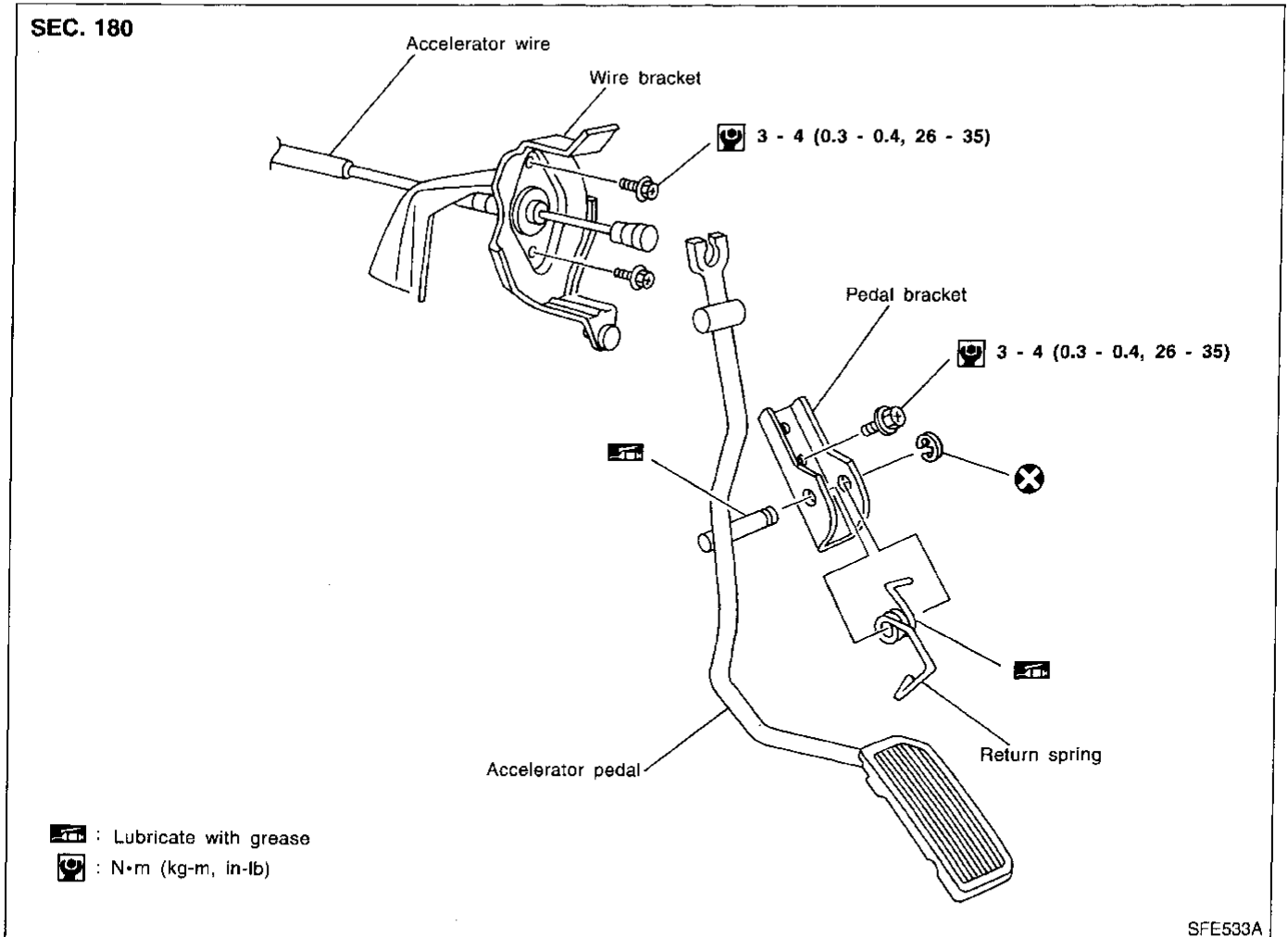

Adjusting Accelerator Wire

NCFE0003

CAUTION:

- Make sure the ASCD wire is not pulling the throttle drum.
 - For ASCD wire adjustment, refer to EL section ["AUTOMATIC SPEED CONTROL DEVICE (ASCD)"].
1. Loosen lock nut, and tighten adjusting nut until throttle drum starts to move.
 2. From that position turn back adjusting nut 1.5 to 2 turns, and secure lock nut.

Removal and Installation

NCFE0004

WARNING:

When replacing fuel line parts, be sure to observe the following:

- Put a "CAUTION: INFLAMMABLE" sign in workshop. GI
- Do not smoke while servicing fuel system. Keep open flames and sparks away from work area. MA
- Be sure to furnish the workshop with a CO₂ fire extinguisher. EM

CAUTION:

- Before removing fuel line parts, carry out the following procedures: LC
 - a) Put drained fuel in an explosion-proof container and put lid on securely. EC
 - b) Release fuel pressure from fuel line. Refer to MA section ("Changing Fuel Filter"). FE
 - c) Disconnect battery ground cable.
- Always replace O-ring with new ones. CL
- Do not kink or twist hose and tube when they are installed. MT
- Do not tighten hose clamps excessively to avoid damaging hoses. AT
- After installation, run engine and check for fuel leaks at connections. AX

AT

AX

SU

BR

ST

RS

BT

HA

SC

EL

IDX

FUEL SYSTEM

Removal and Installation (Cont'd)

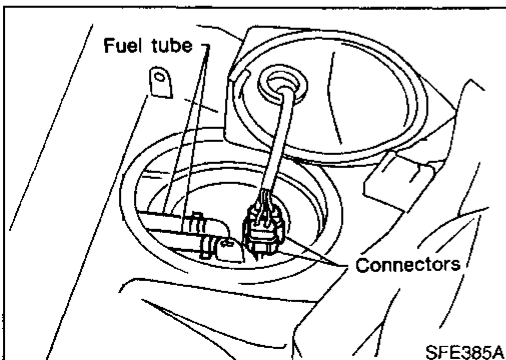
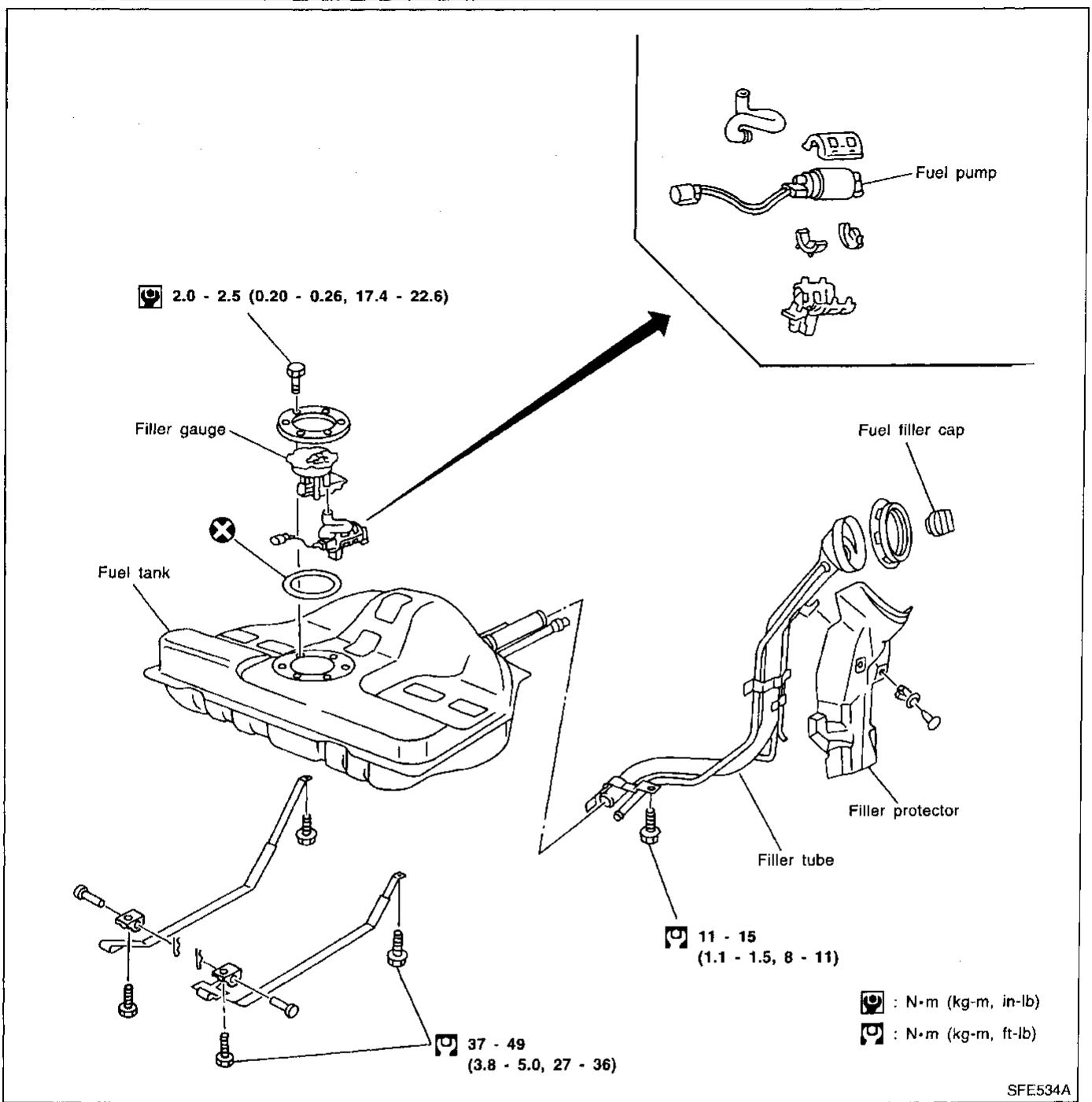

FUEL PUMP AND GAUGE

Removal

1. Release fuel pressure.
Refer to EC section ("Fuel Pressure Release", "BASIC SERVICE PROCEDURE").
2. Remove rear seat back and bottom. Refer to BT section.
3. Remove inspection hole cover located under the rear seat.
4. Disconnect fuel tubes and electrical connectors.
5. Remove the six screws.

NCFE0004S02

NCFE0004S0201

FUEL SYSTEM

Removal and Installation (Cont'd)

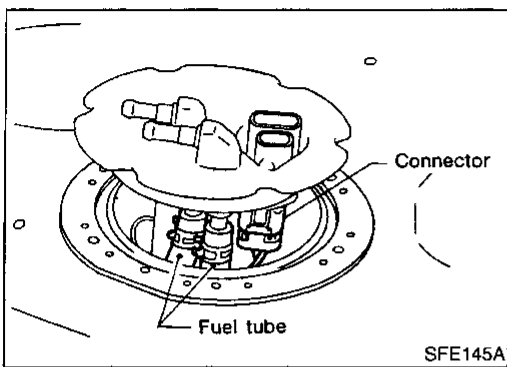

6. Disconnect fuel tubes and connector, then remove fuel gauge assembly.

7. Remove fuel pump with chamber.
 - a. Pull up the front of the chamber.
 - b. Slide chamber forward.
8. Remove fuel pump from chamber.

Installation

To install, reverse the removal procedure.

NCFE0004S0202

CAUTION:

- Tighten bolts to specified torque.
 - ☑ : 2.0 - 2.5 N·m (0.20 - 0.26 kg-m, 17.4 - 22.6 in-lb)
- Always replace O-ring with a new one.
- After installation, run engine and check for leaks at connections.

GI

MA

EM

LC

EC

FE

CL

MT

AT

AX

SU

BR

ST

RS

BT

HA

SC

EL

IDX

EXHAUST SYSTEM

Removal and Installation

Removal and Installation

NCFE0005

CAUTION:

- Always replace exhaust gaskets with new ones when reassembling.
- With engine running, check all tube connections for exhaust gas leaks, and entire system for unusual noises.
- Check to ensure that mounting brackets and mounting insulators are installed properly and free from undue stress. Improper installation could result in excessive noise or vibration.
- Discard any heated oxygen sensor which has been dropped from a height of more than 0.5 m (19.7 in) onto a hard surface such as a concrete floor; use a new one.
- Do not overtorque the oxygen sensor. Doing so may cause damage to the oxygen sensor, resulting in the MIL coming on.

EXHAUST SYSTEM

Removal and Installation (Cont'd)

SEC. 200-208

GI

MA

EM

LC

EC

FE

CL

MT

AT

AX

SU

BR

ST

RS

BT

HA

SC

EL

IDX

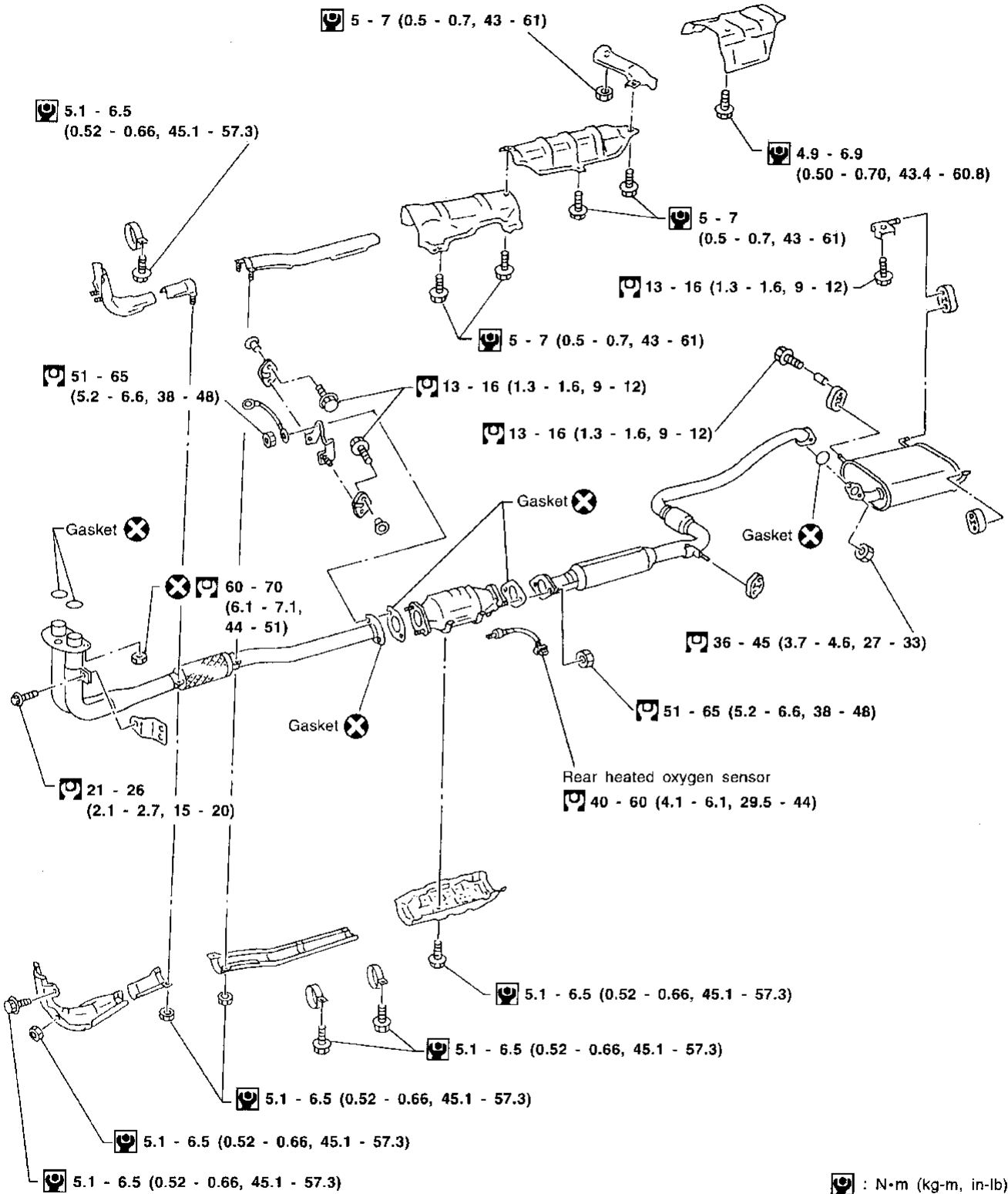

: N·m (kg-m, in-lb)

: N·m (kg-m, ft-lb)

SFE535A