

SECTION **ACC**  
ACCELERATOR CONTROL SYSTEM

A  
ACC  
C  
D  
E  
F  
G  
H  
I  
J  
K  
L  
M

CONTENTS

<b>ACCELERATOR CONTROL SYSTEM</b> .....	2	<b>SERVICE DATA AND SPECIFICATIONS (SDS)</b> .....	4
Removal and Installation .....	2	Tightening Torque .....	4
QG AND QR ENGINE MODELS .....	2		
YD ENGINE MODELS .....	2		
REMOVAL .....	2		
INSTALLATION .....	3		
INSPECTION AFTER INSTALLATION .....	3		

# ACCELERATOR CONTROL SYSTEM

PFP:18005

EBS00GVK

## ACCELERATOR CONTROL SYSTEM

### Removal and Installation QG AND QR ENGINE MODELS

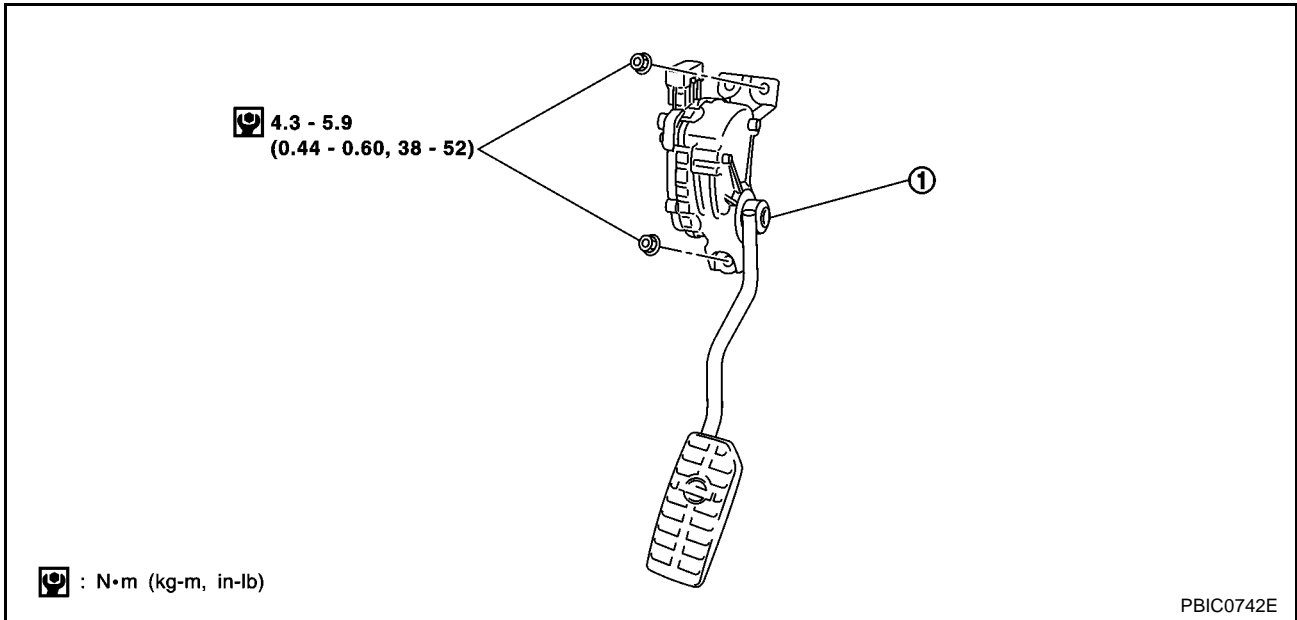

### YD ENGINE MODELS

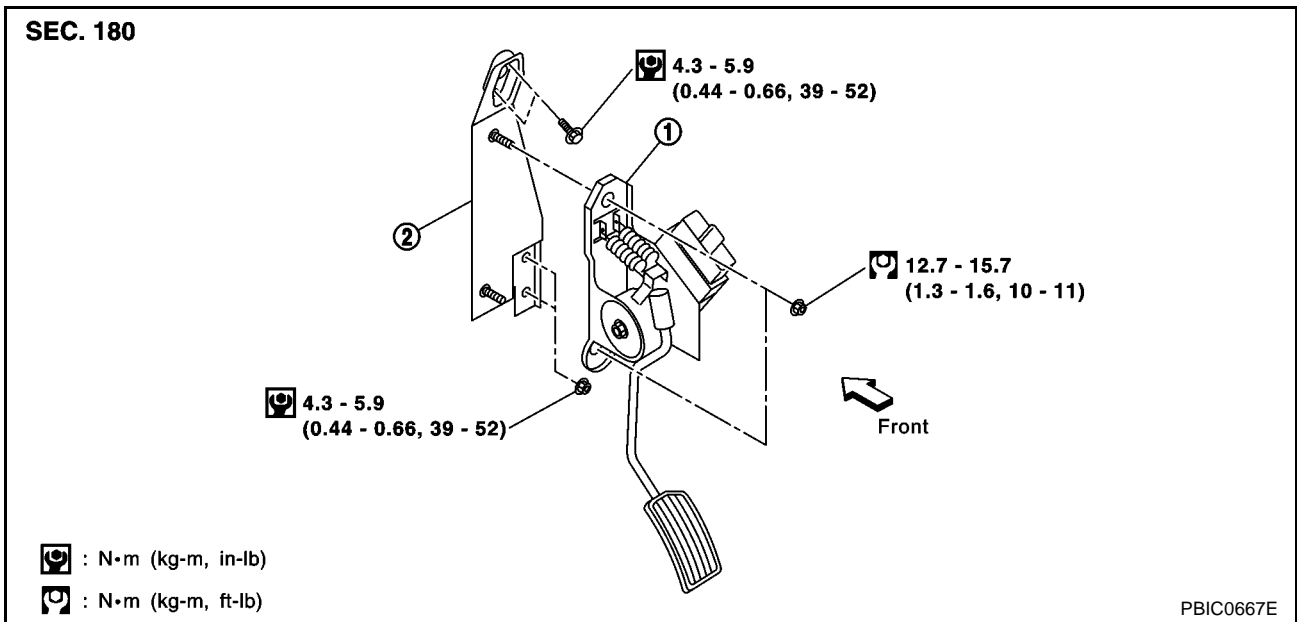

### REMOVAL

1. Remove harness connector.
2. Loosen nuts, and remove accelerator pedal assembly.

#### CAUTION:

- Do not disassemble the accelerator pedal assembly. Do not remove the sensors and the switches from the assembly.
- Avoid impact from dropping etc. during handling.

# ACCELERATOR CONTROL SYSTEM

- Be careful to keep the assembly away from water.
- Do not adjust the adjusting screw (painted white) of the accelerator work unit. (YD engine models)
- When the harness connector of the accelerator sensor is disconnected, perform "Accelerator Pedal Released Position Learning". Refer to "Basic Service Procedure" in EC section.

A

ACC

## INSTALLATION

Install in the reverse order of removal.

## INSPECTION AFTER INSTALLATION

- Check that the accelerator pedal moves smoothly within the whole operation range.
- Check that the accelerator pedal securely returns to the original position.
- For the electrical inspection of the accelerator pedal assembly, refer to [EC-324, "DTC P0226 APP SENSOR"](#) (QG engine models WITH EURO-OBD), [EC-735, "DTC P0226 APP SENSOR"](#) (QG engine models WITHOUT EURO-OBD), [EC-1181, "DTC P0226 APP SENSOR"](#) (QR engine models WITH EURO-OBD), [EC-1537, "DTC P0226 APP SENSOR"](#) (QR engine models WITHOUT EURO-OBD).
- For the electrical inspection of the accelerator work unit, refer to [EC-1802, "DTC P0120 ACCELERATOR PEDAL POSITION SENSOR"](#) . (YD engine models)
- Check that the drum of the accelerator work unit can be fully opened. (YD engine models)

C

D

E

F

G

H

I

J

K

L

M

# SERVICE DATA AND SPECIFICATIONS (SDS)

## SERVICE DATA AND SPECIFICATIONS (SDS)

PFP:00030

### Tightening Torque

EBS00GVL

Unit: N·m (Kg·m, in·lb)

Accelerator pedal assembly (work unit) (QG and QR engine models)	4.3 - 5.9 (0.44 - 0.60, 39 - 52)
Accelerator pedal assembly (work unit) (YD engine models)	12.7 - 15.7 (1.3 - 1.6 ,10 - 11)
Accelerator pedal bracket (YD engine models)	4.3 - 5.9 (0.44 - 0.60, 39 - 52)