

SECTION **PB**
PARKING BRAKE SYSTEM

A
B
C
D
E
PB
G
H
I
J
K
L
M

CONTENTS

NOISE, VIBRATION, AND HARSHNESS (NVH)		
TROUBLESHOOTING	2	
NVH Troubleshooting Chart	2	
PARKING BRAKE CONTROL	3	
Components	3	
		Removal and Installation
		Inspection
		Adjustment
		SERVICE DATA AND SPECIFICATIONS (SDS)
		Parking Brake

PARKING BRAKE CONTROL

PARKING BRAKE CONTROL

PFP:36010

Components

EFS001GA

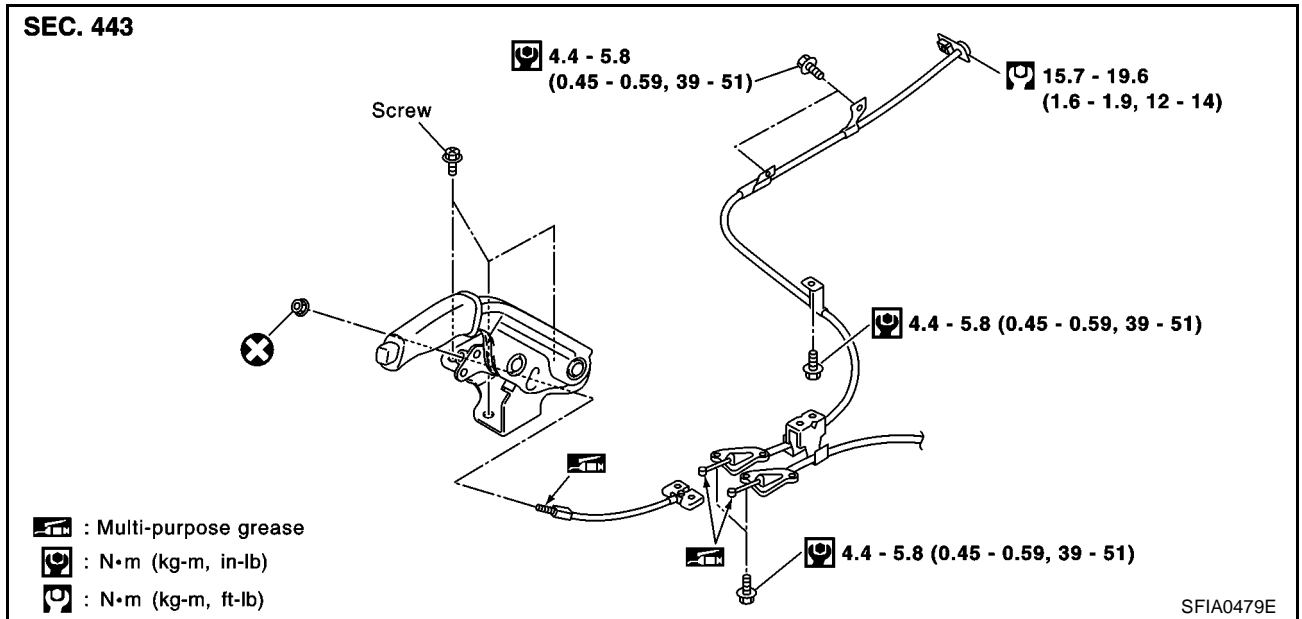

Removal and Installation

EFS001GB

1. Remove center console.
2. Disconnect warning lamp switch connector.
3. Remove cable mounting bolt. Loosen cable and remove self-locking nut.
4. Remove cable from toggle lever of disc brake.

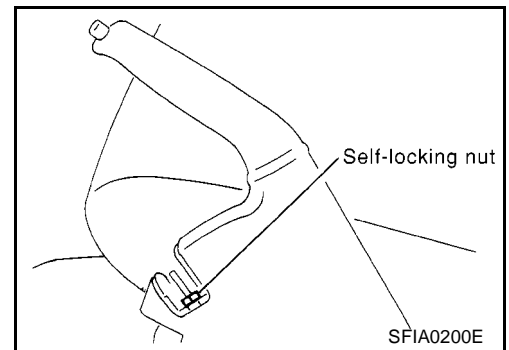

Inspection

EFS001GC

- Operate parking brake lever with a force of 196 N (20 kg, 44 lb). Check stroke is within specified number of notches. (Check it by hearing clicks of ratchet.)

Lever stroke : 7 - 8 notches

- Check parking lever assembly for bend, damage and cracks, and replace if necessary.
- Check cables and equalizer for wear and damage. If a malfunction is detected, replace applicable part.
- Check parking brake warning lamp switch. If a malfunction is detected, replace applicable part.
- Check each part for deformation, or damage by contact with other parts. If a malfunction is detected, replace applicable part.

PARKING BRAKE CONTROL

Adjustment

EFS001GD

1. Insert a deep-well socket wrench into opening of parking brake lever. Rotate self-locking nut to fully loosen cable. Return parking brake lever and adjust rear brake shoe clearance.

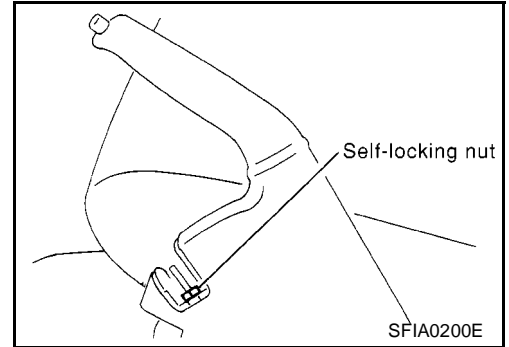

2. Rotate road wheels to be sure that there is no drag.
3. After adjusting clearance of rear shoes, with no drag on rear brake, adjust cable as follows:
 - a. Pull parking brake lever up so that a deep-well socket wrench can be inserted.
 - b. Insert a deep-well socket wrench into opening of parking brake lever. Rotate self-locking nut to adjust lever stroke.

CAUTION:

Do not reuse self-locking nut after removing it.

- c. Operate parking brake lever 3 to 4 times with a force of 196 N (20 kg, 44 lb). Be sure lever stroke is within the specified number of notches.
- d. Return parking brake lever completely. Be sure there is no drag on rear brake.

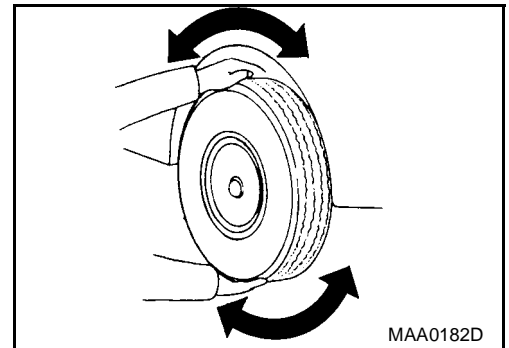

SERVICE DATA AND SPECIFICATIONS (SDS)

SERVICE DATA AND SPECIFICATIONS (SDS)

PFP:00030

Parking Brake

EFS001GG

Lever stroke [operating force 196 N (20 kg,44 lb)]	7 to 8 notches
Total stroke	18 notches
Brake warning lamp stroke	Within 1 notch

A
B
C
D
E
PB
G
H
I
J
K
L
M

SERVICE DATA AND SPECIFICATIONS (SDS)
