

SECTION **SR**
SRS AIRBAG

A
B
C
D
E
F
G
SR
I
J
K
L
M
N
O
P

CONTENTS

FOR USA AND CANADA

PRECAUTION	3	Exploded View	18
PRECAUTIONS	3	Removal and Installation	18
Precaution for Supplemental Restraint System (SRS) "AIR BAG" and "SEAT BELT PRE-TENSIONER"	3	FRONT SEAT BELT PRE-TENSIONER	20
Service	3	Removal and Installation	20
Occupant Classification System	3	OCCUPANT CLASSIFICATION SYSTEM CONTROL UNIT	21
PREPARATION	4	Removal and Installation	21
PREPARATION	4	FOR MEXICO	
Commercial Service Tools	4	PRECAUTION	22
ON-VEHICLE REPAIR	5	PRECAUTIONS	22
DRIVER AIR BAG MODULE	5	Precaution for Supplemental Restraint System (SRS) "AIR BAG" and "SEAT BELT PRE-TENSIONER"	22
Exploded View	5	Service	22
Removal and Installation	5	PREPARATION	23
SPIRAL CABLE	8	PREPARATION	23
Exploded View	8	Commercial Service Tools	23
Removal and Installation	8	ON-VEHICLE REPAIR	24
FRONT PASSENGER AIR BAG MODULE	10	DRIVER AIR BAG MODULE	24
Exploded View	10	Exploded View	24
Removal and Installation	10	Removal and Installation	24
SIDE CURTAIN AIR BAG MODULE	12	SPIRAL CABLE	27
Exploded View	12	Exploded View	27
Removal and Installation	12	Removal and Installation	27
CRASH ZONE SENSOR	14	FRONT PASSENGER AIR BAG MODULE	29
Exploded View	14	Exploded View	29
Removal and Installation	14	Removal and Installation	29
SIDE AIR BAG (SATELLITE) SENSOR	16	SIDE CURTAIN AIR BAG MODULE	31
Exploded View	16	Exploded View	31
Removal and Installation	16	Removal and Installation	31
DIAGNOSIS SENSOR UNIT	18	CRASH ZONE SENSOR	33

Exploded View	33	DIAGNOSIS SENSOR UNIT	37
Removal and Installation	33	Exploded View	37
SIDE AIR BAG (SATELLITE) SENSOR	35	Removal and Installation	37
Exploded View	35	FRONT SEAT BELT PRE-TENSIONER	39
Removal and Installation	35	Removal and Installation	39

PRECAUTION

PRECAUTIONS

Precaution for Supplemental Restraint System (SRS) "AIR BAG" and "SEAT BELT PRE-TENSIONER"

INFOID:000000004235316

The Supplemental Restraint System such as "AIR BAG" and "SEAT BELT PRE-TENSIONER", used along with a front seat belt, helps to reduce the risk or severity of injury to the driver and front passenger for certain types of collision. This system includes seat belt switch inputs and dual stage front air bag modules. The SRS system uses the seat belt switches to determine the front air bag deployment, and may only deploy one front air bag, depending on the severity of a collision and whether the front occupants are belted or unbelted. Information necessary to service the system safely is included in the "SRS AIRBAG" and "SEAT BELT" of this Service Manual.

WARNING:

- To avoid rendering the SRS inoperative, which could increase the risk of personal injury or death in the event of a collision which would result in air bag inflation, all maintenance must be performed by an authorized NISSAN/INFINITI dealer.
- Improper maintenance, including incorrect removal and installation of the SRS, can lead to personal injury caused by unintentional activation of the system. For removal of Spiral Cable and Air Bag Module, see the "SRS AIRBAG".
- Never use electrical test equipment on any circuit related to the SRS unless instructed to in this Service Manual. SRS wiring harnesses can be identified by yellow and/or orange harnesses or harness connectors.

Service

INFOID:000000004678891

- Never use electrical test equipment to check SRS circuits unless instructed to in this Service Manual.
- Before servicing the SRS, turn ignition switch OFF, disconnect battery negative terminal and wait at least 3 minutes.
For approximately 3 minutes after the cables are removed, it is still possible for the air bag and seat belt pretensioner to deploy. Therefore, never work on any SRS connectors or wires until at least 3 minutes have elapsed.
- Diagnosis sensor unit must always be installed with their arrow marks "⇐" pointing towards the front of the vehicle for proper operation. Also check diagnosis sensor unit for cracks, deformities or rust before installation and replace as required.
- The spiral cable must be aligned in the neutral position since its rotations are limited. Never turn steering wheel and column after removal of steering gear.
- Handle air bag module carefully. Always place driver and front passenger air bag modules with the pad side facing upward and seat mounted front side air bag module standing with the stud bolt side facing down.
- Conduct self-diagnosis to check entire SRS for proper functioning after replacing any components.
- After air bag inflates, the front instrument panel assembly should be replaced if damaged.
- Always replace instrument panel pad following front passenger air bag deployment.

Occupant Classification System

INFOID:000000004235318

- Replace occupant classification system control unit and passenger front seat cushion as an assembly. Refer to [SE-27, "Removal and Installation"](#).

A
B
C
D
E
F
G
SR
I
J
K
L
M
N
O
P

PREPARATION

PREPARATION

Commercial Service Tools

INFOID:000000004235319

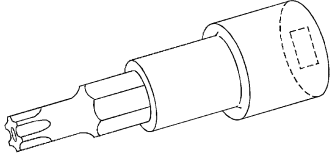
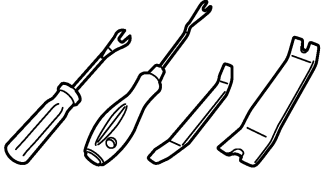
Tool name	Description
<p data-bbox="183 520 451 546">Tamper resistant TORX bit</p>  <p data-bbox="841 632 899 646">S-NT757</p>	<p data-bbox="987 520 1304 546">Removes driver air bag module</p>
<p data-bbox="183 772 321 798">Remover tool</p>  <p data-bbox="841 884 932 898">JMKIA3050ZZ</p>	<p data-bbox="987 772 1369 798">Removes clips, pawls, and metal clips</p>

ON-VEHICLE REPAIR

DRIVER AIR BAG MODULE

Exploded View

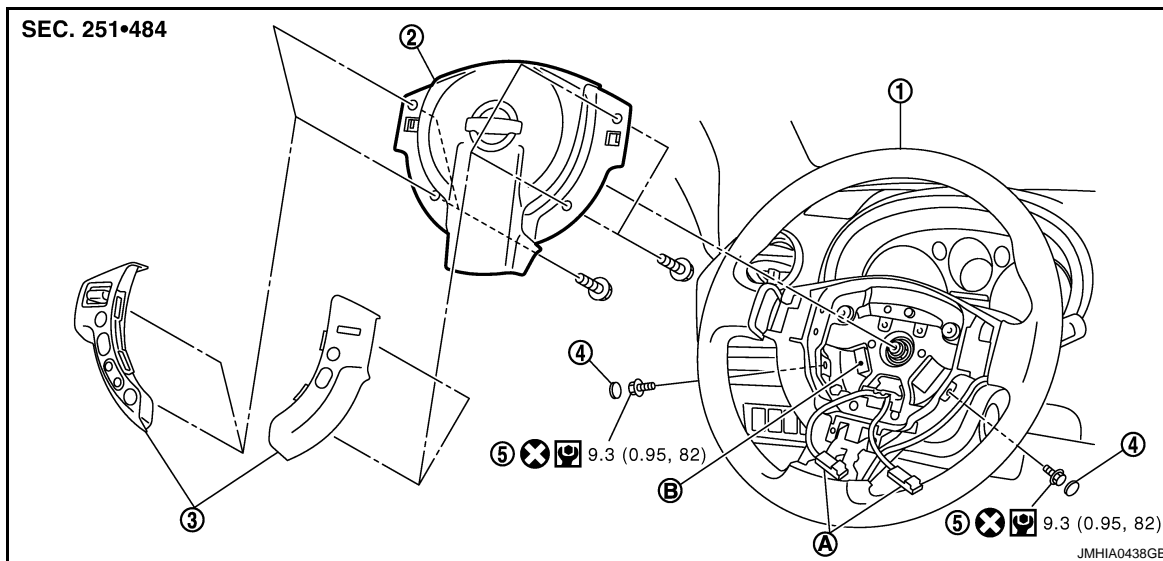

- | | | |
|--------------------------------------|----------------------------------|--------------------|
| 1. Steering wheel | 2. Driver air bag module | 3. Steering switch |
| 4. Side lid (LH/RH) | 5. TORX bolt (LH/RH) | |
| A. Driver air bag harness connectors | B. Horn switch harness connector | |

Refer to [Gl-4. "Components"](#) for symbols in the figure.

Removal and Installation

INFOID:000000004235321

WARNING:

- Before servicing, turn ignition switch OFF, disconnect the battery negative terminal and wait at least 3 minutes.
- Always work from the side of driver air bag module. Never work in front of it.
- Never use the air tools or electric tools for servicing.

REMOVAL

1. Remove the side lids (LH/RH).
2. Remove the driver air bag module mounting TORX bolt (LH/RH) with TORX bit (A).

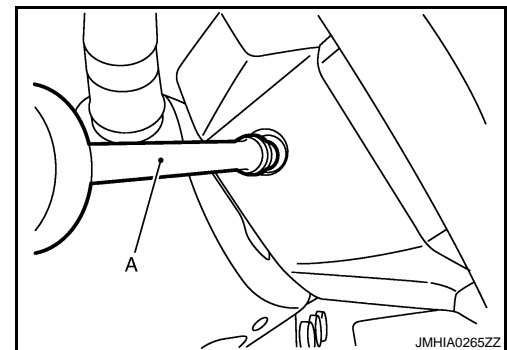

3. Pull out the driver air bag module assembly.

DRIVER AIR BAG MODULE

< ON-VEHICLE REPAIR >

[FOR USA AND CANADA]

4. Disconnect the driver air bag harness connector.

NOTE:

- For installing/removing the driver air bag harness connector, insert thin screwdriver wrapped in tape into notch, lift lock and remove the connector.
- Install the connector with lock raised, and push lock into the connector.
- After installing the connector, check that the lock is pushed securely into it.

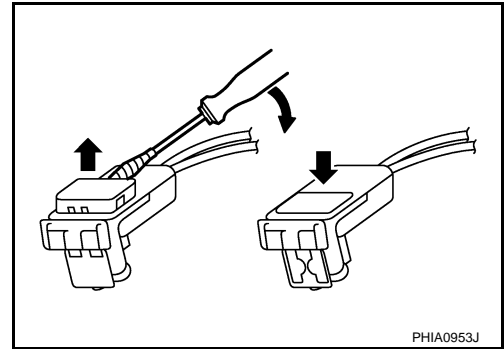

5. Remove the driver air bag module.

CAUTION:

- Always place the driver air bag module with pad side facing upward.

↶ : Upward

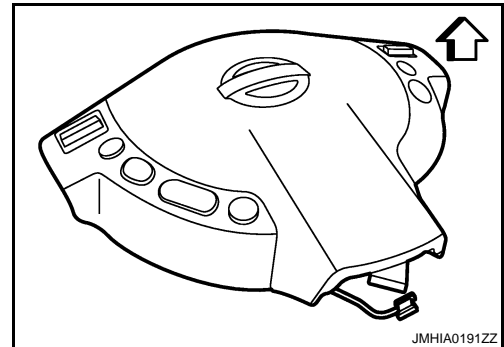

- Never impact the driver air bag module.
- Replace the driver air bag module if it has been dropped or sustained an impact.



- Never insert any foreign objects (screwdriver, etc.) into the driver air bag module.
- Never disassemble the driver air bag module.
- Never expose the driver air bag module to temperatures exceeding 90°C (194°F).
- Never allow oil, grease, detergent, or water to come in contact with the driver air bag module.

INSTALLATION

Install in the reverse order of removal.

CAUTION:

- Never use the old TORX bolts after removal, replace with the new bolts.
- Fix the driver air bag module harness to the harness fixing hook (A).

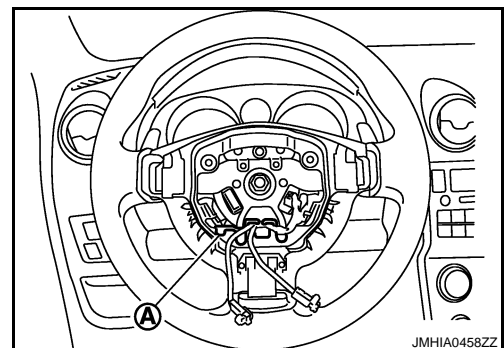

DRIVER AIR BAG MODULE

< ON-VEHICLE REPAIR >

[FOR USA AND CANADA]

- Never damage the harness while installing.
- Tighten the TORX bolts after completely adjusting the centers of fixing holes on the driver air bag module side and the steering wheel side. If the holes are misaligned, the bolt threads are damaged and the module is not installed securely.
- If malfunction is detected by the air bag warning lamp, after repair or replacement of the malfunctioning parts, reset the memory using self-diagnosis or CONSULT-III. Refer to [SRC-18, "Diagnosis Description"](#).
- After the work is completed, check that no system malfunction is detected by air bag warning lamp.

A

B

C

D

E

F

G

SR

I

J

K

L

M

N

O

P

SPIRAL CABLE

< ON-VEHICLE REPAIR >

[FOR USA AND CANADA]

SPIRAL CABLE

Exploded View

INFOID:000000004235322

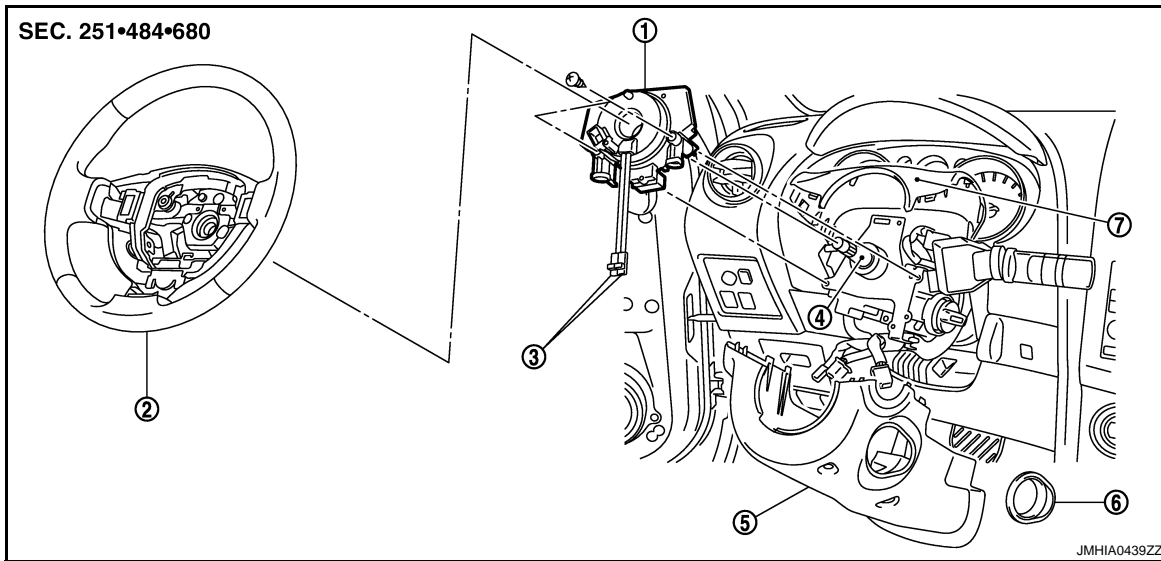

- | | | |
|----------------------------------|----------------------------------|--------------------------------------|
| 1. Spiral cable | 2. Steering wheel | 3. Driver air bag harness connectors |
| 4. Steering column assembly | 5. Steering column cover (lower) | 6. Steering lock escutcheon |
| 7. Steering column cover (upper) | | |

Removal and Installation

INFOID:000000004235323

WARNING:

- Before servicing, turn ignition switch OFF, disconnect the battery negative terminal and wait at least 3 minutes.
- Never use the air tools or electric tools for servicing.

REMOVAL

1. Remove the driver air bag module. Refer to [SR-5, "Removal and Installation"](#).
2. Remove the steering wheel. Refer to [ST-10, "Removal and Installation"](#).
3. Remove the steering column cover (upper/lower). Refer to [IP-12, "Exploded View"](#).
4. Disconnect the spiral cable body side harness connectors (A).

NOTE:

Disconnect the spiral cable body side harness connector after removing the spiral cable.

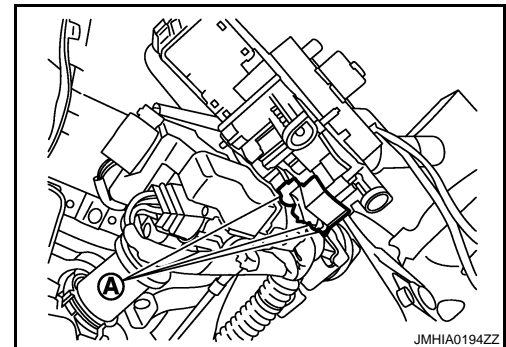

5. Remove the spiral cable fixing screws.
6. Pull out forward the spiral cable.

CAUTION:

SPIRAL CABLE

< ON-VEHICLE REPAIR >

[FOR USA AND CANADA]

- Never impact the spiral cable.
- Replace the spiral cable if it has been dropped or sustained an impact.



- Never disassemble the spiral cable.
- Never apply lubricant to the spiral cable.
- Never allow oil, grease, detergent, or water to come in contact with the spiral cable.

INSTALLATION

Install in the reverse order of removal.

CAUTION:

- The spiral cable may snap during steering operation if the cable is installed in an improper position. The neutral position is set as follows.
- Turn carefully the spiral cable clockwise to the end position. Then turn it counterclockwise (about 2 and a half turns) and stop turning at the point (B) on which the stopper insertion holes are in the same position.
- The service part is installed in the neutral position by the stopper and can be set without adjusting after the stopper is removed.
- Never over turn the spiral cable or go beyond number of turns required. (These will cause the cable to snap.)
- Adjust the spiral cable locating pin (A) to the steering wheel locating pin hole (C).

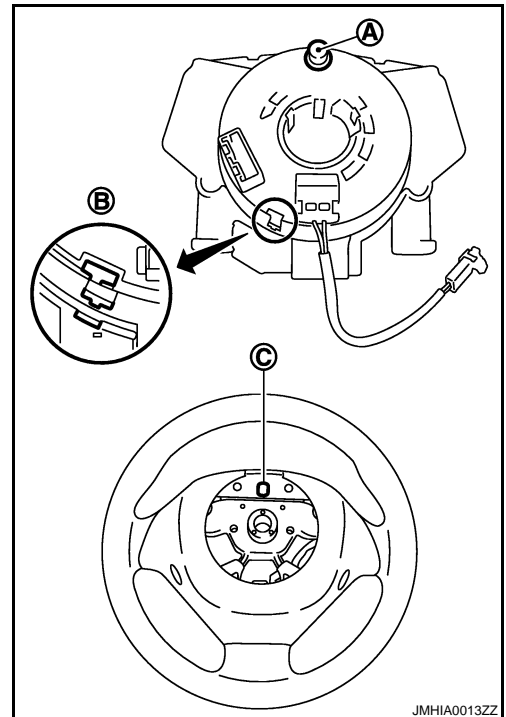

- If malfunction is detected by the air bag warning lamp, after repair or replacement of the malfunctioning parts, reset the memory using self-diagnosis or CONSULT-III. Refer to [SRC-18, "Diagnosis Description"](#).
- After the work is completed, check that no system malfunction is detected by air bag warning lamp.

FRONT PASSENGER AIR BAG MODULE

< ON-VEHICLE REPAIR >

[FOR USA AND CANADA]

FRONT PASSENGER AIR BAG MODULE

Exploded View

INFOID:000000004235324

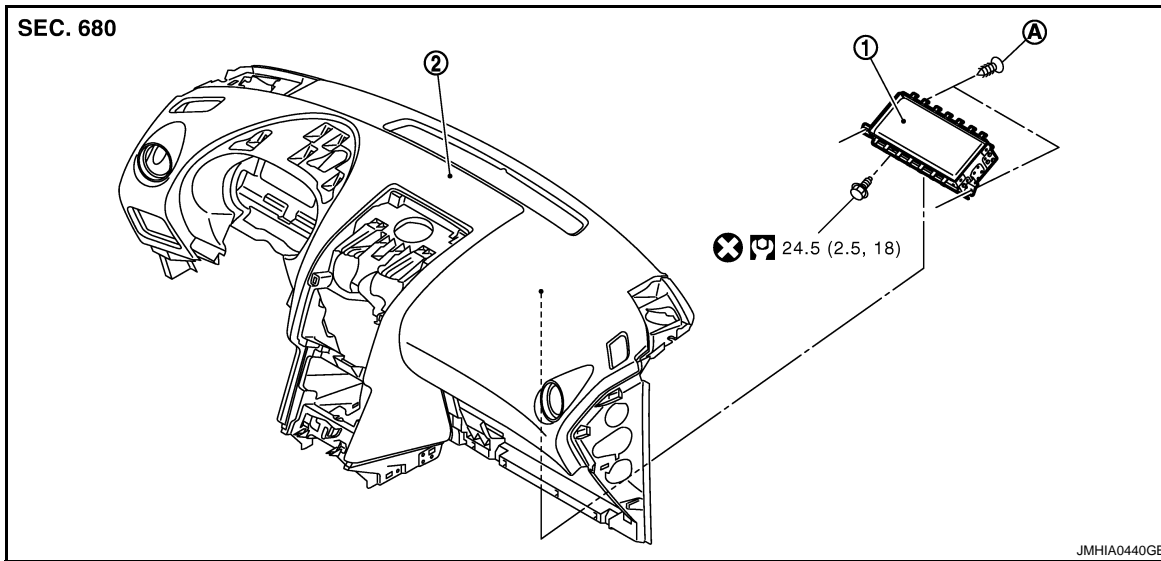

1. Passenger air bag module
 2. Instrument panel assembly
- A. Screws

Refer to [GI-4, "Components"](#) for symbols in the figure.

Removal and Installation

INFOID:000000004235325

WARNING:

- Before servicing, turn ignition switch OFF, disconnect the battery negative terminal and wait at least 3 minutes.
- Always work from the side of passenger air bag module. Never work in front of it.
- Never use the air tools or electric tools for servicing.

REMOVAL

1. Remove the glove box lid assembly. Refer to [IP-13, "Removal and Installation"](#).
2. Remove the Instrument lower assist panel. Refer to [IP-13, "Removal and Installation"](#).
3. Disconnect the passenger air bag harness connector (A).
4. Remove the passenger air bag module fixing bolt (B).

NOTE:

The figure shows the installed front passenger air bag module. (Under view of the module installed without glove box cover.)

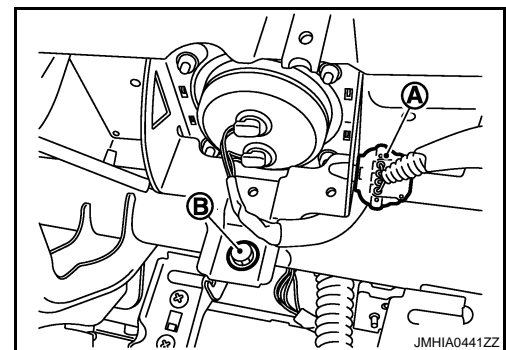

FRONT PASSENGER AIR BAG MODULE

[FOR USA AND CANADA]

< ON-VEHICLE REPAIR >

5. Remove the instrument panel assembly (2).
6. Remove the passenger air bag module fixing screws (C).
7. Disconnect the fixing pawls (B) by using remover tool (A), and then remove the passenger air bag module (1) from instrument panel.

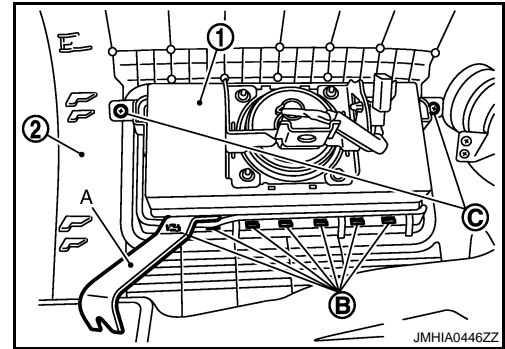

CAUTION:

- Always place the passenger air bag module with pad side facing upward.

↕ : Upward

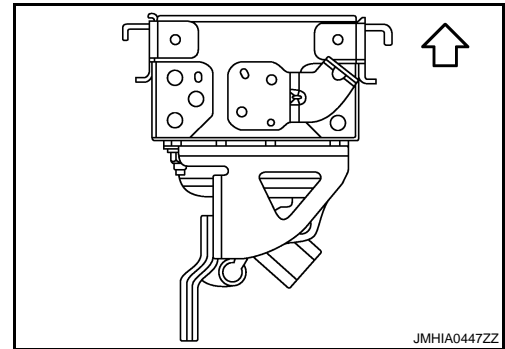

- Never impact the passenger air bag module.
- Replace the passenger air bag module if it has been dropped or sustained an impact.



- Never insert any foreign objects (screwdriver, etc.) into the passenger air bag module.
- Never disassemble the passenger air bag module.
- Never expose the passenger air bag module to temperatures exceeding 90°C (194°F).
- Never allow oil, grease, detergent, or water to come in contact with the passenger air bag module.

INSTALLATION

Install in the reverse order of removal.

CAUTION:

- Never use the old fixing bolts after removal, replace with the new bolts.
- Never damage the harness while installing.
- If malfunction is detected by the air bag warning lamp, after repair or replacement of the malfunctioning parts, reset the memory using self-diagnosis or CONSULT-III. Refer to [SRC-18, "Diagnosis Description"](#).
- After the work is completed, check that no system malfunction is detected by air bag warning lamp.

SIDE CURTAIN AIR BAG MODULE

< ON-VEHICLE REPAIR >

[FOR USA AND CANADA]

SIDE CURTAIN AIR BAG MODULE

Exploded View

INFOID:000000004235326

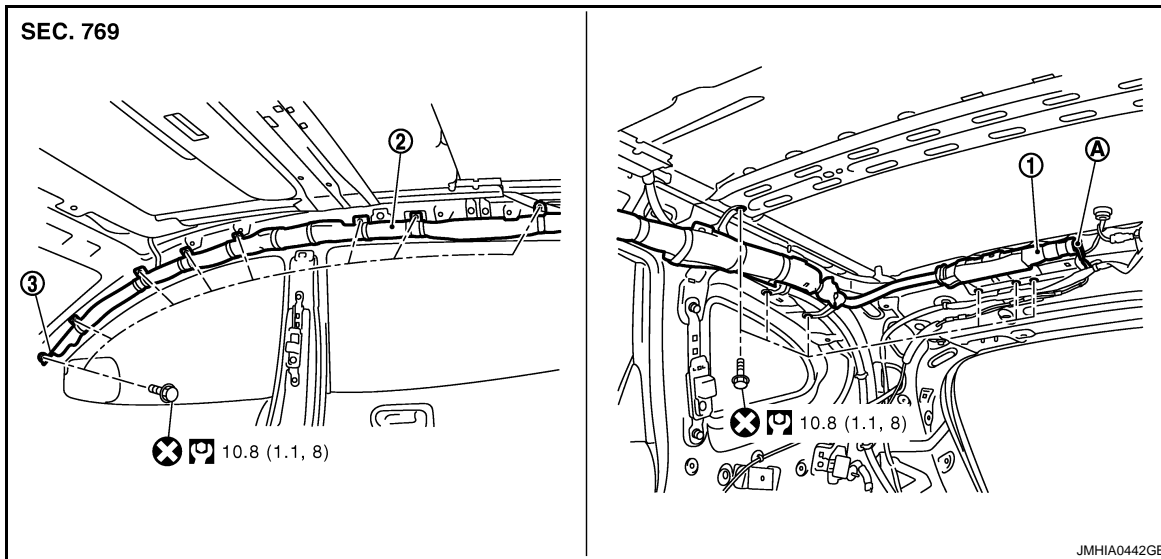

1. Side curtain air bag inflator
 2. Side curtain air bag
 3. Strap
- A. Side curtain air bag harness connector

Refer to [GI-4, "Components"](#) for symbols in the figure.

Removal and Installation

INFOID:000000004235327

WARNING:

- Before servicing, turn ignition switch OFF, disconnect the battery negative terminal and wait at least 3 minutes.
- Never use the air tools or electric tools for servicing.

REMOVAL

1. Remove the headlining.
 - Normal roof models: Refer to [INT-23, "NORMAL ROOF : Removal and Installation"](#).
 - Sunroof models: Refer to [INT-26, "SUNROOF : Removal and Installation"](#).
2. Remove the side curtain air bag module harness connector.

NOTE:

- For installing/removing the side curtain air bag harness connector, insert thin screwdriver wrapped in tape into notch, lift lock and remove the connector.
- Install the connector with lock raised, and push lock into the connector.
- After installing the connector, check that the lock is pushed securely into it.

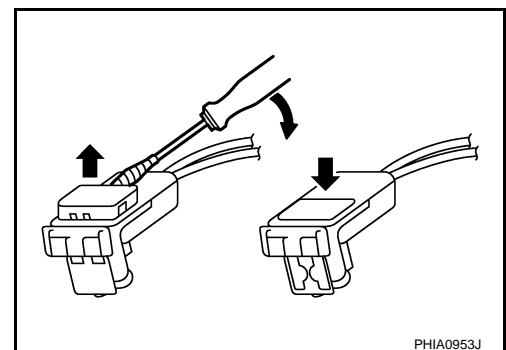

3. Remove the fixing bolts, and then remove the side curtain air bag module.

CAUTION:

- Never impact the side curtain air bag module.

SIDE CURTAIN AIR BAG MODULE

< ON-VEHICLE REPAIR >

[FOR USA AND CANADA]

- Replace the side curtain air bag module if it has been dropped or sustained an impact.



- Never insert any foreign objects (screwdriver, etc.) into the side curtain air bag module.
- Never disassemble the side curtain air bag module.
- Never expose the side curtain air bag module to temperatures exceeding 90 °C (194 °F).
- Never allow oil, grease, detergent, or water to come in contact with the side curtain air bag module.

INSTALLATION

Install in the reverse order of removal.

CAUTION:

- Never damage the harness while installing.
- If malfunction is detected by the air bag warning lamp, after repair or replacement of the malfunctioning parts, reset the memory using self-diagnosis or CONSULT-III. Refer to [SRC-18, "Diagnosis Description"](#).
- After the work is completed, check that no system malfunction is detected by air bag warning lamp.

A
B
C
D
E
F
G
SR
I
J
K
L
M
N
O
P

CRASH ZONE SENSOR

< ON-VEHICLE REPAIR >

[FOR USA AND CANADA]

CRASH ZONE SENSOR

Exploded View

INFOID:000000004235328

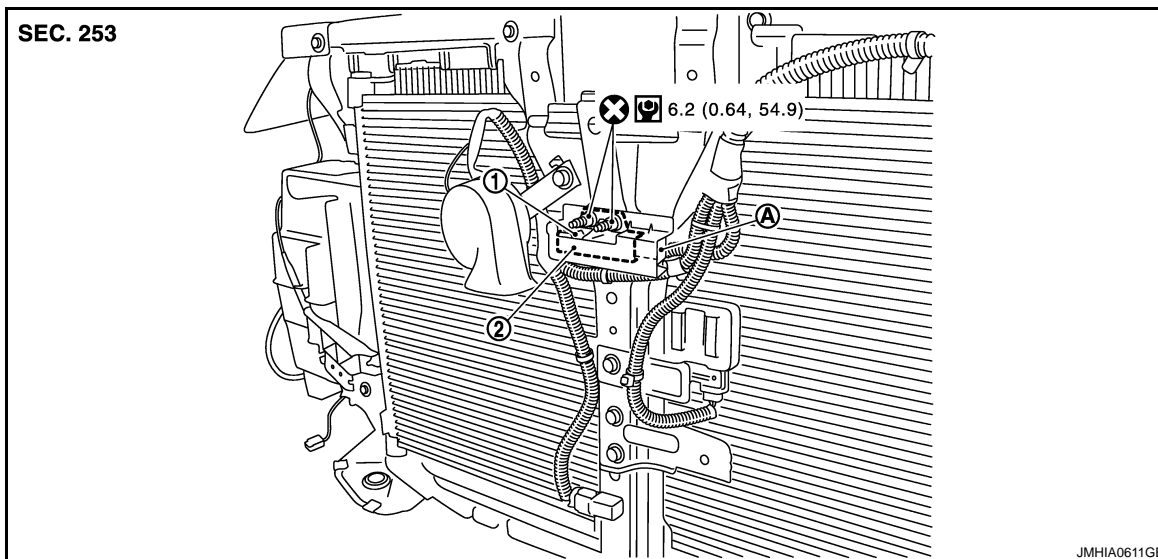

1. Crash zone sensor
2. Crash zone sensor cover
- A. Crash zone sensor harness connector

Refer to [GI-4, "Components"](#) for symbols in the figure.

Removal and Installation

INFOID:000000004235329

WARNING:

- Before servicing, turn ignition switch OFF, disconnect the battery negative terminal and wait at least 3 minutes.
- Never use the air tools or electric tools for servicing.

REMOVAL

1. Remove the front bumper upper clips. Refer to [EXT-13, "Exploded View"](#).
2. Remove the crash zone sensor fixing nuts.
3. Disconnect the crash zone sensor harness connector, and then remove the crash zone sensor.

CAUTION:

- Never impact the crash zone sensor.
- Replace the crash zone sensor if it has been dropped or sustained an impact.



- Replace the crash zone sensor of deployed SRS driver air bag and deployed SRS front passenger air bag.

INSTALLATION

Install in the reverse order of removal.

CAUTION:

- Never use the old fixing nuts after removal, replace with the new nuts.
- Never damage the harness while installing.

CRASH ZONE SENSOR

< ON-VEHICLE REPAIR >

[FOR USA AND CANADA]

- If malfunction is detected by the air bag warning lamp, after repair or replacement of the malfunctioning parts, reset the memory using self-diagnosis or CONSULT-III. Refer to [SRC-18, "Diagnosis Description"](#).
- After the work is completed, check that no system malfunction is detected by air bag warning lamp.

A
B
C
D
E
F
G
SR
I
J
K
L
M
N
O
P

SR

SIDE AIR BAG (SATELLITE) SENSOR

< ON-VEHICLE REPAIR >

[FOR USA AND CANADA]

SIDE AIR BAG (SATELLITE) SENSOR

Exploded View

INFOID:000000004235330

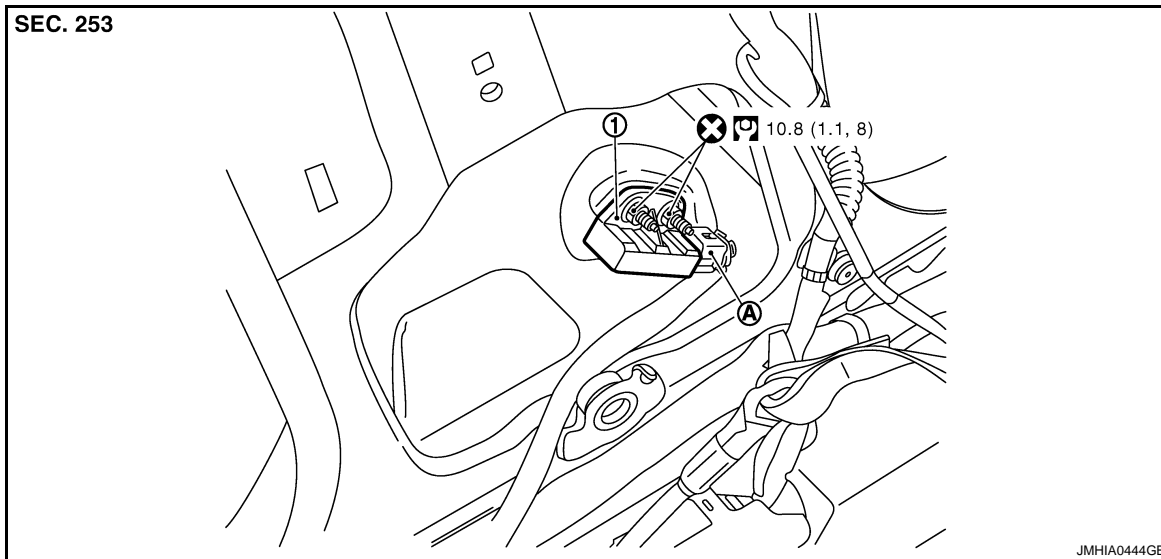

1. Satellite sensor
- A. Satellite sensor harness connector

Refer to [GI-4. "Components"](#) for symbols in the figure.

Removal and Installation

INFOID:000000004235331

WARNING:

- Before servicing, turn ignition switch OFF, disconnect the battery negative terminal and wait at least 3 minutes.
- Never use the air tools or electric tools for servicing.

REMOVAL

1. Remove the front seat belt. Refer to [SB-6. "SEAT BELT RETRACTOR : Removal and Installation"](#).
2. Remove the satellite sensor fixing nuts.
3. Disconnect the satellite sensor harness connector, and then remove the satellite sensor.

CAUTION:

- Never impact the satellite sensor.
- Replace the satellite sensor if it has been dropped or sustained an impact.



- Replace the satellite sensor of deployed SRS front side air bag module and deployed SRS side curtain air bag module.

INSTALLATION

Install in the reverse order of removal.

CAUTION:

- Never use the old fixing nuts after removal, replace with the new nuts.
- Never damage the harness while installing.

SIDE AIR BAG (SATELLITE) SENSOR

< ON-VEHICLE REPAIR >

[FOR USA AND CANADA]

- If malfunction is detected by the air bag warning lamp, after repair or replacement of the malfunctioning parts, reset the memory using self-diagnosis or CONSULT-III. Refer to [SRC-18, "Diagnosis Description"](#).
- After the work is completed, check that no system malfunction is detected by air bag warning lamp.

A
B
C
D
E
F
G
SR
I
J
K
L
M
N
O
P

SR

DIAGNOSIS SENSOR UNIT

< ON-VEHICLE REPAIR >

[FOR USA AND CANADA]

DIAGNOSIS SENSOR UNIT

Exploded View

INFOID:000000004235332

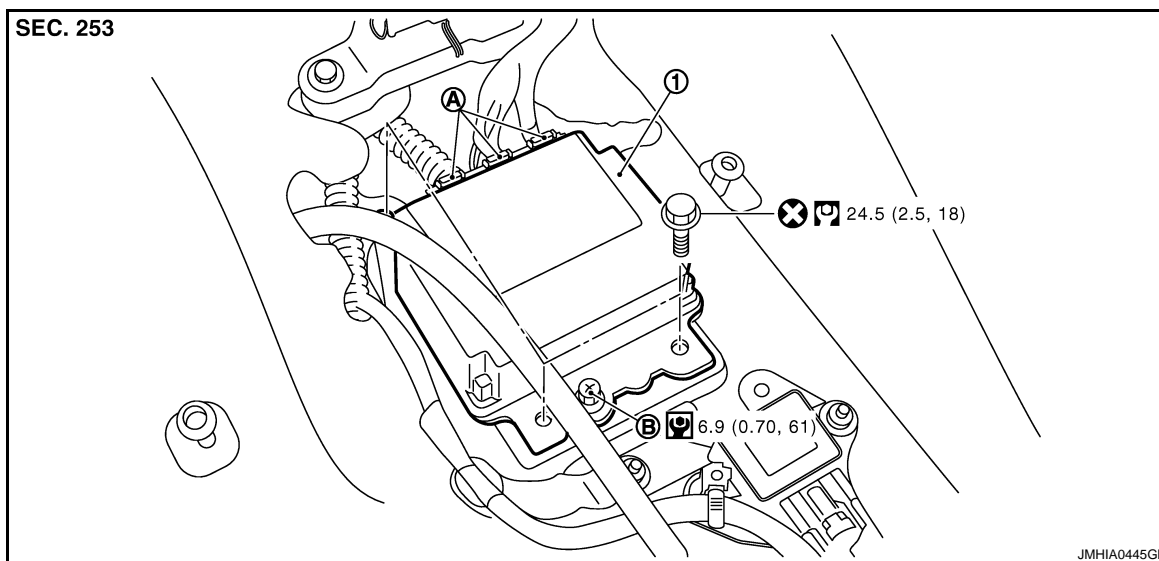

1. Diagnosis sensor unit
- A. Diagnosis sensor unit harness connectors
- B. Ground bolt

Refer to [GI-4, "Components"](#) for symbols in the figure.

Removal and Installation

INFOID:000000004235333

WARNING:

- Before servicing, turn ignition switch OFF, disconnect the battery negative terminal and wait at least 3 minutes.
- Before disconnecting the air bag sensor unit harness connector, be sure to disconnect the each harness connector of the air bag module and pre-tensioner seat belt to prevent air bag deployment by static electricity and pre-tensioner seat belt operation.
- Never use the air tools or electric tools for servicing.

REMOVAL

1. Disconnect the each connector of all air bag modules and pre-tensioner seat belts.
2. Remove the center console assembly. Refer to [IP-20, "Removal and Installation"](#).
3. Disconnect the diagnosis sensor unit harness connectors.
4. Remove the fixing bolts, ground bolt, and then remove the diagnosis sensor unit.

CAUTION:

- Never impact the diagnosis sensor unit.
- Replace the diagnosis sensor unit if it has been dropped or sustained an impact.



- Replace the diagnosis sensor unit of deployed SRS air bag and deployed SRS front seat belt pre-tensioner.

DIAGNOSIS SENSOR UNIT

< ON-VEHICLE REPAIR >

[FOR USA AND CANADA]

INSTALLATION

Install in the reverse order of removal.

CAUTION:

- Never use the old fixing bolts after removal, replace with the new fixing bolts.
- Never damage the harness while installing.
- If malfunction is detected by the air bag warning lamp, after repair or replacement of the malfunctioning parts, reset the memory using self-diagnosis or CONSULT-III. Refer to [SRC-18. "Diagnosis Description"](#).
- After the work is completed, check that no system malfunction is detected by air bag warning lamp.

ECU DISCRIMINATED NO.

After replacing the diagnosis sensor unit, confirm that the diagnosis sensor unit identification is correct for the vehicle as equipped.

Specification		ECU DISCRIMINATED No.
2WD	Models with driver and passenger air bag, seat belt pre-tensioner, seat belt pre-tensioner 2, front side air bag and side curtain air bag	FAEB
AWD		

A
B
C
D
E
F
G
SR
I
J
K
L
M
N
O
P

SR

FRONT SEAT BELT PRE-TENSIONER

< ON-VEHICLE REPAIR >

[FOR USA AND CANADA]

FRONT SEAT BELT PRE-TENSIONER

Removal and Installation

INFOID:000000004235334

For removal and installation procedures, refer to [SB-6. "SEAT BELT RETRACTOR : Removal and Installation"](#).

OCCUPANT CLASSIFICATION SYSTEM CONTROL UNIT

< ON-VEHICLE REPAIR >

[FOR USA AND CANADA]

OCCUPANT CLASSIFICATION SYSTEM CONTROL UNIT

Removal and Installation

INFOID:000000004235335

For removal and installation

The occupant classification system control unit and seat sensor mat are an integral part of the front passenger seat cushion and are replaced as an assembly. Refer to [SE-27, "Removal and Installation"](#).

A

B

C

D

E

F

G

SR

I

J

K

L

M

N

O

P

PRECAUTION

PRECAUTIONS

Precaution for Supplemental Restraint System (SRS) "AIR BAG" and "SEAT BELT PRE-TENSIONER"

INFOID:000000004235336

The Supplemental Restraint System such as "AIR BAG" and "SEAT BELT PRE-TENSIONER", used along with a front seat belt, helps to reduce the risk or severity of injury to the driver and front passenger for certain types of collision. Information necessary to service the system safely is included in the "SRS AIRBAG" and "SEAT BELT" of this Service Manual.

WARNING:

- To avoid rendering the SRS inoperative, which could increase the risk of personal injury or death in the event of a collision which would result in air bag inflation, all maintenance must be performed by an authorized NISSAN/INFINITI dealer.
- Improper maintenance, including incorrect removal and installation of the SRS, can lead to personal injury caused by unintentional activation of the system. For removal of Spiral Cable and Air Bag Module, see the "SRS AIRBAG".
- Do not use electrical test equipment on any circuit related to the SRS unless instructed to in this Service Manual. SRS wiring harnesses can be identified by yellow and/or orange harnesses or harness connectors.

Service

INFOID:000000004678897

- Never use electrical test equipment to check SRS circuits unless instructed to in this Service Manual.
- Before servicing the SRS, turn ignition switch OFF, disconnect battery negative terminal and wait at least 3 minutes.
For approximately 3 minutes after the cables are removed, it is still possible for the air bag and seat belt pretensioner to deploy. Therefore, never work on any SRS connectors or wires until at least 3 minutes have elapsed.
- Diagnosis sensor unit must always be installed with their arrow marks "⇐" pointing towards the front of the vehicle for proper operation. Also check diagnosis sensor unit for cracks, deformities or rust before installation and replace as required.
- The spiral cable must be aligned in the neutral position since its rotations are limited. Never turn steering wheel and column after removal of steering gear.
- Handle air bag module carefully. Always place driver and front passenger air bag modules with the pad side facing upward and seat mounted front side air bag module standing with the stud bolt side facing down.
- Conduct self-diagnosis to check entire SRS for proper functioning after replacing any components.
- After air bag inflates, the front instrument panel assembly should be replaced if damaged.
- Always replace instrument panel pad following front passenger air bag deployment.

PREPARATION

< PREPARATION >

[FOR MEXICO]

PREPARATION

PREPARATION

Commercial Service Tools

INFOID:000000004235338

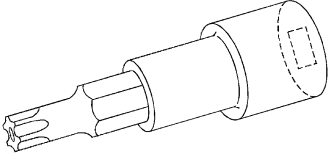
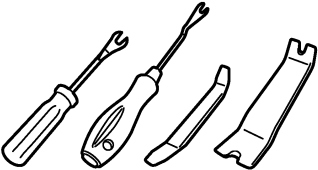
Tool name	Description
<p data-bbox="186 514 454 541">Tamper resistant TORX bit</p>  <p data-bbox="846 632 899 646">S-NT757</p>	<p data-bbox="992 514 1307 541">Removes driver air bag module</p>
<p data-bbox="186 766 324 793">Remover tool</p>  <p data-bbox="846 884 932 898">JMKIA3050ZZ</p>	<p data-bbox="992 766 1372 793">Removes clips, pawls, and metal clips</p>

A
B
C
D
E
F
G
SR
I
J
K
L
M
N
O
P

SR

ON-VEHICLE REPAIR

DRIVER AIR BAG MODULE

Exploded View

INFOID:000000004563403

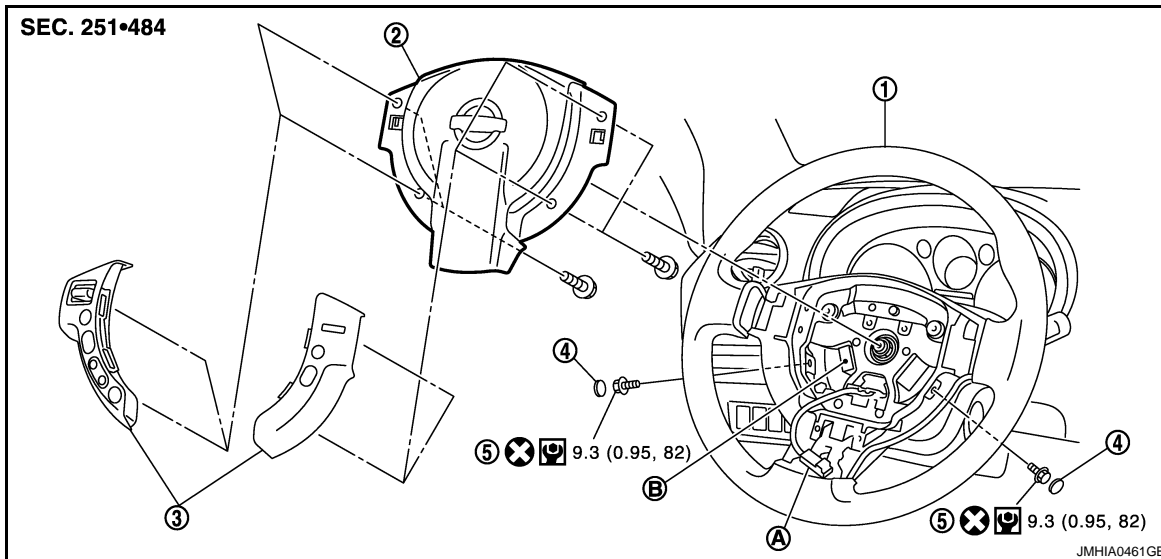

- | | | |
|-------------------------------------|----------------------------------|--------------------|
| 1. Steering wheel | 2. Driver air bag module | 3. Steering switch |
| 4. Side lid (LH/RH) | 5. TORX bolt (LH/RH) | |
| A. Driver air bag harness connector | B. Horn switch harness connector | |

Refer to [GI-4, "Components"](#) for symbols in the figure.

Removal and Installation

INFOID:000000004563404

WARNING:

- Before servicing, turn ignition switch OFF, disconnect the battery negative terminal and wait at least 3 minutes.
- Always work from the side of driver air bag module. Never work in front of it.
- Never use the air tools or electric tools for servicing.

REMOVAL

1. Remove the side lids (LH/RH).
2. Remove the driver air bag module mounting TORX bolt (LH/RH) with TORX bit (A).

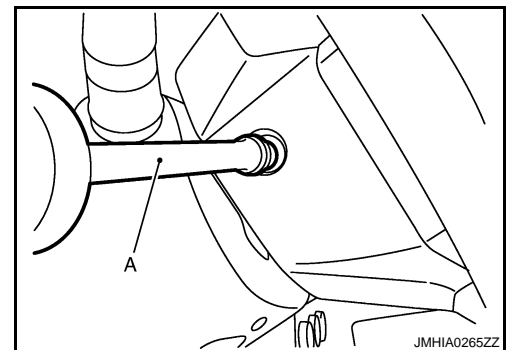

3. Pull out driver air bag module assembly.

DRIVER AIR BAG MODULE

< ON-VEHICLE REPAIR >

[FOR MEXICO]

4. Disconnect driver air bag module harness connector.

NOTE:

- For installing/removing the driver air bag harness connector, insert thin screwdriver wrapped in tape into notch, lift lock and remove connector.
- Install the connector with lock raised, and push lock into the connector.
- After installing the connector, check that the lock is pushed securely into it.

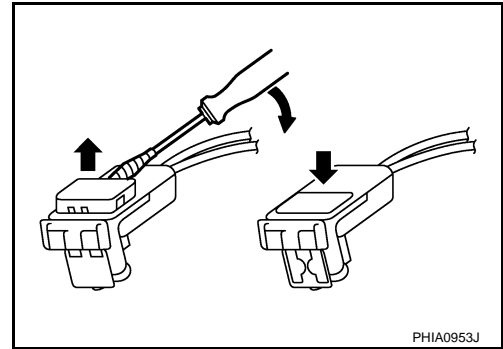

5. Remove the driver air bag module.

CAUTION:

- Always place the driver air bag module with pad side facing upward.

↶ : Upward

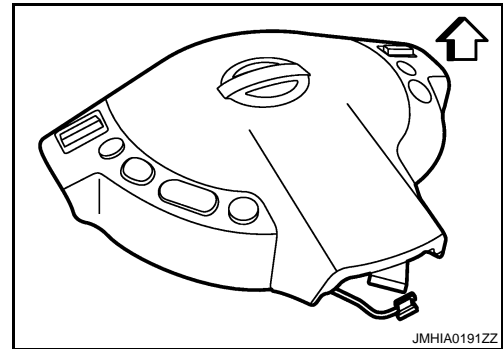

- Never impact the driver air bag module.
- Replace the driver air bag module if it has been dropped or sustained an impact.



- Never insert any foreign objects (screwdriver, etc.) into the driver air bag module.
- Never disassemble the driver air bag module.
- Never expose the driver air bag module to temperatures exceeding 90°C (194°F).
- Never allow oil, grease, detergent, or water to come in contact with the driver air bag module.

INSTALLATION

Install in the reverse order of removal.

CAUTION:

- Never use the old TORX bolts after removal, replace with the new bolts.
- Fix the driver air bag module harness to the harness fixing hook (A).

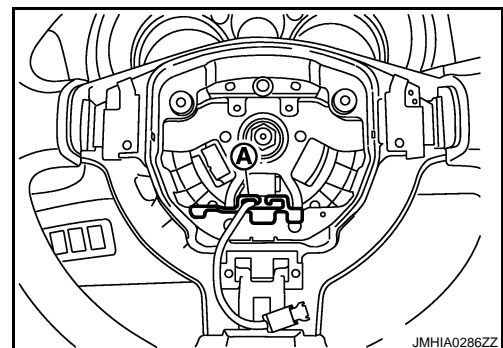

A
B
C
D
E
F
G
SR
I
J
K
L
M
N
O
P

DRIVER AIR BAG MODULE

< ON-VEHICLE REPAIR >

[FOR MEXICO]

-
- Never damage the harness while installing.
 - Tighten the TORX bolts after completely adjusting the centers of fixing holes on the driver air bag module side and the steering wheel side. If the holes are misaligned, the bolt threads are damaged and the module is not installed securely.
 - If malfunction is detected by the air bag warning lamp, after repair or replacement of the malfunctioning parts, reset the memory using self-diagnosis or CONSULT-III. Refer to [SRC-179, "Diagnosis Description"](#).
 - After the work is completed, check that no system malfunction is detected by air bag warning lamp.

SPIRAL CABLE

< ON-VEHICLE REPAIR >

[FOR MEXICO]

SPIRAL CABLE

Exploded View

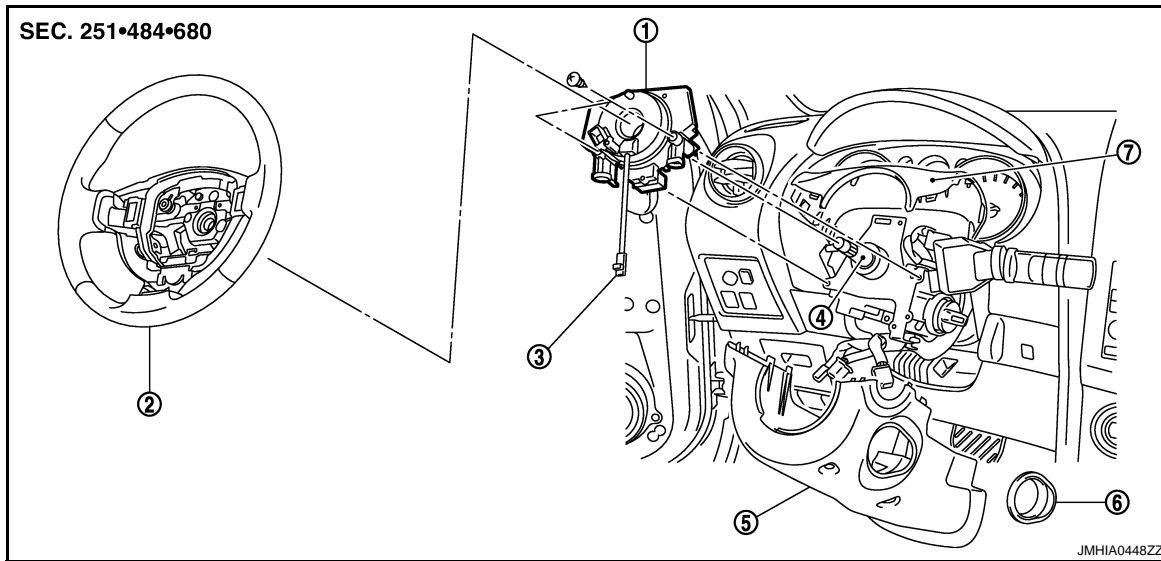

1. Spiral cable
2. Steering wheel
3. Driver air bag harness connector
4. Steering column assembly
5. Steering column cover (lower)
6. Steering lock escutcheon
7. Steering column cover (upper)

Removal and Installation

INFOID:000000004563406

WARNING:

- Before servicing, turn ignition switch OFF, disconnect the battery negative terminal and wait at least 3 minutes.
- Never use the air tools or electric tools for servicing.

REMOVAL

1. Remove the driver air bag module. Refer to [SR-24. "Removal and Installation"](#).
2. Remove the steering wheel. Refer to [ST-10. "Removal and Installation"](#).
3. Remove the steering column cover (upper/lower). Refer to [IP-13. "Removal and Installation"](#).
4. Disconnect the spiral cable body side harness connectors (A).

NOTE:

Disconnect the spiral cable body side harness connector after removing the spiral cable.

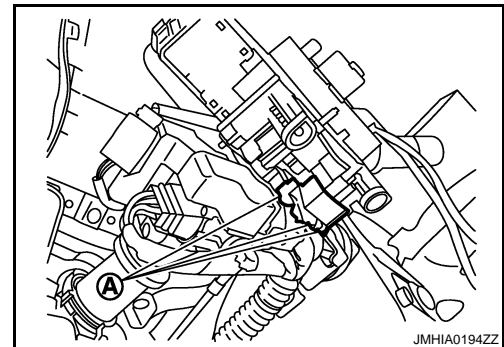

5. Remove the spiral cable fixing screws.
6. Pull out forward the spiral cable.

CAUTION:

SPIRAL CABLE

< ON-VEHICLE REPAIR >

[FOR MEXICO]

- Never impact the spiral cable.
- Replace the spiral cable if it has been dropped or sustained an impact.



- Never disassemble the spiral cable.
- Never apply lubricant to the spiral cable.
- Never allow oil, grease, detergent, or water to come in contact with the spiral cable.

INSTALLATION

Install in the reverse order of removal.

CAUTION:

- The spiral cable may snap during steering operation if the cable is installed in an improper position. The neutral position is set as follows.
- Turn carefully the spiral cable clockwise to the end position. Then turn it counterclockwise (about 2 and a half turns) and stop turning at the point (B) on which the stopper insertion holes are in the same position.
- The service part is installed in the neutral position by the stopper and can be set without adjusting after the stopper is removed.
- Never over turn the spiral cable or go beyond number of turns required. (These will cause the cable to snap.)
- Adjust the spiral cable locating pin (A) to the steering wheel locating pin hole (C).

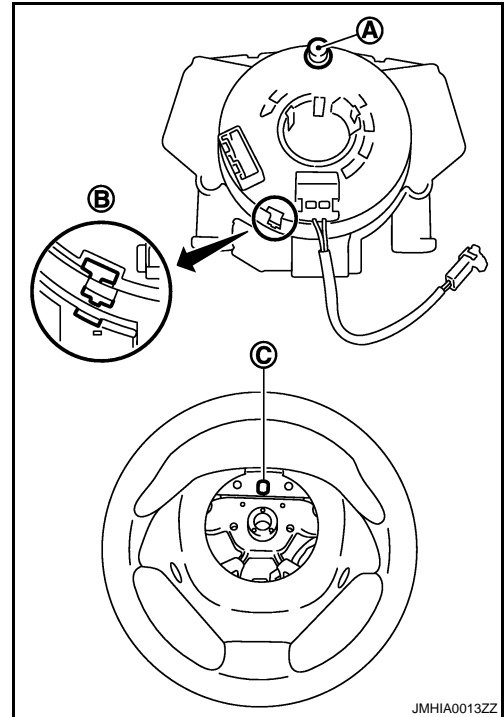

- If malfunction is detected by the air bag warning lamp, after repair or replacement of the malfunctioning parts, reset the memory using self-diagnosis or CONSULT-III. Refer to [SRC-179, "Diagnosis Description"](#).
- After the work is completed, check that no system malfunction is detected by air bag warning lamp.

FRONT PASSENGER AIR BAG MODULE

< ON-VEHICLE REPAIR >

[FOR MEXICO]

FRONT PASSENGER AIR BAG MODULE

Exploded View

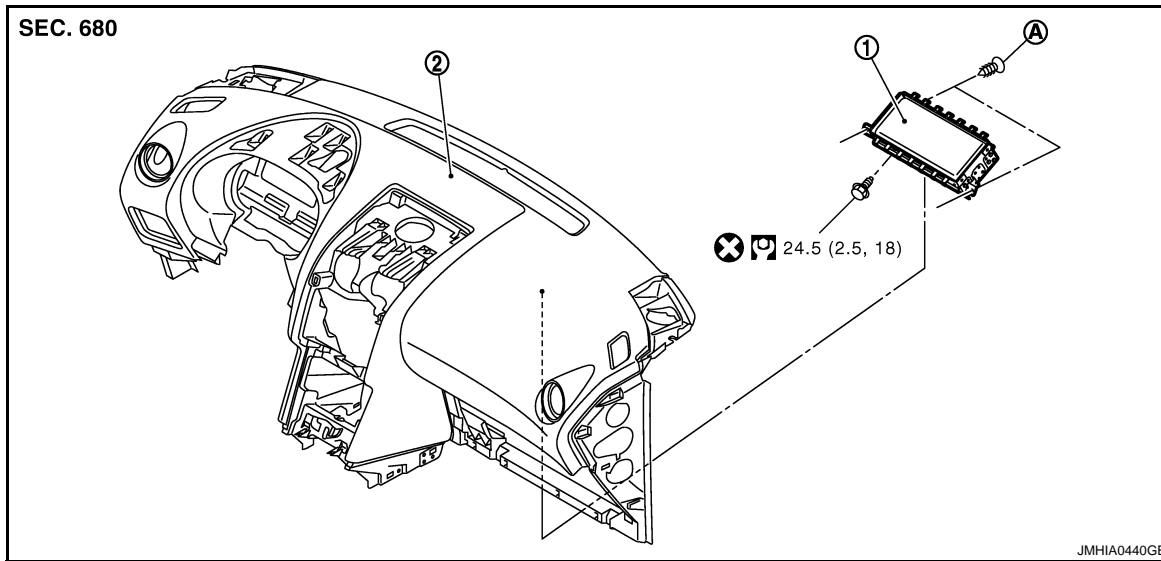

1. Passenger air bag module
 2. Instrument panel assembly
- A. Screws

Refer to [GI-4, "Components"](#) for symbols in the figure.

Removal and Installation

INFOID:000000004563408

WARNING:

- Before servicing, turn ignition switch OFF, disconnect the battery negative terminal and wait at least 3 minutes.
- Always work from the side of passenger air bag module. Never work in front of it.
- Never use the air tools or electric tools for servicing.

REMOVAL

1. Remove the glove box lid assembly. Refer to [IP-20, "Removal and Installation"](#).
2. Remove the Instrument lower assist panel. Refer to [IP-20, "Removal and Installation"](#).
3. Disconnect the passenger air bag harness connector (A).
4. Remove the passenger air bag module fixing bolt (B).

NOTE:

The figure shows the installed front passenger air bag module. (Under view of the module installed without glove box cover.)

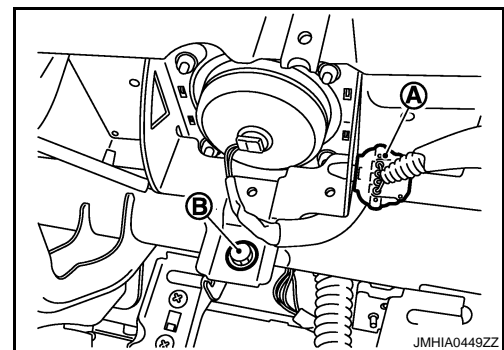

FRONT PASSENGER AIR BAG MODULE

[FOR MEXICO]

< ON-VEHICLE REPAIR >

5. Remove the instrument panel assembly (2).
6. Remove the passenger air bag module fixing screws (C).
7. Disconnect the fixing pawls (B) by using remover tool (A), and then remove the passenger air bag module (1) from instrument panel.

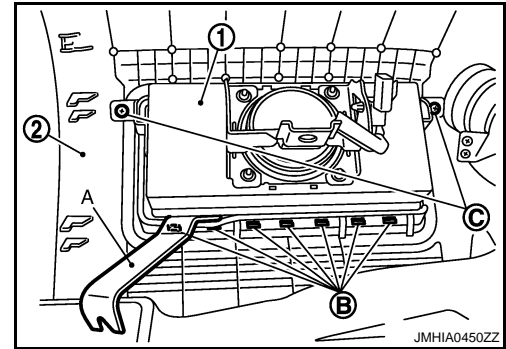

CAUTION:

- Always place the passenger air bag module with pad side facing upward.

⇐ : Upward

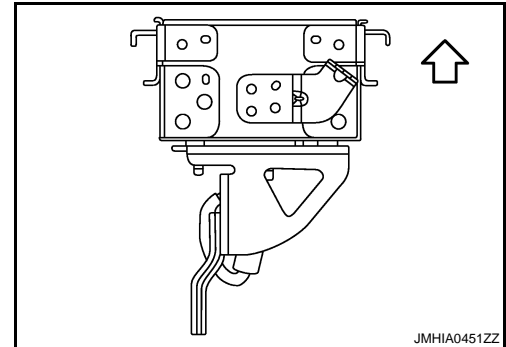

- Never impact the passenger air bag module.
- Replace the passenger air bag module if it has been dropped or sustained an impact.



- Never insert any foreign objects (screwdriver, etc.) into the passenger air bag module.
- Never disassemble the passenger air bag module.
- Never expose the passenger air bag module to temperatures exceeding 90°C (194°F).
- Never allow oil, grease, detergent, or water to come in contact with the passenger air bag module.

INSTALLATION

Install in the reverse order of removal.

CAUTION:

- Never use the old fixing bolts after removal, replace with the new bolts.
- Never damage the harness while installing.
- If malfunction is detected by the air bag warning lamp, after repair or replacement of the malfunctioning parts, reset the memory using self-diagnosis or CONSULT-III. Refer to [SRC-179, "Diagnosis Description"](#).
- After the work is completed, check that no system malfunction is detected by air bag warning lamp.

SIDE CURTAIN AIR BAG MODULE

< ON-VEHICLE REPAIR >

[FOR MEXICO]

SIDE CURTAIN AIR BAG MODULE

Exploded View

INFOID:000000004563409

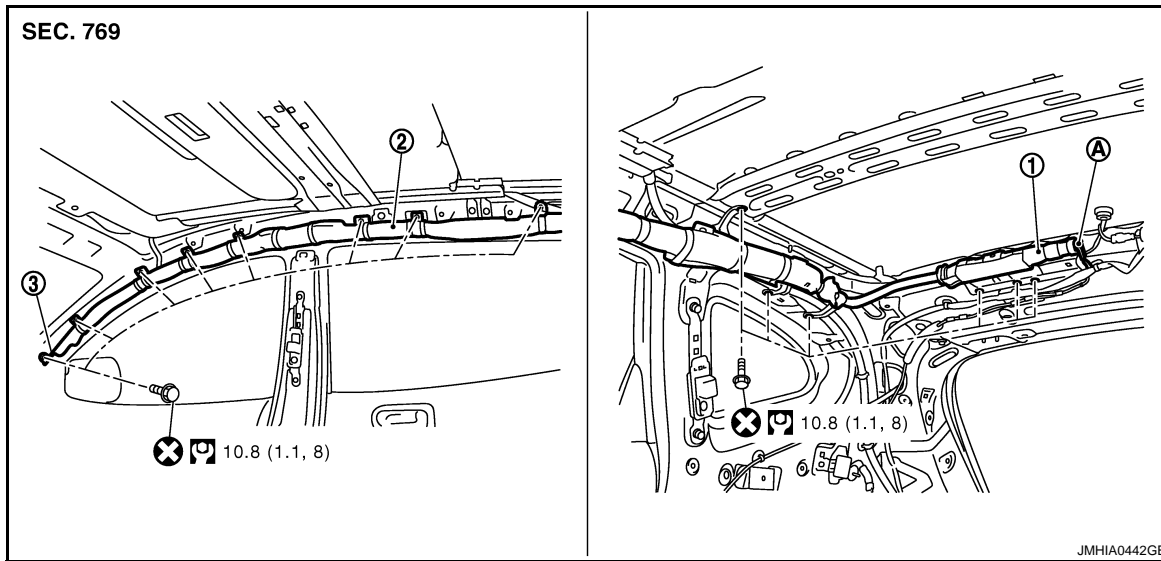

1. Side curtain air bag inflator
 2. Side curtain air bag
 3. Strap
- A. Side curtain air bag harness connector

Refer to [GI-4, "Components"](#) for symbols in the figure.

Removal and Installation

INFOID:000000004563410

WARNING:

- Before servicing, turn ignition switch OFF, disconnect the battery negative terminal and wait at least 3 minutes.
- Never use the air tools or electric tools for servicing.

REMOVAL

1. Remove the headlining.
 - NORMAL ROOF: Refer to [INT-23, "NORMAL ROOF : Removal and Installation"](#).
 - SUNROOF: Refer to [INT-26, "SUNROOF : Removal and Installation"](#).

2. Remove the side curtain air bag harness connector.

NOTE:

- For installing/removing the side curtain air bag module harness connector, insert thin screwdriver wrapped in tape into notch, lift lock and remove the connector.
- Install the connector with lock raised, and push lock into the connector.
- After installing the connector, check that the lock is pushed securely into it.

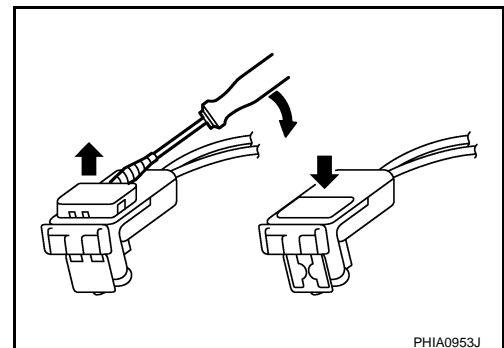

3. Remove fixing bolts, and then remove side curtain air bag module.

CAUTION:

A
B
C
D
E
F
G
SR
I
J
K
L
M
N
O
P

SIDE CURTAIN AIR BAG MODULE

< ON-VEHICLE REPAIR >

[FOR MEXICO]

- Never impact the side curtain air bag module.
- Replace the side curtain air bag module if it has been dropped or sustained an impact.



- Never insert any foreign objects (screwdriver, etc.) into the side curtain air bag module.
- Never disassemble the side curtain air bag module.
- Never expose the side curtain air bag module to temperatures exceeding 90°C (194°F).
- Never allow oil, grease, detergent, or water to come in contact with the side curtain air bag module.

INSTALLATION

Install in the reverse order of removal.

CAUTION:

- Never damage the harness while installing.
- If malfunction is detected by the air bag warning lamp, after repair or replacement of the malfunctioning parts, reset the memory using self-diagnosis or CONSULT-III. Refer to [SRC-179, "Diagnosis Description"](#).
- After the work is completed, check that no system malfunction is detected by air bag warning lamp.

CRASH ZONE SENSOR

< ON-VEHICLE REPAIR >

[FOR MEXICO]

CRASH ZONE SENSOR

Exploded View

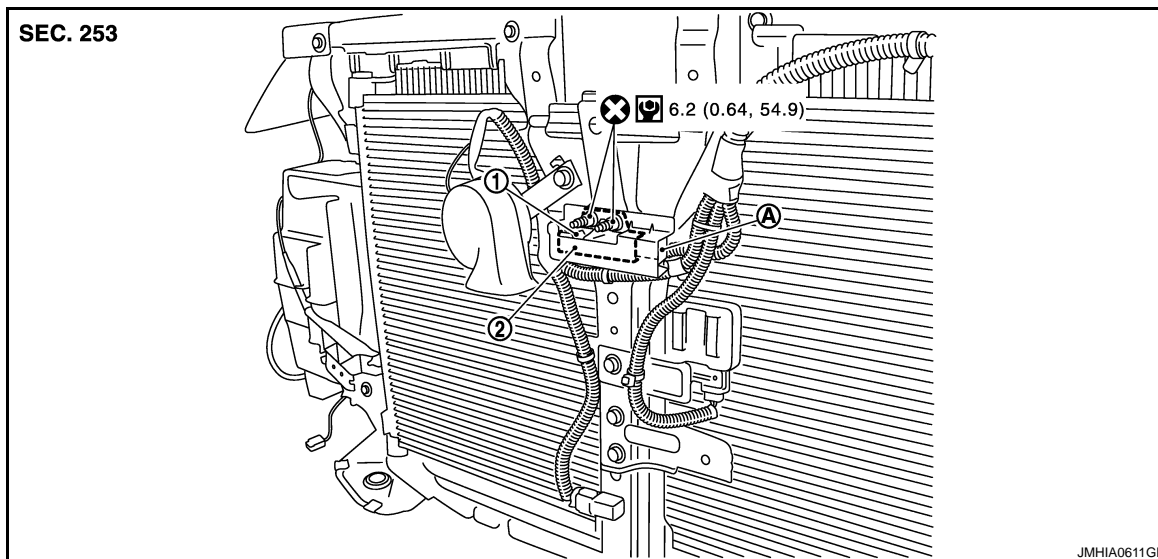

1. Crash zone sensor
2. Crash zone sensor cover
- A. Crash zone sensor harness connector

Refer to [GI-4, "Components"](#) for symbols in the figure.

Removal and Installation

INFOID:000000004563412

WARNING:

- Before servicing, turn ignition switch OFF, disconnect the battery negative terminal and wait at least 3 minutes.
- Never use the air tools or electric tools for servicing.

REMOVAL

1. Remove the front bumper upper clips. Refer to [EXT-13, "Exploded View"](#).
2. Remove the crash zone sensor fixing nuts.
3. Disconnect the crash zone sensor harness connector, and then remove the crash zone sensor.

CAUTION:

- Never impact the crash zone sensor.
- Replace the crash zone sensor if it has been dropped or sustained an impact.



- Replace the crash zone sensor of deployed SRS driver air bag and deployed SRS front passenger air bag.

INSTALLATION

Install in the reverse order of removal.

CAUTION:

- Never use the old fixing nuts after removal, replace with the new nuts.
- Never damage the harness while installing.

A
B
C
D
E
F
G
SR
I
J
K
L
M
N
O
P

CRASH ZONE SENSOR

< ON-VEHICLE REPAIR >

[FOR MEXICO]

-
- If malfunction is detected by the air bag warning lamp, after repair or replacement of the malfunctioning parts, reset the memory using self-diagnosis or CONSULT-III. Refer to [SRC-179, "Diagnosis Description"](#).
 - After the work is completed, check that no system malfunction is detected by air bag warning lamp.

SIDE AIR BAG (SATELLITE) SENSOR

< ON-VEHICLE REPAIR >

[FOR MEXICO]

SIDE AIR BAG (SATELLITE) SENSOR

Exploded View

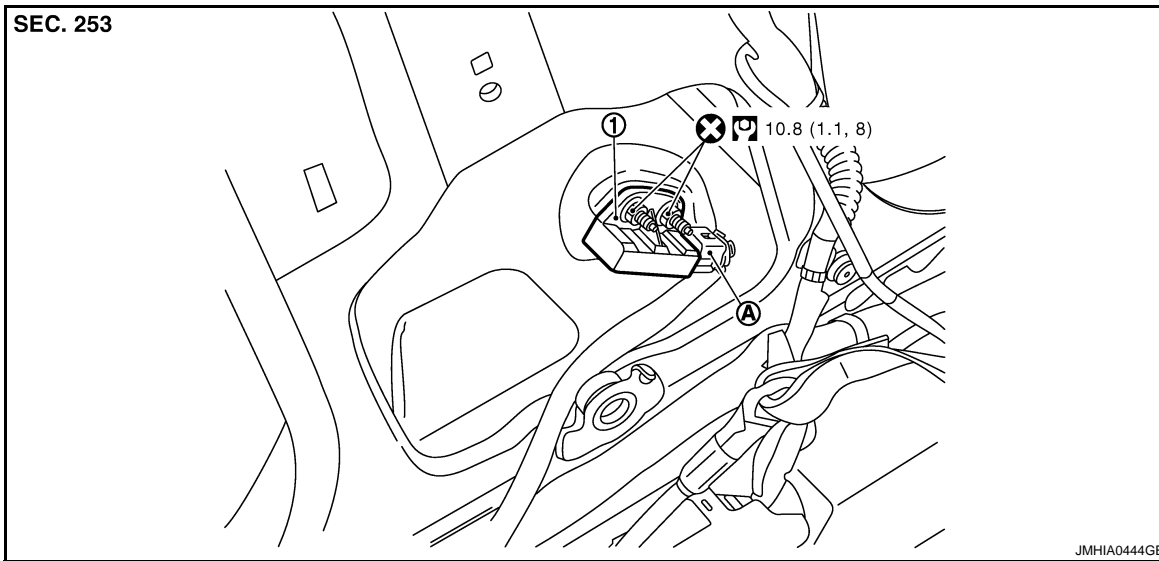

1. Satellite sensor
- A. Satellite sensor harness connector

Refer to [GI-4. "Components"](#) for symbols in the figure.

Removal and Installation

INFOID:000000004563414

WARNING:

- Before servicing, turn ignition switch OFF, disconnect the battery negative terminal and wait at least 3 minutes.
- Never use the air tools or electric tools for servicing.

REMOVAL

1. Remove the front seat belt retractor. Refer to [SB-6. "SEAT BELT RETRACTOR : Removal and Installation"](#).
2. Remove the satellite sensor fixing nuts.
3. Disconnect the satellite sensor harness connector, and then remove the satellite sensor.

CAUTION:

- Never impact the satellite sensor.
- Replace the satellite sensor if it has been dropped or sustained an impact.



- Replace the satellite sensor of deployed SRS front side air bag module and deployed SRS side curtain air bag module.

INSTALLATION

Install in the reverse order of removal.

CAUTION:

- Never use the old fixing nuts after removal, replace with the new nuts.

A
B
C
D
E
F
G
SR
I
J
K
L
M
N
O
P

SIDE AIR BAG (SATELLITE) SENSOR

< ON-VEHICLE REPAIR >

[FOR MEXICO]

-
- Never damage the harness while installing.
 - If malfunction is detected by the air bag warning lamp, after repair or replacement of the malfunctioning parts, reset the memory using self-diagnosis or CONSULT-III. Refer to [SRC-179. "Diagnosis Description"](#).
 - After the work is completed, check that no system malfunction is detected by air bag warning lamp.

DIAGNOSIS SENSOR UNIT

< ON-VEHICLE REPAIR >

[FOR MEXICO]

DIAGNOSIS SENSOR UNIT

Exploded View

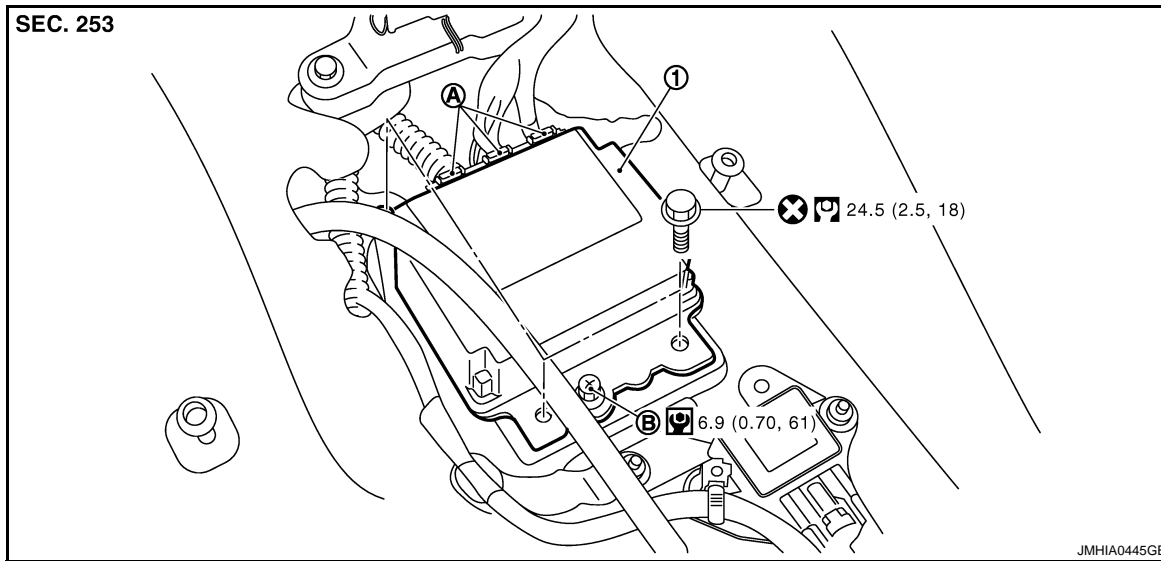

1. Diagnosis sensor unit
- A. Diagnosis sensor unit harness connectors
- B. Ground bolt

Refer to [GI-4, "Components"](#) for symbols in the figure.

Removal and Installation

INFOID:000000004563416

WARNING:

- Before servicing, turn ignition switch OFF, disconnect the battery negative terminal and wait at least 3 minutes.
- Before disconnecting the air bag sensor unit harness connector, be sure to disconnect the each harness connector of the air bag module and pre-tensioner seat belt to prevent air bag deployment by static electricity and pre-tensioner seat belt operation.
- Never use the air tools or electric tools for servicing.

REMOVAL

1. Disconnect the each connector of all air bag modules and pre-tensioner seat belts.
2. Remove the center console assembly. Refer to [IP-20, "Removal and Installation"](#).
3. Disconnect the diagnosis sensor unit harness connectors.
4. Remove the fixing bolts, ground bolt, and then remove the diagnosis sensor unit.

CAUTION:

- Never impact the diagnosis sensor unit.
- Replace the diagnosis sensor unit if it has been dropped or sustained an impact.



- Replace the diagnosis sensor unit of deployed SRS air bag and deployed SRS front seat belt pre-tensioner.

DIAGNOSIS SENSOR UNIT

< ON-VEHICLE REPAIR >

[FOR MEXICO]

INSTALLATION

Install in the reverse order of removal.

CAUTION:

- Never use the old fixing bolts after removal, replace with the new fixing bolts.
- Never damage the harness while installing.
- If malfunction is detected by the air bag warning lamp, after repair or replacement of the malfunctioning parts, reset the memory using self-diagnosis or CONSULT-III. Refer to [SRC-179. "Diagnosis Description"](#).
- After the work is completed, check that no system malfunction is detected by air bag warning lamp.

ECU DISCRIMINATED NO.

After replacing the diagnosis sensor unit, confirm that the diagnosis sensor unit identification is correct for the vehicle as equipped.

Specification		ECU DISCRIMINATED No.
2WD	Models with driver and passenger air bag, seat belt pre-tensioner, seat belt pre-tensioner 2, front side air bag and side curtain air bag	FAEB
AWD		

FRONT SEAT BELT PRE-TENSIONER

< ON-VEHICLE REPAIR >

[FOR MEXICO]

FRONT SEAT BELT PRE-TENSIONER

Removal and Installation

INFOID:000000004563417

For removal and installation procedures, refer to [SB-6. "SEAT BELT RETRACTOR : Removal and Installation"](#).

- A
- B
- C
- D
- E
- F
- G
- SR
- I
- J
- K
- L
- M
- N
- O
- P