

SECTION **PWO**
POWER OUTLET

CONTENTS

COMPONENT DIAGNOSIS	2	POWER SOCKET	5
POWER SOCKET	2	FRONT POWER SOCKET	5
Wiring Diagram - POWER SOCKET -	2	FRONT POWER SOCKET : Exploded View	5
PRECAUTION	4	FRONT POWER SOCKET : Removal and Installation	5
PRECAUTIONS	4	LUGGAGE ROOM POWER SOCKET	5
Precaution for Supplemental Restraint System (SRS) "AIR BAG" and "SEAT BELT PRE-TENSIONER"	4	LUGGAGE ROOM POWER SOCKET : Exploded View	5
ON-VEHICLE REPAIR	5	LUGGAGE ROOM POWER SOCKET : Removal and Installation	5

A
B
C
D
E
F
G
H
I
J
K
L
N
O
P

PWO

POWER SOCKET

< COMPONENT DIAGNOSIS >

COMPONENT DIAGNOSIS

POWER SOCKET

Wiring Diagram - POWER SOCKET -

INFOID:000000001298646

POWER SOCKET

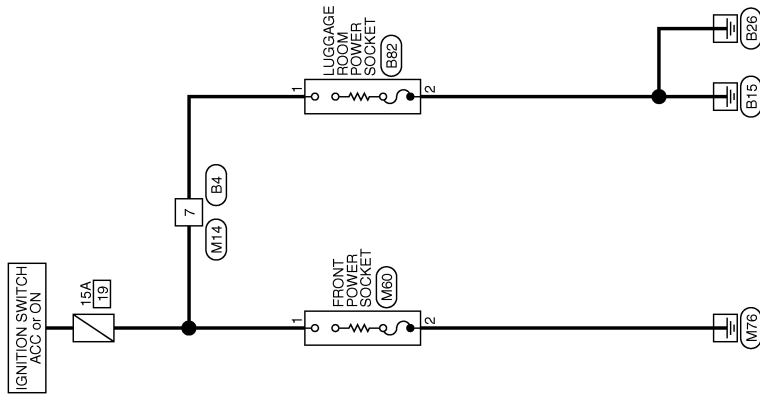

2007/02/28

JCMWA0498Gf

POWER SOCKET

< COMPONENT DIAGNOSIS >

POWER SOCKET

Connector No.	B4
Connector Name	WIRE TO WIRE
Connector Type	NS16MW-CS



Terminal No.	7	Color of Wire	R	Signal Name [Specification]	-
--------------	---	---------------	---	-----------------------------	---

Connector No.	BB2
Connector Name	LUGGAGE ROOM POWER SOCKET
Connector Type	F02FB-Z



Terminal No.	1	Color of Wire	R	Signal Name [Specification]	-
2	B	-	-	-	-

Connector No.	M14
Connector Name	WIRE TO WIRE
Connector Type	NS16FW-CS

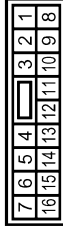

Terminal No.	7	Color of Wire	G	Signal Name [Specification]	-
--------------	---	---------------	---	-----------------------------	---

Connector No.	M60
Connector Name	FRONT POWER SOCKET
Connector Type	F02FB-Z



Terminal No.	1	Color of Wire	L	Signal Name [Specification]	-
2	B	-	-	-	-

A
B
C
D
E
F
G
H
I
J
K
L
N
O
P

PWO

JCMWA0499GE

PRECAUTIONS

< PRECAUTION >

PRECAUTION

PRECAUTIONS

Precaution for Supplemental Restraint System (SRS) "AIR BAG" and "SEAT BELT PRE-TENSIONER"

INFOID:000000001298650

The Supplemental Restraint System such as "AIR BAG" and "SEAT BELT PRE-TENSIONER", used along with a front seat belt, helps to reduce the risk or severity of injury to the driver and front passenger for certain types of collision. Information necessary to service the system safely is included in the "SRS AIRBAG" and "SEAT BELT" of this Service Manual.

WARNING:

- To avoid rendering the SRS inoperative, which could increase the risk of personal injury or death in the event of a collision which would result in air bag inflation, all maintenance must be performed by an authorized NISSAN/INFINITI dealer.
- Improper maintenance, including incorrect removal and installation of the SRS, can lead to personal injury caused by unintentional activation of the system. For removal of Spiral Cable and Air Bag Module, see the "SRS AIRBAG".
- Do not use electrical test equipment on any circuit related to the SRS unless instructed to in this Service Manual. SRS wiring harnesses can be identified by yellow and/or orange harnesses or harness connectors.

POWER SOCKET

< ON-VEHICLE REPAIR >

ON-VEHICLE REPAIR

POWER SOCKET

FRONT POWER SOCKET

FRONT POWER SOCKET : Exploded View

INFOID:000000001298648

1 : Inner socket

2 : Ring

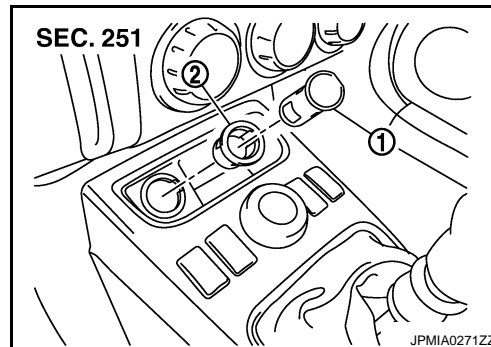

FRONT POWER SOCKET : Removal and Installation

INFOID:000000001298649

REMOVAL

1. Remove console finisher assembly. Refer to [IP-21, "Removal and Installation"](#).
2. Disconnect power socket connector (A).

D : Cut out

3. Pull out the inner socket (1) by pushing the ring pawl (B) from the inner socket hole (square) (C).
4. Remove ring (2) from console finisher assembly while pressing pawls.

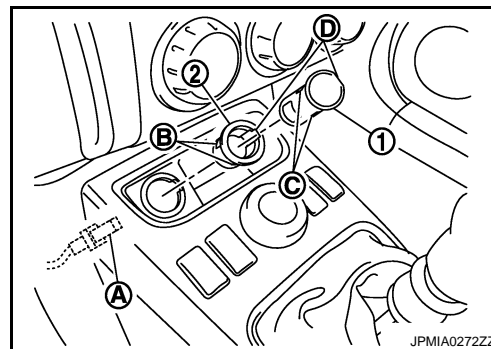

INSTALLATION

Install in the reverse order of removal.

NOTE:

Align inner socket and ring cut out.

LUGGAGE ROOM POWER SOCKET

LUGGAGE ROOM POWER SOCKET : Exploded View

INFOID:000000001298725

1 : Inner socket

2 : Ring

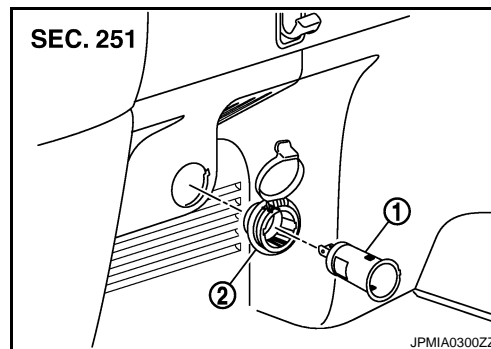

LUGGAGE ROOM POWER SOCKET : Removal and Installation

INFOID:000000001298726

REMOVAL

A
B
C
D
E
F
G
H
I
J
K
L

PWO

N
O
P

POWER SOCKET

< ON-VEHICLE REPAIR >

1. Remove luggage side lower finisher LH. Refer to [INT-28. "Removal and Installation"](#).
2. Disconnect power socket connector (A).

B : Cut out

3. Pull out the inner socket (1) by pushing the ring pawl (C) from the inner socket hole (square) (D).
4. Remove ring (2) from luggage side lower finisher LH while pressing pawls.

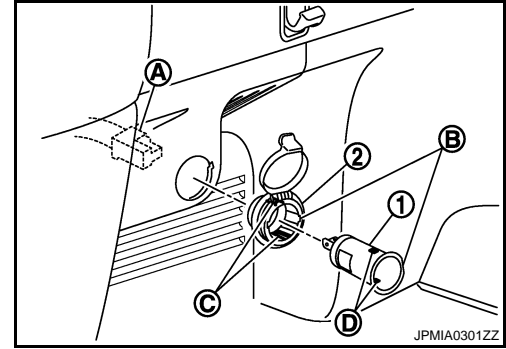

INSTALLATION

Install in the reverse order of removal.

NOTE:

Align inner socket and ring cut out.