

SECTION **SB**  
SEAT BELT

A  
B  
C  
D  
E  
F  
G  
SB  
I  
J  
K  
L  
M  
N  
O  
P

CONTENTS

<b>PRECAUTION</b> .....	2	SEAT BELT BUCKLE : Exploded View .....	7
<b>PRECAUTIONS</b> .....	2	SEAT BELT BUCKLE : Removal and Installation.....	7
Precaution for Supplemental Restraint System (SRS) "AIR BAG" and "SEAT BELT PRE-TEN- SIONER" .....	2	<b>REAR SEAT BELT</b> .....	8
Precaution for Seat Belt Service .....	2	<b>SEAT BELT RETRACTOR</b> .....	8
<b>ON-VEHICLE REPAIR</b> .....	3	SEAT BELT RETRACTOR : Inspection .....	8
<b>FRONT SEAT BELT</b> .....	3	SEAT BELT RETRACTOR : Exploded View .....	10
<b>SEAT BELT RETRACTOR</b> .....	3	SEAT BELT RETRACTOR : Removal and Instal- lation .....	10
SEAT BELT RETRACTOR : Inspection .....	3	<b>SEAT BELT BUCKLE</b> .....	11
SEAT BELT RETRACTOR : Exploded View .....	5	SEAT BELT BUCKLE : Inspection .....	11
SEAT BELT RETRACTOR : Removal and Instal- lation .....	5	SEAT BELT BUCKLE : Exploded View .....	12
<b>SEAT BELT BUCKLE</b> .....	6	SEAT BELT BUCKLE : Removal and Installation....	13
SEAT BELT BUCKLE : Inspection .....	6	<b>TOP TETHER STRAP CHILD RESTRAINT</b> .....	14
		Exploded View .....	14
		Removal and Installation .....	14

# PRECAUTIONS

< PRECAUTION >

## PRECAUTION

### PRECAUTIONS

#### Precaution for Supplemental Restraint System (SRS) "AIR BAG" and "SEAT BELT PRE-TENSIONER"

INFOID:000000001557117

The Supplemental Restraint System such as "AIR BAG" and "SEAT BELT PRE-TENSIONER", used along with a front seat belt, helps to reduce the risk or severity of injury to the driver and front passenger for certain types of collision. Information necessary to service the system safely is included in the "SRS AIRBAG" and "SEAT BELT" of this Service Manual.

#### **WARNING:**

- To avoid rendering the SRS inoperative, which could increase the risk of personal injury or death in the event of a collision which would result in air bag inflation, all maintenance must be performed by an authorized NISSAN/INFINITI dealer.
- Improper maintenance, including incorrect removal and installation of the SRS, can lead to personal injury caused by unintentional activation of the system. For removal of Spiral Cable and Air Bag Module, see the "SRS AIRBAG".
- Do not use electrical test equipment on any circuit related to the SRS unless instructed to in this Service Manual. SRS wiring harnesses can be identified by yellow and/or orange harnesses or harness connectors.

#### Precaution for Seat Belt Service

INFOID:000000001283129

#### **CAUTION:**

- Before removing the front seat belt pre-tensioner assembly, turn the ignition switch off, disconnect both battery cables and wait at least 3 minutes.
- Do not use electrical test equipment for front seat belt pre-tensioner connector.
- After replacing or reinstalling front seat belt pre-tensioner assembly, or reconnecting front seat belt pre-tensioner connector, check the system function. Refer to [SRC-10, "Diagnosis Description"](#).
- Deploy front seat belt pre-tensioner assembly before disposing. Refer to [SR-22, "Caution for Air Bag Module and Seat Belt Pre-tensioner"](#).
- Do not use disassembled buckle or seat belt assembly.
- Replace anchor bolts if they are deformed or worn out.
- Never oil tongue and buckle.
- If any component of seat belt assembly is questionable, do not repair. Replace the entire seat belt assembly.
- If webbing is cut, frayed or damaged, replace seat belt assembly.
- When replacing seat belt assembly, use a genuine NISSAN seat belt assembly.

#### AFTER A COLLISION

#### **WARNING:**

Inspect all seat belt assemblies including retractors and attached hardware after any collision. NISSAN recommends that all seat belt assemblies in use during a collision be replaced unless the collision was minor and the belts show no damage and continue to operate properly. Failure to do so could result in serious personal injury in an accident. Seat belt assemblies not in use during a collision should also be replaced if either damage or improper operation is noted. Seat belt pre-tensioners should be replaced even if the seat belts are not in use during a frontal collision in which the air bags are deployed.

Replace any seat belt assembly (including anchor bolts) if:

- The seat belt was in use at the time of a collision (except for minor collisions and the belts, retractors and buckles show no damage and continue to operate properly).
- The seat belt was damaged in an accident (i.e. torn webbing, bent retractor or guide).
- The seat belt attaching point was damaged in an accident. Inspect the seat belt attaching area for damage or distortion and repair as necessary before installing a new seat belt assembly.
- Anchor bolts are deformed or worn out.
- The front seat belt pre-tensioner should be replaced even if the seat belts are not in use during the collision in which the air bags are deployed.

# FRONT SEAT BELT

< ON-VEHICLE REPAIR >

## ON-VEHICLE REPAIR

### FRONT SEAT BELT

#### SEAT BELT RETRACTOR

#### SEAT BELT RETRACTOR : Inspection

INFOID:000000001283130

#### AFTER A COLLISION

##### **WARNING:**

**Inspect all seat belt assemblies including retractors and attached hardware after any collision. NISSAN/INFINITI recommends that all seat belt assemblies in use during a collision be replaced unless the collision was minor and the belts show no damage and continue to operate properly. Failure to do so could result in serious personal injury in an accident. Seat belt assemblies not in use during a collision should also be replaced if either damage or improper operation is noted. Seat belt pre-tensioners should be replaced even if the seat belts are not in use during a frontal collision in which the air bags are deployed.**

Replace any seat belt assembly (including anchor bolts) if:

- The seat belt was in use at the time of a collision (except for minor collisions and the belts, retractors and buckles show no damage and continue to operate properly).
- The seat belt was damaged in an accident (i.e. torn webbing, bent retractor or guide, etc.).
- The seat belt attaching point was damaged in an accident. Inspect the seat belt attaching area for damage or distortion and repair it necessary before installing a new seat belt assembly.
- Anchor bolts are deformed or worn out.
- The seat belt pre-tensioners should be replaced even if the seat belts were not in use during the collision in which the air bags are deployed.

#### PRELIMINARY CHECKS

1. Check the seat belt warning lamp/chime for proper operation as follows:
  - a. Turn ignition switch ON. The seat belt warning lamp should illuminate.
  - b. Fasten driver seat belt. The seat belt warning lamp should turn off.
2. If the air bag warning lamp is blinking, conduct self-diagnosis with CONSULT-III and air bag warning lamp. Refer to [SRC-10, "Diagnosis Description"](#).
3. Check that the seat belt retractor, seat belt anchor and buckle bolts are securely attached.
4. Check the shoulder seat belt guide and shoulder belt height adjuster for front seats. Ensure guide swivels freely and that webbing lays flat and does not bind in guide. Ensure height adjuster operates properly and holds securely.
5. Check retractor operation:
  - a. Fully extend the seat belt webbing and check for twists, tears or other damage.
  - b. Allow the seat belt to retract. Ensure that webbing returns smoothly and completely into the retractor. If the seat belt does not return smoothly, wipe the inside of the loops with a clean paper cloth. Because dirt build-up in the loops of the upper anchors can cause the seat belts to retract slowly.
  - c. Fasten the seat belt. Check that seat belt returns smoothly and completely to the retractor. If the webbing does not return smoothly, the cause may be an accumulation of dust or dirt. Use the "SEAT BELT TAPE SET" and perform the following steps.

Inspect the front seat belt through-anchor

1. Pull the seat belt out to a length of 500 mm (19.69 in) or more.
  2. Fix the seat belt at the center pillar webbing opening with a clip or other device.
  3. Pass a thin wire through the through-anchor webbing opening. Hold both ends of the wire and pull it tautly while moving it up and down several times along the webbing opening surface to remove dirt stuck there.
  4. Any dirt that cannot be removed with the wire can be removed by cleaning the opening with a clean cloth.
  5. Apply tape at the point where the webbing contacts the through-anchor webbing opening.

**NOTE:**  
Apply the tape so that there is no looseness or wrinkling.
  6. Remove the clip fixing the seat belt and check that the webbing returns smoothly.
6. Repeat steps above as necessary to check the other seat belts.

# FRONT SEAT BELT

< ON-VEHICLE REPAIR >

## SEAT BELT RETRACTOR ON-VEHICLE CHECK

Emergency Locking Retractors (ELR)

### NOTE:

All seat belt retractors are Emergency Locking Retractors (ELR) type. In an emergency (sudden stop) the retractor will lock and prevent the webbing from extending any further.

Check the seat belt retractors with the following test(s) to determine if a retractor assembly is operating properly.

ELR Function Stationary Check

Grasp the shoulder webbing and pull forward quickly. The retractor should lock and prevent the belt from extending further.

ELR Function Moving Check

### WARNING:

**Perform the following test in a safe, open area clear of other vehicles and obstructions (for example, a large, empty parking lot). Road surface must be paved and dry. DO NOT perform the following test on wet or gravel roads or on public streets and highways. This could result in an accident and serious personal injury. The driver and passenger must be prepared to brace themselves in the event that the retractor does not lock.**

1. Fasten driver seat belt. Buckle a passenger into the seat for the belt that is to be tested.
2. Proceed to the designated safe area.
3. Drive the vehicle at approximately 16 km/h (10 MPH). Notify any passengers of a pending sudden stop and the driver and passenger must be prepared to brace themselves in the event that the retractor does not lock, apply brakes firmly and make a very hard stop.

During stop, seat belts should lock and not be extended. If the seat belt retractor assembly does not lock, perform the retractor off-vehicle check.

## SEAT BELT RETRACTOR OFF-VEHICLE CHECK

1. Remove the seat belt retractor.  
Remove the front seat belt assembly. Refer to [SB-5, "SEAT BELT RETRACTOR : Removal and Installation"](#).

2. Slowly pull out webbing while tilting the retractor assembly forward from the mounted position without twisting the retractor assembly as shown in the illustration.

**A** : The webbing can be pulled out in case the retractor is tilted 15° degrees or less.

**B** : The webbing cannot be pulled out in case the retractor is tilted 27° degrees or more.

- A and B show tilting angles.
- ⇐ : Vehicle front.

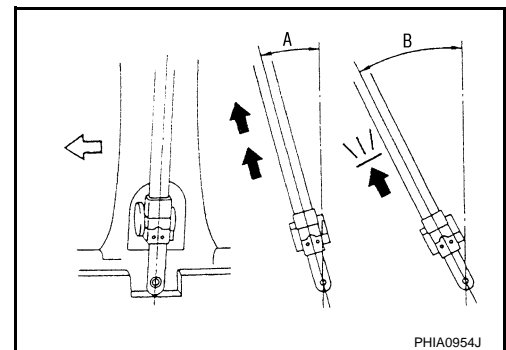

Replace the seat belt assembly if it does not operate normally.

# FRONT SEAT BELT

< ON-VEHICLE REPAIR >

## SEAT BELT RETRACTOR : Exploded View

INFOID:000000001283131

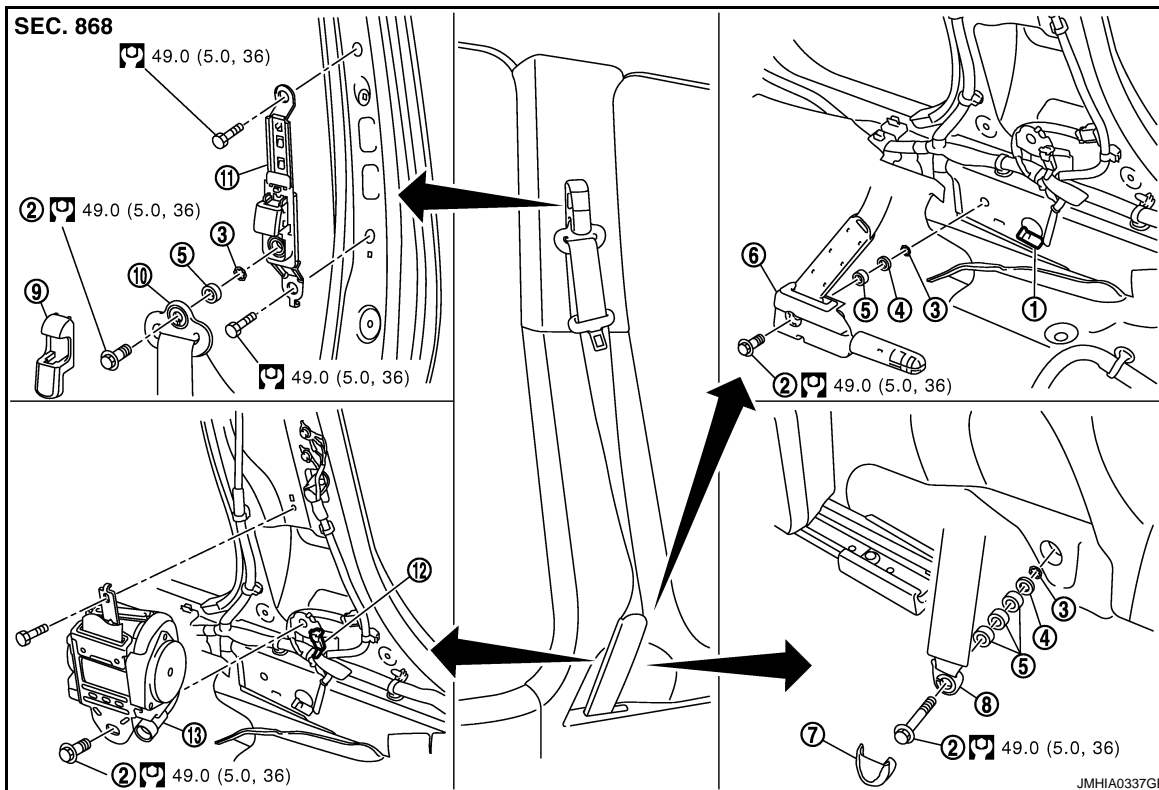

- |                                       |                        |                                       |
|---------------------------------------|------------------------|---------------------------------------|
| 1. Lap pre-tensioner connector        | 2. Anchor bolt         | 3. Retaining washer                   |
| 4. Plain washer                       | 5. Spacer              | 6. Lap pre-tensioner                  |
| 7. Outer anchor cover                 | 8. Outer anchor        | 9. Shoulder anchor cover              |
| 10. Shoulder anchor                   | 11. Seat belt adjuster | 12. Seat belt pre-tensioner connector |
| 13. Pre-tensioner seat belt retractor |                        |                                       |

Refer to [GI-4, "Components"](#) for symbols in the figure.

## SEAT BELT RETRACTOR : Removal and Installation

INFOID:000000001283132

### REMOVAL

#### CAUTION:

**Before servicing SRS, turn the ignition switch off, disconnect both battery cables and wait at least 3 minutes.**

### REMOVAL

- Remove the lap pre-tensioner. (Driver seat belt only)
  - Remove the center pillar lower garnish. Refer to.
  - Disconnect the lap pre-tensioner connector.
    - CAUTION:**
      - For installing/removing lap pre-tensioner connector, insert thin screwdriver wrapped in tape into notch, lift lock and remove connector.
      - Install connector with lock raised, and push lock into connector.

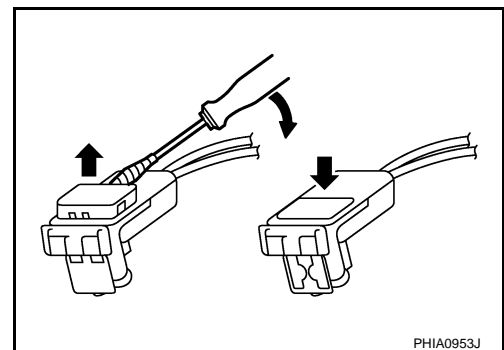

PHIA0953J

# FRONT SEAT BELT

## < ON-VEHICLE REPAIR >

2. Remove the outer anchor. (Passenger seat belt only)
  - Remove the outer anchor cover.
  - Remove the fixing anchor bolt of the outer anchor.
3. Remove the shoulder anchor.
  - Remove the outer shoulder cover.
  - Remove the fixing anchor bolt of the shoulder anchor.
4. Remove seat belt assembly.
  - Disconnect the seat belt pre-tensioner connector.

### **CAUTION:**

- **For installing/removing seat belt pre-tensioner connector, insert thin screwdriver wrapped in tape into notch, lift lock and remove connector.**
- **Install connector with lock raised, and push lock into connector.**

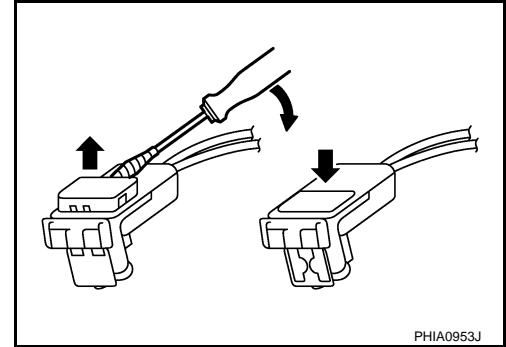

- Remove the fixing bolt and anchor bolt of the pre-tensioner seat retractor.
5. Remove the seat belt adjuster.
    - Remove the center pillar upper garnish. Refer to.
    - Remove the fixing bolt of the seat belt adjuster.

## INSTALLATION

Install in the reverse order of removal.

## SEAT BELT BUCKLE

### SEAT BELT BUCKLE : Inspection

INFOID:000000001283133

## AFTER A COLLISION

### **WARNING:**

**Inspect all seat belt assemblies including retractors and attached hardware after any collision. NISSAN/INFINITI recommends that all seat belt assemblies in use during a collision be replaced unless the collision was minor and the belts show no damage and continue to operate properly. Failure to do so could result in serious personal injury in an accident. Seat belt assemblies not in use during a collision should also be replaced if either damage or improper operation is noted. Seat belt pre-tensioners should be replaced even if the seat belts are not in use during a frontal collision in which the air bags are deployed.**

Replace any seat belt assembly (including anchor bolts) if:

- The seat belt was in use at the time of a collision (except for minor collisions and the belts, retractors and buckles show no damage and continue to operate properly).
- The seat belt was damaged in an accident (i.e. torn webbing, bent retractor or guide, etc.).
- The seat belt attaching point was damaged in an accident. Inspect the seat belt attaching area for damage or distortion and repair it necessary before installing a new seat belt assembly.
- Anchor bolts are deformed or worn out.
- The seat belt pre-tensioner should be replaced even if the seat belts were not in use during the collision in which the air bags are deployed.

## PRELIMINARY CHECKS

1. Check the seat belt warning lamp/chime for proper operation as follows:
  - a. Turn ignition switch ON. The seat belt warning lamp should illuminate.
  - b. Fasten driver seat belt. The seat belt warning lamp should turn off.
2. If the air bag warning lamp is blinking, conduct self-diagnosis using CONSULT-III and air bag warning lamp. Refer to [SRC-10, "Diagnosis Description"](#).

# FRONT SEAT BELT

## < ON-VEHICLE REPAIR >

3. Check that the seat belt retractor, seat belt anchor and buckle bolts are securely attached.
4. Repeat steps above as necessary to check the other seat belts.

## SEAT BELT BUCKLE : Exploded View

INFOID:000000001283134

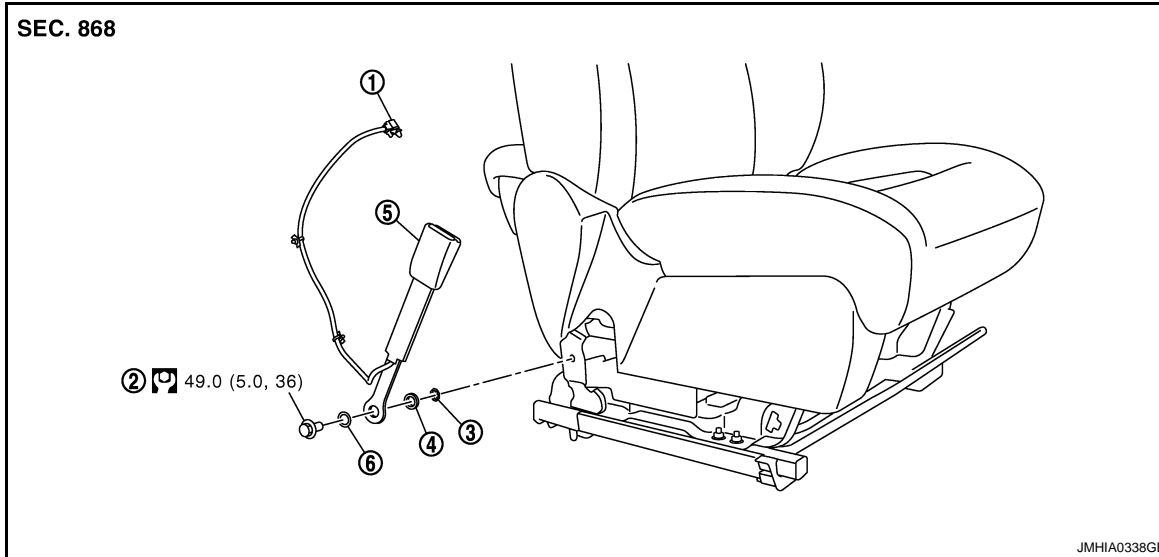

- |                                       |                     |                     |
|---------------------------------------|---------------------|---------------------|
| 1. Seat belt buckle harness connector | 2. Anchor bolt      | 3. Retaining washer |
| 4. Plain washer                       | 5. Seat belt buckle | 6. Wave washer      |

Refer to [GI-4, "Components"](#) for symbols in the figure.

## SEAT BELT BUCKLE : Removal and Installation

INFOID:000000001283135

### REMOVAL

Remove the seat belt buckle.

- Remove the front seat from vehicle. Refer to [SE-36, "Removal and Installation"](#). (for ease of tool operation in narrow space.)
- Disconnect the seat belt buckle harness connector remove and harness clamp.
- Remove the fixing anchor bolt of the seat belt buckle.

### INSTALLATION

Installation in the reverse order of removal.

# REAR SEAT BELT

< ON-VEHICLE REPAIR >

## REAR SEAT BELT SEAT BELT RETRACTOR

### SEAT BELT RETRACTOR : Inspection

INFOID:000000001283136

#### AFTER A COLLISION

##### **WARNING:**

**Inspect all seat belt assemblies including retractors and attached hardware after any collision. NISSAN/INFINITI recommends that all seat belt assemblies in use during a collision be replaced unless the collision was minor and the belts show no damage and continue to operate properly. Failure to do so could result in serious personal injury in an accident. Seat belt assemblies not in use during a collision should also be replaced if either damage or improper operation is noted. Seat belt pre-tensioners should be replaced even if the seat belts are not in use during a frontal collision in which the air bags are deployed.**

Replace any seat belt assembly (including anchor bolts) if:

- The seat belt was in use at the time of a collision (except for minor collisions and the belts, retractors and buckles show no damage and continue to operate properly).
- The seat belt was damaged in an accident (i.e. torn webbing, bent retractor or guide, etc.).
- The seat belt attaching point was damaged in an accident. Inspect the seat belt attaching area for damage or distortion and repair it necessary before installing a new seat belt assembly.
- Anchor bolts are deformed or worn out.
- The seat belt pre-tensioners should be replaced even if the seat belts were not in use during the collision in which the air bags are deployed.

#### PRELIMINARY CHECKS

1. Check the seat belt warning lamp/chime for proper operation as follows:
  - a. Turn ignition switch ON. The seat belt warning lamp should illuminate.
  - b. Fasten driver seat belt. The seat belt warning lamp should turn off.
2. If the air bag warning lamp is blinking, conduct self-diagnosis with CONSULT-III and air bag warning lamp. Refer to [SRC-10. "Diagnosis Description"](#).
3. Check that the seat belt retractor, seat belt anchor and buckle bolts are securely attached.
4. Check retractor operation:
  - a. Fully extend the seat belt webbing and check for twists, tears or other damage.
  - b. Allow the seat belt to retract. Ensure that webbing returns smoothly and completely into the retractor. If the seat belt does not return smoothly, wipe the inside of the loops with a clean paper cloth. Because dirt build-up in the loops of that upper anchors can cause the seat belts to retract slowly.
  - c. Fasten the seat belt. Check that seat belt returns smoothly and completely to the retractor. If the webbing does not return smoothly, the cause may be an accumulation of dust or dirt. Use the "SEAT BELT TAPE SET" and perform the following steps.
5. Repeat steps above as necessary to check the other seat belts.

#### SEAT BELT RETRACTOR ON-VEHICLE CHECK

Emergency Locking Retractors (ELR)

##### **NOTE:**

All seat belt retractors are Emergency Locking Retractors (ELR) type. In an emergency (sudden stop) the retractor will lock and prevent the webbing from extending any further.

Check the seat belt retractors with the following test(s) to determine if a retractor assembly is operating properly.

ELR Function Stationary Check

Grasp the shoulder webbing and pull forward quickly. The retractor should lock and prevent the belt from extending further.

ELR Function Moving Check

##### **WARNING:**

**Perform the following test in a safe, open area clear of other vehicles and obstructions (for example, a large, empty parking lot). Road surface must be paved and dry. DO NOT perform the following test on**



# REAR SEAT BELT

## < ON-VEHICLE REPAIR >

wet or gravel roads or on public streets and highways. This could result in an accident and serious personal injury. The driver and passenger must be prepared to brace themselves in the event that the retractor does not lock.

1. Fasten driver seat belt. Buckle a passenger into the seat for the belt that is to be tested.
2. Proceed to the designated safe area.
3. Drive the vehicle at approximately 16 km/h (10 MPH). Notify any passengers of a pending sudden stop and the driver and passenger must be prepared to brace themselves in the event that the retractor does not lock, apply brakes firmly and make a very hard stop.

During stop, seat belts should lock and not be extended. If the seat belt retractor assembly does not lock, perform the retractor off-vehicle check.

## SEAT BELT RETRACTOR OFF-VEHICLE CHECK

1. Remove the seat belt retractor.  
Remove the rear seat belt assembly. Refer to [SB-10. "SEAT BELT RETRACTOR : Removal and Installation"](#).
2. Slowly pull out webbing while tilting the retractor assembly forward from the mounted position without twisting the retractor assembly as shown in the illustration.

### a. Outer seat belt retractor

**A** : The webbing can be pulled out in case the retractor is tilted 15° degrees or less.

**B** : The webbing cannot be pulled out in case the retractor is tilted 27° degrees or more.

- A and B show tilting angles.
- ← : Vehicle front.

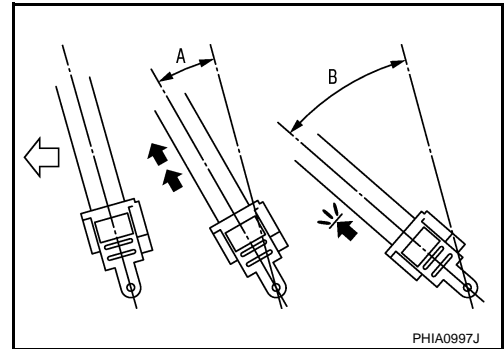

### b. Center seat belt retractor

**A** : The webbing can be pulled out in case the retractor is tilted 15° degrees or less.

**B** : The webbing cannot be pulled out in case the retractor is tilted 27° degrees or more.

- A and B show tilting angles.
- ← : Vehicle front.

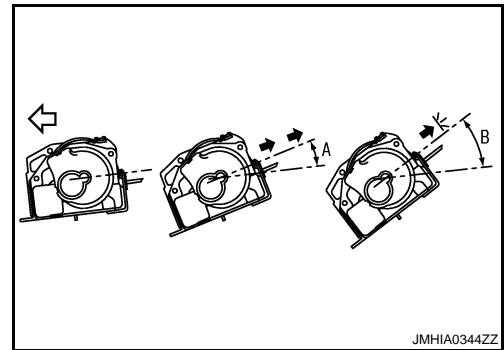

Replace the seat belt assembly if it does not operate normally.

# REAR SEAT BELT

< ON-VEHICLE REPAIR >

## SEAT BELT RETRACTOR : Exploded View

INFOID:000000001283137

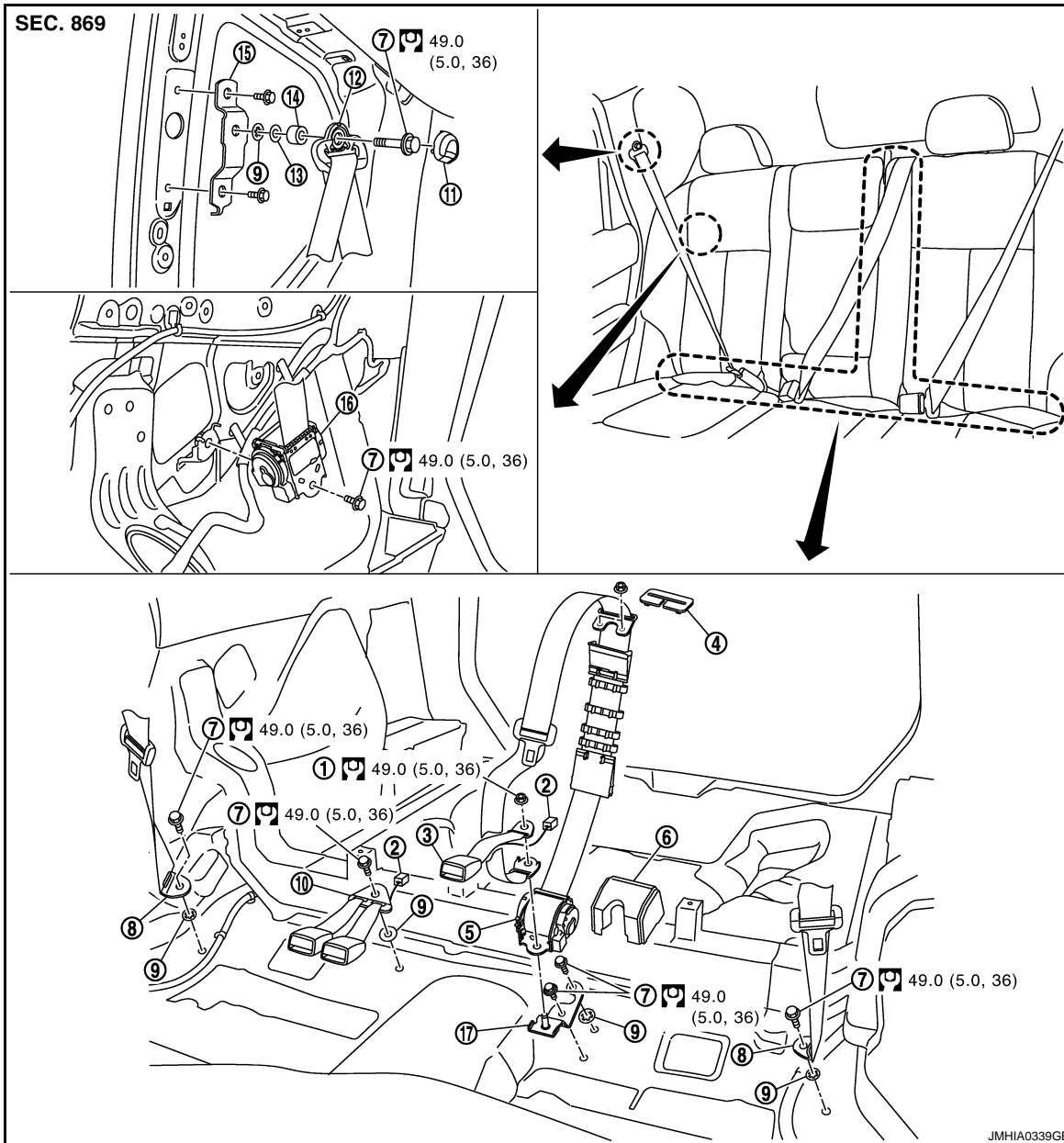

- |                                       |  |                                     |
|---------------------------------------|--|-------------------------------------|
| 1. Anchor nut                         | 2. Seat belt buckle harness connector  | 3. Outer seat belt buckle           |
| 4. Seat belt finisher                 | 5. Center seat belt retractor          | 6. Center seat belt retractor cover |
| 7. Anchor bolt                        | 8. Outer anchor                        | 9. Retaining washer                 |
| 10. Center and outer seat belt buckle | 11. Shoulder anchor cover              | 12. Shoulder anchor                 |
| 13. Plain washer                      | 14. Spacer                             | 15. Shoulder anchor bracket         |
| 16. Outer seat belt retractor         | 17. Center seat belt retractor bracket |                                     |

Refer to [GI-4, "Components"](#) for symbols in the figure.

## SEAT BELT RETRACTOR : Removal and Installation

INFOID:000000001283138

### REMOVAL

- Remove the center seat belt retractor.
  - Lift to fold seat cushion up.
  - Remove the center seat belt retractor fixing anchor nut.
  - Remove the outer seat belt buckle.

## REAR SEAT BELT

### < ON-VEHICLE REPAIR >

- Remove the seatback board. Refer to [SE-48. "Disassembly and Assembly"](#).
- Remove the seat belt finisher.
- Remove the seat belt mounting nut (A).

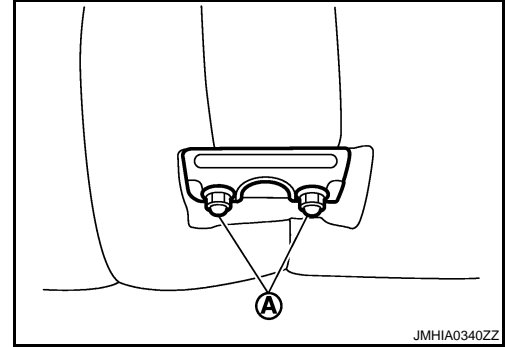

- Remove the hog ring securing upper portion of rear seatback trim.
- Remove the seat belt guide (1) and seat belt upper guide (2).

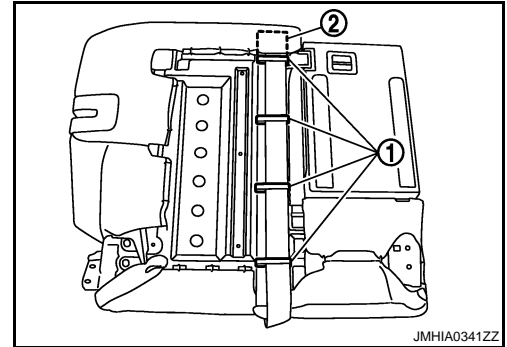

- Draw the seat belt tongue through the seatback upper side hole, and remove the center seat belt retractor from the seatback lower side.
2. Remove the outer anchor.  
Remove the outer lower anchor fixing anchor bolt and remove the outer anchor.
  3. Remove the shoulder anchor.
    - Remove the shoulder anchor cover.
    - Remove the shoulder anchor fixing anchor bolt and remove the shoulder anchor.
  4. Remove the outer seat belt retractor.
  5. Remove side seat belt retractor.
    - Remove the seatback. Refer to [SE-48. "Disassembly and Assembly"](#).
    - Remove the luggage side lower finisher. Refer to [INT-28. "Removal and Installation"](#).
    - Remove the fixing anchor bolt and the outer seat belt retractor.
  6. Remove the shoulder anchor bracket.
    - Remove the luggage side upper finisher. Refer to [INT-28. "Removal and Installation"](#).
    - Remove the shoulder anchor bracket fixing bolt and remove the shoulder anchor bracket.

### INSTALLATION

Install in the reverse order of removal.

### SEAT BELT BUCKLE

### SEAT BELT BUCKLE : Inspection

INFOID:000000001283142

### AFTER A COLLISION

#### **WARNING:**

**Inspect all seat belt assemblies including retractors and attached hardware after any collision. NISSAN/INFINITI recommends that all seat belt assemblies in use during a collision be replaced unless the collision was minor and the belts show no damage and continue to operate properly. Failure to do so could result in serious personal injury in an accident. Seat belt assemblies not in use during a collision should also be replaced if either damage or improper operation is noted. Seat belt pretensioners should be replaced even if the seat belts are not in use during a frontal collision in which the air bags are deployed.**

# REAR SEAT BELT

## < ON-VEHICLE REPAIR >

Replace any seat belt assembly (including anchor bolts) if:

- The seat belt was in use at the time of a collision (except for minor collisions and the belts, retractors and buckles show no damage and continue to operate properly).
- The seat belt was damaged in an accident. (i.e. torn webbing, bent retractor or guide, etc.)
- The seat belt attaching point was damaged in an accident. Inspect the seat belt attaching area for damage or distortion and repair it necessary before installing a new seat belt assembly.
- Anchor bolts are deformed or worn out.
- The seat belt pre-tensioner should be replaced even if the seat belts were not in use during the collision in which the air bags are deployed.

## PRELIMINARY CHECKS

1. Check that the seat belt retractor, seat belt anchor and buckle bolts are securely attached.
2. Repeat step above as necessary to check the other seat belts.

## SEAT BELT BUCKLE : Exploded View

INFOID:000000001559276

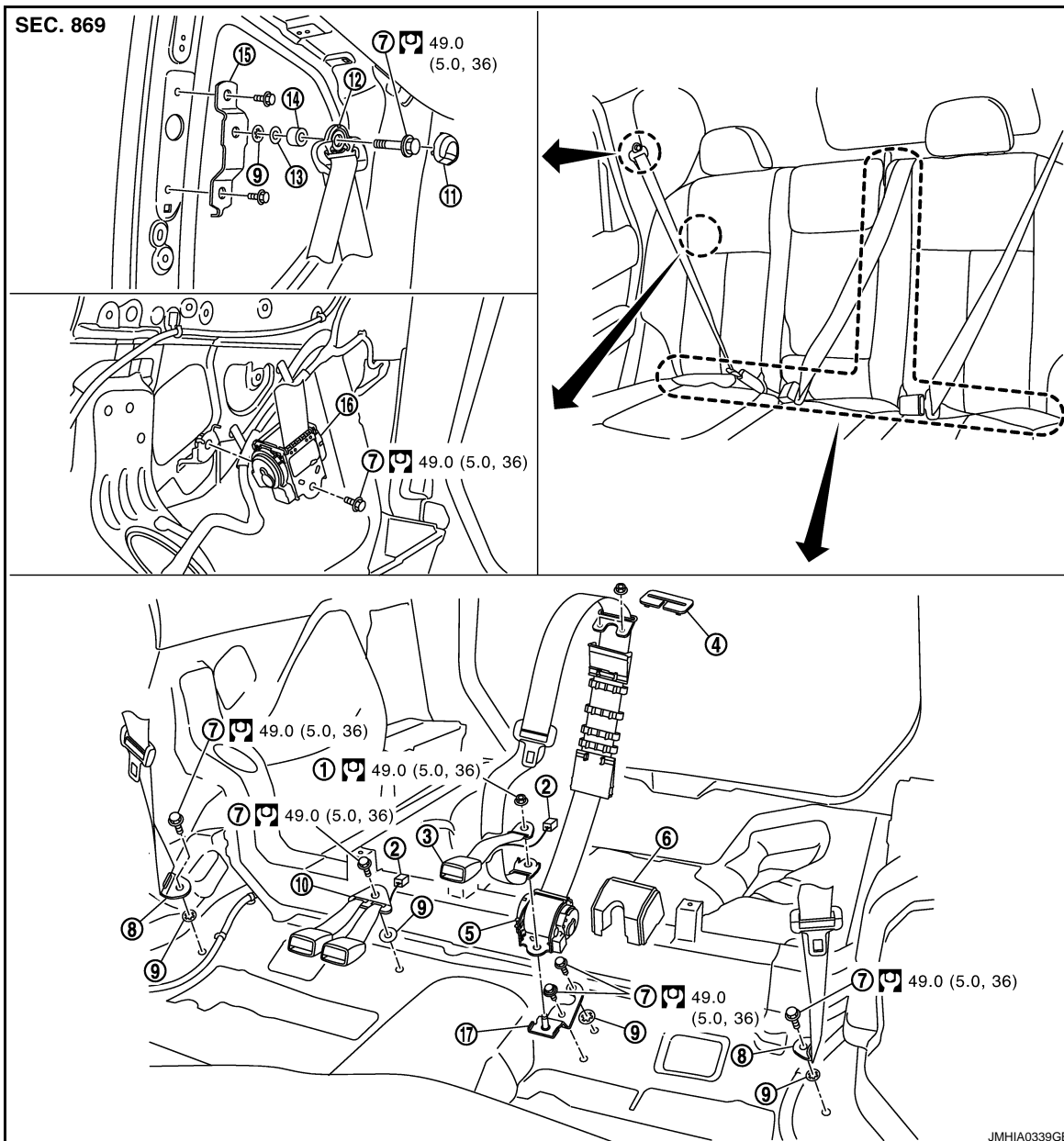

- |                       |                                       |                                     |
|-----------------------|---------------------------------------|-------------------------------------|
| 1. Anchor nut         | 2. Seat belt buckle harness connector | 3. Outer seat belt buckle           |
| 4. Seat belt finisher | 5. Center seat belt retractor         | 6. Center seat belt retractor cover |

# REAR SEAT BELT

## < ON-VEHICLE REPAIR >

- |                                       |  |                             |
|---------------------------------------|--|-----------------------------|
| 7. Anchor bolt                        | 8. Outer anchor                        | 9. Retaining washer         |
| 10. Center and outer seat belt buckle | 11. Shoulder anchor cover              | 12. Shoulder anchor         |
| 13. Plain washer                      | 14. Spacer                             | 15. Shoulder anchor bracket |
| 16. Outer seat belt retractor         | 17. Center seat belt retractor bracket |                             |

Refer to [GI-4. "Components"](#) for symbols in the figure.

## SEAT BELT BUCKLE : Removal and Installation

INFOID:000000001283144

### REMOVAL

Remove the seat belt buckle.

- Lift to fold seat cushion up.
- Disconnect the seat belt buckle harness connector.
- Remove the fixing anchor bolt and anchor nut of the inner anchor.

### INSTALLATION

Install in the reverse order of removal.

A  
B  
C  
D  
E  
F  
G  
I  
J  
K  
L  
M  
N  
O  
P

SB

# TOP TETHER STRAP CHILD RESTRAINT

< ON-VEHICLE REPAIR >

## TOP TETHER STRAP CHILD RESTRAINT

Exploded View

INFOID:000000001350743

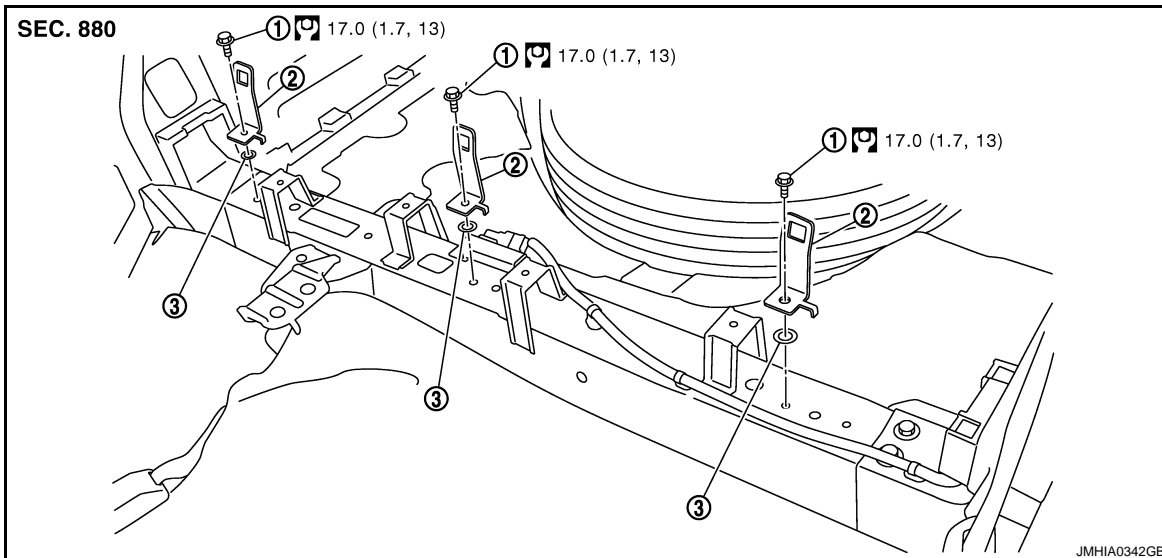

1. Anchor bolt

2. Anchor plate

3. Retaining washer

Refer to [GI-4, "Components"](#) for symbols in the figure.

## Removal and Installation

INFOID:000000001283147

### REMOVAL

#### **CAUTION:**

**Replace anchor bolts if they are deformed or worn out.**

1. Remove the luggage floor center finisher. Refer to [INT-28, "Exploded View"](#).
2. Remove the top tether strap child restraint.

### INSTALLATION

Install in the reverse order of removal.