

WHEEL BEARING

PERIODIC MAINTENANCE SERVICES

22. Wheel Bearing

A: INSPECTION

1. FRONT WHEEL BEARING

NOTE:

Inspect the condition of front wheel bearing grease.

- 1) Jack up the front of vehicle.
- 2) While holding front wheel by hand, swing it in and out to check bearing free play.
- 3) Loosen wheel nuts and remove front wheel.
- 4) If bearing free play exists in step 2) above, attach a dial gauge to hub and measure axial displacement in axial direction.

Service limit:

Straight-ahead position within 0.05 mm (0.0020 in)

- 5) Remove bolts and self-locking nuts, and extract transverse link from front crossmember.
 - 6) Remove SFJ (Non-TURBO model) or AAR (TURBO model) of front drive shaft from transmission. <Ref. to DS-29, Front Drive Shaft.>
 - 7) While supporting front drive shaft horizontally with one hand, turn hub with the other to check for noise or binding.
- If hub is noisy or binds, disassemble front axle and check condition of oil seals, bearing, etc.

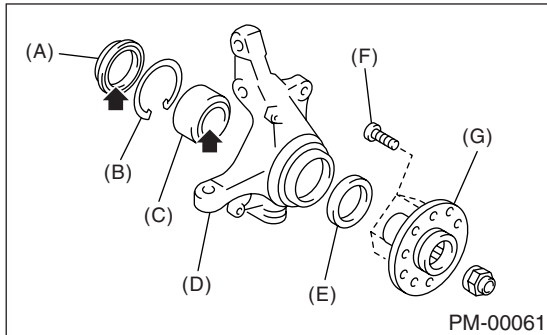

- (A) Inner oil seal
- (B) Snap ring
- (C) Bearing
- (D) Housing
- (E) Outer oil seal
- (F) Hub bolt
- (G) Hub

2. REAR WHEEL BEARING

- 1) Jack up the rear of vehicle.
- 2) While holding rear wheel by hand, swing it in and out to check bearing free play.
- 3) Loosen wheel nuts and remove rear wheel.
- 4) If bearing free play exists in step 2) above, attach a dial gauge to hub assembly and measure axial displacement in axial direction.

Service limit:

Straight-ahead position within 0.05 mm (0.0020 in)

- 5) Remove the DOJ of rear drive shaft from rear differential. <Ref. to DS-37, Rear Drive Shaft.>
 - 6) While supporting rear drive shaft horizontally with one hand, turn hub assembly with the other to check for noise or binding.
- If hub assembly is noisy or binds, disassemble rear axle and check condition of oil seals, bearings, etc.

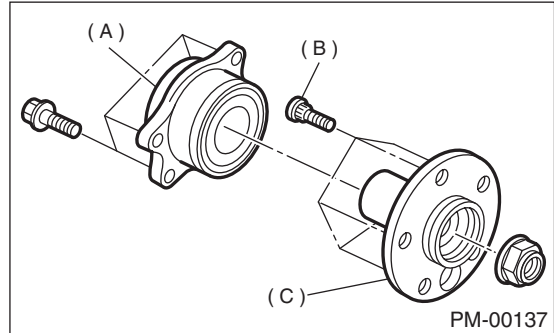

- (A) Hub unit
- (B) Hub bolt
- (C) Hub