

2. Accelerator Pedal

A: REMOVAL

- 1) Disconnect ground cable from battery.
- 2) Remove lock nut from accelerator cable bracket.
- 3) Remove accelerator cable from bracket.
- 4) Remove accelerator cable end from throttle cam.

NOTE:

Be careful not to kink accelerator cable.

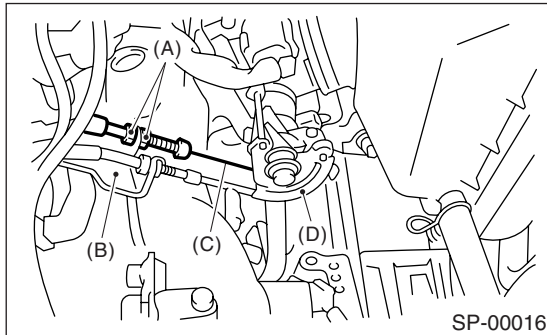

- (A) Lock nut
- (B) Accelerator cable bracket
- (C) Accelerator cable
- (D) Throttle cam

- 5) Remove clip inside engine compartment.

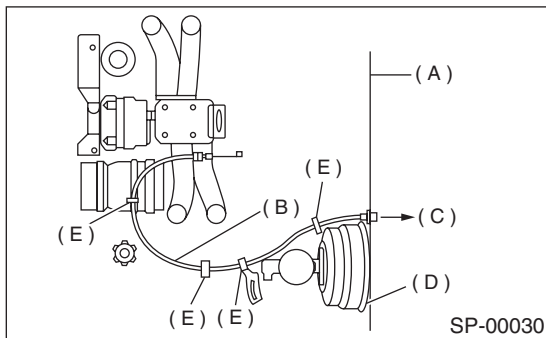

- (A) Toe board
- (B) Accelerator cable
- (C) Accelerator pedal
- (D) Brake booster
- (E) Clip

- 6) Remove instrument panel lower cover from instrument panel, and connector.

- 7) Remove accelerator pedal connecting bolt from accelerator pedal bracket.

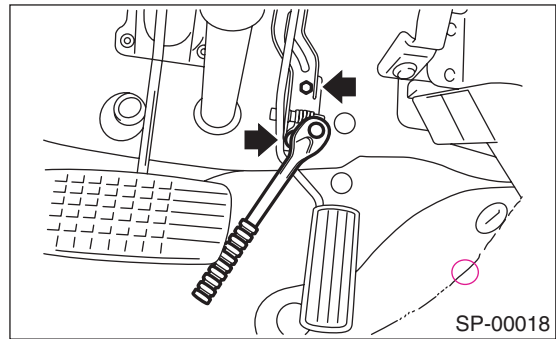

- 8) Disconnect grommet (A) from toe board.

NOTE:

From engine room side, push grommet (A) into hole.

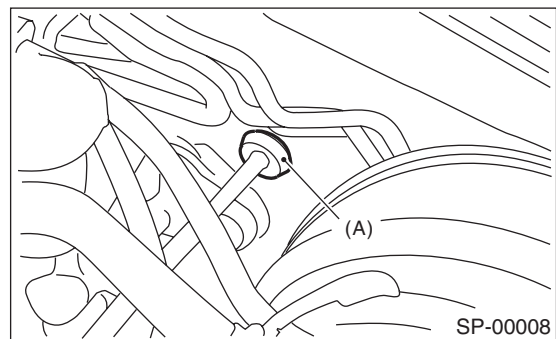

- (A) Grommet

- 9) Pull out the cable from the toe board hole.
- 10) Disconnect accelerator cable bushing from accelerator pedal lever.

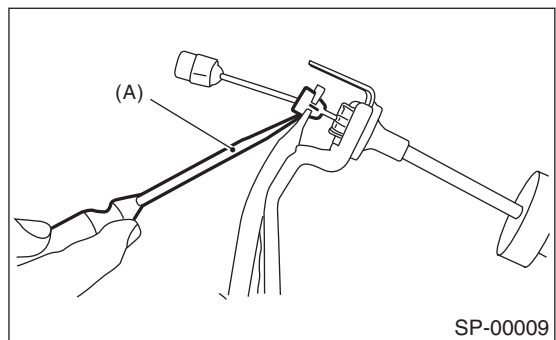

- (A) Flat-bladed screwdriver

ACCELERATOR PEDAL

SPEED CONTROL SYSTEMS

11) Disconnect accelerator cable stopper (A) from bracket.

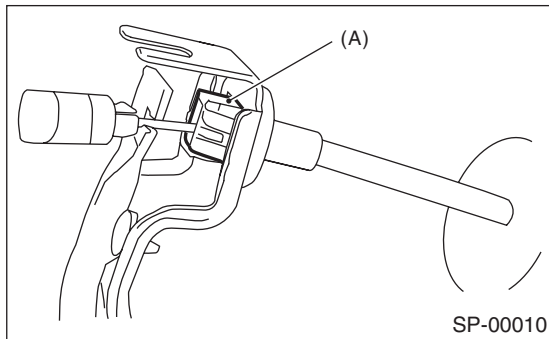

(A) Accelerator cable stopper

12) Remove accelerator cable and bracket.

B: INSTALLATION

1) Install in the reverse order of removal.

NOTE:

- If cable clamp is damaged, replace it with a new one.
- Never fail to cover outer cable end with boot.
- Be careful not to kink accelerator cable.

2) Adjust after pedal installation. <Ref. to SP(H4SO)-5, ADJUSTMENT, Accelerator Pedal.>

C: DISASSEMBLY

1) Remove the clip, and then remove the accelerator pedal from the bracket.

2) Pull out the spring pin, and then remove the accelerator pedal from the accelerator pedal lever.

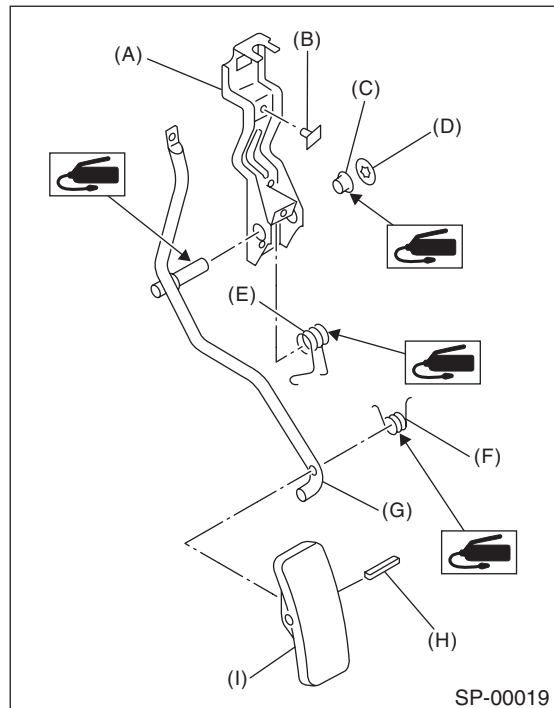

- (A) Bracket
- (B) Stopper
- (C) Bushing
- (D) Clip
- (E) Accelerator spring
- (F) Accelerator pedal spring
- (G) Accelerator pedal lever
- (H) Spring pin
- (I) Accelerator pedal

D: ASSEMBLY

Assemble in the reverse order of disassembly.

NOTE:

Clean areas as shown in the illustration and apply grease.

Grease:

Part No. 003602010 (SUNLIGHT No. 2)

E: INSPECTION

- 1) Lightly move pedal pad in lateral the direction to ensure pedal deflection is in specified range.
- 2) If excessive deflection is noted, replace bushing and clip with new ones.

Deflection of accelerator pedal:

Service limit

$\pm 2.0 \text{ mm } (\pm 0.079 \text{ in})$ or less

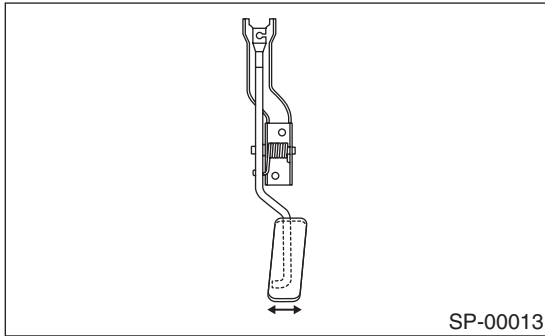

F: ADJUSTMENT

- 1) Check pedal stroke and free play by operating accelerator pedal by hand.
- 2) If it is not within specified value, adjust it by turning accelerator cable lock nut.

Free play at pedal pad: L

$0 - 4 \text{ mm } (0 - 0.16 \text{ in})$

Stroke at pedal pad: A

$50 - 55 \text{ mm } (1.97 - 2.17 \text{ in})$

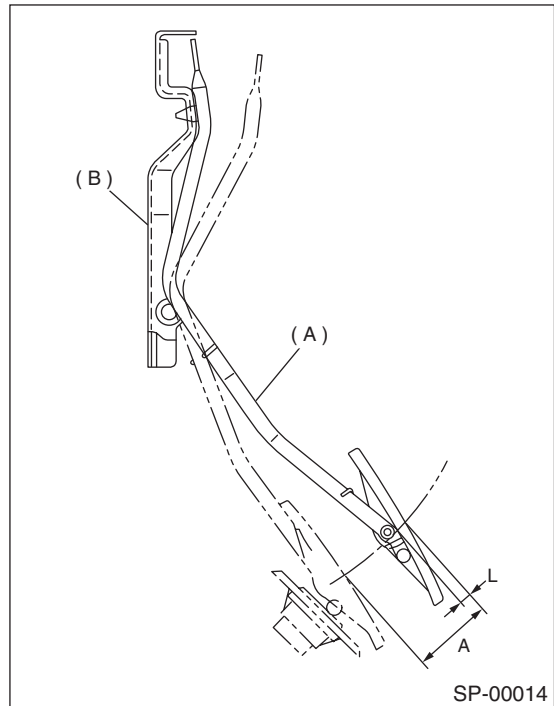

- (A) Accelerator pedal lever
- (B) Accelerator pedal bracket

Accelerator cable lock nut tightening torque:

$12 \text{ N}\cdot\text{m } (1.2 \text{ kgf}\cdot\text{m}, 9 \text{ ft}\cdot\text{lb})$