

PCV HOSE ASSEMBLY

EMISSION CONTROL (AUX. EMISSION CONTROL DEVICES)

16.PCV Hose Assembly

A: REMOVAL

CAUTION:

Removal is not allowed except for the damage of PCV hose, diagnosis connector and PCV valve.

- 1) Remove the intake manifold.
<Ref. to FU(H4DOTC)-15, REMOVAL, Intake Manifold.>
- 2) Unlock with a dent of special tool clipped by a protrusion of clamp.
- 3) Remove the PCV hose assembly.
ST 18353AA000 CLUMP PLIER

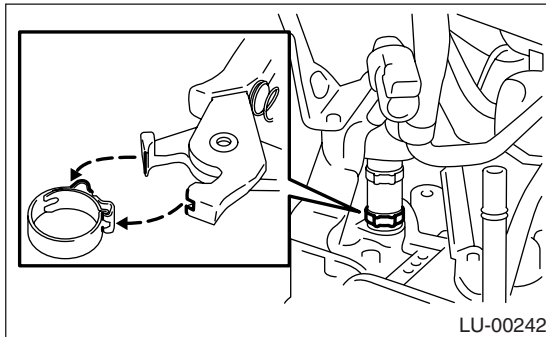

B: INSTALLATION

NOTE:

Replace the clamp with a new one.

- 1) Install the PCV hose assembly and lock it with a protrusion of clamp clipped by special tool.
ST 18353AA000 CLUMP PLIER

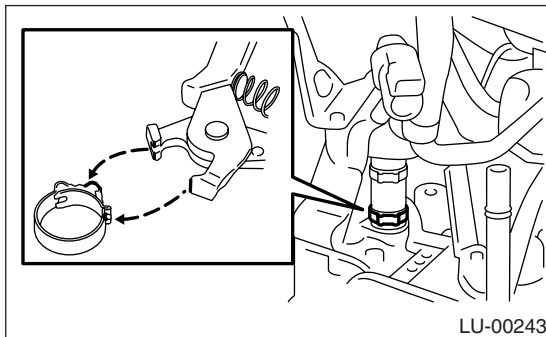

- 2) Install the intake manifold.
<Ref. to FU(H4DOTC)-17, INSTALLATION, Intake Manifold.>

PCV HOSE ASSEMBLY

EMISSION CONTROL (AUX. EMISSION CONTROL DEVICES)

MEMO: