

## 23. Dropping Resistor

### A: REMOVAL

**NOTE:**

Dropping resistor is installed only for NON-TURBO model.

1) Disconnect the ground cable from battery.

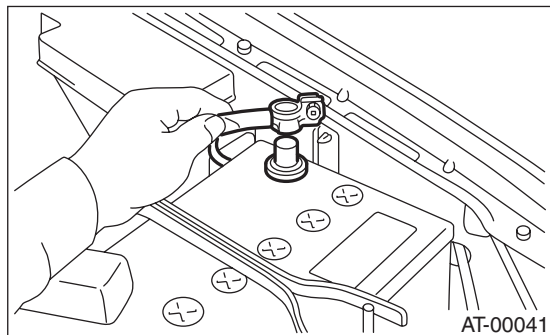

2) Remove the air intake duct.

<Ref. to IN(H4SO)-6, REMOVAL, Air Cleaner Case.>

3) Disconnect the connector from dropping resistor.

4) Remove the dropping resistor.

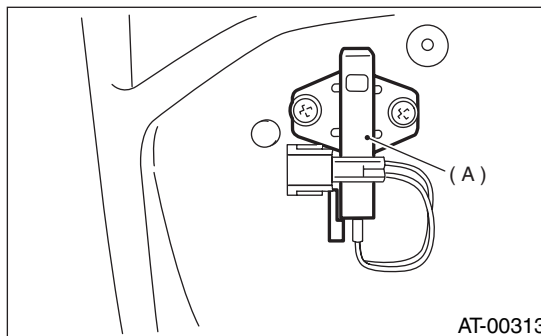

(A) Dropping resistor

### B: INSTALLATION

Install in the reverse order of removal.

**Tightening torque:**

**13 N·m (1.3 kgf-m, 10 ft-lb)**

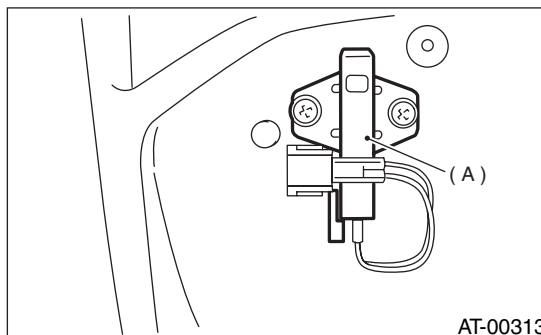

(A) Dropping resistor

### C: INSPECTION

Step	Check	Yes	No
<b>1 CHECK RESISTOR.</b> 1) Turn ignition switch to OFF. 2) Disconnect the connector from dropping resistor. 3) Measure the resistance between dropping resistor terminals. <b>Terminals</b> <b>No. 1 — No. 2:</b>	Is the resistance 9 — 15 Ω?	Go to step 2.	Replace the dropping resistor. <Ref. to 4AT-79, Dropping Resistor.>
<b>2 CHECK RESISTOR.</b> Measure the resistance between dropping resistor terminals. <b>Terminals</b> <b>No. 3 — No. 4:</b>	Is the resistance 9 — 15 Ω?	Dropping resistor is normal.	Replace the dropping resistor. <Ref. to 4AT-79, Dropping Resistor.>