

# UNIVERSAL JOINT

POWER ASSISTED SYSTEM (POWER STEERING)

## 3. Universal Joint

### A: REMOVAL

- 1) Set the vehicle on a lift.
- 2) Remove the steering wheel. <Ref. to PS-17, REMOVAL, Steering Wheel.>
- 3) Lift-up the vehicle.
- 4) Remove universal joint bolts and then remove universal joint.

#### CAUTION:

**Scribe alignment marks on universal joint so that it can be reassembled at the original serration.**

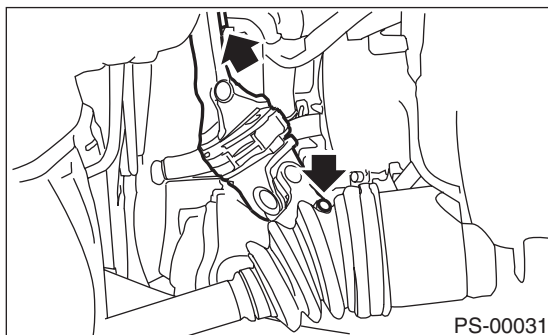

### B: INSTALLATION

- 1) Install universal joint.
  - (1) Align bolts hole on the long yoke side of universal joint with the cutout at the serrated section of shaft end, and insert universal joint.
  - (2) Align bolt hole on the short yoke side of universal joint with the cutout at the serrated section of gearbox assembly. Lower universal joint completely.
  - (3) Temporarily tighten bolt on the short yoke side. Raise universal joint to make sure the bolt is properly passing through the cutout at the serrated section.
  - (4) Tighten bolt on the long yoke, then that on the short yoke side.

#### Tightening torque:

**24 N·m (2.4 kgf·m, 17.4 ft·lb)**

#### CAUTION:

- Make sure that universal joint bolt is tightened through notch in shaft serration.
- Excessively large tightening torque of universal joint bolts may lead to heavy steering wheel operation.

#### Standard clearance between gearbox to DOJ:

**Over 15 mm (0.59 in)**

- 2) Lower the vehicle.
- 3) Align center of roll connector. <Ref. to AB-18, ADJUSTMENT, Roll Connector.>

#### CAUTION:

**Ensure that front wheel are set straight forward direction.**

- 4) Install steering wheel and airbag module. <Ref. to PS-17, INSTALLATION, Steering Wheel.>

#### WARNING:

**Always refer to “Airbag System” before performing airbag module service (if so equipped). <Ref. to AB-13, INSPECTION, Driver’s Airbag Module.> and <Ref. to AB-13, INSTALLATION, Driver’s Airbag Module.>**

# UNIVERSAL JOINT

POWER ASSISTED SYSTEM (POWER STEERING)

## C: INSPECTION

Clean the disassembled parts with a cloth, and check for wear, damage, or any other faults. If necessary, repair or replace faulty parts.

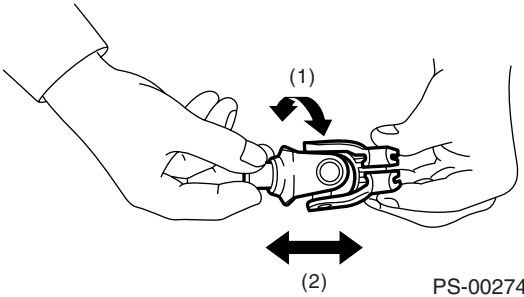
Inspection	Corrective action
<p>(1) Free play (2) Swinging torque Yawing torque Looseness</p>  <p>PS-00274</p> <p><b>Standard value of universal joint free play: 0 mm (0 in)</b> <b>Max. value of universal joint swinging torque: 0.3 N·m (0.03 kgf·m, 0.2 ft·lb)</b></p>	<p>Replace if faulty.</p>

Measurement of folding torque of universal joint is as shown in the figures.

**Service limit:**

**Maximum load; 5.49 N (0.56 kgf, 1.23 lb) or less**

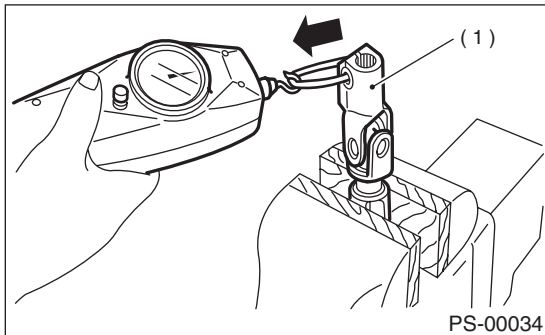

(1) Long yoke

**Service limit:**

**Maximum load; 5.49 N (0.56 kgf, 1.23 lb) or less**

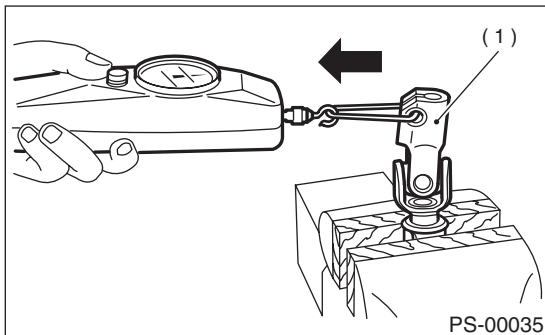

(1) Long yoke

**Service limit:**

**Maximum load; 8.43 N (0.86 kgf, 1.90 lb) or less**

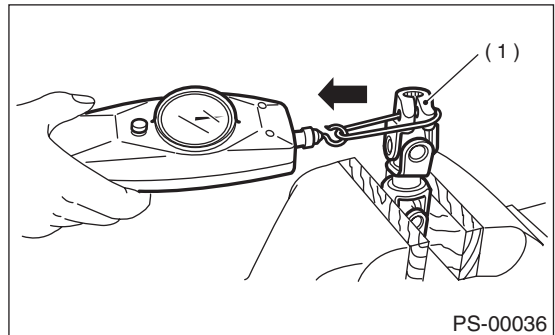

(1) Short yoke

**Service limit:**

**Maximum load; 8.43 N (0.86 kgf, 1.90 lb) or less**

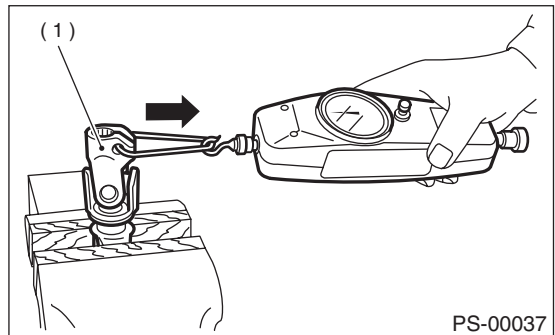

(1) Short yoke