

## 17. Instrument Panel Assembly

### A: REMOVAL

Airbag system wiring harness is routed near the combination meter.

#### WARNING:

- All airbag system wiring harness and connectors are colored yellow. Do not use electrical test equipment on these circuits.
- Be careful not to damage airbag system harness when servicing the instrument panel.

- 1) Disconnect ground cable from battery.
- 2) Remove lower cover.

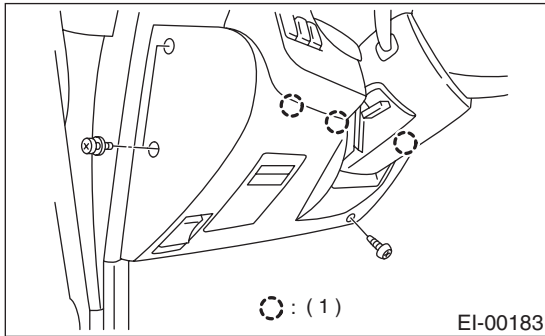

(1) Hook pawl

- 3) Remove lower column cover and disconnect harness connectors to steering column.

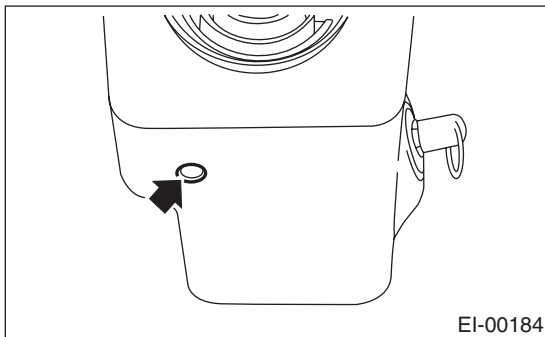

- 4) Remove steering column assembly (with steering wheel). <Ref. to PS-20, REMOVAL, Tilt Steering Column.>

- 5) Remove stopper (A) then remove glove box.

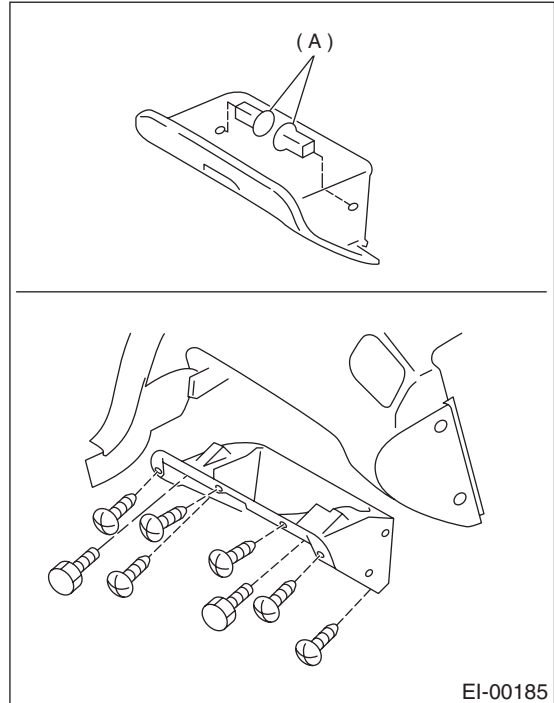

- 6) Remove side panel of both sides.

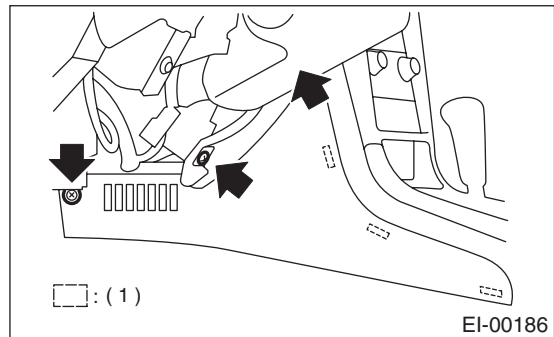

(1) Hook pawl

- 7) Remove passenger's airbag module. <Ref. to AB-14, REMOVAL, Passenger's Airbag Module.>
- 8) Remove console box. <Ref. to EI-36, REMOVAL, Console Box.>
- 9) Remove front pillar upper trim of both sides.

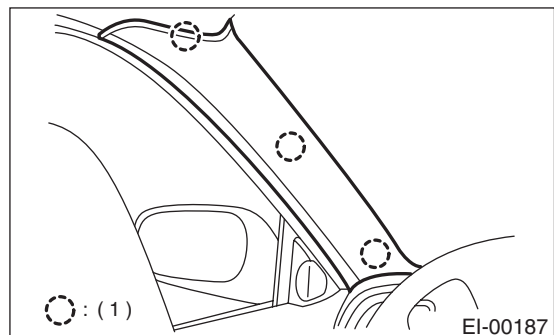

(1) Hook pawl

# INSTRUMENT PANEL ASSEMBLY

## EXTERIOR/INTERIOR TRIM

10) Remove front pillar lower trim (A) of passenger side.

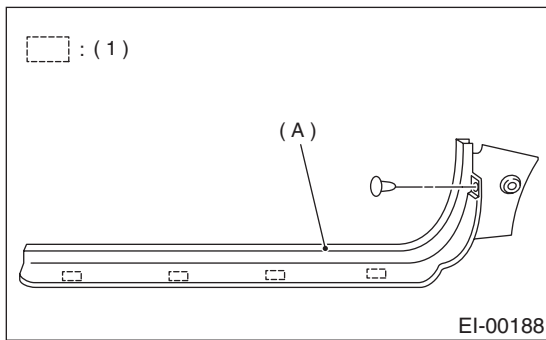

(1) Hook pawl

11) Set temperature control switch (A) to “FULL HOT” and then disconnect temperature control cable from bottom of heater unit. (Manual A/C equipped model)

### NOTE:

Do not move the switch and link when installing.

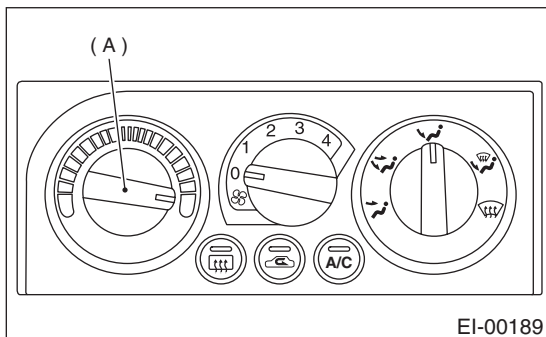

12) Remove instrument panel mounting bolts.

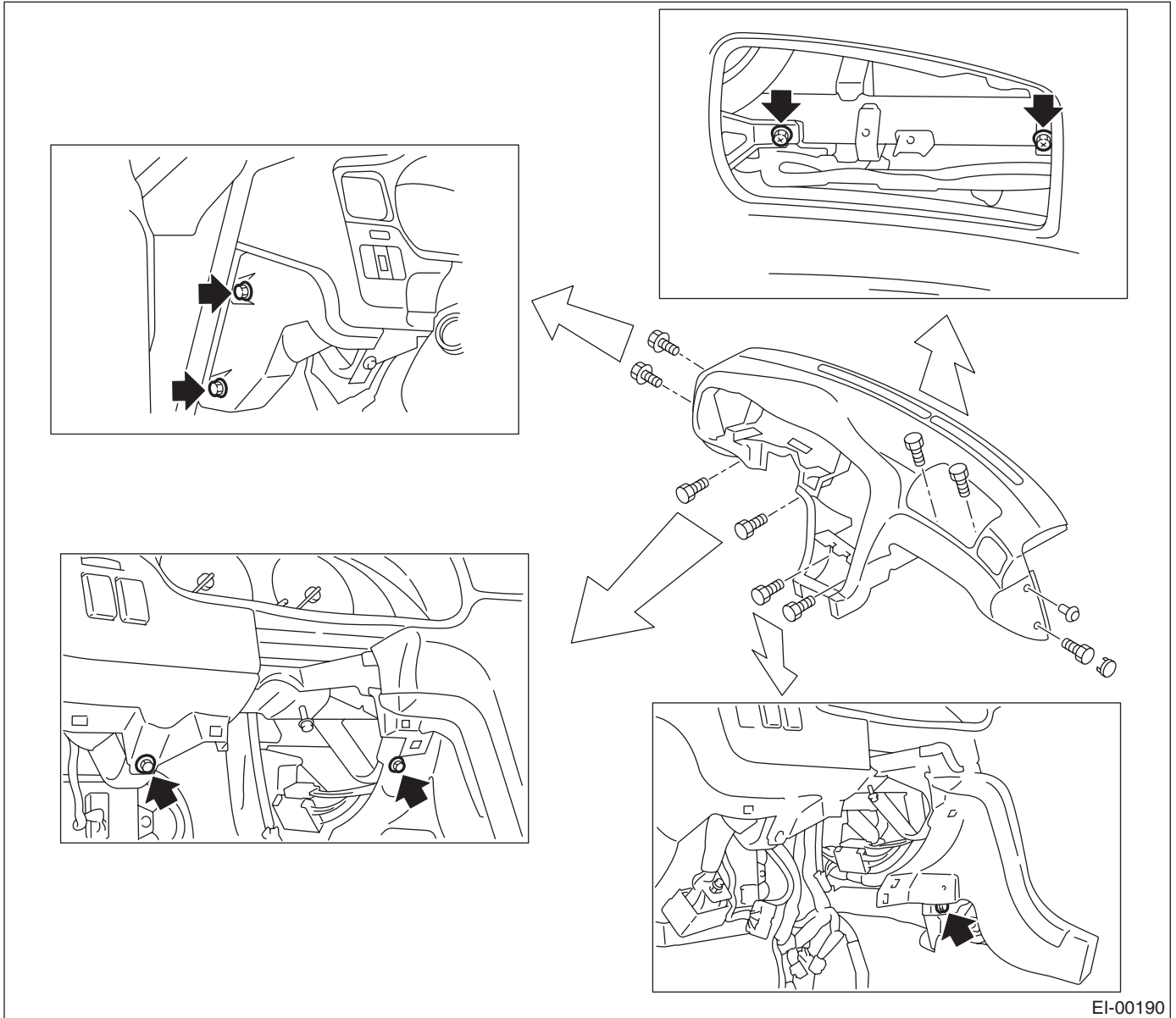

# INSTRUMENT PANEL ASSEMBLY

## EXTERIOR/INTERIOR TRIM

13) Disconnect harness connectors and remove instrument panel ASSY carefully.

### CAUTION:

**Do not pull the harness when disconnecting the connector.**

### NOTE:

If necessary, make matching marks for easy reassembly.

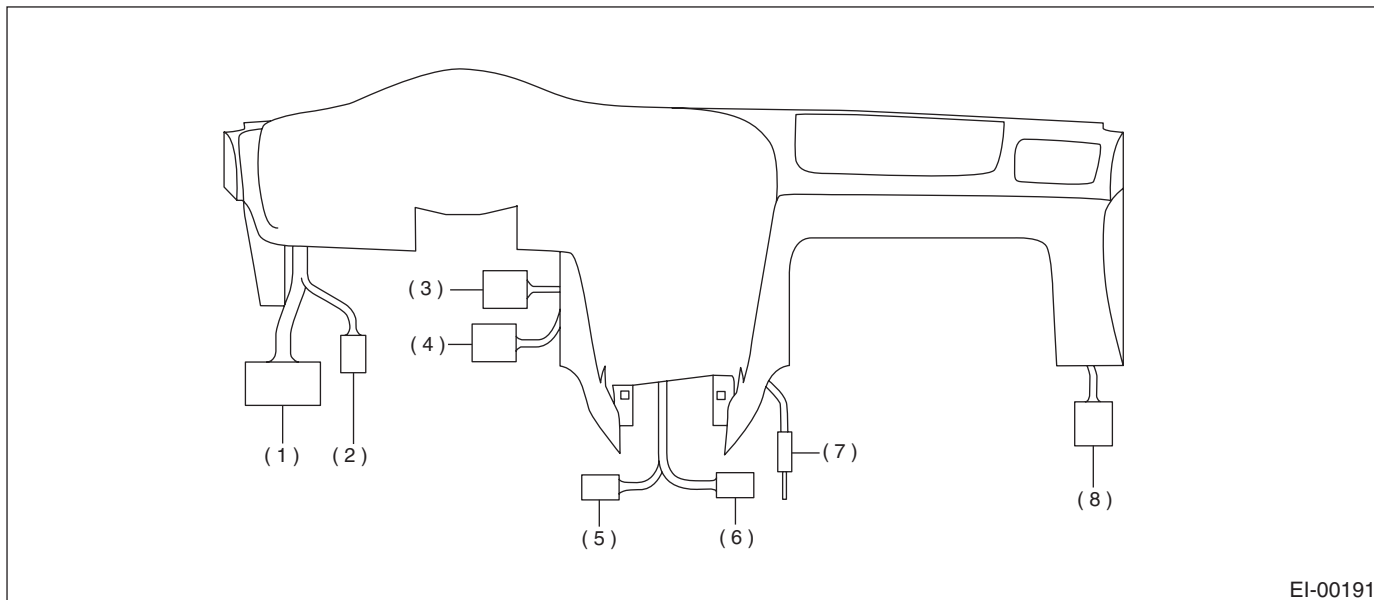

EI-00191

- (1) SMJ/White
- (2) 2P/Blue
- (3) 10P/White

- (4) 8P/White
- (5) 1P/Black
- (6) 1P/Black

- (7) Antenna feeder
- (8) 16P/Blue

### CAUTION:

- Take care not to scratch the instrument panel and related parts.
- When storing the removed instrument panel, place it standing up on the floor.

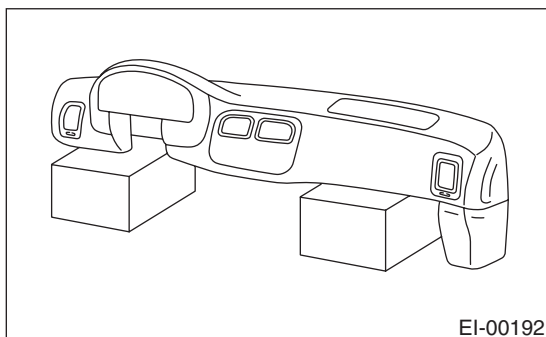

EI-00192

### NOTE:

When setting the instrument panel into position, push the three hooks into grommet (A) on the body panel.

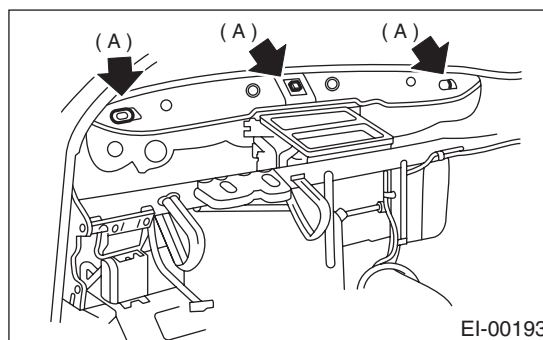

EI-00193

## B: INSTALLATION

Install in the reverse order of removal.

### CAUTION:

- Be careful not to snag the harness.
- Make sure to connect harness connector.
- Take care not to scratch the instrument panel and related parts.

### Tightening torque:

Refer to **COMPONENT** in *General Description*. <Ref. to EI-9, **INSTRUMENT PANEL, COMPONENT, General Description**.>