

# FRONT SEAT

## SEATS

### 2. Front Seat

#### A: REMOVAL

##### 1. STANDARD SEAT

- 1) Disconnect ground cable from battery.
- 2) While pressing headrest lock button, remove headrest.

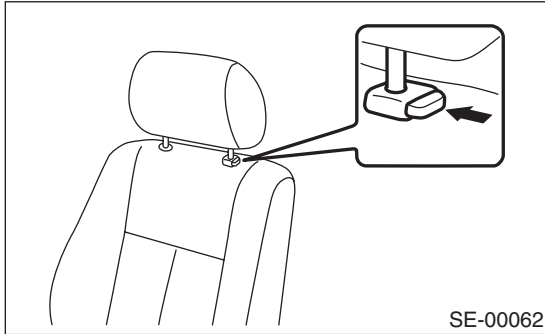

- 3) Tilt forward backrest.
- 4) Move seat to full front end.
- 5) Remove bolt cover at rear end of slide rail.

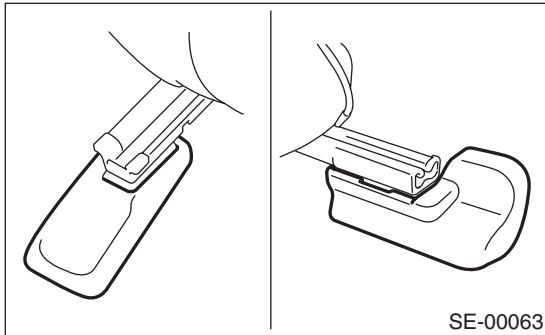

- 6) Disconnect connectors of seat heater and seat belt warning. (Seat heater equipped vehicle)
- 7) Remove two bolts at rear side of seat rail.

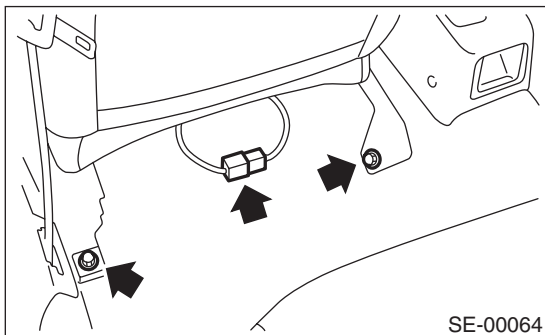

- 8) Move seat to full rear end.
- 9) Remove two bolts at front side of seat rail.

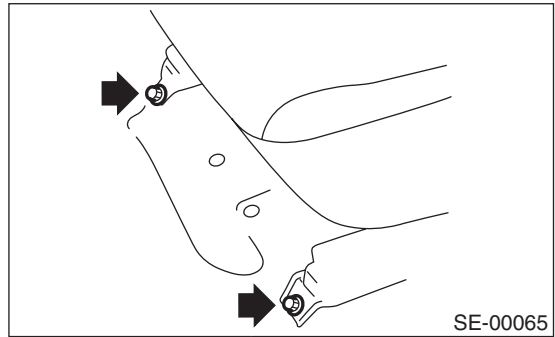

- 10) Remove front seat from vehicle.

#### CAUTION:

**When removing seat from vehicle, take care not to damage body, seat, or trim.**

##### 2. POWER SEAT

- 1) While pressing headrest lock button, remove headrest.

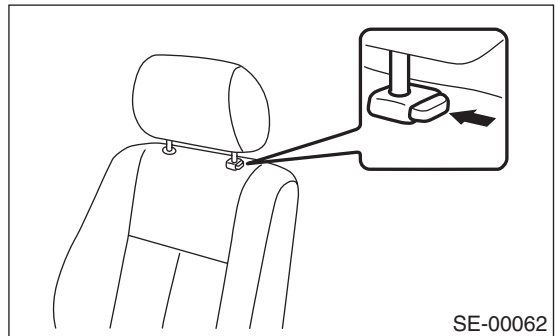

- 2) Tilt forward backrest.
- 3) Move seat to full front end.
- 4) Remove bolt cover at rear end of slide rail.

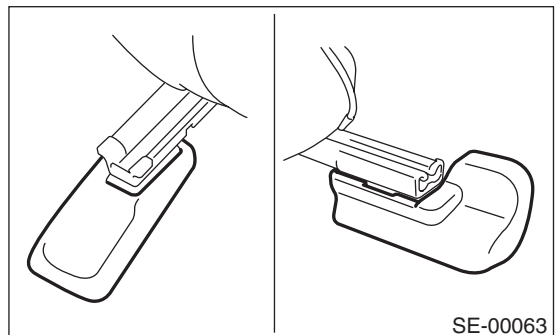

5) Remove two bolts at rear side of seat rail.

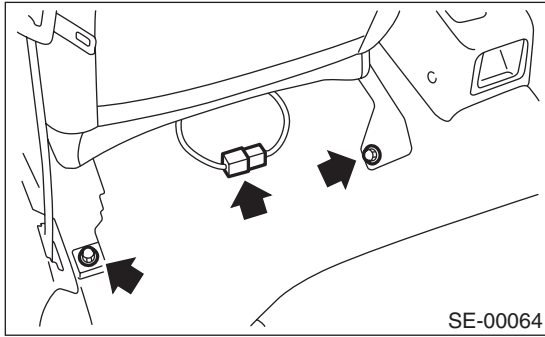

6) Move seat to full rear end.

7) Remove two bolts at front side of seat rail.

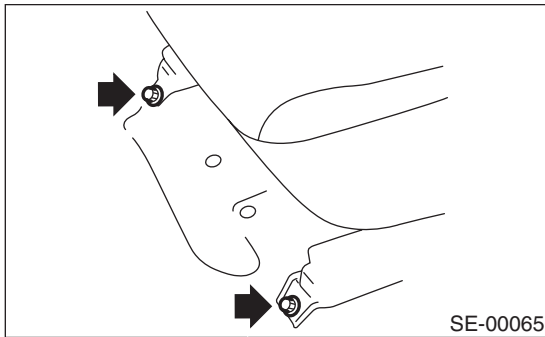

8) Disconnect ground cable from battery.

9) Disconnect connectors of seat heater and seat belt warning. (Seat heater equipped vehicle)

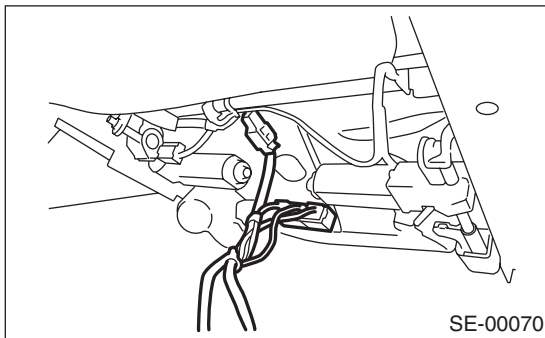

10) Remove front seat from vehicle.

**CAUTION:**

When removing seat form vehicle, take care not to damage body, seat, or trim.

## B: INSTALLATION

### 1. STANDARD SEAT

1) Install in the reverse order of removal.

2) Place slide rail rear inner on location bolts (A).

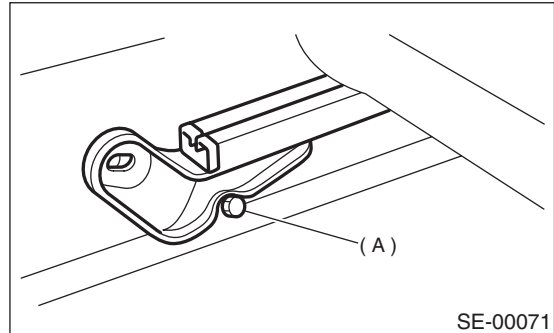

3) Tighten the four bolts of slide rail.

**CAUTION:**

Confirm that seat can move smoothly and be locked securely at any position.

### 2. POWER SEAT

1) Install in the reverse order of removal.

2) Place slide rail rear inner on location bolts (A).

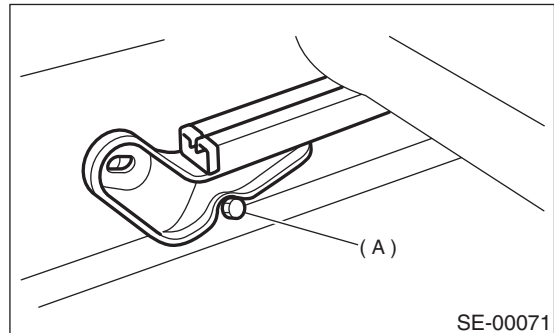

3) Tighten the four bolts of slide rail.

**CAUTION:**

Confirm that seat can move smoothly.

**Tightening torque:**

Refer to **COMPONENT** in *General Description*.

<Ref. to SE-2, FRONT SEAT, COMPONENT, General Description.>

# FRONT SEAT

## SEATS

### C: DISASSEMBLY

#### 1. STANDARD SEAT

1) Remove seats from vehicle. <Ref. to SE-6, REMOVAL, Front Seat.>

2) Remove lumbar lever cover.

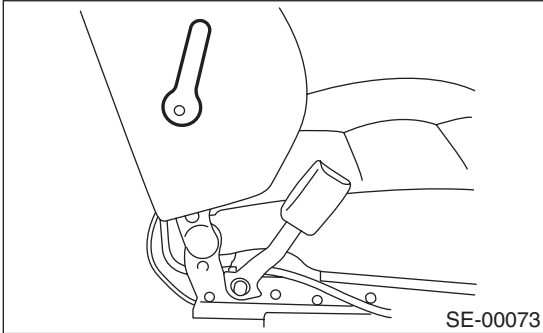

3) Remove hook at bottom, and then remove seat back board.

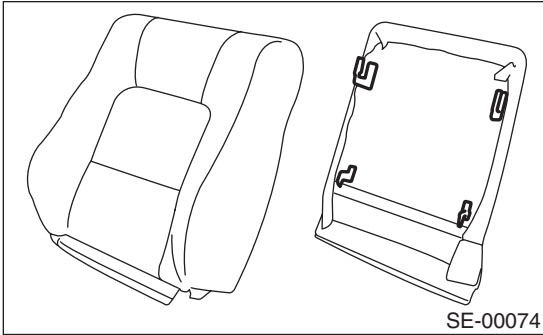

4) Remove hook on back side of seat, and remove hog rings using a plier.

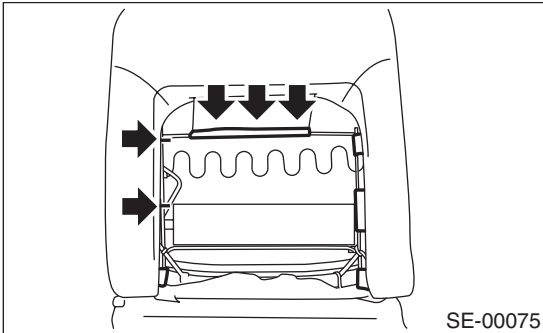

5) Remove clamp of seat heater wire harness. (Seat heater equipped vehicle)

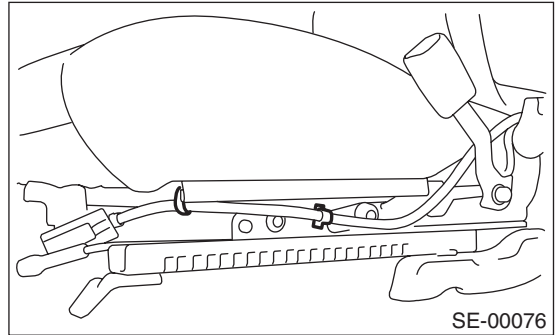

6) Turn cover and cushion, and remove the two bolts from hinge.

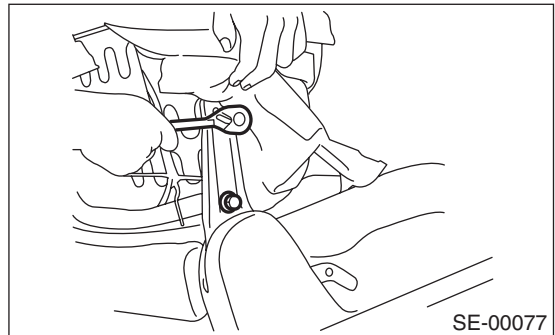

7) Remove hinge screw cover and screws, and remove seat back from hinge.

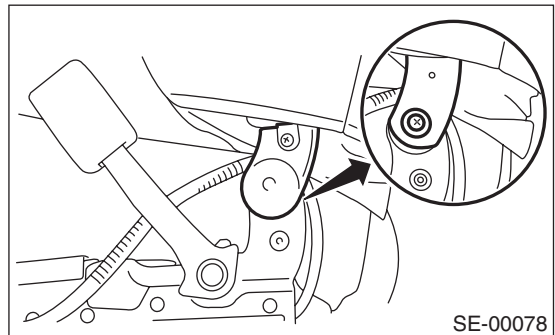

8) While picking up tip with a plier, remove head-rest lock bushing.

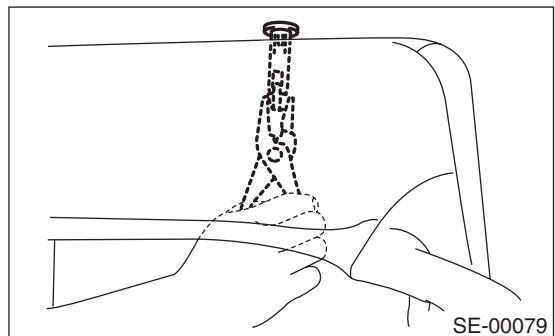

9) Remove hog ring (A) on front face of seat.

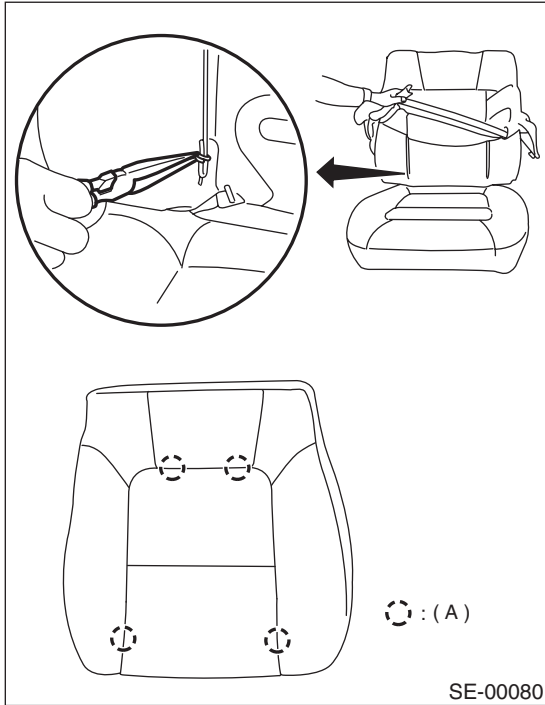

10) Remove hog rings, and then remove seat heater. (Seat heater equipped vehicle)

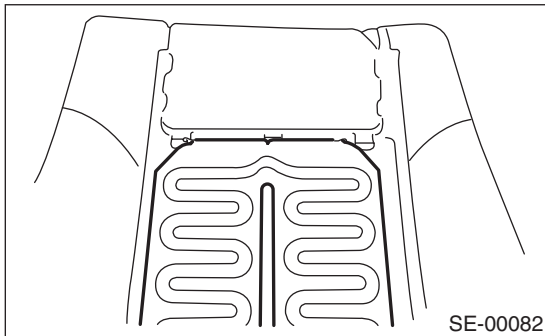

11) Remove seat cover.

12) Remove backrest pad.

13) Remove reclining cover and hinge cover. (Non-tilt type vehicle)

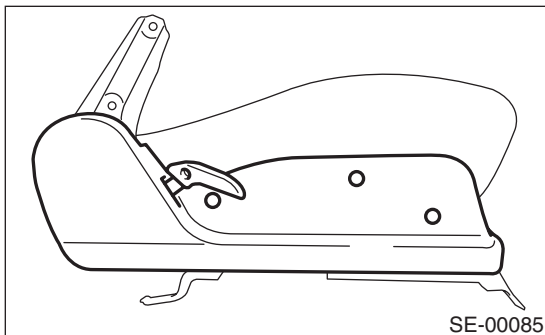

14) Remove the 4 bolts of seat hinge assembly, and then remove seat cushion.

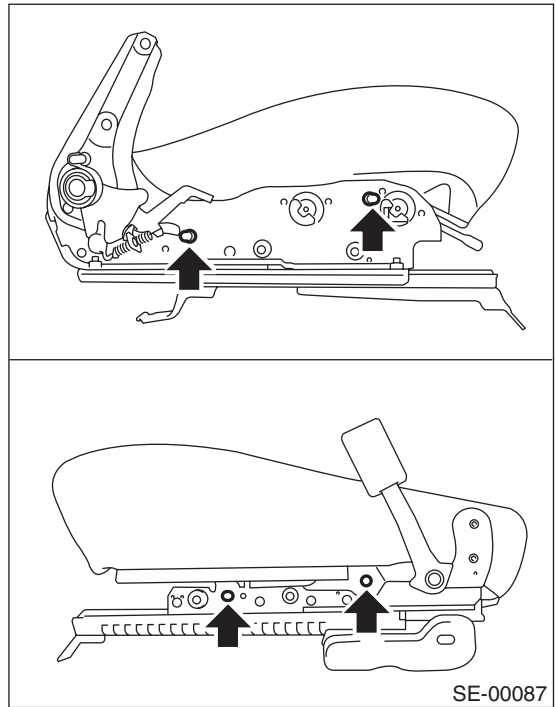

15) Remove hook clips on back side of seat cushion, and remove wire rings.

16) Remove clamp of seat heater wire harness. (Seat heater equipped vehicle)

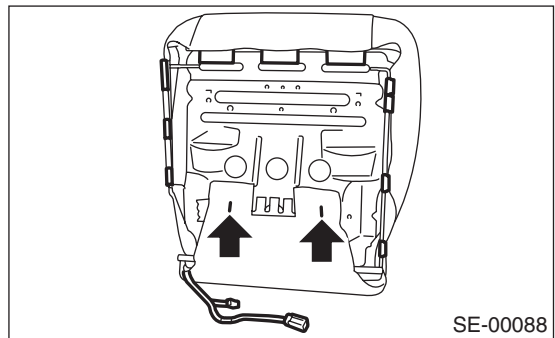

17) Remove hog rings (A).

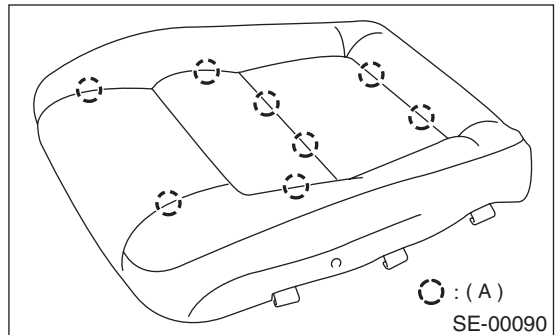

# FRONT SEAT

## SEATS

- 18) Remove cushion cover.
- 19) Remove cushion pad.
- 20) Remove reclining lever cover.

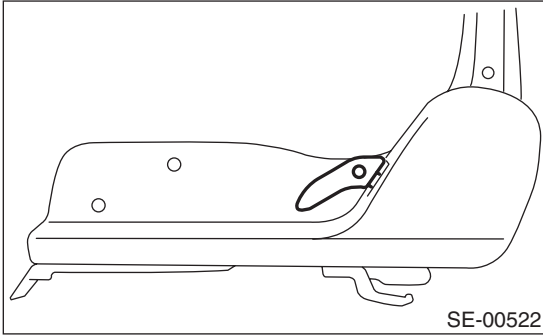

- 21) Remove hinge cover cap and screws.

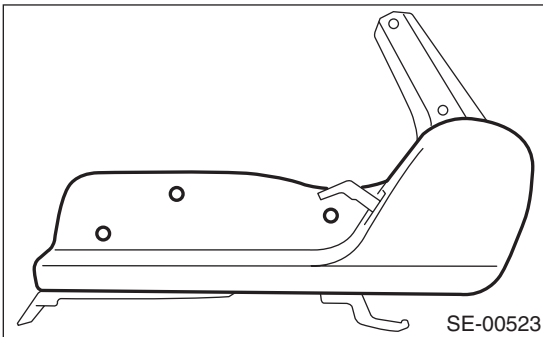

- 22) Remove seat hinge cover and hinge spring cover.

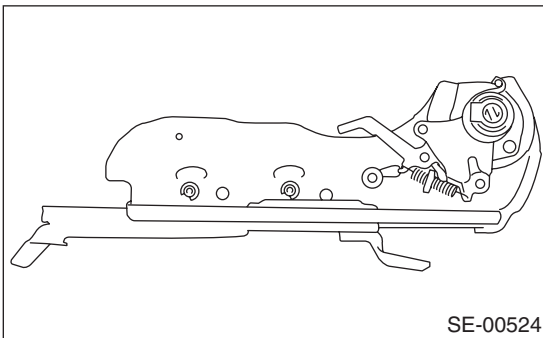

- 23) Remove 2 bolts, and then remove slide rail.

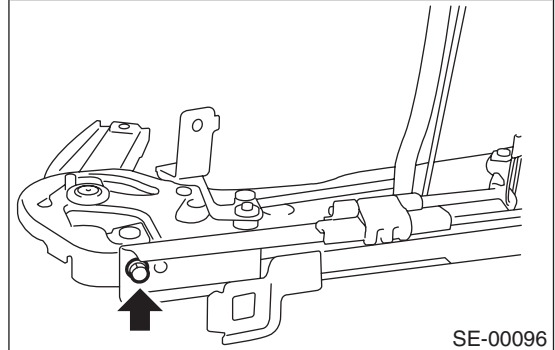
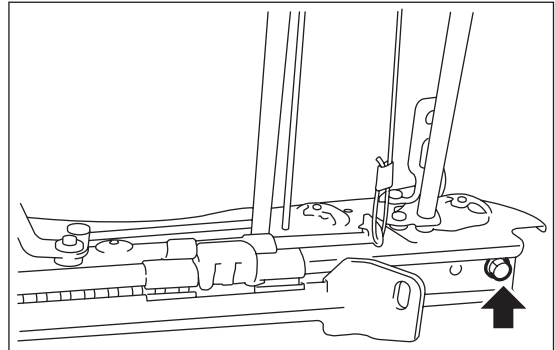

- 24) Remove 4 screws, and then remove hinge.

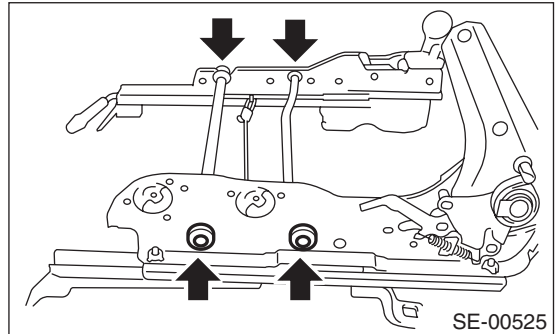

- 25) Remove 2 bolts, and then remove slide rail.

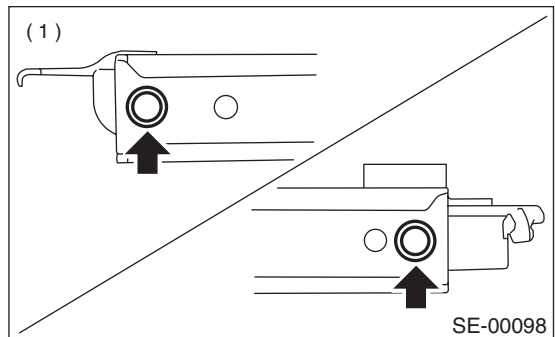

(1) Lower side of seat rail

- 26) Remove connecting wire.

## 2. POWER SEAT

- 1) Remove seats from vehicle. <Ref. to SE-6, REMOVAL, Front Seat.>
- 2) Remove lumbar lever cover.

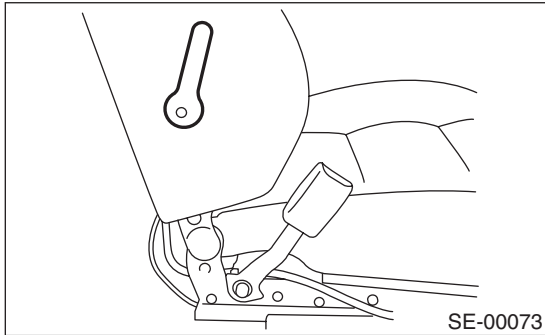

- 3) Remove hook at bottom, and then remove seat back board.

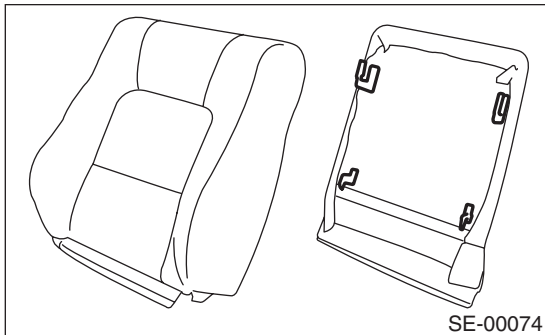

- 4) Remove hook on back side of seat, and remove wire rings using a plier.

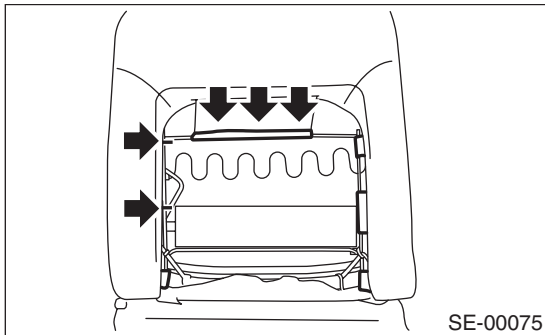

- 5) Remove clamp of seat heater wire harness. (Seat heater equipped vehicle)

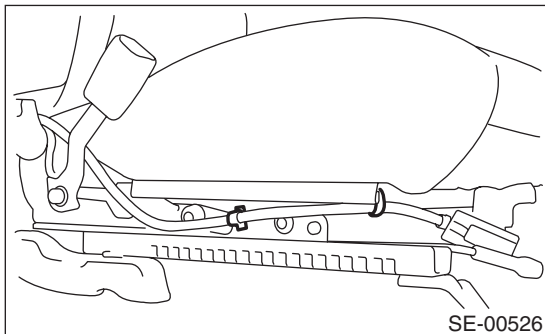

- 6) Turn cover and cushion, and remove the two bolts from hinge.

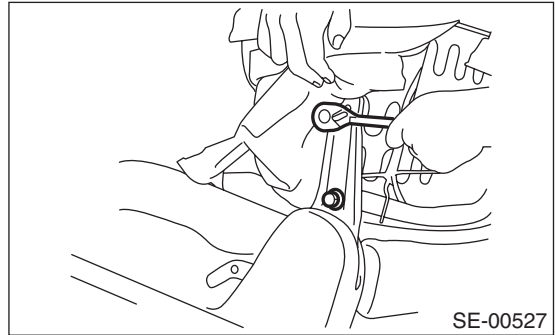

- 7) Remove hinge screw cover and screws, and remove seat back from hinge.

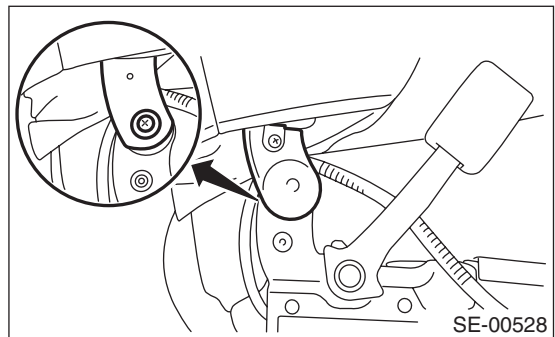

- 8) While picking up tip with a plier, remove head-rest lock bushing.

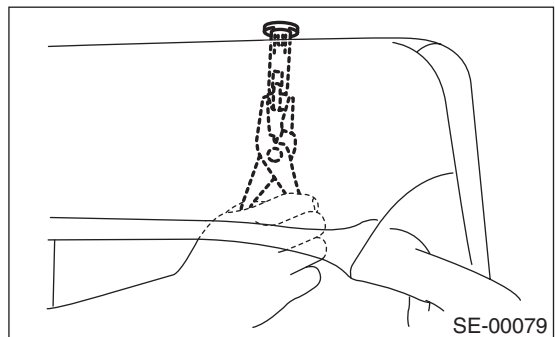

# FRONT SEAT

## SEATS

9) Remove hog ring (A) on front face of seat.

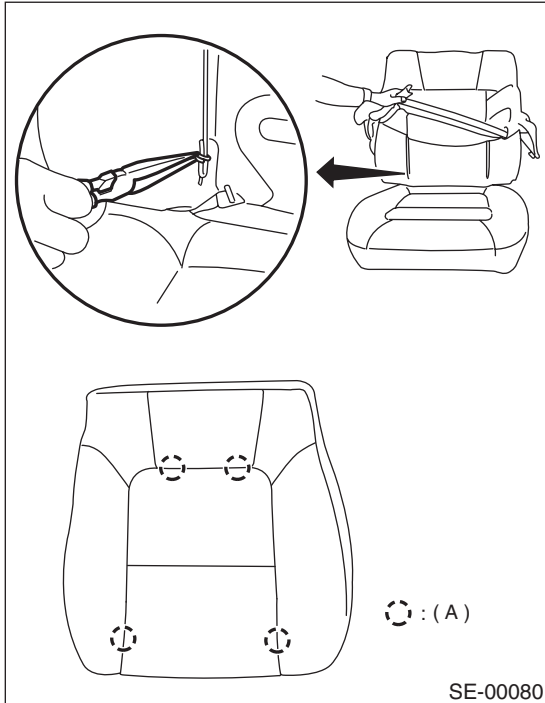

10) Remove wire rings, and then remove seat heater. (Seat heater equipped vehicle)

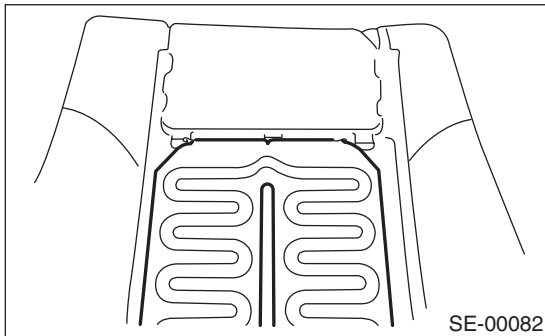

11) Remove seat cover.

12) Remove backrest pad.

13) Remove the 4 bolts of seat hinge assembly, and then remove seat cushion.

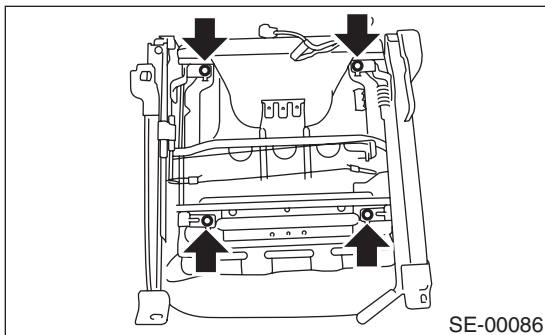

14) Remove hook clips on back side of seat cushion, and remove wire rings.

15) Remove clamp of seat heater wire harness. (Seat heater equipped vehicle)

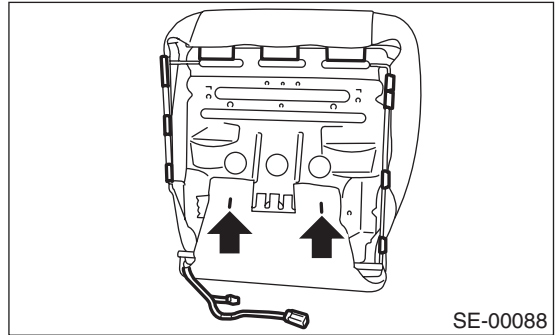

16) Remove hog rings (A).

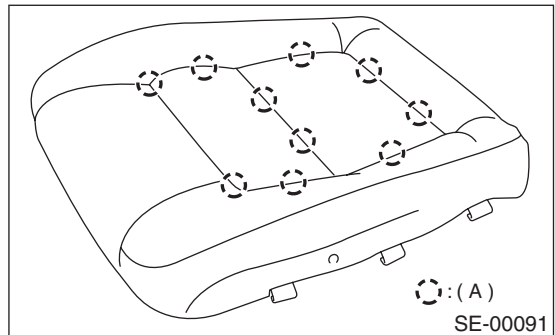

17) Remove cushion cover.

18) Remove cushion pad.

19) Remove the screw and then remove the cover.

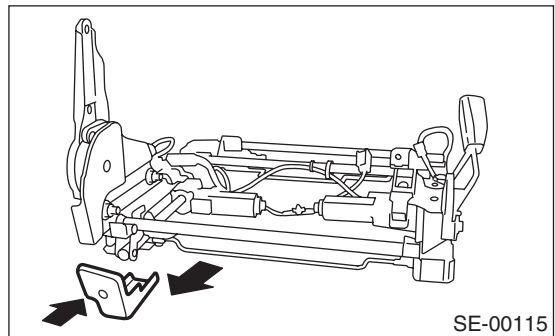

20) Remove the reclining lever cover and screw, disconnect the seat switch connector on the underside of the cover, and remove the hinge cover.

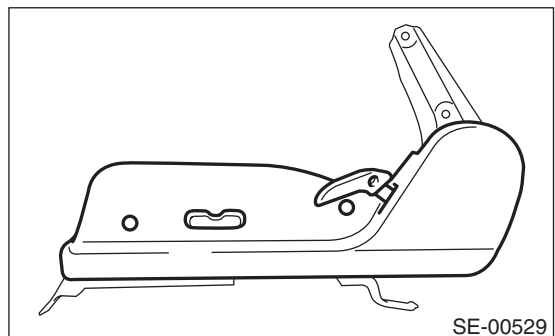

21) Remove the cover on the underside of the seat hinge, remove the two bolts, and remove the seat hinge.

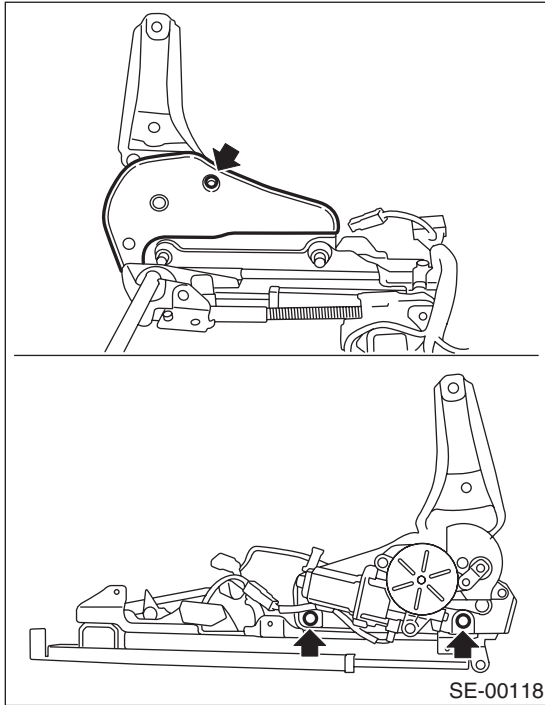

## D: ASSEMBLY

### 1. STANDARD SEAT

1) Assemble in the reverse order of disassembly.

#### NOTE:

- Do not contaminate or damage cover.
- While installing hog rings, prevent seat from getting wrinkled.

2) Attach seat cover end hole to hinge inner.

### 2. POWER SEAT

1) Assemble in the reverse order of disassembly.

#### NOTE:

- Do not contaminate or damage cover.
- While installing hog rings, prevent seat from getting wrinkled.
- Make sure the connector is firmly connected.
- Make sure the wire harness is not pinched.

2) Attach seat cover end hole to hinge inner.

#### **Tightening torque:**

**Refer to COMPONENT in General Description.**

**<Ref. to SE-2, FRONT SEAT, COMPONENT, General Description.>**