

SUNROOF SWITCH

SUNROOF/T-TOP/CONVERTIBLE TOP (SUNROOF)

6. Sunroof Switch

A: REMOVAL

- 1) Disconnect ground cable from battery.
- 2) Remove spot light lens (A) and sunroof switch mounting screw (B).

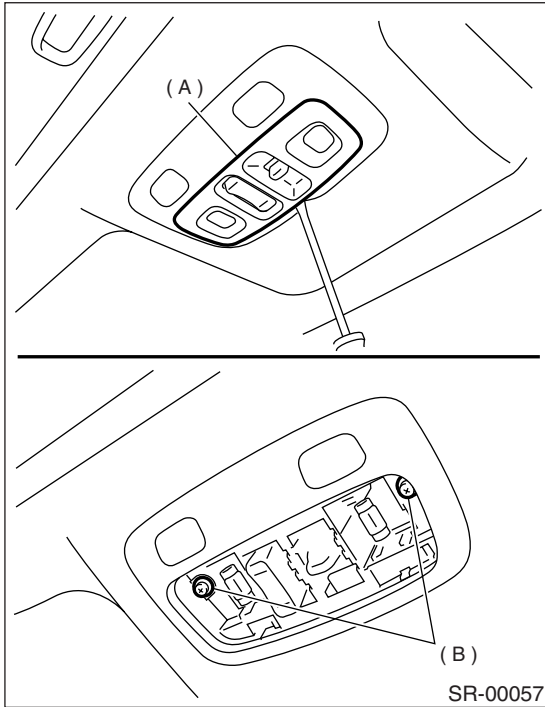

- 3) Disconnect harness connectors and remove sunroof switch.

B: INSTALLATION

Install in the reverse order of removal.

C: INSPECTION

Measure sunroof switch resistance.

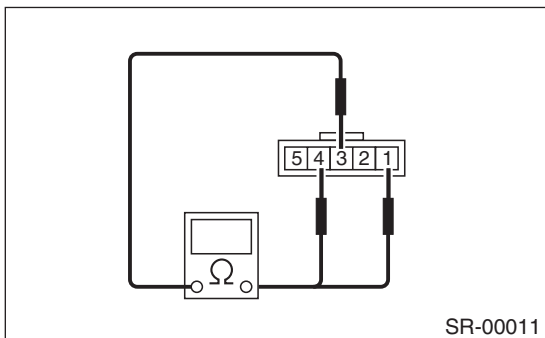

Switch position	Terminal No.	Specified condition
Open	3 and 4	Less than 1 Ω
Close	1 and 3	Less than 1 Ω
Tilt up	3 and 4	Less than 1 Ω
Tilt down	1 and 3	Less than 1 Ω