

2. Radiator and Radiator Fan

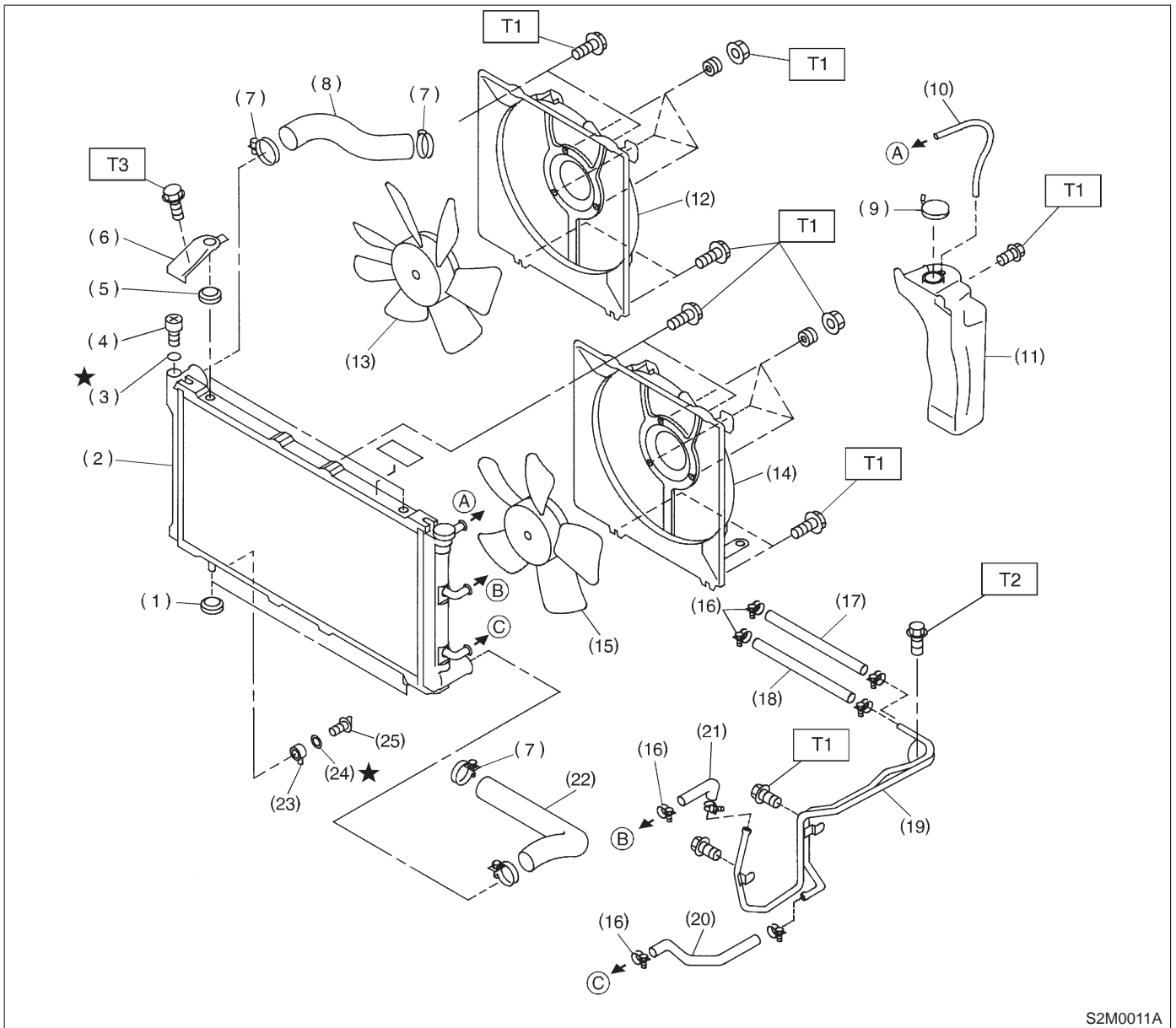

S2M0011A

- | | | |
|---------------------------------------|---|--|
| (1) Radiator lower cushion | (13) Radiator sub fan ASSY | (21) ATF inlet hose B (AT vehicles only) |
| (2) Radiator | (14) Main fan shroud | (22) Radiator outlet hose |
| (3) O-ring | (15) Radiator main fan ASSY | (23) Radiator drain pipe |
| (4) Air vent plug | (16) ATF hose clamp (AT vehicles only) | (24) Gasket |
| (5) Radiator upper cushion | (17) ATF inlet hose A (AT vehicles only) | (25) Radiator drain plug |
| (6) Radiator upper bracket | (18) ATF outlet hose A (AT vehicles only) | |
| (7) Clamp | (19) ATF pipe (AT vehicles only) | |
| (8) Radiator inlet hose | (20) ATF outlet hose B (AT vehicles only) | |
| (9) Engine coolant reservoir tank cap | | |
| (10) Over flow hose | | |
| (11) Engine coolant reservoir tank | | |
| (12) Sub fan shroud | | |

Tightening torque: N·m (kg·m, ft·lb)
T1: 7.4±2.0 (0.75±0.20, 5.4±1.4)
T2: 12±3 (1.2±0.3, 8.7±2.2)
T3: 18±5 (1.8±0.5, 13.0±3.6)