

8. Engine Coolant

A: DRAINING OF ENGINE COOLANT

- 1) Lift-up the vehicle.
- 2) Remove under cover.
- 3) Fit vinyl tube to drain pipe.

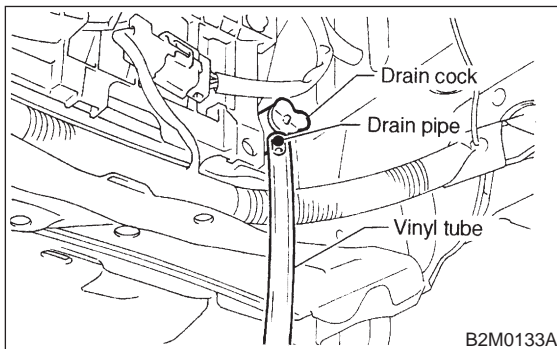

- 4) Loosen drain cock to drain engine coolant into container.

NOTE:

Remove radiator cap so that engine coolant will drain faster.

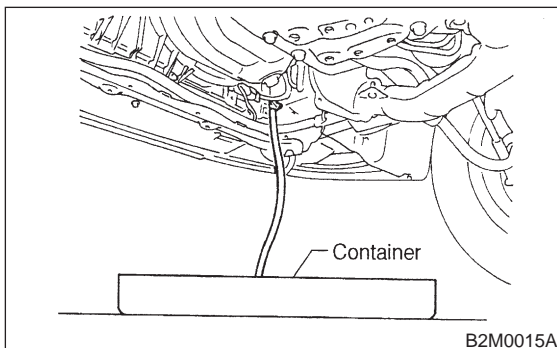

B: FILLING OF ENGINE COOLANT

- 1) Remove air vent plug from radiator.

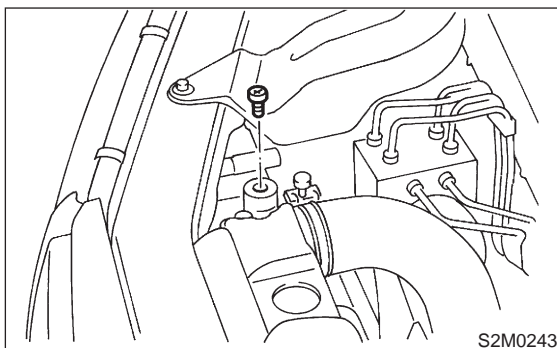

- 2) Fill engine coolant into radiator up to filler neck position.

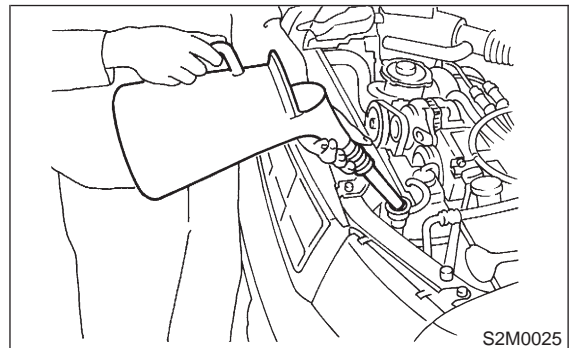

- 3) Fill engine coolant into reservoir tank up to upper level.

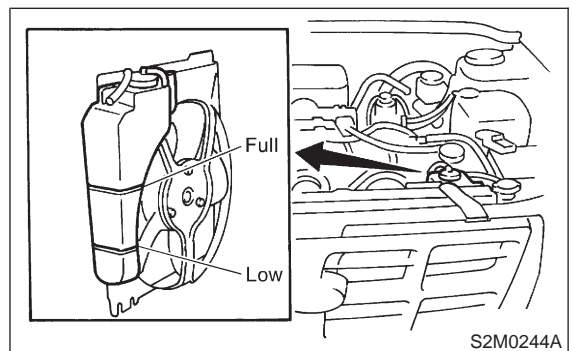

- 4) Attach radiator cap and reservoir tank cap properly.
- 5) Install air vent plug.
- 6) Warm-up engine completely for more than five minutes at 2,000 to 3,000 rpm.
- 7) Stop engine and wait until temperature drops to a safe level.
- 8) If engine coolant level drops in radiator, add engine coolant to filler neck position.
- 9) If engine coolant level drops from upper level of reservoir tank, add engine coolant to upper level.
- 10) Attach radiator cap and reservoir tank cap properly.

C: CHECKING OF COOLING SYSTEM

1) Remove radiator cap, top off radiator, and attach tester to radiator in place of cap.

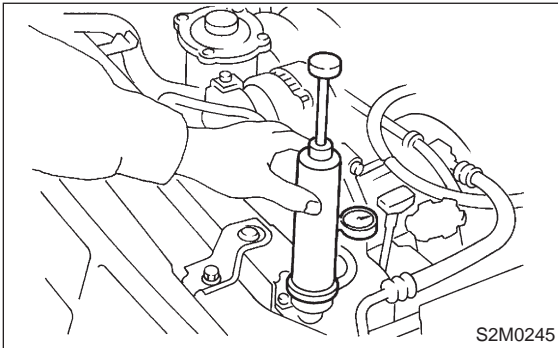

2) Apply a pressure of 157 kPa (1.6 kg/cm², 23 psi) to radiator to check if:

- (1) Engine coolant leaks at/around radiator.
- (2) Engine coolant leaks at/around hoses or connections.

CAUTION:

- Engine should be off.
- Wipe engine coolant from check points in advance.
- Be careful to prevent engine coolant from spurting out when removing tester.
- Be careful also not to deform filler neck of radiator when installing or removing tester.

9. Fuel

A: PRECAUTIONS

WARNING:

- Place "No fire" signs near the working area.
- Disconnect ground terminal from battery.
- Be careful not to spill fuel on the floor.

B: RELEASING OF FUEL PRESSURE

1) Disconnect connector from fuel pump relay.

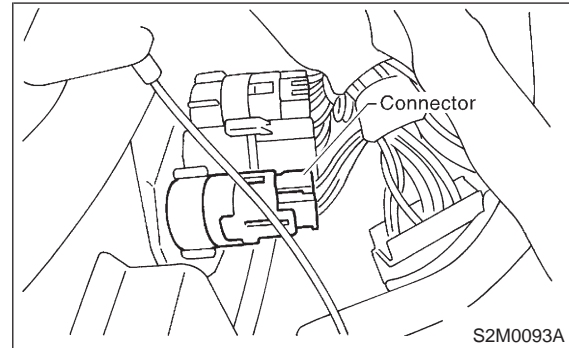

- 2) Start the engine, and run it until it stalls.
- 3) After the engine stalls, crank it for five more seconds.
- 4) Turn ignition switch OFF.

C: DRAINING OF FUEL

- 1) Release fuel pressure. <Ref. to 2-2 [W9B0].>
- 2) Remove fuel filler cap.
- 3) Disconnect battery ground cable.

