

6. Rear Gate and Glass

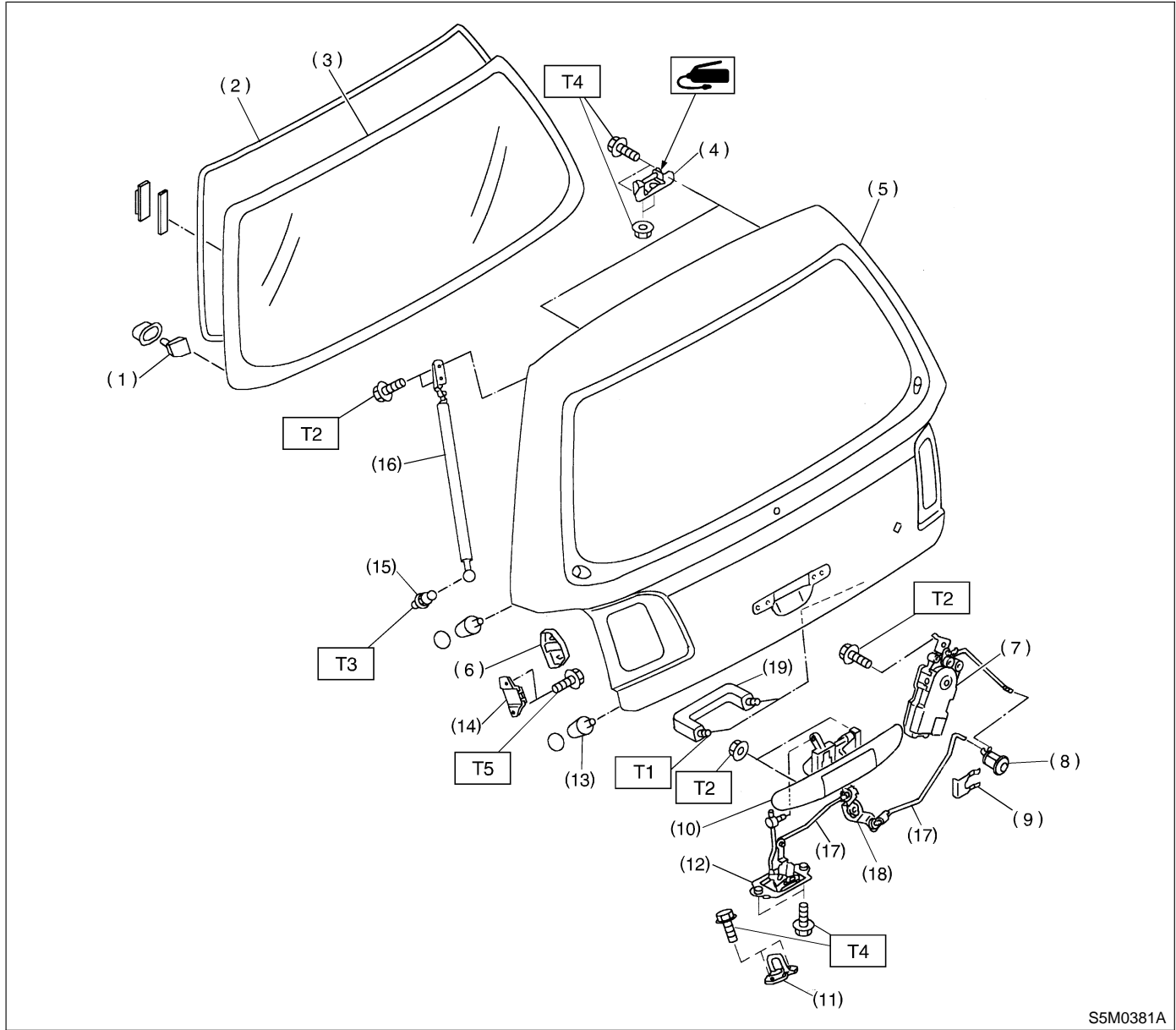

- (1) Locate pin
- (2) Dam rubber
- (3) Glass
- (4) Hinge
- (5) Rear gate
- (6) Buffer cover
- (7) Auto-door lock actuator
- (8) Key cylinder
- (9) Clip

- (10) Outer handle
- (11) Striker
- (12) Latch
- (13) Stopper
- (14) Buffer
- (15) Stud
- (16) Gas stay
- (17) Rod
- (18) Link

- (19) Rear gate inner handle

Tightening torque: N·m (kg·m, ft·lb)

T1: 2.0±0.5 (0.2±0.05, 1.4±0.4)

T2: 7.4±2.0 (0.75±0.2, 5.4±1.4)

T3: 14±4 (1.4±0.4, 10.1±2.9)

T4: 25±5 (2.5±0.5, 18.1±3.6)

T5: 13±3 (1.3±0.3, 9.4±2.2)