

1. Fuel Tank

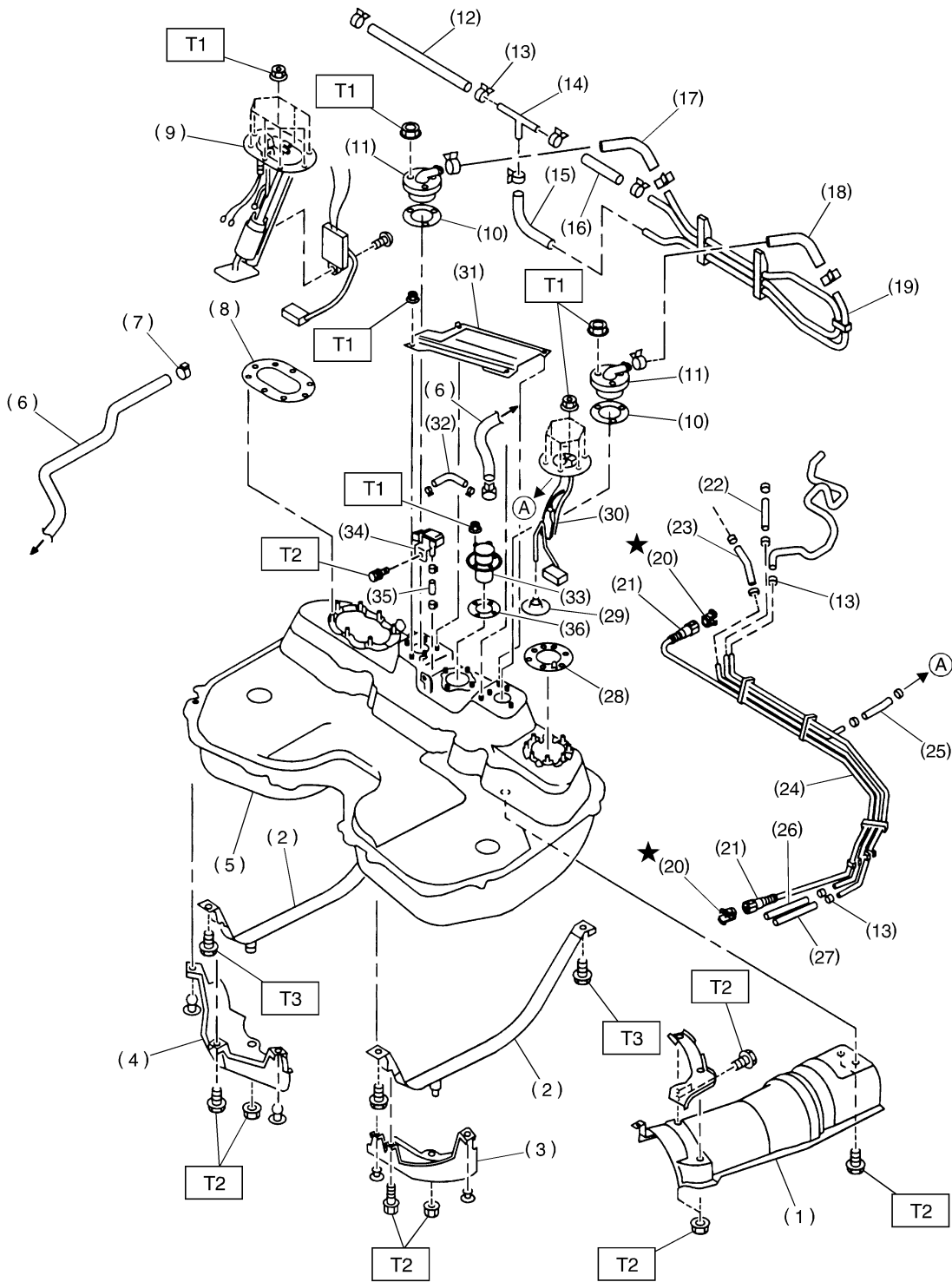

S2M2001A

- | | | |
|----------------------------|-----------------------------------|---|
| (1) Heat sealed cover | (15) Evaporation hose C | (29) Jet pump filter |
| (2) Fuel tank band | (16) Evaporation hose B | (30) Fuel sub level sensor |
| (3) Protector LH | (17) Evaporation hose D | (31) Protector cover |
| (4) Protector RH | (18) Evaporation hose E | (32) Vent valve hose |
| (5) Fuel tank | (19) Evaporation pipe ASSY | (33) Vent valve |
| (6) Canister hose A | (20) Retainer | (34) Fuel tank pressure sensor |
| (7) Clamp | (21) Quick connector | (35) Fuel tank pressure sensor hose |
| (8) Fuel pump gasket | (22) Jet pump hose A | (36) Vent valve gasket |
| (9) Fuel pump ASSY | (23) Fuel return hose A | |
| (10) Fuel cut valve gasket | (24) Fuel pipe ASSY | <hr/> Tightening torque: N-m (kg-m, ft-lb) |
| (11) Fuel cut valve | (25) Jet pump hose B | T1: 4.4±1.5 (0.45±0.15, 3.3±1.1) |
| (12) Evaporation hose A | (26) Fuel return hose B | T2: 7.4±2.0 (0.75±0.2, 5.4±1.4) |
| (13) Clip | (27) Evaporation hose F | T3: 33±10 (3.4±1.0, 25±7) |
| (14) Joint pipe | (28) Fuel sub level sensor gasket | <hr/> |