

## 8. Control Unit S701285

### A: REMOVAL S701285A18

- 1) Disconnect GND cable from battery.
- 2) Set temperature control switch to "FULL HOT" and mode selector switch to "DEF" position and recirc switch to "FRESH" position.
- 3) Disconnect temperature control cable and mode door control cable from heater unit then disconnect recirc control cable from intake unit.

**NOTE:**

Do not attempt to move links during installation.

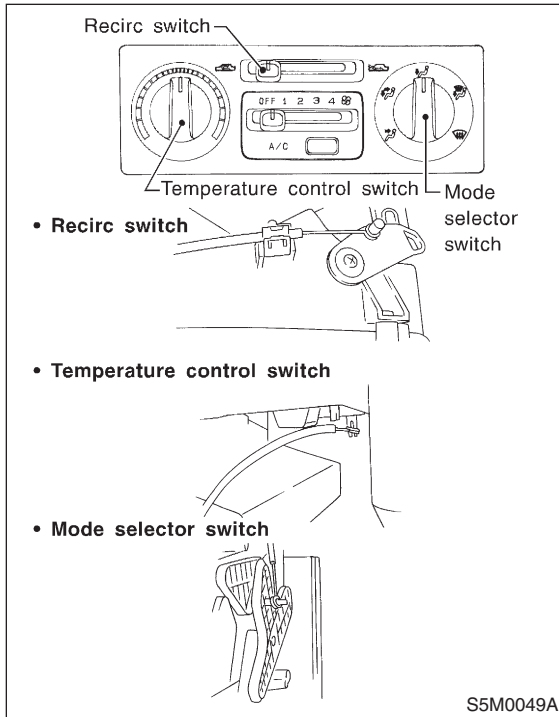

- 4) Remove console box. <Ref. to EI-24 REMOVAL, Console Box.>
- 5) Remove center panel and then disconnect connector.
- 6) Remove audio.

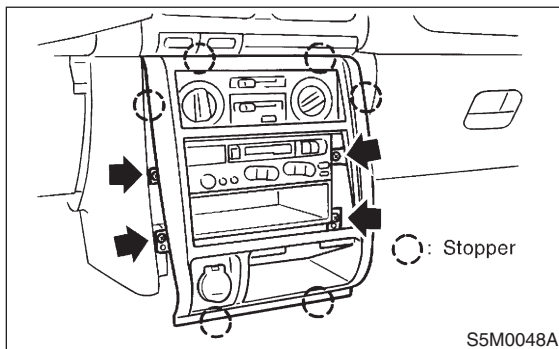

- 7) Remove control unit assembly from center console.

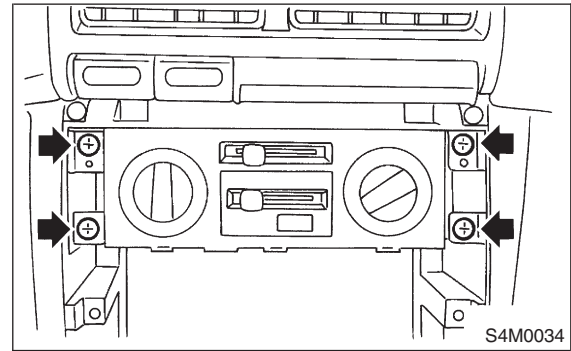

### B: INSTALLATION S701285A11

Install in the reverse order of removal.

**NOTE:**

Before installing control unit, set temperature control switch to "FULL HOT" and mode selector switch to "DEF" position and recirc switch to "FRESH" position.

# CONTROL UNIT

HVAC System (Heater, Ventilator and A/C)

## C: INSPECTION S701285A10

### 1. FAN SWITCH S701285A1003

Check continuity between terminals at each switch position.

Switch position	Terminals					
	1	2	3	4	5	6
1	○				○	○
2	○			○		○
3	○		○			○
4	○	○				○
	IGN					GND

H5M1280A

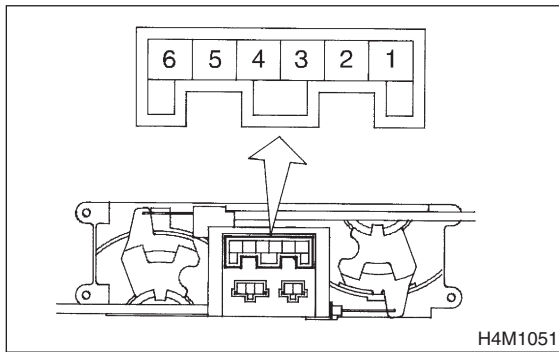

H4M1051

### 2. A/C SWITCH S701285A1004

Check A/C switch continuity between each terminal.

Terminal	Switch ON	Illumi.
1		○
2	○	○
3	○	○

H5M1281A

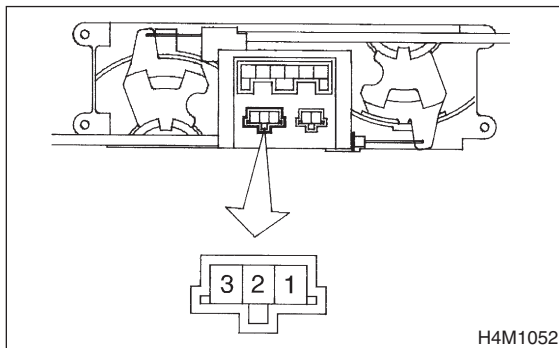

H4M1052

## D: ADJUSTMENT S701285A01

- Operate temperature control switch to "FULL COLD" and mode selector switch to "VENT" position and recirc switch to "RECIRC" position.
- Install control cable to lever. While pushing outer cable, secure control cable with clip.

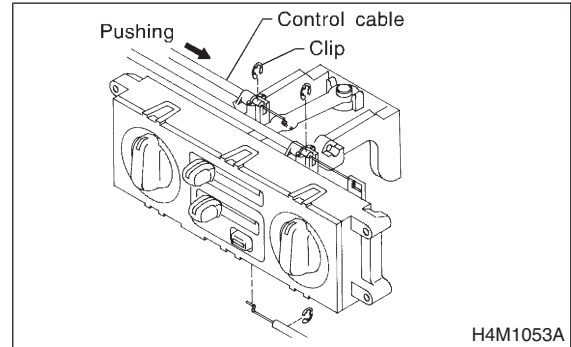

H4M1053A