

40. Front Wiring Harness S903445

A: LOCATION S903445A13

Connector				Connecting to	
No.	Pole	Color	Area	No.	Name
F2	16	Blue	B-4	B100	Bulkhead wiring harness (ABS)
F3	2	★	B-1		Front turn signal light RH
F5	1 × 2	★	B-1		Horn
F6	2	Black	B-1		Front fog light RH
F7	3	★	B-1		Headlight RH
F16	2	Black	B-1		Sub fan motor
F17	2	Black	B-2		Radiator main fan motor
F19	2	★	C-3		Front turn signal light LH
F21	2	Black	C-2		Front fog light LH
F23	3	★	B-2		Headlight LH
F24	3	Gray	B-2		A/C compressor
F25	1	★	B-2		Generator
F26	3	Green	B-2		
F27	4	★	B-3		A/C fuse (Relay holder)
F28	4	★	B-3		A/C sub fan relay (Relay holder)
F31	4	★	B-3		A/C relay (Relay holder)
F32	2	Green	B-3		Front washer motor
F33	2	★	B-3		Rear washer motor
F34	4	★	B-3		SBF holder
F35	2	★	B-3		M/B
F36	3	★	B-3		
F37	6	Black	B-3		
F38	1	★	B-3		
F39	8	Black	B-3		
F40	9	Brown	B-4		F/B
F41	7	Gray	B-4		
F44	8	★	B-4	B61	Bulkhead wiring harness
F45	20	★	B-4	B62	
F46	8	★	B-4	B108	
F49	31	★	B-2		ABS control module
F51	2	★	B-2		Side turn signal light RH
F52	2	Gray	B-1		Front clearance light RH
F53	2	Gray	C-3		Front clearance light LH
F54	2	★	B-4		Side turn signal light LH
F55	12	★	B-4	R49	Rear wiring harness (ABS)
F62	6	★	B-1	F63	Shield joint connector (ABS)
F63	6	★	B-1	F62	
F64	1	★	B-2		ABS motor ground
F66	4	★	B-3		Radiator main fan relay (Relay holder)
F67	2	★	B-3		FWD switch (Relay holder)
F68	4	Black	B-3		M/B

★: Non-colored

FRONT WIRING HARNESS

Wiring System

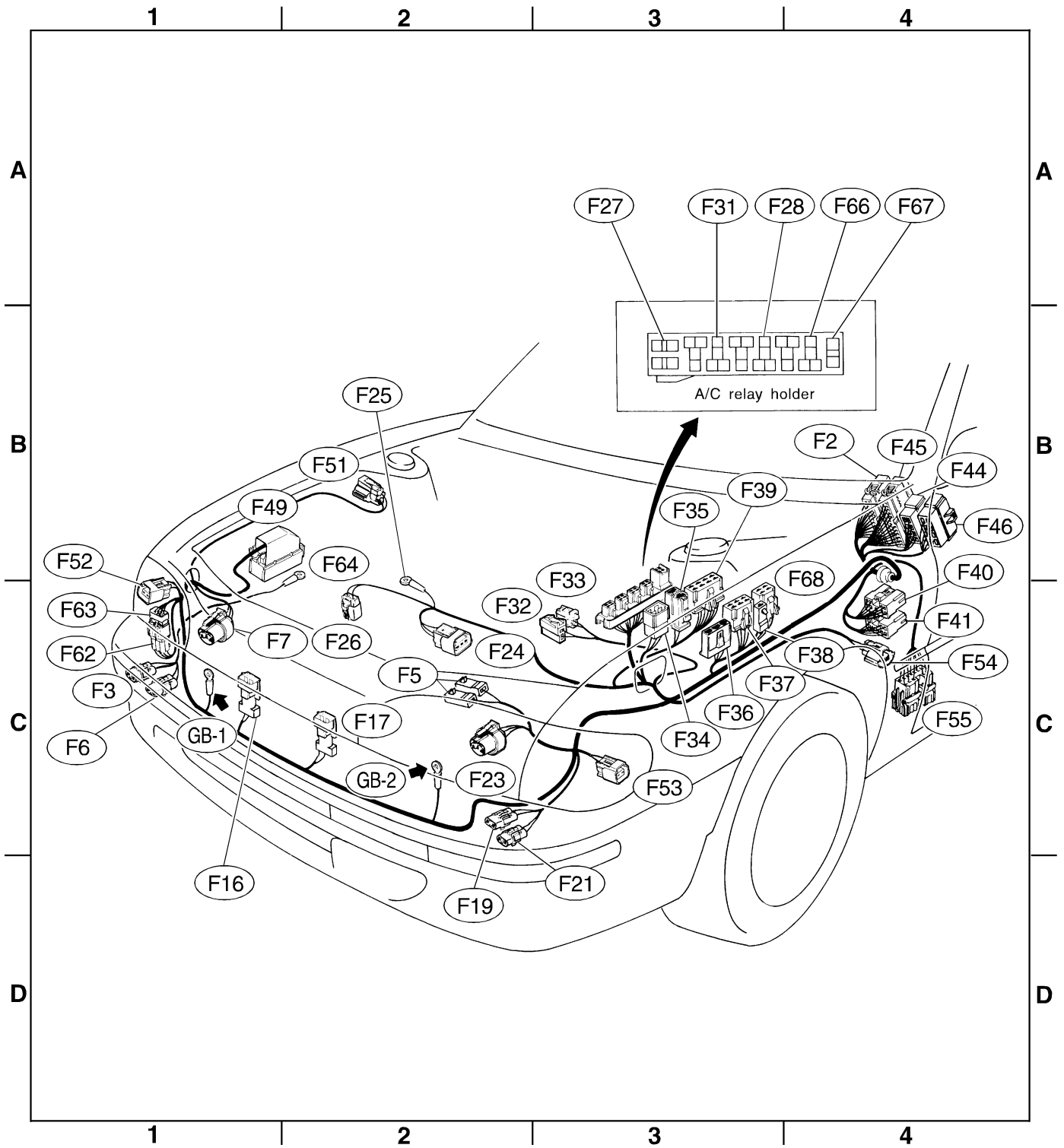

H6M0782A