

Brought to you by Eris Studios  
NOT FOR RESALE

**NOTE**

NOTE

# 1. Note

## A: NOTE

This information will improve the efficiency of maintenance and assure that the finished work is of a good quality.

### 1. FASTENERS NOTICE

Fasteners are used to prevent the parts from damage, dislocation and play due to looseness. Fasteners must be tightened to the specified torque.

Do not apply paint, lubricant, rust retardant or other substance to the surface around bolts, nuts, etc. Doing so will make it difficult to obtain the correct torque and result in looseness and other problem.

### 2. STATIC ELECTRICITY DAMAGE

Do not touch the control modules, connectors, logic boards and other such parts when there is a risk of static electricity. Always use a static electricity prevention cord or touch grounded metal for the elimination of static electricity before conducting work.

### 3. BATTERY

When removing the battery cables, always be sure to turn the ignition switch to OFF to prevent electrical damage to the control module from overcurrent.

### 4. SERVICE PARTS

Use genuine parts for maximum performance and maintenance when conducting repairs. Subaru/FHI will not be responsible for poor performance resulting from the use of parts except for genuine parts.

### 5. PROTECTING VEHICLE UNDER MAINTENANCE

Make sure to attach the fender cover, seat covers, etc. before work.

### 6. ENSURING SECURITY DURING WORK

When working in a group of two or more, perform the work with calling each other to ensure mutual safety.

## 7. LIFT AND JACK

When using a lift or shop jack to raise a vehicle or using rigid rack to support a vehicle, always follow instructions concerning jack-up points and weight limits to prevent the vehicle from falling, which could result in injury. Be especially careful that the vehicle is balanced before raising it. Be sure to set the wheel stoppers when jacking-up only the front or rear side of the vehicle.

### CAUTION:

**When the side sill interferes with the lift arm, a grooveless attachment can be used. In this case, perform the operation carefully because the dislocation from the side sill flange may occur.**

### NOTE:

- When using a lift, follow its operation manual before work.
- When the side sill cover contacts the lift arm, use a lift attachment.
- Do not work or leave unattended while the vehicle is supported with jack, support it with rigid racks.
- Be sure to use the rigid racks with rubber attached to cradle to support the vehicle.
- When using a plate lift, use a rubber attachment. (Model with side sill cover)

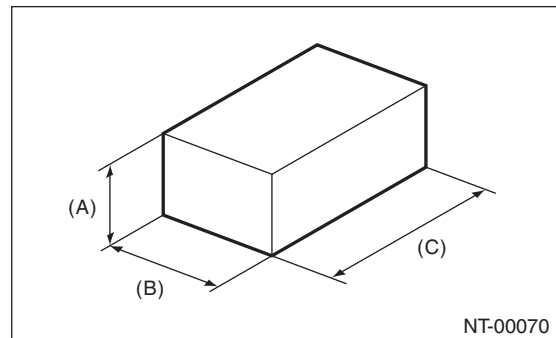

- (A) 80 mm (3.1 in) or more
- (B) 100 — 150 mm (3.94 — 5.91 in)
- (C) 120 — 190 mm (4.72 — 7.48 in)

# Note

Brought to you by Eris Studios  
NOT FOR RESALE

- Do not use the plate lift whose attachment does not reach the supporting locations. The figure of vehicle indicates the supporting locations, supporting procedures, etc. for 5 door model, and they are same for 4 door model.  
Supporting locations

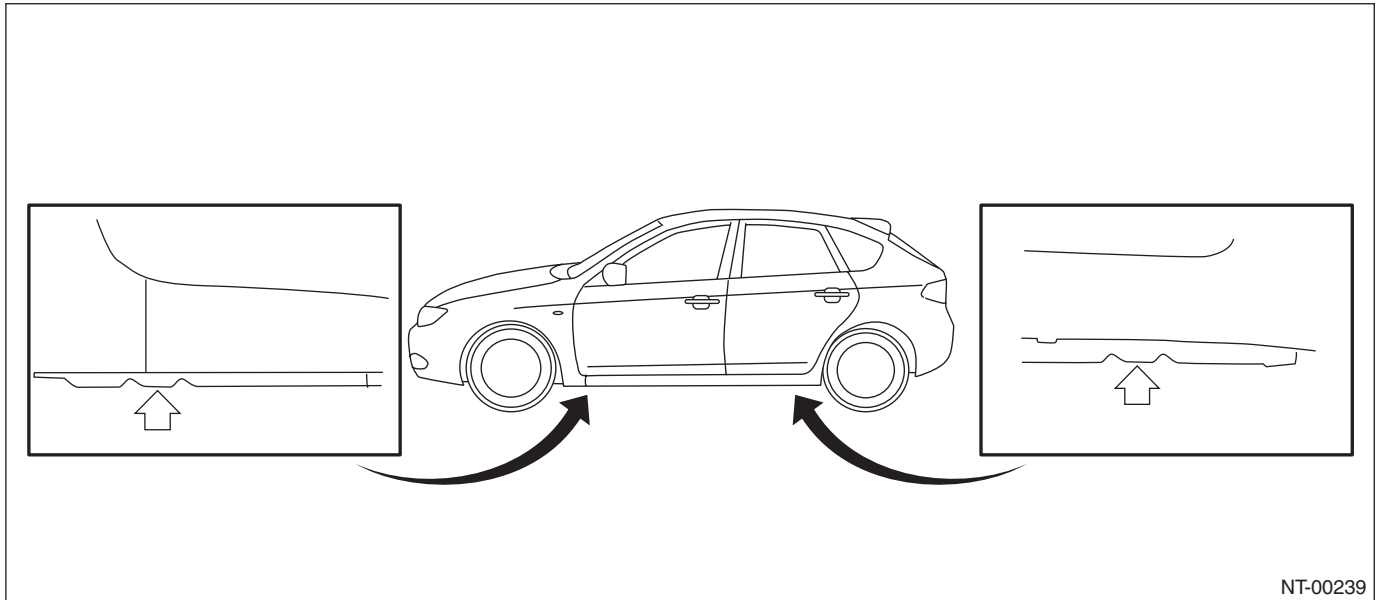

NT-00239

## Pantograph jack

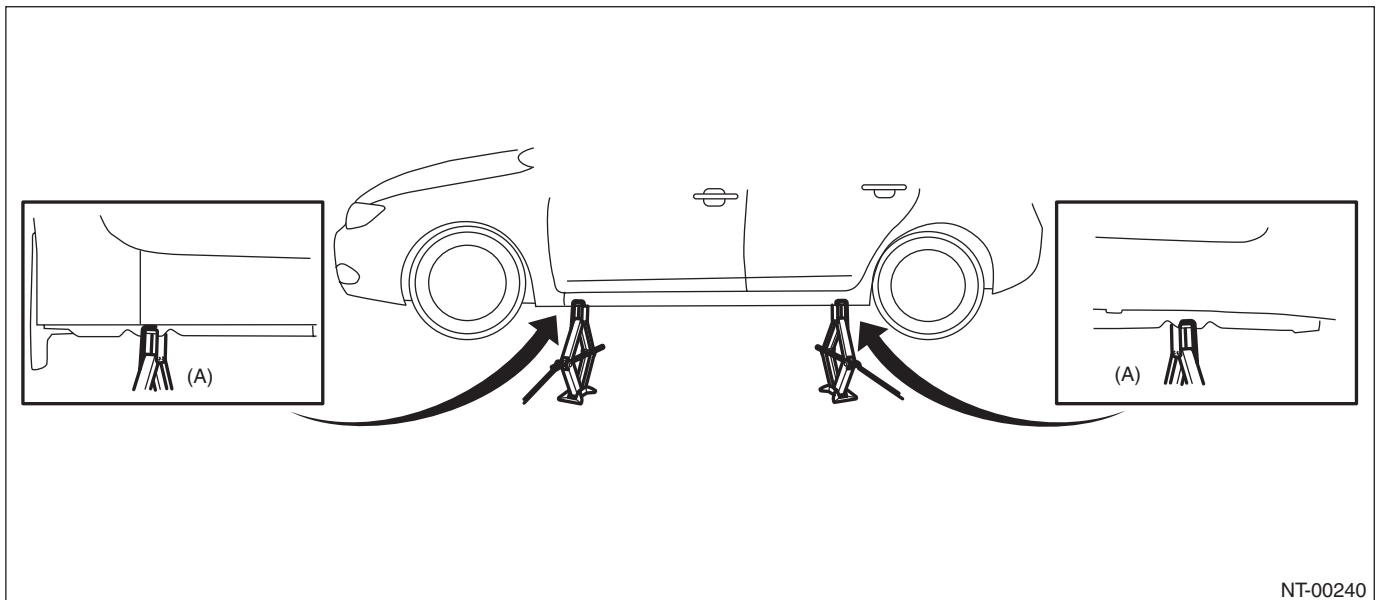

NT-00240

- (A) Set the jacks between cutout portions.

NOTE

Lift

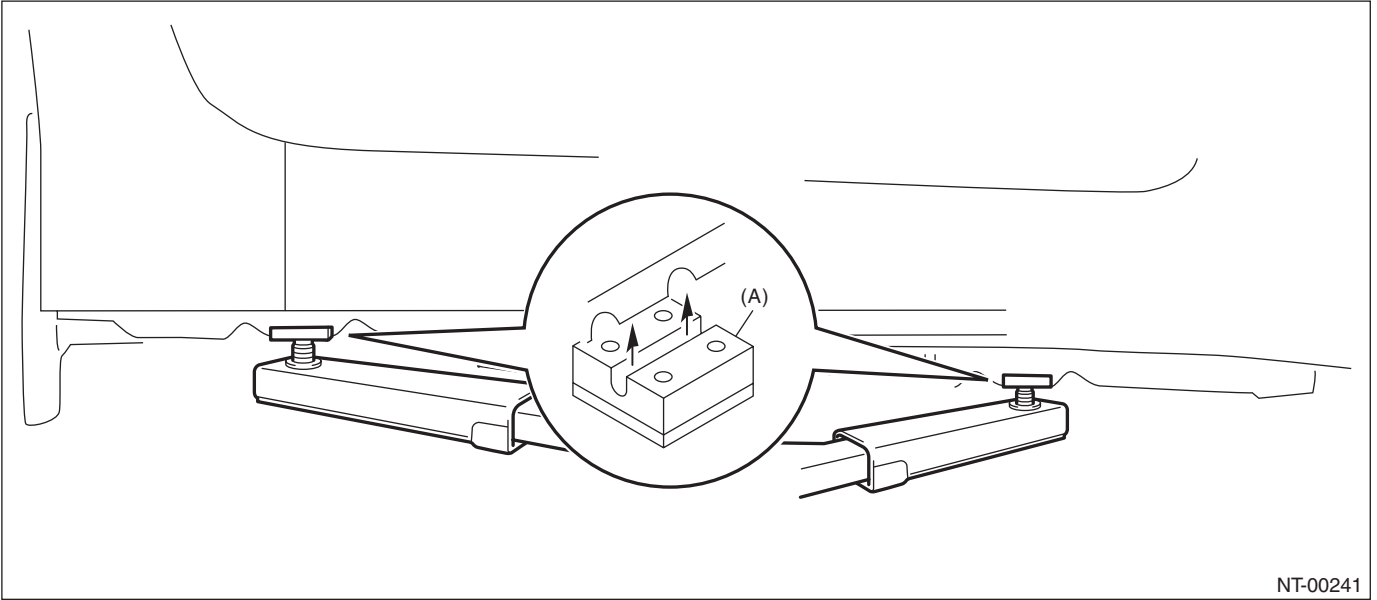

NT-00241

(A) Attachment

Rigid racks

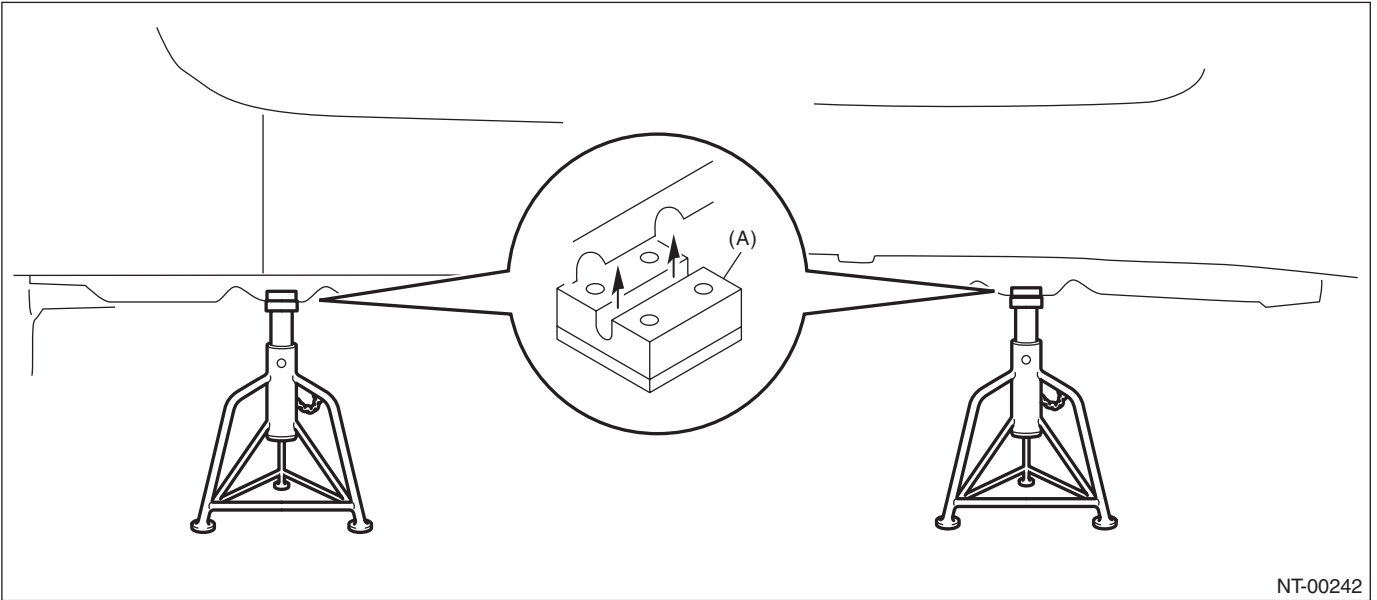

NT-00242

(A) Attachment

Plate lift

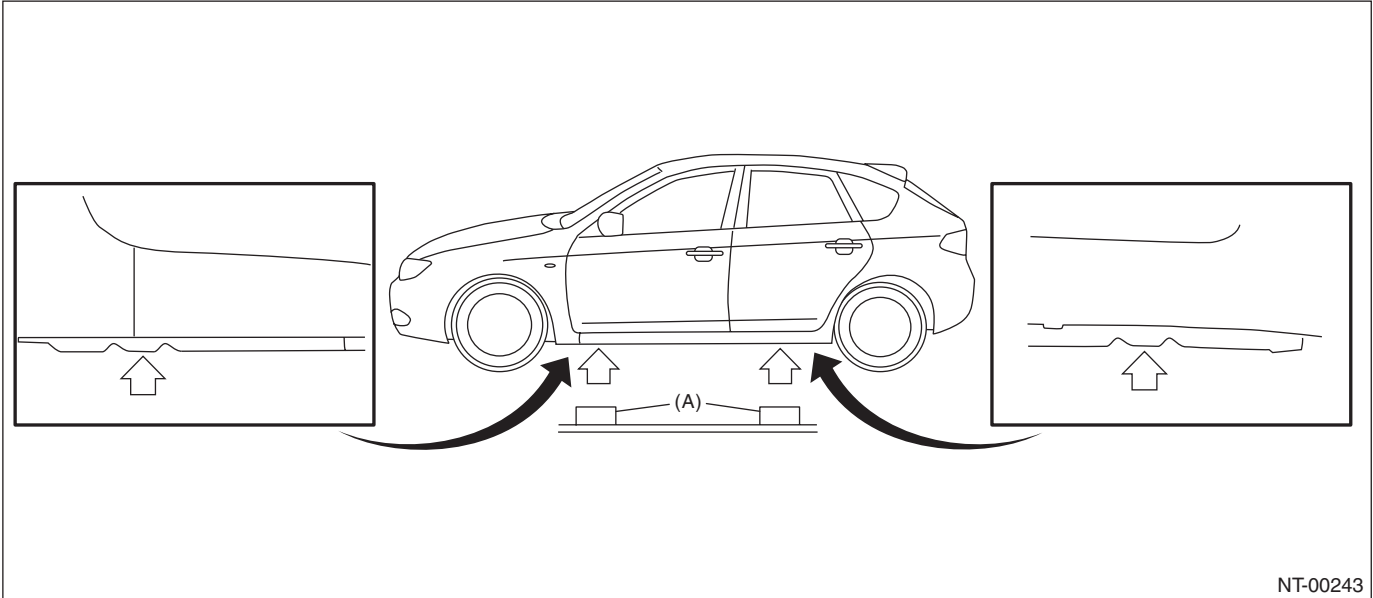

NT-00243

(A) Attachment

- Use the attachment by aligning its position as follows.

- Model without side sill spoiler

For the models without side sill spoiler, align the center of attachment with the center of cutout portions.

Front

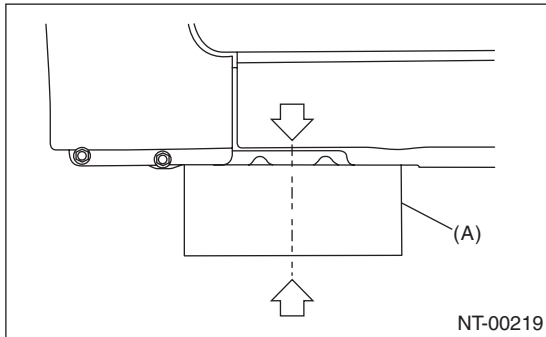

NT-00219

Rear

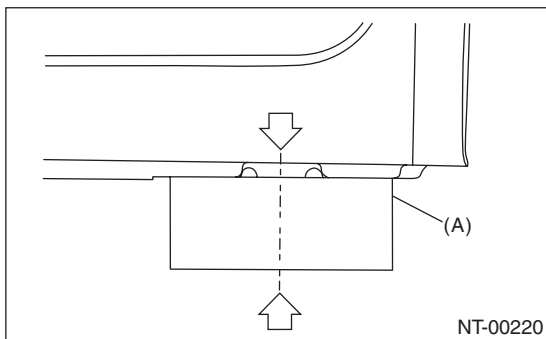

NT-00220

(A) Attachment

- Model with side sill spoiler

For the models with side sill spoiler, align the center of attachment with the center of vehicle cutout portion (the center of spoiler cutout portion).

Front

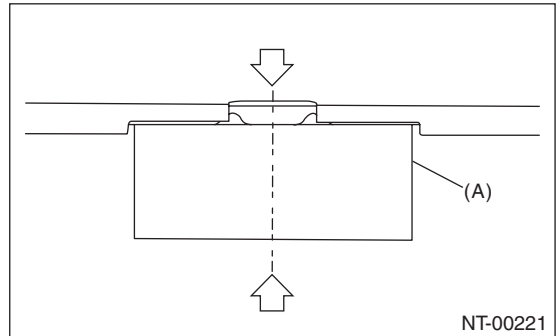

NT-00221

Rear

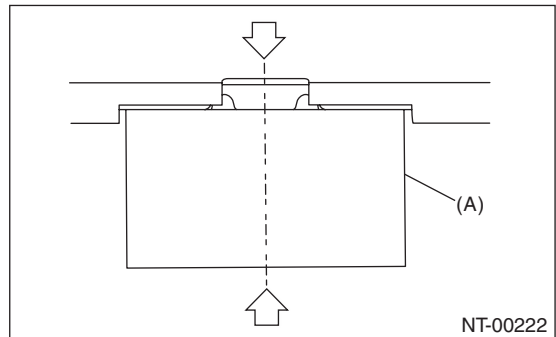

NT-00222

(A) Attachment

# Note

NOTE

Brought to you by Eris Studios  
NOT FOR RESALE

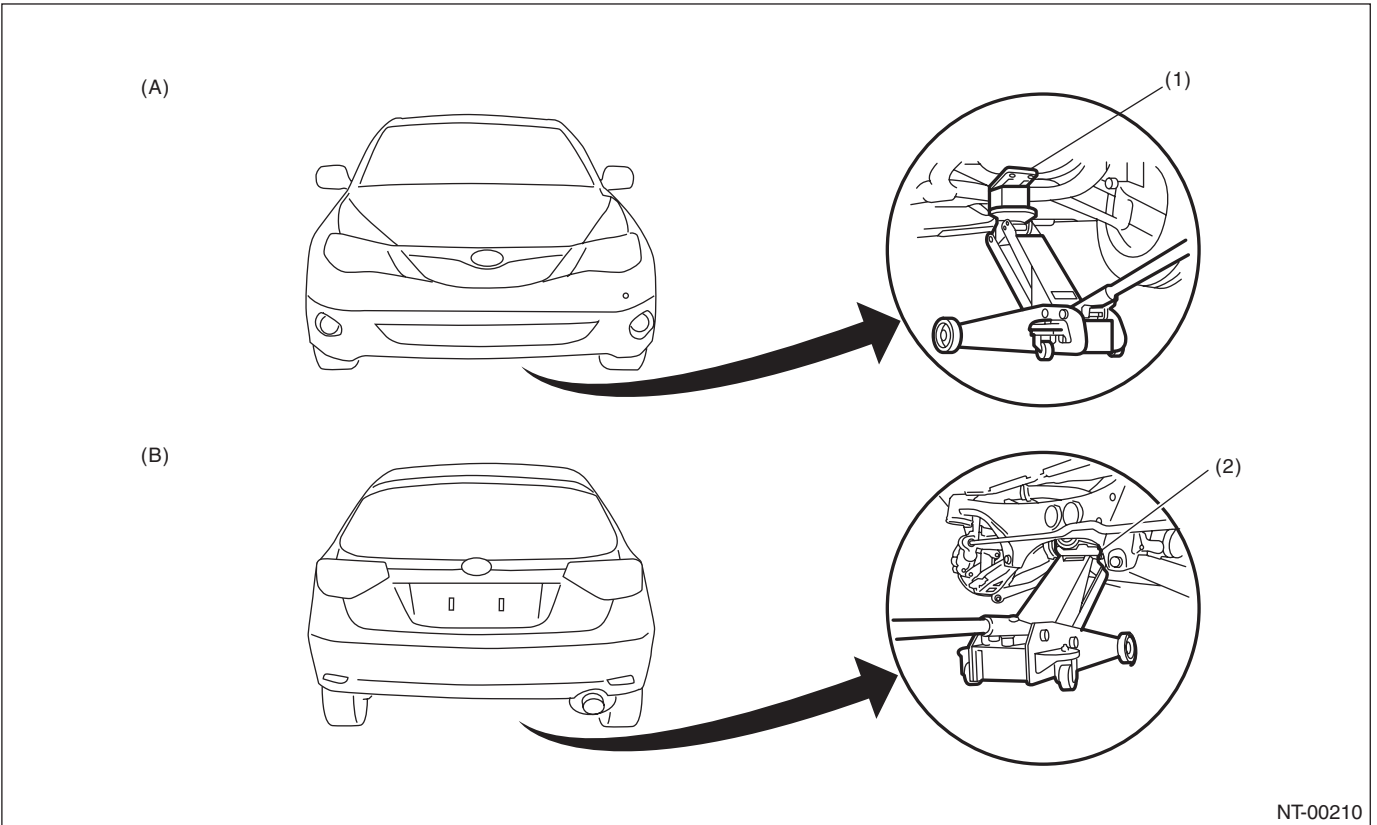

NT-00210

(A) Front

(B) Rear

(1) Front crossmember

(2) Crossmember

### 8. TIE-DOWNS

The tie-down hooks are used when transporting vehicles and when using the chassis dynamo. Attach tie-down only to the specified locations on the vehicle.

- TIE-DOWN LOCATION

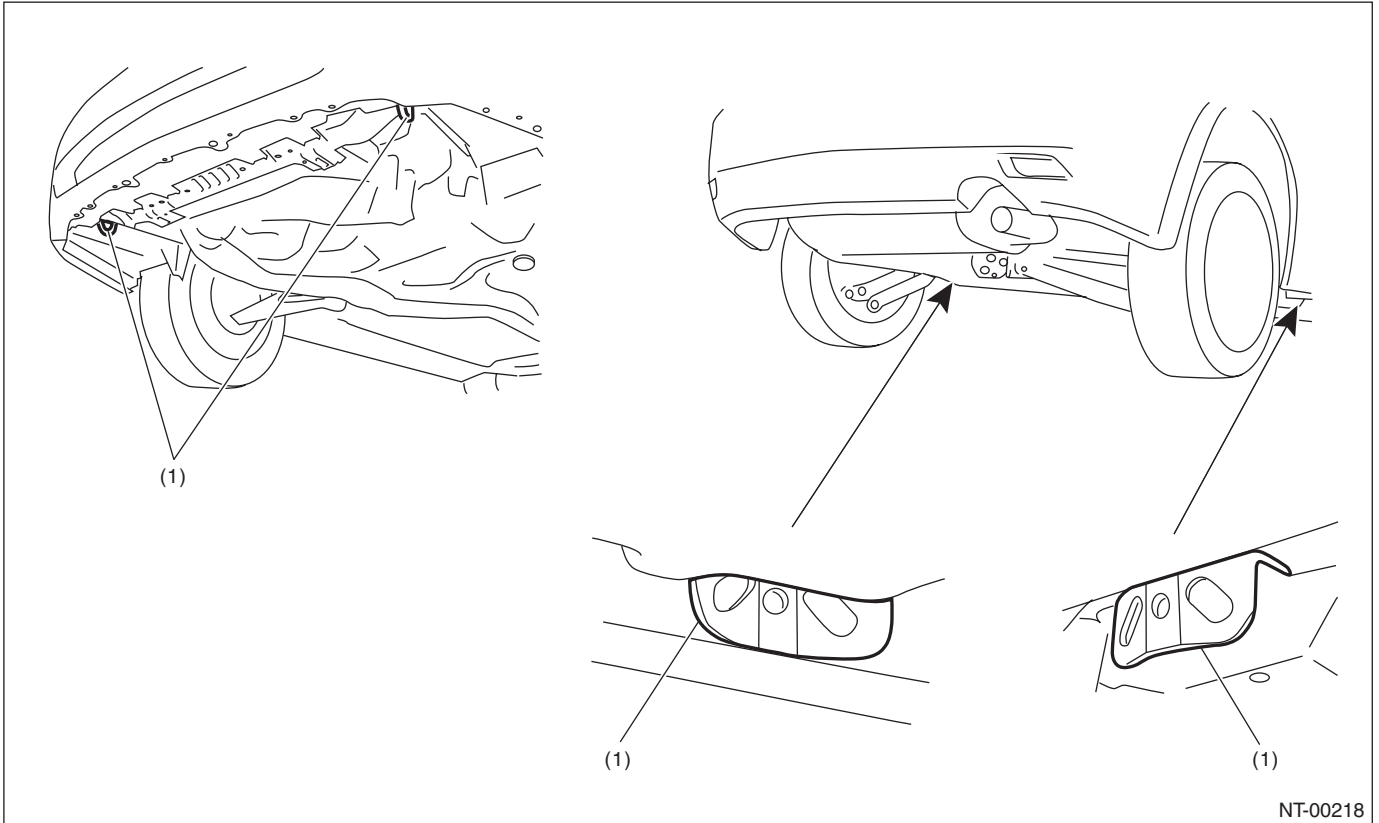

(1) Hook for tie-down

# Note

NOTE

Brought to you by Eris Studios  
NOT FOR RESALE

## • TIE-DOWN HOOK & EYE BOLT

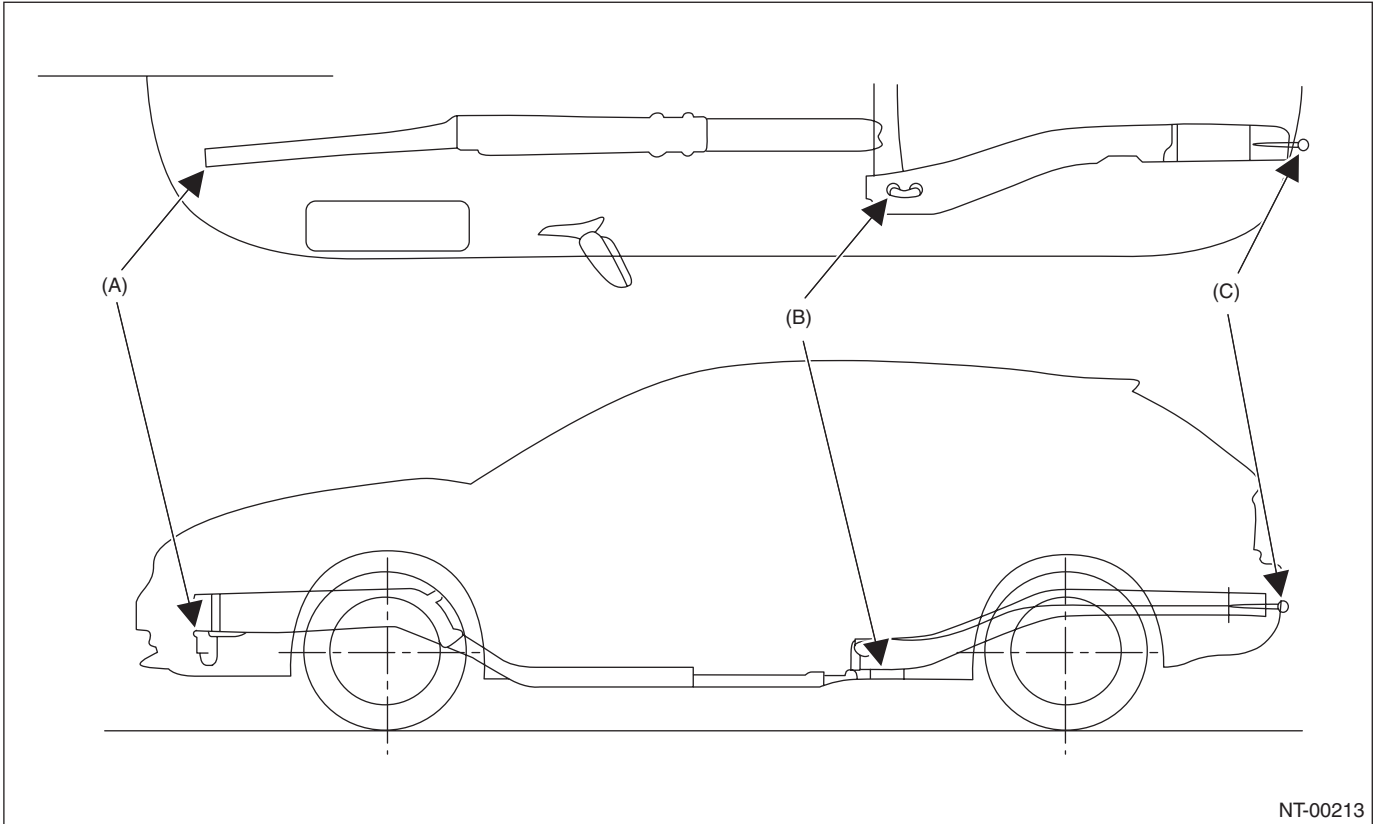

(A) Front tie-down hook

(B) Rear tie-down hook

(C) Eye bolt



# Note

Brought to you by Eris Studios  
NOT FOR RESALE

## • TIE-DOWN DIRECTION

### CAUTION:

Pull the tie-down chains LH and RH in the same direction, but front and rear side in the counter direction.

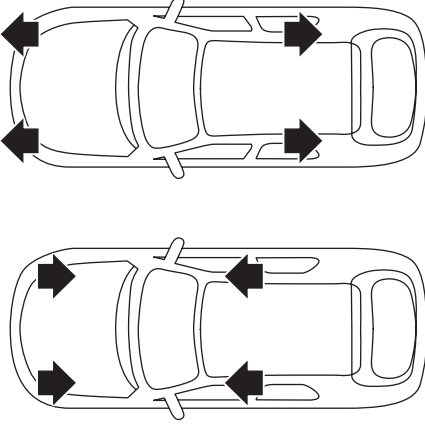
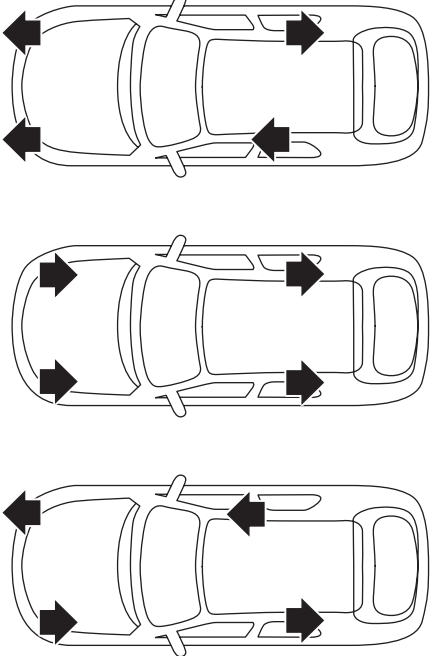
	Recommended	NG
Tie-down direction	 NT-00214	 NT-00215

# Note

Brought to you by Eris Studios  
NOT FOR RESALE

## NOTE

### • TIE-DOWN RANGE

For ground transportation

#### CAUTION:

When the vehicle is tied down from vehicle inside, hook the hooks of tie-down chain on the rear tie-down hooks from vehicle inside. When the vehicle is tied down from vehicle outside, hook the hooks of tie-down chain on the rear tie-down hooks from vehicle outside.

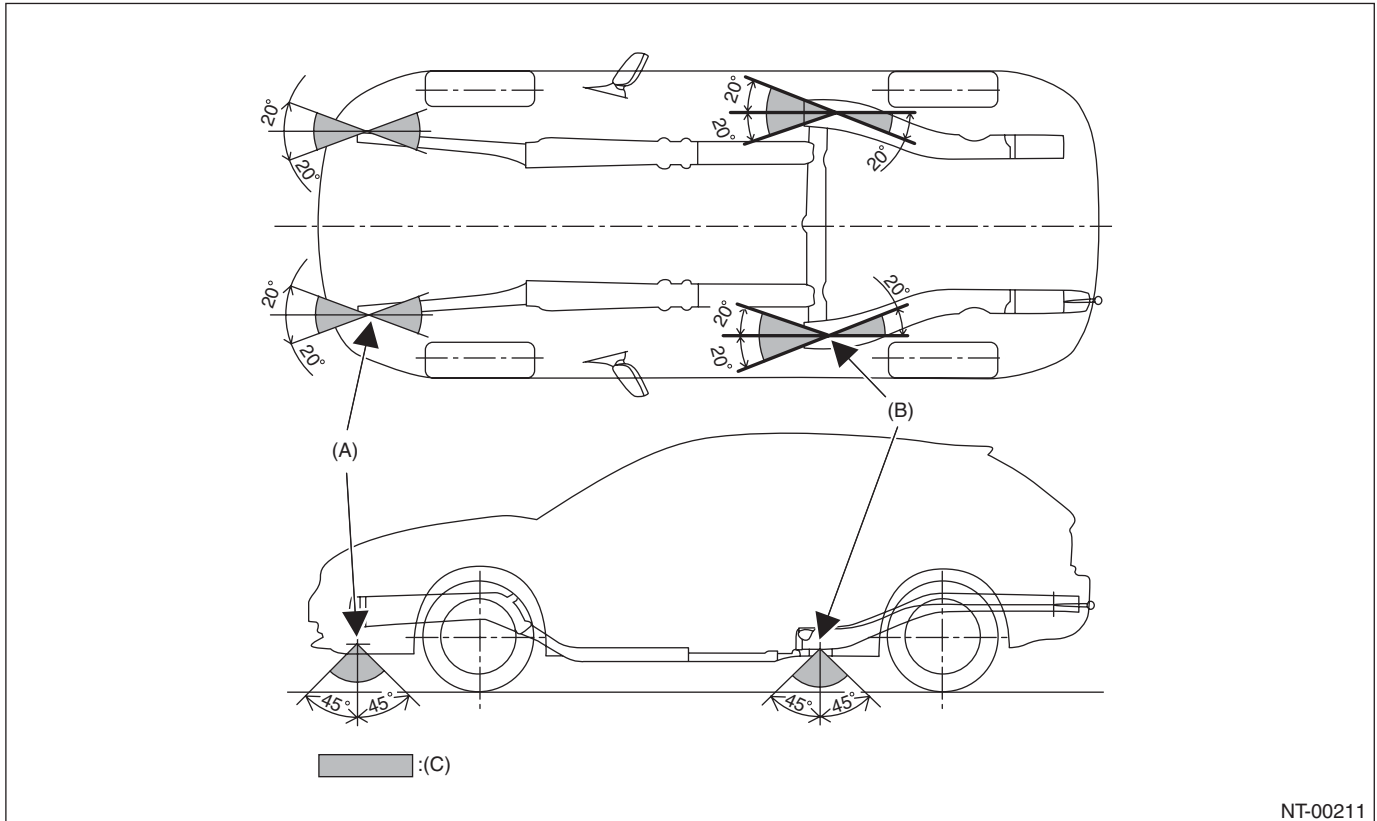

NT-00211

(A) Front tie-down hook

(B) Rear tie-down hook

# Note

Brought to you by Eris Studios  
NOT FOR RESALE

For sea transportation

## CAUTION:

The eye bolts are exclusively used for towing and sea transportation tie-down, and do not use them for ground and freight transportation.

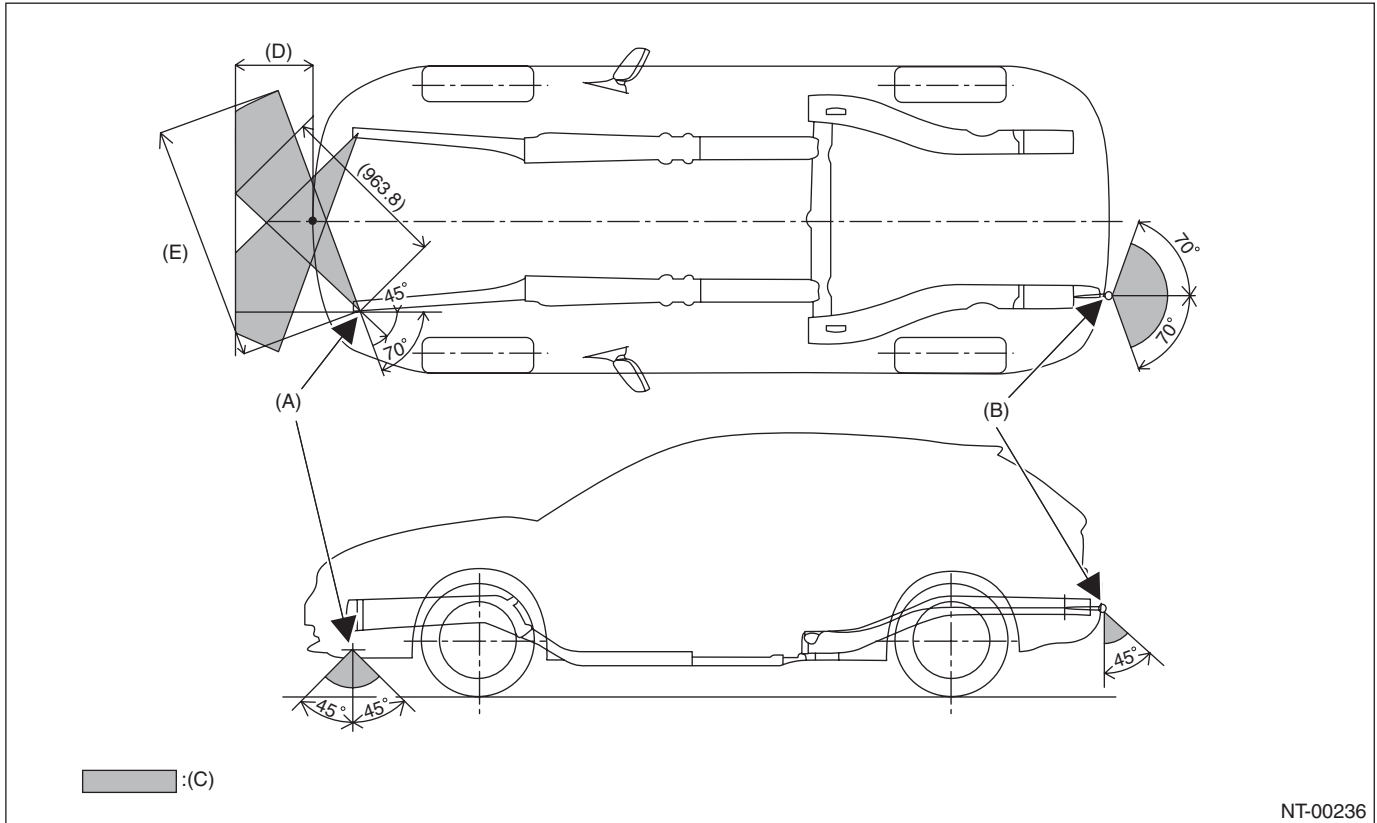

NT-00236

- (A) Front tie-down hook
- (B) Eye bolt

- (C) Chain pulling range at tie-down condition

- (D) 400 mm (15.7 in)
- (E) 1,320 mm (52.0 in)

## Note

NOTE

Brought to you by Eris Studios  
NOT FOR RESALE

### • VEHICLE SINKING VOLUME AT TIE-DOWN CONDITION

#### CAUTION:

The vehicle sinking volume at tie-down condition should be less than 50 mm (1.97 in) and make sure to fix the vehicle securely.

Check to see if the tensions of chains or belts at tie-down condition are appropriate in the following procedures.

- 1) Measure the distance (A) between the center of wheel and highest arch point.
- 2) Compare the measured dimensions of before and after tie-down.
- 3) If the difference is less than 50 mm (1.97 in), it is judged as OK. If the difference is 50 mm (1.97 in) or more, it is judged as NG because the tension is too high.

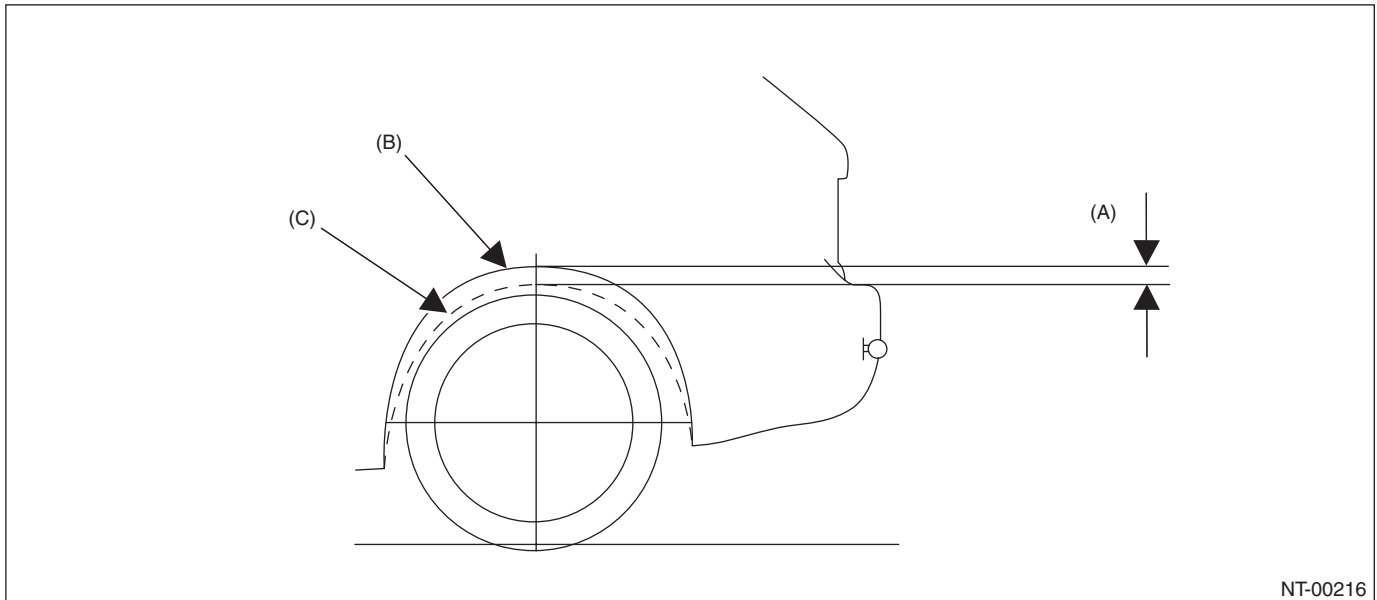

NT-00216

(B) Arch position before tie-down

(C) Arch position after tie-down

# Note

Brought to you by Eris Studios  
NOT FOR RESALE

## • NOTES FOR THE USE OF TIE-DOWN HOOK

When the vehicle is tied down from the rear side, use the holes at the rear side, and when the vehicle is tied down from the front side, use the holes at the front side.

When the vehicle is tied down from vehicle inside, hook the hooks of tie-down chain from vehicle inside, and when the vehicle is tied down from vehicle outside, hook the hooks of tie-down chain from vehicle outside.

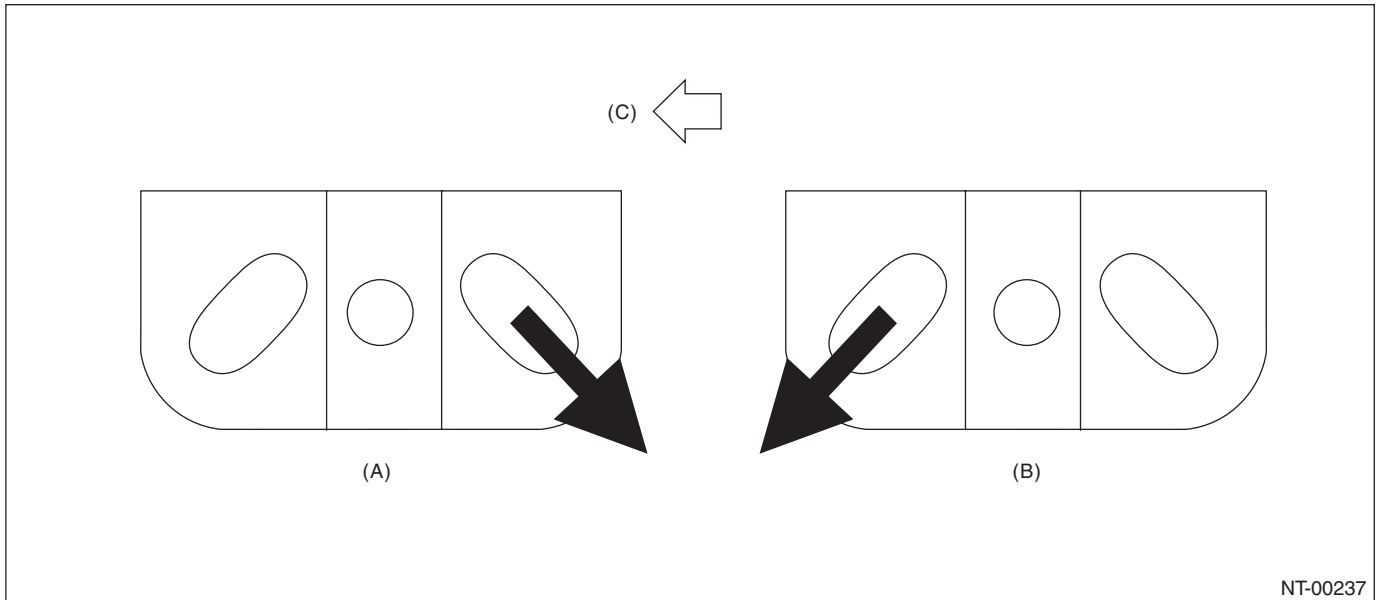

NT-00237

(A) When the vehicle is tied down towards the rear side

(B) When the vehicle is tied down towards the front side

(C) Vehicle front

## Note

### NOTE

Brought to you by Eris Studios  
NOT FOR RESALE

## 9. TOWING

Avoid towing vehicles except when the vehicle cannot be driven. For models with AWD, AT or VTD, use a loader instead of towing. When towing other vehicles, pay attention to the following to prevent hook or vehicle damage resulting from excessive weight.

- Do not tow other vehicles with a front tie-down hook.
- Make sure the vehicle towing is heavier than the vehicle being towed.

### • FRONT

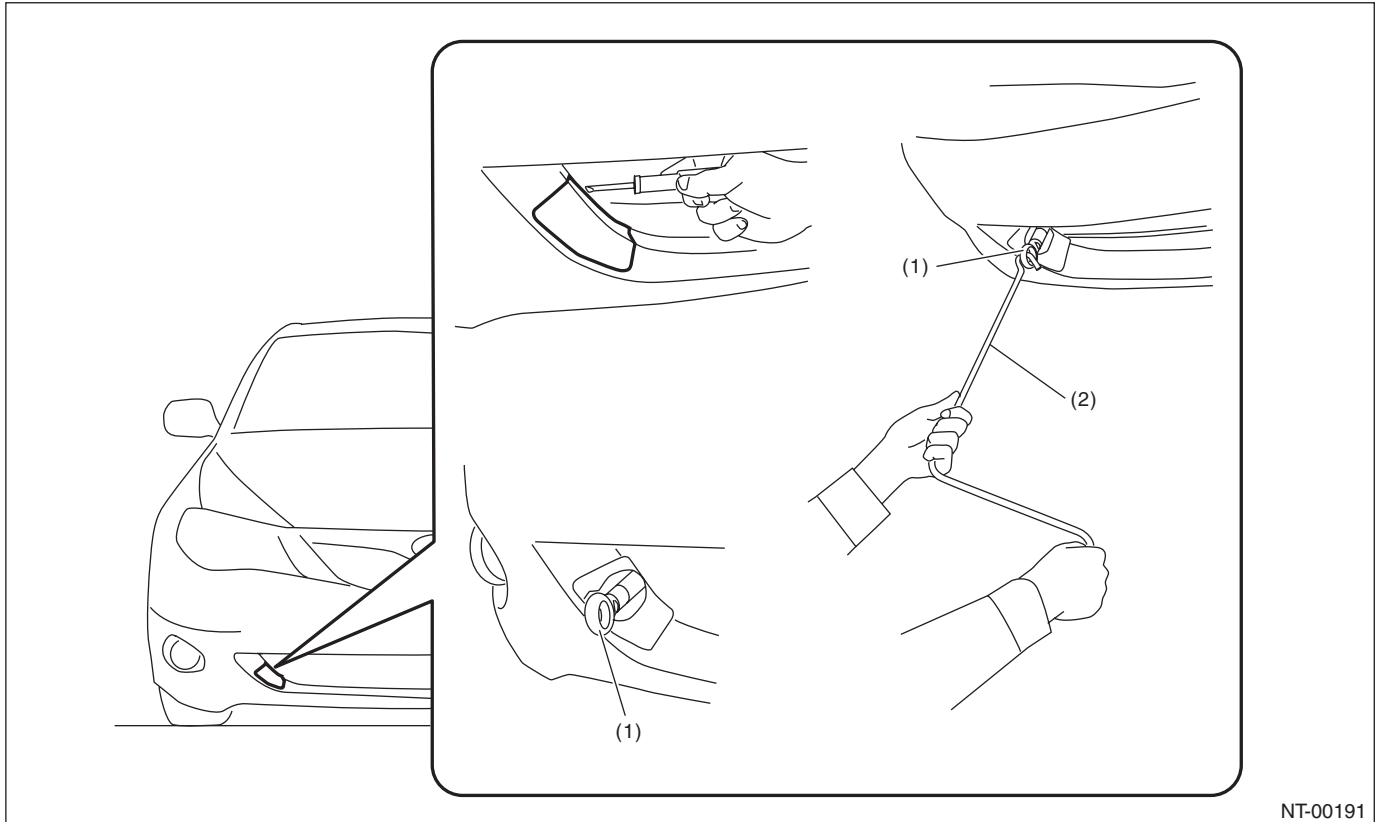

NT-00191

(1) Eye bolt

(2) Jack handle

• REAR

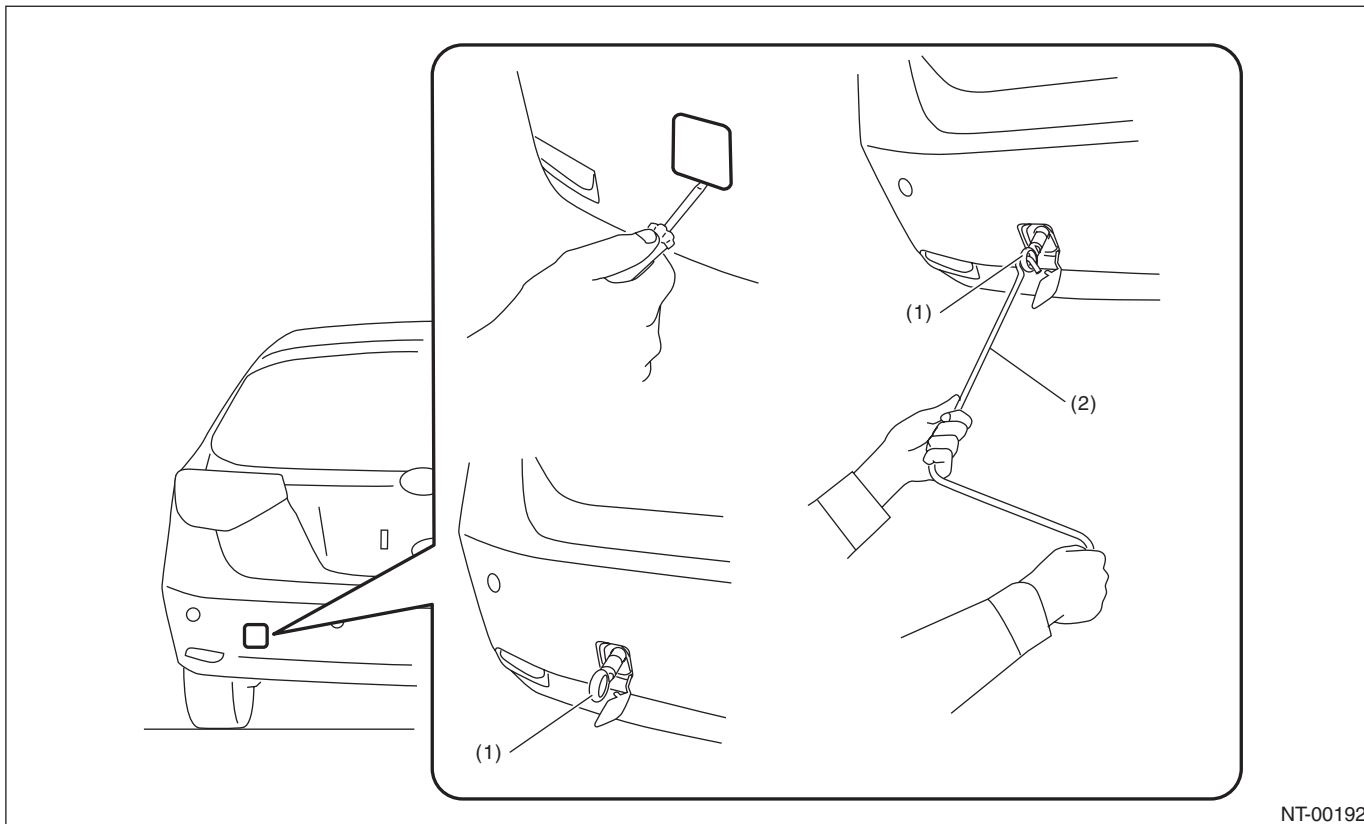

(1) Eye bolt

(2) Jack handle

**CAUTION:**

**When tightening the eye bolt using a wheel wrench, be careful not to scratch the bumper.**

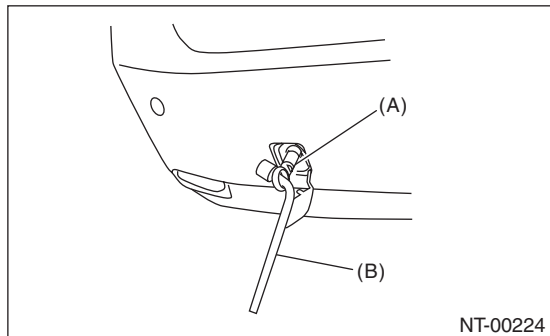

(A) Eye bolt

(B) Wheel wrench

NOTE

**10.FRONT HOOD DAMPER STAY**

**CAUTION:**

- Do not leave one side of damper stay removed.
- Always perform works such as inspections and maintenance with both damper stays attached.

At the check and general maintenance

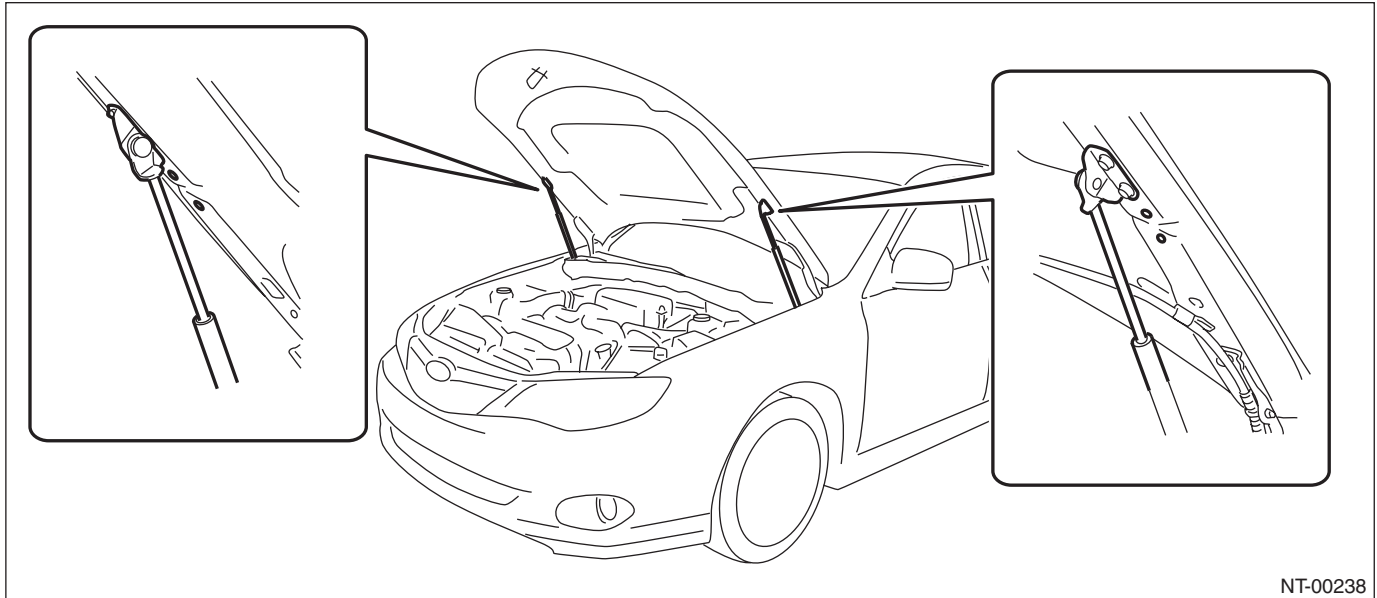

**When wider hood opening is necessary**

Set the damper stay below as shown in the figure.

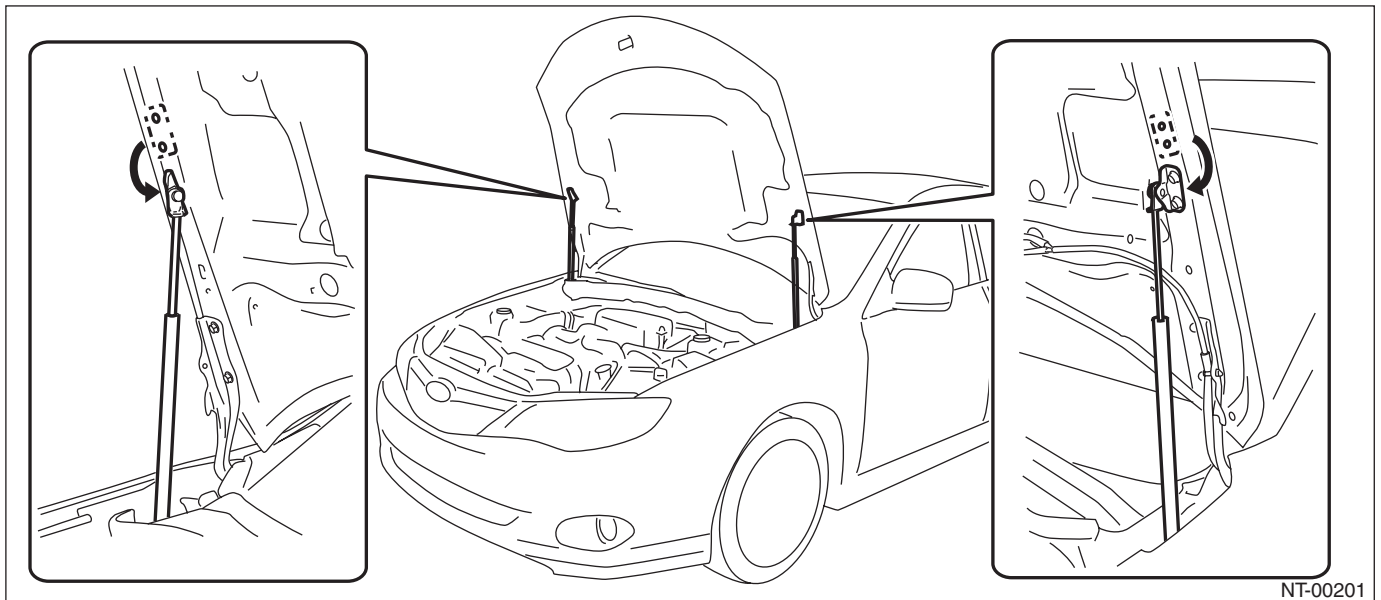

**11.TRAINING**

For an information about training, contact a dealer or agent.

**12.GENERAL SCAN TOOL**

Using general scan tools will greatly improve the efficiency of repairing engine electronic controls. Subaru Select Monitor can be used to diagnose the engine, ABS, AT and other electronically controlled parts.