

Brought to you by Eris Studios
NOT FOR RESALE

EXHAUST

General Description

Brought to you by Eris Studios
NOT FOR RESALE

EXHAUST

1. General Description

A: COMPONENT

- SEDAN MODEL

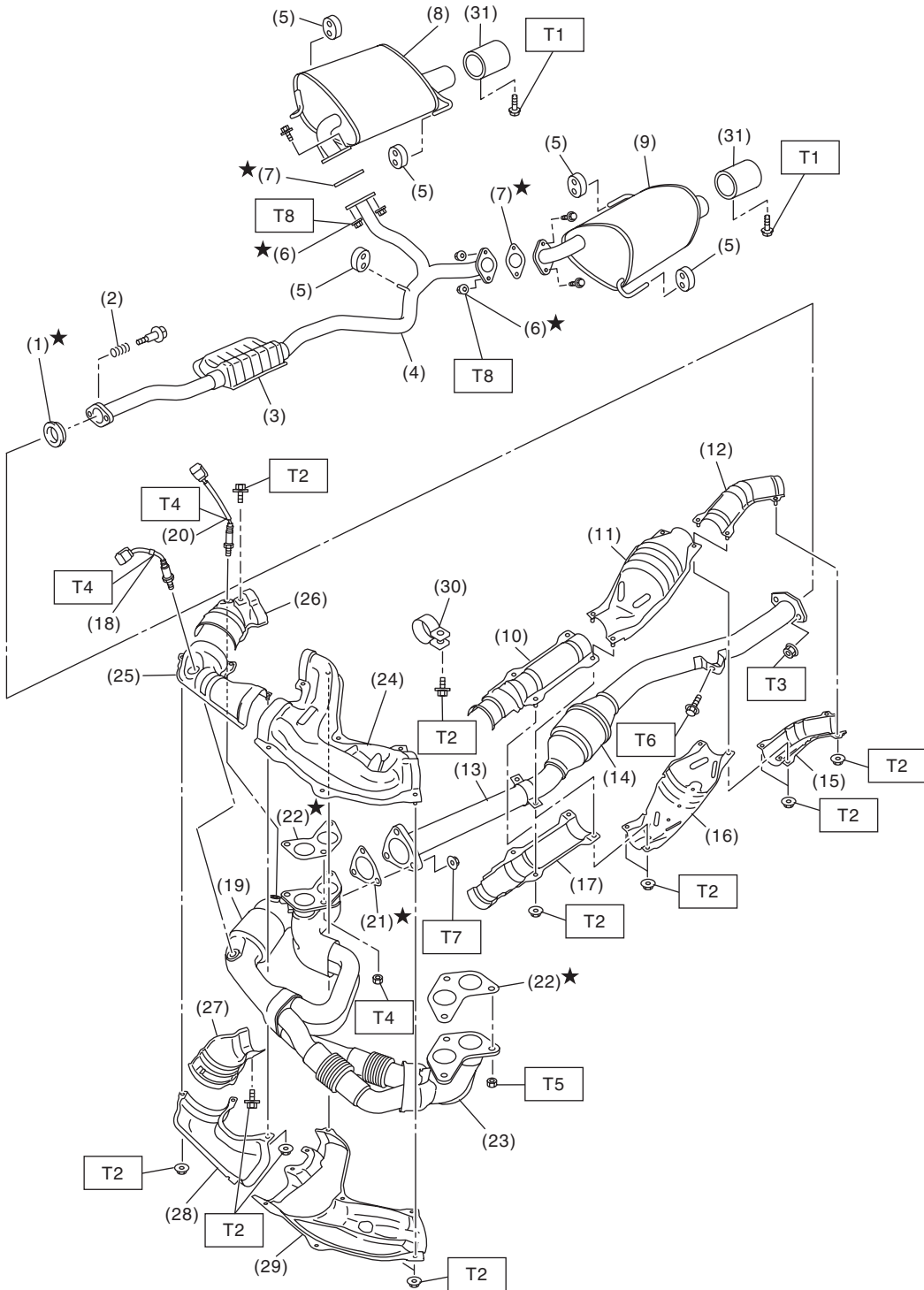

EX-02263

General Description

Brought to you by Eris Studios
NOT FOR RESALE
EXHAUST

(1) Gasket	(16) Rear catalytic converter lower cover	(28) Front exhaust pipe lower cover RH
(2) Spring		(29) Front exhaust pipe lower cover LH
(3) Chamber	(17) Center exhaust pipe front lower cover	(30) Band
(4) Rear exhaust pipe		(31) Muffler cutter (Model with muffler cutter)
(5) Cushion rubber	(18) Front oxygen (A/F) sensor	
(6) Self-locking nut	(19) Front catalytic converter	
(7) Gasket	(20) Rear oxygen sensor	
(8) Muffler (RH)	(21) Gasket	
(9) Muffler (LH)	(22) Gasket	
(10) Center exhaust pipe front upper cover	(23) Front exhaust pipe	
(11) Rear catalytic converter upper cover	(24) Front exhaust pipe upper cover LH	
(12) Center exhaust pipe rear upper cover	(25) Front exhaust pipe upper cover RH	
(13) Center exhaust pipe	(26) Front catalytic converter upper cover	
(14) Rear catalytic converter	(27) Front catalytic converter lower cover	
(15) Center exhaust pipe rear lower cover		

Tightening torque:N·m (kgf·m, ft·lb)

T1: 7.5 (0.76, 5.5)

T2: 13 (1.3, 9.4)

T3: 18 (1.8, 13.3)

T4: 21 (2.1, 15.5)

T5: 30 (3.1, 22.1)

T6: 35 (3.6, 25.8)

T7: 40 (4.1, 29.5)

T8: 48 (4.9, 35.4)

General Description

Brought to you by Eris Studios
NOT FOR RESALE

EXHAUST

- WAGON MODEL

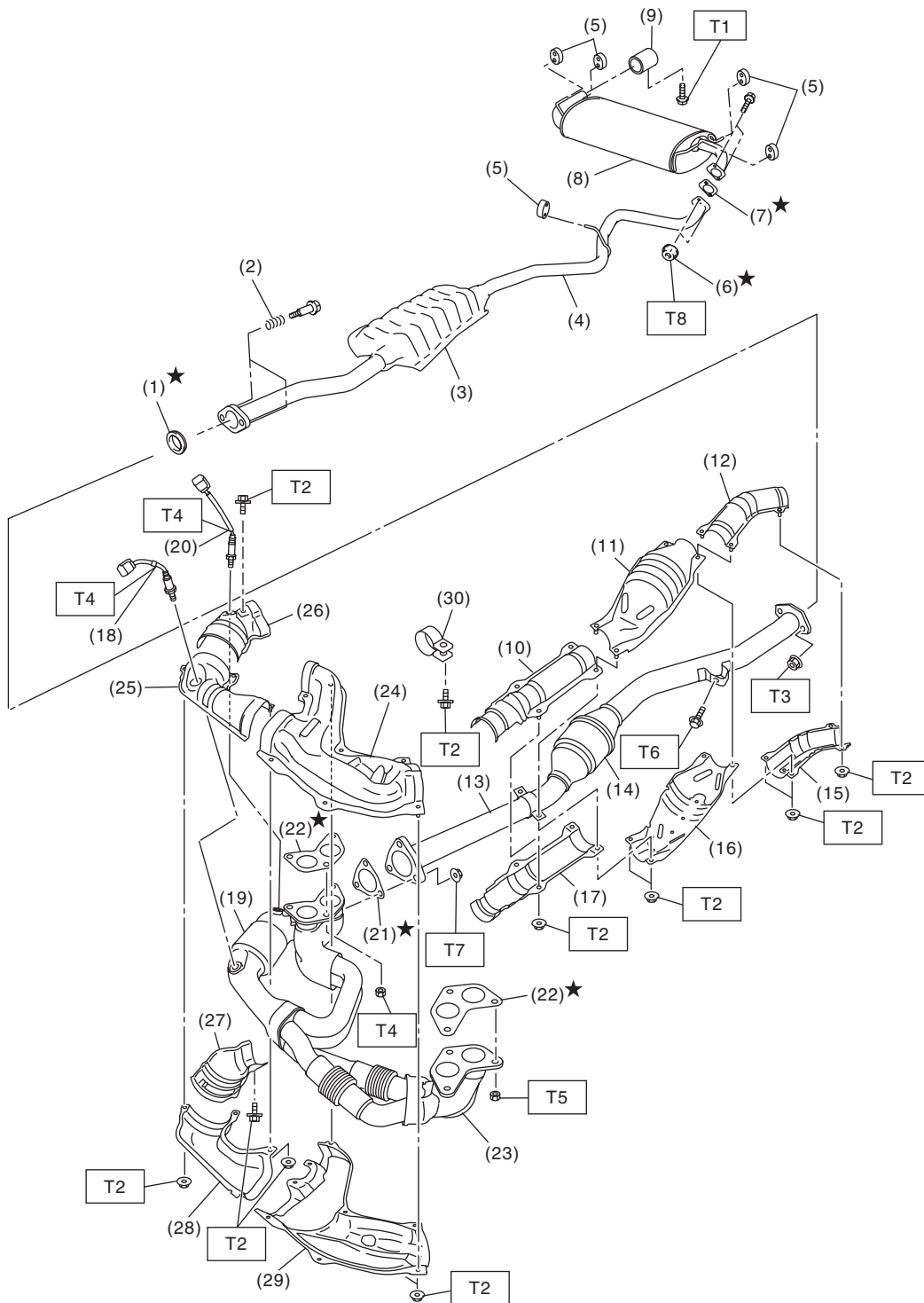

EX-02248

General Description

Brought to you by **3D Eris Studios**
 NOT FOR RESALE
EXHAUST

(1) Gasket	(14) Rear catalytic converter	(27) Front catalytic converter lower cover
(2) Spring	(15) Center exhaust pipe rear lower cover	(28) Front exhaust pipe lower cover RH
(3) Chamber	(16) Rear catalytic converter lower cover	(29) Front exhaust pipe lower cover LH
(4) Rear exhaust pipe	(17) Center exhaust pipe front lower cover	(30) Band
(5) Cushion rubber		
(6) Self-locking nut		
(7) Gasket		
(8) Muffler	(18) Front oxygen (A/F) sensor	
(9) Muffler cutter (Model with muffler cutter)	(19) Front catalytic converter	
(10) Center exhaust pipe front upper cover	(20) Rear oxygen sensor	
(11) Rear catalytic converter upper cover	(21) Gasket	
(12) Center exhaust pipe rear upper cover	(22) Gasket	
(13) Center exhaust pipe	(23) Front exhaust pipe	
	(24) Front exhaust pipe upper cover LH	
	(25) Front exhaust pipe upper cover RH	
	(26) Front catalytic converter upper cover	

Tightening torque:N·m (kgf-m, ft-lb)

T1: 7.5 (0.76, 5.5)

T2: 13 (1.3, 9.4)

T3: 18 (1.8, 13.3)

T4: 21 (2.1, 15.5)

T5: 30 (3.1, 22.1)

T6: 35 (3.6, 25.8)

T7: 40 (4.1, 29.5)

T8: 48 (4.9, 35.4)

B: CAUTION

- Wear appropriate work clothing, including a cap, protective goggles and protective shoes when performing any work.
- Remove contamination including dirt and corrosion before removal, installation or disassembly.
- Keep the disassembled parts in order and protect them from dust and dirt.
- Before removal, installation or disassembly, be sure to clarify the failure. Avoid unnecessary removal, installation, disassembly and replacement.
- Vehicle components are extremely hot after driving. Be wary of receiving burns from heated parts.
- Be sure to tighten fasteners including bolts and nuts to the specified torque.
- Place shop jacks or rigid racks at the specified points.
- Before disconnecting connectors of sensors or units, be sure to disconnect the ground cable from the battery.
- If any fat adheres to the exhaust pipe, wipe it off. Otherwise a fire may happen.

EXHAUST

2. Front Exhaust Pipe

A: REMOVAL

CAUTION:

Be careful not to burn yourself, because the exhaust pipe becomes extremely hot after running.

- 1) Set the vehicle on a lift.
- 2) Disconnect the ground cable from the battery.

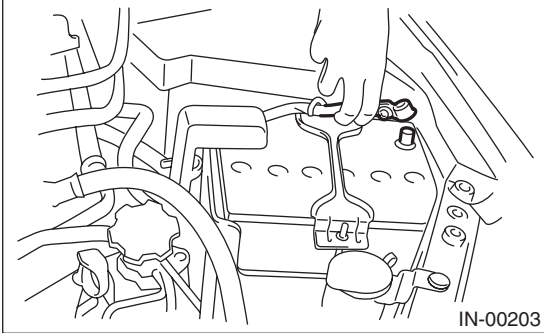

- 3) Unclip the clip fastening the harness and disconnect the following connectors.

- (1) Front oxygen (A/F) sensor connector
- (2) Rear oxygen sensor connector

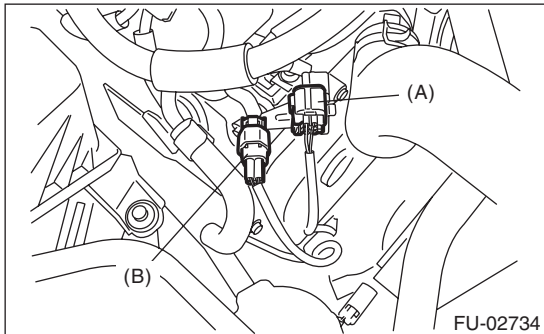

- (A) Front oxygen (A/F) sensor connector
(B) Rear oxygen sensor connector

- 4) Lift up the vehicle.
- 5) Separate the center exhaust pipe from rear exhaust pipe.

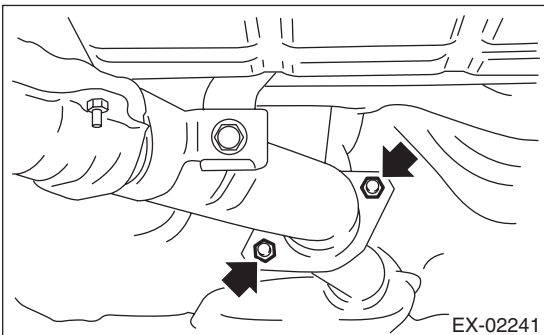

- 6) Remove the under cover.

- 7) Remove the nuts which hold front exhaust pipe onto cylinder heads.

CAUTION:

Be careful not to pull down the front and center exhaust pipe assembly.

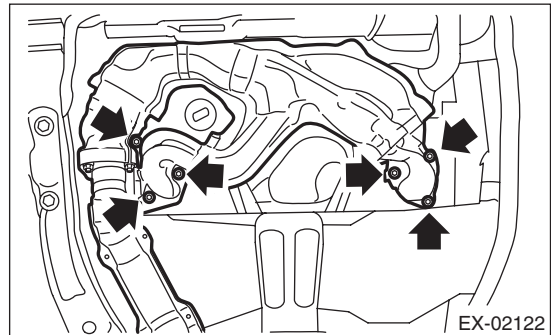

- 8) Remove the bolt which holds center exhaust pipe to hanger bracket.

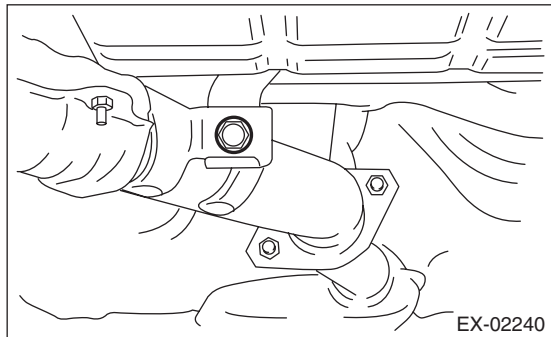

- 9) Remove the front and center exhaust pipe assembly from the vehicle.

CAUTION:

- The front and center exhaust pipe assemblies are very heavy. Be careful not to drop the exhaust pipes when removing.
- After removing the front and center exhaust pipe assemblies, do not pull on the rear exhaust pipe with excessive force.

- 10) Separate the front exhaust pipe from center exhaust pipe.

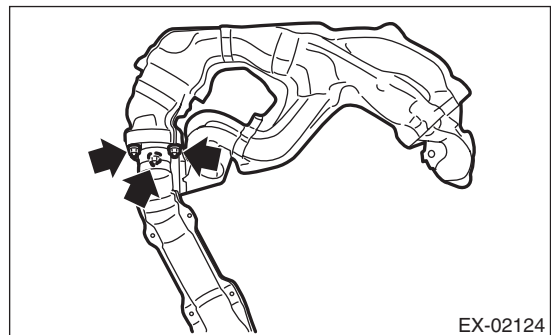

- 11) Remove the front oxygen (A/F) sensor and rear oxygen sensor. <Ref. to FU(H4SO)-35, REMOVAL, Front Oxygen (A/F) Sensor.> <Ref. to FU(H4SO)-37, REMOVAL, Rear Oxygen Sensor.>

B: INSTALLATION

- 1) Install the front oxygen (A/F) sensor and rear oxygen sensor to the front exhaust pipe. <Ref. to FU(H4SO)-36, INSTALLATION, Front Oxygen (A/F) Sensor.> <Ref. to FU(H4SO)-38, INSTALLATION, Rear Oxygen Sensor.>
- 2) Install the front exhaust pipe to center exhaust pipe.

NOTE:

Use a new gasket.

Tightening torque:

40 N·m (4.1 kgf-m, 29.5 ft-lb)

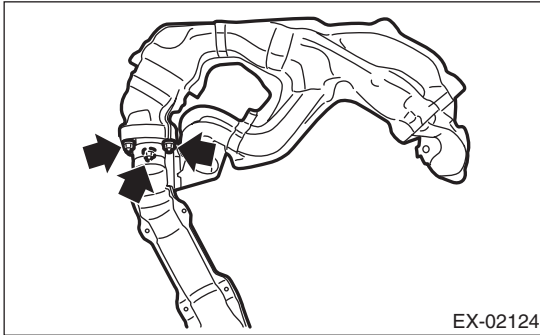

- 3) Install the front and center exhaust pipe assembly to the vehicle.

NOTE:

Use a new gasket.

- 4) Temporarily tighten the nuts which hold front exhaust pipe to cylinder heads.

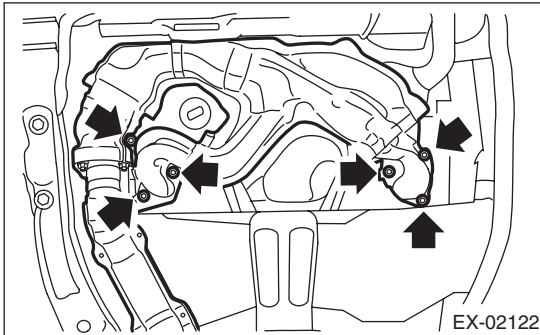

- 5) Tighten the bolt which holds the center exhaust pipe to exhaust pipe.

NOTE:

Use a new gasket.

Tightening torque:

18 N·m (1.8 kgf-m, 13.3 ft-lb)

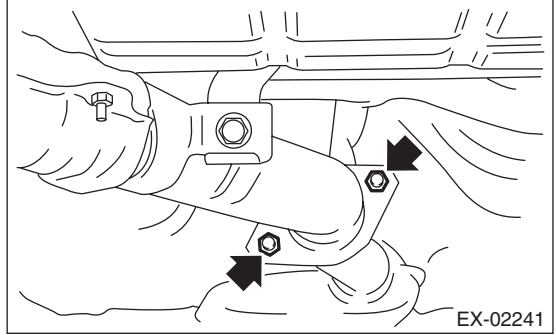

- 6) Tighten the bolt which holds center exhaust pipe to hanger bracket.

Tightening torque:

35 N·m (3.6 kgf-m, 25.8 ft-lb)

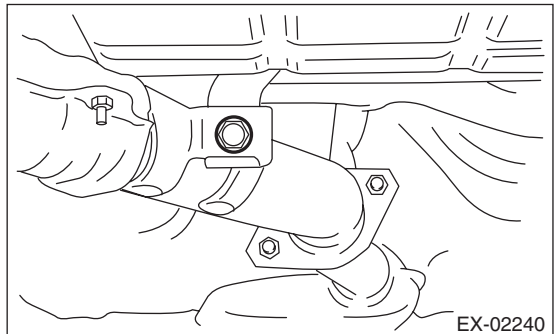

- 7) Tighten the nuts which hold front exhaust pipe to cylinder heads.

Tightening torque:

30 N·m (3.1 kgf-m, 22.1 ft-lb)

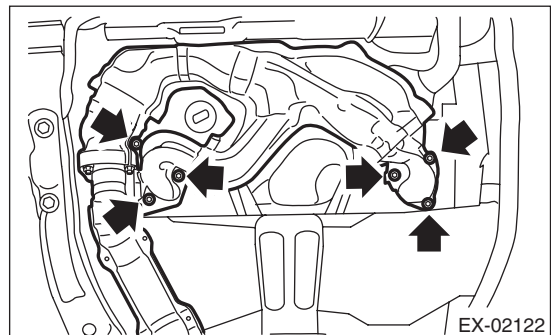

- 8) Install the under cover.
- 9) Lower the vehicle.

Front Exhaust Pipe

Brought to you by Eris Studios
NOT FOR RESALE

EXHAUST

- 10) Connect the following connectors.
 - (1) Front oxygen (A/F) sensor connector
 - (2) Rear oxygen sensor connector

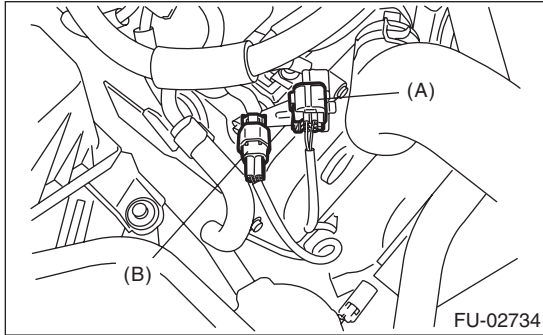

- (A) Front oxygen (A/F) sensor connector
- (B) Rear oxygen sensor connector

- 11) Connect the battery ground cable to battery.

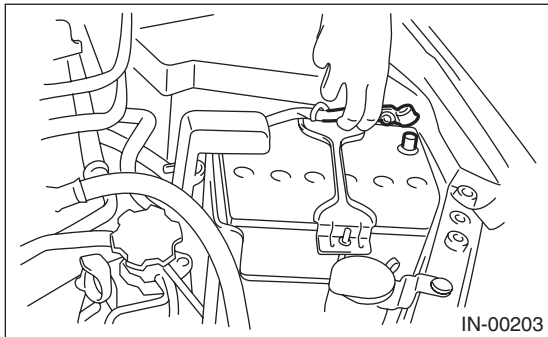

C: INSPECTION

- 1) Check the connections and welds for exhaust leaks.
- 2) Make sure there are no holes or rusting.

3. Center Exhaust Pipe

A: REMOVAL

- 1) After removing the center and front exhaust pipes as one unit, separate them. Refer to “Front Exhaust Pipe” for the removal procedure. <Ref. to EX(H4SO)-6, REMOVAL, Front Exhaust Pipe.>
- 2) Remove the front oxygen (A/F) sensor and rear oxygen sensor. <Ref. to FU(H4SO)-35, REMOVAL, Front Oxygen (A/F) Sensor.> <Ref. to FU(H4SO)-37, REMOVAL, Rear Oxygen Sensor.>

B: INSTALLATION

- 1) Install the front oxygen (A/F) sensor and rear oxygen sensor. <Ref. to FU(H4SO)-36, INSTALLATION, Front Oxygen (A/F) Sensor.> <Ref. to FU(H4SO)-38, INSTALLATION, Rear Oxygen Sensor.>
- 2) Install the center exhaust pipe and front exhaust pipe as one unit. Refer to “Front Exhaust Pipe” for the installation procedure. <Ref. to EX(H4SO)-7, INSTALLATION, Front Exhaust Pipe.>

C: INSPECTION

- 1) Check the connections and welds for exhaust leaks.
- 2) Make sure there are no holes or rusting.

EXHAUST

4. Rear Exhaust Pipe

A: REMOVAL

CAUTION:

Be careful not to burn yourself, because the exhaust pipe becomes extremely hot after running.

- 1) Set the vehicle on a lift.
- 2) Lift up the vehicle.
- 3) Separate the rear exhaust pipe from center exhaust pipe.

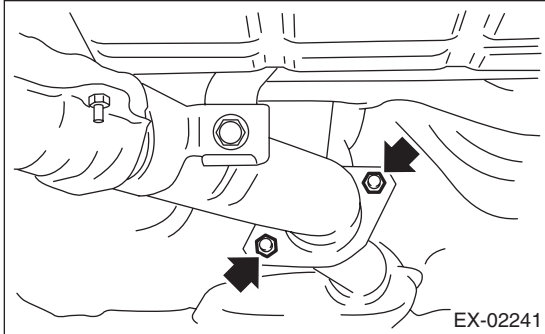

- 4) Separate the rear exhaust pipe from muffler.

CAUTION:

Be careful not to pull down the rear exhaust pipe.

- Sedan model

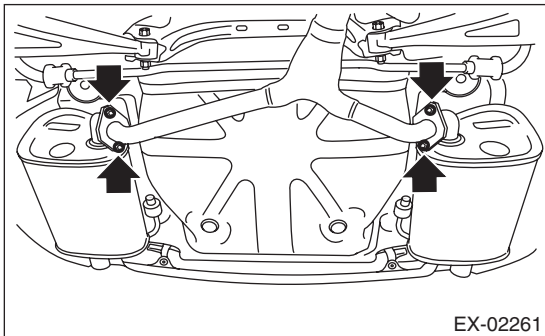

- Wagon model

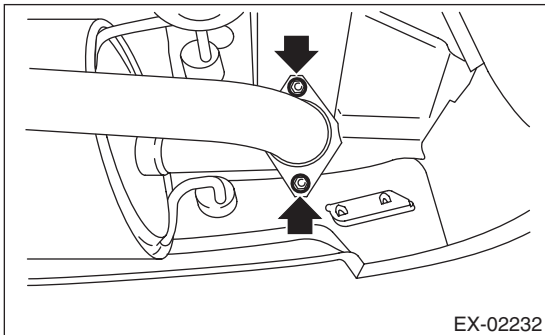

- 5) Apply a coat of spray type lubricant to the mating area of cushion rubber.

- 6) Remove the rear exhaust pipe bracket from cushion rubber.

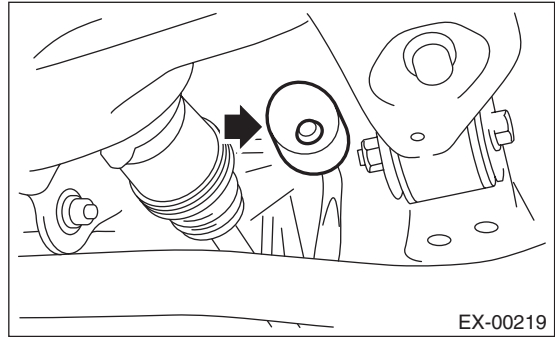

- 7) Remove the rear exhaust pipe.

B: INSTALLATION

- 1) Apply a coat of spray type lubricant to the mating area of cushion rubber.
- 2) Install the rear exhaust pipe bracket to cushion rubber.

NOTE:

After assembling, decrease the lubricant which was applied to the cushion rubber while removing/installing.

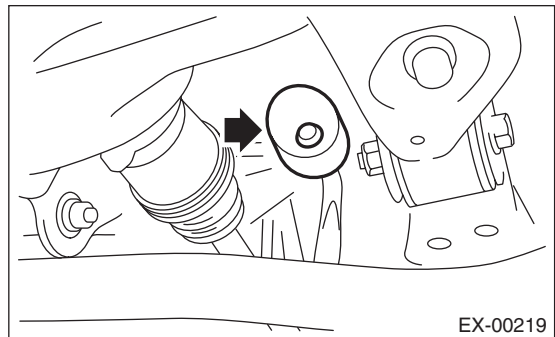

Rear Exhaust Pipe

Brought to you by Eris Studios
NOT FOR SALE

3) Install the rear exhaust pipe to muffler.

NOTE:

Use a new gasket and self-locking nut.

Tightening torque:

48 N·m (4.9 kgf·m, 35.4 ft·lb)

- Sedan model

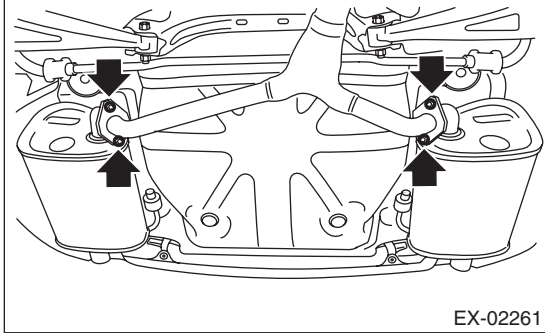

- Wagon model

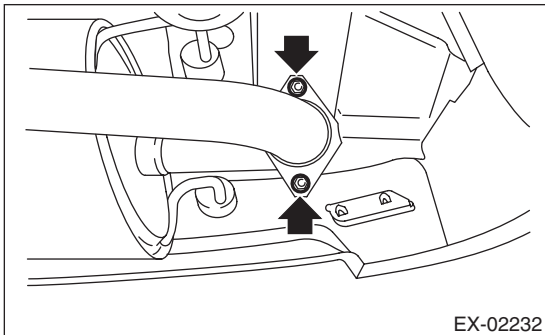

4) Install the rear exhaust pipe to center exhaust pipe.

NOTE:

Use a new gasket.

Tightening torque:

18 N·m (1.8 kgf·m, 13.3 ft·lb)

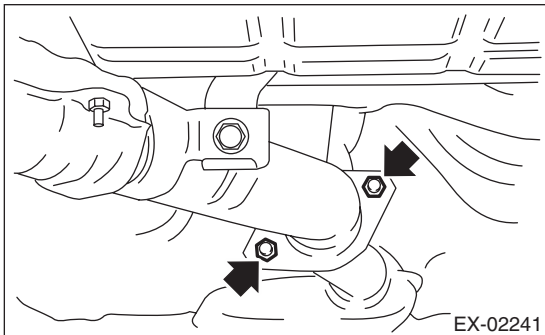

5) Lower the vehicle.

C: INSPECTION

- 1) Check the connections and welds for exhaust leaks.
- 2) Make sure there are no holes or rusting.
- 3) Check the cushion rubber for wear or crack.

EXHAUST

5. Muffler

A: REMOVAL

CAUTION:

Be careful not to burn yourself, because the exhaust pipe becomes extremely hot after running.

- 1) Set the vehicle on a lift.
- 2) Lift up the vehicle.
- 3) Separate the muffler from rear exhaust pipe.

- Sedan model

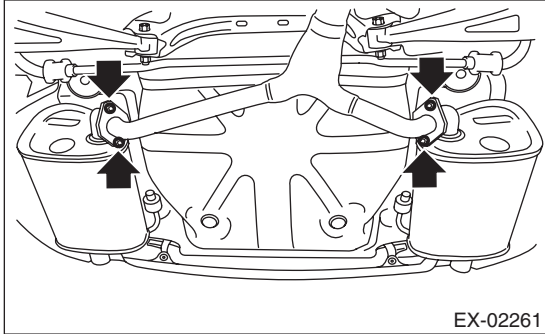

- Wagon model

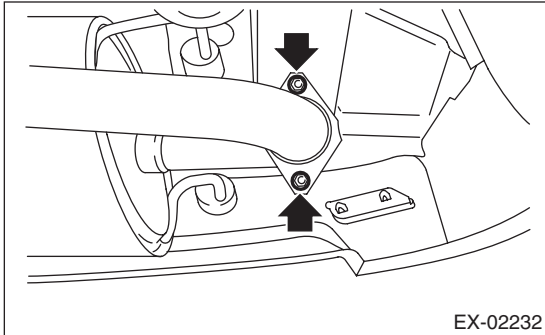

- 4) Apply a coat of spray type lubricant to the mating area of cushion rubber.

- 5) Remove the front and rear cushion rubber, and then remove the muffler.

CAUTION:

Be careful not to drop the muffler during removal.

- Sedan model

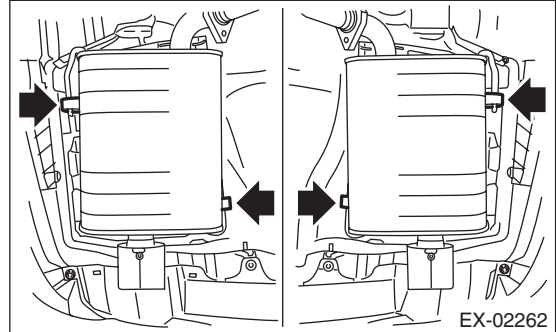

- Wagon model

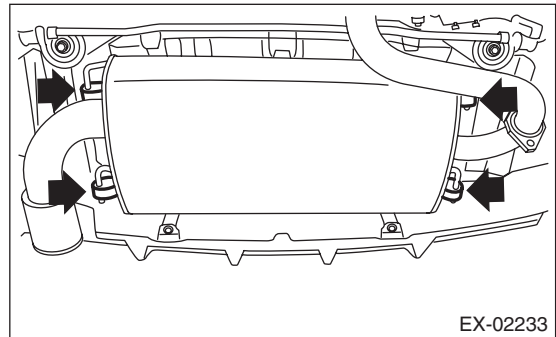

B: INSTALLATION

Install in the reverse order of removal.

NOTE:

- Use a new gasket and self-locking nut.
- After assembling, degrease the lubricant which was applied to the cushion rubber while removing/ installing.

Tightening torque:

48 N·m (4.9 kgf-m, 35.4 ft-lb)

- Sedan model

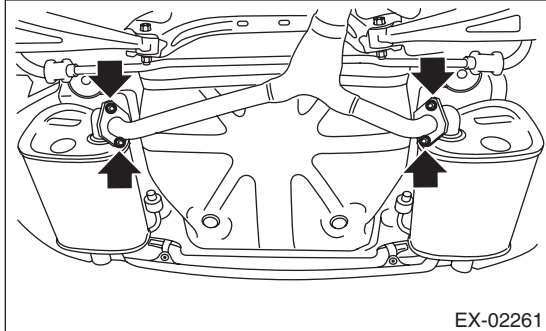

- Wagon model

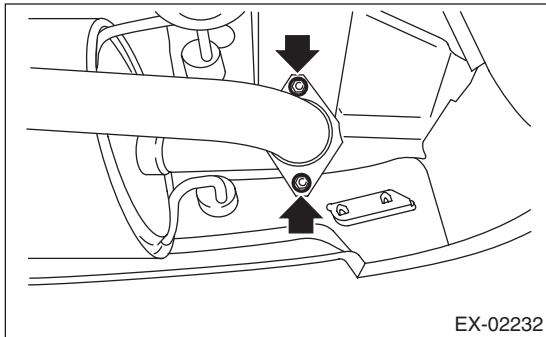

C: INSPECTION

- 1) Check the connections and welds for exhaust leaks.
- 2) Make sure there are no holes or rusting.
- 3) Check the cushion rubber for wear or crack.

Muffler

EXHAUST

Brought to you by Eris Studios
NOT FOR RESALE