

Brought to you by Eris Studios  
NOT FOR RESALE

# EXTERIOR BODY PANELS

# General Description

EXTERIOR BODY PANELS

Brought to you by Eris Studios  
NOT FOR RESALE

## 1. General Description

### A: SPECIFICATION

#### 1. FRONT

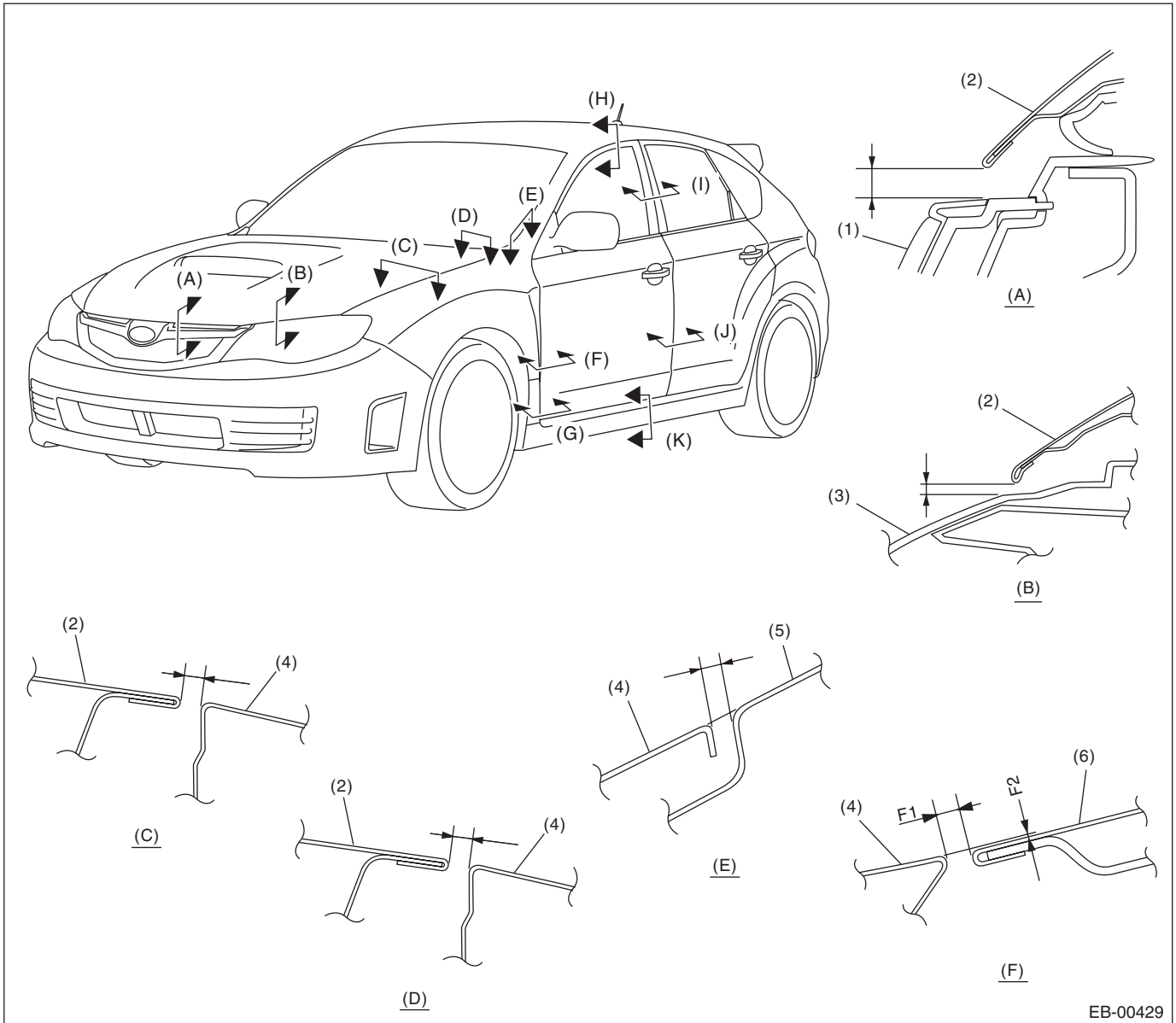

EB-00429

# General Description

## EXTERIOR BODY PANELS

Brought to you by  
NOT FOR SALE  
Pentris Studios

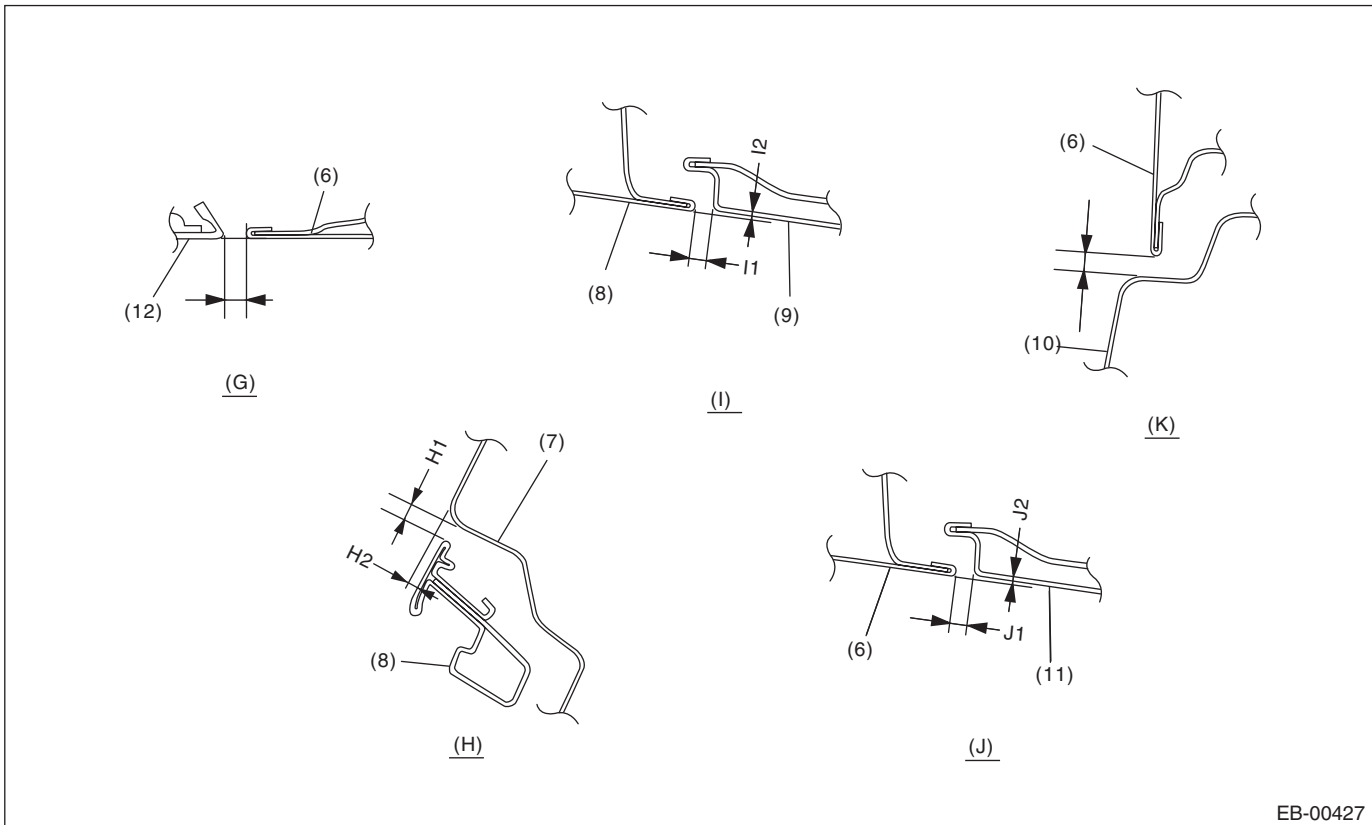

EB-00427

- (1) Front grille
- (2) Front hood panel
- (3) Headlight
- (4) Front fender panel
- (5) Front pillar panel
- (6) Front door panel
- (7) Roof panel
- (8) Front door sash
- (9) Rear door sash
- (10) Side sill spoiler
- (11) Rear door panel
- (12) Fender garnish

Section	Part	Standard value
(A)	Front hood panel to Front grille	6.0±1.0 mm (0.24±0.04 in)
(B)	Front hood panel to Headlight	6.0±1.0 mm (0.24±0.04 in)
(C)	Front hood panel to Front fender panel	3.5±1.0 mm (0.14±0.04 in)
(D)	Front hood panel to Front fender panel (Rear end only)	4.8 <sup>+0.7</sup> <sub>-1.0</sub> mm (0.19 <sup>+0.03</sup> <sub>-0.04</sub> in)
(E)	Front fender panel to Front pillar panel	3.0±1.0 mm (0.12±0.04 in)
(F)	Front fender panel to Front door panel	F1: 4.0±1.0 mm (0.16±0.04 in) F2: 0 <sup>+1.0</sup> <sub>-0.5</sub> mm (0 <sup>+0.04</sup> <sub>-0.02</sub> in)
(G)	Fender garnish to Front door panel	4.0±1.0 mm (0.16±0.04 in)
(H)	Roof panel to Front door sash	H1: 5.0±1.0 mm (0.20±0.04 in) H2: 3.8±1.0 mm (0.15±0.04 in)
(I)	Front door sash to Rear door sash	I1: 5.5±1.0 mm (0.22±0.04 in) I2: 0 <sup>+1.0</sup> <sub>-0.5</sub> mm (0 <sup>+0.04</sup> <sub>-0.02</sub> in)
(J)	Front door panel to Rear door panel	J1: 4.5±1.0 mm (0.18±0.04 in) J2: 0 <sup>+1.0</sup> <sub>-0.5</sub> mm (0 <sup>+0.04</sup> <sub>-0.02</sub> in)
(K)	Front door panel to Side sill spoiler	6.0±1.0 mm (0.23±0.04 in)

# General Description

## EXTERIOR BODY PANELS

### 2. REAR

Brought to you by Eris Studios  
NOT FOR RESALE

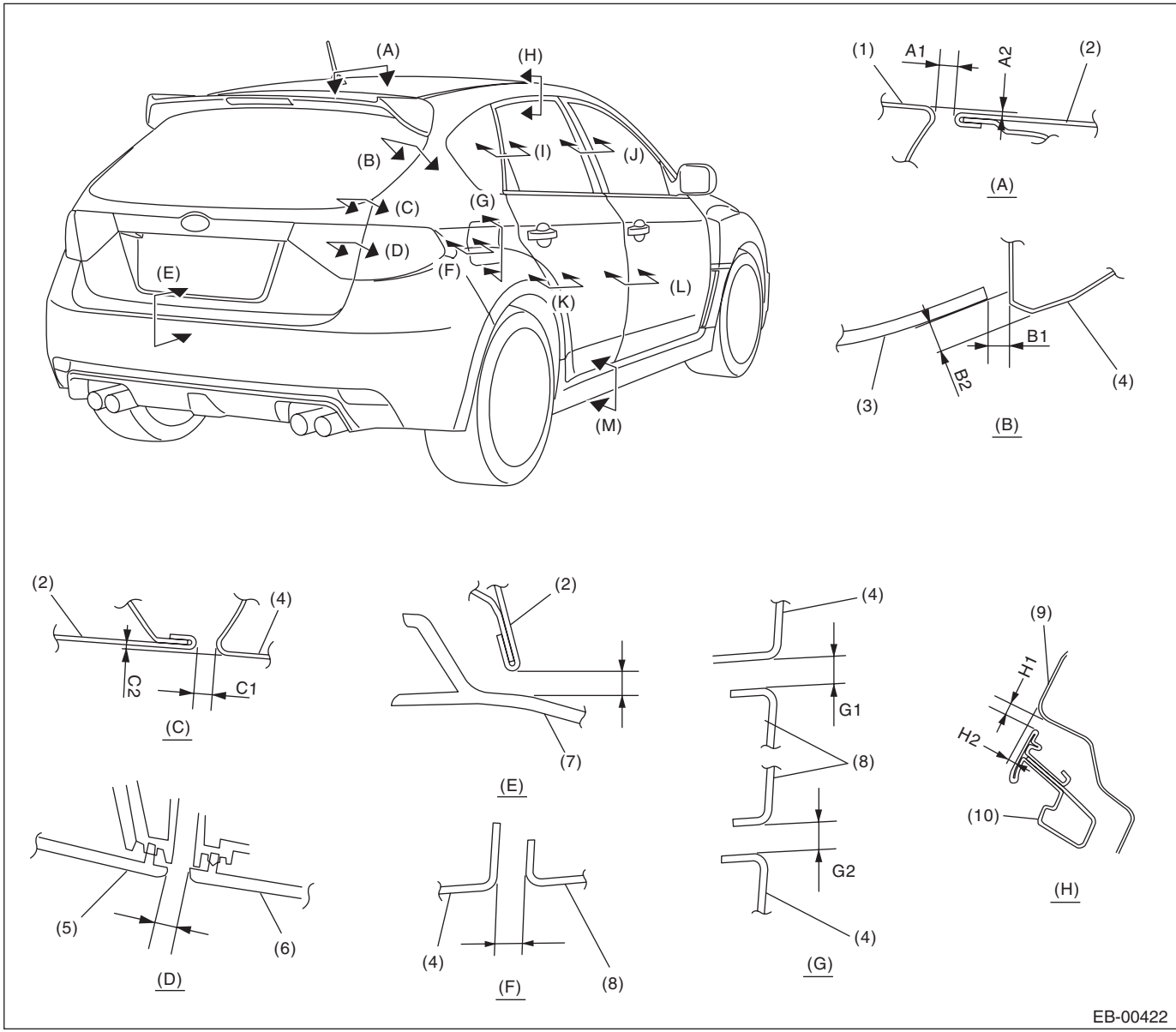

EB-00422

# General Description

## EXTERIOR BODY PANELS

Brought to you by  
NOT FOR SALE  
Pentris Studios

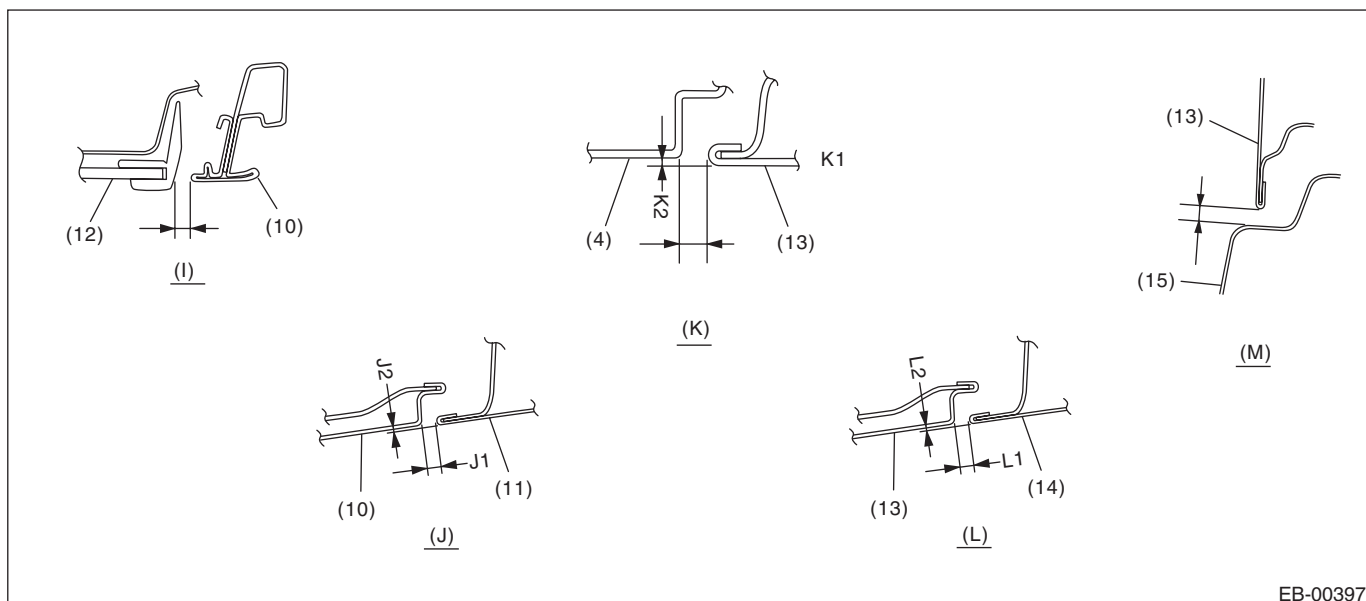

EB-00397

- |                         |                            |                         |
|-------------------------|----------------------------|-------------------------|
| (1) Roof panel          | (6) Rear combination light | (11) Front door sash    |
| (2) Rear gate panel     | (7) Rear bumper            | (12) Rear quarter glass |
| (3) Rear gate glass     | (8) Fuel filler lid        | (13) Rear door panel    |
| (4) Rear quarter panel  | (9) Roof panel             | (14) Front door panel   |
| (5) Rear finisher light | (10) Rear door sash        | (15) Side sill spoiler  |

Section	Part	Standard value
(A)	Roof panel to Rear gate panel	A1: $6.0^{+1.0}_{-0.5}$ mm ( $0.23^{+0.04}_{-0.02}$ in) A2: $1.0 \pm 1.0$ mm ( $0.02 \pm 0.02$ in)
(B)	Rear gate glass to Rear quarter panel	B1: $5.0 \pm 1.5$ mm ( $0.20 \pm 0.06$ in) B2: $6.7 \pm 1.5$ mm ( $0.26 \pm 0.06$ in)
(C)	Rear gate panel to Rear quarter panel	C1: $4.6 \pm 1.0$ mm ( $0.18 \pm 0.04$ in) C2: $0.5 \pm 1.0$ mm ( $0.02 \pm 0.04$ in)
(D)	Rear combination light to Rear finisher light	$5.0 \pm 1.0$ mm ( $0.20 \pm 0.04$ in)
(E)	Rear gate panel to Rear bumper	$8.0 \pm 1.0$ mm ( $0.31 \pm 0.04$ in)
(F)	Rear quarter panel to Fuel filler lid	$3.5 \pm 0.5$ mm ( $0.14 \pm 0.02$ in)
(G)	Rear quarter panel to Fuel filler lid	G1: $3.5 \pm 0.5$ mm ( $0.14 \pm 0.06$ in) G2: $4.0 \pm 0.5$ mm ( $0.18 \pm 0.06$ in)
(H)	Roof panel to Rear door sash	H1: $5.0 \pm 1.0$ mm ( $0.20 \pm 0.04$ in) H2: $3.8 \pm 1.0$ mm ( $0.15 \pm 0.04$ in)
(I)	Rear door sash to Rear quarter glass	$7.0 \pm 1.0$ mm ( $0.28 \pm 0.04$ in)
(J)	Rear door sash to Front door sash	J1: $5.5 \pm 1.0$ mm ( $0.22 \pm 0.04$ in) J2: $0^{+1.0}_{-0.5}$ mm ( $0^{+0.04}_{-0.02}$ in)
(K)	Rear door panel to Rear quarter panel	K1: $4.0 \pm 1.0$ mm ( $0.16 \pm 0.04$ in) K2: $0^{+1.0}_{-0.5}$ mm ( $0^{+0.04}_{-0.02}$ in) (Vehicle body standard)
(L)	Front door panel to Rear door panel	L1: $4.5 \pm 1.0$ mm ( $0.18 \pm 0.04$ in) L2: $0^{+1.0}_{-0.5}$ mm ( $0^{+0.04}_{-0.02}$ in)
(M)	Rear door panel to Side sill spoiler	$6.0 \pm 1.0$ mm ( $0.24 \pm 0.04$ in)

# General Description

## EXTERIOR BODY PANELS

### B: COMPONENT

#### 1. FRONT HOOD

Brought to you by Eris Studios  
NOT FOR SALE

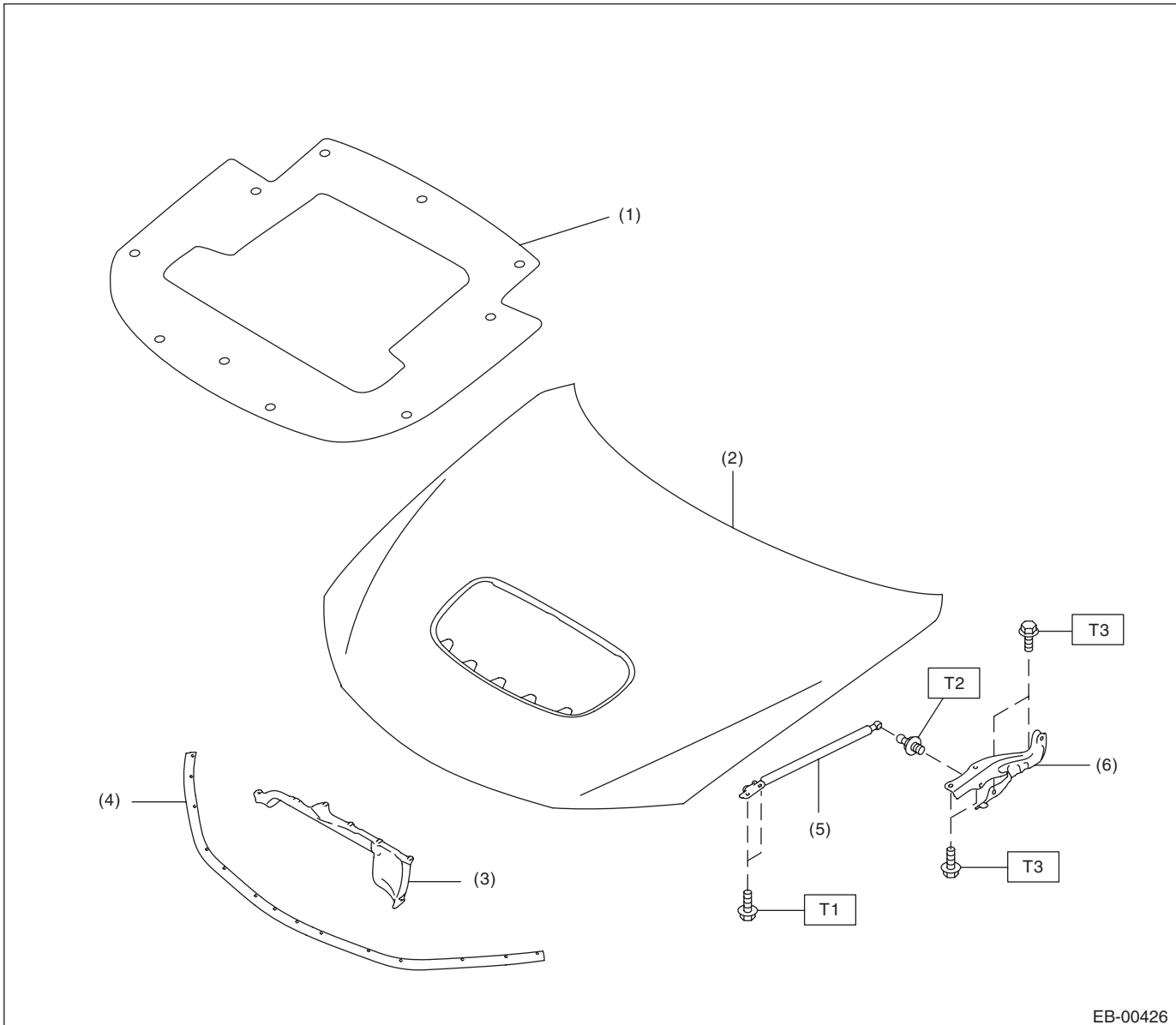

EB-00426

- |                           |                 |
|---------------------------|-----------------|
| (1) Insulator             | (5) Damper stay |
| (2) Front hood panel ASSY | (6) Hinge       |
| (3) Seal (intake duct)    |                 |
| (4) Seal (front panel)    |                 |

**Tightening torque: N·m (kgf·m, ft·lb)**

**T1: 7.5 (0.76, 5.5)**

**T2: 20 (2.04, 14.5)**

**T3: 24.5 (2.5, 18.1)**

### 2. FRONT FENDER

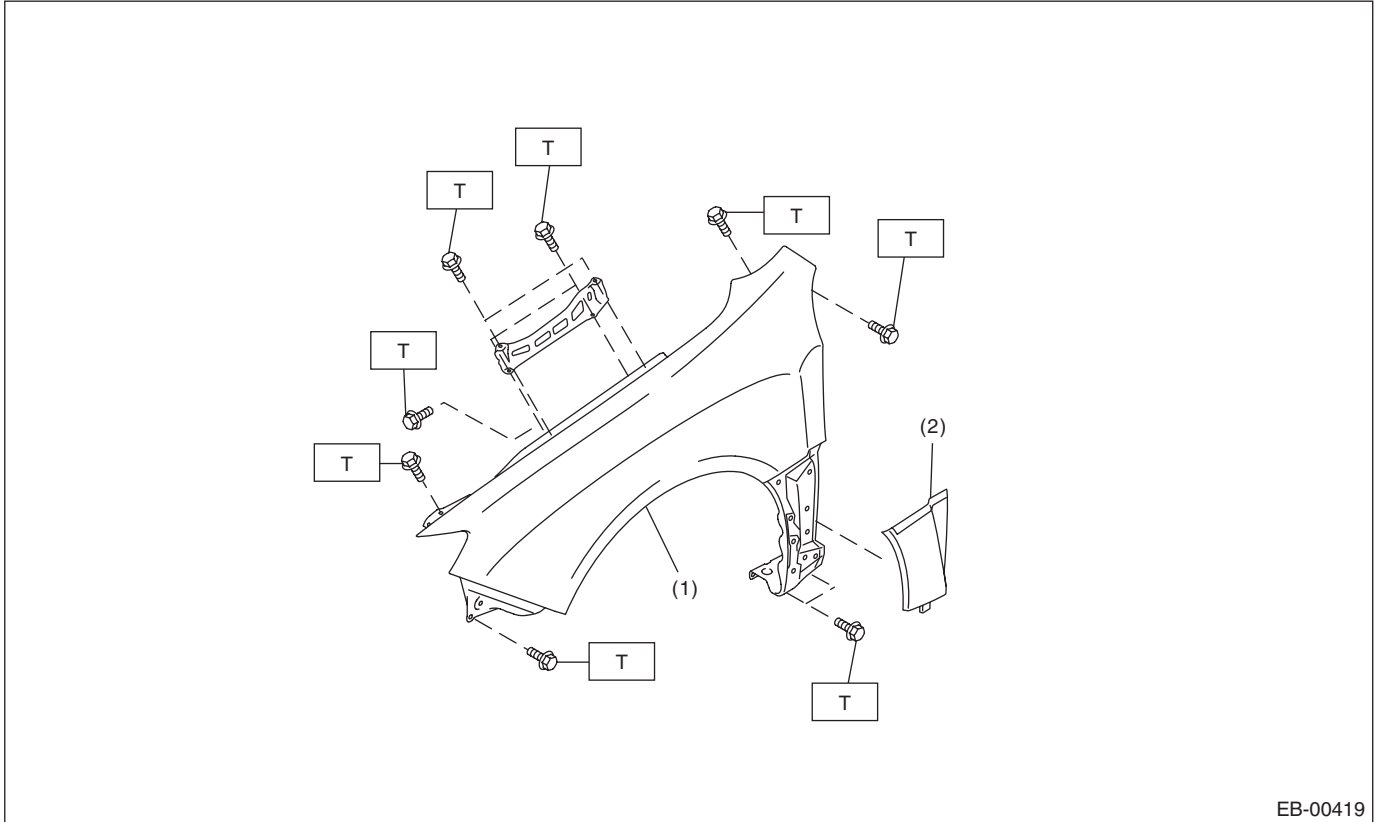

EB-00419

(1) Front fender panel

(2) Front fender garnish

**Tightening torque: N·m (kgf·m, ft·lb)**

**T: 7.4 (0.75, 5.5)**

# General Description

## EXTERIOR BODY PANELS

Brought to you by Eris Studios  
NOT FOR RESALE

### 3. FRONT DOOR

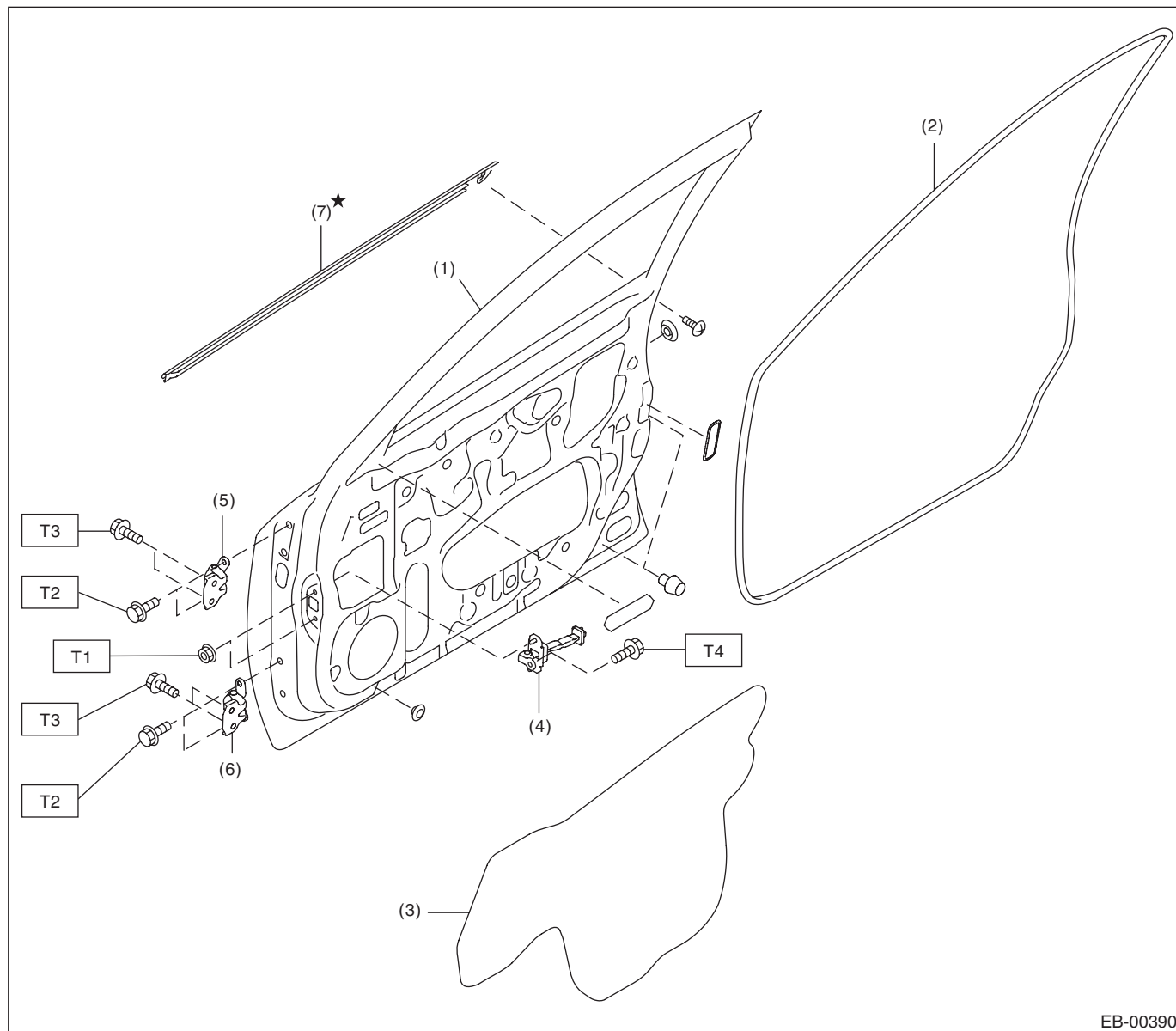

EB-00390

- |                                    |                                    |
|------------------------------------|------------------------------------|
| (1) Front door panel               | (6) Lower hinge                    |
| (2) Front door weather strip inner | (7) Front door weather strip outer |
| (3) Sealing cover                  |                                    |
| (4) Checker                        |                                    |
| (5) Upper hinge                    |                                    |

**Tightening torque: N·m (kgf·m, ft·lb)**

**T1: 7.5 (0.76, 5.5)**

**T2: 25 (2.5, 18.4)**

**T3: 30 (3.1, 22.1)**

**T4: 33 (3.4, 24.3)**



Brought to you by  
 NOT FOR SALE  
 Chris Studios

### 4. REAR DOOR

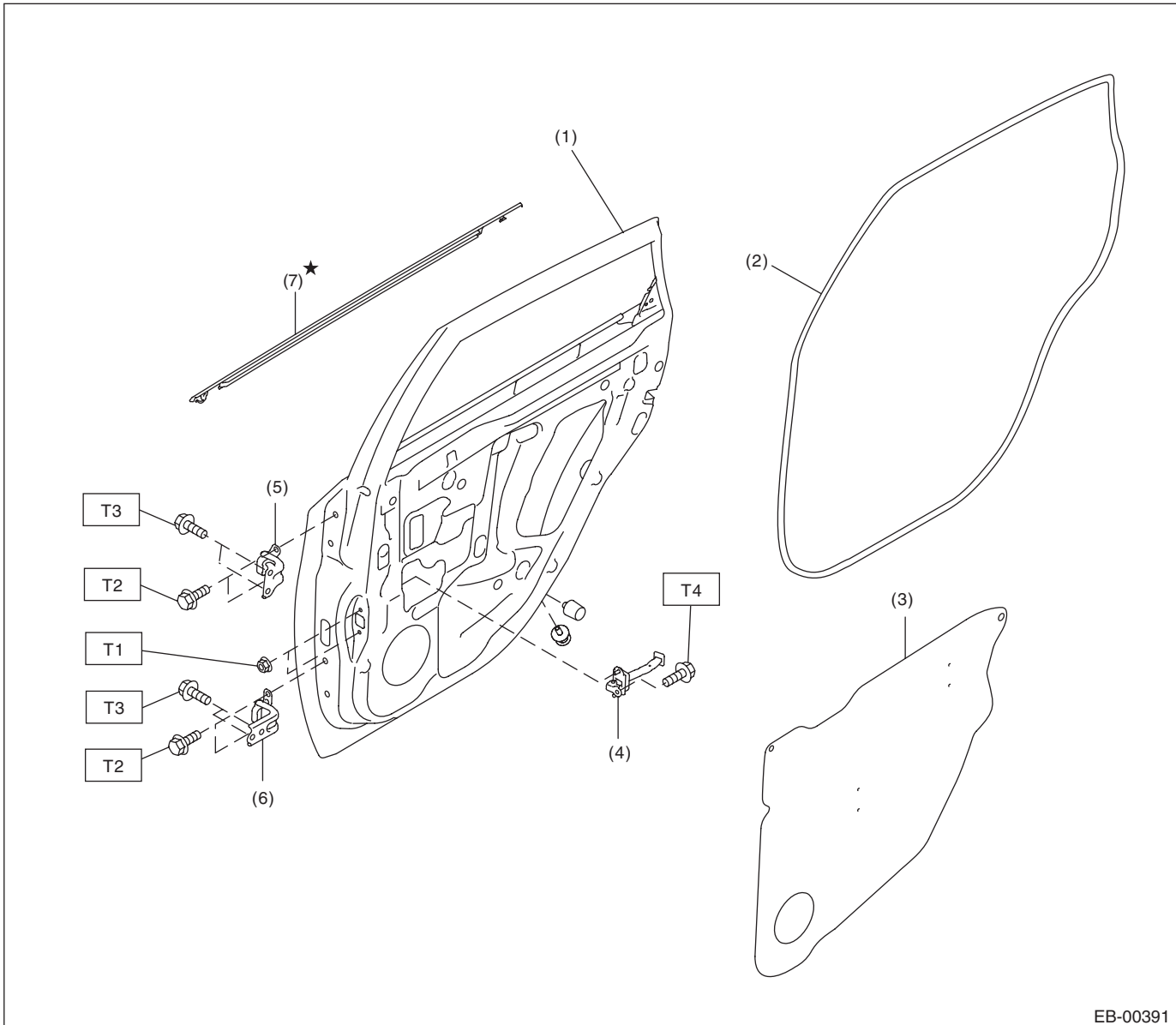

EB-00391

- |                                   |                                   |
|-----------------------------------|-----------------------------------|
| (1) Rear door panel               | (6) Lower hinge                   |
| (2) Rear door weather strip inner | (7) Rear door weather strip outer |
| (3) Sealing cover                 |                                   |
| (4) Checker                       |                                   |
| (5) Upper hinge                   |                                   |

**Tightening torque: N·m (kgf·m, ft·lb)**

**T1: 7.5 (0.76, 5.5)**

**T2: 25 (2.5, 18.4)**

**T3: 30 (3.1, 22.1)**

**T4: 33 (3.4, 24.3)**

# General Description

## EXTERIOR BODY PANELS

Brought to you by Eris Studios  
NOT FOR RESALE

### 5. REAR GATE

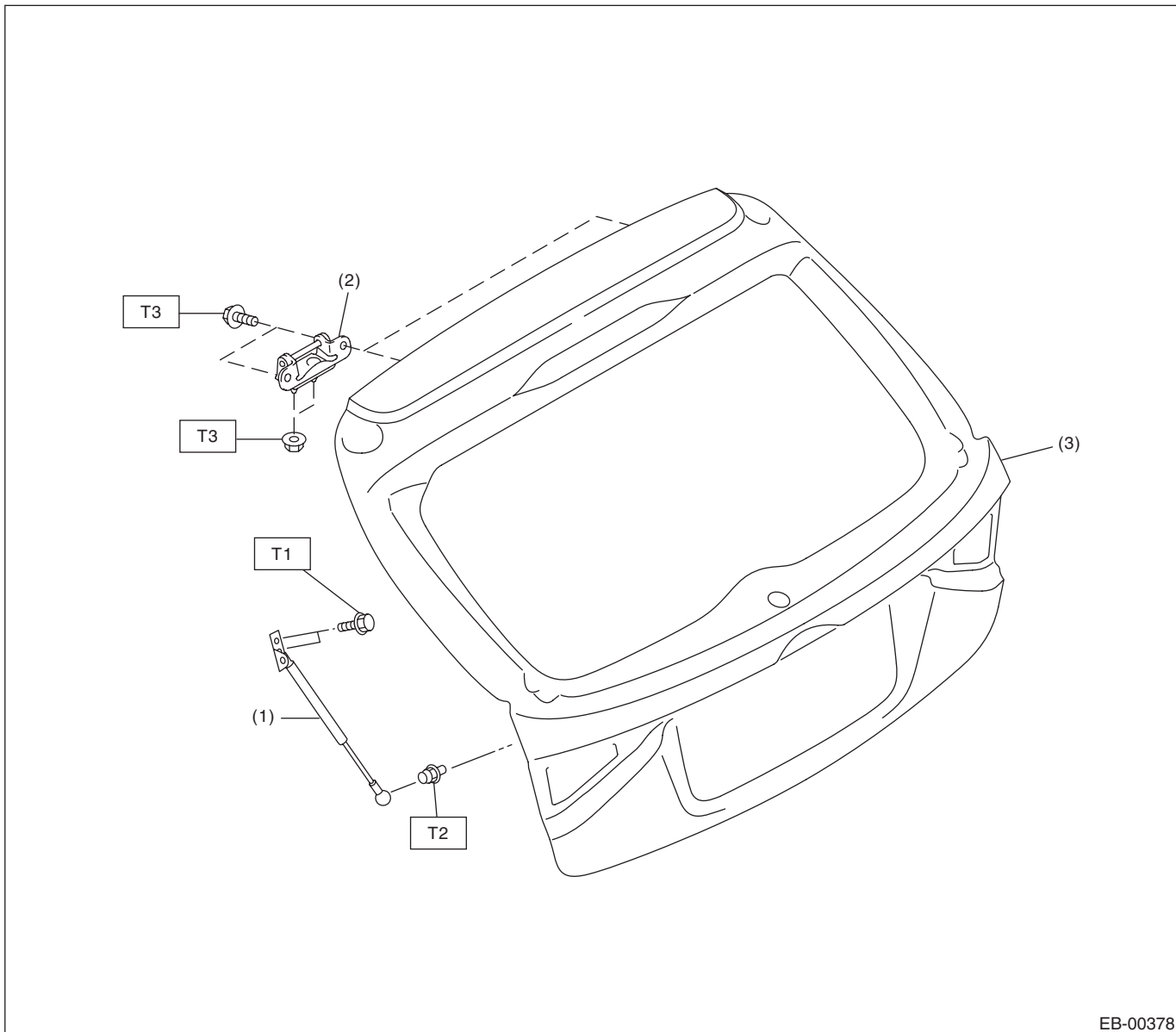

EB-00378

(1) Rear gate damper stay

(3) Rear gate panel

(2) Hinge

**Tightening torque: N·m (kgf·m, ft·lb)**

**T1: 10 (1.02, 7.4)**

**T2: 20 (2.04, 14.5)**

**T3: 25 (2.6, 18.4)**

Brought to you by  
Chris Studios  
NOT FOR SALE

## C: CAUTION

- Exterior body panels are heavy. Do not drop and damage the panels. During removal and installation, do not damage the panel painting surface.
- While removing mounting bolts, using assistance devices such as a support jack will help support the panel.
- Be careful not to lose small parts.

## D: PREPARATION TOOL

### 1. SPECIAL TOOL

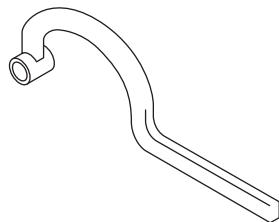
ILLUSTRATION	TOOL NUMBER	DESCRIPTION	REMARKS
  ST-925610000	925610000	WRENCH	Used for removing and installing door hinge.

### 2. GENERAL TOOL

TOOL NAME	REMARKS
Support jack	Used for supporting door panel.
Clip remover	Used for removing various types of clips

## EXTERIOR BODY PANELS

### 2. Front Hood

#### A: REMOVAL

##### 1. FRONT HOOD INSULATOR

Release the clips to remove the front hood insulator.

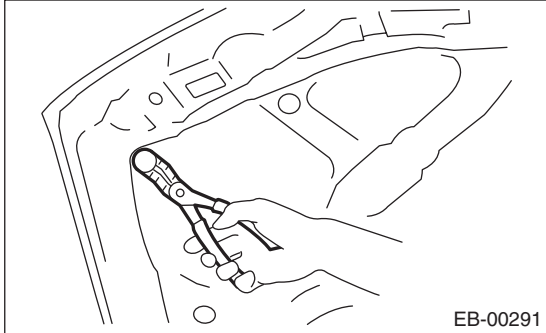

##### 2. FRONT HOOD SEAL

Remove the seal.

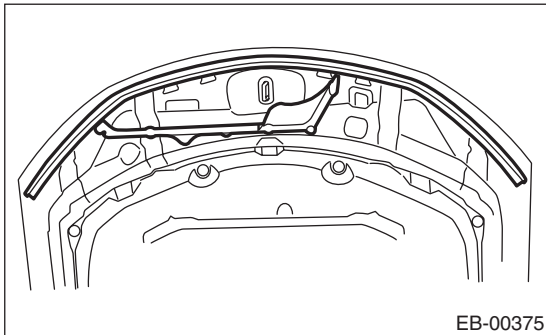

##### 3. FRONT HOOD DAMPER

#### CAUTION:

The front hood panel is heavy. When removing or installing the damper stay and hood hinge, be sure to work in a group of two or more.

1) Remove the mounting bolts, and remove the damper stay.

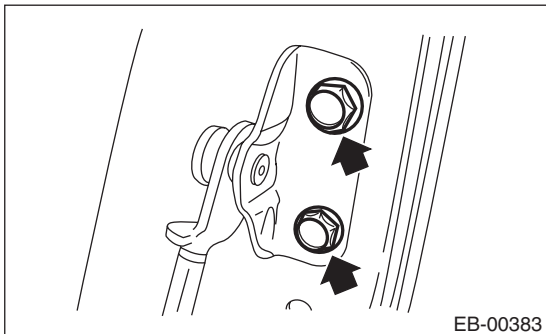

2) Remove the mounting bolt of front hood damper stay.

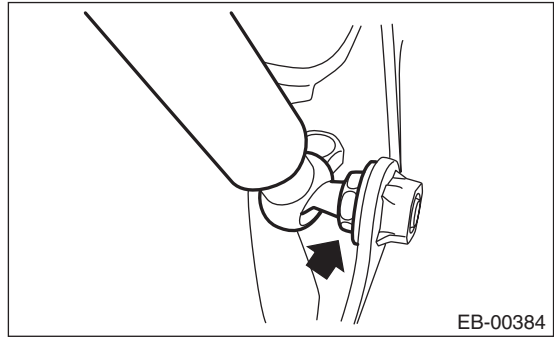

##### 4. FRONT HOOD HINGE

#### CAUTION:

The front hood panel is heavy. When removing or installing the damper stay and hood hinge, be sure to work in a group of two or more.

1) Remove the front hood damper.  
2) Remove the bolts, and remove the front hood panel.

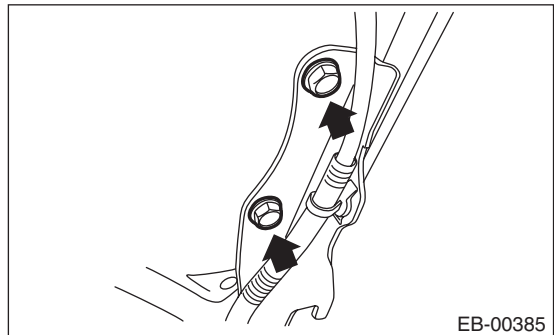

3) Remove the clip, and remove the cowl side panel front.

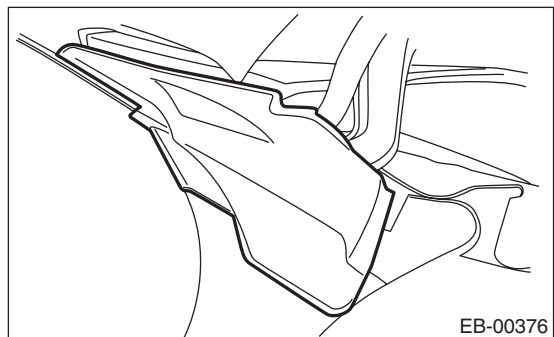

Brought to you by  
NOT FOR SALE  
Chris Studios

4) Remove the bolts of front hood hinge.

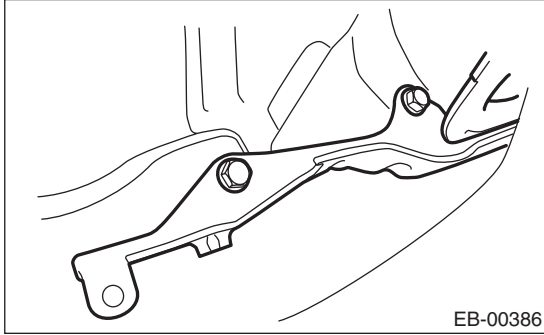

## 5. FRONT HOOD PANEL

### CAUTION:

The front hood panel is heavy. When removing or installing the damper stay and hood hinge, be sure to work in a group of two or more.

- 1) Remove the front hood insulator.
- 2) Remove the front hood seal.
- 3) Remove the window washer hose and nozzle. <Ref. to WW-17, REMOVAL, Front Washer Nozzle.>
- 4) Remove the front hood damper.
- 5) Remove the bolt, and remove the front hood panel from the front hood hinge.

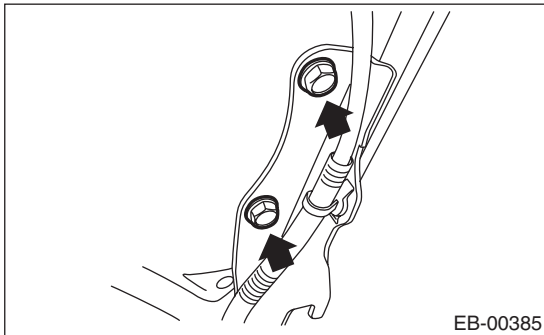

## B: INSTALLATION

Install in the reverse order of removal.

### NOTE:

- Be careful not to catch the window washer hose between insulators etc.
- Install while paying attention to make a uniform clearance around the front hood panel. For the dimension of clearance, refer to "SPECIFICATION" in "General Description". <Ref. to EB-2, SPECIFICATION, General Description.>

### Tightening torque:

Refer to "COMPONENT" of "General Description". <Ref. to EB-6, FRONT HOOD, COMPONENT, General Description.>

## C: ADJUSTMENT

- 1) Adjust the clearance between front hood panel and front fender panel. Clearance must be equal at both sides. For the clearance dimensions, refer to "SPECIFICATION" in "General Description". <Ref. to EB-2, SPECIFICATION, General Description.>
- 2) Use the hinge mounting bolts to align the front hood longitudinal and lateral position.

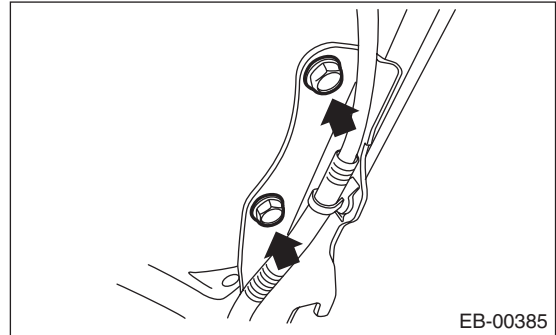

- 3) Adjust the height at the front end of hood. <Ref. to SL-39, ADJUSTMENT, Front Hood Lock Assembly.>
- 4) Rotate the hood buffer to adjust lateral height.

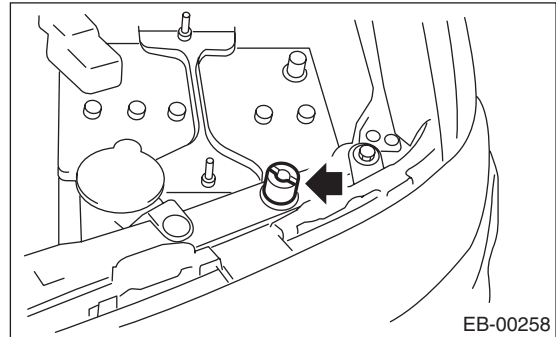

## D: DISPOSAL

For the disposal procedures of front hood damper stay, refer to the disposal procedures of rear gate damper stay. <Ref. to EB-28, REAR GATE DAMPER STAY, DISPOSAL, Rear Gate.>

## 3. Front Fender

### A: REMOVAL

#### 1. FENDER PANEL

- 1) Disconnect the ground cable from the battery.
- 2) Remove the side sill spoilers. <Ref. to EI-37, REMOVAL, Side Sill Spoiler.>
- 3) Remove the front bumper. <Ref. to EI-26, REMOVAL, Front Bumper.>
- 4) Remove the headlight assembly. <Ref. to LI-13, REMOVAL, Headlight Assembly.>
- 5) Remove the mud guard. <Ref. to EI-25, REMOVAL, Mud Guard.>
- 6) Remove the cowl panel side.

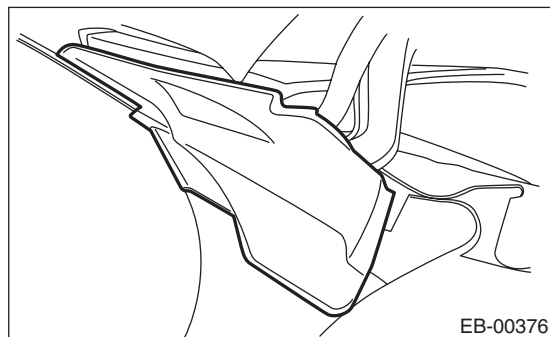

- 7) Remove the bolt, and remove the front fender panel.

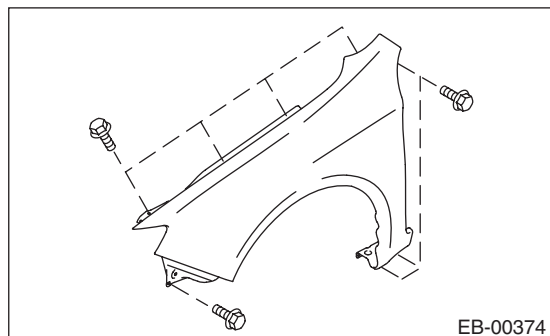

#### 2. FENDER GARNISH

- 1) Disconnect the ground cable from the battery.
- 2) Remove the side sill spoilers. <Ref. to EI-37, REMOVAL, Side Sill Spoiler.>
- 3) Remove the clips and remove the front fender garnish.

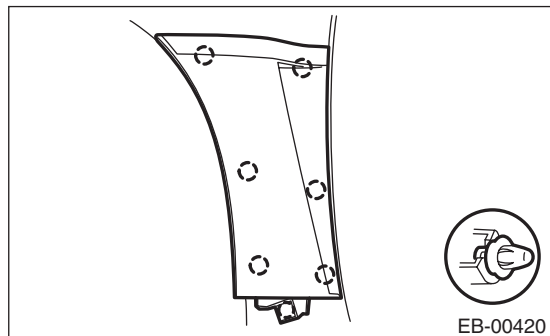

### B: INSTALLATION

Install in the reverse order of removal.

#### Tightening torque:

**7.5 N·m (0.76 kgf-m, 5.5 ft-lb)**

#### CAUTION:

- Always use new double-sided tape.
- After attaching the front fender panel, always perform headlight beam level adjustment.

#### NOTE:

Install while paying attention to make a uniform clearance around the front fender panel. For the clearance dimensions, refer to "SPECIFICATION" in "General Description". <Ref. to EB-2, SPECIFICATION, General Description.>

Brought to you by Chris Studios  
NOT FOR SALE

### 4. Front Door

#### A: REMOVAL

- 1) Disconnect the ground cable from the battery.
- 2) Remove the front door trim. <Ref. to EI-39, REMOVAL, Door Trim.>
- 3) Remove the outer mirror assembly. <Ref. to GW-14, REMOVAL, Outer Mirror Assembly.>
- 4) Remove the front door speaker. <Ref. to ET-7, REMOVAL, Front Speaker.>
- 5) Remove the sealing cover. <Ref. to EB-17, REMOVAL, Front Sealing Cover.>
- 6) Remove the front door glass. <Ref. to GW-10, REMOVAL, Front Door Glass.>
- 7) Remove the front door regulator and motor. <Ref. to GW-11, REMOVAL, Front Regulator and Motor Assembly.>
- 8) Remove the front door latch assembly. <Ref. to SL-33, REMOVAL, Front Door Latch and Door Lock Actuator Assembly.>
- 9) Remove the front outer handle. <Ref. to SL-32, REMOVAL, Front Outer Handle.>
- 10) Remove the front door weather strip inner.

**NOTE:**

If the weather strip clip is removed with excessive force, the weather strip may be damaged. Be sure to use clip remover to remove.

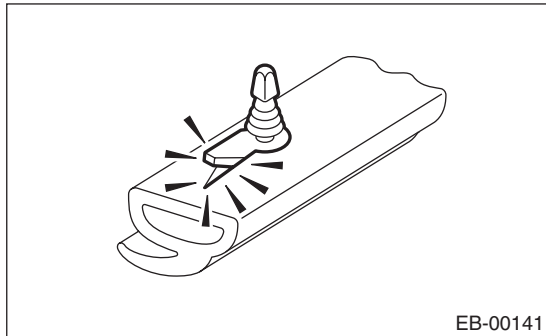

- 11) Remove the bolts and nuts to remove the door checker.

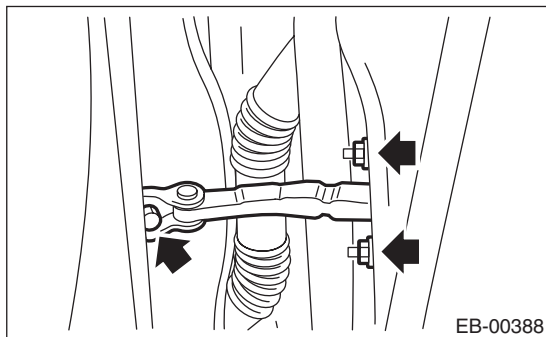

- 12) Remove the front pillar lower trim. <Ref. to EI-49, REMOVAL, Lower Inner Trim.>

- 13) Disconnect the connector of door harness from body harness.

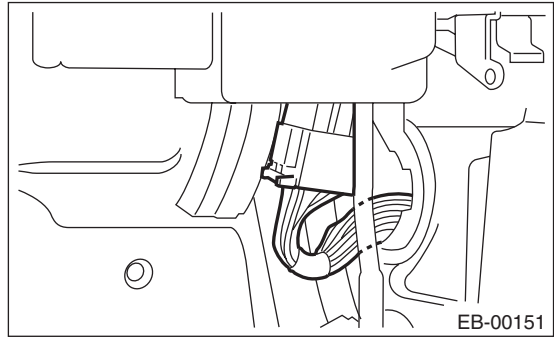

- 14) Put a wooden block on jack and place jack under the front door. Support the door with a jack to protect it from damage.

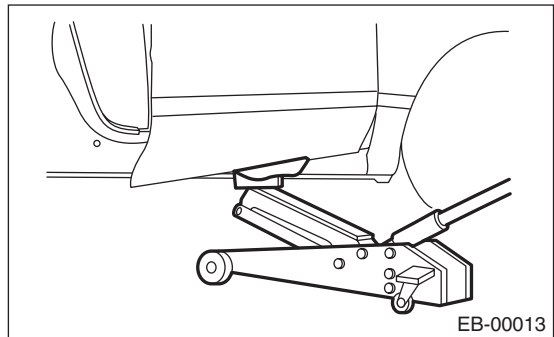

- 15) Remove the door-side bolts for upper and lower hinges, then remove front door panel.

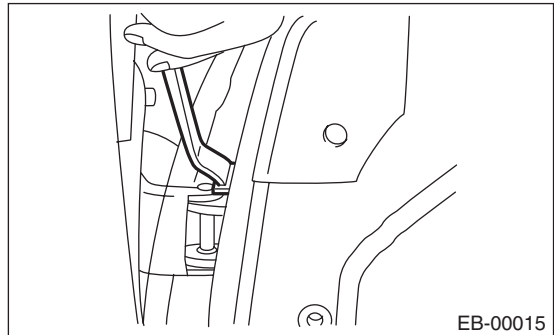

- 16) Remove the door hinge from vehicle.

### B: INSTALLATION

1) Put a wooden block on jack and place the front door on that.

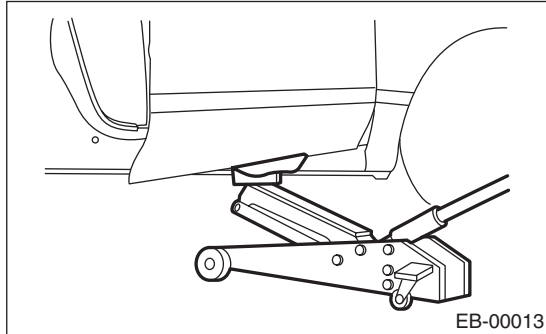

- 2) Apply grease to the sliding area of door hinges, and install the door hinge to vehicle.
- 3) Install the front door to upper hinge and lower hinge adjusting by jack.
- 4) Tighten bolt of door checker.
- 5) Connect door harness connector, and install the instrument panel lower cover.
- 6) Install the front pillar lower trim.

#### **Tightening torque:**

**Refer to "COMPONENT" of "General Description".**

**<Ref. to EB-9, REAR DOOR, COMPONENT, General Description.>**

7) Install while paying attention to make a uniform clearance around the front door panel. For the dimension of clearance, refer to "SPECIFICATION" in "General Description". <Ref. to EB-2, SPECIFICATION, General Description.>

### C: ADJUSTMENT

1) Using the ST, loosen the body-side bolts of upper and lower hinges to align the vertical and horizontal positions of the front door panel.

ST 925610000 WRENCH

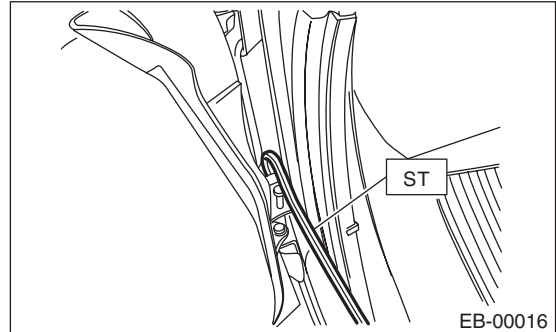

2) Loosen the screw (A) and tap striker (B) using plastic hammer to adjust the gap between rear end surface of front door panel and front end surface of rear door.

#### **CAUTION:**

**Do not use an impact wrench. Welding area on the striker nut plate is easily broken.**

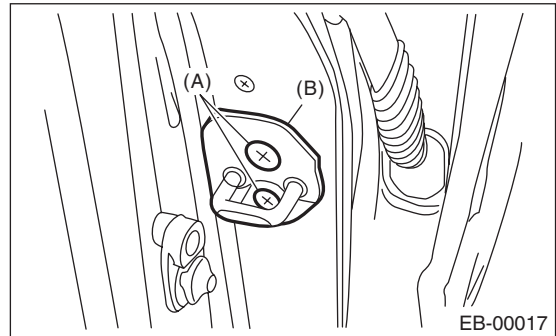



## 5. Front Sealing Cover

### A: REMOVAL

- 1) Disconnect the ground cable from the battery.
- 2) Remove the front door trim. <Ref. to EI-39, REMOVAL, Door Trim.>
- 3) Remove the sealing cover.

**NOTE:**

- Carefully remove the butyl tape. Excessive force will easily break the cover.
- If cover gets broken, replace it with a new part.



### B: INSTALLATION

- 1) Install in the reverse order of removal.
- 2) When replacing the sealing cover, use the butyl tape.
- 3) Press the butyl tape-applied area firmly to prevent any floating on surface.

**Butyl tape:**

**3M8626 or the equivalent**

**NOTE:**

- Apply a uniform bead of butyl tape.
- Attach the sealing cover, keeping it from becoming wrinkled.
- Breaks in the bead will allow water leakage and contamination.

### C: INSPECTION

If the sealing cover gets damaged, replace it with a new part.

### 6. Rear Door

#### A: REMOVAL

- 1) Disconnect the ground cable from the battery.
- 2) Remove the rear door trim. <Ref. to EI-39, REMOVAL, Door Trim.>
- 3) Remove the rear speaker. <Ref. to ET-9, REMOVAL, Rear Speaker.>
- 4) Remove the sealing cover. <Ref. to EB-20, REMOVAL, Rear Sealing Cover.>
- 5) Remove the door sash and rear door glass. <Ref. to GW-17, REMOVAL, Rear Door Glass.>
- 6) Remove the rear door regulator and motor assembly. <Ref. to GW-18, REMOVAL, Rear Regulator and Motor Assembly.>
- 7) Remove the rear door latch. <Ref. to SL-36, REMOVAL, Rear Door Latch and Door Lock Actuator Assembly.>
- 8) Remove the rear outer handle. <Ref. to SL-35, REMOVAL, Rear Outer Handle.>
- 9) Remove the rear door weather strip inner.

**NOTE:**

If the weather strip clip is removed with excessive force, the weather strip may be damaged. Be sure to use clip remover to remove.

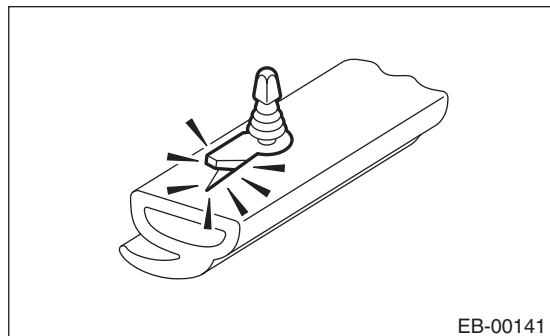

- 10) Remove the bolts and nuts to remove the door checker.

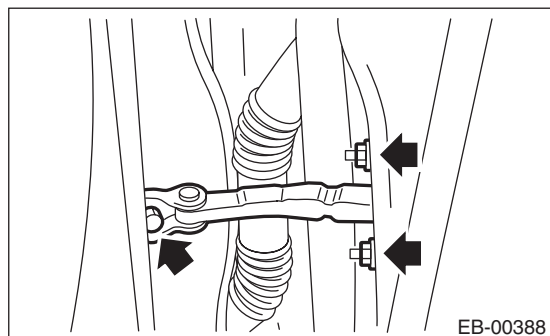

- 11) Pull the door harness connector inside the center pillar, then disconnect the connector.

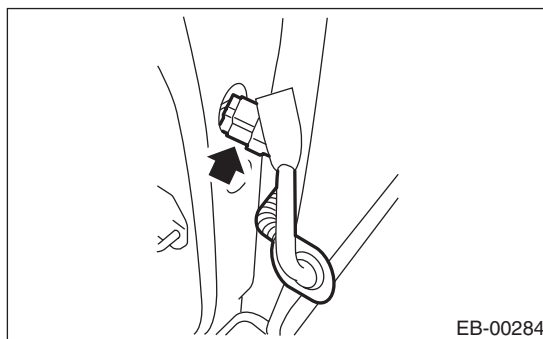

- 12) Put a wooden block on jack and place jack under the rear door. Support the rear door with a jack to protect it from damage.

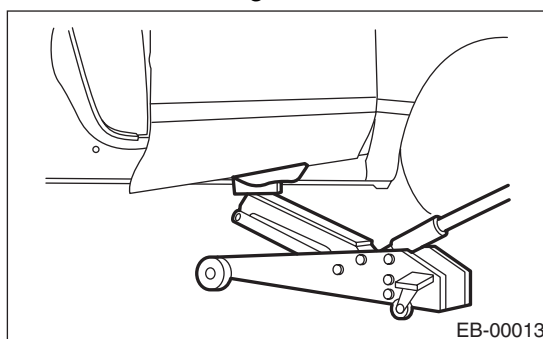

- 13) Remove the door-side bolts for upper and lower hinges, then remove the rear door panel.

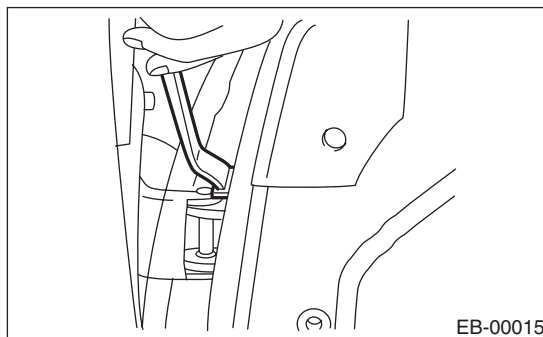

- 14) Remove the door hinge from vehicle.

**B: INSTALLATION**

- 1) Put a wooden block on jack and place the rear door on that.

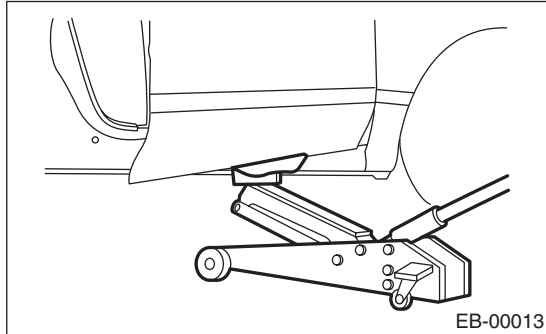

- 2) Apply grease to the moving part of door hinges.
- 3) Install the rear door to upper hinge and lower hinge adjusting by jack.
- 4) Tighten bolt of door checker.
- 5) Connect the door harness connector.

**Tightening torque:**

Refer to “**COMPONENT**” of “**General Description**”.

<Ref. to **EB-9, REAR DOOR, COMPONENT, General Description.**>

- 6) Install while paying attention to make a uniform clearance around the rear door panel. For the dimension of clearance, refer to “**SPECIFICATION**” in “**General Description**”. <Ref. to **EB-2, SPECIFICATION, General Description.**>

**C: ADJUSTMENT**

- 1) Open the rear door, loosen the door-side bolts of upper and lower hinges to align the position for vertical and horizontal direction of rear door panel.

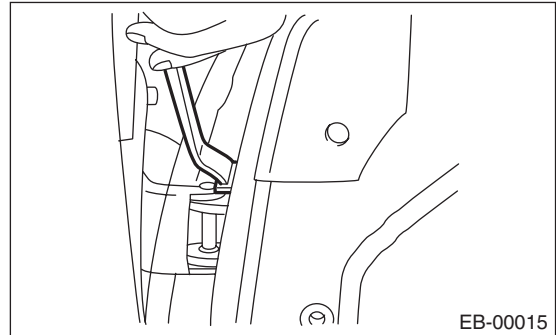

- 2) Loosen the screw (A) and tap striker (B) using plastic hammer to adjust the gap between rear end surface of rear door panel and body surface.

**CAUTION:**

**Do not use an impact wrench. Welding area on the striker nut plate is easily broken.**

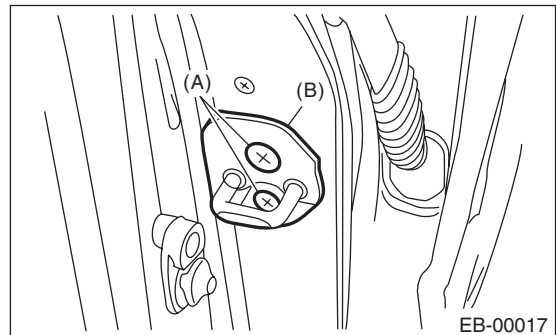

## 7. Rear Sealing Cover

### A: REMOVAL

- 1) Disconnect the ground cable from the battery.
- 2) Remove the rear door trim. <Ref. to EI-39, REMOVAL, Door Trim.>
- 3) Remove the rear speaker. <Ref. to ET-9, REMOVAL, Rear Speaker.>
- 4) Remove the sealing cover.

#### NOTE:

- Carefully remove the butyl tape. Excessive force will easily break the cover.
- If cover gets broken, replace it with a new part.

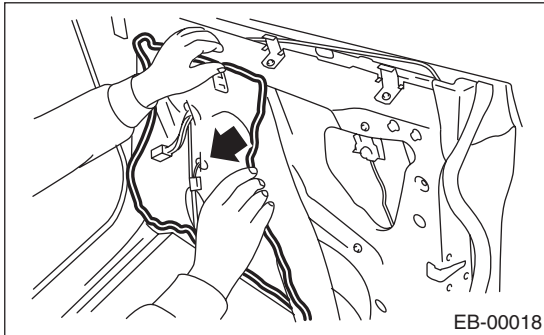

### B: INSTALLATION

- 1) Install in the reverse order of removal.
- 2) When replacing the sealing cover, use the butyl tape.
- 3) Press the butyl tape-applied area firmly to prevent any floating on surface.

#### **Butyl tape:**

**3M8626 or the equivalent**

#### NOTE:

- Apply a uniform bead of butyl tape.
- Attach the sealing cover, keeping it from becoming wrinkled.
- If the butyl tape is applied unevenly, it will cause water leakage and soiling.

### C: INSPECTION

If the sealing cover gets damaged, replace it with a new part.

Brought to you by Chris Studios  
NOT FOR SALE

## 8. Door Sash Tape

### A: REMOVAL

#### 1. FRONT DOOR

- 1) Disconnect the ground cable from the battery.
- 2) Remove the front door trim. <Ref. to EI-39, REMOVAL, Door Trim.>
- 3) Remove the outer mirror assembly. <Ref. to GW-14, REMOVAL, Outer Mirror Assembly.>
- 4) Remove the sealing cover. <Ref. to EB-17, REMOVAL, Front Sealing Cover.>
- 5) Remove the front door glass. <Ref. to GW-10, REMOVAL, Front Door Glass.>
- 6) Remove the glass run rubber.
- 7) Remove the B pillar upper clip, and remove the front door weather strip.

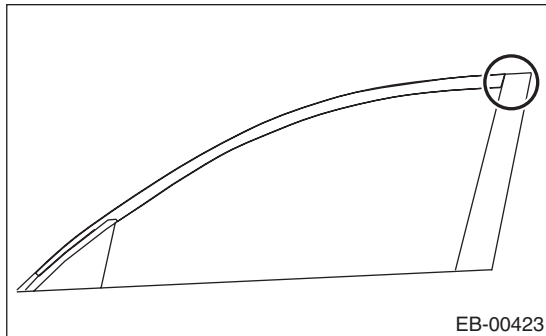

- 8) Remove the screws, and remove the front door weather strip outer.

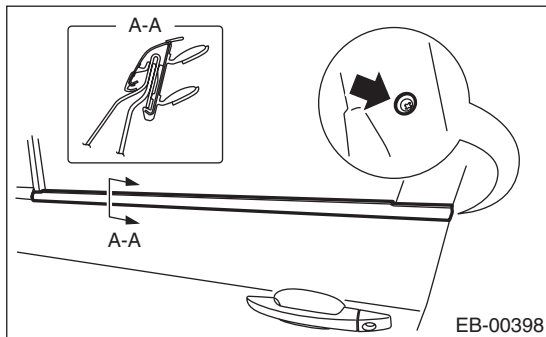

#### CAUTION:

- When removing the weather strip outer, be careful not to damage the vehicle.
- If the weather strip outer is deformed, always replace with a new part.

- 9) Peel the door sash tape from the door sash.

#### NOTE:

- If the tape is difficult to remove, warm the tape with a hairdryer, etc. to make the removal easier. Use a household hairdryer. Do not use industrial dryers.
- If tape residue is remaining on the door sash, wipe clean.

#### 2. REAR DOOR

- 1) Disconnect the ground cable from the battery.
- 2) Remove the rear door trim. <Ref. to EI-39, REMOVAL, Door Trim.>
- 3) Remove the sealing cover. <Ref. to EB-20, REMOVAL, Rear Sealing Cover.>
- 4) Remove the rear door glass. <Ref. to GW-17, REMOVAL, Rear Door Glass.>
- 5) Remove the glass run rubber.
- 6) Remove the B pillar upper clip, and remove the front door weather strip.

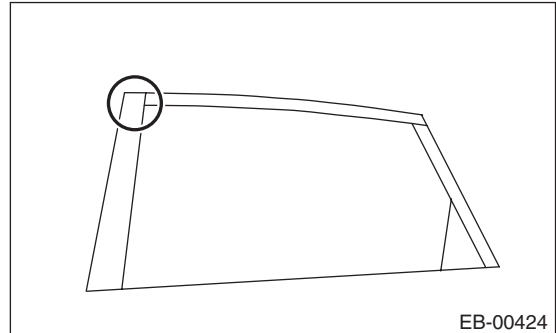

- 7) Loosen the screws and clips to remove the gusset cover outer.

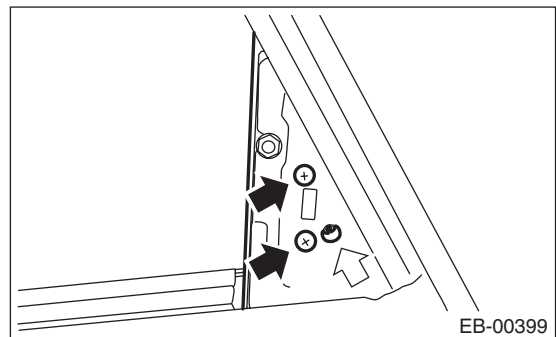

- 8) Remove the rear door weather strip outer.

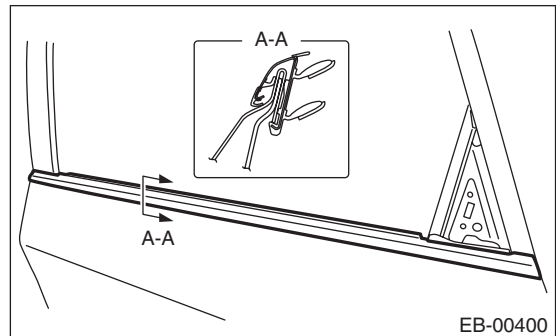

#### CAUTION:

- When removing the weather strip outer, be careful not to damage the vehicle.
- If the weather strip outer is deformed, always replace with a new part.

# Door Sash Tape

Brought to you by Eris Studios  
NOT FOR RESALE

## EXTERIOR BODY PANELS

9) Peel the door sash tape from the door sash.

### NOTE:

- If the tape is difficult to remove, warm the tape with a hairdryer, etc. to make the removal easier. Use a household hairdryer. Do not use industrial dryers.
- If tape residue is remaining on the door sash, wipe clean.

## B: INSTALLATION

### CAUTION:

- When applying tape, use a spatula, etc. to apply evenly, pushing it against the sash to make sure that no air bubbles are formed. If air bubbles are formed, reapply the tape.
- If the tape is wrinkled, etc. during application, replace the tape.
- Turning points and ends of the tape will be a cause for peeling if the pressure is insufficient during application, so make sure to push down on the tape firmly when applying.
- There are locations where the tape ends will overlap each other. When applying the tape, be careful of the order of their application.

#### • Front

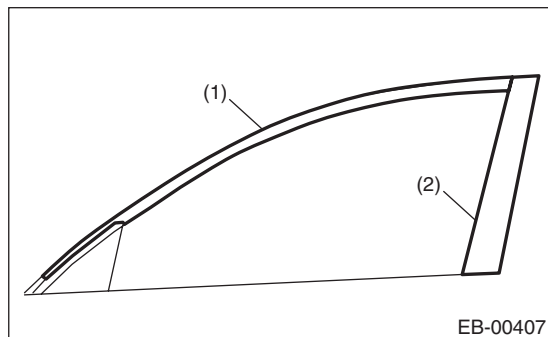

#### • Rear

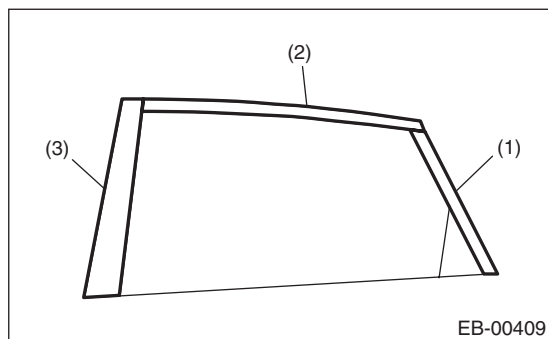

## 1. FRONT DOOR

1) Match the upper area of the gusset and the cut area of the tape as shown in the figure. (Position of the arrow)

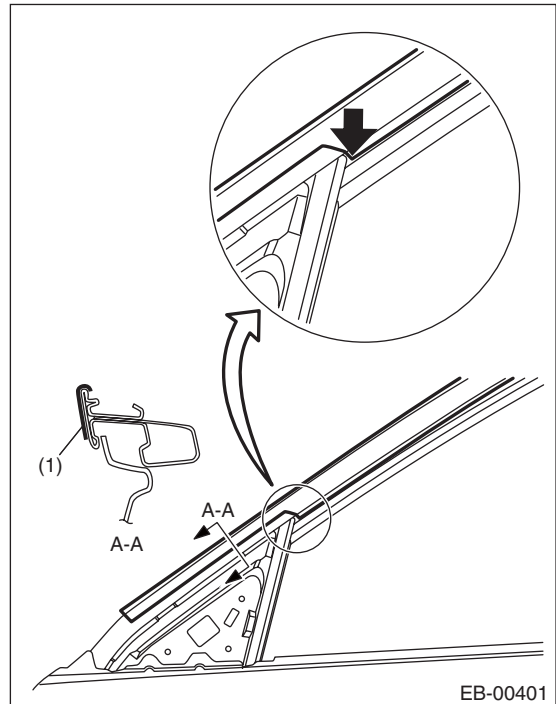

2) Apply tape from the front of the vehicle towards the rear.

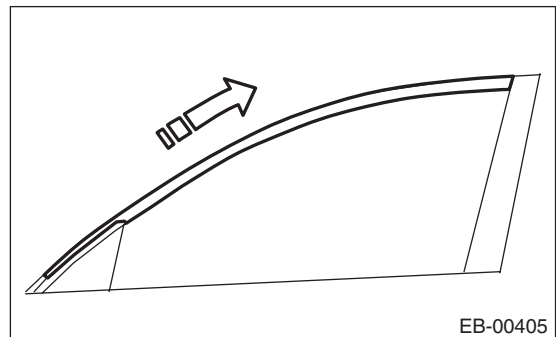

### NOTE:

Apply the tape end at a position within  $2.5 \pm 1.5$  mm from the front door rear sash line.

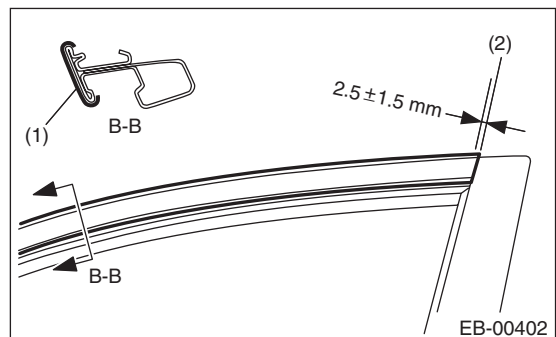

(1) Front door sash tape - front

(2) Front door rear sash line

Brought to you by  
NOT FOR SALE  
Pentris Studios

3) Cut off both ends of the front door sash tape - rear.

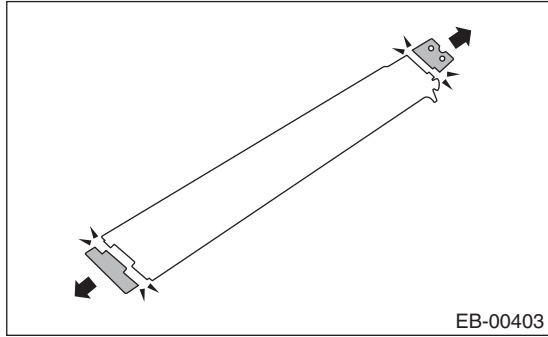

7) Fold the corners at the door upper end area in the order of (1) — (3).

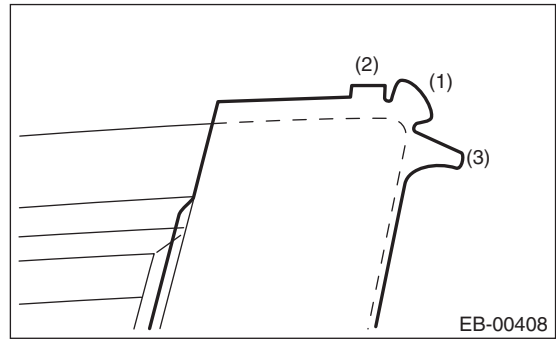

4) Match the sash corner and the cut area of the tape as shown in the figure. (Position of the arrow)

5) The lower end of the tape is to be aligned so that a space of approximately 3.7 mm remains, so that the attachment holes of the weather strip outer are not blocked. (Position of the arrow)

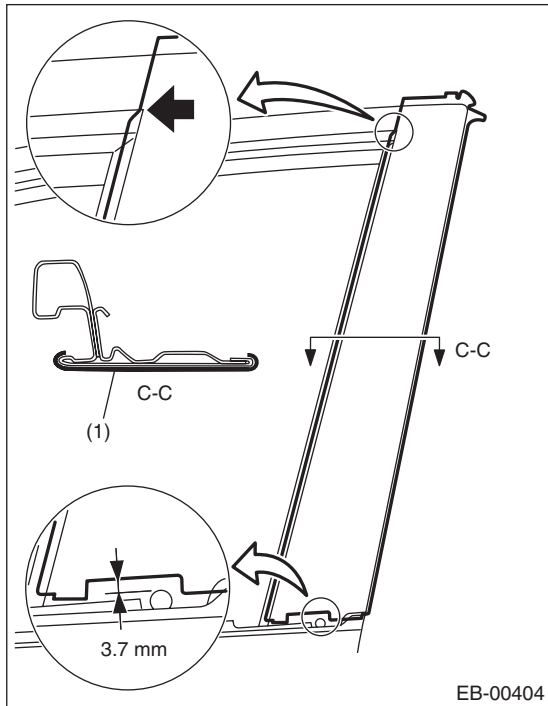

8) Thereafter, install door parts in the reverse order of disassembly.

9) Install while paying attention to make a uniform clearance around the front door panel. For the clearance dimensions, refer to "SPECIFICATION" in "General Description". <Ref. to EB-2, SPECIFICATION, General Description.>

6) Apply tape from the top of the vehicle towards the bottom.

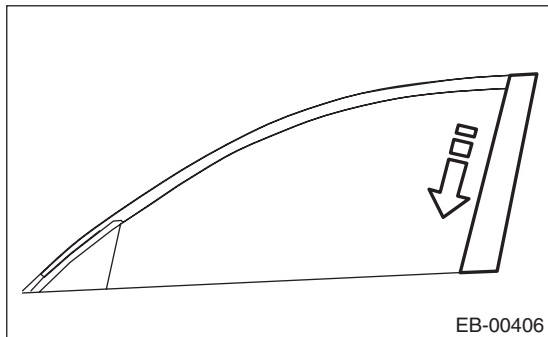

# Door Sash Tape

Brought to you by Eris Studios  
NOT FOR RESALE

## EXTERIOR BODY PANELS

### 2. REAR DOOR

1) Apply the tape end at a position within  $2.5 \pm 1.5$  mm from the rear door front sash line.

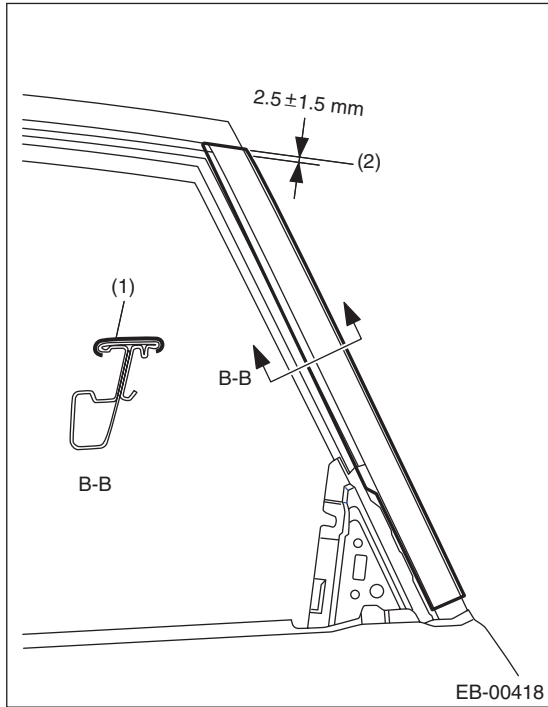

- (1) Rear door sash tape - rear
- (2) Rear door upper sash line

2) Apply tape from the top of the vehicle towards the bottom.

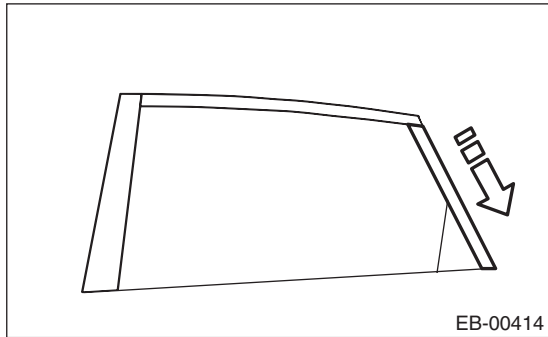

3) Match the rear door upper sash corner and the cut area of the tape as shown in the figure. (Position of the arrow)

#### NOTE:

Apply the tape end at a position within  $2.5 \pm 1.5$  mm from the rear door front sash line.

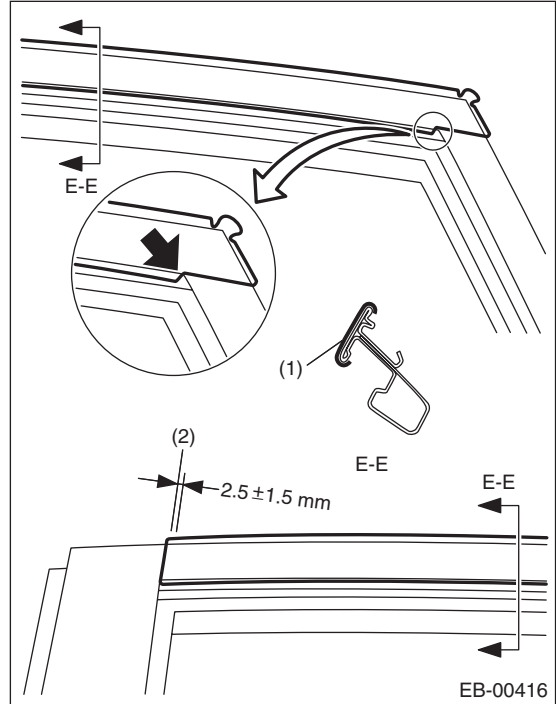

- (1) Rear door sash tape - medium
- (2) Rear door front sash line

4) Apply tape from the rear of the vehicle towards the front.

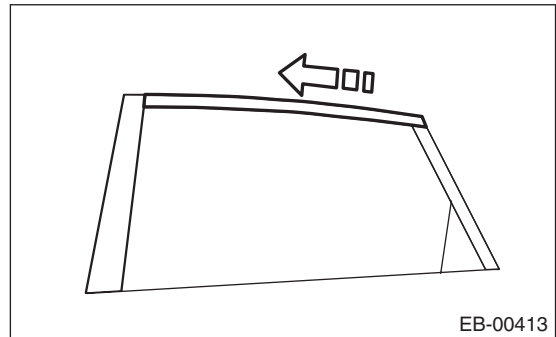



Brought to you by  
 NOT FOR SALE  
 Chris Studios

5) Fold the corners at the door upper end area in the order of (1) — (3).

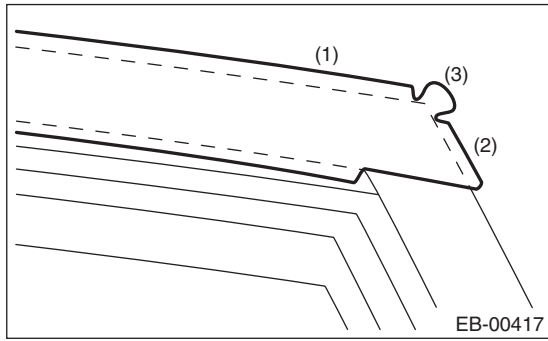

6) Cut off both ends of the rear door sash tape - front.

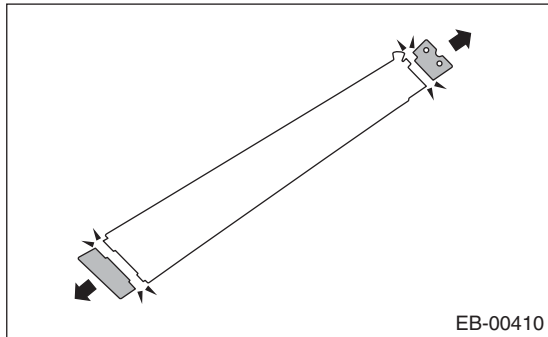

7) Match the sash corner and the cut area of the tape as shown in the figure. (Position of the arrow)

8) The lower end of the tape is to be aligned so that a space of approximately 3.7 mm remains, so that the attachment holes of the weather strip outer are not blocked. (Position of the arrow)

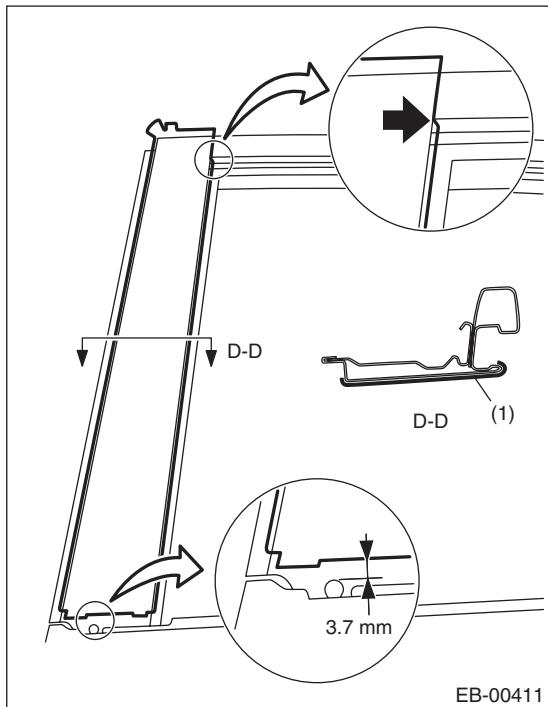

(1) Rear door sash tape - front

9) Apply tape from the top of the vehicle towards the bottom.

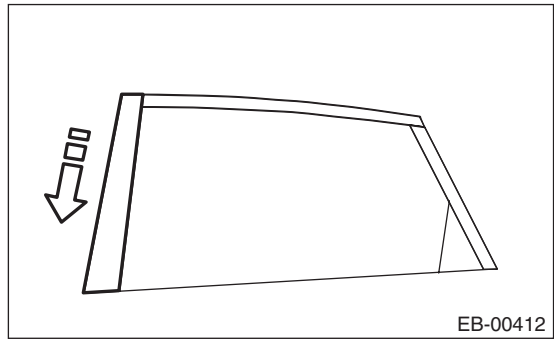

10) Fold the corners at the door upper end area in the order of (1) — (2).

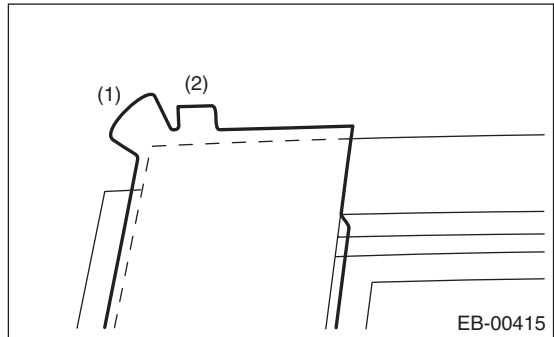

11) Thereafter, install door parts in the reverse order of disassembly.

12) Install while paying attention to make a uniform clearance around the rear door panel. For the clearance dimensions, refer to "SPECIFICATION" in "General Description". <Ref. to EB-2, SPECIFICATION, General Description.>

## 9. Rear Gate

### A: REMOVAL

#### 1. REAR GATE PANEL

- 1) Disconnect the ground cable from the battery.
- 2) Remove the rear gate trim. <Ref. to EI-55, REMOVAL, Rear Gate Trim.>
- 3) Remove the rear finisher light assembly. <Ref. to LI-27, REMOVAL, Rear Finisher Light Assembly.>
- 4) Remove the rear gate garnish. <Ref. to EI-58, REMOVAL, Rear Gate Garnish.>
- 5) Remove the rear wiper arm. <Ref. to WW-18, REMOVAL, Rear Wiper Arm.>
- 6) Remove the rear wiper motor. <Ref. to WW-19, REMOVAL, Rear Wiper Motor.>
- 7) Remove the rear gate latch assembly. <Ref. to SL-38, REMOVAL, Rear Gate Latch Assembly.>
- 8) Remove the roof spoiler. <Ref. to EI-36, REMOVAL, Roof Spoiler.>
- 9) Remove the rubber duct (A) connection.

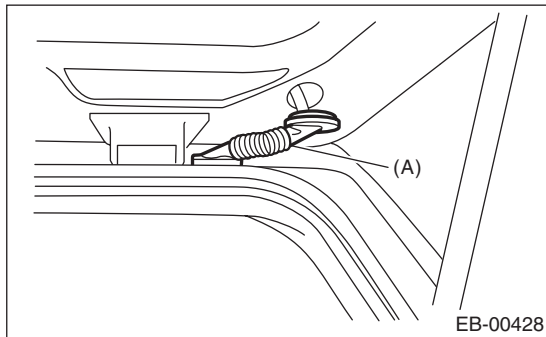

- 10) Pull out the harness and washer hose from the rear gate.
- 11) Remove harness clip of each connector from the rear gate panel.
- 12) Before removing the rear gate damper stay, prevent the rear gate from closing using prop or the like.

**CAUTION:**

If the prop comes off, operators may get injured and vehicle may get damaged. Make sure to support the rear gate with secure material to prevent injury or damage.

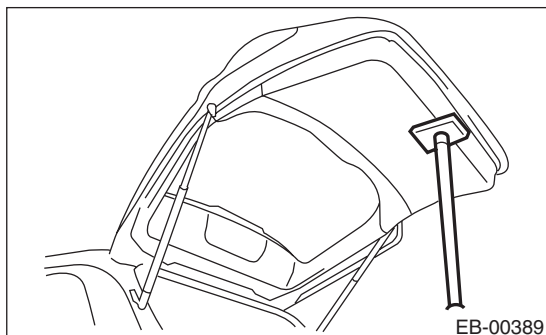

- 13) Remove the mounting bolt of rear gate damper stay.

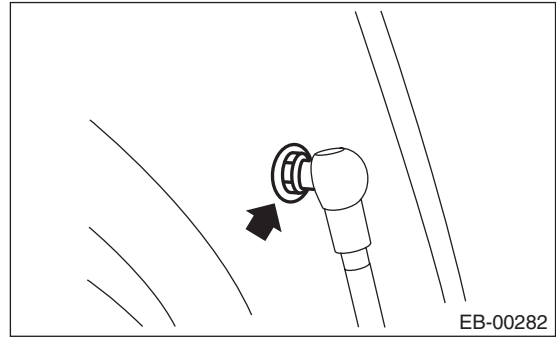

- 14) Remove the rear gate hinge bolt, and remove the rear gate panel.

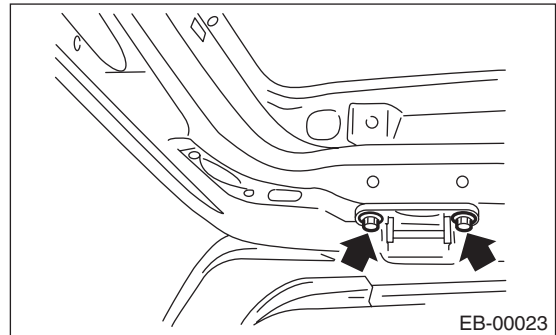

- 15) Remove the rear gate hinge from the vehicle.

Brought to you by  
 NOT FOR SALE  
 Studios

## 2. REAR GATE DAMPER STAY

### CAUTION:

- Do not damage piston rods and oil seals.
- Never disassemble cylinders: They contain gas.

1) Before removing the rear gate damper stay, prevent the rear gate from closing using prop or the like.

### CAUTION:

If the prop comes off, operators may get injured and vehicle may get damaged. Make sure to support the rear gate with secure material to prevent injury or damage.

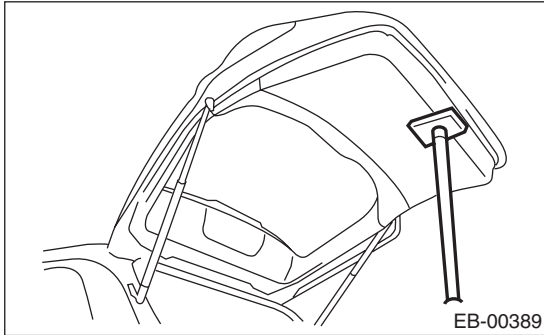

2) Remove the mounting bolt of rear gate damper stay.

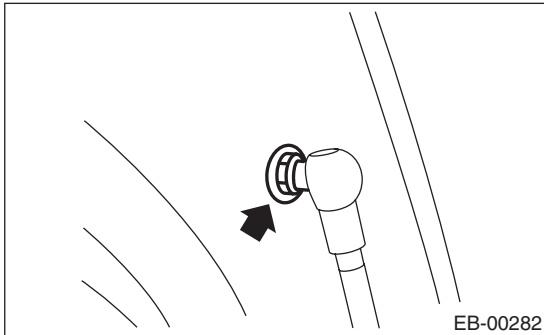

3) Remove the mounting bolts, and remove the damper stay.

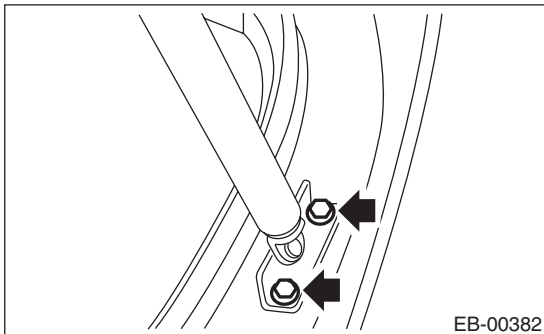

## B: INSTALLATION

### 1. REAR GATE PANEL

1) Install in the reverse order of removal.

#### Tightening torque:

**25 N·m (2.6 kgf-m, 18.4 ft-lb)**

2) Install while paying attention to make a uniform clearance around the rear gate panel. For the dimension of clearance, refer to "SPECIFICATION" in "General Description". <Ref. to EB-2, SPECIFICATION, General Description.>

### 2. REAR GATE DAMPER STAY

1) Prevent the rear gate from closing using prop or the like.

### CAUTION:

If the prop comes off, operators may get injured and vehicle may get damaged. Make sure to support the rear gate with secure material to prevent injury or damage.

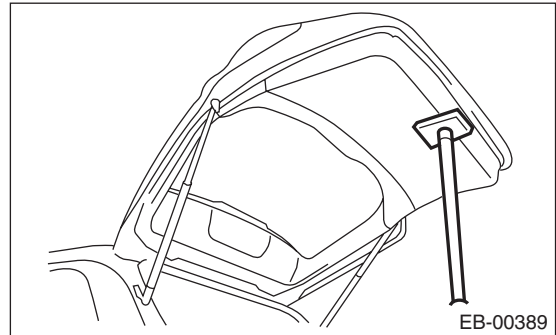

2) Install in the reverse order of removal.

#### Tightening torque:

Refer to "COMPONENT" of "General Description".

<Ref. to EB-10, REAR GATE, COMPONENT, General Description.>

### C: DISPOSAL

#### 1. REAR GATE DAMPER STAY

##### CAUTION:

Gas is colorless, odorless, and harmless. However, gas pressure may spray cutting powder or oil. Be sure to wear dust-resistant goggles.

1) Cover with a vinyl sack as shown in the figure.

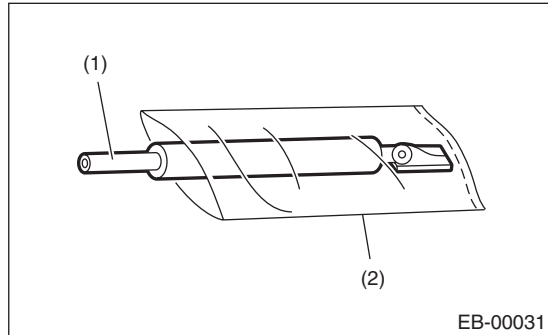

- (1) Rear gate damper stay
- (2) Vinyl sack

##### NOTE:

Prevent the vinyl sack from being caught by drill cutting edge.

2) Lift the body side slightly with piston rods fully extended, and secure the body side with vise.

Drill a hole of 2 to 3 mm (0.08 to 0.12 in) diameter at a point 10 to 200 mm (0.39 to 7.87 in) from the body side, and bleed the gas in the rear gate damper stay completely.

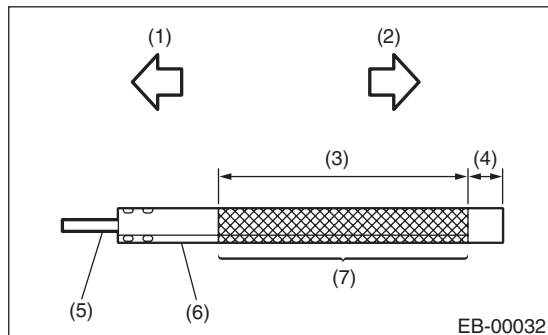

- (1) Door side
- (2) Body side
- (3) 190 mm (7.48 in)
- (4) 10 mm (0.39 in)
- (5) Piston rod
- (6) Cylinder
- (7) Portion to be drilled