

Brought to you by Eris Studios
NOT FOR RESALE

NOTE

NOTE

1. Note

A: NOTE

This information will improve the efficiency of maintenance and assure that the finished work is of a good quality.

1. FASTENERS NOTICE

Fasteners are used to prevent the parts from damage, dislocation and play due to looseness. Fasteners must be tightened to the specified torque.

Do not apply paint, lubricant, rust retardant or other substance to the surface around bolts, nuts, etc. Doing so will make it difficult to obtain the correct torque and result in looseness and other problem.

2. STATIC ELECTRICITY DAMAGE

Do not touch the control modules, connectors, logic boards and other such parts when there is a risk of static electricity. Always use a static electricity prevention cord or touch grounded metal for the elimination of static electricity before conducting work.

3. BATTERY

When removing the battery cables, always be sure to turn the ignition switch to OFF to prevent electrical damage to the control module from overcurrent.

4. SERVICE PARTS

Use genuine parts for maximum performance and maintenance when conducting repairs. Subaru/FHI will not be responsible for poor performance resulting from the use of parts except for genuine parts.

5. PROTECTING VEHICLE UNDER MAINTENANCE

Make sure to attach the fender cover, seat covers, etc. before work.

6. ENSURING SECURITY DURING WORK

When working in a group of two or more, perform the work with calling each other to ensure mutual safety.

7. LIFT AND JACK

When using a lift or shop jack to raise a vehicle or using rigid rack to support a vehicle, always follow instructions concerning jack-up points and weight limits to prevent the vehicle from falling, which could result in injury. Be especially careful that the vehicle is balanced before raising it. Be sure to set the wheel stoppers when jacking-up only the front or rear side of the vehicle.

CAUTION:

When the side sill interferes with the lift arm, a grooveless attachment can be used. In this case, perform the operation carefully because the dislocation from the side sill flange may occur.

NOTE:

- When using a lift, follow its operation manual before work.
- When the side sill cover contacts the lift arm, use a lift attachment.
- Do not work or leave unattended while the vehicle is supported with jack, support it with rigid racks.
- Be sure to use the rigid racks with rubber attached to cradle to support the vehicle.
- When using a plate lift, use a rubber attachment.

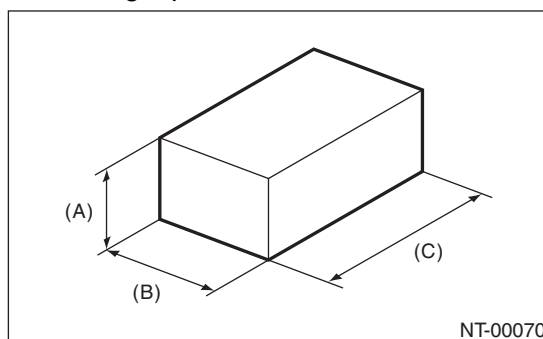

- (A) 80 mm (3.1 in) or more
- (B) 100 — 150 mm (3.94 — 5.91 in)
- (C) 120 — 190 mm (4.72 — 7.48 in)

Note

Brought to you by *Meris Studios*
NOT FOR SALE

NOTE

- Do not use the plate lift whose attachment does not reach the supporting locations.
Supporting locations

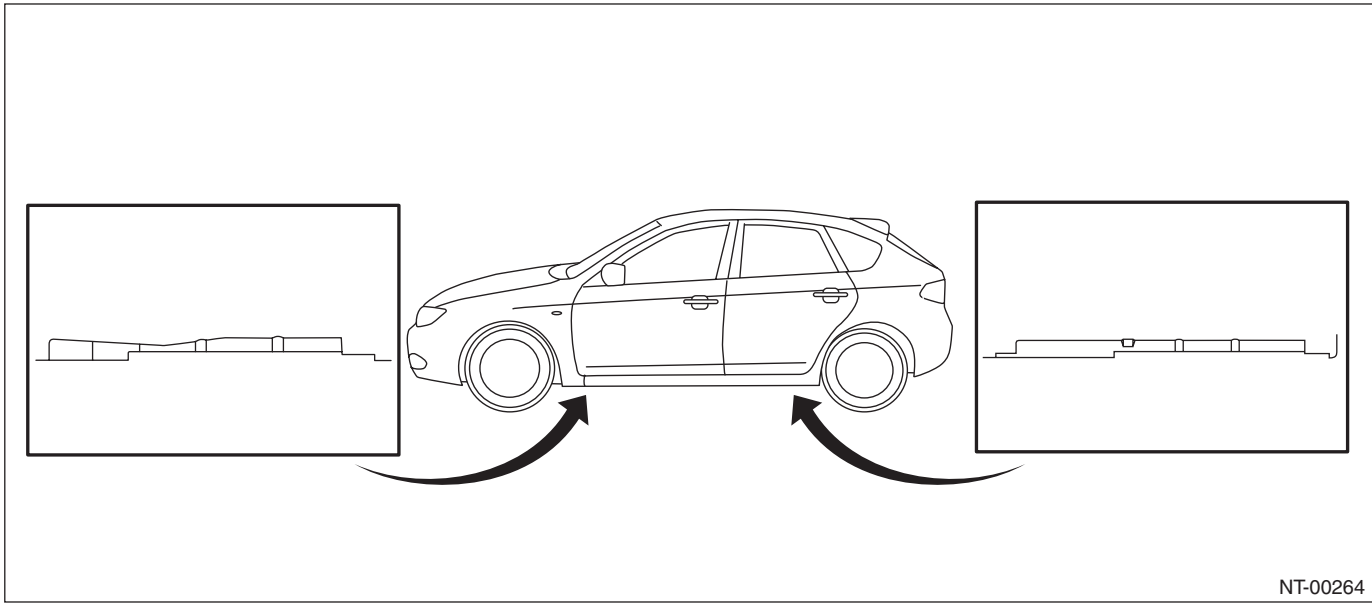

NT-00264

Pantograph jack

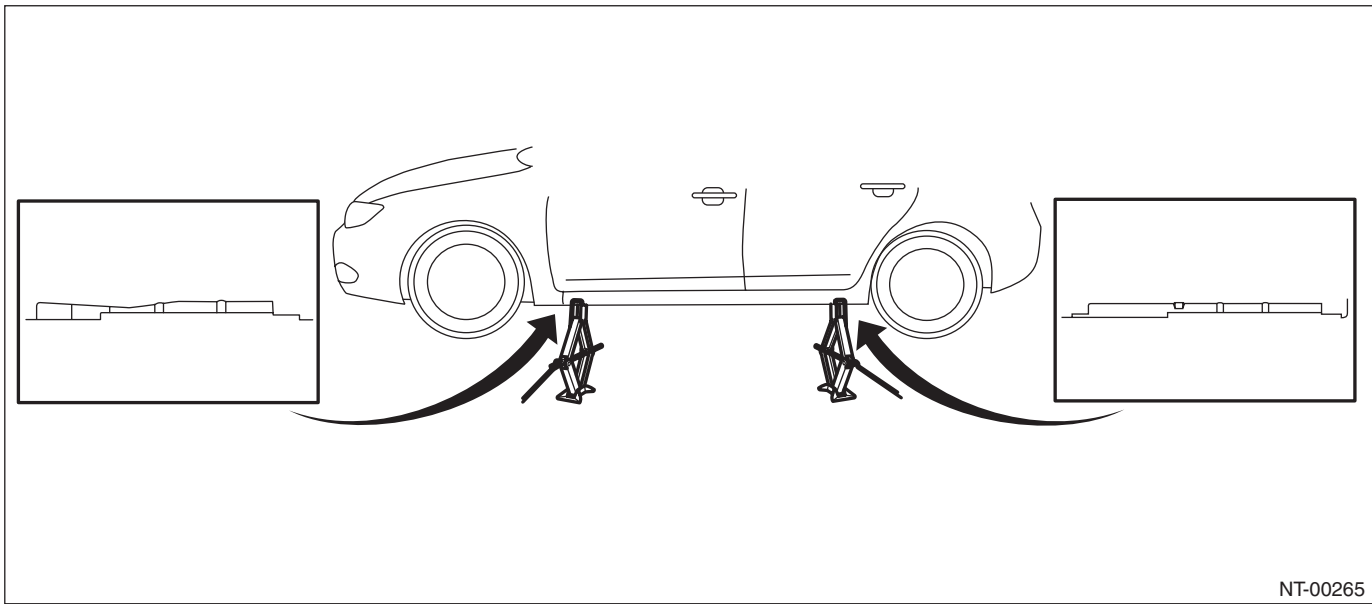

NT-00265

Note

Brought to you by Eris Studios
NOT FOR RESALE

NOTE

Lift

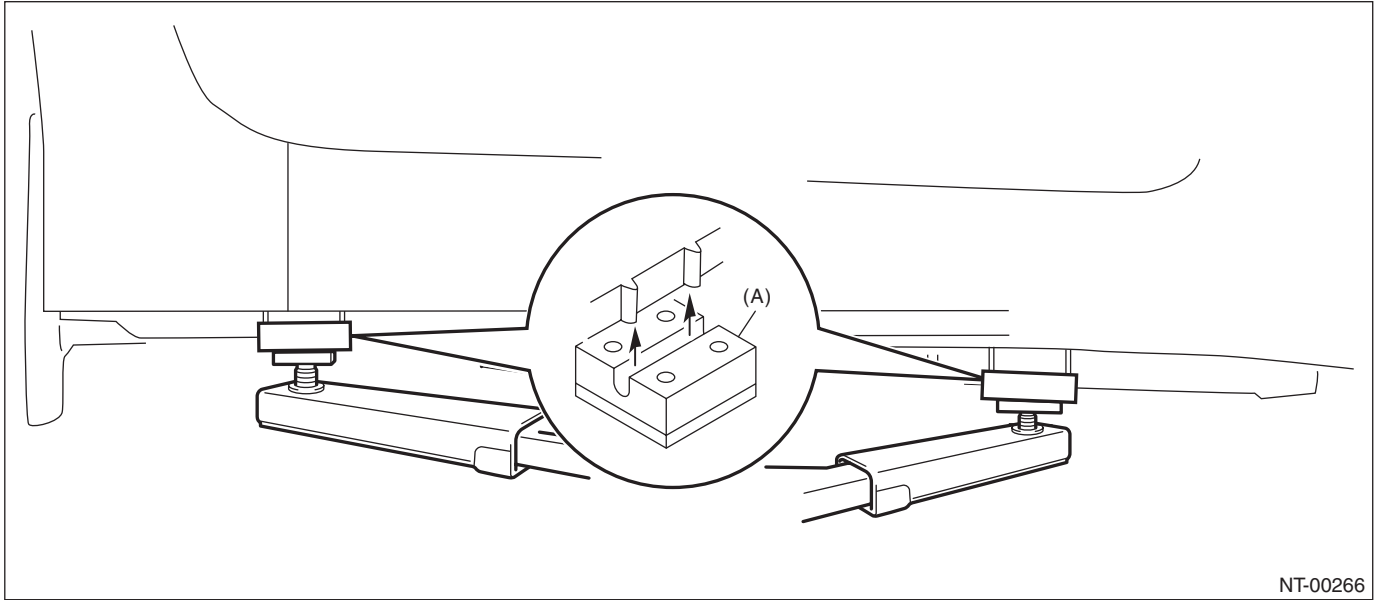

NT-00266

(A) Attachment

Rigid racks

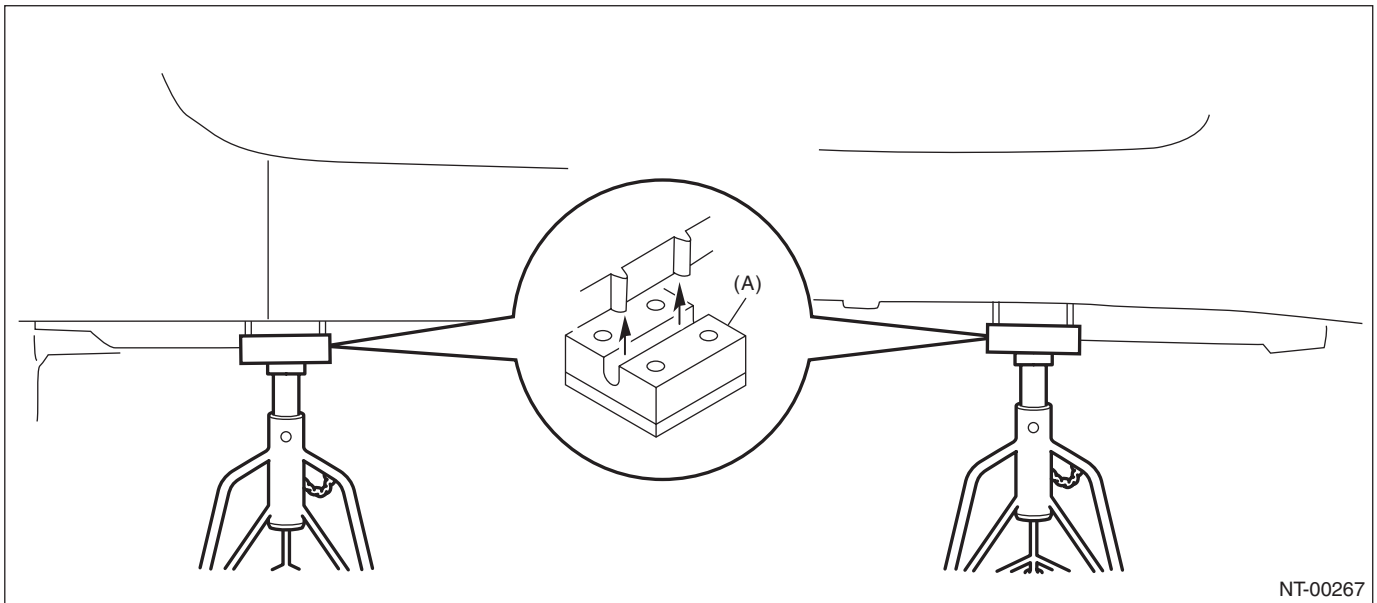

NT-00267

(A) Attachment

Note

Brought to you by *Peris Studios*
NOT FOR SALE

NOTE

Plate lift

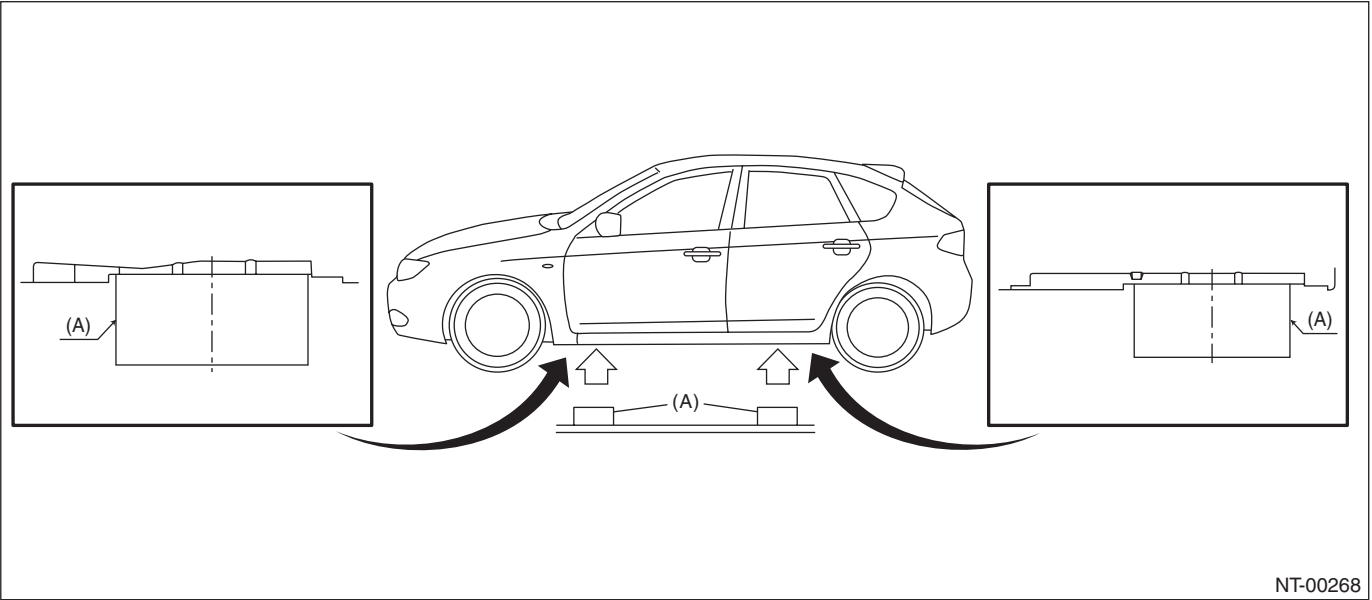

NT-00268

(A) Attachment

Garage jack

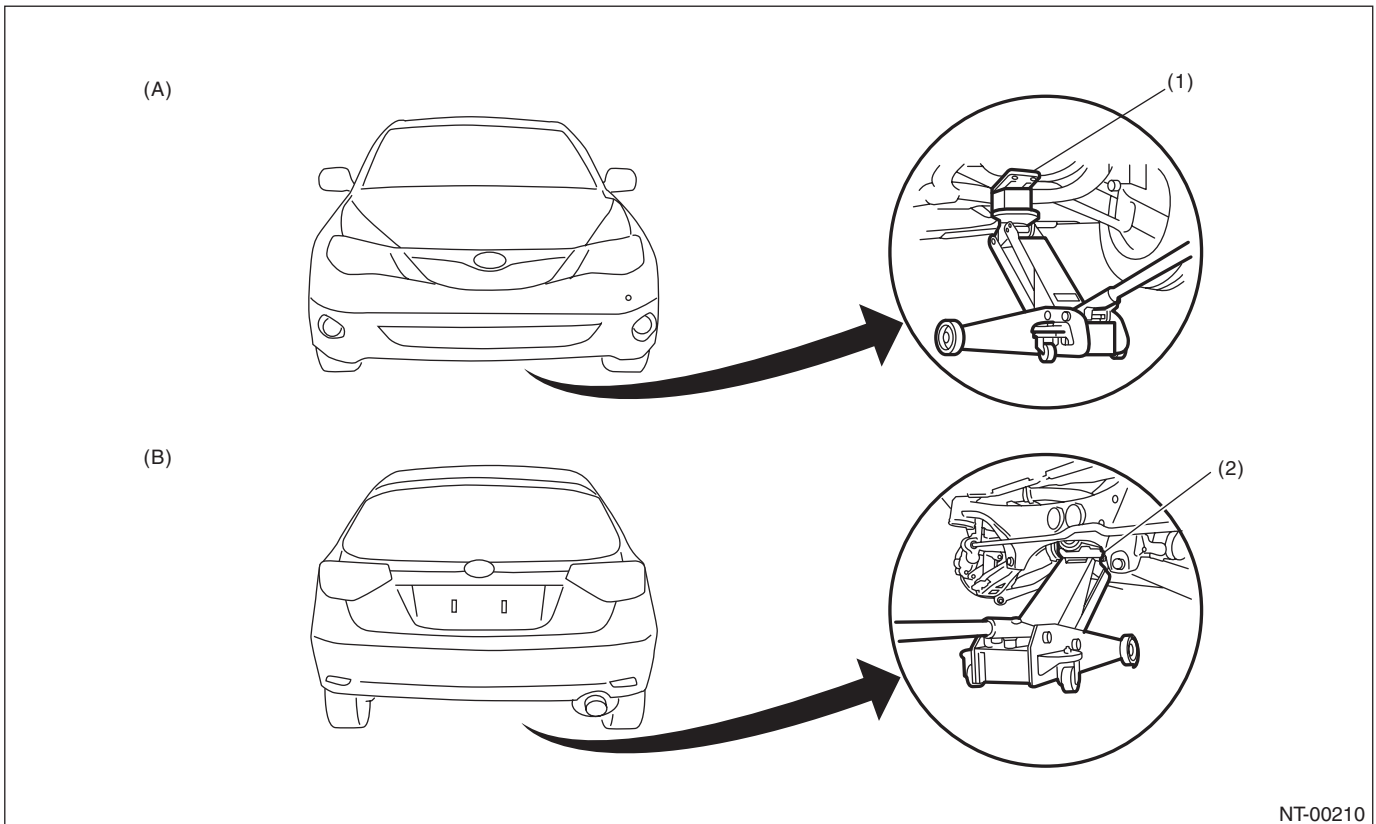

NT-00210

(A) Front

(B) Rear

(1) Front crossmember

(2) Rear differential

Note

Brought to you by Eris Studios
NOT FOR RESALE

NOTE

8. TIE-DOWNS

The tie-down hooks are used when transporting vehicles and when using the chassis dynamo. Attach tie-down only to the specified locations on the vehicle.

- TIE-DOWN LOCATION

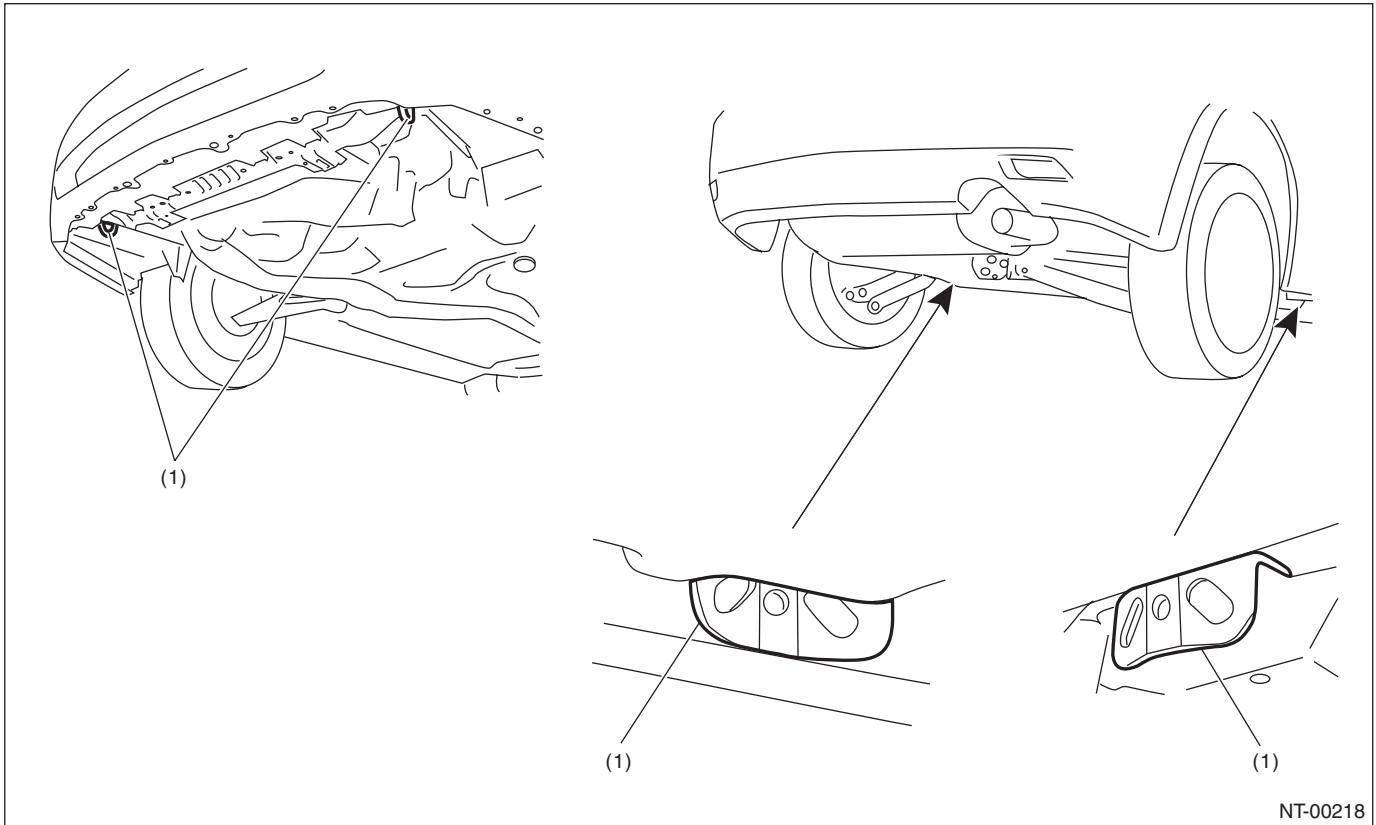

NT-00218

(1) Hook for tie-down

Note

Brought to you by *Peris Studios*
NOT FOR SALE

NOTE

• TIE-DOWN HOOK & EYE BOLT

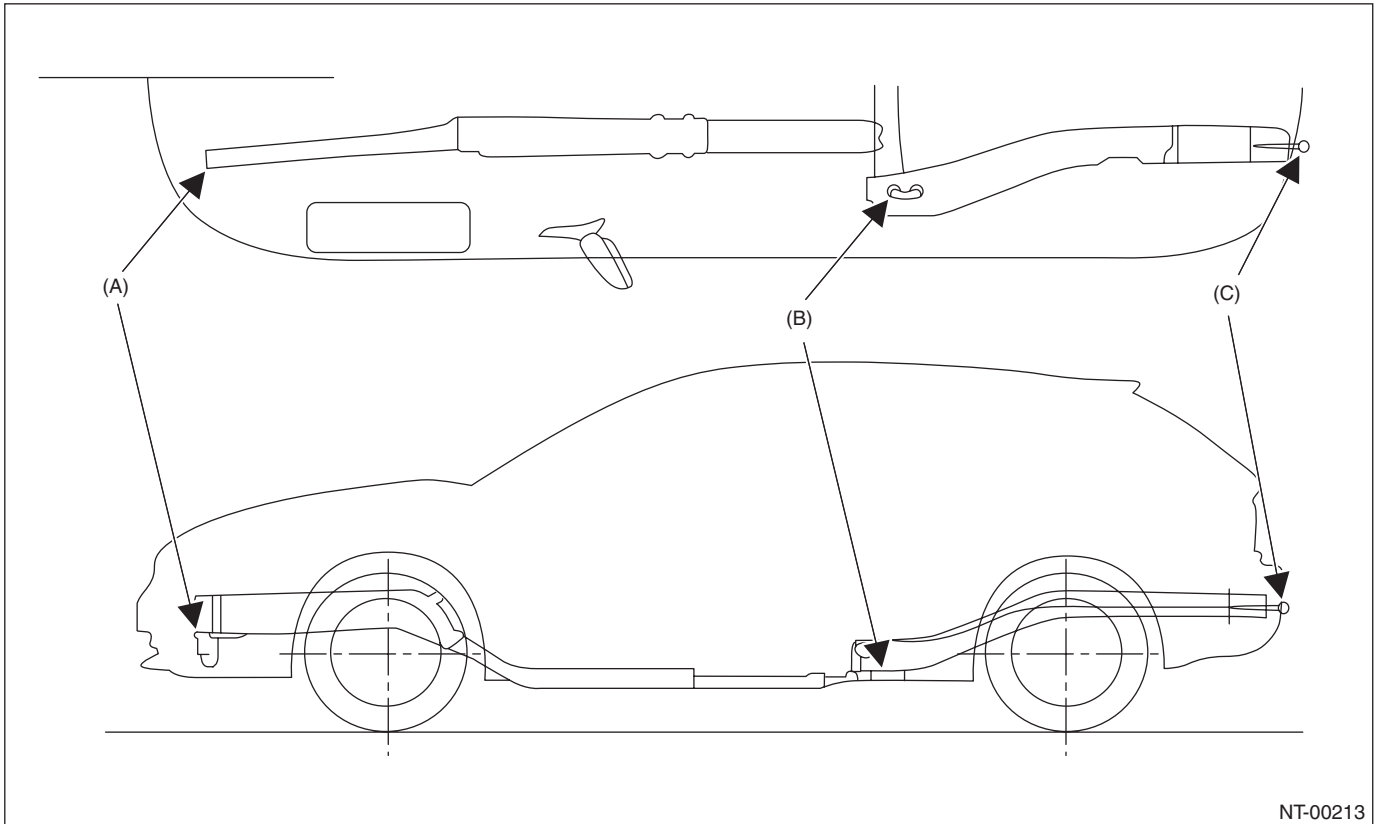

NT-00213

(A) Front tie-down hook

(B) Rear tie-down hook

(C) Eye bolt

Note

Brought to you by Eris Studios
NOT FOR RESALE

NOTE

• TIE-DOWN DIRECTION

CAUTION:

Pull the tie-down chains LH and RH in the same direction, but front and rear side in the counter direction.

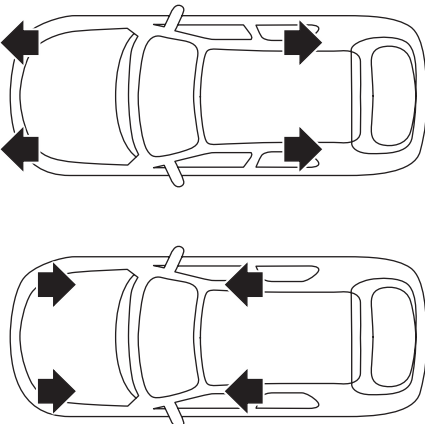
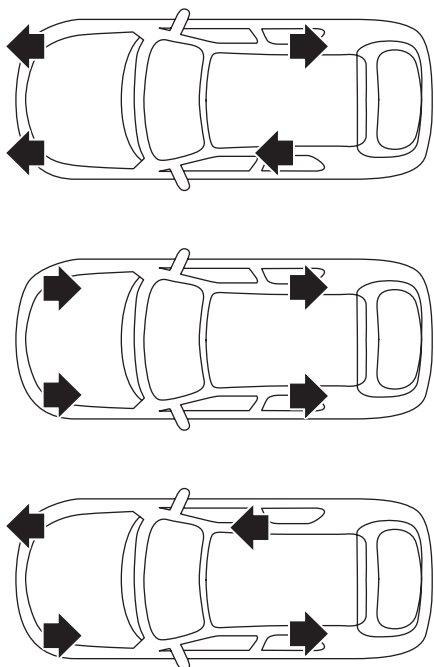
	Recommended	NG
Tie-down direction	 NT-00214	 NT-00215

Note

Brought to you by *Peris Studios*
NOT FOR SALE

NOTE

• TIE-DOWN RANGE

For ground transportation

CAUTION:

When the vehicle is tied down from vehicle inside, hook the hooks of tie-down chain on the rear tie-down hooks from vehicle inside. When the vehicle is tied down from vehicle outside, hook the hooks of tie-down chain on the rear tie-down hooks from vehicle outside.

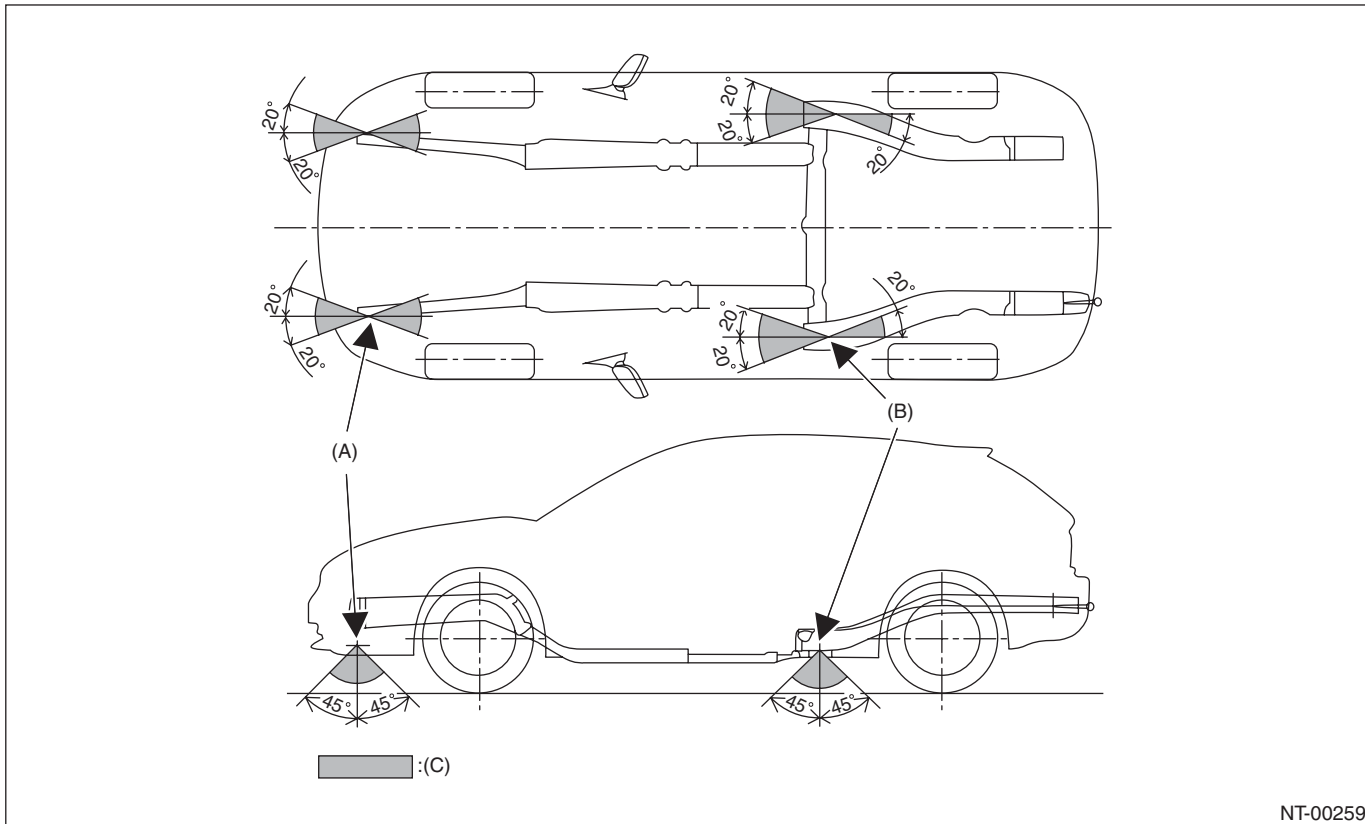

NT-00259

(A) Front tie-down hook

(B) Rear tie-down hook

(C) Chain pulling range at tie-down condition

Note

Brought to you by Eris Studios
NOT FOR RESALE

NOTE

For sea transportation

CAUTION:

The eye bolts are exclusively used for towing and sea transportation tie-down, and do not use them for ground and freight transportation.

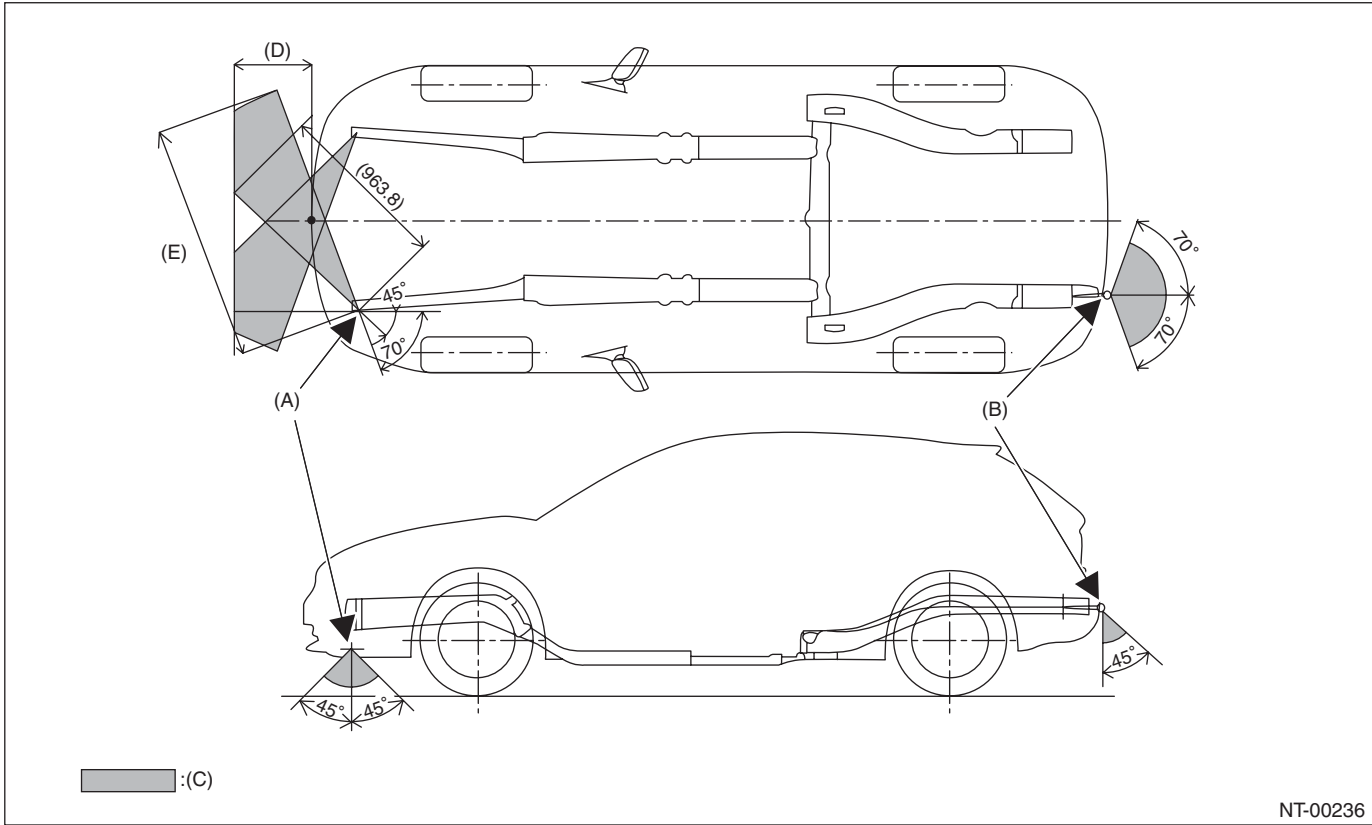

- (A) Front tie-down hook
- (B) Eye bolt

- (C) Chain pulling range at tie-down condition

- (D) 400 mm (15.7 in)
- (E) 1,320 mm (52.0 in)

Note

Brought to you by
NOTES
NOT FOR SALE
NOTE

• VEHICLE SINKING VOLUME AT TIE-DOWN CONDITION

CAUTION:

The vehicle sinking volume at tie-down condition should be less than 50 mm (1.97 in) and make sure to fix the vehicle securely.

Check to see if the tensions of chains or belts at tie-down condition are appropriate in the following procedures.

- 1) Measure the distance (A) between the center of wheel and highest arch point.
- 2) Compare the measured dimensions of before and after tie-down.
- 3) If the difference is less than 50 mm (1.97 in), it is judged as OK. If the difference is 50 mm (1.97 in) or more, it is judged as NG because the tension is too high.

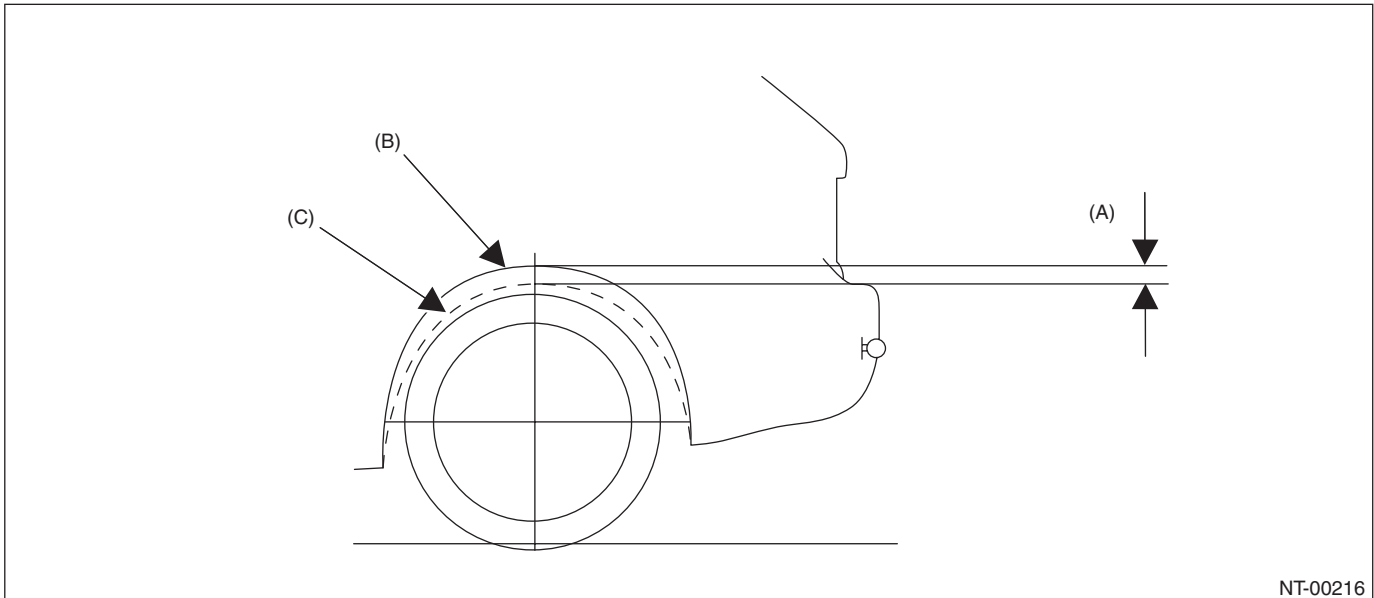

NT-00216

(B) Arch position before tie-down

(C) Arch position after tie-down

Note

Brought to you by Eris Studios
NOT FOR RESALE

NOTE

• NOTES FOR THE USE OF TIE-DOWN HOOK

When the vehicle is tied down from the rear side, use the holes at the rear side, and when the vehicle is tied down from the front side, use the holes at the front side.

When the vehicle is tied down from vehicle inside, hook the hooks of tie-down chain from vehicle inside, and when the vehicle is tied down from vehicle outside, hook the hooks of tie-down chain from vehicle outside.

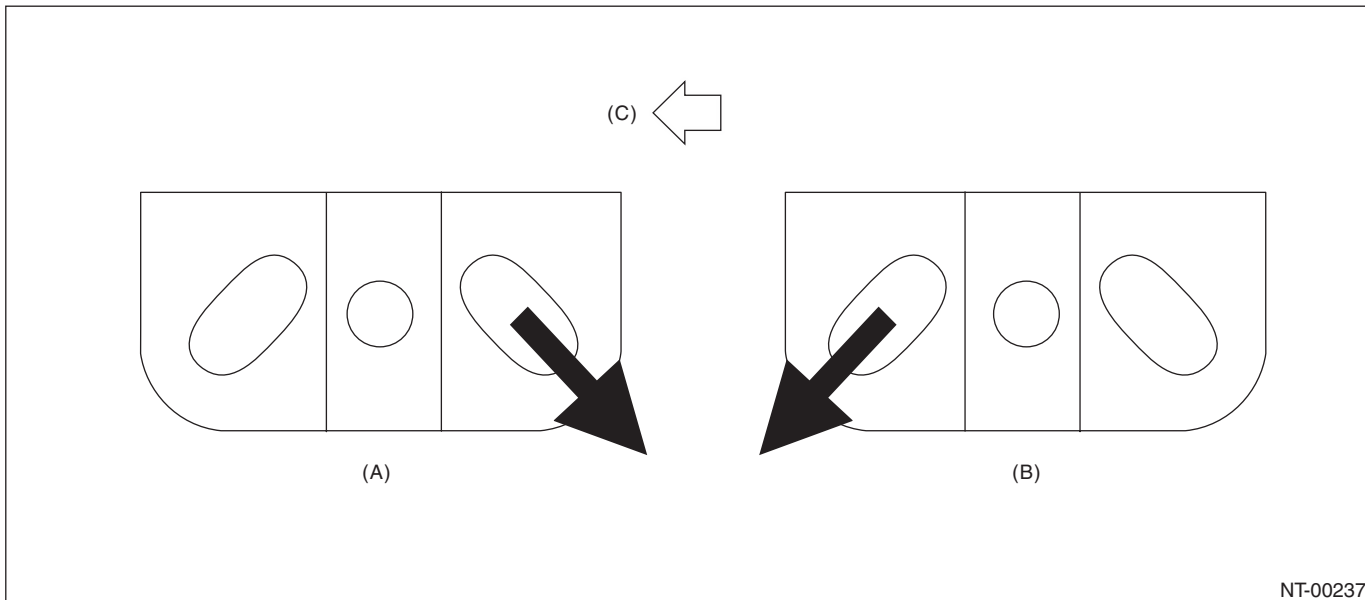

NT-00237

(A) When the vehicle is tied down towards the rear side

(B) When the vehicle is tied down towards the front side

(C) Vehicle front

9. TOWING

Avoid towing vehicles except when the vehicle cannot be driven. For models with VDC, use a loader instead of towing. When towing other vehicles, pay attention to the following to prevent hook or vehicle damage resulting from excessive weight.

- Do not tow other vehicles with a front tie-down hook.
- Make sure the vehicle towing is heavier than the vehicle being towed.

- **FRONT**

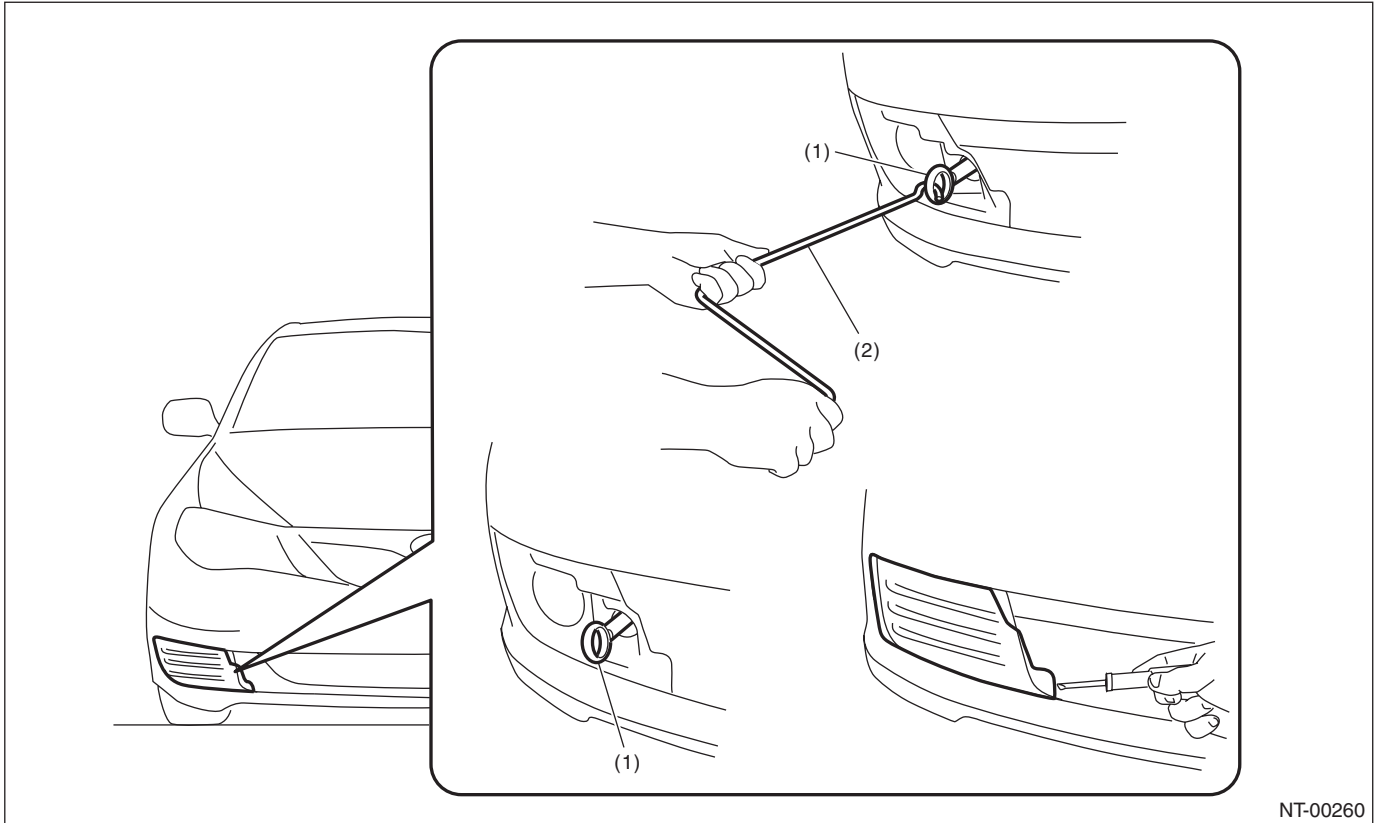

NT-00260

(1) Eye bolt

(2) Jack handle

NOTE

• REAR

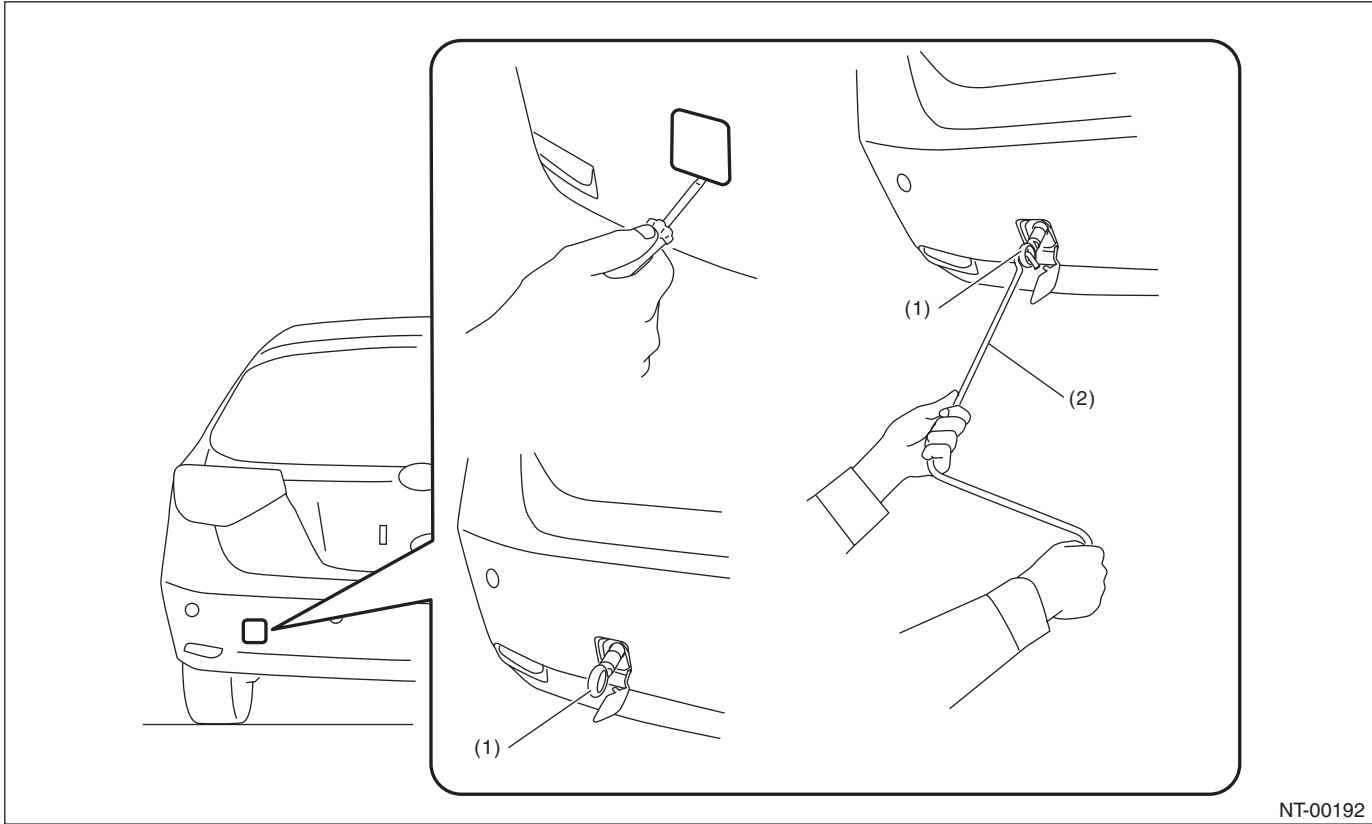

(1) Eye bolt

(2) Jack handle

CAUTION:
When tightening the eye bolt using a wheel wrench, be careful not to scratch the bumper.

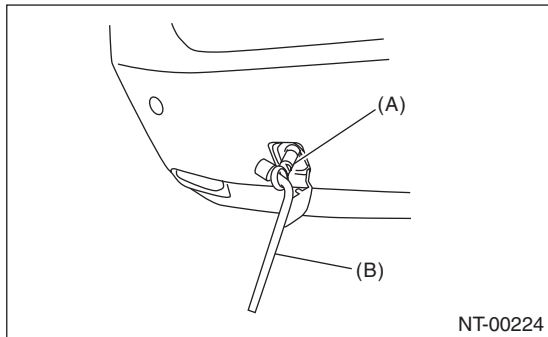

(A) Eye bolt

(B) Wheel wrench

10. LOADING ONTO CAR CARRIER TRUCK

CAUTION:

- When carrying the vehicle onto a car carrier truck, perform the operation being careful with the gap between the height of the carrier's floor and the vehicle lower side because of little clearance under the front bumper.

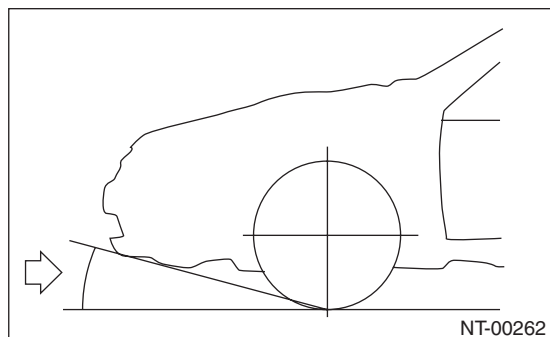

- Use a supporting board (rubber) where the clearance is too small.
- Perform the operation being careful with the position shown in the figure below.

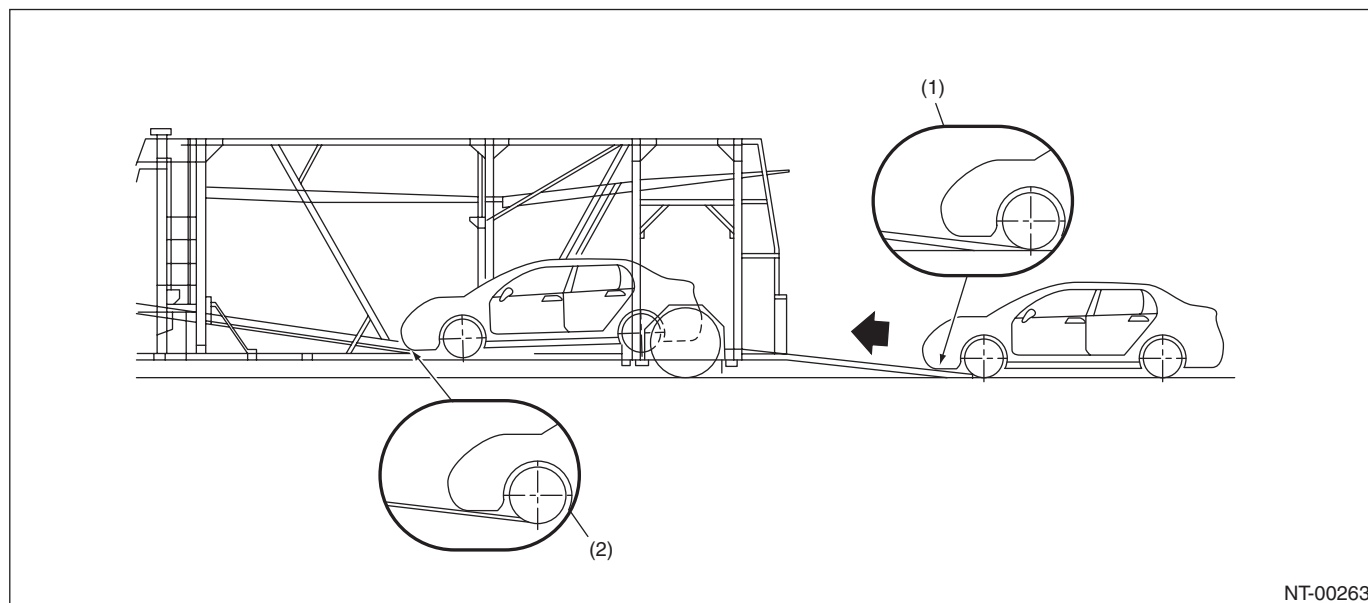

- (1) Use a supporting board (rubber) ensuring clearance from the ramp.
- (2) Before carrying the vehicle completely, lower the lower center floor until it is level to make clearance.

NOTE

11.FRONT HOOD DAMPER STAY

CAUTION:

- Do not leave one side of damper stay removed.
- Always perform works such as inspections and maintenance with both damper stays attached.

At the check and general maintenance

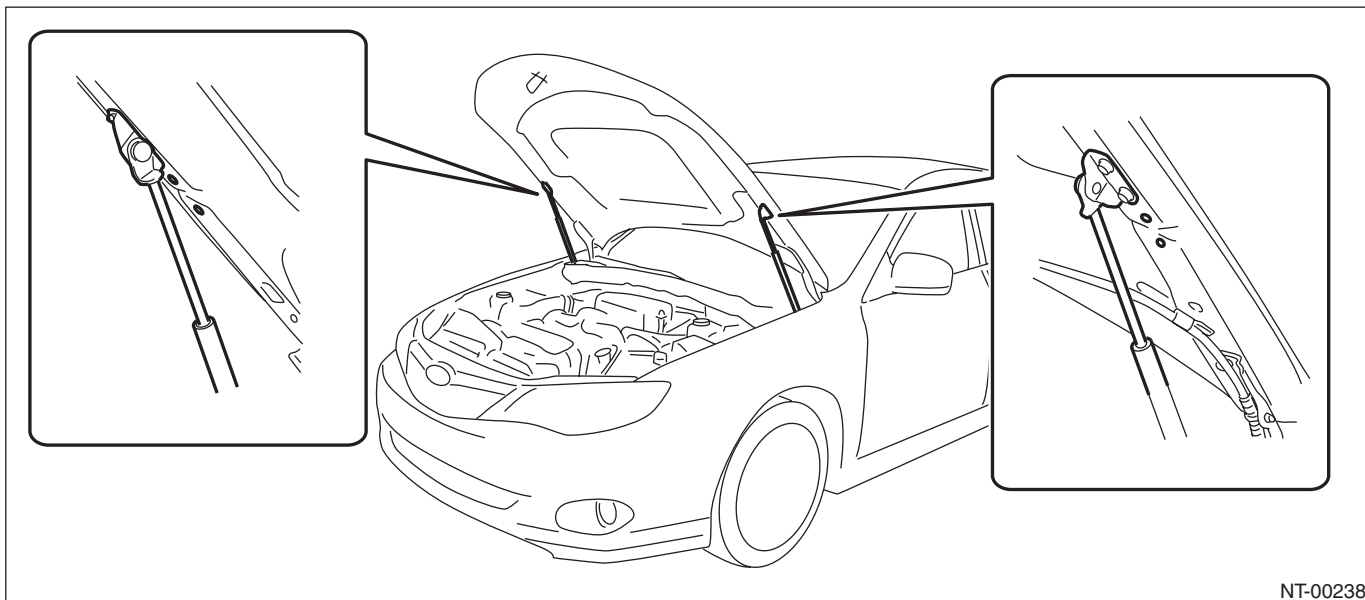

When wider hood opening is necessary

Set the damper stay below as shown in the figure.

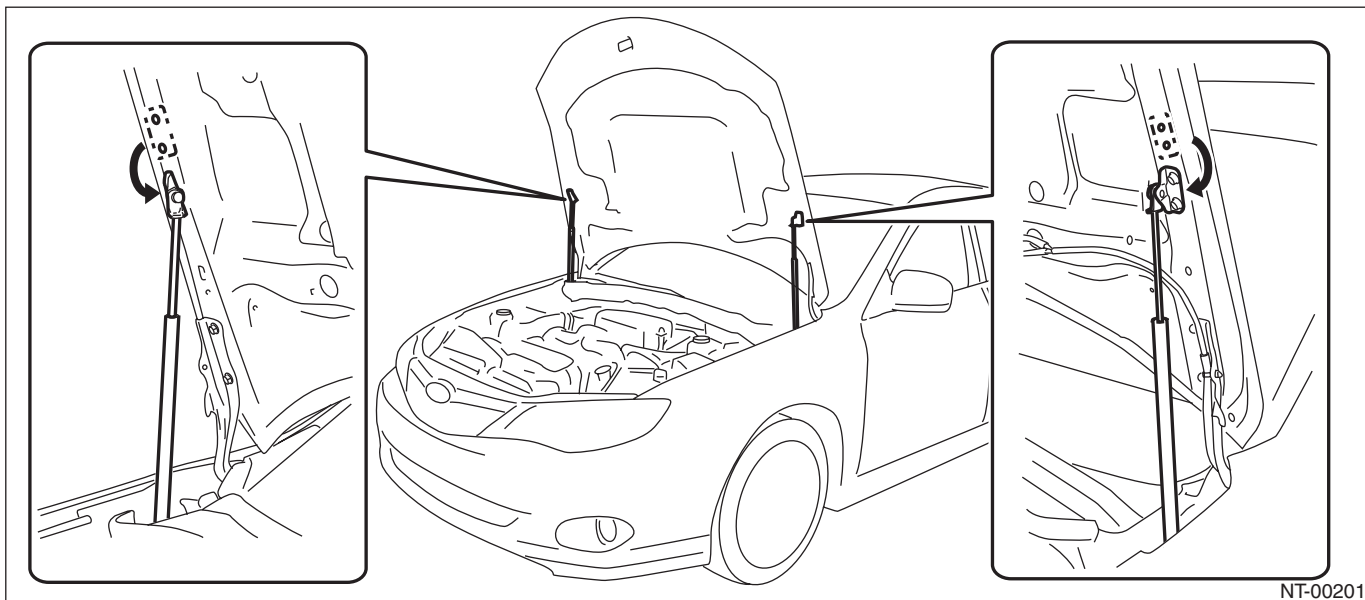

12.TRAINING

For an information about training, contact a dealer or agent.

13.GENERAL SCAN TOOL

Using general scan tools will greatly improve the efficiency of repairing engine electronic controls. Subaru Select Monitor can be used to diagnose the engine, VDC and other electronically controlled parts.