

## 4. Select Cable

### A: REMOVAL

- 1) Shift the select lever to "N" range.
- 2) Disconnect the ground cable from battery.
- 3) Lift up the vehicle.
- 4) Remove the center exhaust pipe. <Ref. to EX(H4DO)-14, REMOVAL, Center Exhaust Pipe.>
- 5) Remove the center exhaust cover.

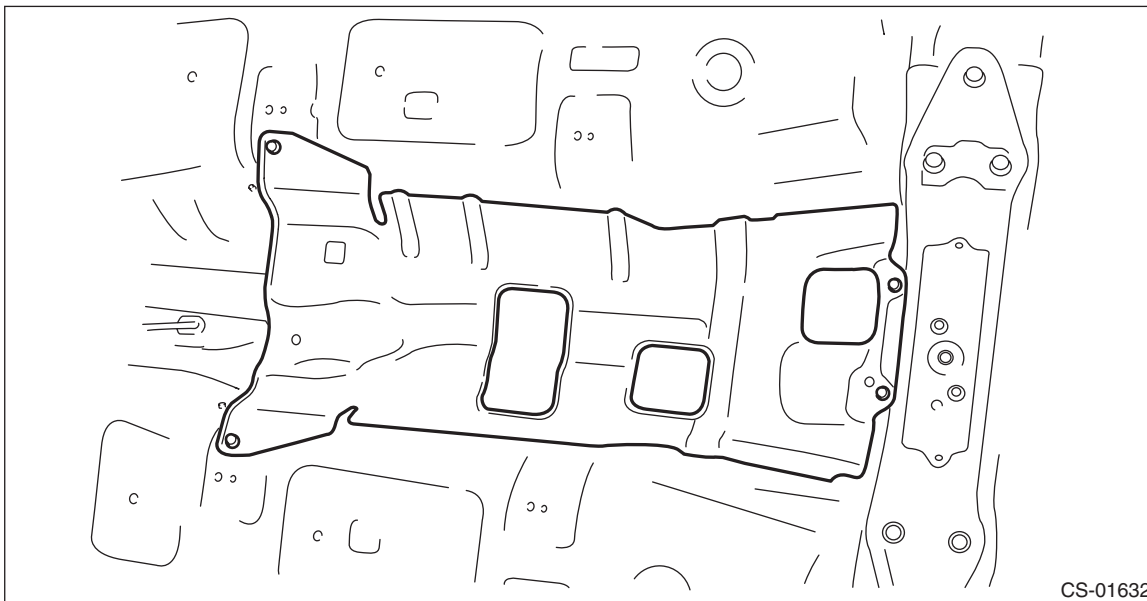

- 6) Remove the snap pin and washer from the shifter arm.

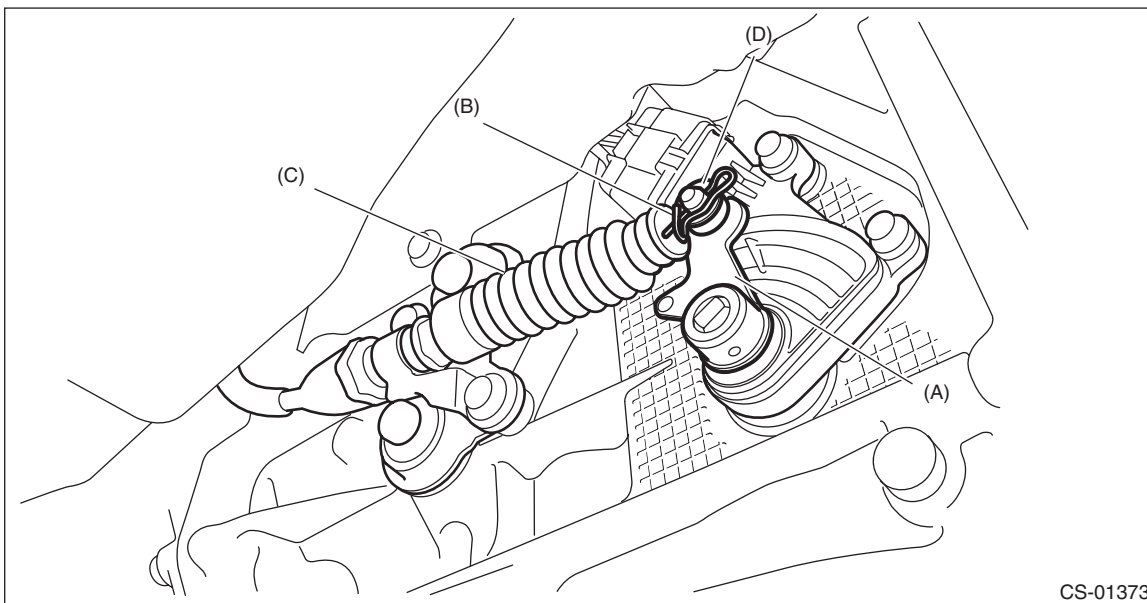

- (A) Shifter arm
- (B) Snap pin
- (C) Select cable
- (D) Washer

## Select Cable

### CONTROL SYSTEMS

7) Remove the plate assembly from the transmission case.

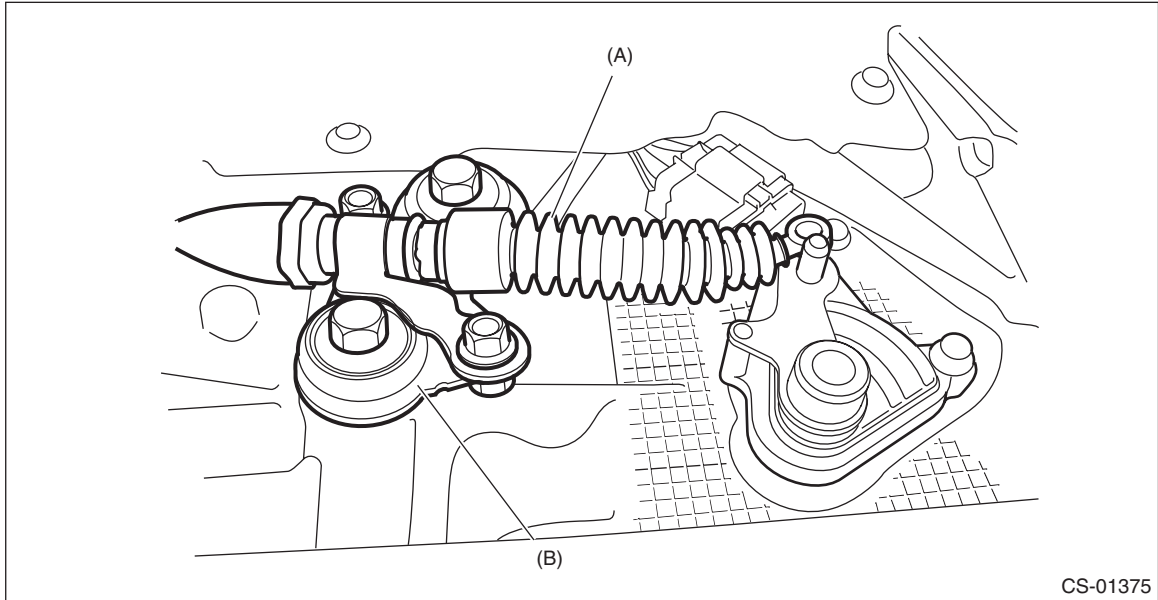

(A) Select cable

(B) Plate ASSY

8) Disconnect the cable from arm COMPL.

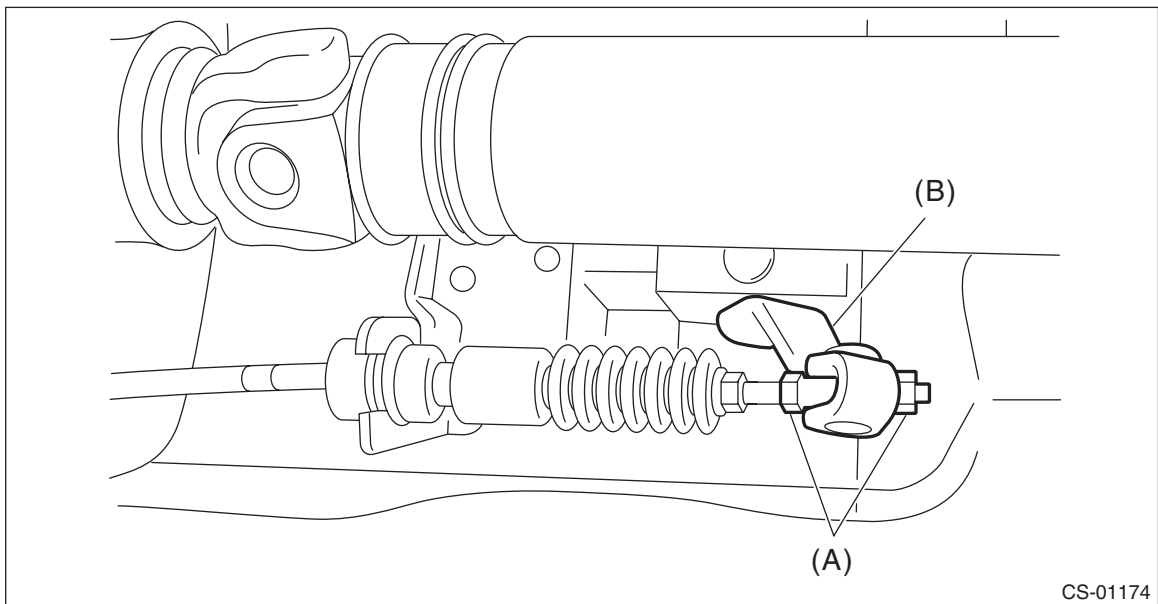

(A) Adjusting nut

(B) Arm COMPL

9) Raise the claw of clamp to remove the cable from bracket.

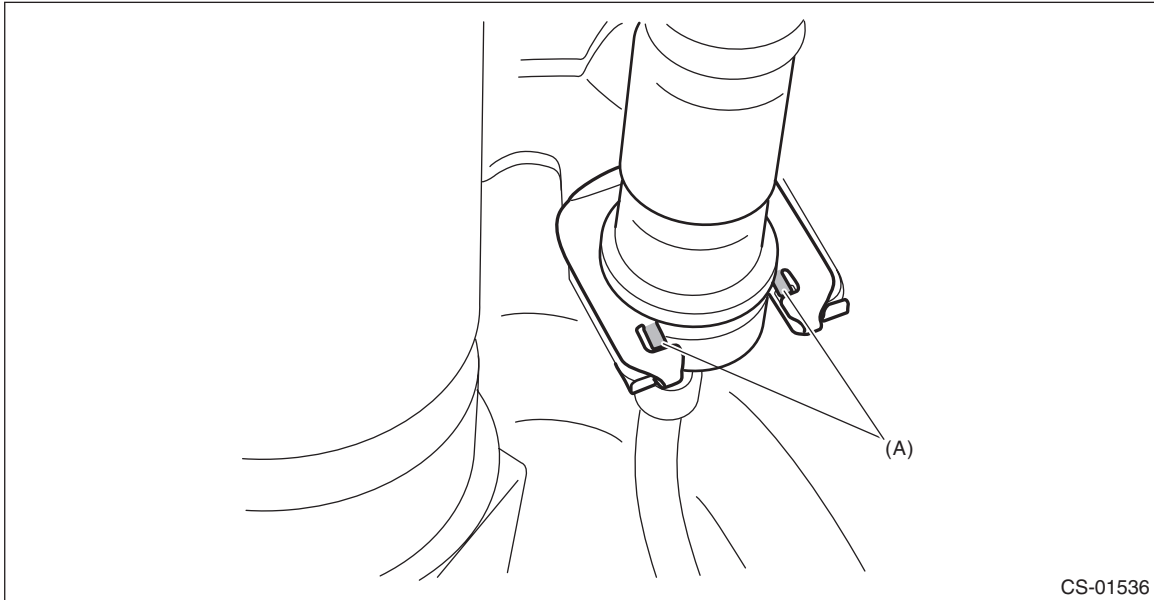

(A) Claw

10) Remove the select cable from plate assembly.

## B: INSTALLATION

1) Install the select cable to plate assembly.

**Tightening torque:**

**18 N·m (1.8 kgf·m, 13.3 ft-lb)**

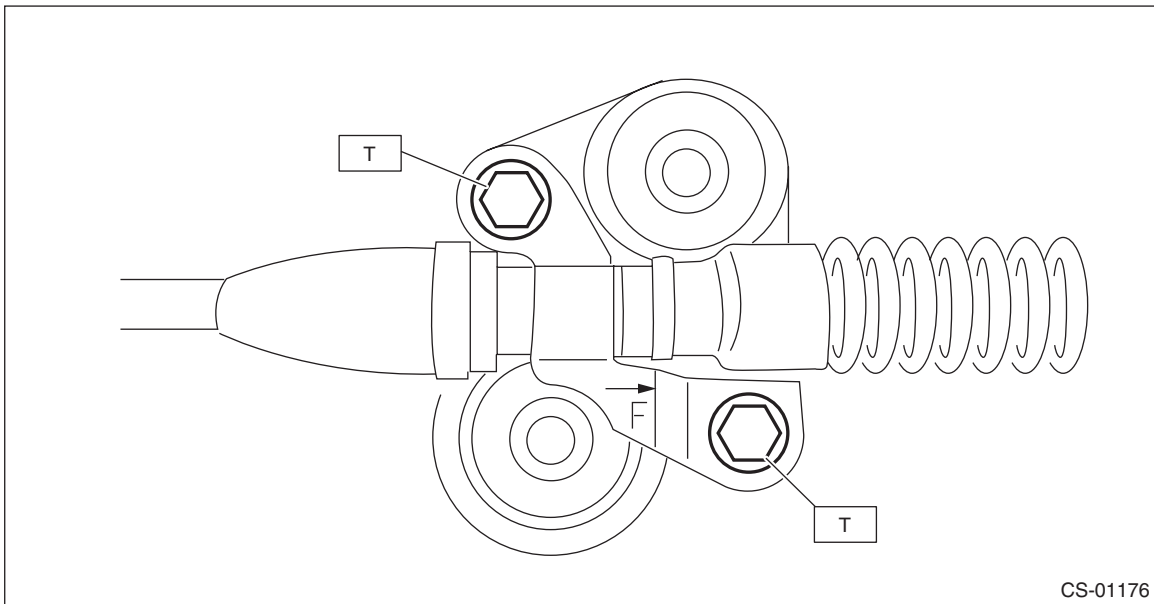

2) Install the select cable to the shifter arm.

## Select Cable

### CONTROL SYSTEMS

3) Install the plate assembly to transmission.

**Tightening torque:**

**T: 25 N·m (2.5 kgf-m, 18.4 ft-lb)**

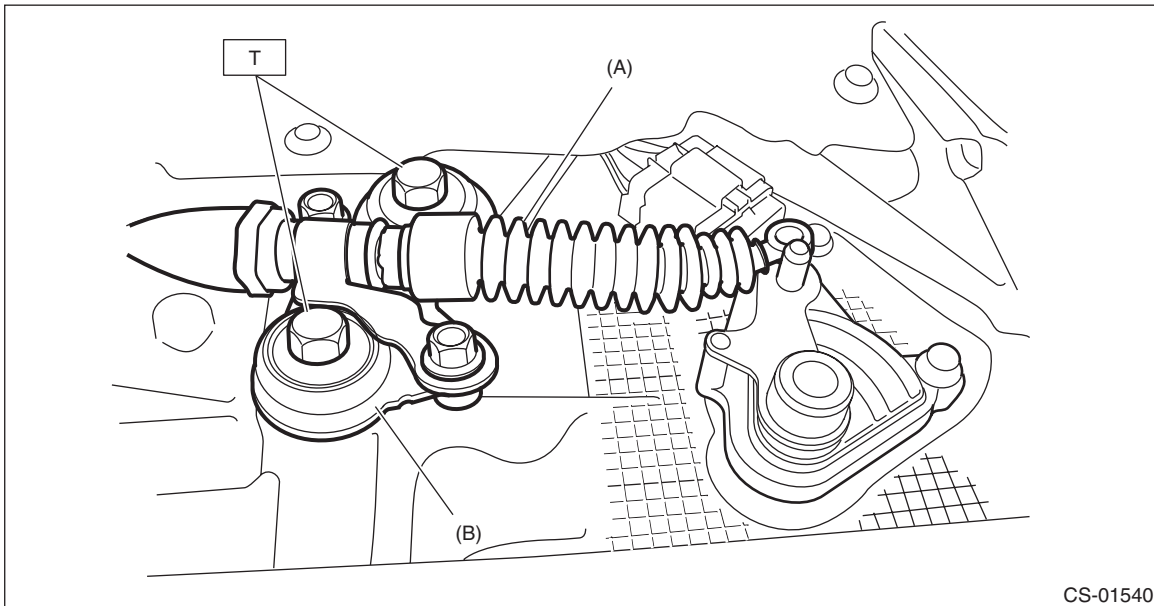

- (A) Select cable
- (B) Plate ASSY

4) Install the washer and snap pin to the shifter arm.

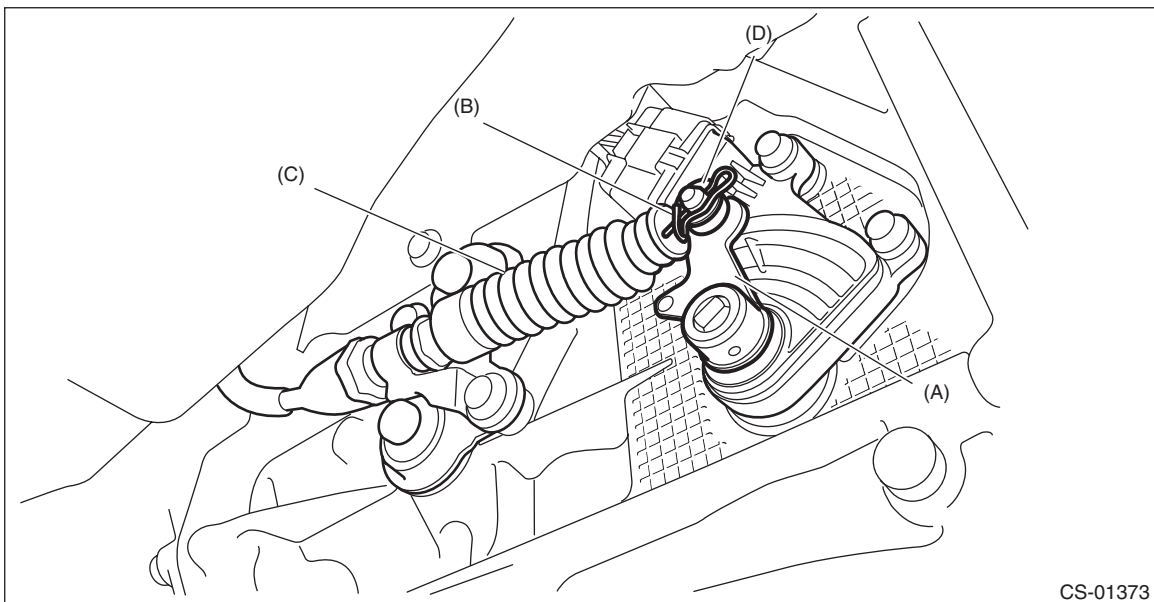

- (A) Shifter arm
- (B) Snap pin
- (C) Select cable
- (D) Washer

5) Install new clamp paying attention to the installing direction.

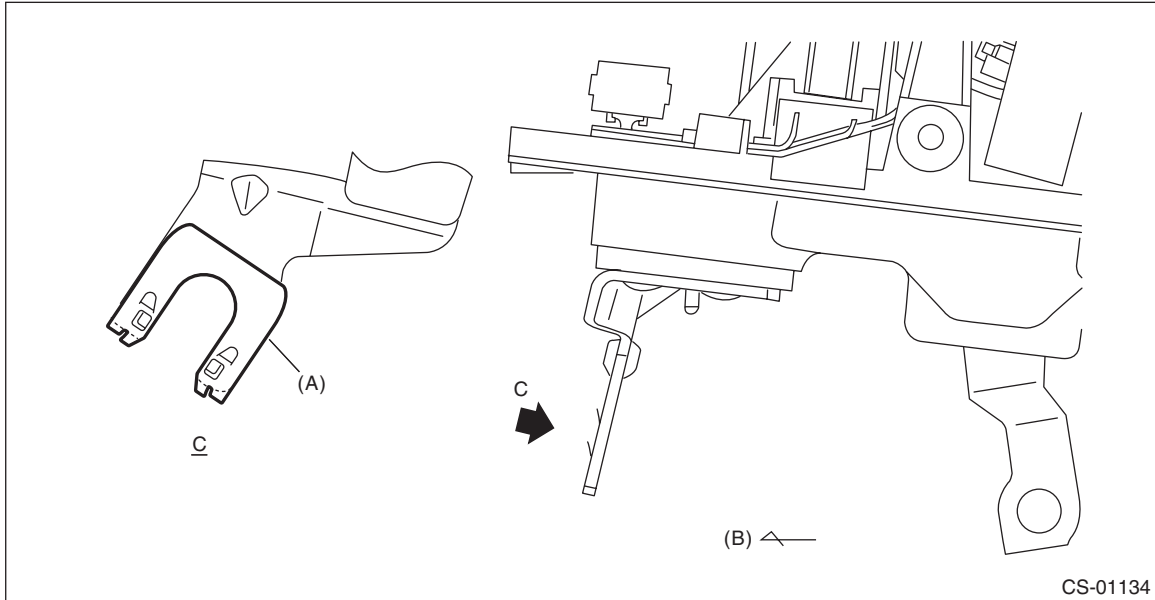

- (A) Clamp
- (B) Forward

6) Insert the tip of inner cable into connector hole of select lever, and fix the cable to bracket.

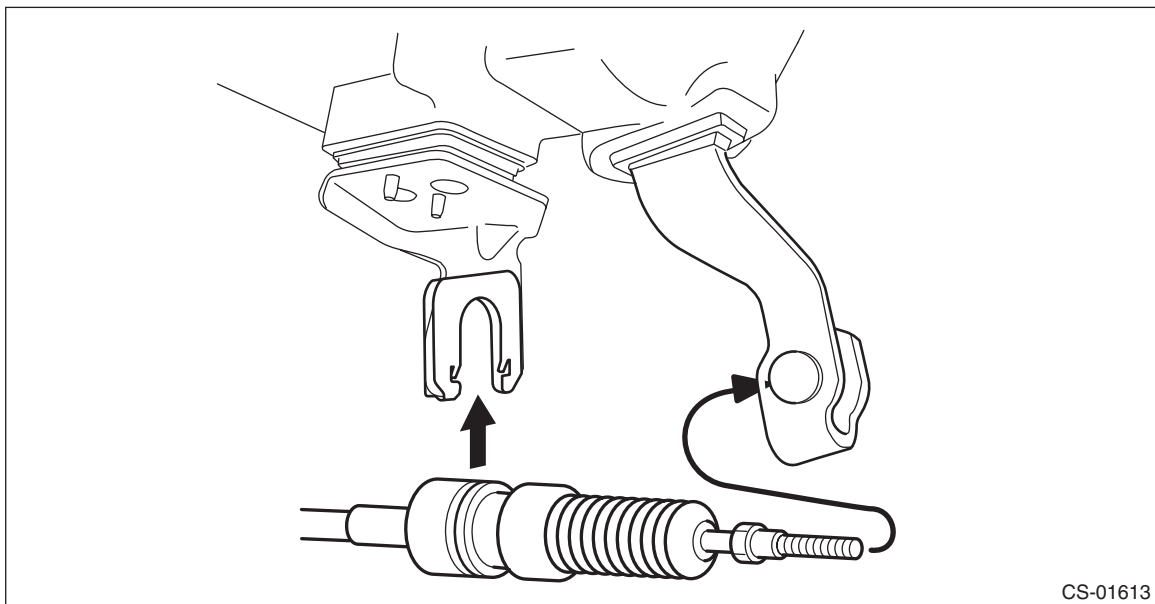

7) Shift the select lever to the "N" range, and then adjust the select cable position. <Ref. to CS-49, ADJUSTMENT, Select Cable.>

## Select Cable

### CONTROL SYSTEMS

---

8) Install the center exhaust cover.

**Tightening torque:**

**18 N·m (1.8 kgf-m, 13.3 ft-lb)**

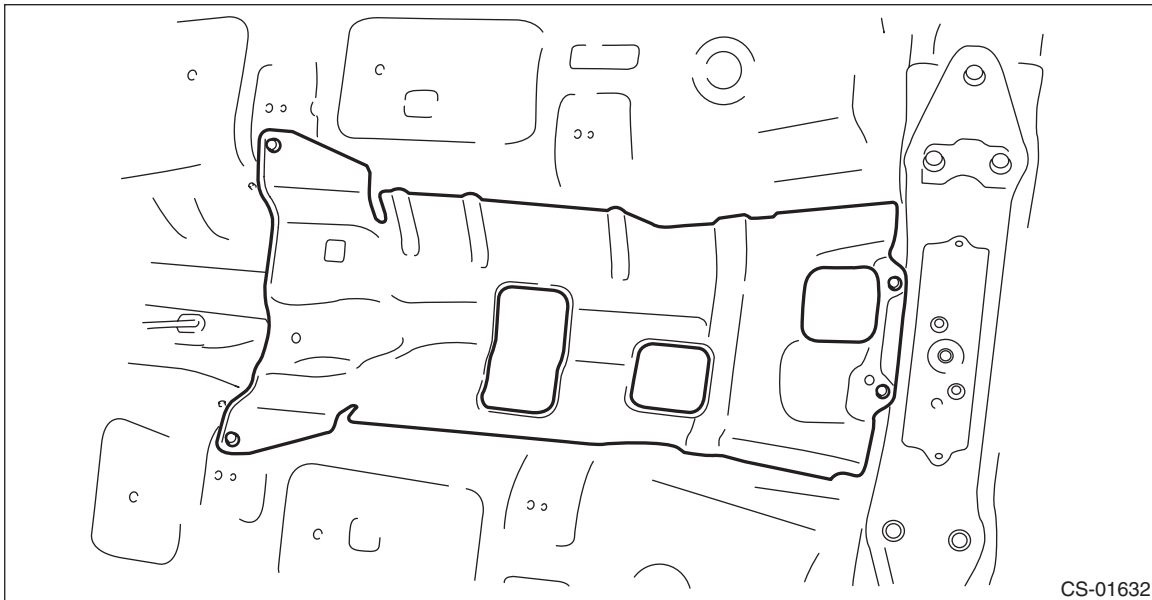

9) Install the center exhaust pipe. <Ref. to EX(H4DO)-14, INSTALLATION, Center Exhaust Pipe.>

10) Lower the vehicle.

11) Connect the battery ground terminal.

### C: INSPECTION

Check the removed cable and replace or adjust if damaged, rusty or malfunctioning.

- 1) Check the cable for smooth operation.
- 2) Check the inner cable for damage and rust.
- 3) Check the outer cable for damage, bends and cracks.
- 4) Check the boot for damage, cracks and deterioration.
- 5) Move the select lever from "P" to "D" range. Check the existence of feel to contact the detents in each range. If the detents cannot be felt or the position pointer is improperly aligned, adjust the cable.
- 6) Check if the starter motor rotates when the select lever is set to "P" range.
- 7) Check the back-up light illumination when the select lever is in "R" range.
- 8) Check the parking lock operation when the select lever is in "P" range.

## D: ADJUSTMENT

- 1) Shift the select lever to "N" range.
- 2) Lift up the vehicle.
- 3) Remove the center exhaust pipe. <Ref. to EX(H4DO)-14, REMOVAL, Center Exhaust Pipe.>
- 4) Remove the center exhaust cover.

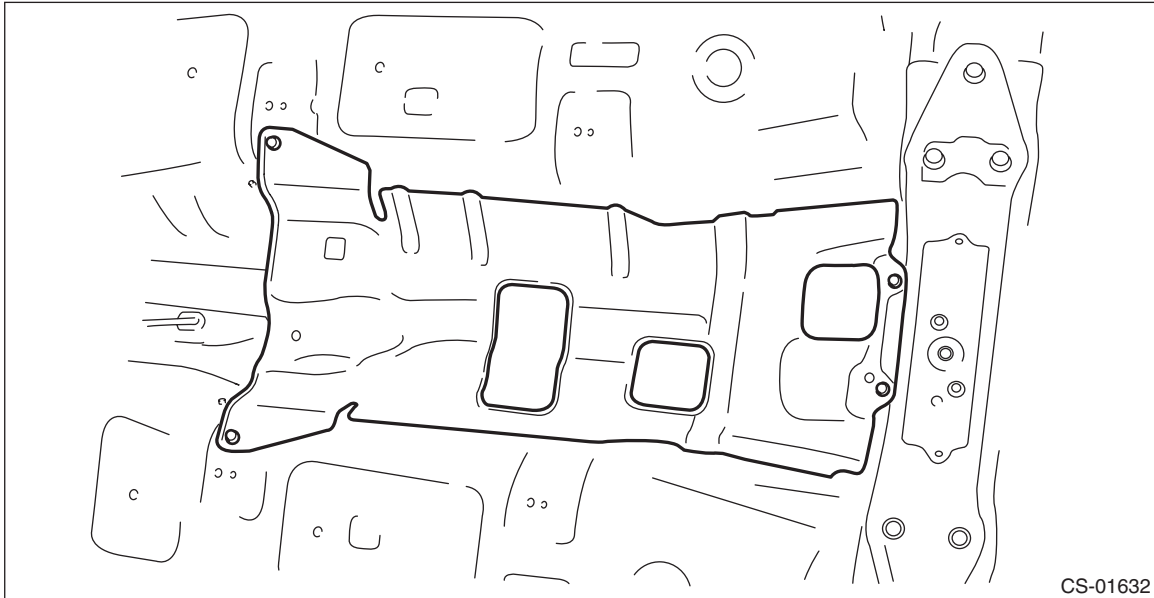

- 5) Loosen the adjusting nuts on both sides.

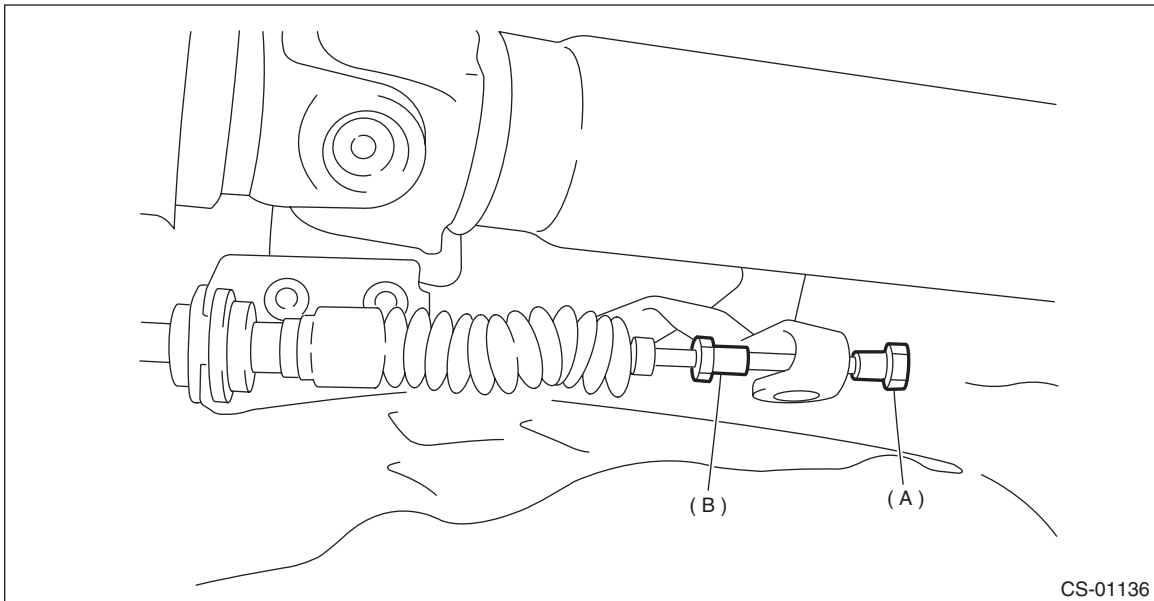

- (A) Adjusting nut A  
(B) Adjusting nut B

## Select Cable

### CONTROL SYSTEMS

6) Turn adjusting nut B until it lightly touches the connector.

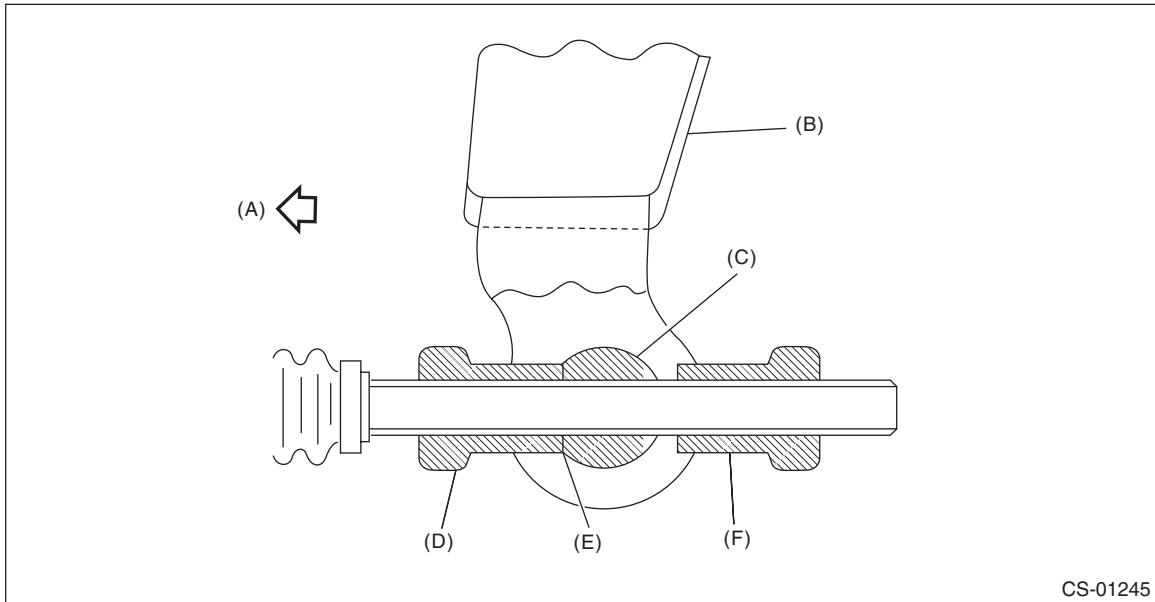

- (A) Forward side
- (B) Select lever
- (C) Connector
- (D) Adjusting nut B
- (E) Contact point
- (F) Adjusting nut A

7) Set a spanner wrench to adjusting nut B so that it does not rotate, and then tighten the adjusting nut A.

#### **Tightening torque:**

**7.5 N·m (0.76 kgf-m, 5.5 ft-lb)**

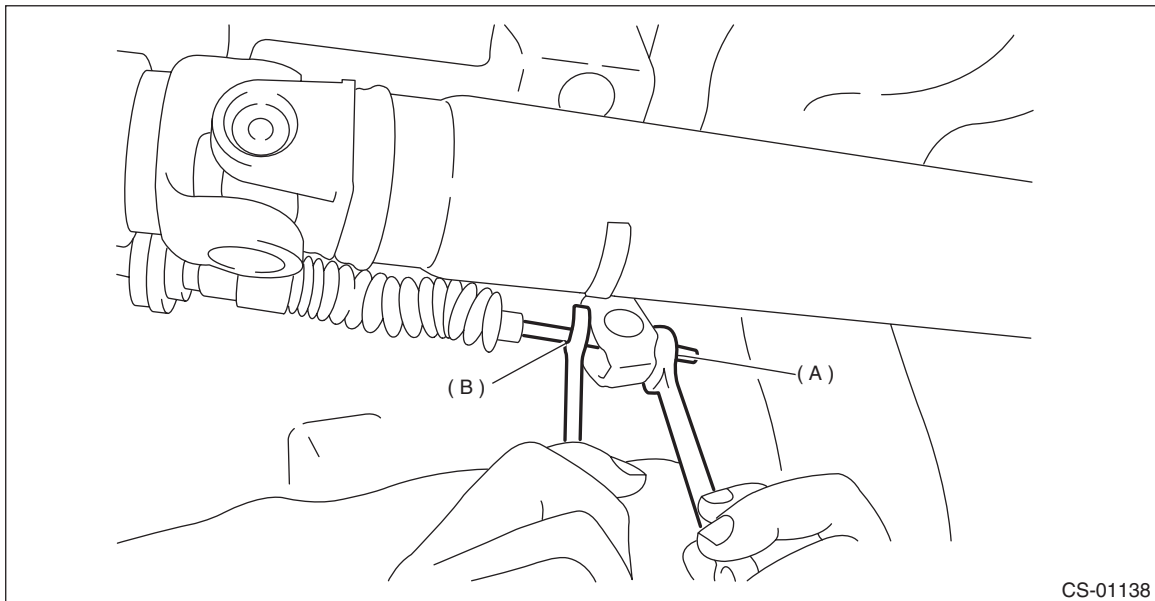

- (A) Adjusting nut A
- (B) Adjusting nut B

8) After the completion of adjustment, confirm that the select lever operates normally at all ranges.

9) Install in the reverse order of removal.