

# Heater and Cooling Unit

HVAC SYSTEM (HEATER, VENTILATOR AND A/C)

## 17.Heater and Cooling Unit

### A: REMOVAL

- 1) Disconnect the ground cable from battery.
- 2) Using the refrigerant recovery system, discharge refrigerant. <Ref. to AC-26, PROCEDURE, Refrigerant Recovery Procedure.>
- 3) Drain the coolant from the radiator. <Ref. to CO(H4DO)-13, DRAINING OF ENGINE COOLANT, REPLACEMENT, Engine Coolant.>
- 4) Remove the intake boot. <Ref. to IN(H4DO)-12, REMOVAL, Air Intake Boot.>

### CAUTION:

**Move aside the intake boot to perform the operation without disconnecting the PCV hose.**

- 5) Remove the bolt, and remove the hose - pressure suction and the pipe - evaporator cooling from the expansion valve - cooling.

- 6) Loosen the heater hose clamps and remove the hoses.

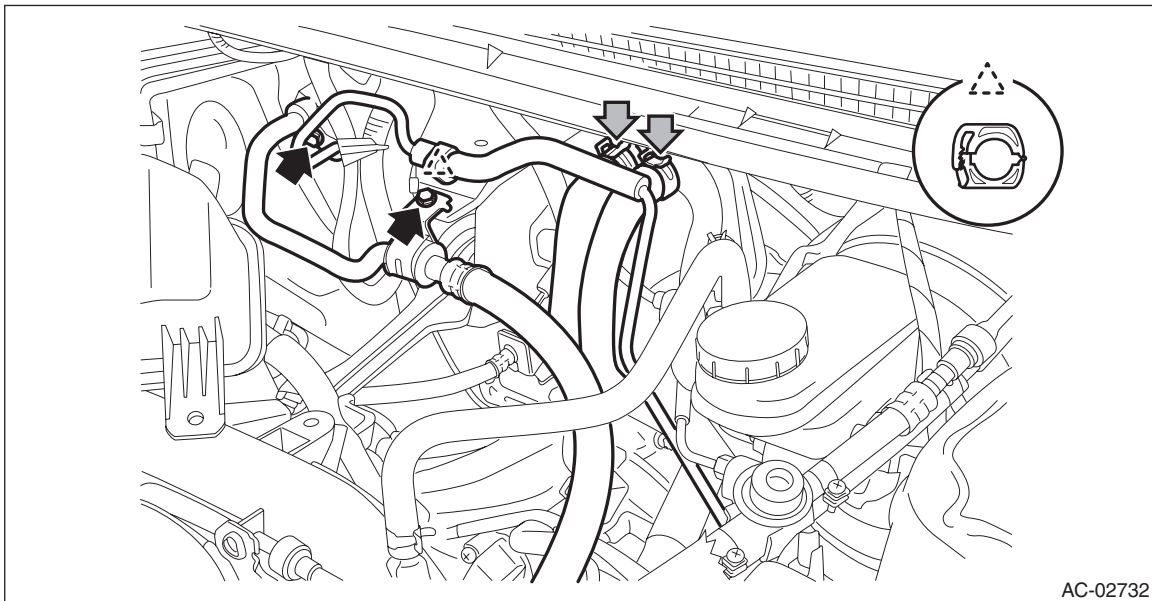

- 7) Remove the instrument panel assembly. <Ref. to EI-74, REMOVAL, Instrument Panel Assembly.>

## Heater and Cooling Unit

### HVAC SYSTEM (HEATER, VENTILATOR AND A/C)

- 8) Remove the engine control module (ECM).
- (1) Release the lock and remove the relay holder.
  - (2) Remove the nut (a).
  - (3) Loosen the bolt (b), and remove the engine control module (ECM).

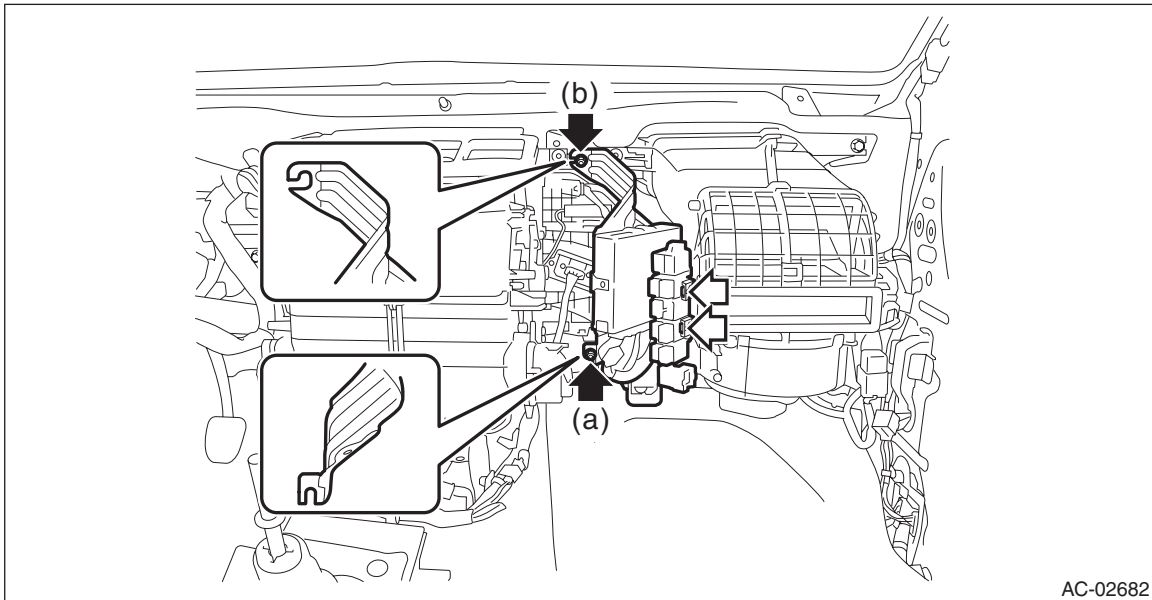

AC-02682

- 9) Remove the blower motor unit assembly.
- (1) Disconnect the blower motor relay and each connector.

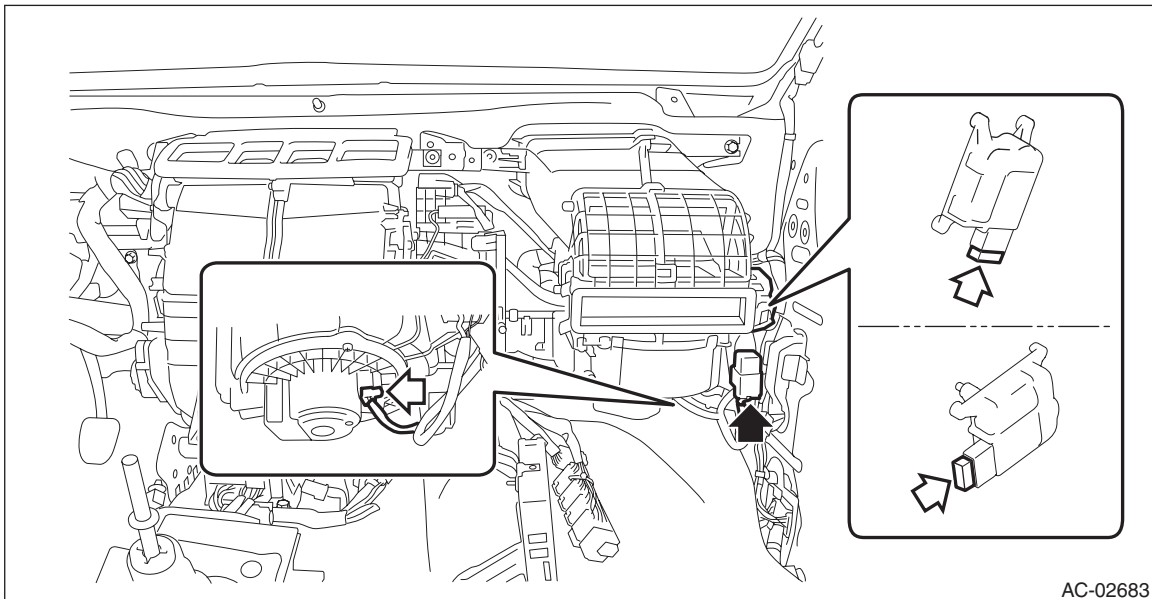

AC-02683

# Heater and Cooling Unit

HVAC SYSTEM (HEATER, VENTILATOR AND A/C)

(2) Remove the bolts and nuts to remove blower motor unit assembly.

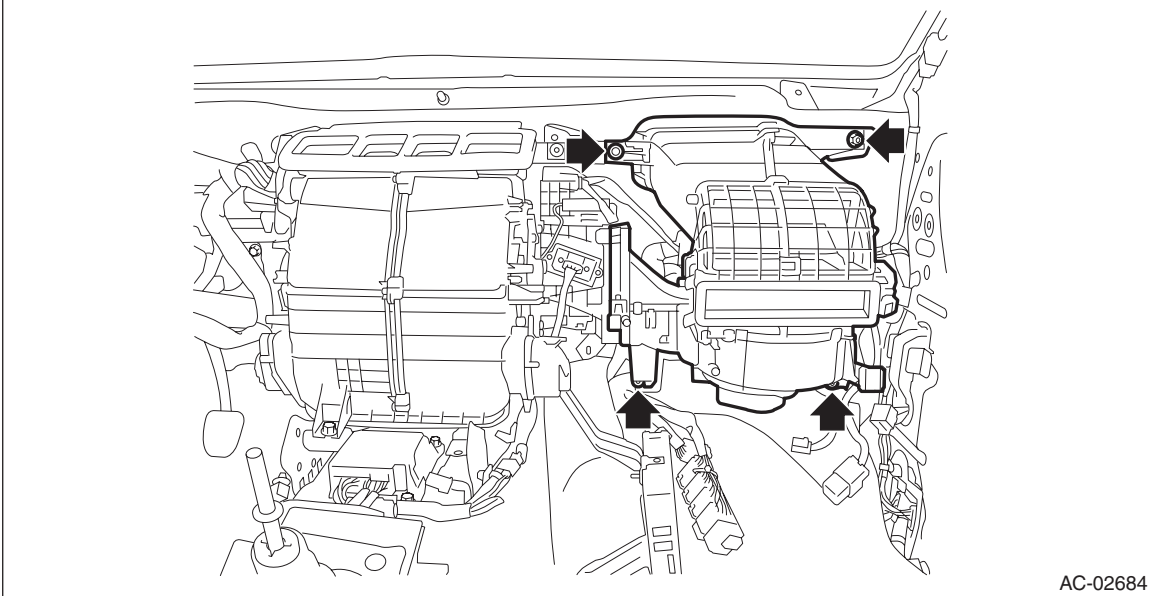

AC-02684

10) Remove the heater and cooling unit assembly.

(1) Disconnect each connector and the hose - drain.

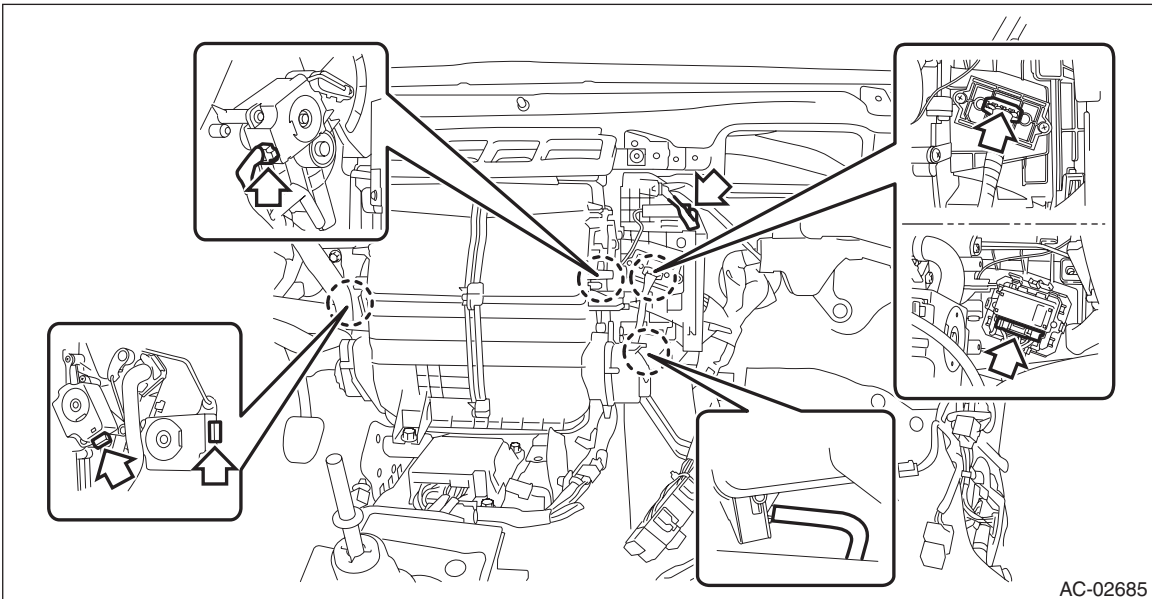

AC-02685

# Heater and Cooling Unit

## HVAC SYSTEM (HEATER, VENTILATOR AND A/C)

(2) Remove the bolt and nuts, and remove the heater & cooling unit assembly.

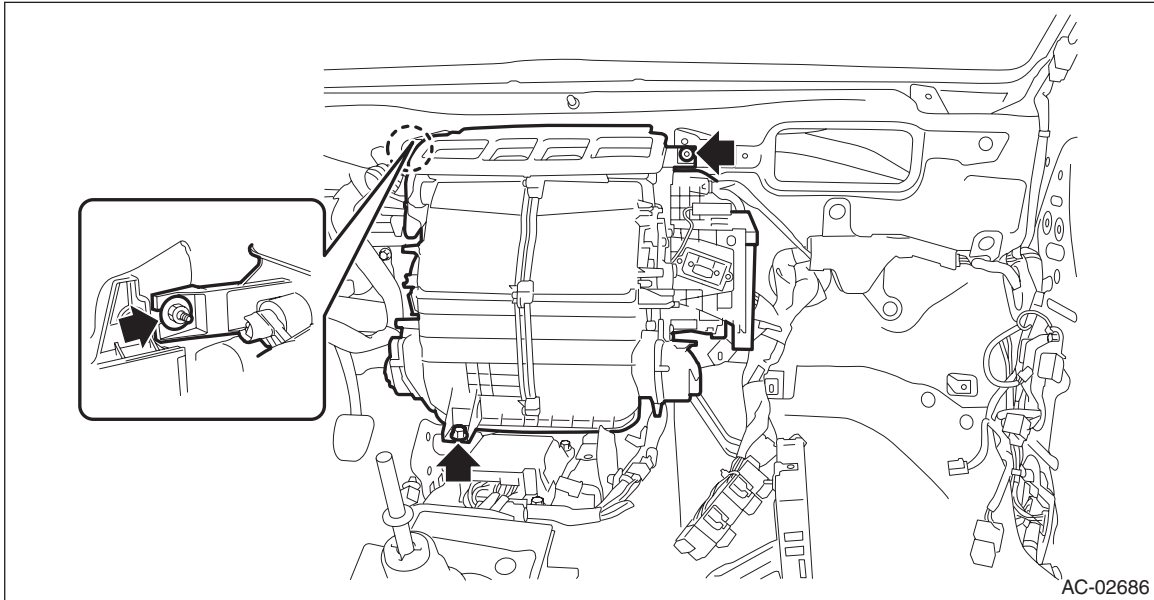

## B: INSTALLATION

### CAUTION:

**Replace O-rings with new parts and install securely.**

1) Install each part in the reverse order of removal.

### NOTE:

Refer to "INSTALLATION" of "Instrument Panel Assembly". <Ref. to EI-92, INSTALLATION, Instrument Panel Assembly.>

### Tightening torque:

**Heater cooling unit:** <Ref. to AC-6, HEATER AND COOLING UNIT, COMPONENT, General Description.>

**Blower motor unit:** <Ref. to AC-10, BLOWER MOTOR UNIT, COMPONENT, General Description.>

**Engine control module (ECM):** 7.5 N·m (0.76 kgf-m, 5.5 ft-lb)

2) Fill engine coolant. <Ref. to CO(H4DO)-14, FILLING OF ENGINE COOLANT, REPLACEMENT, Engine Coolant.>

3) Charge refrigerant. <Ref. to AC-27, PROCEDURE, Refrigerant Charging Procedure.>