

Spot Map Light

LIGHTING SYSTEM

31. Spot Map Light

A: REMOVAL

- 1) Disconnect the ground cable from battery.
- 2) Remove the light assembly - map.

CAUTION:

When using a flat tip screwdriver, apply protective tape or cloth and be careful not to cause damage.

- (1) Release the claws and remove the lens.
 - (2) Remove the screws and pull out the light assembly - map.
- Model without sunroof

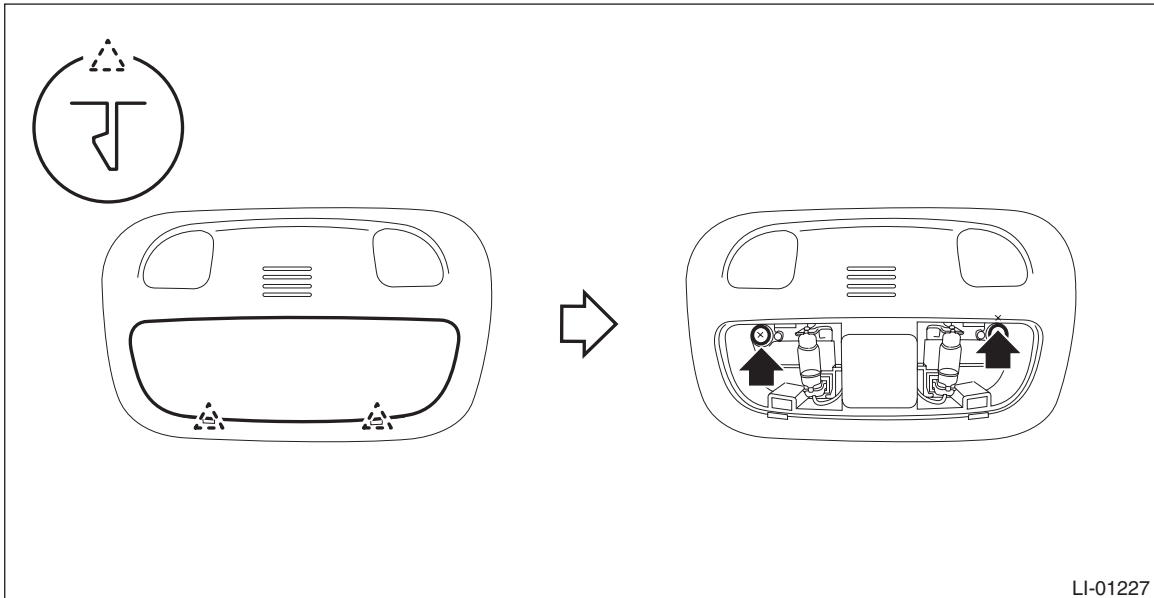

- Model with sunroof

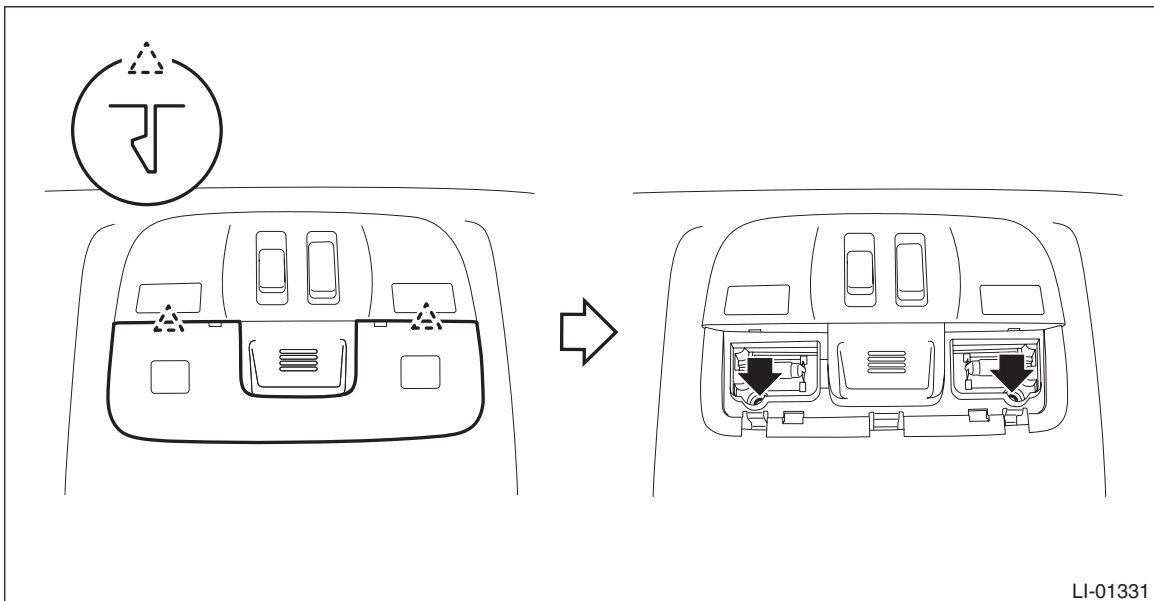

- (3) Disconnect the connector and remove the light assembly - map and the bulb.

B: INSTALLATION

Install each part in the reverse order of removal.

C: INSPECTION

1. SPOT MAP LIGHT BULB

- 1) Visually check the bulb for blow out.
- 2) Check the bulb specification. <Ref. to LI-2, SPECIFICATION, General Description.>
- 3) Replace the bulb if it is found defective.

2. SPOT MAP LIGHT SWITCH

Unit inspection

Preparation tool:

Circuit tester

- 1) Check the resistance between switch terminals.
- Model without sunroof

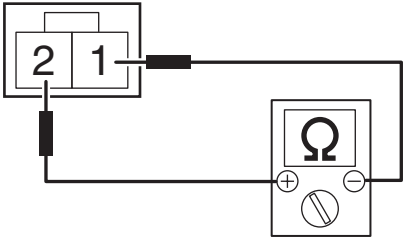
Terminal No.	Inspection conditions	Standard	Connection diagram
1 — 2	Switch OFF	1 MΩ or more	 <p style="text-align: right; font-size: small;">LI-01253</p>
	Switch ON	Approx. 18 Ω	

- Model with sunroof

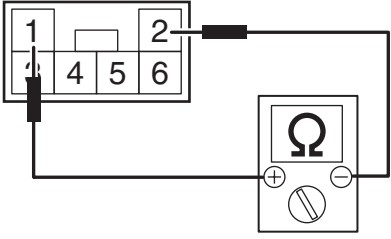
Terminal No.	Inspection conditions	Standard	Connection diagram
1 — 2	Switch OFF	1 MΩ or more	 <p style="text-align: right; font-size: small;">LI-01332</p>
	Switch ON	Approx. 18 Ω	

- 2) Replace the light assembly - map if the inspection result is not within the standard value.