

Rearview Mirror

GLASS/WINDOWS/MIRRORS

12.Rearview Mirror

A: REMOVAL

CAUTION:

Be careful not to damage the mirror surface and the glass - front window.

1) Release the claws, and then remove the cover.

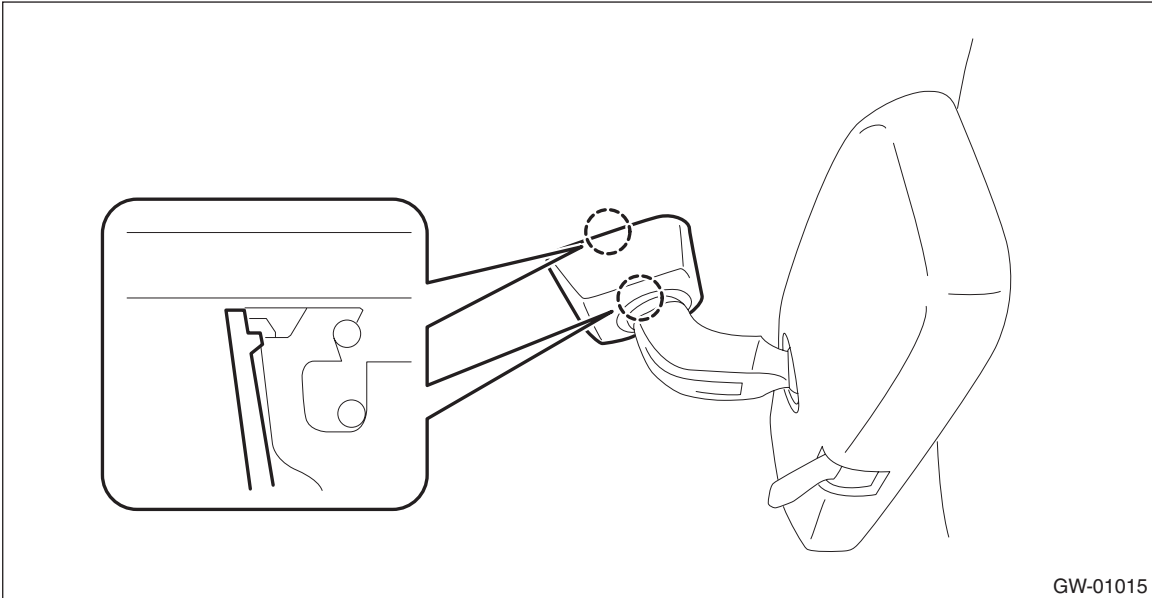

2) Release the lock lever, and slide the mirror assembly - inner rearview to remove.

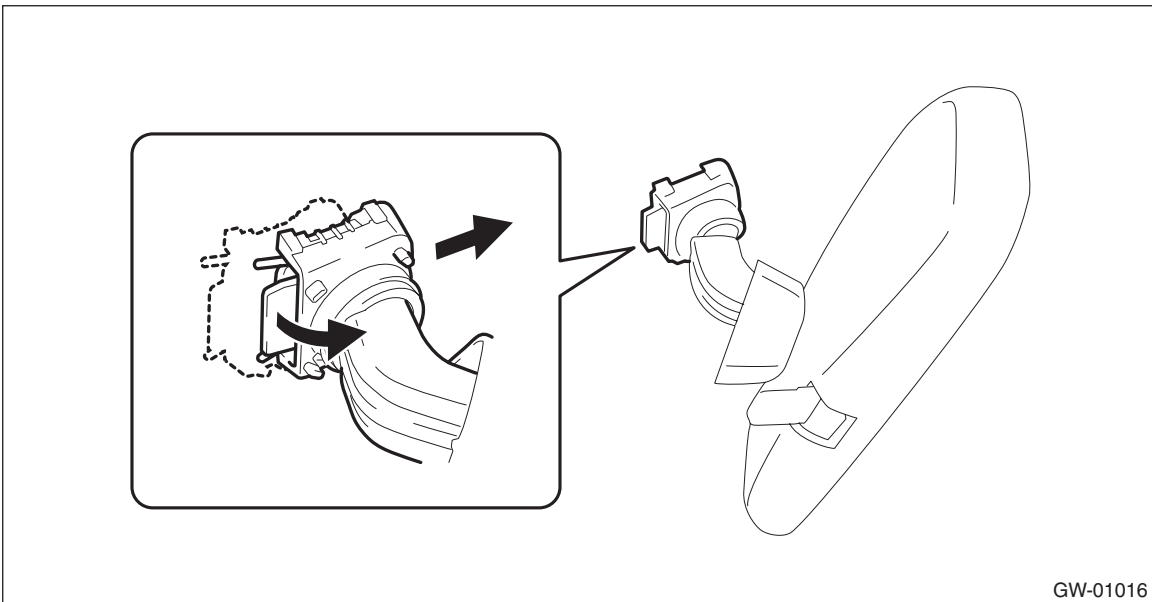

3) When the mirror mount is damaged, use something like piano wire or a spatula to remove.

B: INSTALLATION

Install each part in the reverse order of removal.

NOTE:

If the mirror mount is removed, it is attached according to the following procedures.

1. Clean the old adhesive completely.
2. Attach the mirror mount by matching with the mark on the glass - front window.
3. Make sure that the mirror mount is firmly adhered.

Adhesive:

REPAIR KIT IN MR (Part No. 65029FC000) or equivalent

C: INSPECTION

Check the mirror and mirror mount for damage.