

2. Power Steering System

1. LHD MODEL

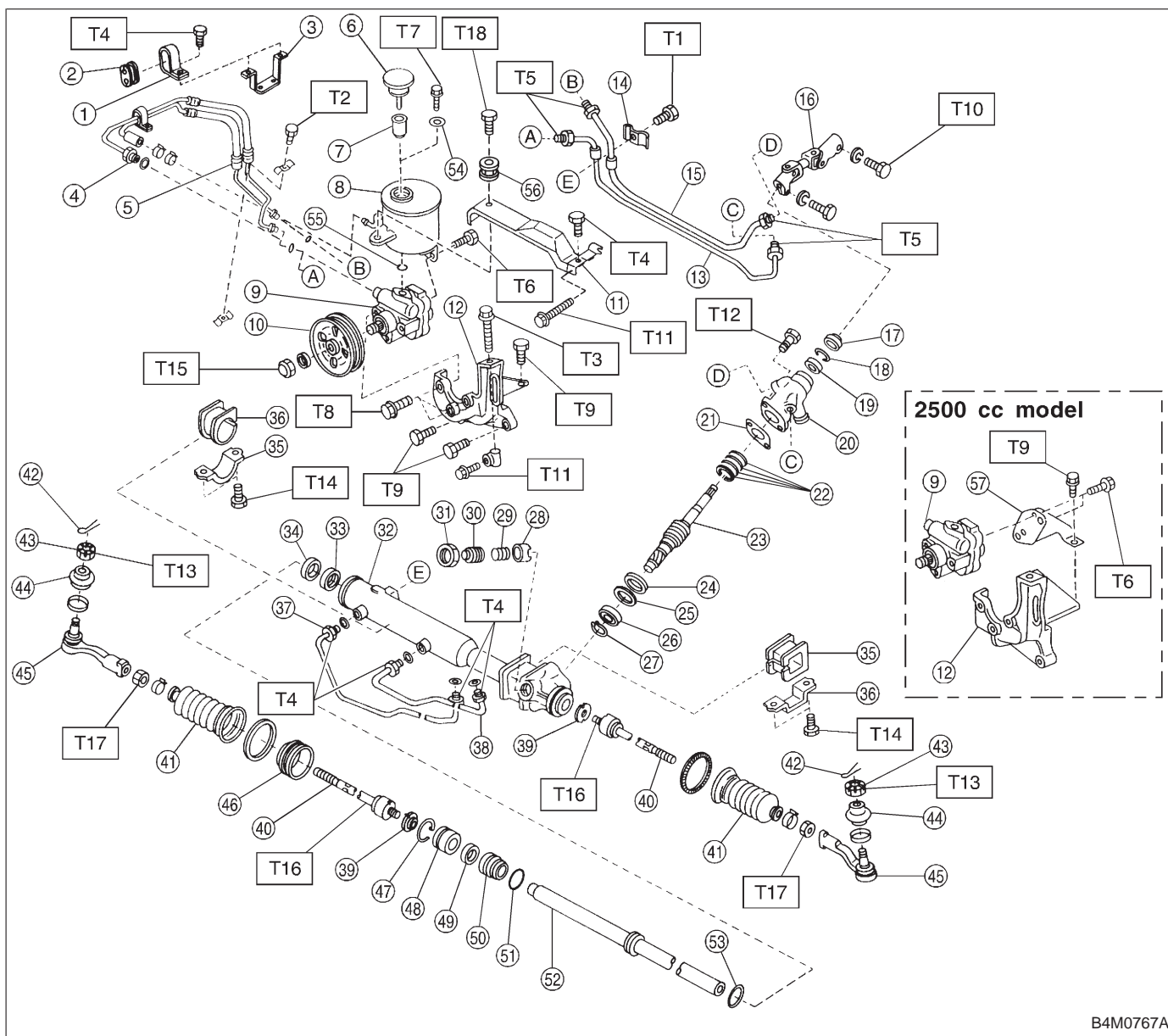

B4M0767A

**Tightening torque: N·m (kg·m, ft·lb)**

- T1: 5.4±1.5 (0.55±0.15, 4.0±1.1)
- T2: 7.4±2.0 (0.75±0.20, 5.4±1.4)
- T3: 8±2 (0.8±0.2, 5.8±1.4)
- T4: 13±3 (1.3±0.3, 9.4±2.2)
- T5: 15±5 (1.5±0.5, 10.8±3.6)
- T6: 15.7±2.4 (1.60±0.24, 11.58±1.77)
- T7: 18.1±2.5 (1.85±0.25, 13.35±1.84)
- T8: 20.1±2.5 (2.05±0.25, 14.8±1.8)
- T9: 22±2 (2.2±0.2, 15.9±1.4)

- T10: 24±3 (2.4±0.3, 17.4±2.2)
- T11: 24.5±2.0 (2.50±0.2, 18.07±1.48)
- T12: 25±5 (2.5±0.5, 18.1±3.6)
- T13: 27.0±2.5 (2.75±0.25, 19.92±1.84)
- T14: 59±12 (6.0±1.2, 43±9)
- T15: 60.8±6.9 (6.2±0.7, 44.8±5.1)
- T16: 78±10 (8.0±1.0, 58±7)
- T17: 83±5 (8.5±0.5, 61.5±3.6)
- T18: 6.35±1.0 (0.65±0.1, 4.7±0.7)

2. Power Steering System

---

- |                         |                              |
|-------------------------|------------------------------|
| ① Clamp                 | ③① Adjusting screw           |
| ② Adapter               | ③② Lock nut                  |
| ③ Hose bracket          | ③③ Housing ASSY              |
| ④ Pipe C                | ③④ Back-up washer            |
| ⑤ Pipe D                | ③⑤ Oil seal                  |
| ⑥ Cap                   | ③⑥ Adapter                   |
| ⑦ Strainer              | ③⑦ Clamp                     |
| ⑧ Tank                  | ③⑧ Pipe A                    |
| ⑨ Oil pump              | ③⑨ Pipe B                    |
| ⑩ Pulley                | ③⑩ Lock washer               |
| ⑪ Belt cover            | ④① Tie-rod                   |
| ⑫ Bracket               | ④② Boot                      |
| ⑬ Pipe E                | ④③ Cotter pin                |
| ⑭ Clamp plate           | ④④ Castle nut                |
| ⑮ Pipe F                | ④⑤ Dust seal                 |
| ⑯ Universal joint       | ④⑥ Tie-rod end               |
| ⑰ Dust seal             | ④⑦ Spacer                    |
| ⑱ C-ring                | ④⑧ Circlip                   |
| ⑲ Oil seal              | ④⑨ Rack stopper              |
| ⑳ Valve housing         | ④⑩ Oil seal                  |
| ㉑ Packing               | ④⑪ Rack bushing              |
| ㉒ Seal ring             | ④⑫ O-ring                    |
| ㉓ Pinion and valve ASSY | ④⑬ Rack                      |
| ㉔ Oil seal              | ④⑭ Piston ring               |
| ㉕ Back-up washer        | ④⑮ Seal washer               |
| ㉖ Ball bearing          | ④⑯ O-ring                    |
| ㉗ Snap ring             | ④⑰ Bush                      |
| ㉘ Sleeve                | ④⑱ Stay (2500 cc model only) |
| ㉙ Spring                |                              |

2. RHD MODEL

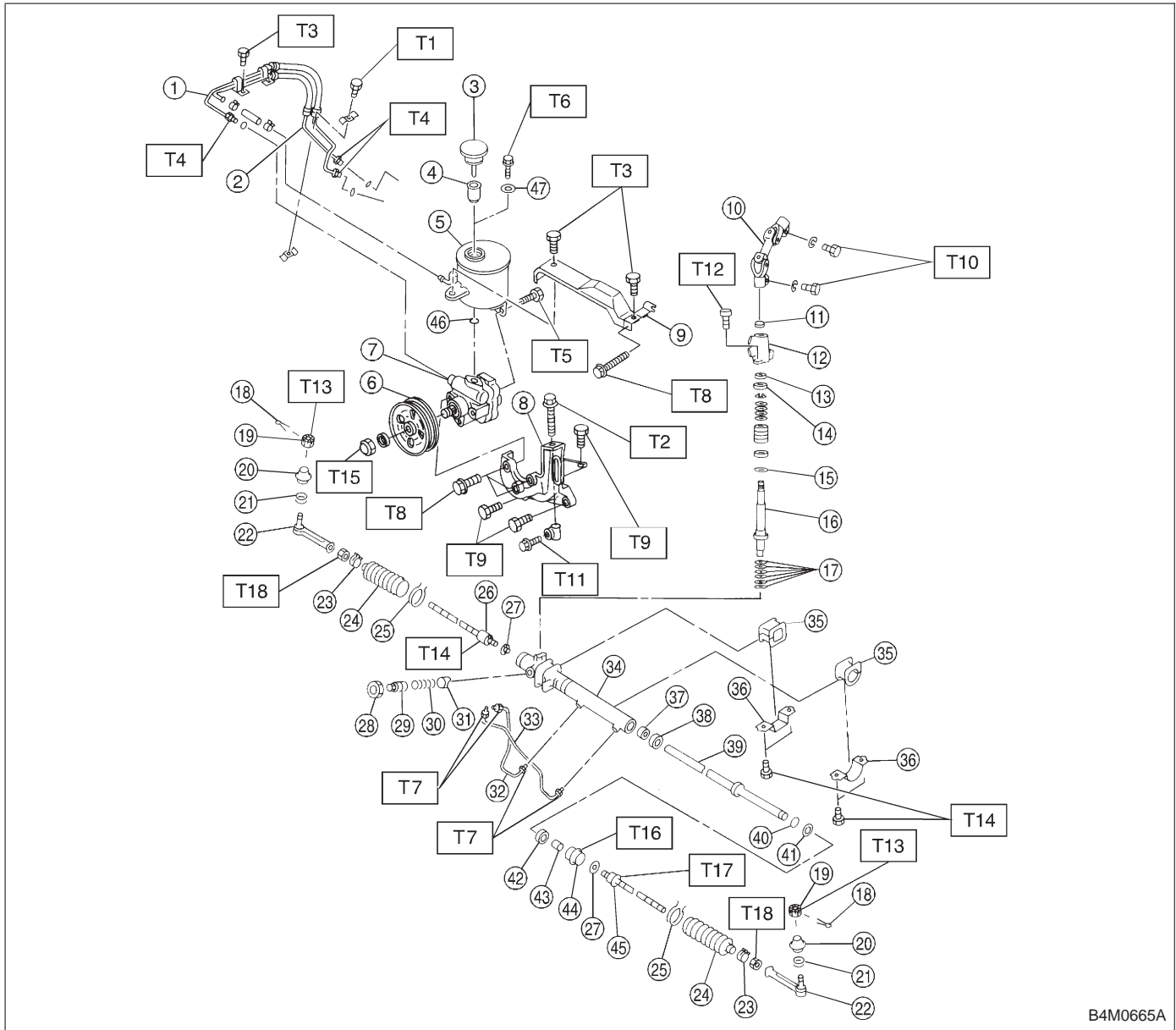

B4M0665A

**Tightening torque: N·m (kg·m, ft·lb)**

- T1: 7.4±2.0 (0.75±0.2, 5.4±1.4)
- T2: 8±2 (0.8±0.2, 5.8±1.4)
- T3: 13±3 (1.3±0.3, 9.4±2.2)
- T4: 15±5 (1.5±0.5, 10.8±3.6)
- T5: 15.7±2.4 (1.60±0.24, 11.58±1.77)
- T6: 18.1±2.5 (1.85±0.26, 13.35±1.84)
- T7: 20±4 (2.0±0.4, 14±2.9)
- T8: 20.1±2.5 (2.05±0.25, 14.8±1.8)
- T9: 22±2 (2.2±0.2, 15.9±1.4)
- T10: 24±3 (2.4±0.3, 17.4±2.2)
- T11: 24.5±2.0 (2.50±0.20, 18.07±1.48)
- T12: 25±5 (2.5±0.5, 18.1±3.6)
- T13: 27.0±2.5 (2.75±0.26, 19.92±1.84)
- T14: 59±12 (6.0±1.2, 43±9)
- T15: 61±7 (6.2±0.7, 44.8±5.1)
- T16: 64±10 (6.5±1.0, 47±7)
- T17: 78±10 (8.0±1.0, 58±7)
- T18: 83±5 (8.5±0.5, 61.5±3.6)

2. Power Steering System

---

- |                   |                    |
|-------------------|--------------------|
| ① Pipe C          | ②⑤ Wire            |
| ② Pipe D          | ②⑥ Tie-rod RH      |
| ③ Cap             | ②⑦ Lock washer     |
| ④ Strainer        | ②⑧ Lock nut        |
| ⑤ Tank            | ②⑨ Adjusting screw |
| ⑥ Pulley          | ②⑩ Spring          |
| ⑦ Oil pump        | ②⑪ Sleeve          |
| ⑧ Bracket         | ②⑫ Pipe B          |
| ⑨ Belt cover      | ②⑬ Pipe A          |
| ⑩ Universal joint | ②⑭ Housing ASSY    |
| ⑪ Dust cover      | ②⑮ Adapter         |
| ⑫ Valve housing   | ②⑯ Clamp           |
| ⑬ Y-packing       | ②⑰ Back-up washer  |
| ⑭ Ball bearing    | ②⑱ Oil seal        |
| ⑮ Spacer          | ②⑲ Rack            |
| ⑯ Pinion          | ②⑳ O-ring          |
| ⑰ Shim            | ②㉑ Oil seal        |
| ⑱ Cotter pin      | ②㉒ Y-packing       |
| ⑲ Castle nut      | ②㉓ Bush            |
| ⑳ Dust seal       | ②㉔ Holder          |
| ㉑ Clip            | ②㉕ Tie-rod LH      |
| ㉒ Tie-rod end     | ②㉖ O-ring          |
| ㉓ Clip            | ②㉗ Seal washer     |
| ㉔ Boot            |                    |