

27. Transmission Control Device

S510214

A: REMOVAL

S510214A18

- 1) Extract the torque converter clutch assembly. <Ref. to AT-35, REMOVAL, Torque Converter Clutch Assembly.>
- 2) Remove the input shaft.
- 3) Disconnect transmission harness connector from stay.

NOTE:

Lift-up lever behind the connector and disconnect it from stay.

- 4) Disconnect the air breather hoses. <Ref. to AT-28, REMOVAL, Air Breather Hose.>
- 5) Disconnect inhibitor switch connector from stay.
- 6) Wrap vinyl tape around the nipple attached to the air breather hose.
- 7) Remove pitching stopper bracket.
- 8) Remove the inhibitor switch.

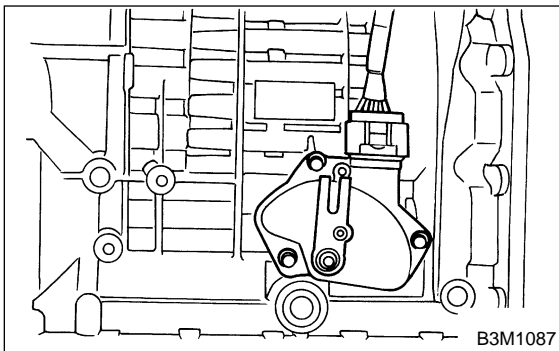

- 9) Remove control valve body assembly. <Ref. to AT-81, REMOVAL, Control Valve Body Assembly.>
- 10) Pull off the straight pin of manual plate.

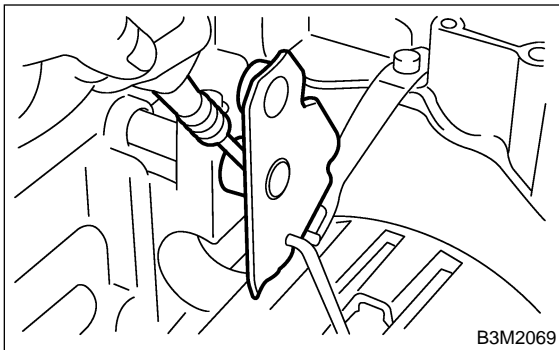

- 11) Remove bolts securing select lever, then remove select lever, manual plate and parking rod.

NOTE:

Be careful not to damage the lips of the press-fitted oil seal in the case.

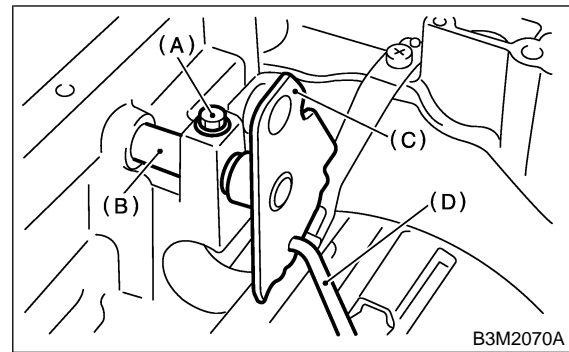

- (A) Bolt
- (B) Range select lever
- (C) Manual plate
- (D) Parking rod

- 12) Remove the detention spring.

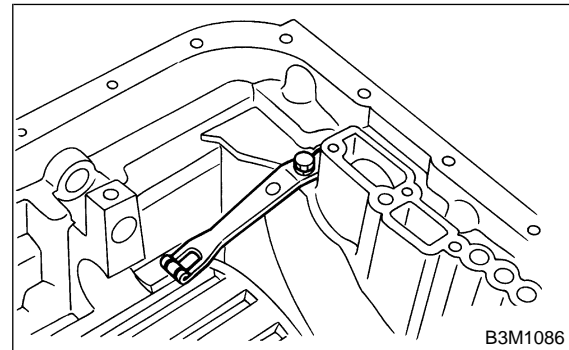

B: INSTALLATION

S510214A11

- 1) Install detention spring to transmission case.

Tightening torque:

6 N·m (0.6 kgf-m, 4.3 ft-lb)

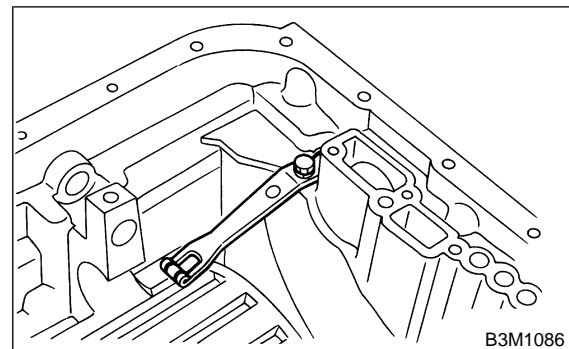

TRANSMISSION CONTROL DEVICE

Automatic Transmission

2) Insert range select lever, and tighten bolt.

Tightening torque:

6 N·m (0.6 kgf-m, 4.3 ft-lb)

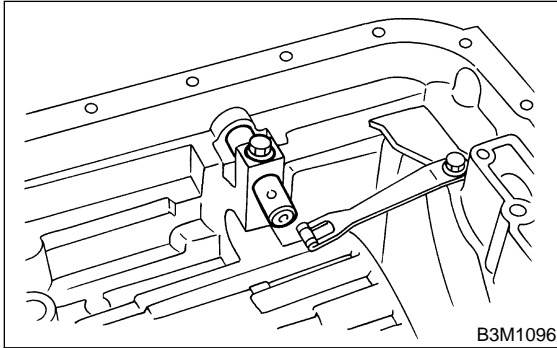

3) Insert manual plate and parking rod.

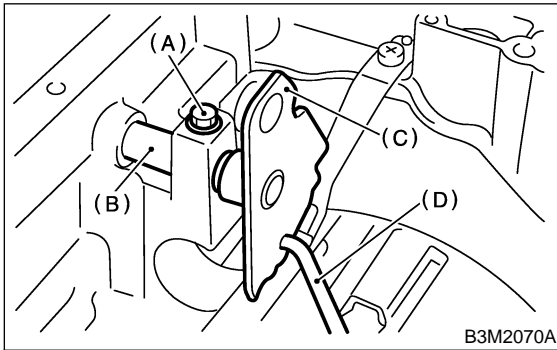

- (A) Bolt
- (B) Range select lever
- (C) Manual plate
- (D) Parking rod

4) Insert spring pin to manual plate.

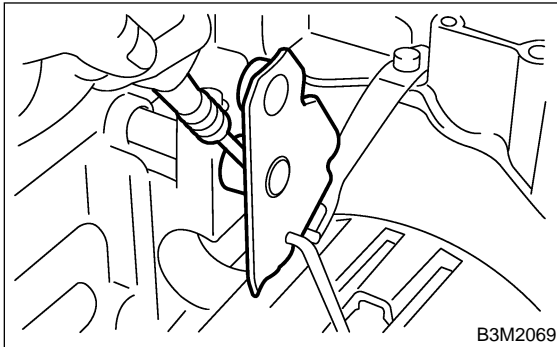

5) Install control valve assembly and oil pan. <Ref. to AT-82, INSTALLATION, Control Valve Body Assembly.>

6) Turn over the transmission case to its original position.

7) Install pitching stopper bracket.

Tightening torque:

41 N·m (4.2 kgf-m, 30.4 ft-lb)

8) Install inhibitor switch and adjust the inhibitor switch by referring to Supplement AT section.

9) Insert inhibitor switch and transmission connector into stay.

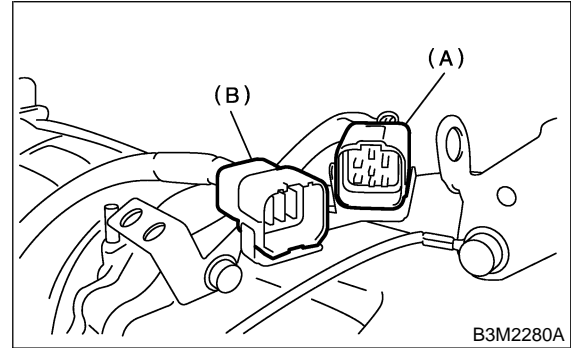

- (A) Transmission harness
- (B) Inhibitor switch harness

10) Install air breather hose. <Ref. to AT-28, INSTALLATION, Air Breather Hose.>

11) Insert the input shaft while turning lightly by hand.

CAUTION:

Be careful not to damage the bushing.

Normal protrusion A:

50 — 55 mm (1.97 — 2.17 in)

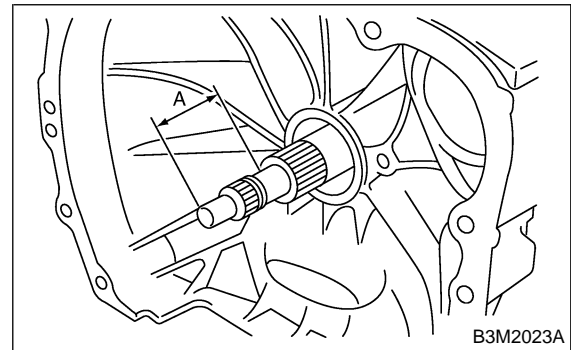

12) Install the torque converter clutch assembly. <Ref. to AT-35, INSTALLATION, Torque Converter Clutch Assembly.>

C: INSPECTION S510214A10

Make sure the manual lever and detention spring are not worn or otherwise damaged.