

# GENERAL DESCRIPTION

Exhaust

## 1. General Description S142001

### A: COMPONENT S142001A05

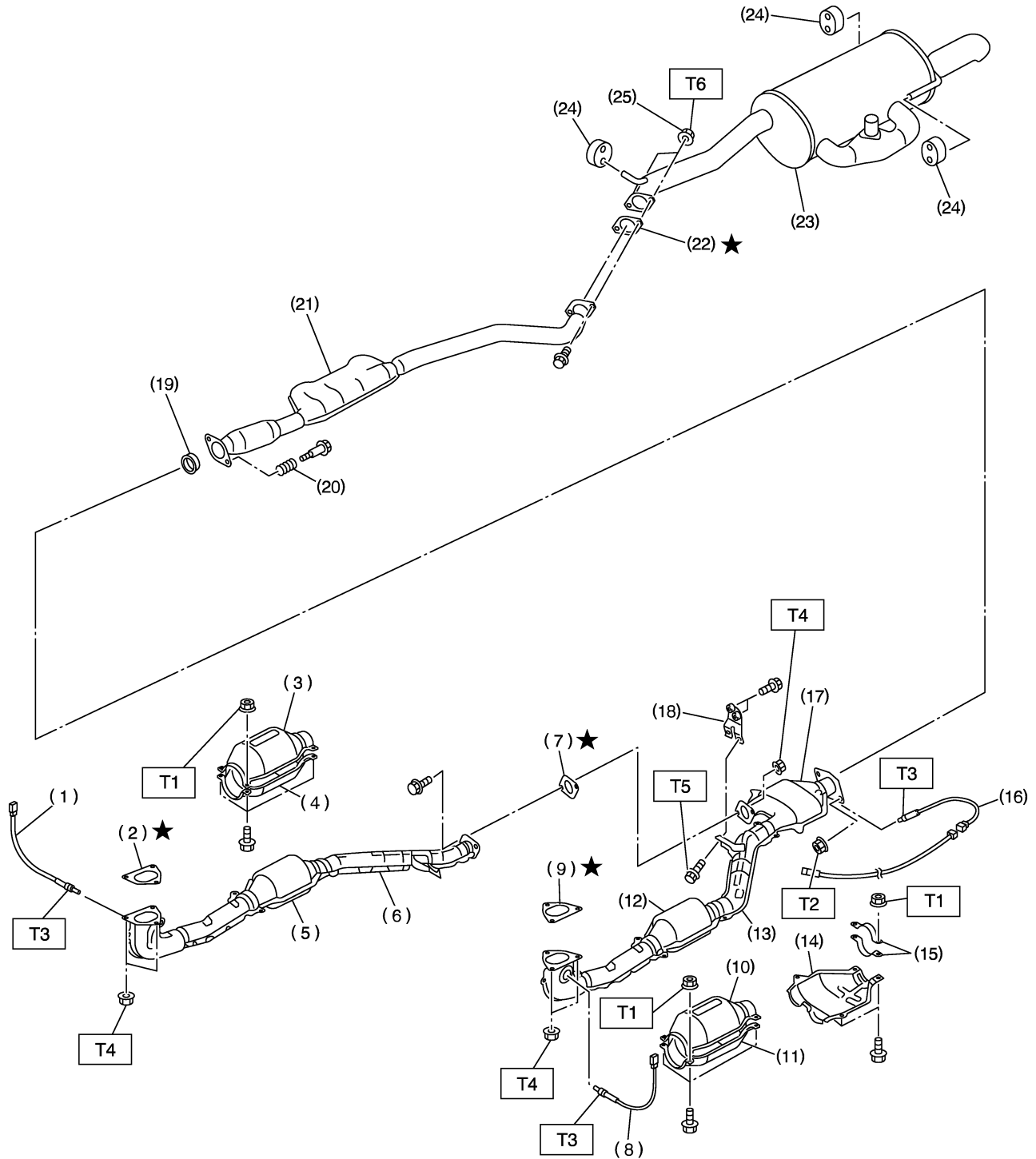

B2M4701A

EX(H6)-2

# GENERAL DESCRIPTION

Exhaust

- (1) Front oxygen (A/F) sensor (RH)
- (2) Gasket (RH)
- (3) Upper front catalytic converter cover (RH)
- (4) Lower front catalytic converter cover (RH)
- (5) Front catalytic converter (RH)
- (6) Front exhaust pipe (RH)
- (7) Gasket (RH)
- (8) Front oxygen (A/F) sensor (LH)
- (9) Gasket (LH)
- (10) Upper front catalytic converter cover (LH)

- (11) Lower front catalytic converter cover (LH)
- (12) Front catalytic converter (LH)
- (13) Front exhaust pipe (LH)
- (14) Lower rear catalytic converter cover
- (15) Clamp
- (16) Rear oxygen sensor
- (17) Rear catalytic converter
- (18) Bracket
- (19) Gasket
- (20) Spring
- (21) Rear exhaust pipe

- (22) Gasket
- (23) Muffler
- (24) Cushion rubber
- (25) Self-locking nut

---

**Tightening torque: N·m (kgf-m, ft-lb)**

**T1: 13 (1.3, 9.4)**

**T2: 18 (1.8, 13.0)**

**T3: 21 (2.1, 15)**

**T4: 30 (3.1, 22.4)**

**T5: 35 (3.6, 26.0)**

**T6: 48 (4.9, 35.4)**

---

### **B: CAUTION** S142001A03

- Wear working clothing, including a cap, protective goggles, and protective shoes during operation.
- Remove contamination including dirt and corrosion before removal, installation or disassembly.
- Keep the disassembled parts in order and protect them from dust or dirt.
- Before removal, installation or disassembly, be sure to clarify the failure. Avoid unnecessary removal, installation, disassembly, and replacement.
- Be careful not to burn your hands, because each part on the vehicle is hot after running.
- Be sure to tighten fasteners including bolts and nuts to the specified torque.
- Place shop jacks or safety stands at the specified points.
- Before disconnecting electrical connectors of sensors or units, be sure to disconnect ground cable from battery.