

## 2. Accelerator Pedal

### A: REMOVAL

1) Disconnect the ground cable from the battery.

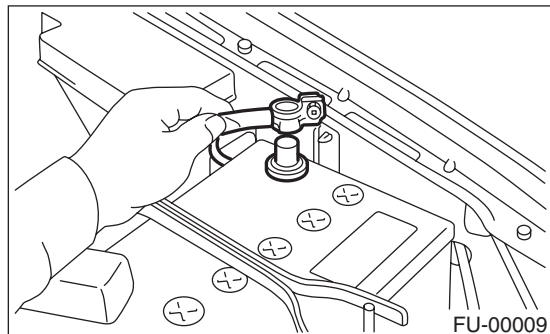

2) Disconnect the connector (A).

3) Remove the nut (B) securing accelerator pedal assembly.

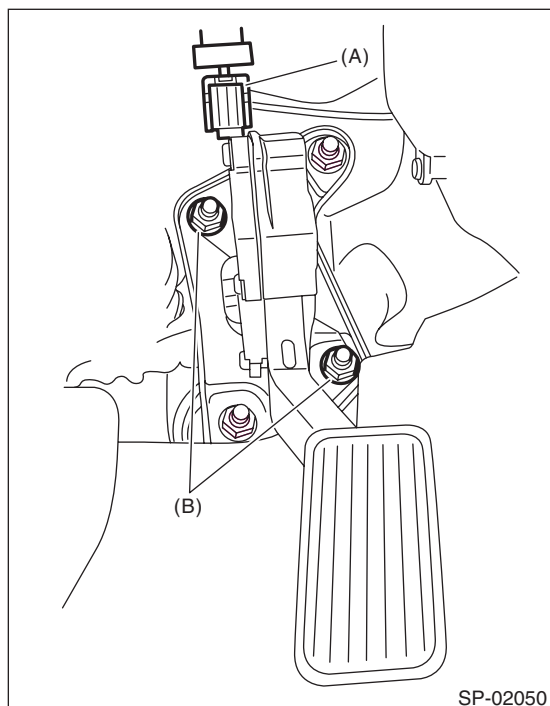

### B: INSTALLATION

Install in the reverse order of removal.

**Tightening torque:**

**18 N·m (1.8 kgf-m, 13.0 ft-lb)**

### C: DISASSEMBLY

NOTE:

The accelerator pedal cannot be disassembled.

# Accelerator Pedal

SPEED CONTROL SYSTEMS

---

# IGNITION

# *IG(H4SO)*

---

	<b>Page</b>
1. General Description .....	2
2. Spark Plug .....	4
3. Ignition Coil and Ignitor Assembly .....	6
4. Spark Plug Cord .....	7