

Front Regulator and Motor Assembly

GLASS/WINDOWS/MIRRORS

6. Front Regulator and Motor Assembly

A: REMOVAL

- 1) Remove the front door glass. <Ref. to GW-16, REMOVAL, Front Door Glass.>
- 2) Remove the front regulator and motor assembly.
 - (1) Disconnect the connector.
 - (2) Remove the bolts, and then remove the front regulator and motor assembly.

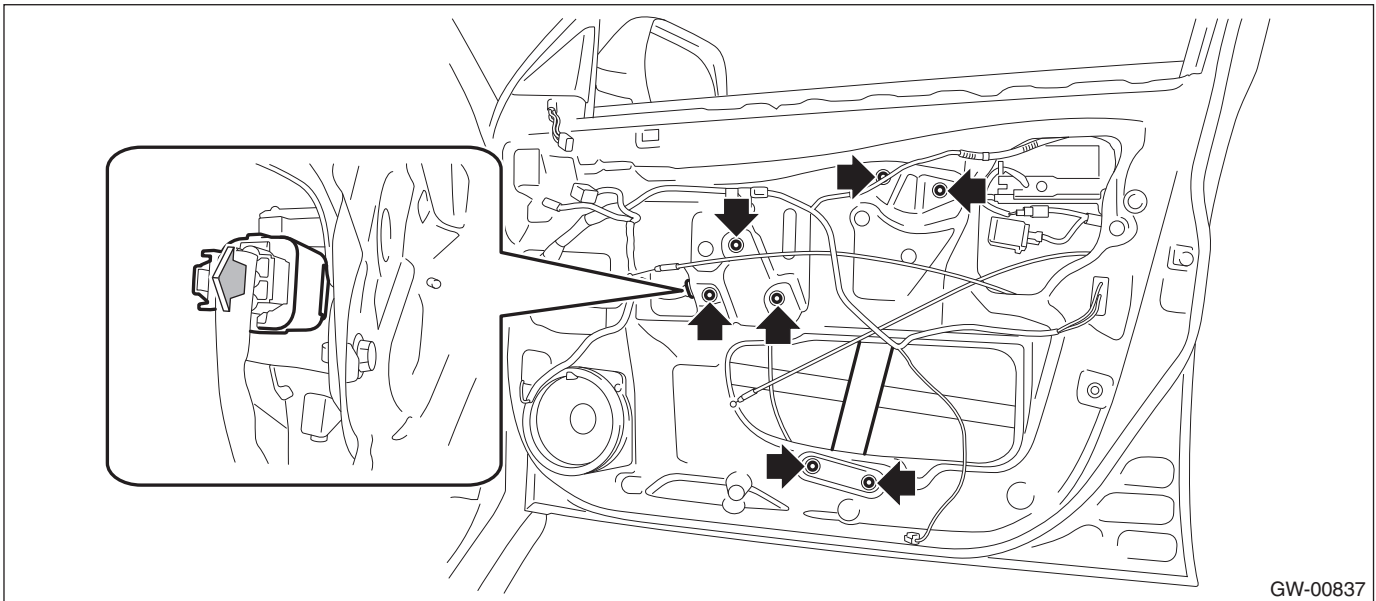

B: INSTALLATION

Install each part in the reverse order of removal.

Tightening torque:

Refer to "COMPONENT" of "General Description". <Ref. to GW-4, FRONT DOOR GLASS, COMPONENT, General Description.>

C: INSPECTION

- 1) Disconnect the motor connector.
- 2) Apply battery voltage between the motor connector terminals and check the motor operation.

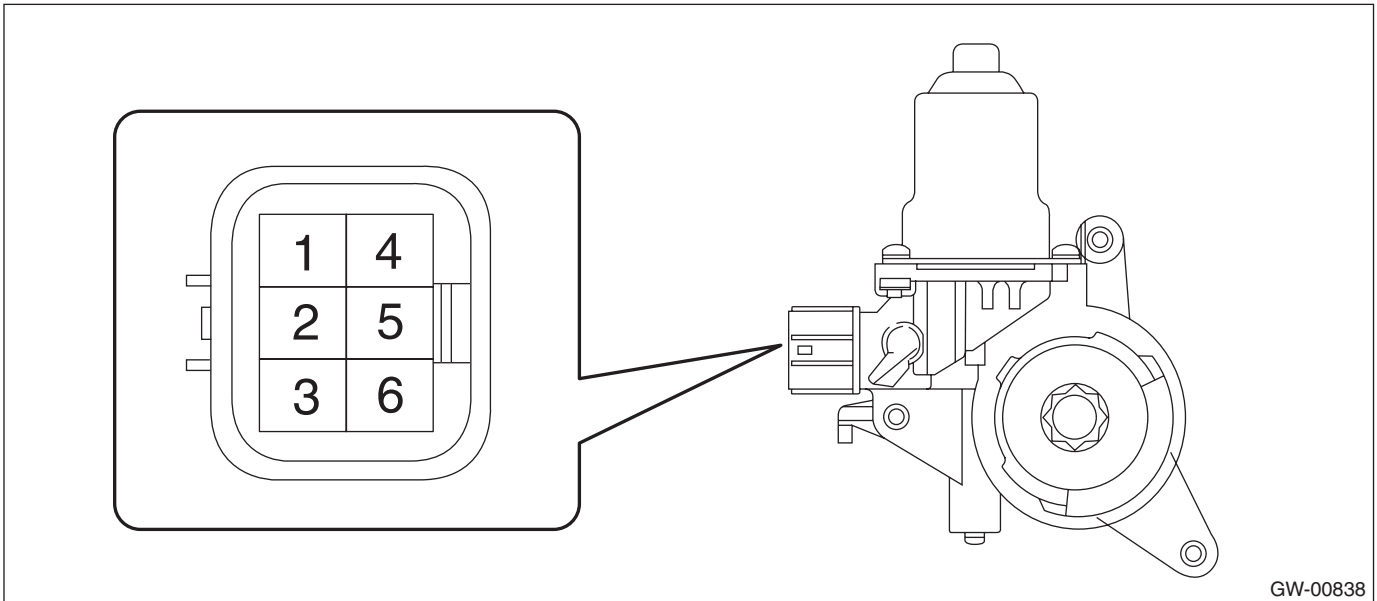

GW-00838

Terminal No.	Inspection conditions	Specification
1 (+) — 4 (-)	Apply battery voltage between terminals.	Increase
4 (+) — 1 (-)	Apply battery voltage between terminals.	Decrease

- 3) If the inspection results in improper operation, replace the front regulator and motor assembly.