

Sunroof Switch

SUNROOF/T-TOP/CONVERTIBLE TOP (SUNROOF)

7. Sunroof Switch

A: REMOVAL

- 1) Disconnect the ground cable from battery.
- 2) Remove the overhead console.
 - (1) Push and open the rear end of the overhead console lid, and remove the screws.
 - (2) Remove the clips and pull out the overhead console to disconnect the connectors.

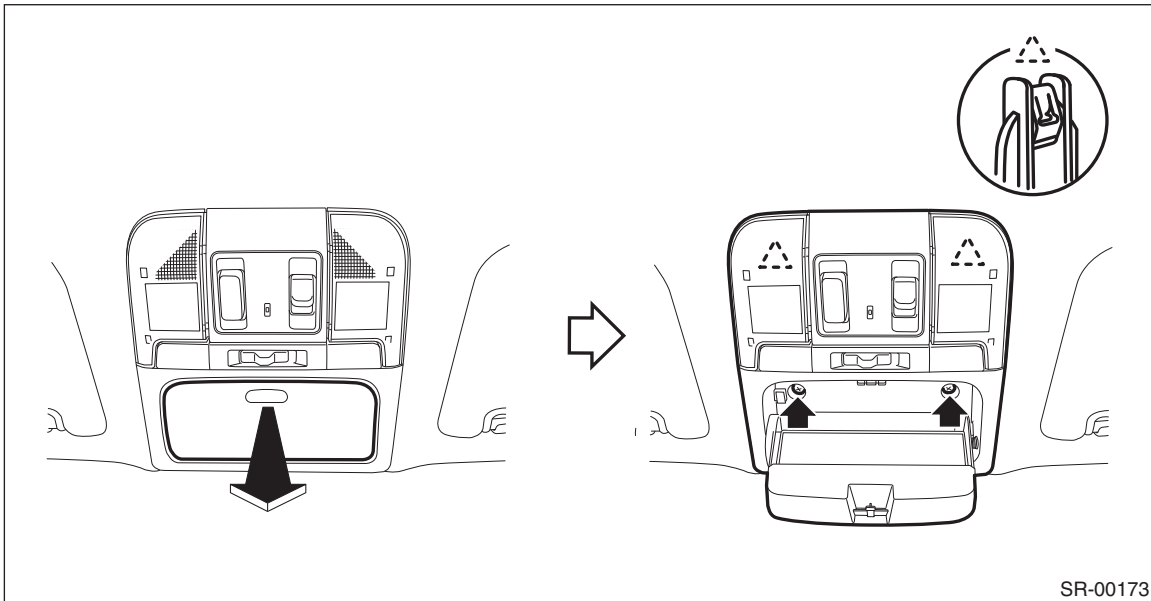

- 3) Release the claws and remove the sunroof switch from the overhead console.

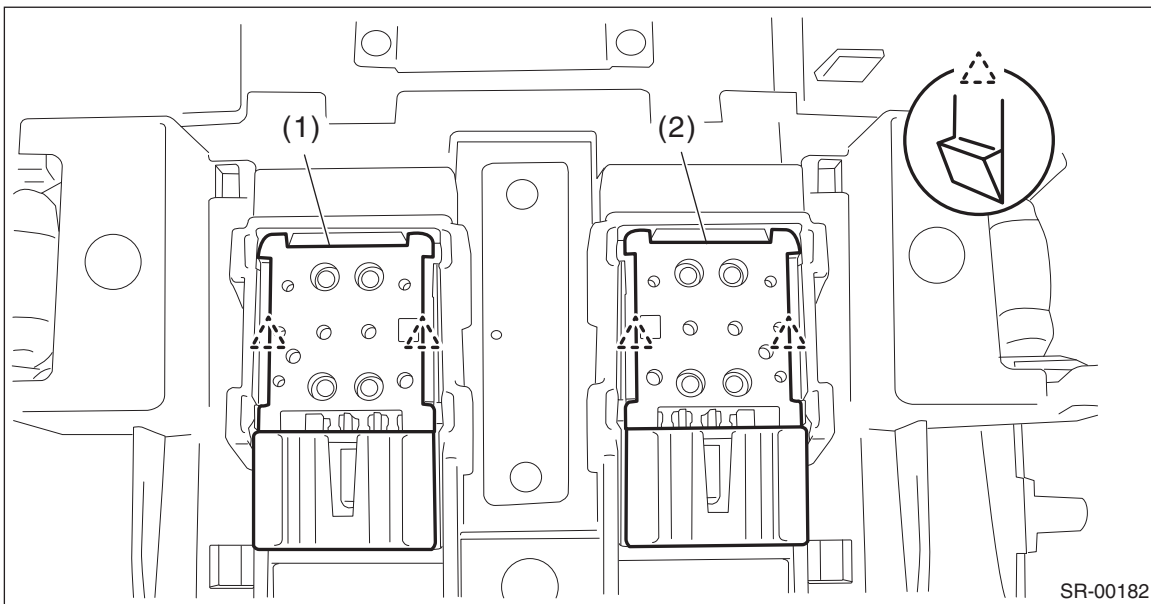

(1) Sunroof switch (tilt)

(2) Sunroof switch (slide)

B: INSTALLATION

Install each part in the reverse order of removal.

Sunroof Switch

SUNROOF/T-TOP/CONVERTIBLE TOP (SUNROOF)

C: INSPECTION

- 1) Remove the overhead console.
- 2) Check the resistance between sunroof switch terminals.

Preparation tool: Circuit tester

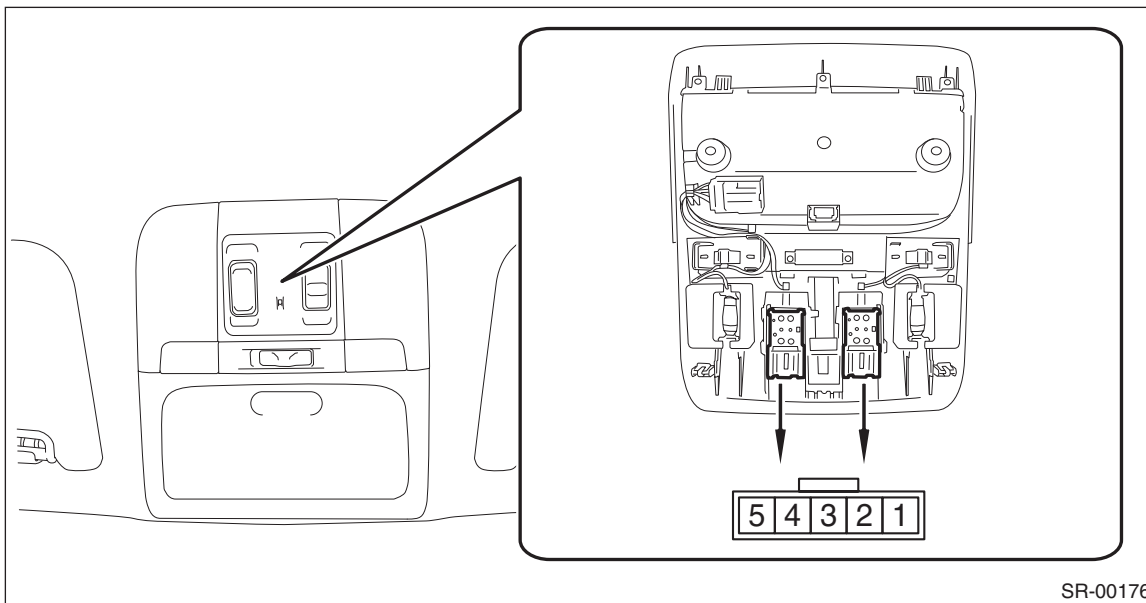

Terminal No.	Inspection conditions	Standard	Connector No.
1 — 3	Open	Less than 1 Ω	R128
4 — 3	Close	Less than 1 Ω	
1 — 3	Tilt up	Less than 1 Ω	R187
4 — 3	Tilt down	Less than 1 Ω	

- 3) Replace the sunroof switch if it is found defective.