

# Timing Belt Cover

MECHANICAL

## 14. Timing Belt Cover

### A: REMOVAL

#### 1. WORK ON THE VEHICLE

- 1) Remove the collector cover.
- 2) Disconnect the ground cable from battery.

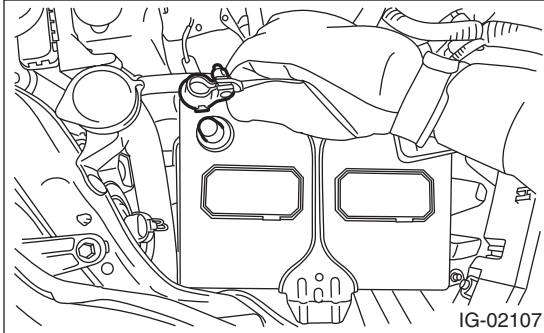

- 3) When removing the timing belt cover RH
  - (1) Remove the air intake duct. <Ref. to IN(H4DOTC)-12, REMOVAL, Air Intake Duct.>
  - (2) Loosen the clamp which holds the intake duct to intercooler.

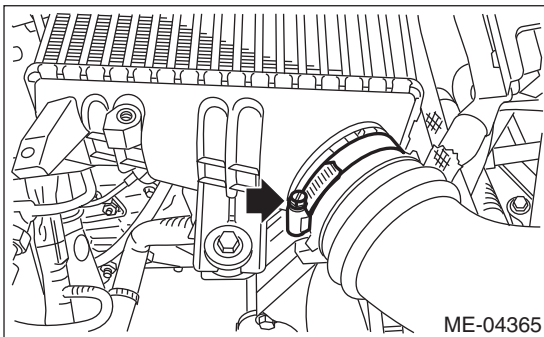

- (3) Remove the V-belts. <Ref. to ME(H4DOTC)-42, REMOVAL, V-belt.>
- (4) Remove the generator. <Ref. to SC(H4SO)-18, REMOVAL, Generator.>
- (5) Remove the suction hose from intake duct.

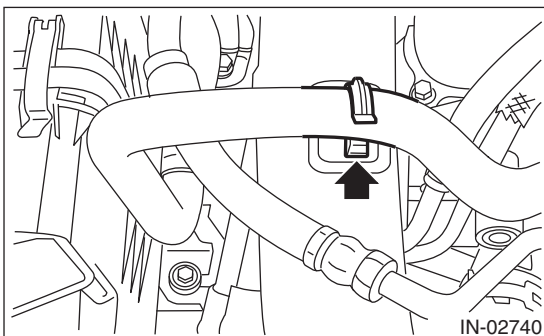

- (6) Disconnect the connector (A) from power steering pump, and remove the power steering pump together with the power steering pump bracket from engine and rod stopper.

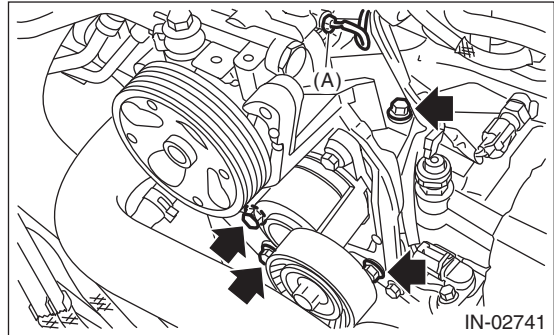

- (7) Mount the power steering pump together with the power steering pump bracket on RH side wheel apron.

- (8) Remove the radiator sub fan motor assembly. <Ref. to CO(H4DOTC)-27, REMOVAL, Radiator Sub Fan and Fan Motor.>

- (9) Remove the engine coolant hose from the clip (A).

- (10) Remove the bolts which secure the intake duct to the turbocharger, and remove the air bypass valve from the intake duct.

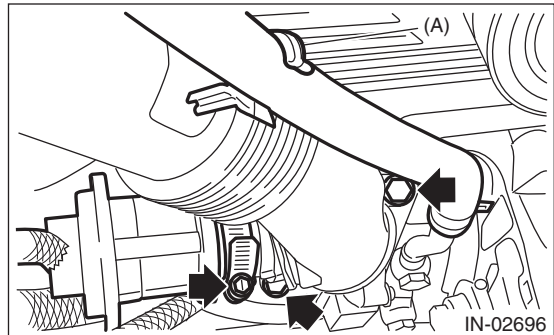

- (11) Remove the intake duct from intake manifold.

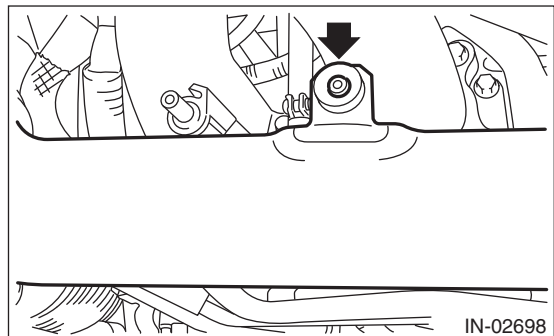

# Timing Belt Cover

MECHANICAL

(12) Disconnect the vacuum hose from blow-by pipe, and remove the bolt securing the blow-by pipe from the intake manifold protector RH.

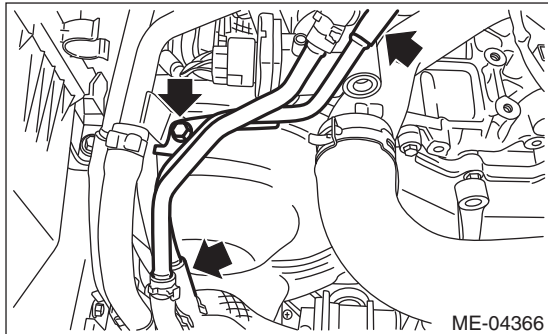

(13) Disconnect the vacuum hose from PCV pipe.

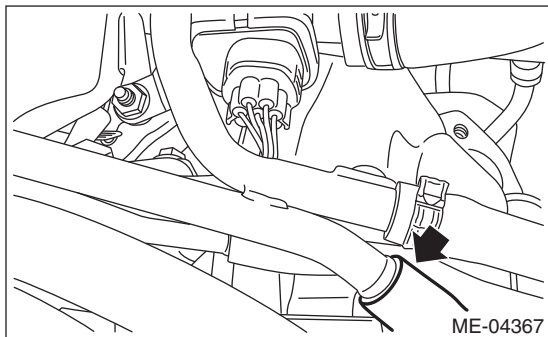

(14) Remove the vacuum hose (A), vacuum hose (B), vacuum hose (C) and vacuum hose (D) from the clip (E).

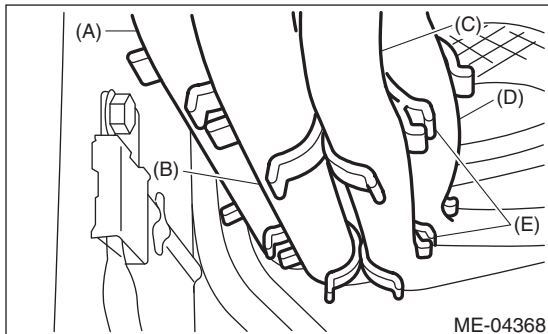

(15) Remove the bolts which secure the upper side of the timing belt cover RH.

(16) Lift up the vehicle.

(17) Remove the under cover. <Ref. to EI-35, REMOVAL, Front Under Cover.>

(18) Remove the air by-pass valve. <Ref. to IN(H4DOTC)-25, REMOVAL, Air By-pass Valve.>

(19) Remove the clip holding the engine harness.

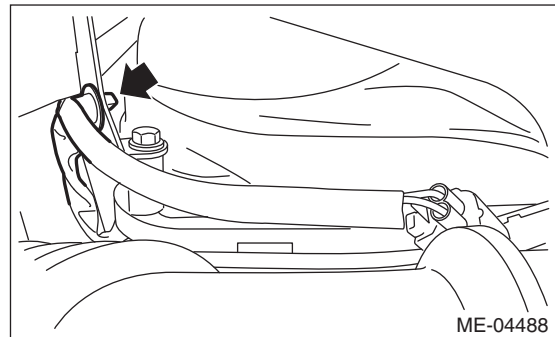

(20) Loosen the remaining bolts which secure timing belt cover RH, and remove the timing belt cover RH together with the hose clip stay assembly.

4) When removing the timing belt cover LH

(1) Disconnect the connectors from front oxygen (A/F) sensor and rear oxygen sensor, and remove the clip (A) securing the front oxygen (A/F) sensor harness and rear oxygen sensor harness.

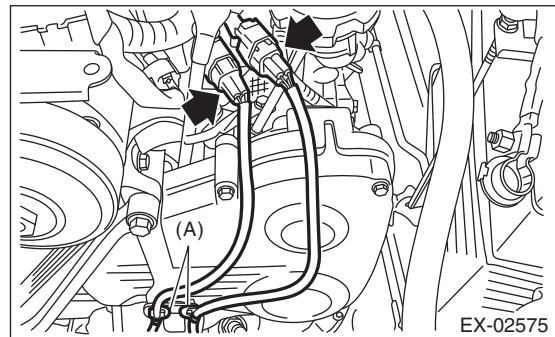

(2) Remove the bolts which secure the upper side of the timing belt cover LH.

(3) Lift up the vehicle.

(4) Remove the under cover. <Ref. to EI-35, REMOVAL, Front Under Cover.>

(5) Loosen the remaining bolts which secure timing belt cover LH, and remove the timing belt cover LH together with the oxygen sensor bracket.

5) When removing the front timing belt cover

(1) Remove the stopper rod.

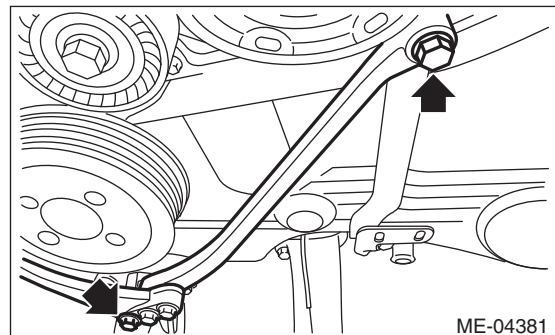

# Timing Belt Cover

## MECHANICAL

- (2) Remove the crank pulley. <Ref. to ME(H4DOTC)-44, REMOVAL, Crank Pulley.>
- (3) Remove the timing belt cover RH and timing belt cover LH. Refer to step 3) and step 4) for removal procedures.
- (4) Remove the bolts securing the front timing belt cover, and remove the front timing belt cover.

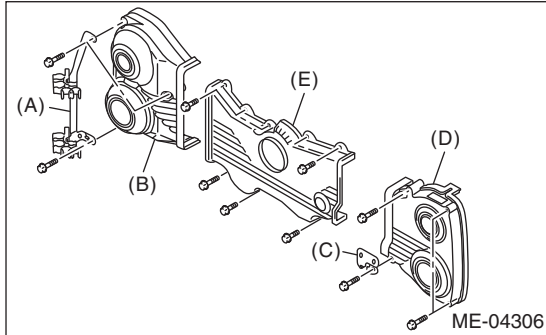

- (A) Hose clip stay ASSY
- (B) Timing belt cover RH
- (C) Oxygen sensor bracket
- (D) Timing belt cover LH
- (E) Front timing belt cover

## 2. WORK ON THE ENGINE UNIT ONLY

- 1) Remove the crank pulley. <Ref. to ME(H4DOTC)-44, REMOVAL, Crank Pulley.>
- 2) Remove the blow-by pipe from the intake manifold protector RH.

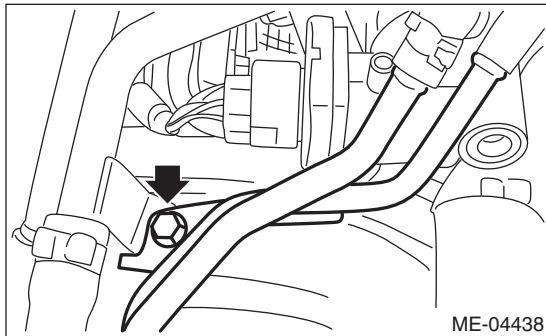

- 3) Remove the vacuum hose (A), vacuum hose (B), vacuum hose (C) and vacuum hose (D) from the clip (E).

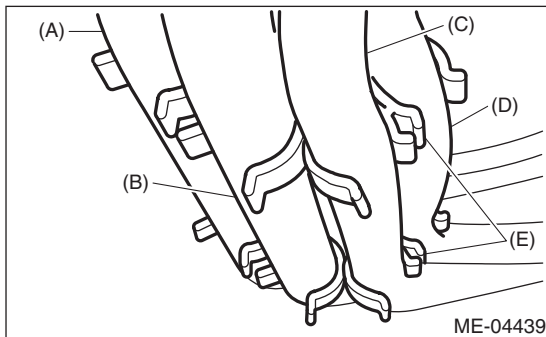

- 4) Remove the clip which holds the engine harness to the hose clip stay assembly.

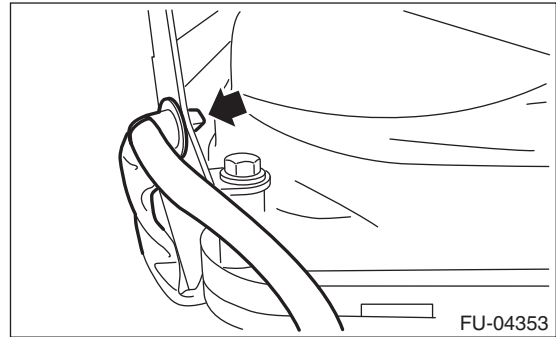

- 5) Remove timing belt cover RH (B) together with the hose clip stay assembly (A).
- 6) Remove timing belt cover (LH) (D) together with the oxygen (A/F) sensor bracket (C).
- 7) Remove front timing belt cover (E).

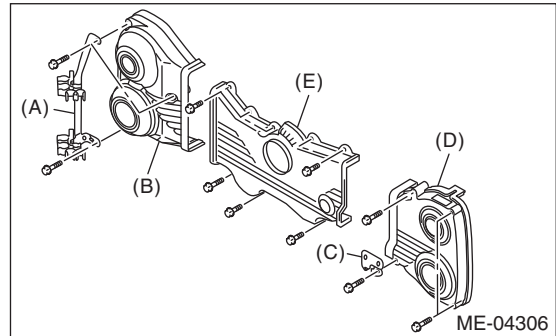

## B: INSTALLATION

### 1. WORK ON THE VEHICLE

Install in the reverse order of removal.

**NOTE:**

Install the vacuum hose as shown in the figure.

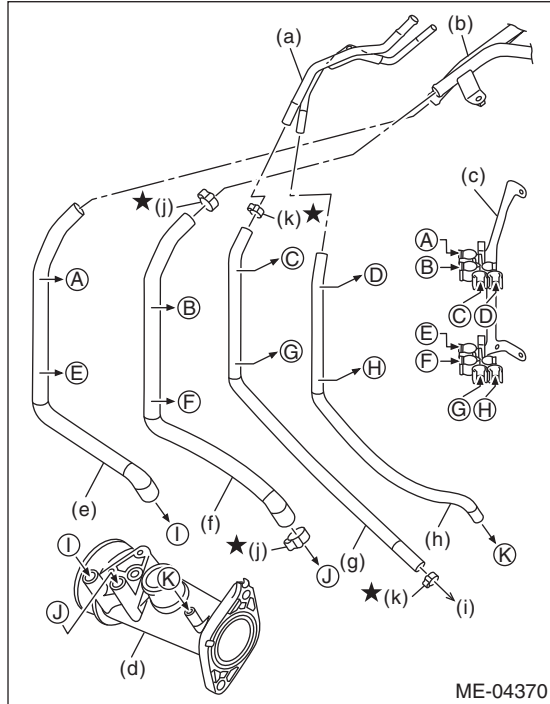

- (a) Blow-by pipe
- (b) PCV pipe
- (c) Hose clip stay ASSY
- (d) Intake duct
- (e) Vacuum hose (A)
- (f) Vacuum hose (B)
- (g) Vacuum hose (C)
- (h) Vacuum hose (D)
- (i) To Oil catch tank
- (j) Clamp
- (k) Clamp

**Tightening torque:**

**5 N·m (0.5 kgf-m, 3.7 ft-lb)**

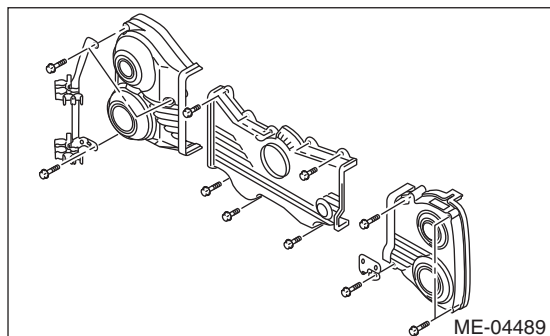

**Tightening torque:**

**6.4 N·m (0.7 kgf-m, 4.7 ft-lb)**

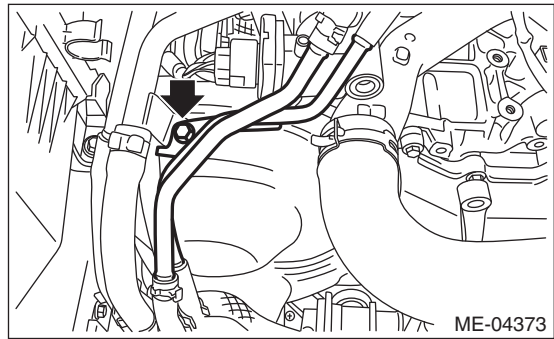

**Tightening torque:**

**T1: 3 N·m (0.3 kgf-m, 2.2 ft-lb)**

**T2: 16 N·m (1.6 kgf-m, 11.8 ft-lb)**

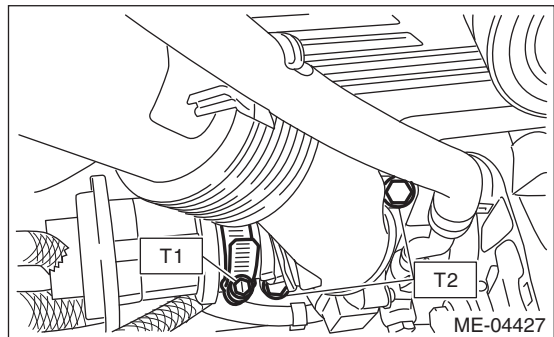

**Tightening torque:**

**Refer to "COMPONENT" of "STARTING/CHARGING SYSTEMS" for the tightening torque. <Ref. to SC(H4SO)-5, GENERATOR, COMPONENT, General Description.>**

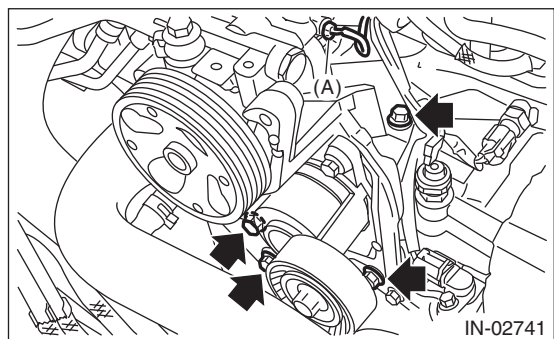

**Tightening torque:**

**3 N·m (0.3 kgf-m, 2.2 ft-lb)**

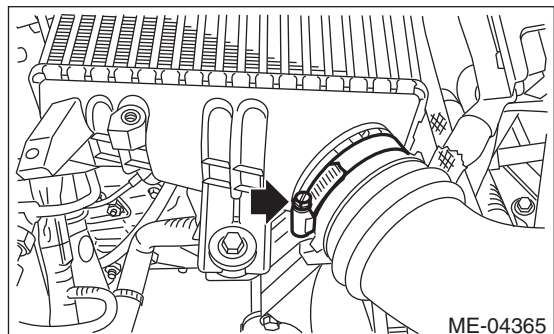

# Timing Belt Cover

MECHANICAL

**Tightening torque:**

**36 N-m (3.7 kgf-m, 26.6 ft-lb)**

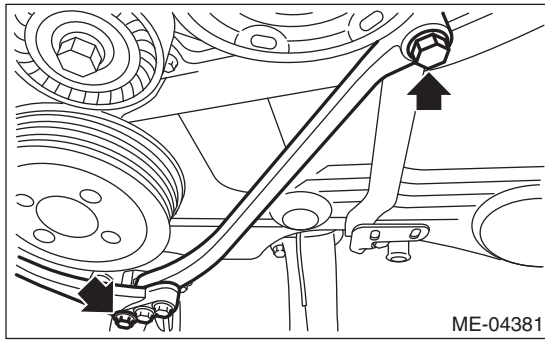

**Tightening torque:**

**5 N-m (0.5 kgf-m, 3.7 ft-lb)**

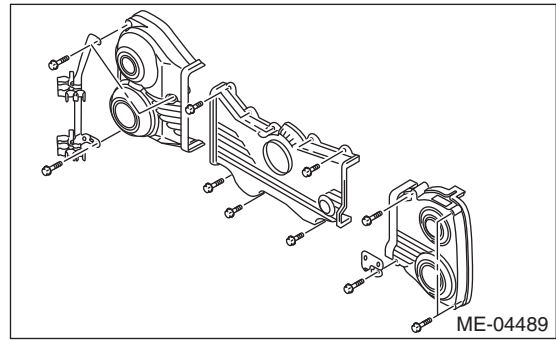

## 2. WORK ON THE ENGINE UNIT ONLY

Install in the reverse order of removal.

**NOTE:**

Install the vacuum hose as shown in the figure.

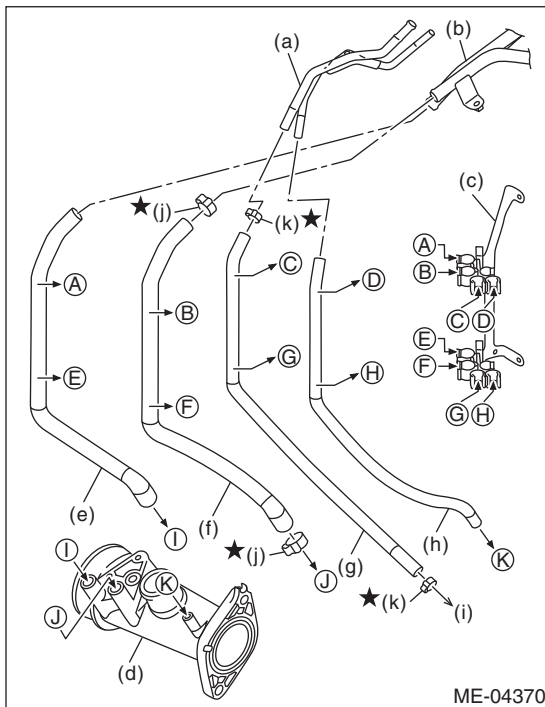

- (a) Blow-by pipe
- (b) PCV pipe
- (c) Hose clip stay ASSY
- (d) Intake duct
- (e) Vacuum hose (A)
- (f) Vacuum hose (B)
- (g) Vacuum hose (C)
- (h) Vacuum hose (D)
- (i) To Oil catch tank
- (j) Clamp
- (k) Clamp

**Tightening torque:**

**6.4 N-m (0.7 kgf-m, 4.7 ft-lb)**

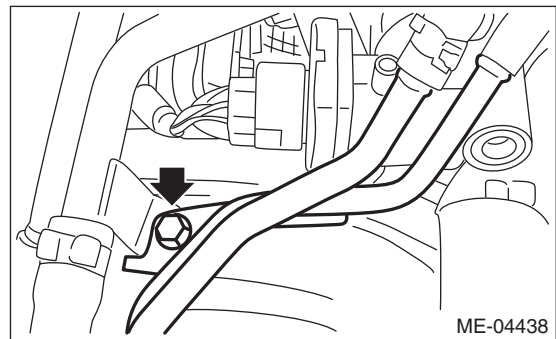

## C: INSPECTION

Check that the timing belt cover does not have deformation, cracks and any other damage.