

## 3. Air Cleaner Case

### A: REMOVAL

- 1) Disconnect the ground cable from battery.
- 2) Disconnect the power steering oil pressure hose (suction hose) from the clip on the side of air cleaner case (rear).

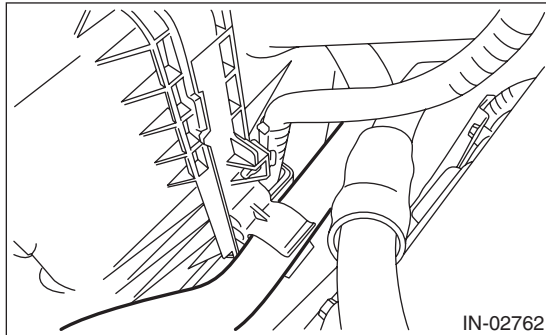

- 3) Disconnect the connector (A) from the mass air flow and intake air temperature sensor, and remove the clip (B).

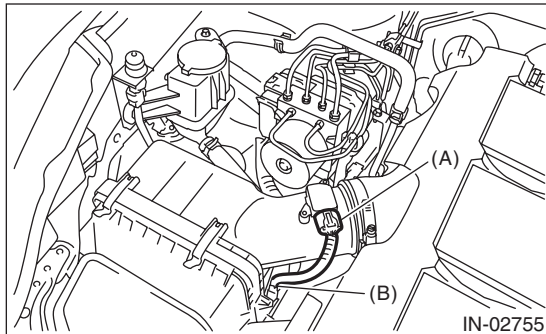

- 4) Loosen the clamp (A) which connects the air cleaner case (rear) and air intake boot.
- 5) Remove the clip (B) securing the upper side of air cleaner case (rear).

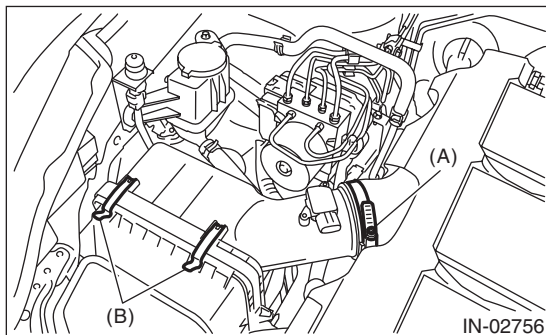

- 6) Remove the air intake duct. <Ref. to IN(H6DO)-8, REMOVAL, Air Intake Duct.>
- 7) Remove the air cleaner case (rear) and air cleaner element.

- 8) Remove the bolts (A) and nuts (B) which secure the air cleaner case (front) to the body.

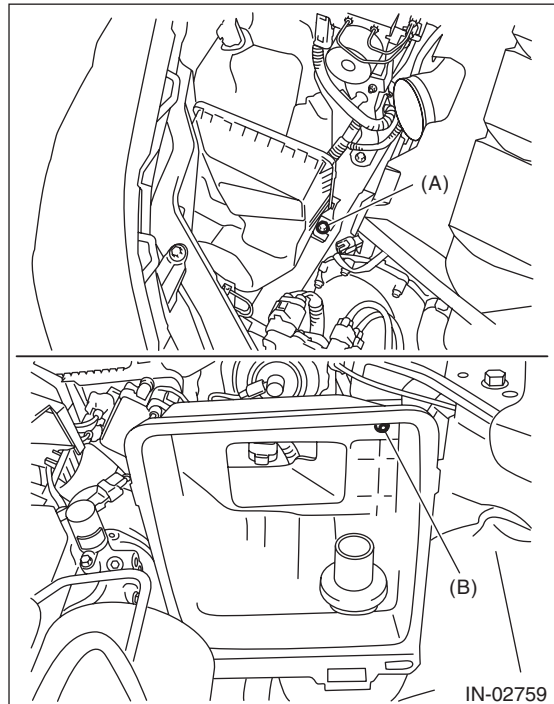

- 9) Remove the air cleaner case (front).

### B: INSTALLATION

- 1) Install the bolt (A) and nut (B) which secure the air cleaner case (front) to the body.

#### Tightening torque:

##### Bolt (A)

**6 N·m (0.6 kgf-m, 4.4 ft-lb)**

##### Nut (B)

**7.5 N·m (0.8 kgf-m, 5.5 ft-lb)**

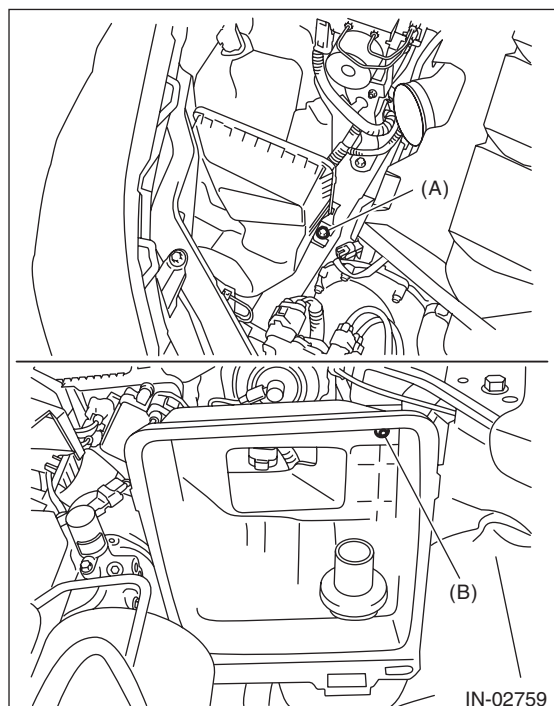

# Air Cleaner Case

## INTAKE (INDUCTION)

2) Install the air cleaner case (rear) and air cleaner element.

### NOTE:

When installing the air cleaner case (rear), align the protrusion of the air cleaner case (rear) to the hole on the air cleaner case (front) to install.

3) Install the air intake duct. <Ref. to IN(H6DO)-8, INSTALLATION, Air Intake Duct.>

4) Attach the clip (B) to the air cleaner case (front), and tighten the clamp (A) connecting the air cleaner case (rear) and air intake boot assembly.

### Tightening torque:

#### Clamp (A)

**3 N·m (0.3 kgf-m, 2.2 ft-lb)**

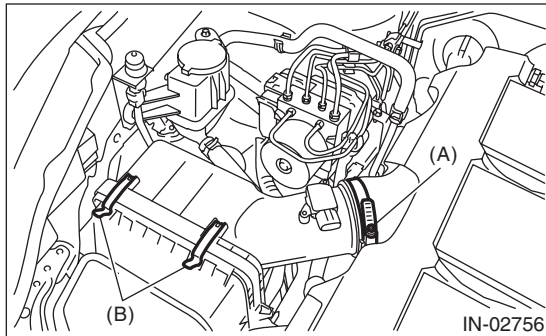

5) Connect the connector (A) to the mass air flow and intake air temperature sensor, and fasten the harness to clip (B).

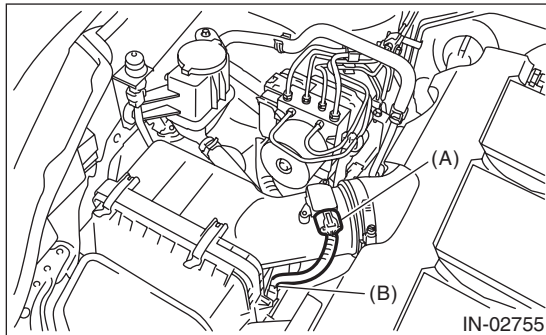

6) Connect the power steering oil pressure hose (suction hose) to the clip on the side of air cleaner case (rear).

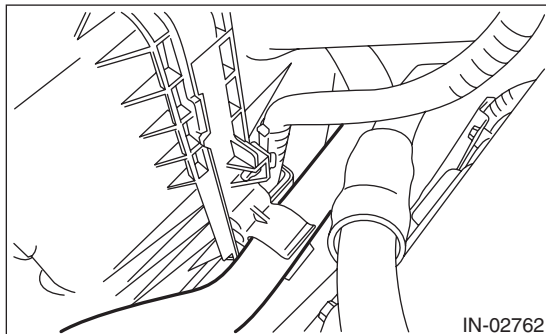

7) Connect the battery ground terminal.

## C: INSPECTION

1) Check that the air cleaner case has no deformation, cracks or other damages.

2) Check the air intake boot assembly for cracks, damage or looseness.