

# Rear Shock Absorber

## REAR SUSPENSION

### 7. Rear Shock Absorber

#### A: REMOVAL

- 1) Disconnect the ground cable from battery.
- 2) Remove the trunk trim panel assembly - side (sedan model) or rear floor mat (OUTBACK model).
  - Sedan model: <Ref. to EI-130, TRUNK ROOM TRIM, REMOVAL, Trunk Room Trim.>
  - OUTBACK model:

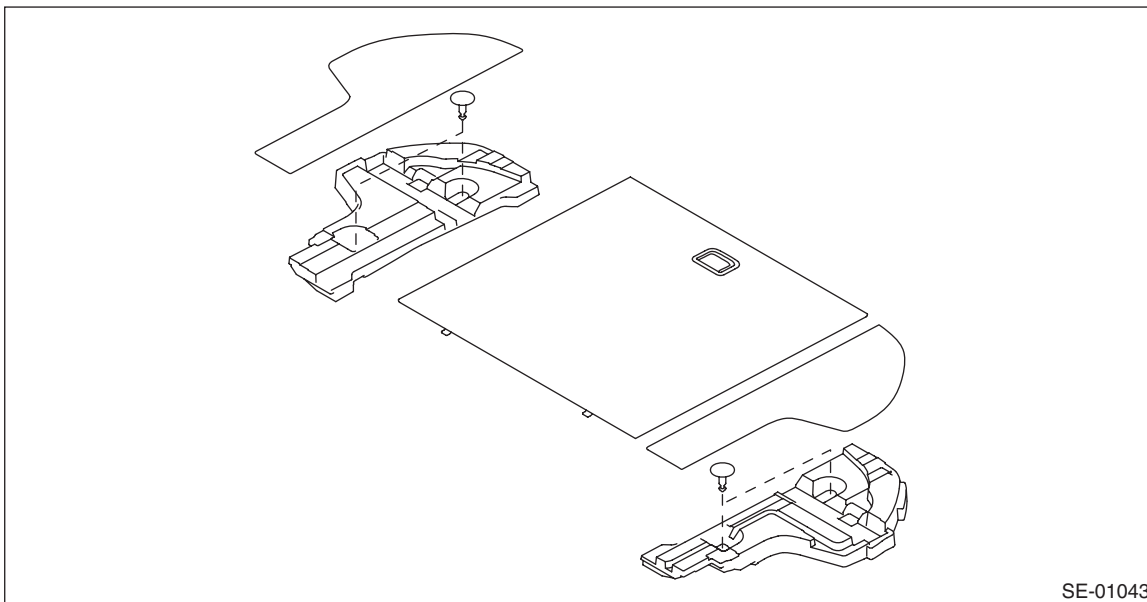

- 3) Lift up the vehicle, and then remove the rear wheels.
- 4) Remove the bolts and nuts and lower the rear lateral link.
  - (1) Remove the nut and disconnect the rear stabilizer link.
  - (2) Remove the shock absorber lower bolt.
  - (3) Disconnect the rear lateral link.

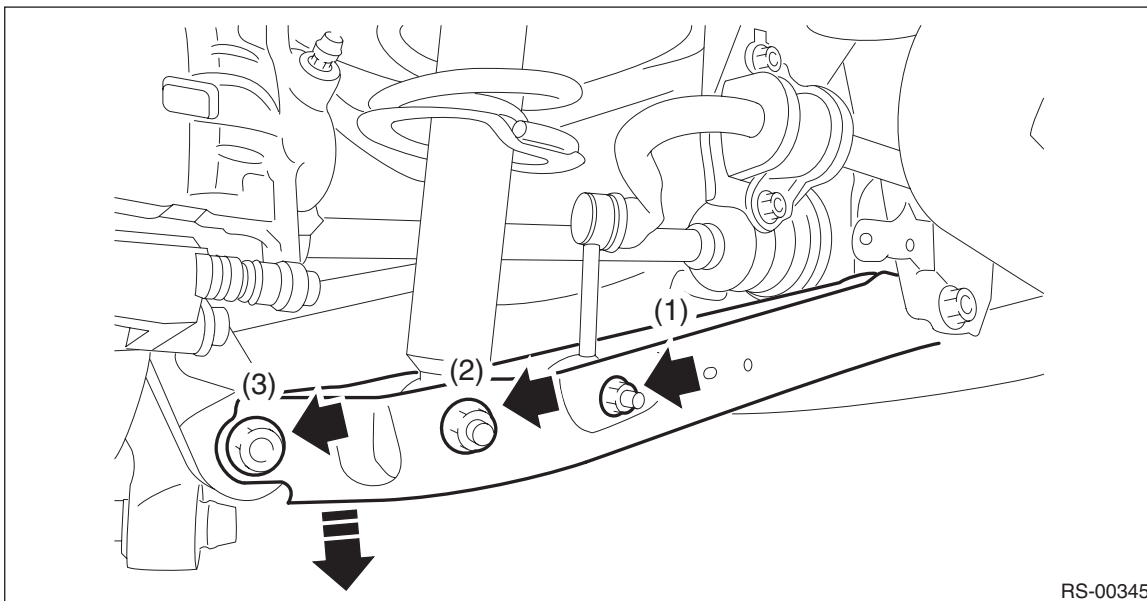

5) Remove the shock absorber mount nut.

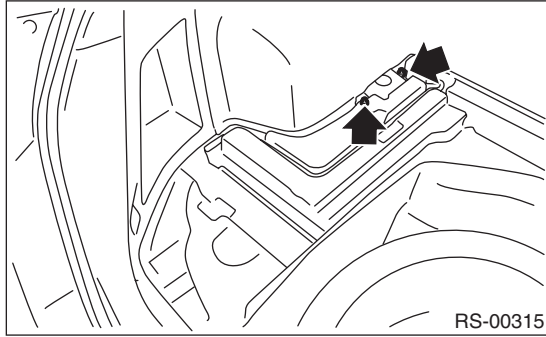

6) Remove the shock absorber.

## B: INSTALLATION

### CAUTION:

- Be sure to use a new flange nut and self-locking nut.
- Always tighten the bushing in the state where the vehicle is at curb weight and the wheels are in full contact with the ground.

1) Install each part in the reverse order of removal.

### Tightening torque:

Refer to “COMPONENT” of “General Description” for the tightening torque. <Ref. to RS-3, COMPONENT, General Description.>

2) Install the rear wheels.

### Tightening torque:

**120 N·m (12.24 kgf-m, 88.5 ft-lb)**

3) Check the wheel alignment and adjust it if necessary. <Ref. to FS-9, INSPECTION, Wheel Alignment.>

### CAUTION:

When the wheel alignment has been adjusted, perform the 0 point setting mode for each sensor in the VDCCM&H/U. <Ref. to VDC-20, ADJUSTMENT, VDC Control Module and Hydraulic Control Unit (VDCCM&H/U).>

## C: DISASSEMBLY

Refer to “Front Strut” for disassembly procedure. <Ref. to FS-43, DISASSEMBLY, Front Strut.>

## D: ASSEMBLY

Refer to “Front Strut” for assembly procedures. <Ref. to FS-44, ASSEMBLY, Front Strut.>

## E: INSPECTION

Refer to “Front Strut” for inspection procedures. <Ref. to FS-45, INSPECTION, Front Strut.>

# Rear Shock Absorber

REAR SUSPENSION

---

## F: DISPOSAL

### CAUTION:

- Before handling the shock absorber, be sure to wear goggles to protect eyes from gas, oil and cutting powder.

- Do not disassemble the shock absorber or place it into a fire.

- Drill a hole into shock absorbers in case of discarding shock absorbers filled with gas.

1) Place the shock absorber on a level surface with the piston rod fully expanded.

2) Make a hole into the specified position 30 mm (1.18 in) deep using a drill with 2 — 3 mm (0.08 — 0.12 in) diameter.

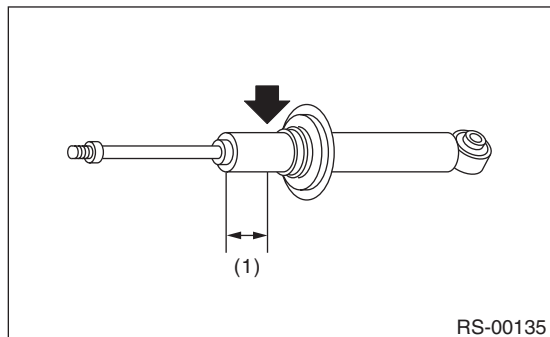

(1) 40 mm (1.57 in)