

## 22.Rear Shelf Trim

### A: REMOVAL

1) Disconnect the ground cable from battery and wait for at least 60 seconds before starting work.

#### CAUTION:

The airbag system is fitted with a backup power supply. After disconnecting the battery ground cable, the airbag may operate if you do not wait for 60 seconds before starting the service of airbag system.

2) Remove the rear seat cushion assembly.

(1) Pull up the seat cushion and release the hook.

#### CAUTION:

If the hook is disconnected from the vehicle body, replace the hook with the new part to prevent the decline of the fixed force of the seat.

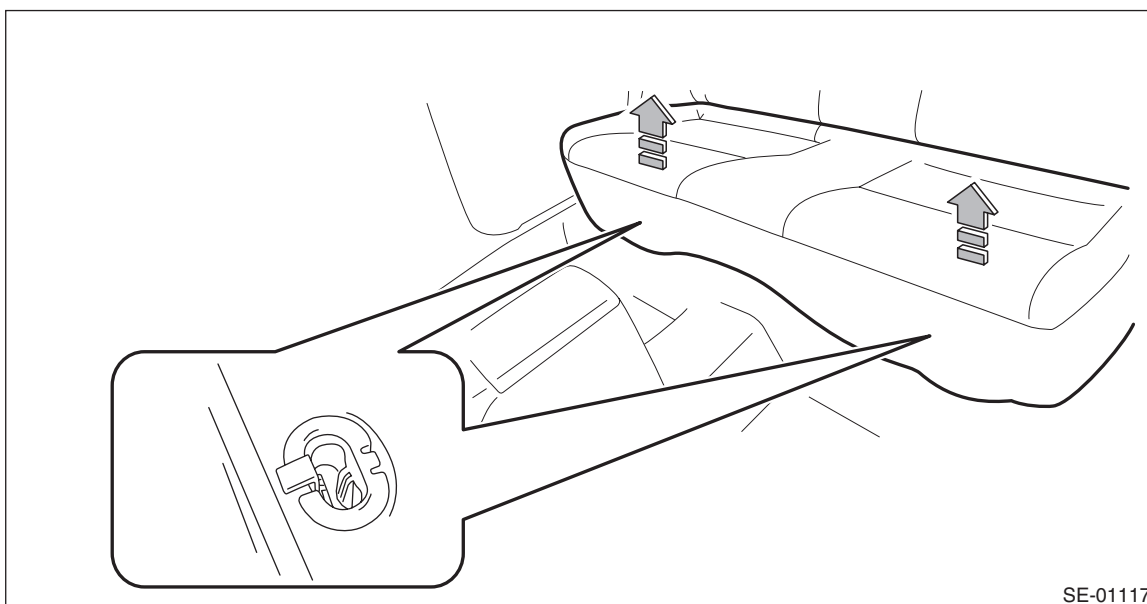
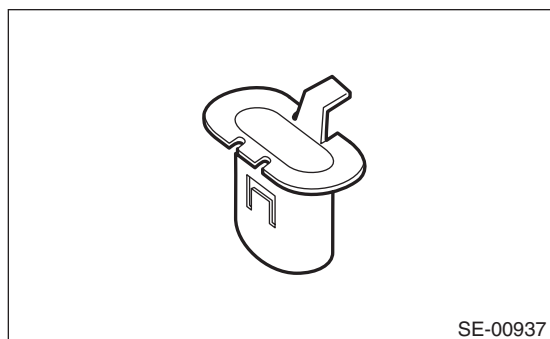

## Rear Shelf Trim

### EXTERIOR/INTERIOR TRIM

(2) Remove the hook (A) by pushing it back while lifting the front side of the seat cushion, and remove the seat cushion.

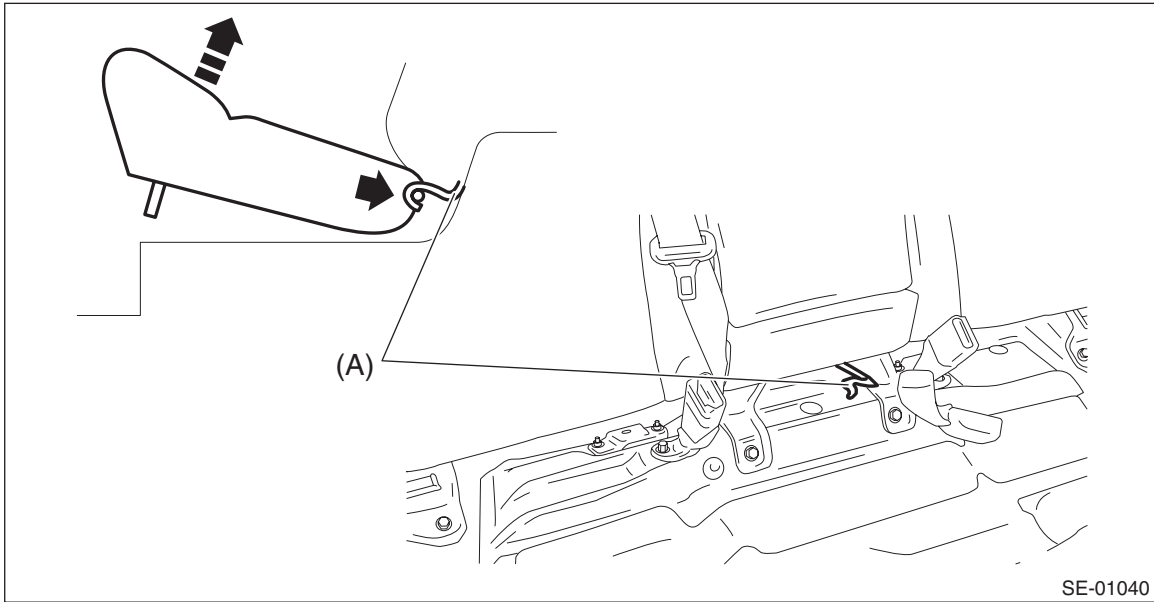

3) Release the clips and claws, and remove the side sill covers - rear INN on the left and right sides.

#### CAUTION:

Do not pull with excessive force. Doing so may damage the claws of the side sill cover INN.

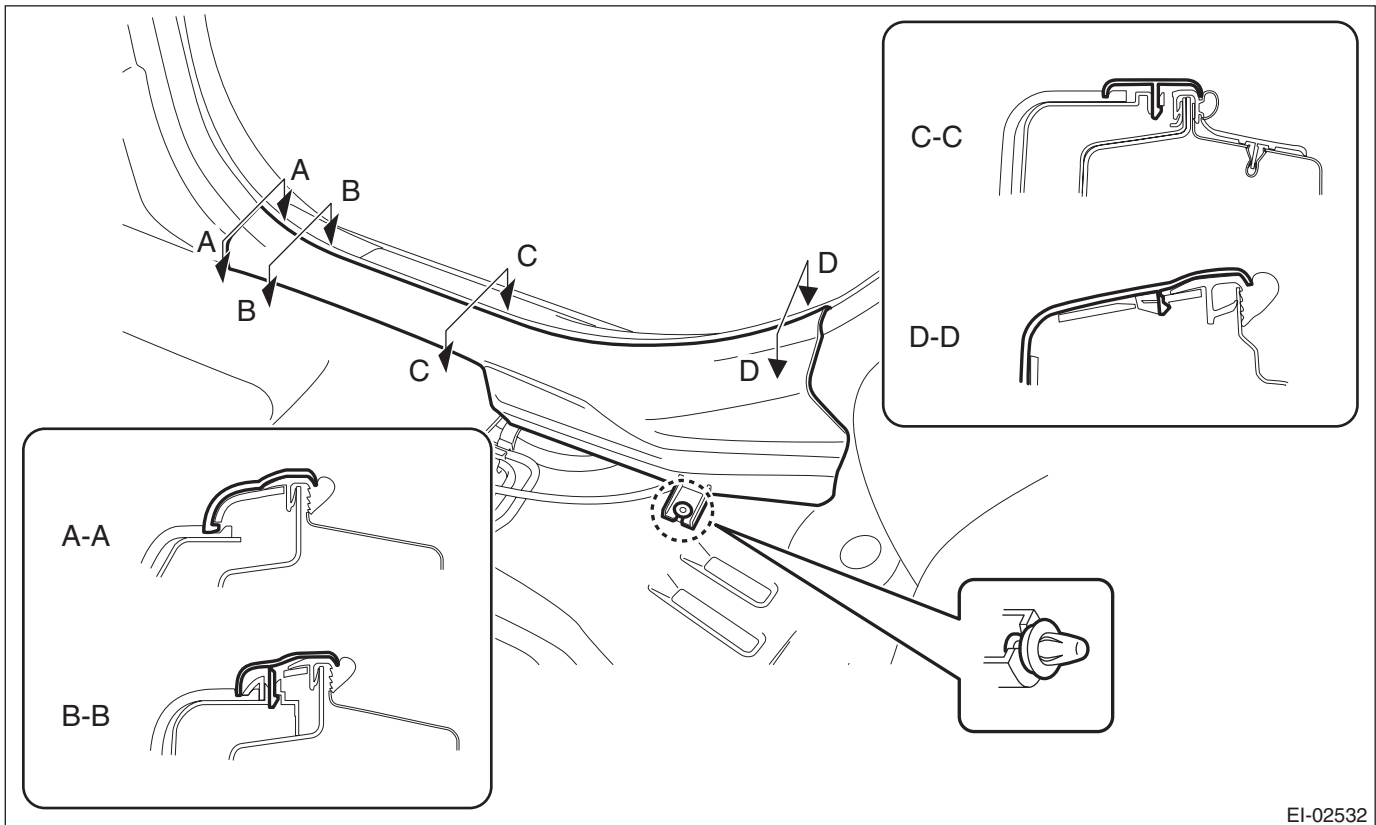

#### NOTE:

To release the claws of the side sill cover INN, the following steps are recommended.

1. Take out the weather strip from under the side sill cover INN.
2. Turn over the floor mat and release the claw (C-C and D-D) by accessing from behind the side sill cover INN.

4) Remove the left and right rear quarter trim LWR.

(1) Remove the backrest side pad.

a) Remove the screws.

**Preparation tool:**

**Stubby screwdriver**

b) Turn over the bottom end of the backrest side pad in the forward direction so that the claws are released.

c) Remove the backrest side pad by pulling it up.

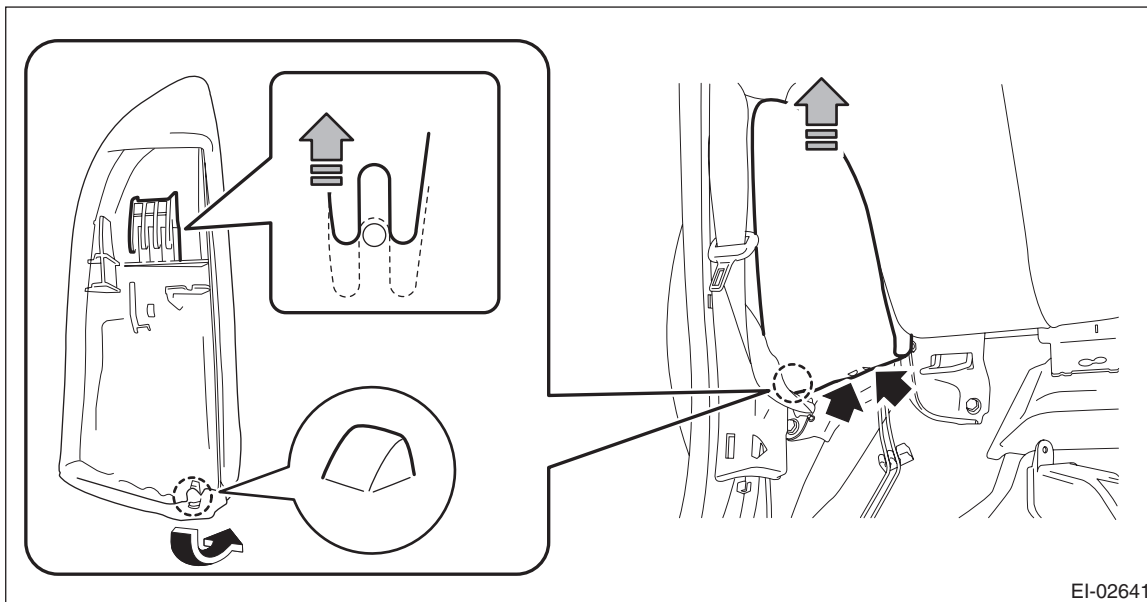

(2) Pull the release lever in the trunk room, and then tilt the backrest forward.

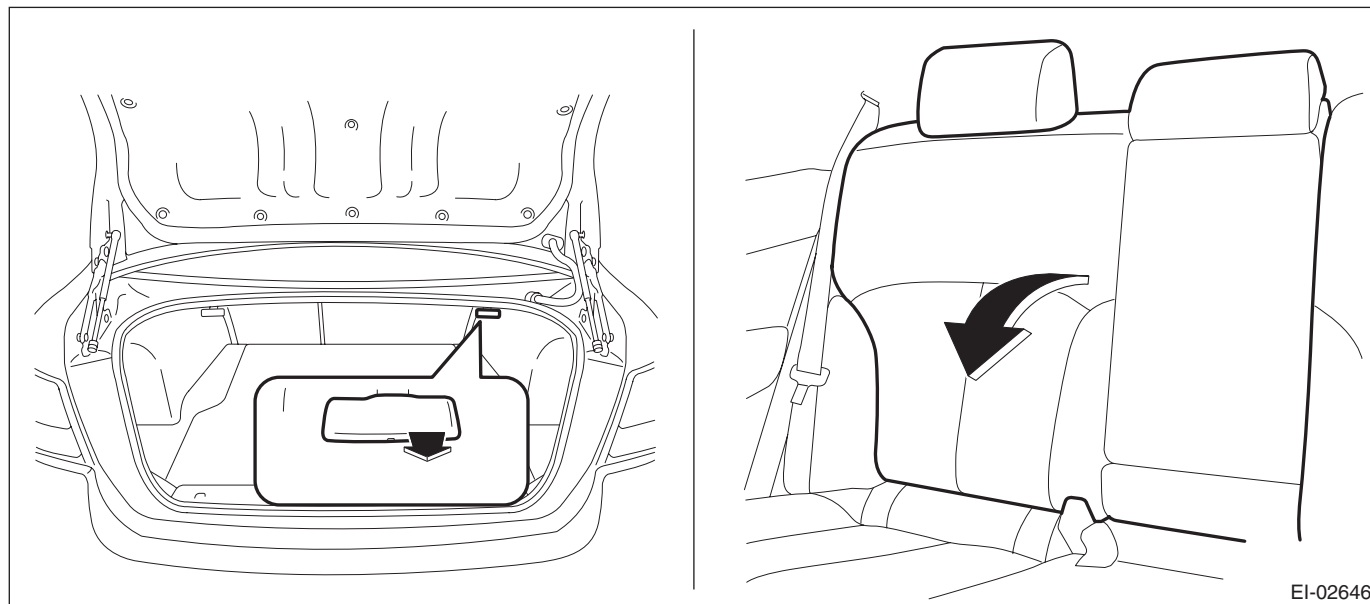

(3) Release the clips of the trunk trim panel assembly - side.

## Rear Shelf Trim

### EXTERIOR/INTERIOR TRIM

- (4) Remove the clips, and remove the rear quarter trim LWR.

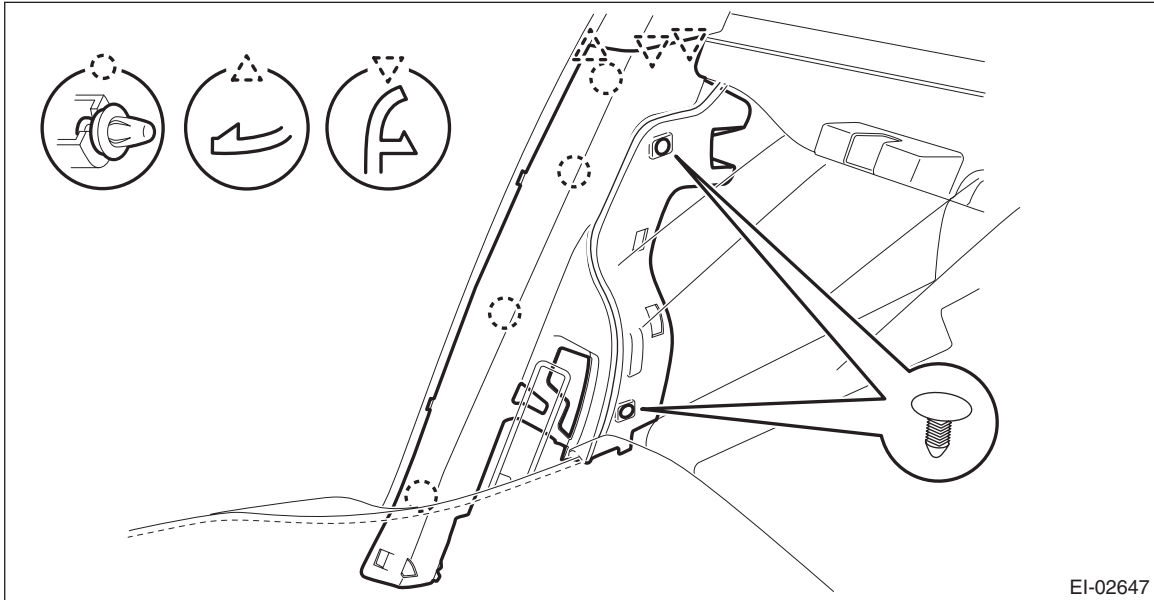

- 5) Remove the left and right rear quarter trim UPR.

- (1) Remove the lower anchor bolt of the outer belt assembly.

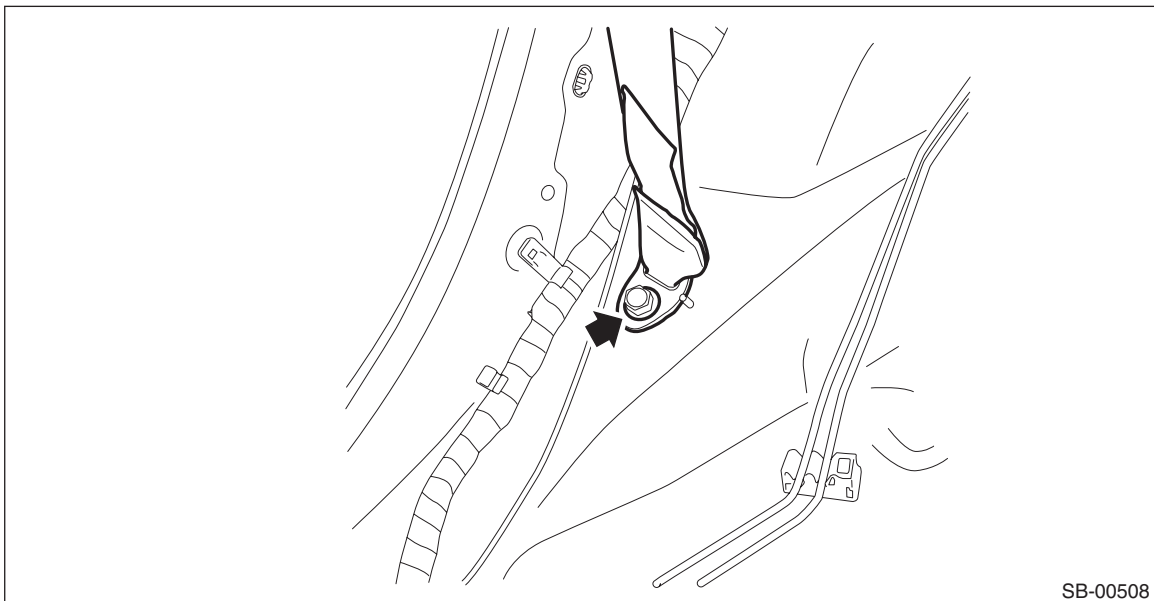

- (2) Release the clips, and remove the rear quarter trim UPR.

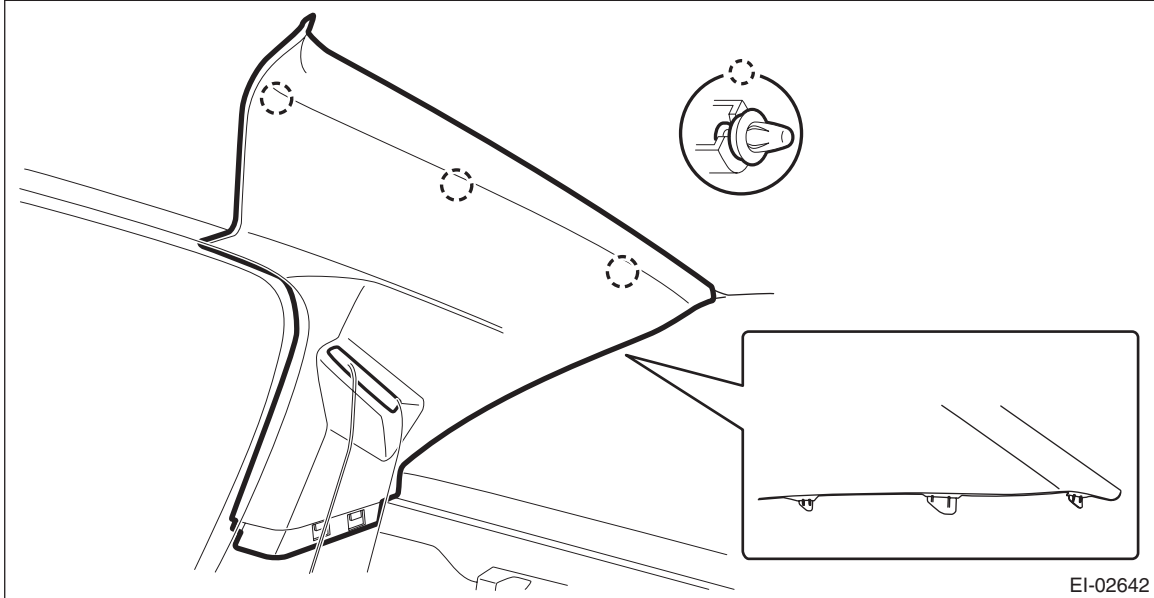

- (3) Pull out the seat belt and remove the rear quarter trim UPR.  
6) Release the clips and remove the trunk trim panel assembly - front on the left and right sides.

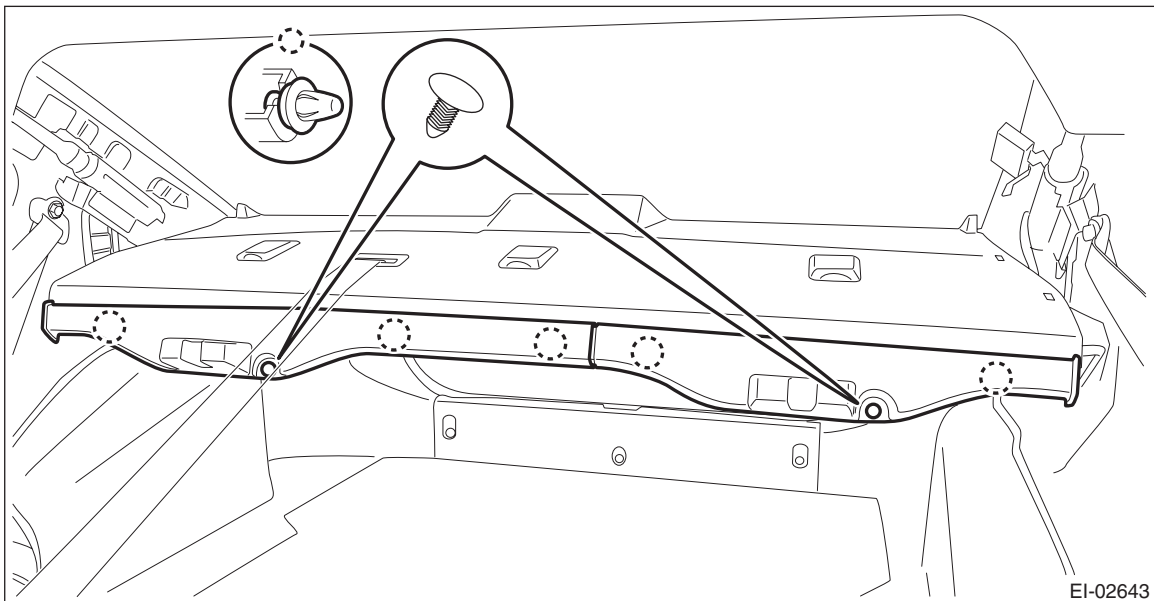

## Rear Shelf Trim

### EXTERIOR/INTERIOR TRIM

- 7) Remove the lower anchor of the shoulder belt assembly CTR.
- (1) Remove the nuts and remove the ISO-FIX anchor.
  - (2) Remove the bolts, and remove the lower anchor of shoulder belt assembly CTR.

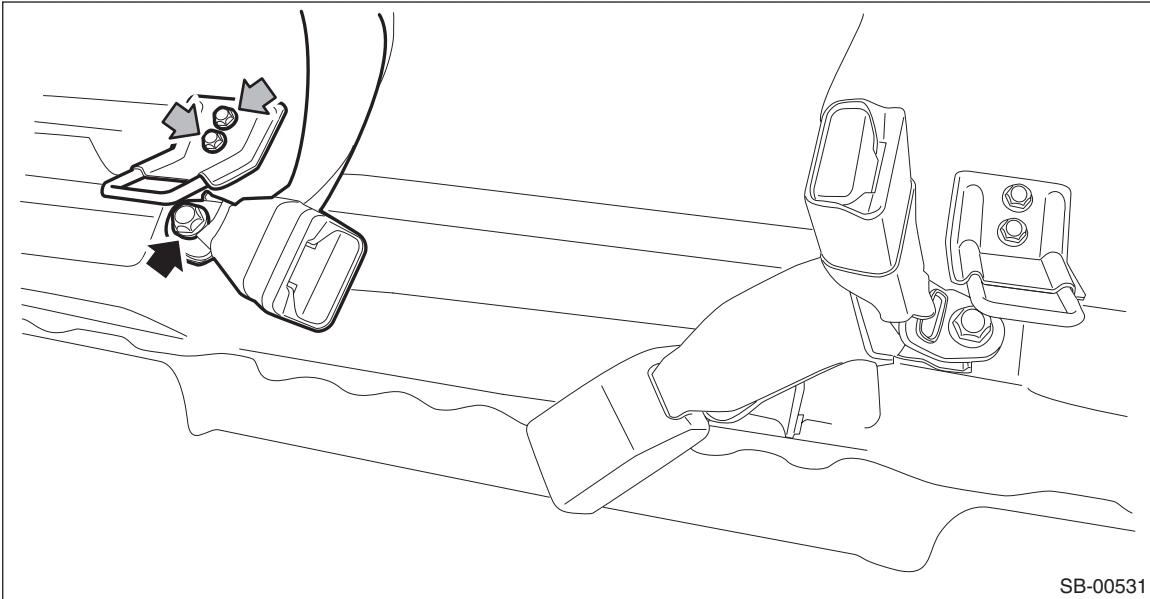

- 8) Remove the rear shelf panel assembly.
- (1) Release the clips to float the rear shelf panel assembly.
  - (2) Release the belt guide and guide the anchor of rear center seat belt to behind the shelf panel.
  - (3) Disconnect the connector of high-mounted stop light.
  - (4) Remove the rear shelf panel assembly.

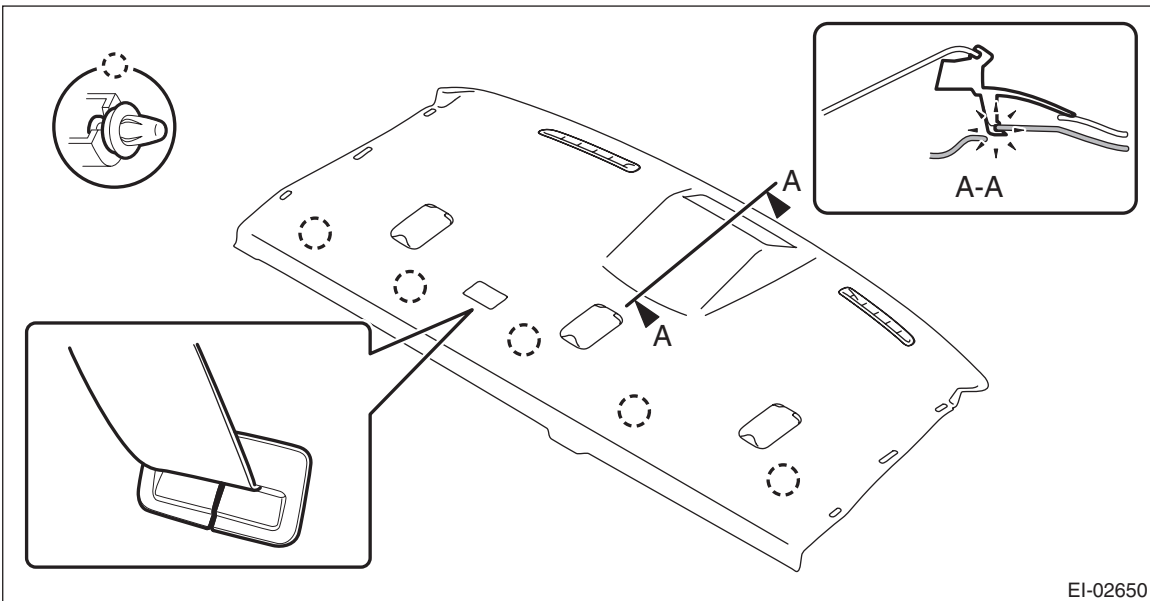

**B: INSTALLATION****CAUTION:**

- Make sure to insert the claws on the back of high-mounted stop light into the rear shelf panel.
- If the hook is disconnected from the vehicle body, replace the hook with the new part to prevent the decline of the fixed force of the seat.

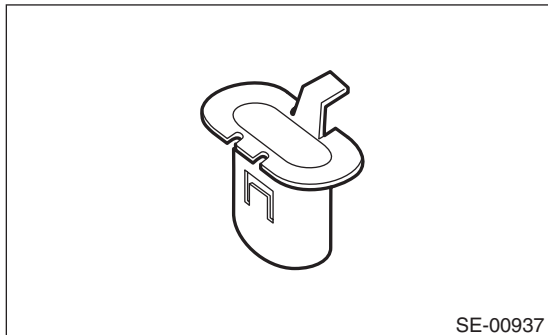

- Make sure to insert the claws on the back of high-mounted stop light into the rear shelf panel.
- Install each part in the reverse order of removal.

**Tightening torque:**

**ISO-FIX anchor:** 25 N·m (2.55 kgf-m, 18.4 ft-lb)

**Rear seat belt:** <Ref. to SB-3, REAR SEAT BELT (SEDAN MODEL), COMPONENT, General Description.>