

27.Rear Gate Trim

A: REMOVAL

- 1) Remove the rear gate upper trim.
 - (1) Remove the claws on the trim edge.
 - (2) Disconnect the claws in the center of trim, and remove the rear gate upper trim.

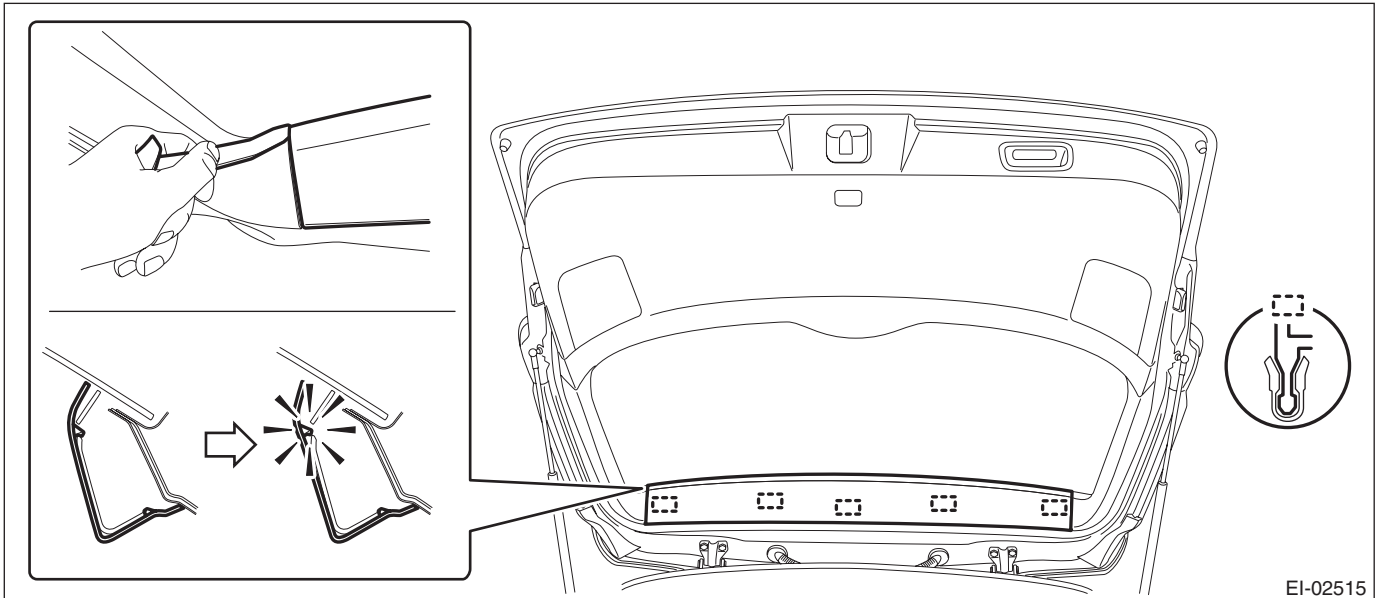

- 2) Remove the rear gate pillar trim.
 - (1) Release the claws.
 - (2) Remove the claws on the bottom of trim, and remove the rear gate pillar trim.

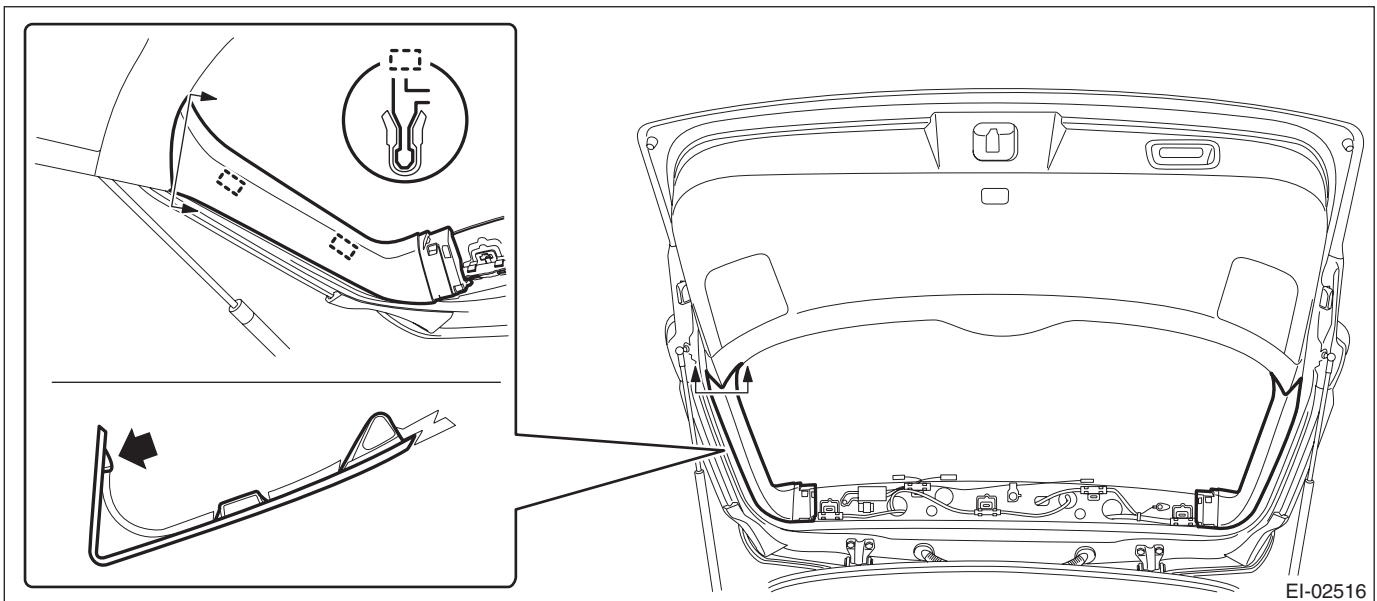

3) Remove the hand grip of rear gate.

CAUTION:

- **Be careful not to scratch the trim.**
- **To protect the trim from damage, attach a protective tape to the tool in use.**
 - (1) Insert a precision screwdriver (a).
 - (2) With the screwdriver inserted, move the precision screwdriver toward the claw and open the cap.
 - (3) Remove the screws and detach the hand grip.

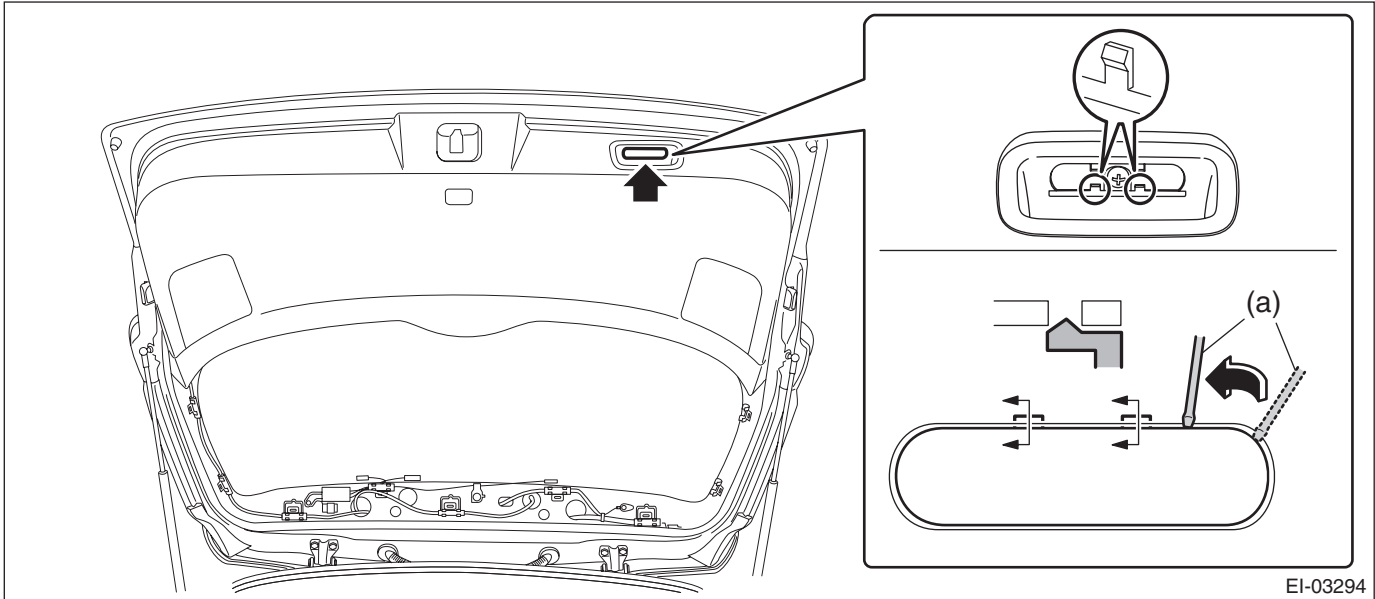

EI-03294

4) Remove the clips, and then remove the rear gate lower trim.

- (1) Remove the clips on both ends.
- (2) Release the clips and remove the rear gate lower trim.

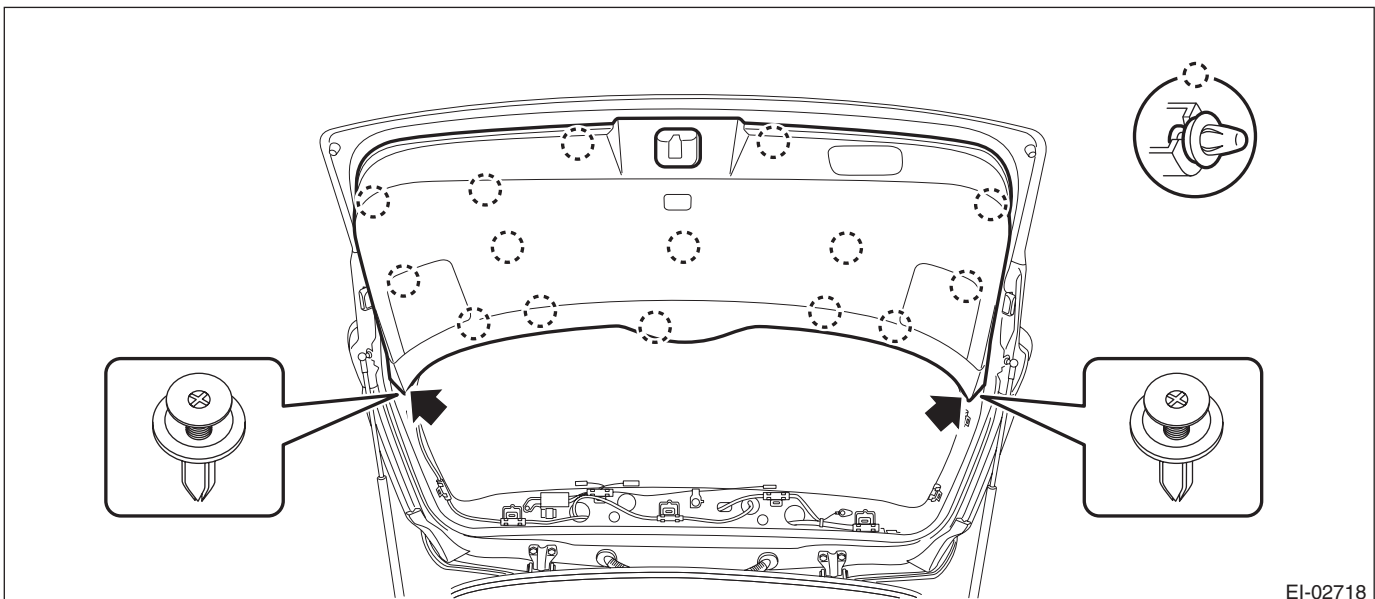

EI-02718

B: INSTALLATION

Install each part in the reverse order of removal.